

Radiation issues in UJ76

- ✓ Neutron rates ($E > 20 \text{ MeV}$) expected in UJ76
- ✓ Equipment inventory and layout
- ✓ Moving equipment in the TZ76 gallery

LHC Project Note 372 (ultimate conditions $4 \cdot 10^{16}$ p lost/year)

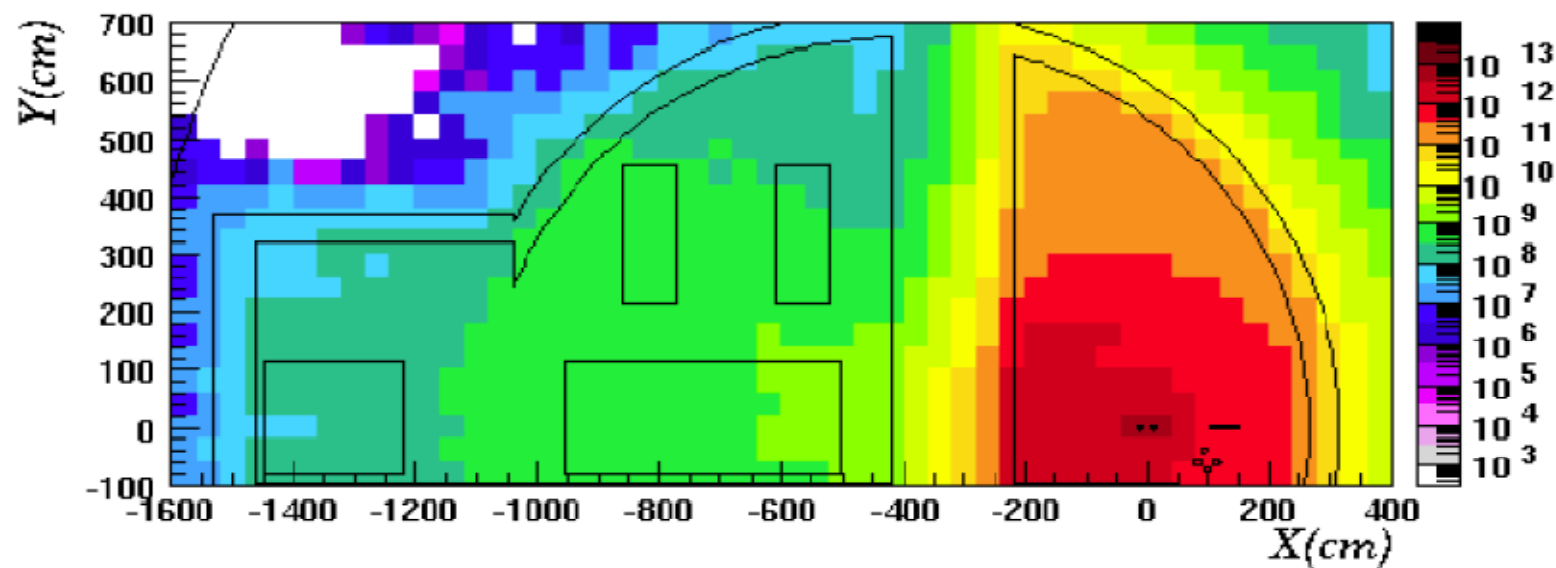
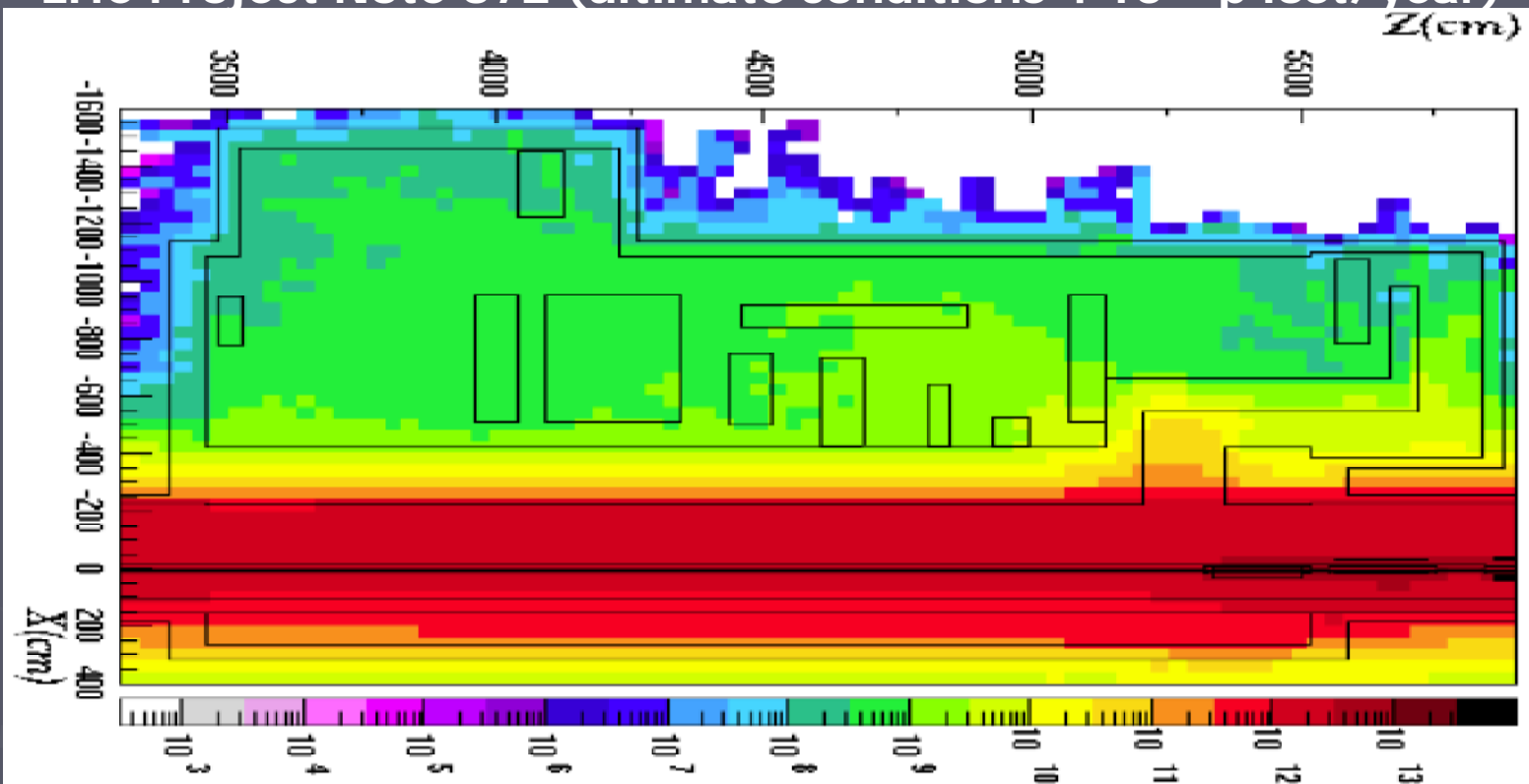

Rack inventory: ICL Web Page → Liens utiles: PSIWG → Racks Schedule

Tableau récapitulatif des demandes d'emplacements de racks à la date du 13/07/2006

	Responsables	D.Macia TS/LEA	J-C.Billy AT/VAC	F.Decorre t AB/ATB	J.Koopman AB/BDI	T.Wijanda s AB/CO	P.Anderss en IT/CS	L.De Joage TS/EL	JJ.Gotttrae x IT/CS	JJ.Gotttrae x IT/CS	JJ.Gotttrae x L.Guerrero IT/CS	M.Rama TS/CSSE	V.Rodol AB/RF	J.Boathos d AB/BT	J.Casas- Ceballos AT/ACR	R.Denz AT/MER	F.Bordry AB/PO	D.Perrin TS/IRP	A.Marin TS/SU	M.Treballie TS/MA/SE	J.F.Jeget TS/CSSE	P.Dahlen AT/MEL				
Systemes	ZDC	Vacuum	Collimation	BI	Ctrl	Ctrl+Inf	Ctrl	Radio	Video	Telecom			RF	Kickers	Cryo	GPS	Convertisseurs	Surv	Survey	Alarmes	Ctrl	Classic	D			
Appellation		VY	TYCFL TYCHL TYCCR	BY	CYFRE CYTIM	CYNET	CYFIB	CYRR						MYI MYIGP	QYC	DYPG	DYPI	RYSA	RYSC	RYCA	PYMR	GYPOS				
Back LEP		YES	YES	YES	YES	YES				YES				YES	YES	YES	YES	YES	YES	NO				YES	YES	YES
Point 7	SR6				7					1	1	2		60							3		1	2		
	SR6 (LCR)					4	2	1											1	1		0.5				
	UJ76		27	2	3	1	1	1							1.5	0.5		4	1		1		2		1	
	UJ76 (Safe R)								1																	
	T276		46																							
	RR73				1										3	1	1	3	1							
	RR77				1										3	1	1	3	1							
	RE72		2			2	2	1	1						1	1					1		1			
	RE78		2			2	2	1	1						1	1					1		1			
	SD7								2		1											5				
SR7				7	2						1										2		1			
SR7 (LCR)					4	2	1											1			0.5					
Point 8	US85				1	3	2	1											0.5				1	1		
	US85 (Safe R)								1																	
	UX85																	0.5								
	UA83		20	2	5		2					2			6	8	2	11	2	5	1	2				
	UA87		20	4	7		2					2			15	6	9	2	11	2	5	1	2	5		
	UJ83																							0		
	UJ84																							0		
	UJ86																							0		
	UJ87																							0		
BF82		2			2	2	1	1						1	1					1		1				

Rack layout: ICL → Liens utiles: TS-EL P Orlandi → LHC → Implantations

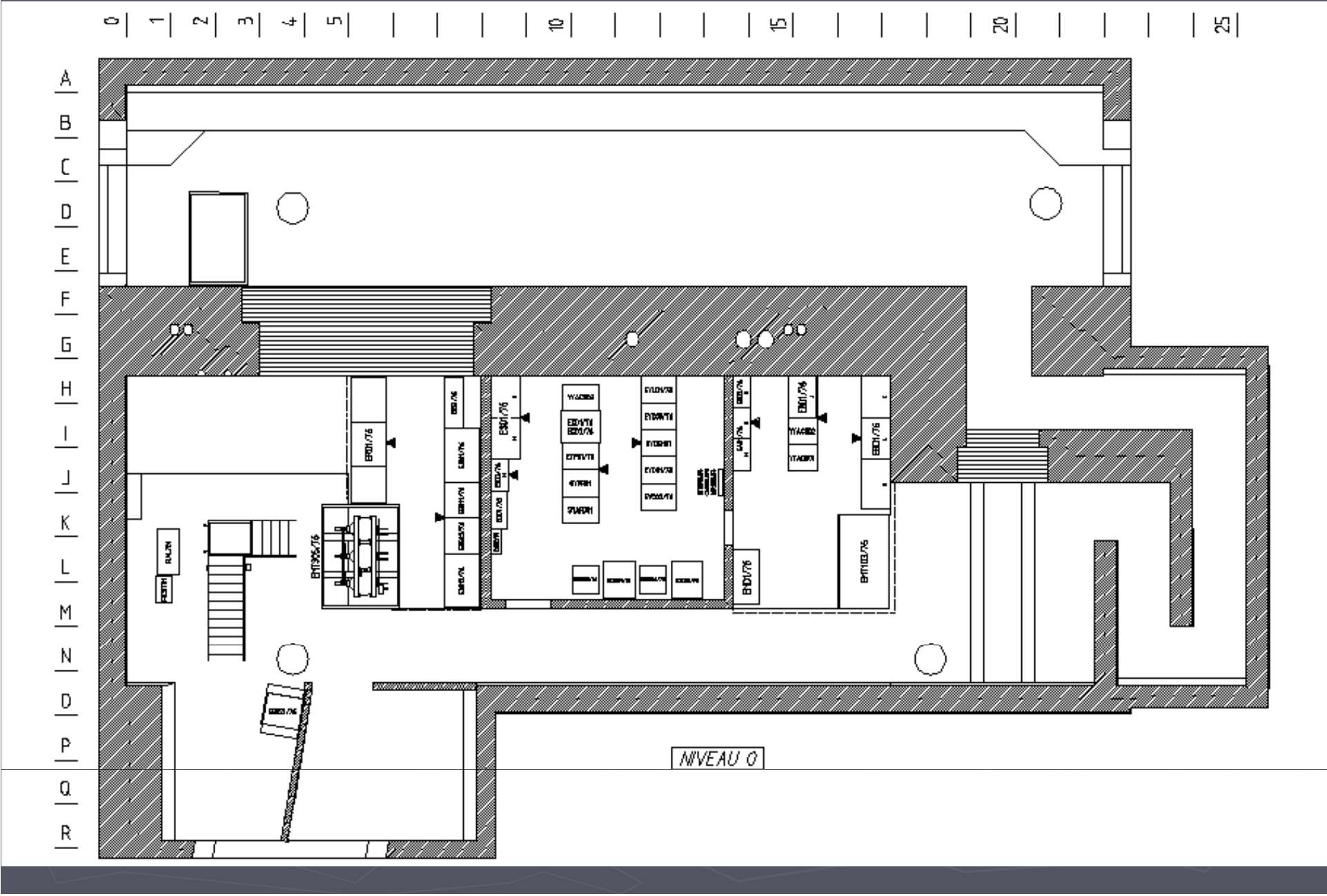

Rack layout: ICL → Liens utiles: TS-EL P Orlandi → LHC → Implantations

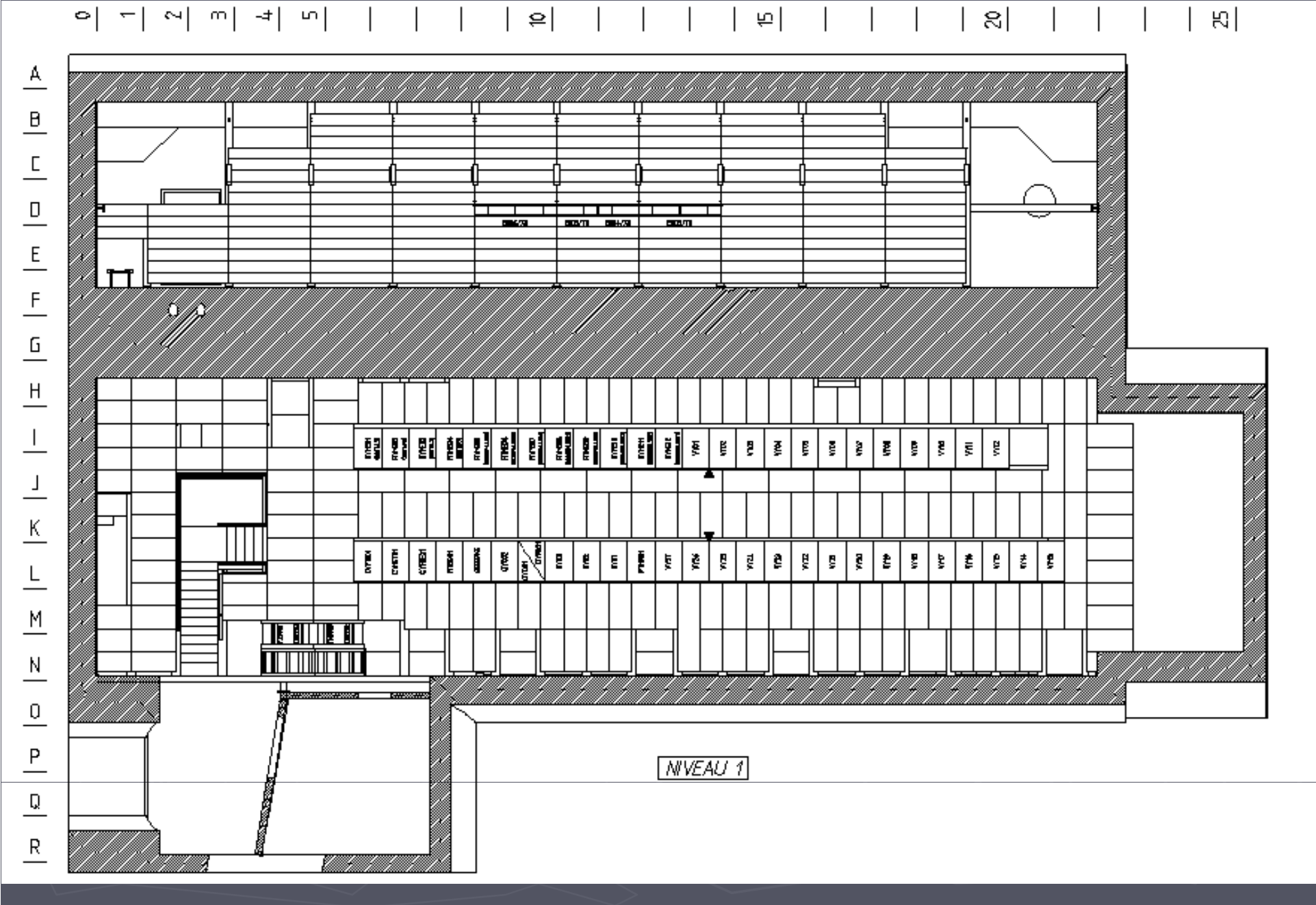

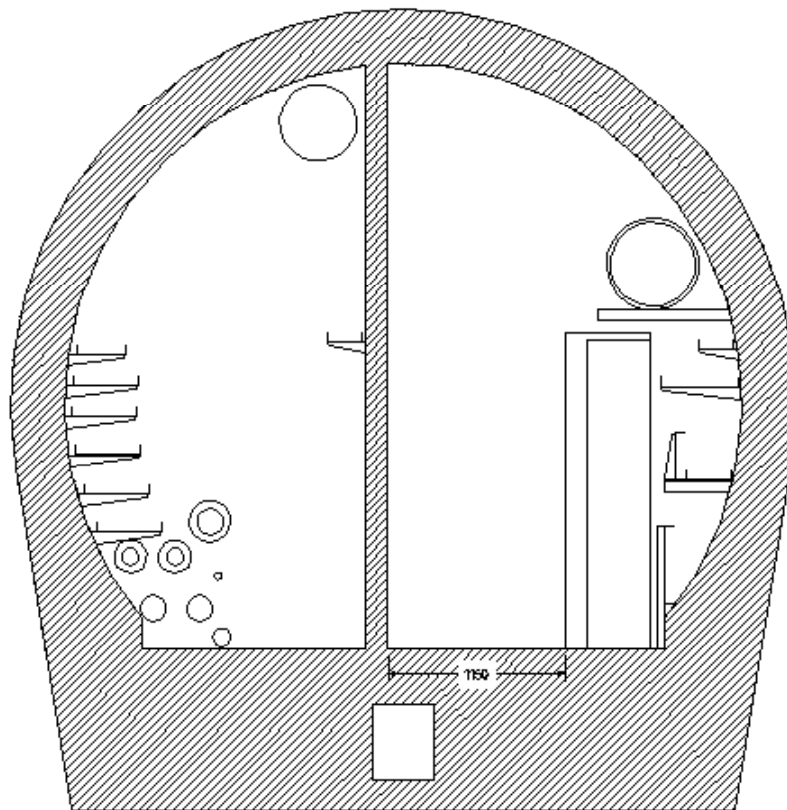
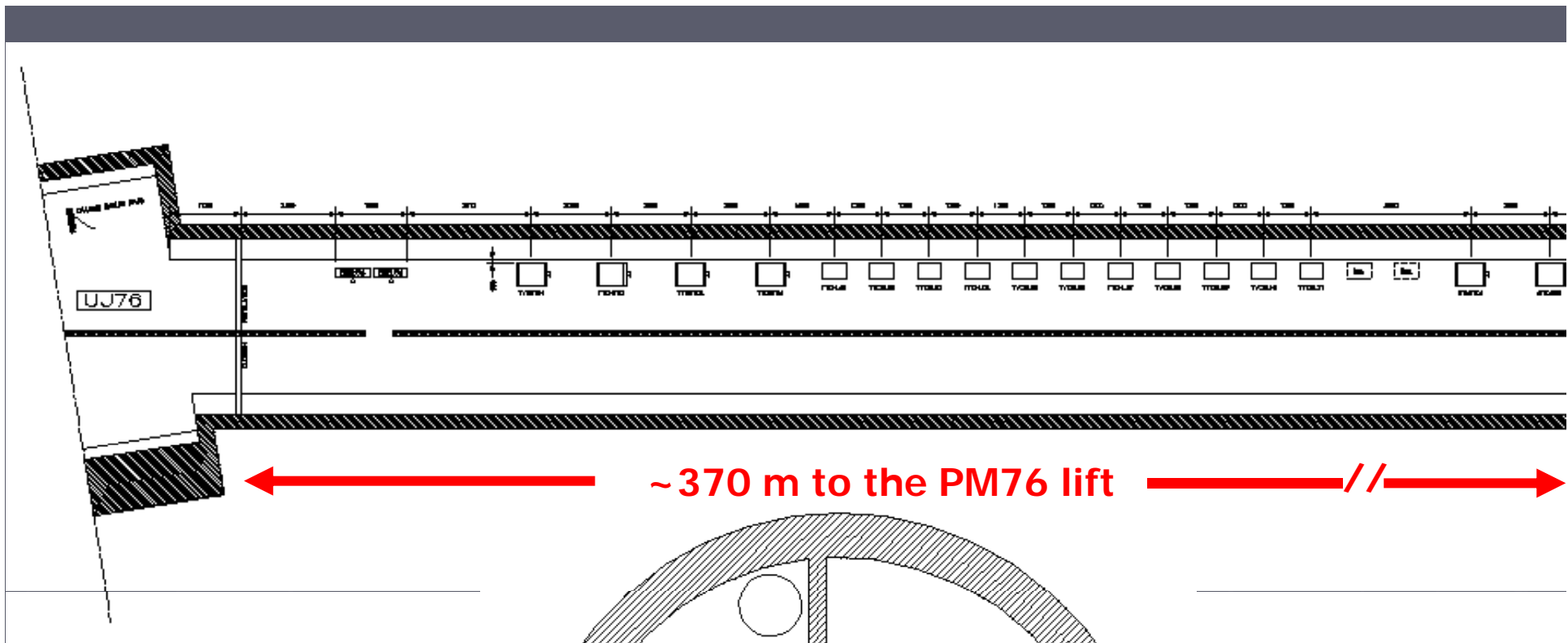

Study re-installation of equipment from UJ76 to TZ76

- ✓ Identify equipment sensitive to Single Event Offset
 - Set priorities according to criticality:
 - ✓ Potential damage to LHC component
 - ✓ Interlock and controlled beam abort
 - ✓ Loss of information with no impact on running time
- ✓ Remove separation wall and ventilation ducts in TZ76
- ✓ Install patch pannels in UJ76 + new cables to TZ76
- ✓ Move equipment during shut downs according to priorities
- ✓ Need to start integration work as soon as possible:
 - ✓ Systems and system dependency, number of racks
 - ✓ Number and type of cables to be laid, maximum length allowed
 - ✓ Powering (UPS, AC, DC) and power consumption, need for water cooling
 - ✓ Communication (Ethernet, WorldFip, Profibus)
 - ✓ Special conditions (EMS sensitivity, safe room, locked area, etc...)
 - ➔ questionnaire in preparation with Markus Brugger

Shielding survey duct in UJ76



