



---

# Physics coordinator report

2015 overview

2016 schedule

Safety & access

B. 508 & 275

Karl Johnston





# Beam time pie for 2015

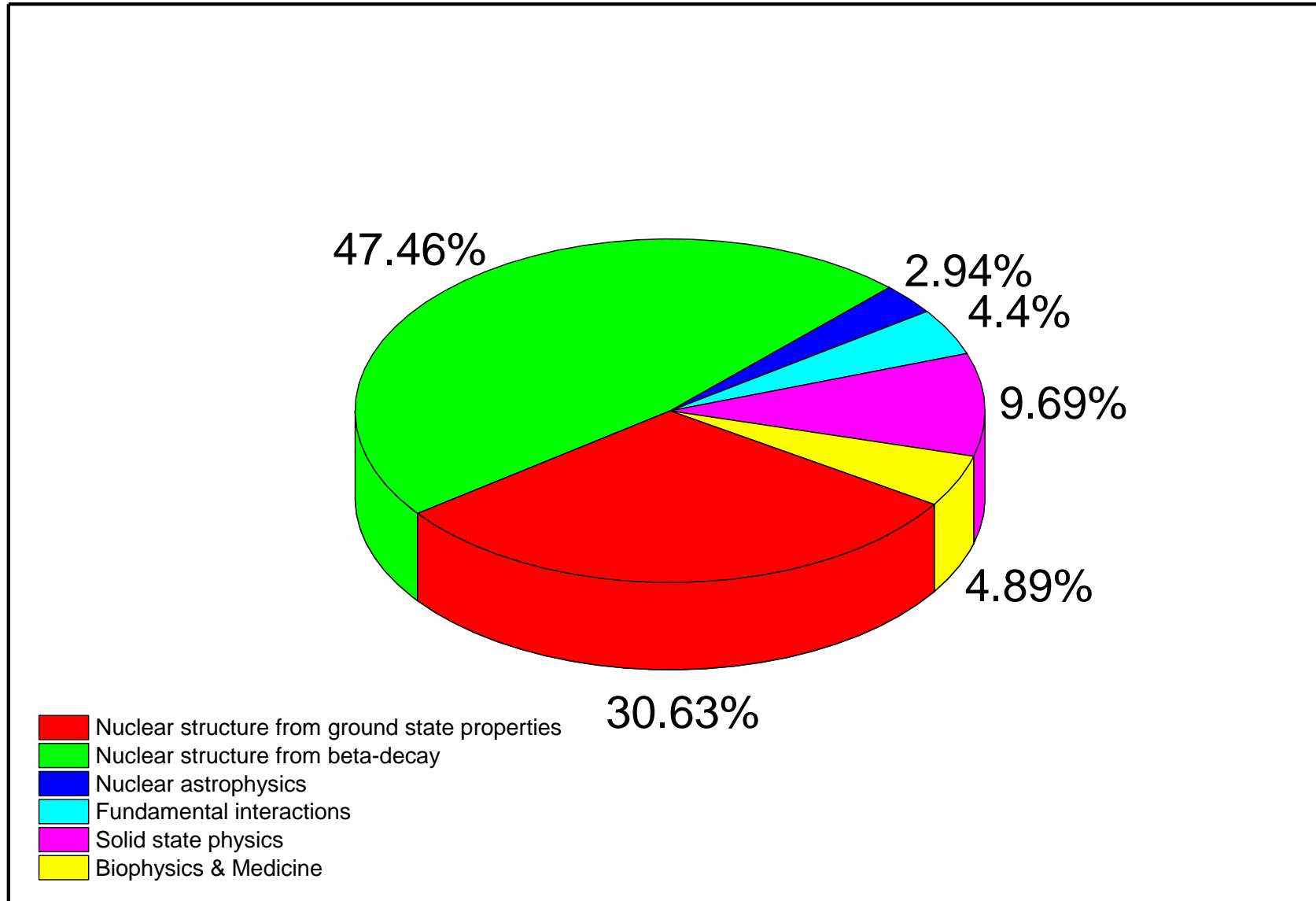

# Schedule for 2016

	Jan			Feb			Mar																	
	Controls maintenance			Start ion source and linac3			Start linac2			Close PS, SPS Close PSB			Protons to PSB			Beam to SPS			Beam to PS			Beam available to LHC		
Wk	1	2	3	4	5	6	7	8	9	10	11	12	13	14	15	16	17	18	19	20	21	22	23	24
Mo																								
Tu																								
We																								
Th																								
Fr																								
Sa																								
Su																								

Jan: Controls maintenance (Wk 1), Start ion source and linac3 (Wk 4), Start linac2 (Wk 7), Close PS, SPS, Close PSB (Wk 8), Protons to PSB (Wk 9), Beam to SPS (Wk 9), Beam to PS (Wk 10), Beam available to LHC (Wk 11).

Feb: Technical stop (Wk 5).

Mar: Recombination injections (Wk 9).

	Beam to AD Start NA setup ISOLDE, nTOF, EA setup			Start NA proton physics		Start AD physics Start physics East Area								
	Apr			May					June					
Wk	14	15	16	17	18	19	20	21	22	23	24	25	26	
Mo					May Day		Whit							
Tu														
We														
Th														
Fr														
Sa														
Su														

	Start AWAKE commissioning					Ions to PS					Ions to SPS			
	July				Aug				Sep					
Wk	27	28	29	30	31	32	33	34	35	36	37	38	39	
Mo														
Tu														
We														
Th														
Fr														
Sa														
Su														

	Oct			Nov			Dec						
Wk	40	41	42	43	44	45	46	47	48	49	50	51	52
Mo													
Tu													
We													
Th													
Fr													
Sa													
Su													

Start AWAKE physics

End proton physics

Ions to LHC

End of run (36.00)

LHC ion run  
Primary Pb to NA

36.00

36.00

36.00

36.00

36.00

36.00

36.00

36.00

36.00

36.00

36.00

36.00

36.00

36.00

36.00

36.00

36.00

36.00

36.00

36.00

36.00

36.00

36.00

36.00

36.00

36.00

36.00

36.00

36.00

36.00

36.00

36.00

36.00

36.00

36.00

36.00

36.00

36.00

36.00

36.00

36.00

36.00

36.00

36.00

36.00

36.00

36.00

36.00

36.00

36.00

36.00

36.00

36.00

36.00

36.00

36.00

36.00

36.00

36.00

36.00

36.00

36.00

36.00

36.00

36.00

36.00

36.00

36.00

36.00

36.00

36.00

36.00

36.00

36.00

36.00

36.00

36.00

36.00

36.00

36.00

36.00

36.00

36.00

36.00

36.00

36.00

36.00

36.00

36.00

36.00

36.00

36.00

36.00

36.00

36.00

36.00

36.00

36.00

36.00

36.00

36.00

36.00

36.00

36.00

36.00

36.00

36.00

36.00

36.00

36.00

36.00

36.00

36.00

36.00

36.00

36.00

36.00

36.00

36.00

36.00

36.00

36.00

36.00

36.00

36.00

36.00

36.00

36.00

36.00

36.00

36.00

36.00

36.00

36.00

36.00

36.00

36.00

36.00

36.00

36.00

36.00

36.00

36.00

36.00

36.00

36.00

36.00

36.00

36.00

36.00

36.00

36.00

36.00

36.00

36.00

36.00

36.00

36.00

36.00

36.00

36.00

36.00

36.00

36.00

36.00

36.00

36.00

36.00

36.00

36.00

36.00

36.00

36.00

36.00

36.00

36.00

36.00

36.00

36.00

36.00

36.00

36.00

36.00

36.00

36.00

36.00

36.00

36.00

36.00

36.00

36.00

36.00

36.00

36.00

36.00

36.00

36.00

36.00

36.00

36.00

36.00

36.00

36.00

36.00

36.00

36.00

36.00

36.00

36.00

36.00

36.00

36.00

36.00

36.00

36.00

36.00

36.00

36.00

36.00

36.00

36.00

36.00

36.00

36.00

36.00

36.00

36.00

36.00

36.00

36.00

36.00

36.00

36.00

36.00

36.00

36.00

36.00

36.00

36.00

36.00

36.00

36.00

36.00

36.00

36.00

36.00

36.00

36.00

36.00

36.00

36.00

36.00

36.00

36.00

36.00

36.00

36.00

36.00

36.00

36.00

36.00

36.00

36.00

36.00

36.00

36.00

36.00

36.00

36.00

36.00

36.00

36.00

36.00

36.00

36.00

36.00

36.00

36.00

36.00

36.00

36.00

36.00

36.00

36.00

36.00

36.00

36.00

36.00

36.00

36.00

36.00

36.00

36.00

36.00

36.00

36.00

36.00

36.00

36.00

36.00

36.00

36.00

36.00

36.00

36.00

36.00

36.00

36.00

36.00

36.00

36.00

36.00

36.00

36.00

36.00

36.00

36.00

36.00

36.00

36.00

36.00

36.00

36.00

36.00

36.00

36.00

36.00

36.00

36.00

36.00

36.00

36.00

36.00

36.00

36.00

36.00

36.00

36.00

36.00

36.00

36.00

36.00

36.00

36.00

36.00

36.00

36.00

36.00

36.00

36.00

36.00

36.00

36.00

36.00

36.00

36.00

36.00

36.00

36.00

36.00

36.00

36.00

36.00

36.00

36.00

36.00

36.00

36.00

36.00

36.00

36.00

36.00

36.00

36.00

36.00

36.00

36.00

36.00

36.00

36.00

36.00

36.00

36.00

36.00

36.00

36.00

36.00

36.00

36.00

36.00

36.00

36.00

36.00

36.00

36.00

36.00

36.00

36.00

36.00

36.00

36.00

36.00

36.00

36.00

36.00

36.00

36.00

36.00

36.00

36.00

36.00

36.00

36.00

36.00

36.00

36.00

36.00

36.00

36.00

36.00

36.00

36.00

36.00

36.00

36.00

36.00

36.00

36.00

36.00

36.00

36.00

36.00

36.00

36.00

36.00

36.00

36.00

36.00

36.00

36.00

36.00

36.00

36.00

36.00

36.00

36.00

36.00

36.00

36.00

36.00

36.00

36.00

36.00

36.00

36.00

36.00

36.00

36.00

36.00

36.00

36.00

36.00

36.00

36.00

36.00

36.00

36.00

36.00

36.00

36.00

36.00

36.00

36.00

36.00

36.00

36.00

36.00

36.00

36.00

36.00

36.00

36.00

36.00

36.00

36.00

36.00

36.00

36.00

36.00

36.00

36.00

36.00

36.00

36.00

36.00

36.00

36.00

36.00

36.00

36.00

36.00

36.00

36.00

36.00

36.00

36.00

36.00

36.00

36.00

36.00

36.00

36.00

36.00

36.00

36.00

36.00

36.00

36.00

36.00

36.00

36.00

36.00

36.00

36.00

36.00

36.00

36.00

36.00

36.00

36.00

36.00

36.00

36.00

36.00

36.00

36.00

36.00

36.00

36.00

36.00

36.00

36.00

36.00

36.00

36.00

36.00

36.00

36.00

36.00

36.00

36.00

36.00

36.00

36.00

36.00

36.00

36.00

36.00

36.00

36.00

36.00

36.00

36.00

36.00

36.00

36.00

36.00

36.00

36.00

36.00

36.00

36.00

36.00

36.00

36.00

36.00

36.00

36.00

36.00

36.00

36.00

36.00

36.00

36.00

36.00

36.00

36.00

36.00

36.00

36.00

36.00

36.00

36.00

36.00

36.00

36.00

36.00

36.00

36.00

36.00

36.00

36.00

36.00

36.00

36.00

36.00

36.00

36.00

36.00

36.00

36.00

36.00

36.00

36.00

36.00

36.00

36.00

36.00

36.00

36.00

36.00

36.00

36.00

36.00

36.00

36.00

36.00

36.00

36.00

36.00

36.00

36.00

36.00

36.00

36.00

36.00

36.00

36.00

36.00

36.00

36.00

36.00

36.00

36.00

36.00

36.00

36.00

36.00

36.00

36.00

36.00

36.00

36.00

36.00

36.00

36.00

36.00

36.00

36.00

36.00

36.00

36.00

36.00

36.00

36.00

36.00

36.00

36.00

36.00

36.00

36.00

36.00

36.00

36.00

36.00

36.00

36.00

36.00

36.00

36.00

36.00

36.00

36.00

36.00

36.00

36.00

36.00

36.00

36.00

36.00

36.00

36.00

36.00

36.00

36.00

36.00

36.00

36.00

36.00

36.00

36.00

36.00

36.00

36.00

36.00

36.00

36.00

36.00

36.00

36.00

36.00

36.00

36.00

36.00

36.00

36.00

36.00

36.00

36.00

36.00

36.00

36.00

36.00

36.00

36.00

36.00

36.00

36.00

36.00

36.00

36.00

36.00

36.00

36.00

36.00

36.00

36.00

36.00

36.00

36.00

36.00

36.00

36.00

36.00

36.00

36.00

36.00

36.00

36.00

36.00

36.00

36.00

36.00

36.00

36.00

36.00

36.00

36.00

36.00

36.00

36.00

36.00

36.00

36.00

36.00

36.00

36.00

36.00

36.00

36.00

36.00

36.00

36.00

36.00

36.00

36.00

36.00

36.00

36.00

36.00

36.00

36.00

36.00

36.00

36.00

36.00

36.00

36.00

36.00

36.00

36.00

36.00

36.00

36.00

36.00

36.00

36.00

36.00

36.00

36.00

36.00

36.00

36.00

36.00

36.00

36.00

36.00

36.00

36.00

36.00

36.00

36.00

36.00

36.00

36.00

36.00

36.00

36.00

36.00

36.00

36.00

36.00

36.00

36.00

36.00

36.00

36.00

36.00

36.00

36.00

36.00

36.00

36.00

36.00

36.00

36.00

36.00

36.00

36.00

36.00

36.00

36.00

36.00

36.00

36.00

36.00

36.00

36.00

36.00

36.00

36.00

36.00

36.00

36.00

36.00

36.00

36.00

36.00

36.00

36.00

36.00

36.00

36.00

36.00

36.00

36.00

36.00

36.00

36.00

36.00

36.00

36.00

36.00

36.00

36.00

36.00

36.00

36.00

36.00

36.00

36.00

36.00

36.00

36.00

36.00

36.00

36.00

36.00

36.00

36.00

36.00

36.00

36.00

36.00

36.00

36.00

36.00

36.00

36.00

36.00

36.00

36.00

36.00

36.00

36.00

36.00

36.00

36.00

36.00

36.00

<

Based on the length of the YETS 2015-16 & EYETS 16-17 [ATS-PM-MS-0001]:

- Beam to LHC: March 14<sup>th</sup>.
- Physics at Isolde & nTOF: April 11<sup>th</sup>.
- p-physics at North Area: April 18<sup>th</sup>. (Awake October 3<sup>rd</sup>)
- East Area & AD physics: April 25<sup>th</sup>.
- Proton -> Pb November 14<sup>th</sup>.
- End of run December 12<sup>th</sup>.

INTC physics: 31 weeks. ( $\sim 1.8 \times 10^{19}$  pot for nTOF)

NA FT physics: 30 weeks (p) + 4 weeks (Pb)

AD & EA: 29 weeks.

Weekly MDs, 3 Technical stops, UA9 runs indicative (tbd by SPSC). SPS scrubbing likely needed, but no dedicated scrubbing run.

# HIE-ISOLDE Experiments Workshop 1.2.2016

## First conclusions

- 24 approved proposals ask for beam time in 2016
- Full energy range of accelerator up to 6.0 MeV/u
- Mass range from  $^{18}\text{N}$  up to  $^{228}\text{Ra}$
- MINIBALL configuration for Coulomb excitation and transfer reactions will be installed for 2016 campaign
- Combination with SPEDE is available after successful stable beam commissioning in summer 2016
- High number of experiments should be provided to user community
- Everyone is eagerly awaiting the HIE-ISOLDE beams

# Outline of ISOLDE Schedule

	April				May				June				
Wk	14	15	16	17	18	19	20	21	22	23	24	25	26
Mo	28	4	11	18	25	2	9	16	23	30	6	13	20
Tu		Proton set up to ISOLDE											
We					Low energy running period								
Th													
Fr													
Sa					Commissioning of CM1 and CM2								
Su													
	July				August					September			
Wk	27	28	29	30	31	32	33	34	35	36	37	38	39
Mo	27	4	11	18	25	1	8	15	22	29	5	12	19
Tu													
We										HIE ISOLDE running period			
Th													
Fr													
Sa	Commissioning of CM1 and CM2												
Su													
	October				November					December			
Wk	40	41	42	43	44	45	46	47	48	49	50	51	52
Mo	26	3	10	17	24	31	7	14	21	28	5	12	19
Tu													
We													
Th													
Fr													
Sa													
Su													

- 20 weeks for dedicated LE physics, including negative ion run (~ 3 weeks in total)
- LE beam requests are out and due by end of week 5.
- Initial idea of demands and resources by end of next week.
- 12 weeks for HIE ISOLDE
- HIE beam requests end of next week.
- Setting up time needs to be taken into account.

# Safety and Courses

For all setups: both fixed and travelling:  
**safety clearance required before running**

- Courses in 2016 for all: (as for 2015)
  - Online: general and ISOLDE RP, electrical awareness
  - 2-h ISOLDE RP
  - 1.5-h ISOLDE electrical safety.
  - Hands-on courses take place on **Tuesday afternoons**. More sessions may be possible later in the year if necessary, e.g. during HIE-ISOLDE period.
  - Some training under review e.g. electrical course.
  - Need for refreshing courses etc (probably going to be electronic for the first renewal at least).
  - **Courses need to be validated in EDH and are now linked to access**

- Ongoing discussion: safety helmets and shoes?
- Adopt better practice for controlling on leaving the hall...





# Access to ISOLDE

- ISOWORK has been suppressed. Now only **ISOHALL**.
- Access to HIE-ISOLDE recommended for only local physicists when moving equipment or dewars etc
- Access for users is still at the Jura side.
  - **Tourniquet at 508 controls access to the hall in addition to access door in Building 508. Both operated via dosemeter.**
  - Door to the hall is no longer controlled by the CERN card.

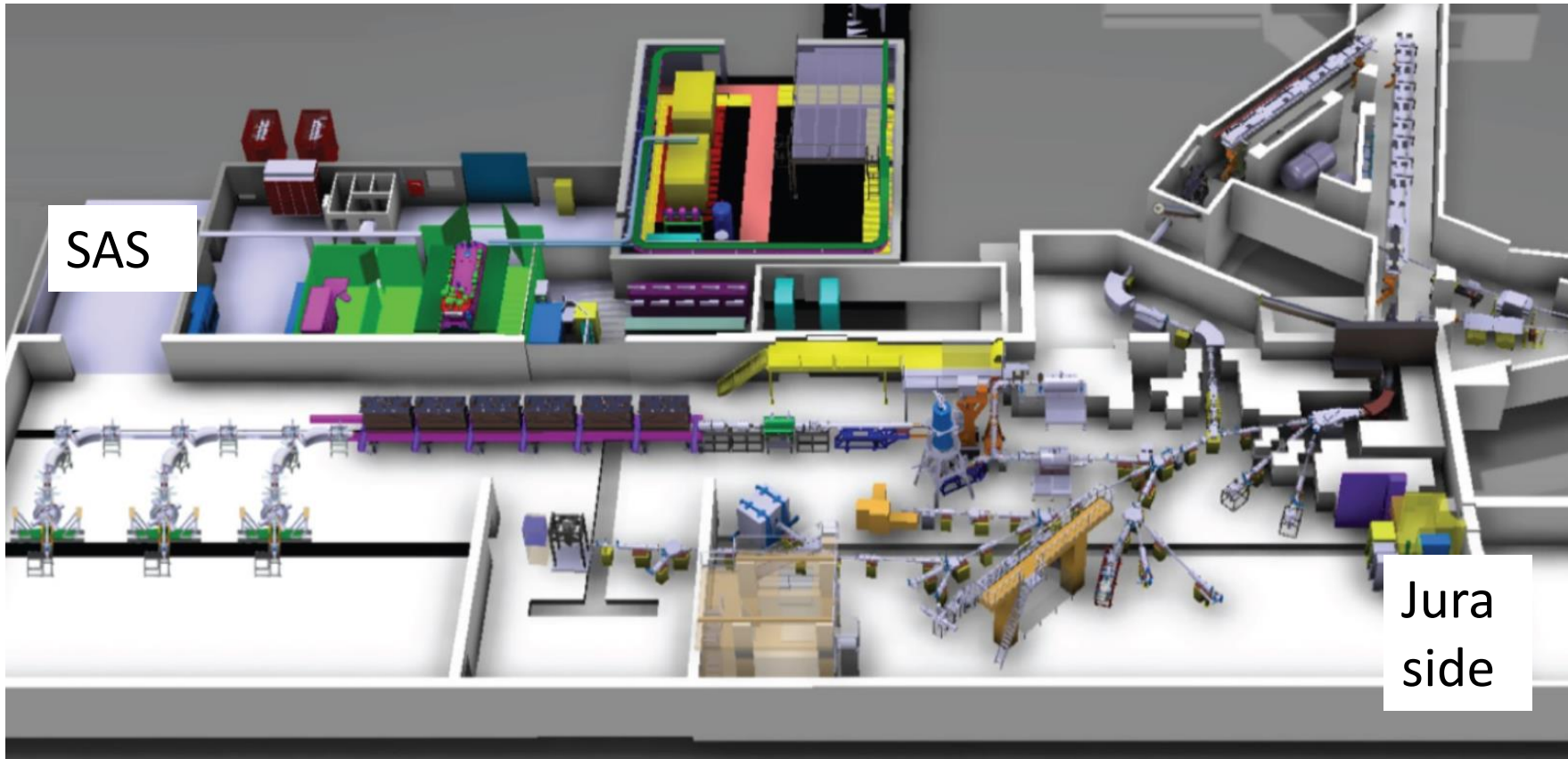





Must  
stay  
closed!

# Visits to ISOLDE

- ISOLDE as Controlled RP area:
- Only professional visits allowed
  - Our suggestion – university students, uni and school teachers, VIPs
- Non-professional visits access on case-by-case basis
  - High-school students above 16y
  - Private-public visits: friends, family
- No visits during the opening of beamlines or making high-intensity collections
- All visits
  - announced to myself, Richard, or Kara
  - Included in weekly schedule
  - discussed and approved or not in Tuesday Isolde technical meeting
  - Dedicated calendar available [https://espace.cern.ch/isolde-visits-info/\\_layouts/15/start.aspx#/Lists/Calendar/calendar.aspx](https://espace.cern.ch/isolde-visits-info/_layouts/15/start.aspx#/Lists/Calendar/calendar.aspx)
- RP make a survey prior to each visit.
- Wear helmets and closed shoes.

# ISOLDE Visits: Nationality of visitor

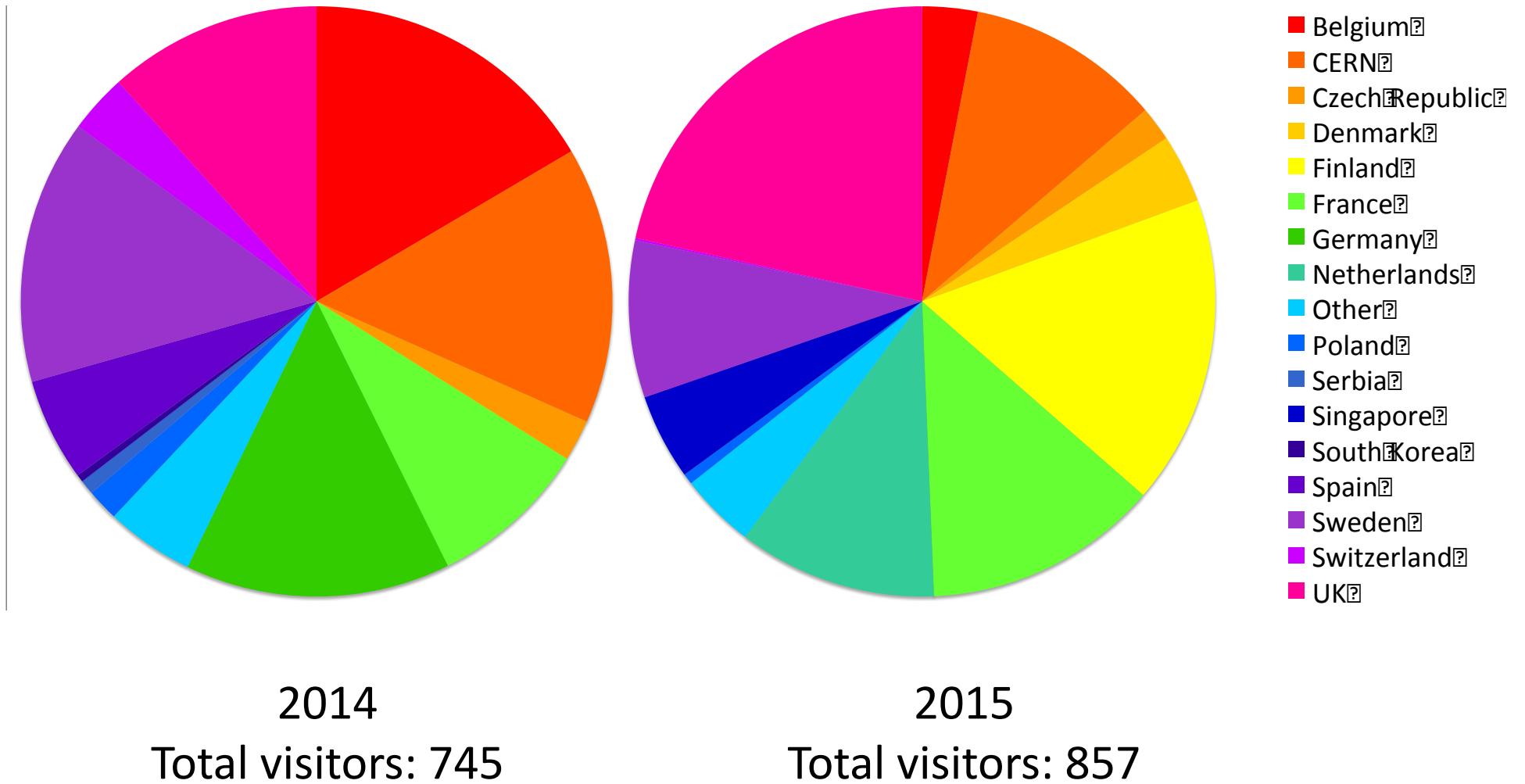

*Thanks to Kara lynch*



# Building 508



- Rack for p-request, beamgates and access in place.
- Access keys modules will be installed in it this week
- p-request and beamgates hardware is being prepared.
- Ethernet re-connection of PCs is ongoing.

## ISOLDE Visitors room



# Building 508: Kitchen



Almost there....needs final plumbing



Tooling area available for users: requires clearance





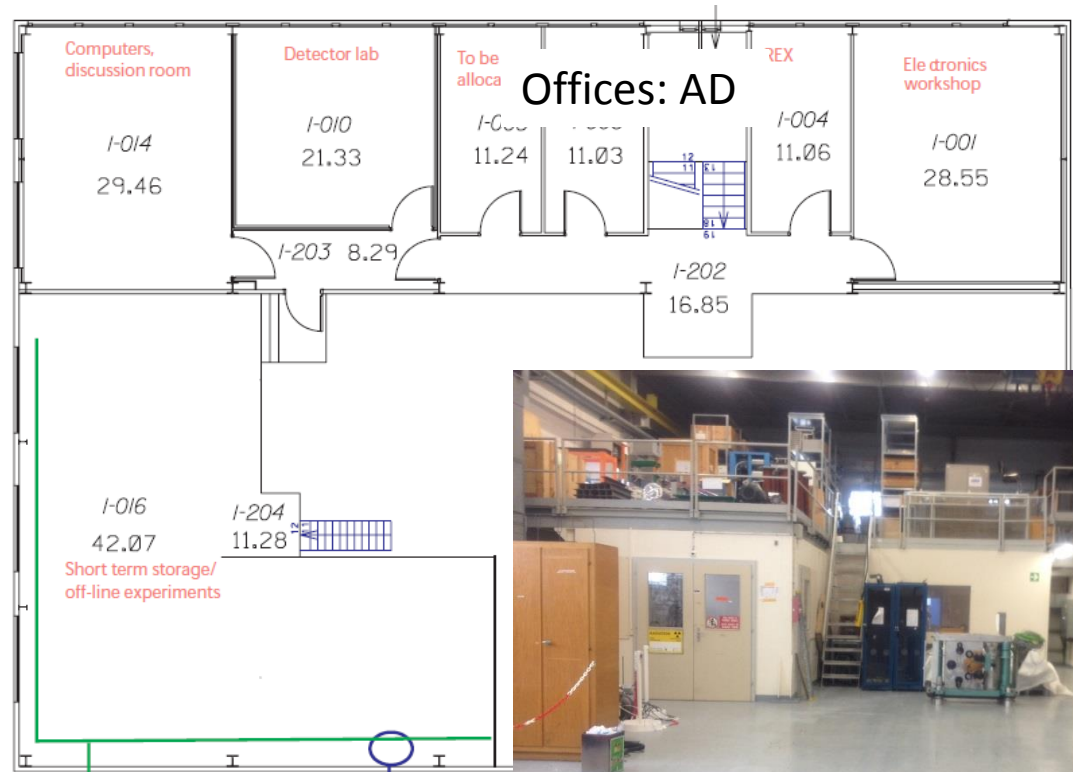
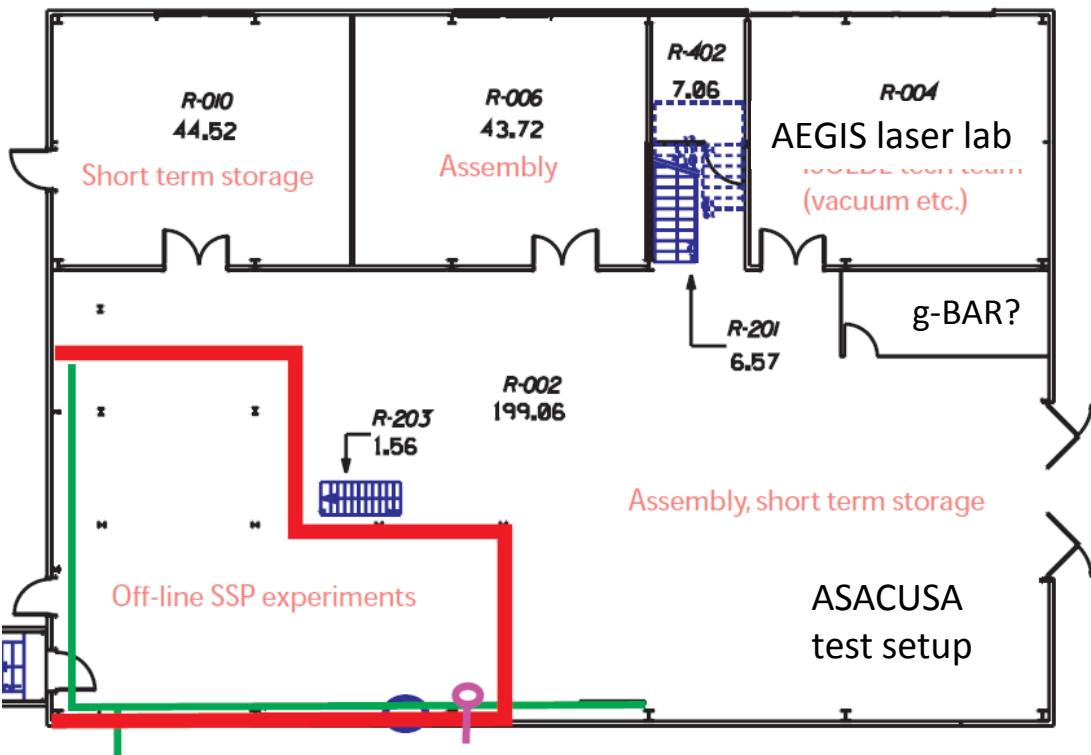

## Building 275

Offline lab almost ready (floor needs to be re-done).  
 De-classification is underway.  
 Requests for use are ready to be accepted.  
 Currently ISOLTRAP and beta-NMR will use some space and time.

