

Access and control of user zones

Bastien Rae



ACCESS MODES OF A SECONDARY BEAM AREA

- **'CLOSED'** area: no access permitted, beam potentially present;
- **'LOCKED'** area: no access possible (except for fire brigade and radiation protection)
- **'ACCESS WITH KEY'**: entering is possible by taking a key, one key per person entering (short KEY ACCESS)
- **'FREE'** access: access without restrictions
- **'PATROL'**: It has a very limited duration and serves changing a zone status from "FREE" to any other mode.

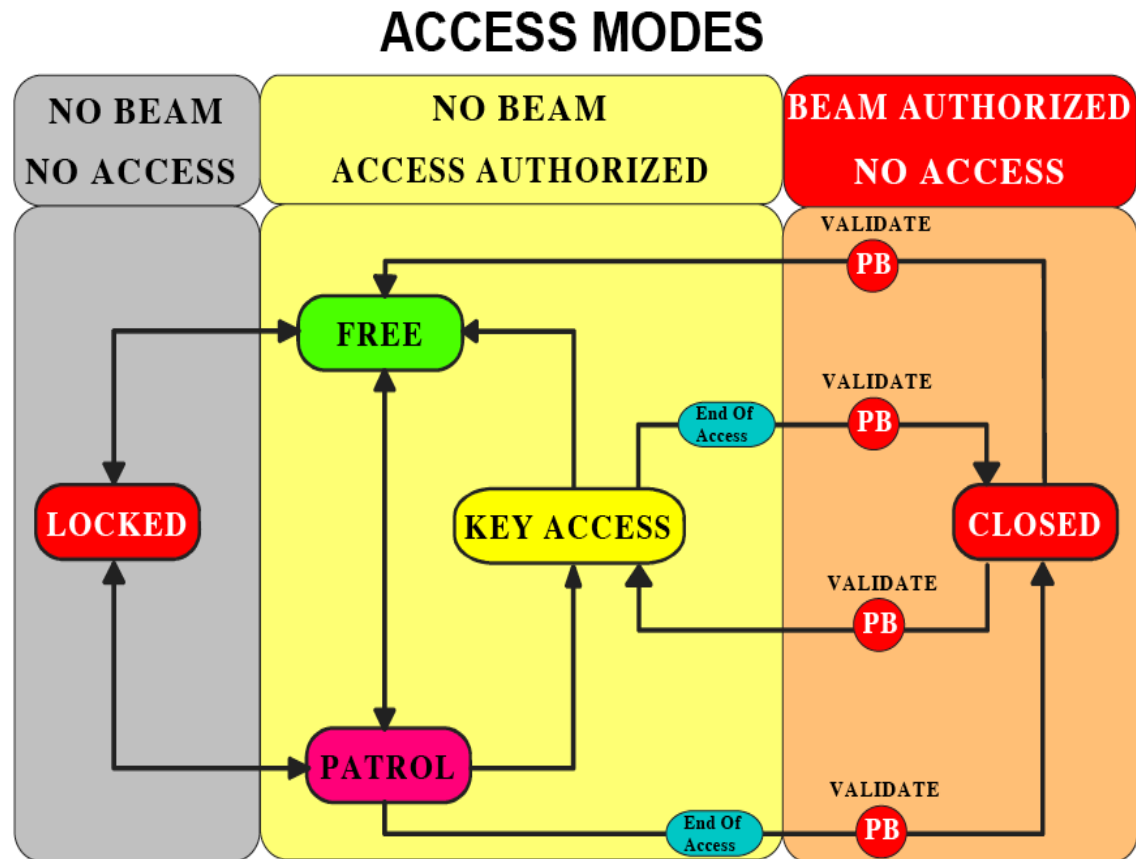

ACCESS MODES OF A SECONDARY BEAM AREA

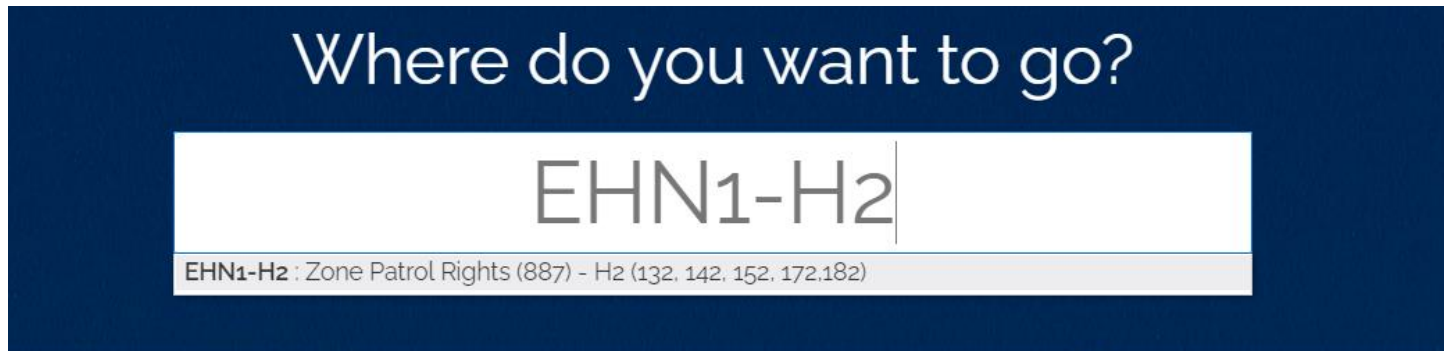

Information about Patrol Right

- Patrol Right are not necessary to enter in the user zones or the EHN1. The personal dosimeter is enough.
- 2 peoples max per test beam group (3 if justified) can ask for patrol rights (after the training)
- Contact me (bastien.rae@cern.ch) for organizing a training prior your test (usually on Wednesday)
- During LS2 most of the rights have been cancel. Even if you had the rights before You need to renew the training.
- To ask for patrol right please follow this [link](#) below and right in the first text box (EHN1-xx) your corresponding beam line.

REMARK

EMERGENCY BUTTON

On each door there is an emergency button above the handle. It's also give you information if you have enter or not.

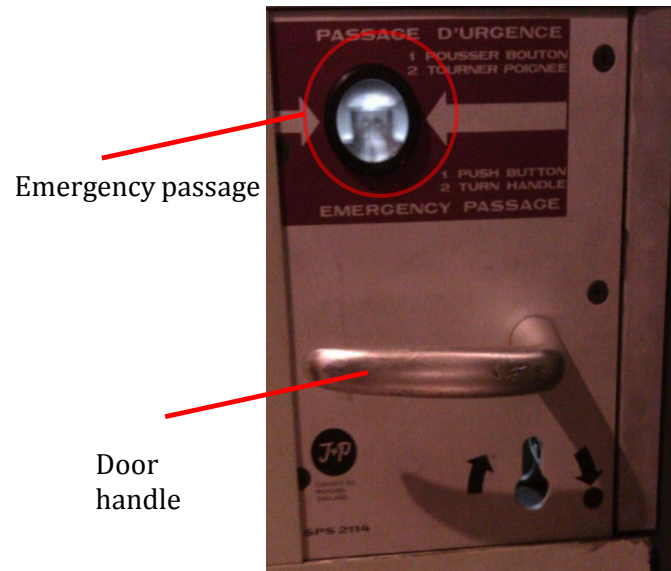

Light is green,
you can enter



Light is red,
you can't have an access

YOU MUST USE THE EMERGENCY BUTTON ONLY IN CASE OF EMERGENCY !

CESAR

Access control

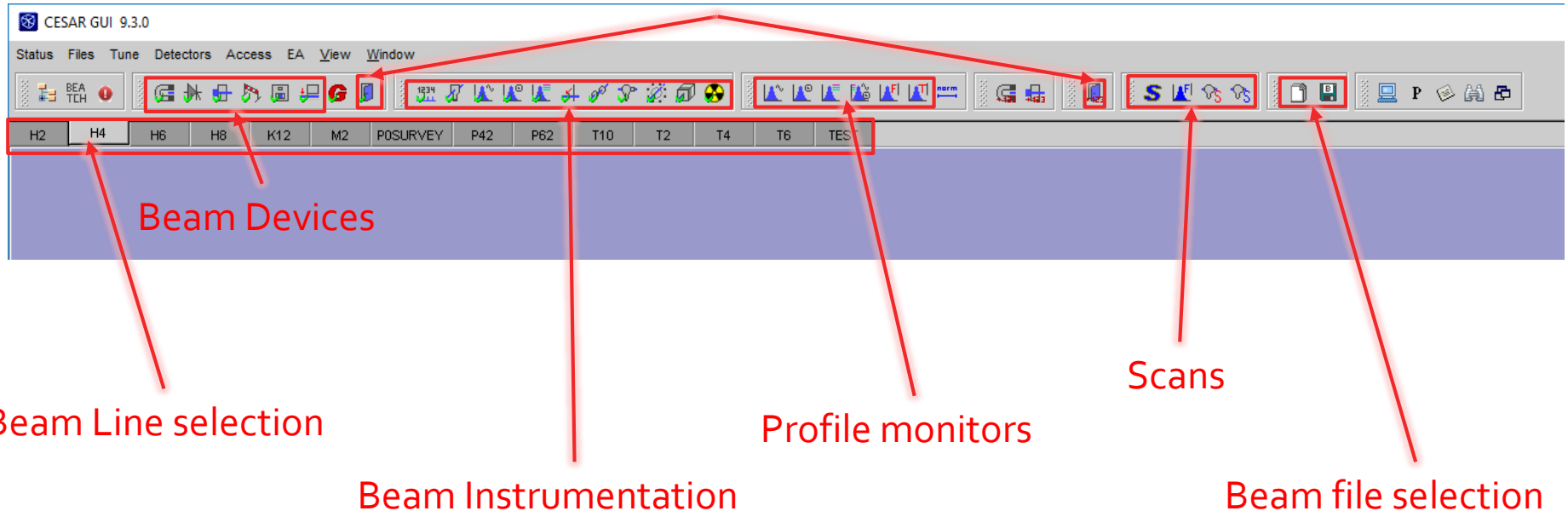

CESAR is the software that allow you ton control the beam, and ask for Beam on or off:

- When opening CESAR in the control PC you just click on "logging by location"
- When you request for Beam on you should enter your NICE credential.
- Please contact me (bastien.rae@cern.ch) to organize a small training (~45min).

CONTACT

If you have any question or problem, please do not hesitate to contact :

During working hours (8:30 to 17:30) :

- The Physicist responsible for you line
- You can also send an e-mail to sba-physicists@cern.ch

At Any time, you can call the CCC :

- For the PS call : *76677*
- For the SPS call : *77500* or *70475*





Questions ?