



HL-LHC INTEGRATION MEETING

New cryogenic cabinet configuration: DFHX and DFHM area

M. Curylo, J. Fleiter

DFHX AREA (UR55): current situation

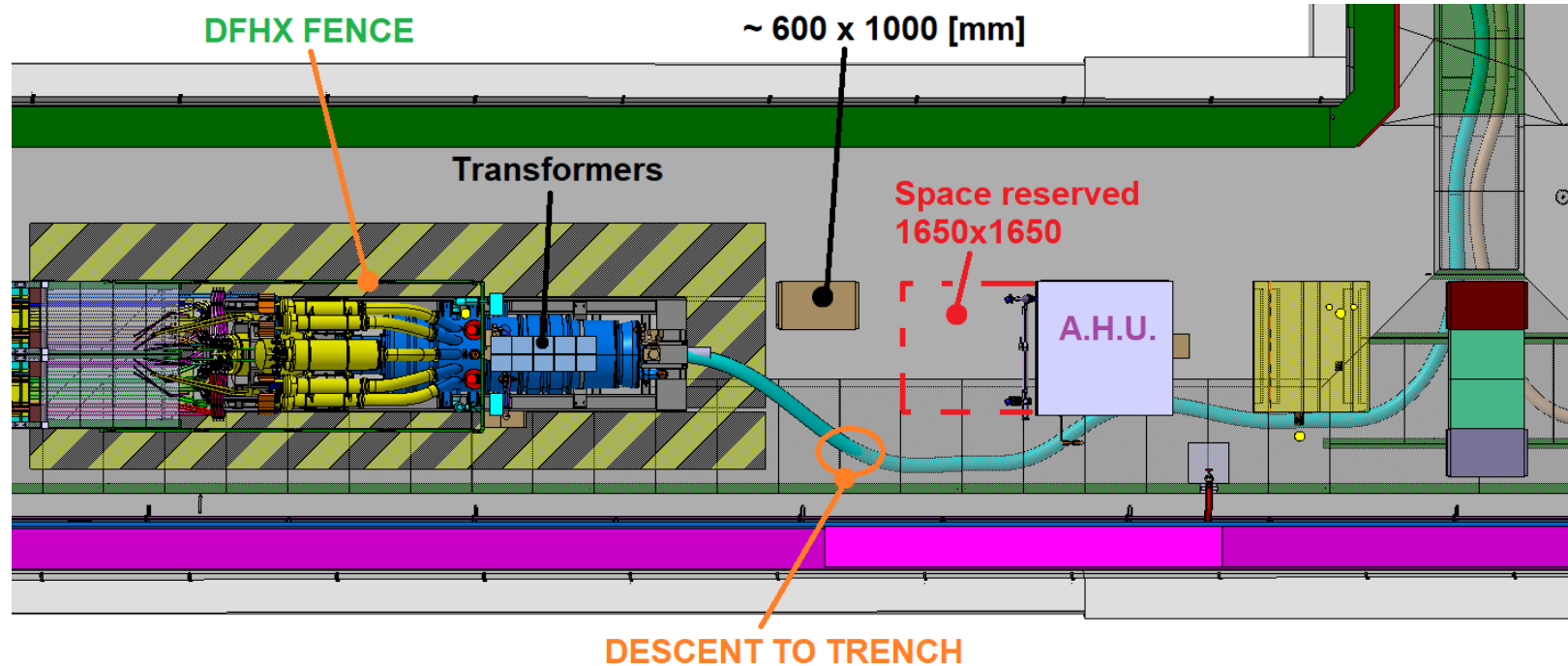

DFHX AREA (UR55): to discuss

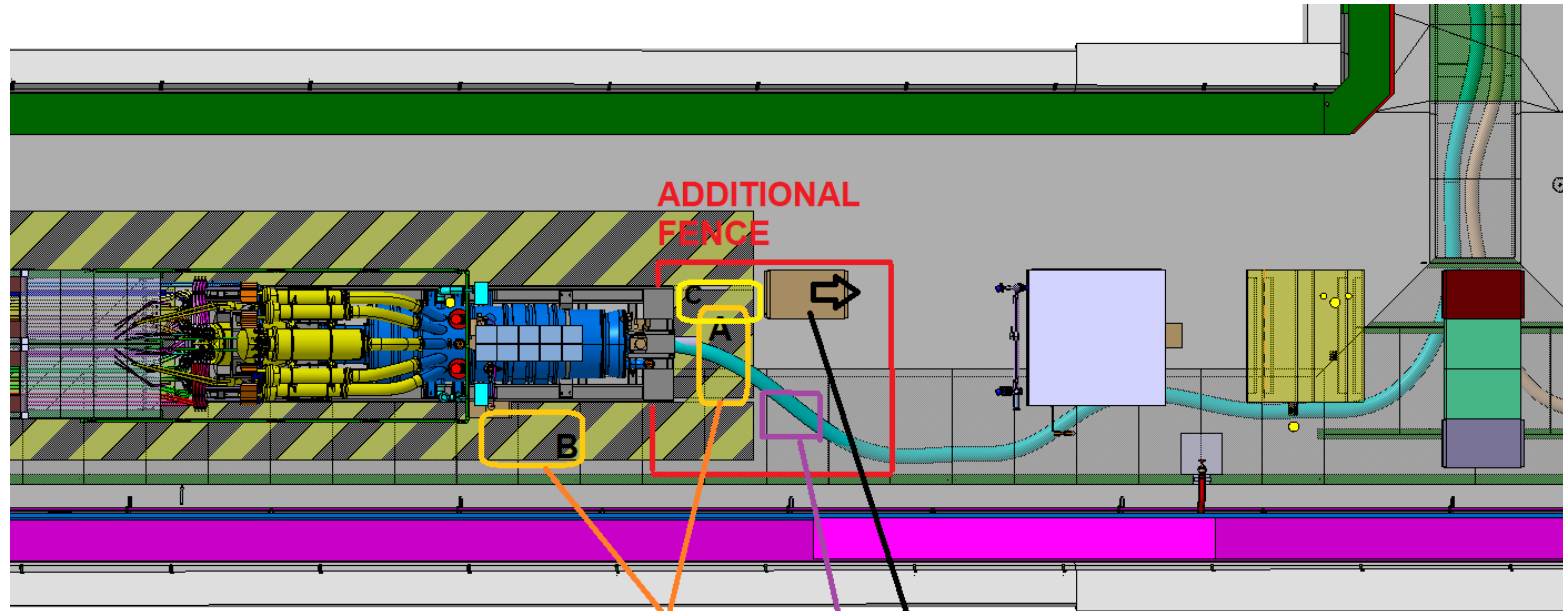

place for mobile pumping stations:
option A, option B
or option C

removing from this zone
or
moving into fence corner
with rotation of 90°

DSH support frame
mounted to the trench floor

Mobile pumping station

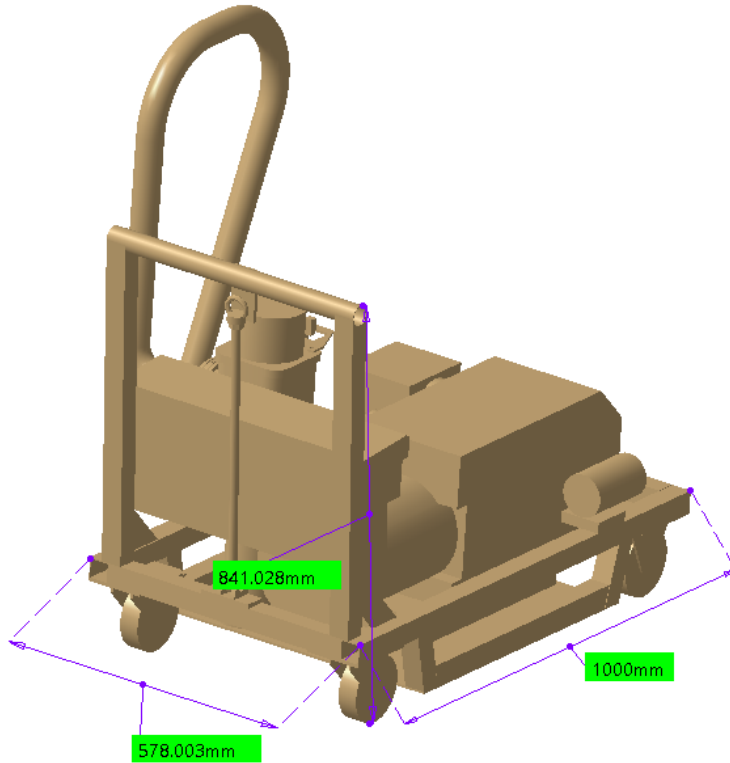

Source:

CDD:
LHCVPGMA0007

DFHM AREA (UR55): current situation

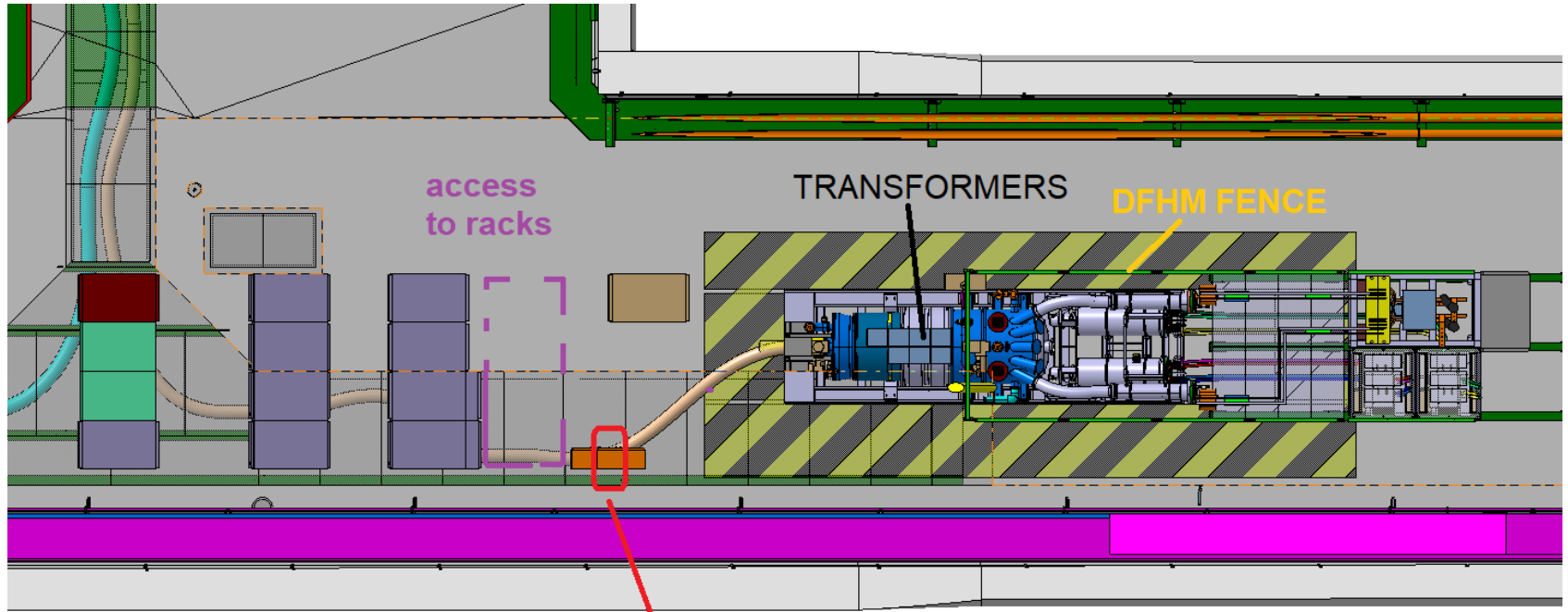

**DESCENT TO
TRENCH**

DFHX AREA (UR55): to discuss

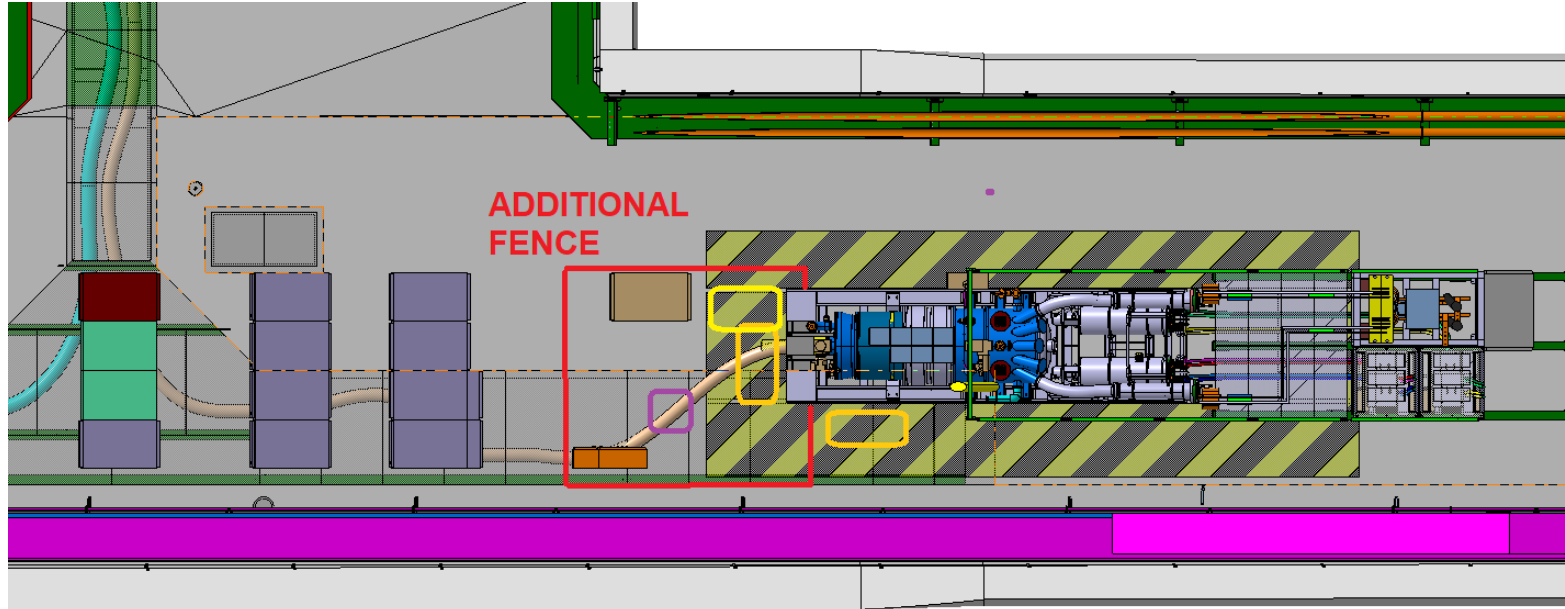

Creating a new fenced zone near the DSH descent to trench + remarks due to position of rack close to DFH

- The DFH has a 'no-stay' boundary due to electrical and cryogenic hazards. Repositioning a control rack at the very limit of the zone doesn't move in the direction of improving safety.
- Protection against mechanical damage of the DSH system
- Two trench covers can be permanently dismantled during operation: access to this zone protects new fence.
- No rack in DFH zone gives flexibilities of handling DSH and shaping of supporting structures

Backup slides

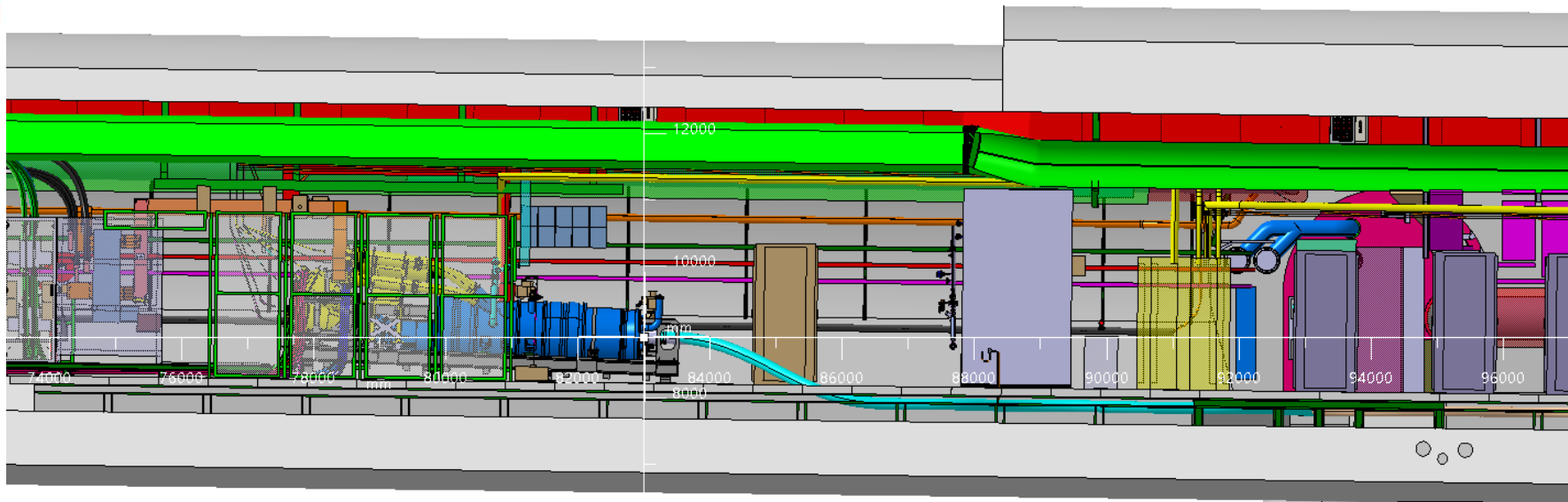

DFHX area: side view

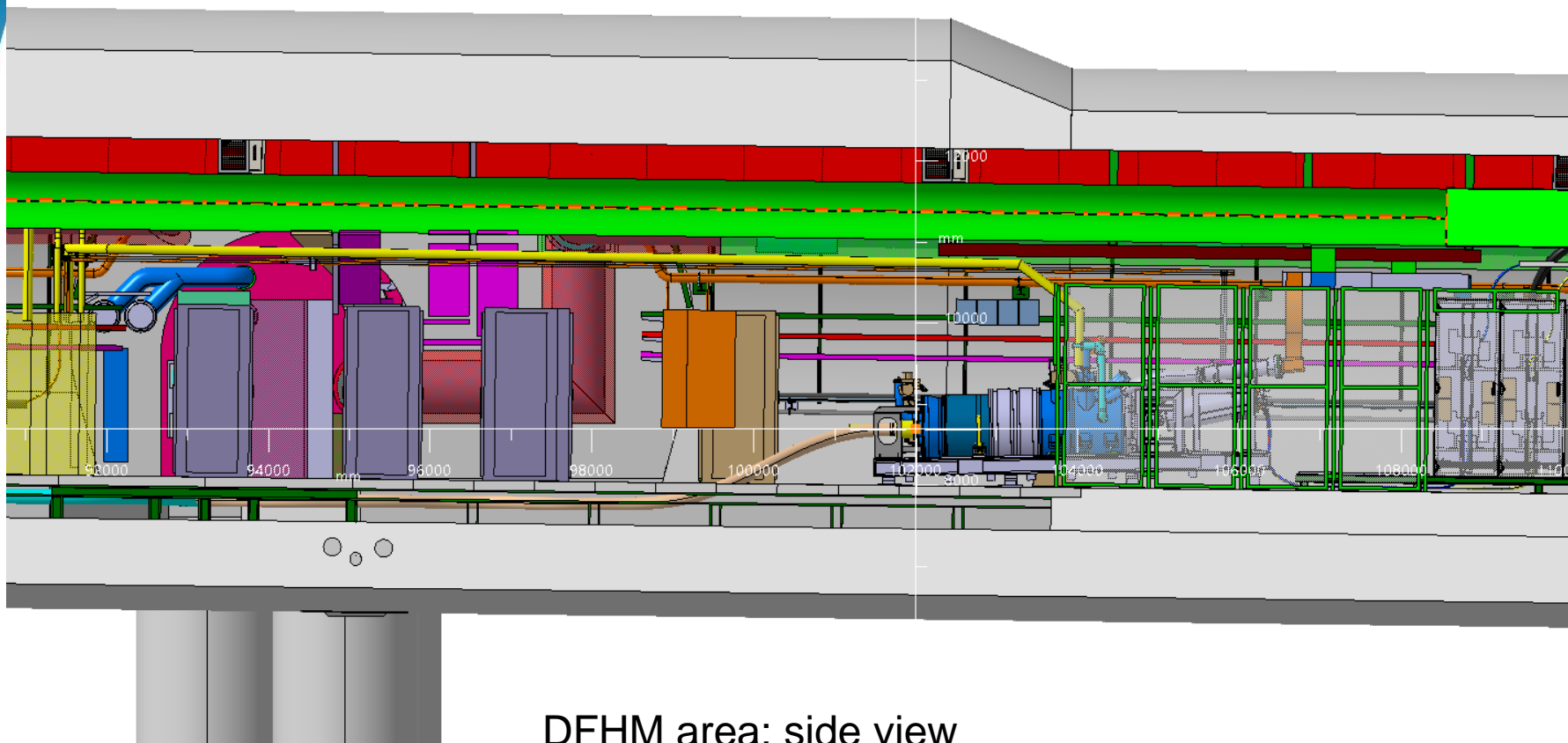

DFHM area: side view