

The Dark Side of the Universe

DSU 2022



UNSW Sydney, December 5-9, 2022



Gordon Godfrey Bequest for Theoretical Physics

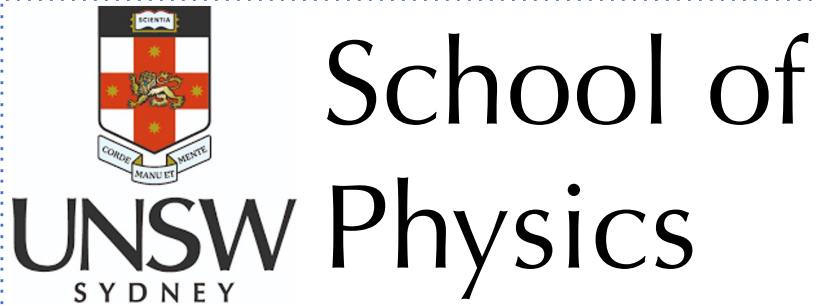

Chief Scientist
& Engineer

Sessions: plenary...

- Monday to Friday 09:00-12:30, G03 Ainsworth (this room).
- Coffee breaks: 10:30-11:00 in Ainsworth foyer.
 - A selection of “standard” coffees (latte, cappuccino, etc.) available **upon presentation of your conference badge** at **Coffee on Campus**.
 - They also take special requests (e.g., non-dairy milk).
 - You are welcome to use the seating at Coffee on Campus.

Sessions: parallel...

- Monday, Tuesday, and Thursday 14:00-18:00, **Old Main Building** (or just “Main Building” or “OMB”)
- Coffee breaks 15:40-16:10 in **G59/60** in **Old Main Building**.
- Look for **these posters**; they will show you the way around OMB.

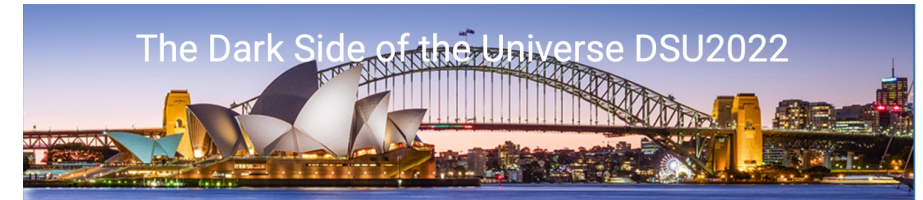

Parallel sessions and afternoon tea

149 229 230 G59/60

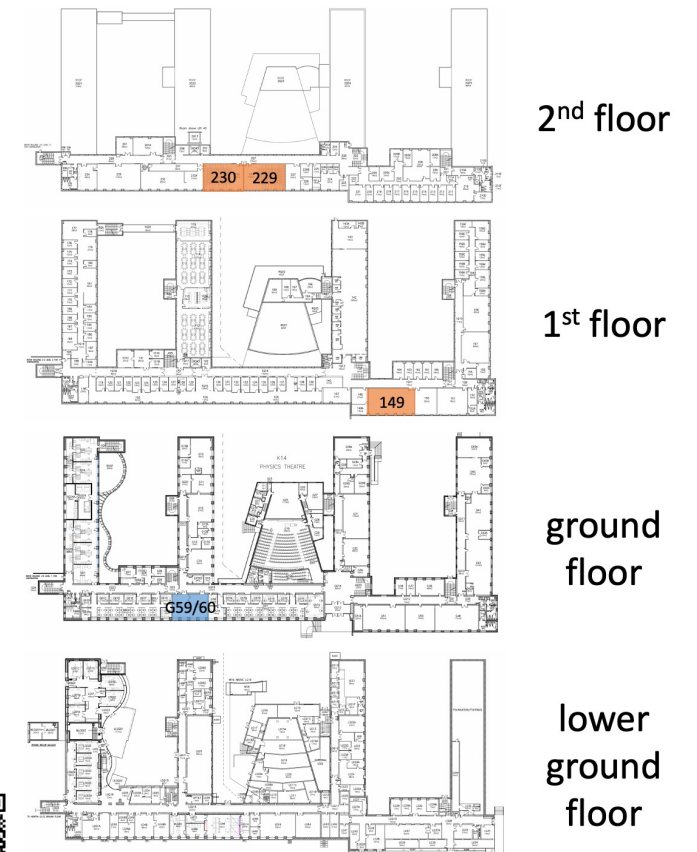

Kensington Campus - MazeMap
use.mazemap.com

Old Main Building



The Mall

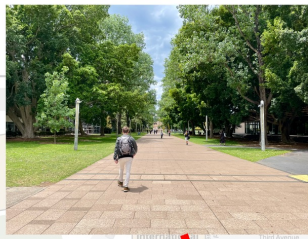

Kensington Campus Map

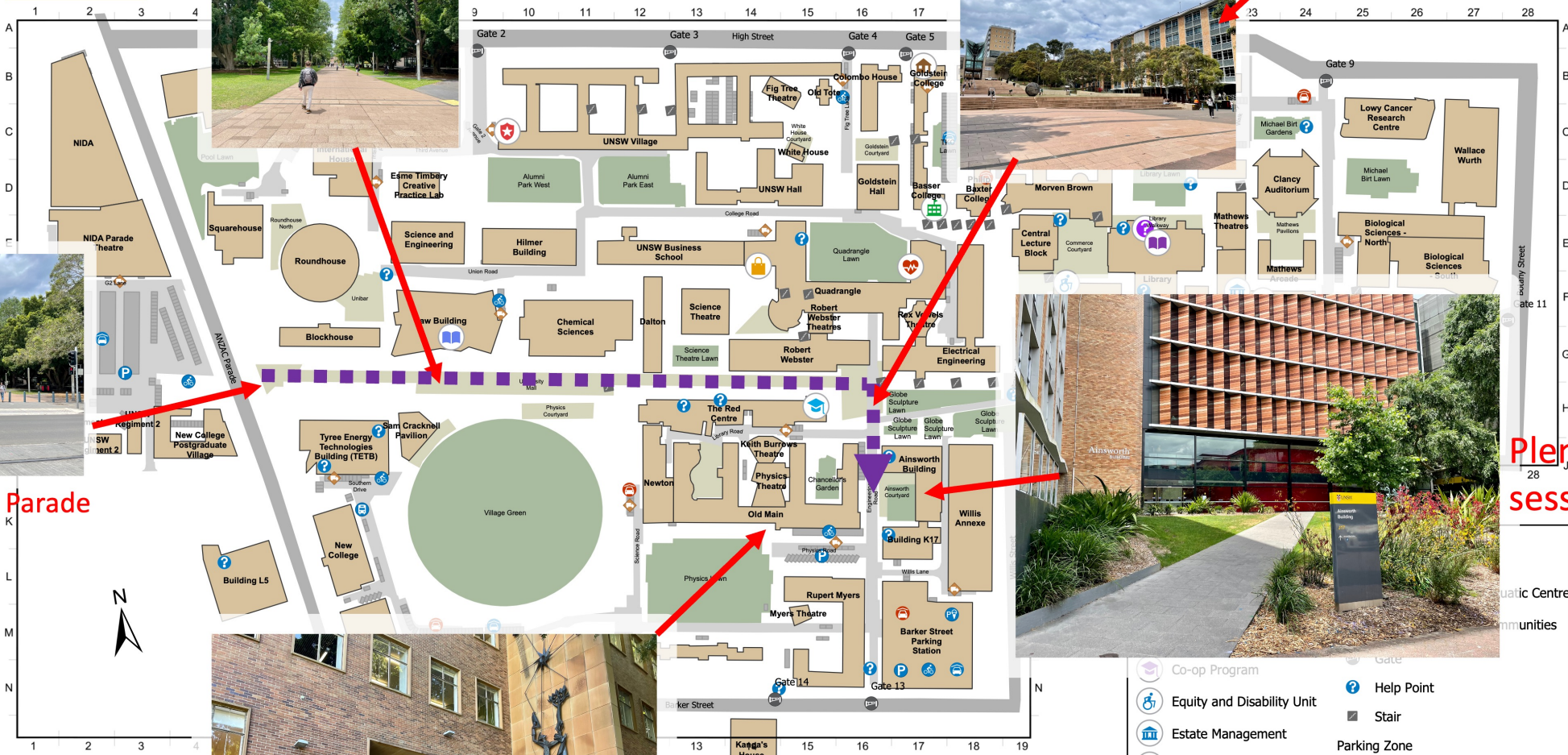

Ainsworth Building



Plenary sessions



L3 UNSW Anzac Parade Light rail stop

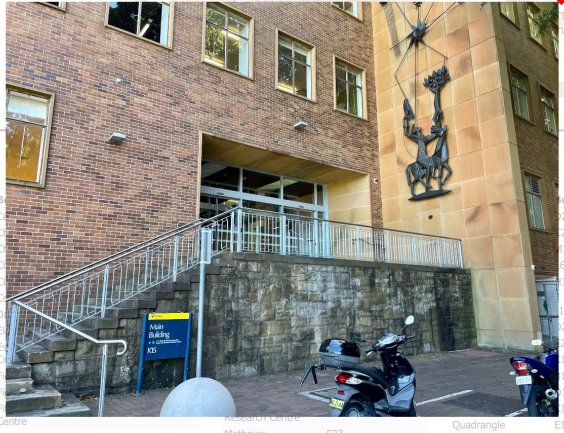

Parallel sessions

Building Name	Building Code
AGSM	G27
Ainsworth Building	J17
Bank	F22
Barker Apartments	N13
Barker Apartments	N13
Barker Street Parking Station	N18
Basser College	D17
Biological Sciences - North	D26
Biological Sciences - South	E26
Blockhouse	G6
Batany Street Parking Station	H25
Building K17	K17
Building L5	L5

Building Code	Building Name	Building Code	Building Name	Building Code
B21	Repository	B21	Tyree Energy Technologies Building (TETB)	H6
F17	Rex Vowles Theatre	F17	University Terraces	B8
G14	Robert Webster Theatres	G14	UNSW Business School	E12
G15	Robert Webster Theatres	G15	UNSW Hall	D14
E6	Roundhouse	E6	UNSW Regiment	H1
M15	Rupert Myers	M15	UNSW Regiment 2	J2
H8	Sam Cracknell Pavilion	H8	UNSW Regiment 2	J2
F25	Samuels	F25	UNSW Village	B10
E8	Science and Engineering	E8	Valentine Annexe	H22
F13	Science Theatre	F13	Wallace Wurth	C27
G23	Solar Industrial Research Facility (SIRF)	G23	Warrane College	M7
E4	Squarehouse	E4	White House	C15
H13	The Red Centre	H13	Willis Annexe	J18

- Co-op Program
- Equity and Disability Unit
- Estate Management
- Freehills Law Library
- Future Students
- IT Walk-in Service Centre
- Library
- Medical Centre
- Post Office
- Print Centre
- The Nucleus: Student Hub
- Gate
- Help Point
- Stair
- Parking Zone
- Type
- Bus Bay
- Accessible
- Go Get
- Loading Zone
- Meter/Permit
- Meters
- Motorbike
- Permit
- Reserve

WiFi access...

- **Eduroam** is available for registered users.
- **UNSW Guest network.**
 - Choose “UNSW Guest” on your device.
 - Follow the instructions to complete and activate your registration.

Social events...

- **Reception:** Monday 18:00-20:00, Ainsworth foyer/courtyard (this building).

Social events...

- **Reception:** Monday 18:00-20:00, Ainsworth foyer/courtyard (this building).
- **Conference dinner:** Thursday from 19:00, at **Watersedge at Campbell's Stores**, 7-26 Circular Quay W, The Rocks NSW 2000
 - **We are very close to venue capacity:** if you wish to bring additional guests, please email DSU2022@unsw.edu.au before purchasing tickets on Eventbrite.

Social events...

- **Reception:** Monday 18:00-20:00, Ainsworth foyer/courtyard (this building).
- **Conference dinner:** Thursday from 19:00, at **Watersedge at Campbell's Stores**, 7-26 Circular Quay W, The Rocks NSW 2000
 - **We are very close to venue capacity:** if you wish to bring additional guests, please email DSU2022@unsw.edu.au before purchasing tickets on Eventbrite.
- **Wear your conference badge** and, where applicable, **present guest tickets** for admittance.

Admits 1 guest

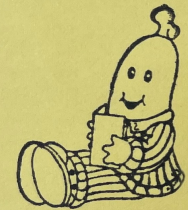

Admits 2 guests

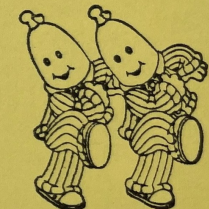

Social events...

- **Reception:** Monday 18:00-20:00, Ainsworth foyer/courtyard (this building).
- **Conference dinner:** Thursday from 19:00, at **Watersedge at Campbell's Stores**, 7-26 Circular Quay W, The Rocks NSW 2000
 - **We are very close to venue capacity:** if you wish to bring additional guests, please email DSU2022@unsw.edu.au before purchasing tickets on Eventbrite.
- **Wear your conference badge** and, where applicable, **present guest tickets** for admittance.



Admits 1 guest



Admits 2 guests

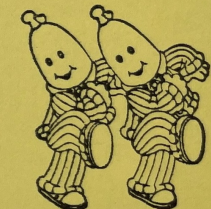

Instructions for speakers...

- Please **upload and make public** slides to indico by
 - **08:00** on day of presentation (plenary)
 - **13:00** on day of presentation (parallel)
- If you can't upload, email to DSU2022@unsw.edu.au by the indicated time; we'll upload for you.
- Preferred format is PDF. If you choose to use a non-PDF format, please always submit a PDF as well as a backup.
- Let us know **well in advance** if you wish to use your own computer.

Helpers...



Sabine Bolwell



Nathan Cohen



Tobias Felkl

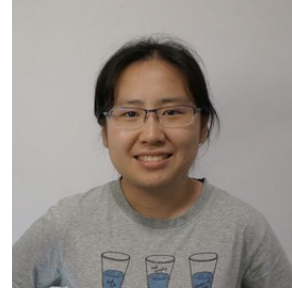

Yuqi Kang

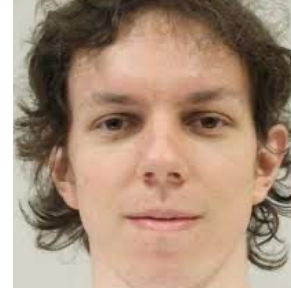

Adam Lackner



Gabriela Lichtenstein

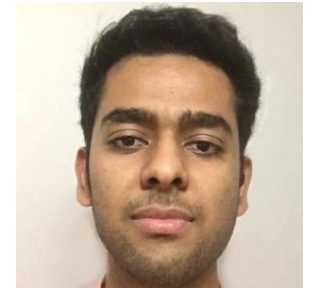

Aamek Malhotra



Markus Mosbech



Giovanni Pierobon



Ellen Sirks



Adam Stewart

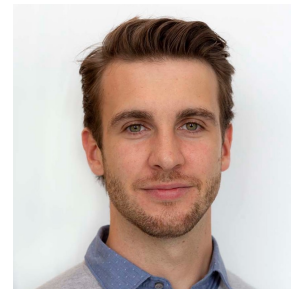

Julius Wons

