

# Fysiska institutionen / Department of Physics

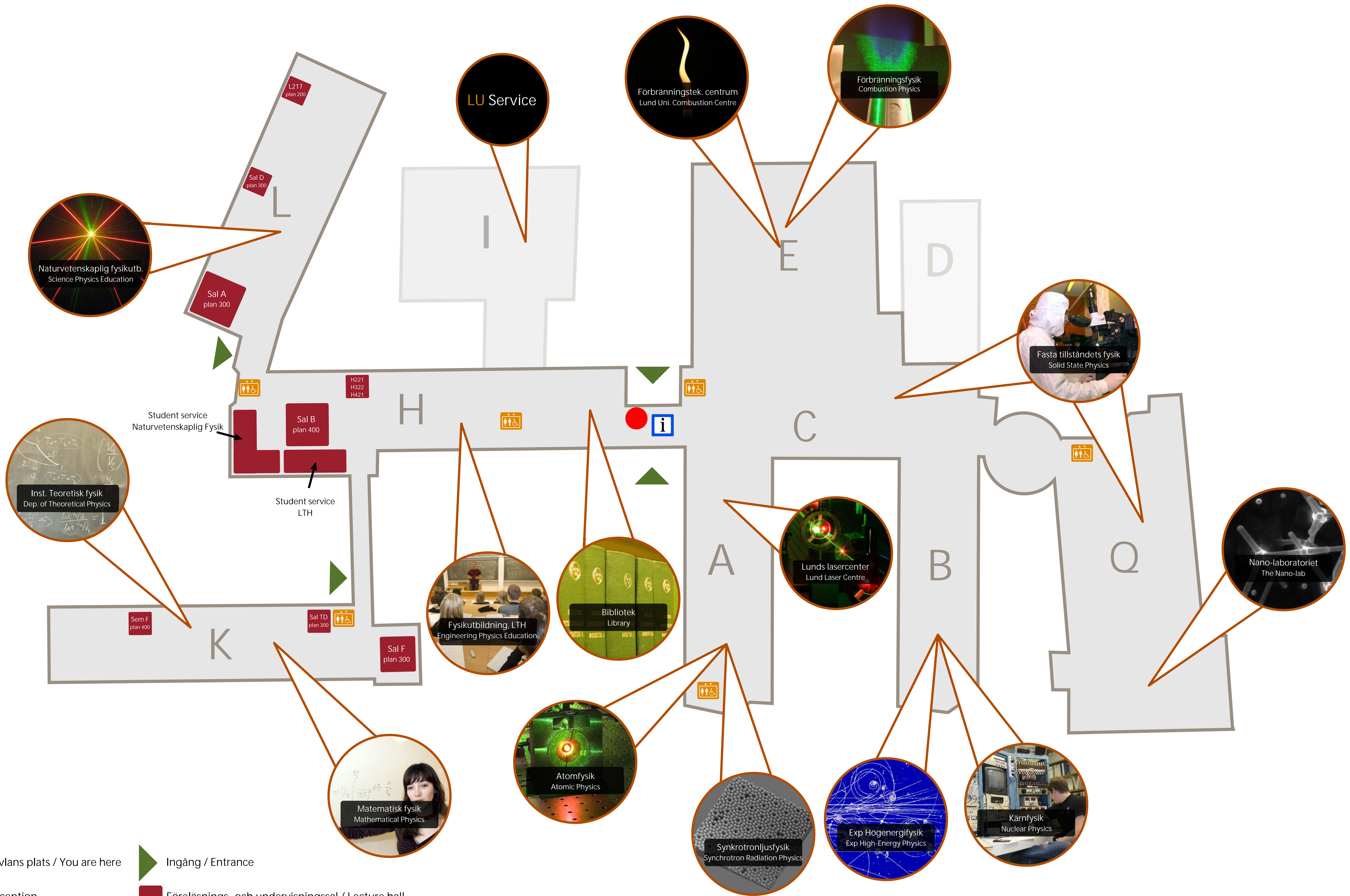

Tavlan plats / You are here

Ingång / Entrance

Reception

Föreläsnings- och undervisningssal / Lecture hall

Hiss / Elevator

Prefektansli återfinns i hus H på plan 400 / Head of Department is located in building H on level 400

Nationellt resurscentrum för fysik återfinns i hus H på plan 400 / The National Centre for Education in Physics is located in building H on level 400

Kryolab återfinns i hus E / The Cryogenic Laboratory is located in building E