

# Intégration Galerie 825

# Intégration Galerie 825

Les modèles intégration de la galerie 825 découpé en 4 parties ~300m:

- ST1608334      Intégration 825 Partie1 4180      ← Zone Est
- ST1608351      Intégration 825 Partie2 4180
- ST1608355      Intégration 825 Partie3 4180
- ST1608360      Intégration 825 Partie4 4180      ← Zone Ouest

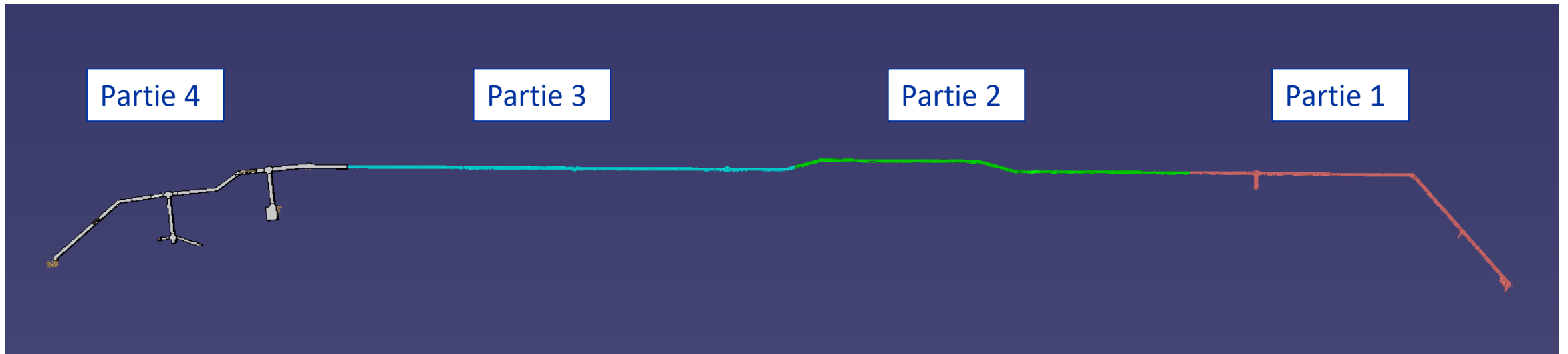
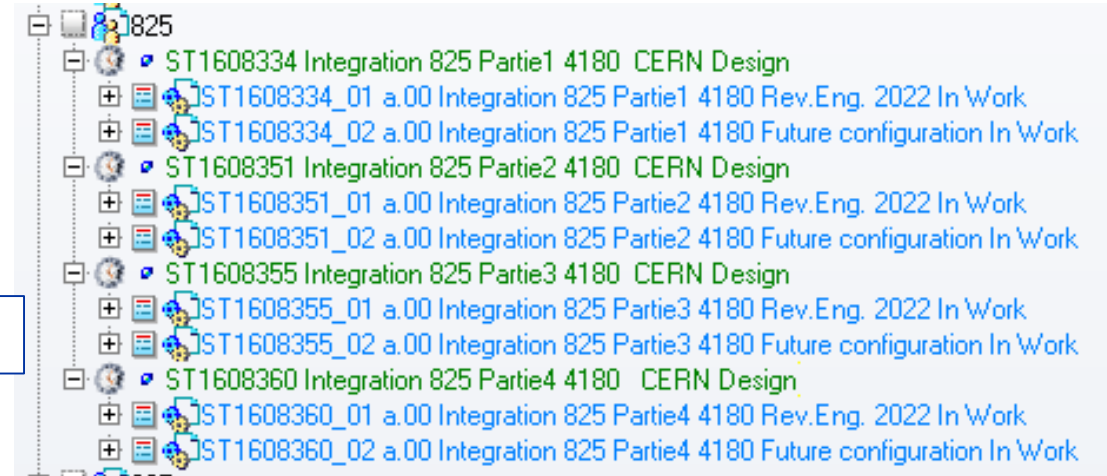

# Intégration Galerie 825

zone ouest (Partie 4) :

- ST1608360 Integration 825 Partie4 4180 ← Zone Ouest

Priorités		Galerie	Numéro ST ASS GENERALE INT	Etat d'avancement par service					
				Scan survey	Maillage catia intégration	Génie civil	EL	CV	Tertiaire
2	825 Partie 4	Reverse	ST1608360_01	Finalisé	Finalisé	Finalisé	Finalisé	En cours	En cours
		Future	ST1608360_02	Finalisé	Finalisé	Finalisé	Finalisé	En cours	En cours

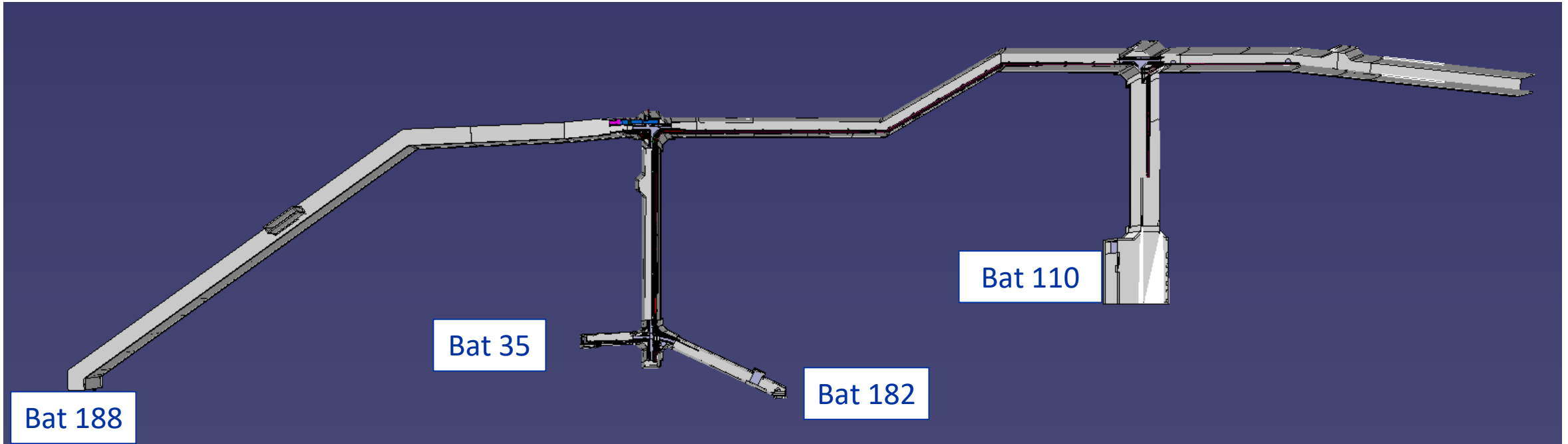

# Intégration Galerie 825

zone ouest (Partie 4)

Livrable des modèles 3D:

## GT825 (b.35-b.188):

- 3D proposal: 26/1/23
- 3D validation confirmed: 2/2/23

Activity	Milestone	Date	Gallery	Location
RE	Delivery	27/7/23	825	b.35-b.110 (with cross next to b.110 and branch)
RE	Validation	10/8/23	825	b.35-b.110 (with cross next to b.110 and branch)
FC	Delivery	10/8/23	825	b.35-b.110 (with cross next to b.110 and branch)
FC	Validation	24/8/23	825	b.35-b.110 (with cross next to b.110 and branch)

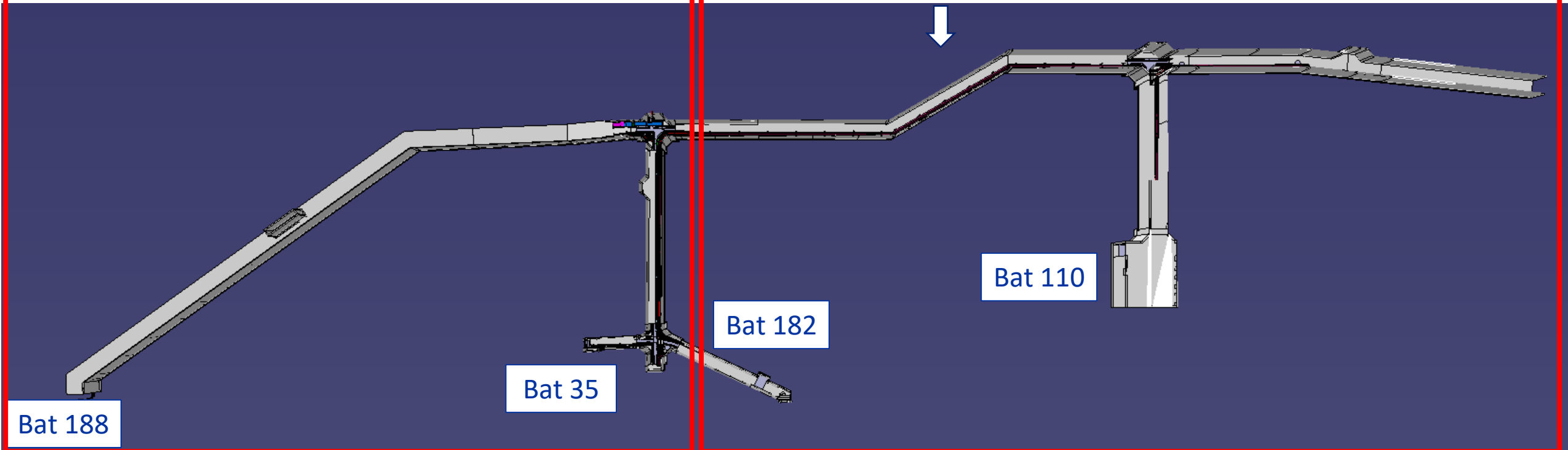

# Intégration Galerie 825

zone ouest (Partie 4) **Reverse Eng** en cours:

Jonction 825/b.188 Dcum A-1190

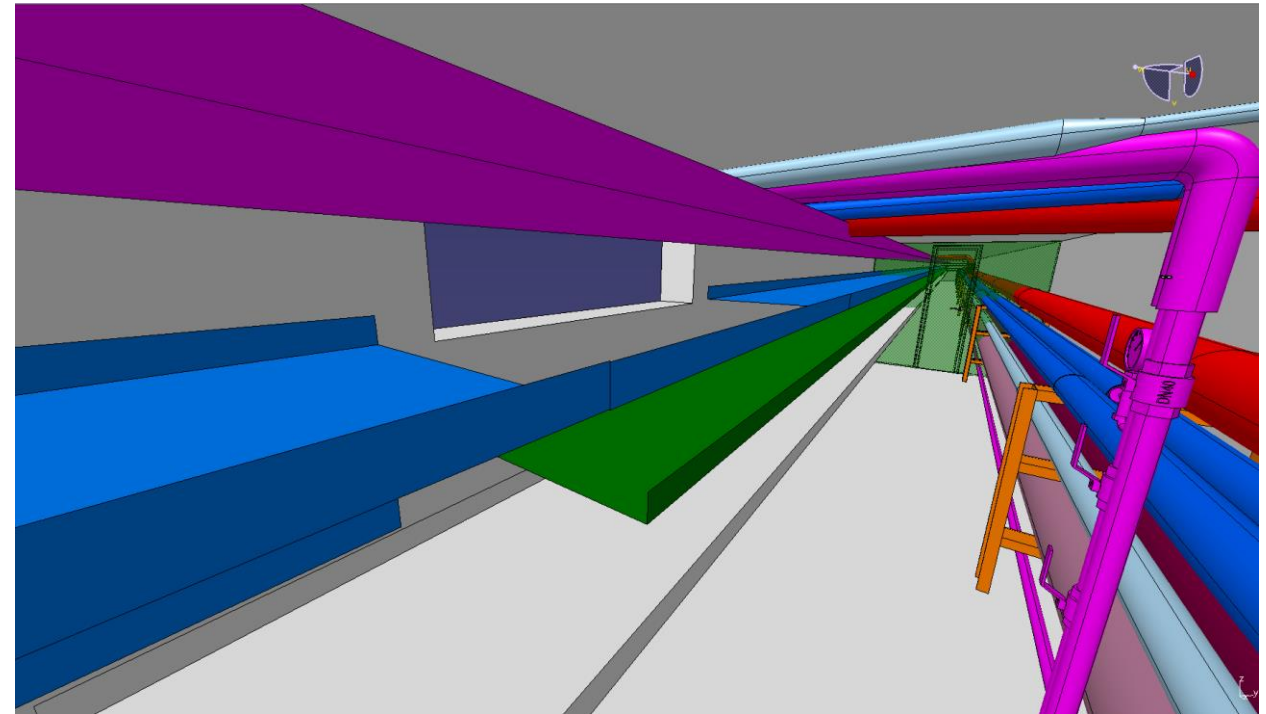
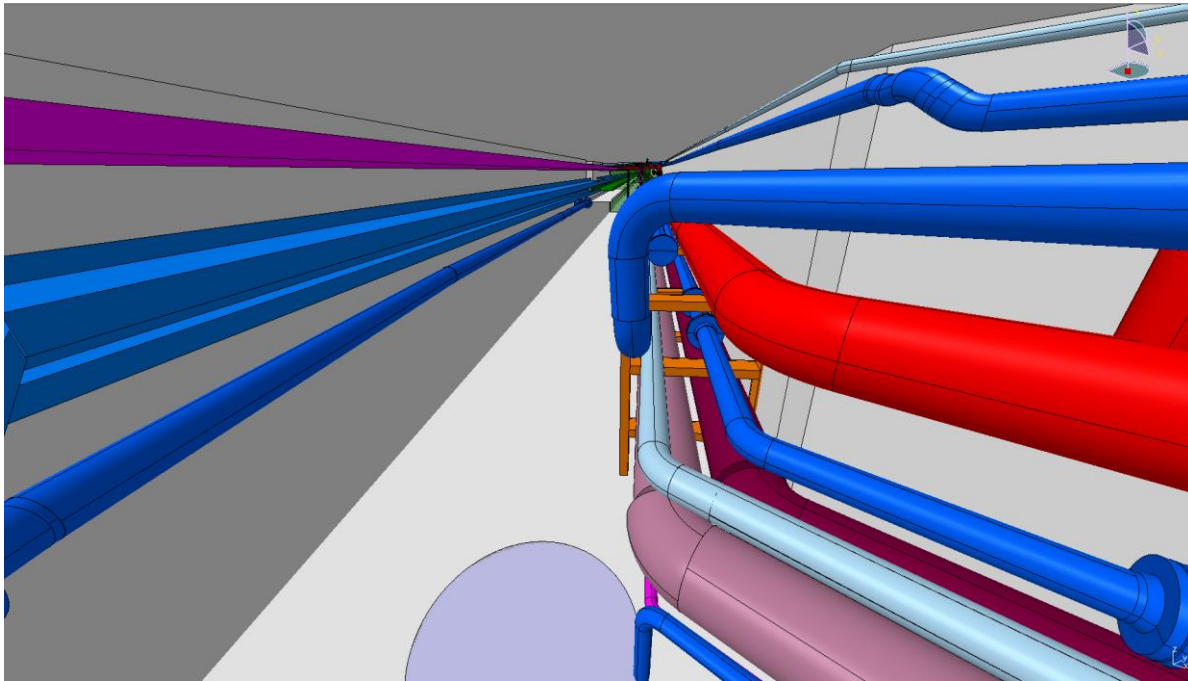

# Intégration Galerie 825

zone ouest (Partie 4) **Reverse Eng** en cours:

Jonction 825/Dcum A-1090

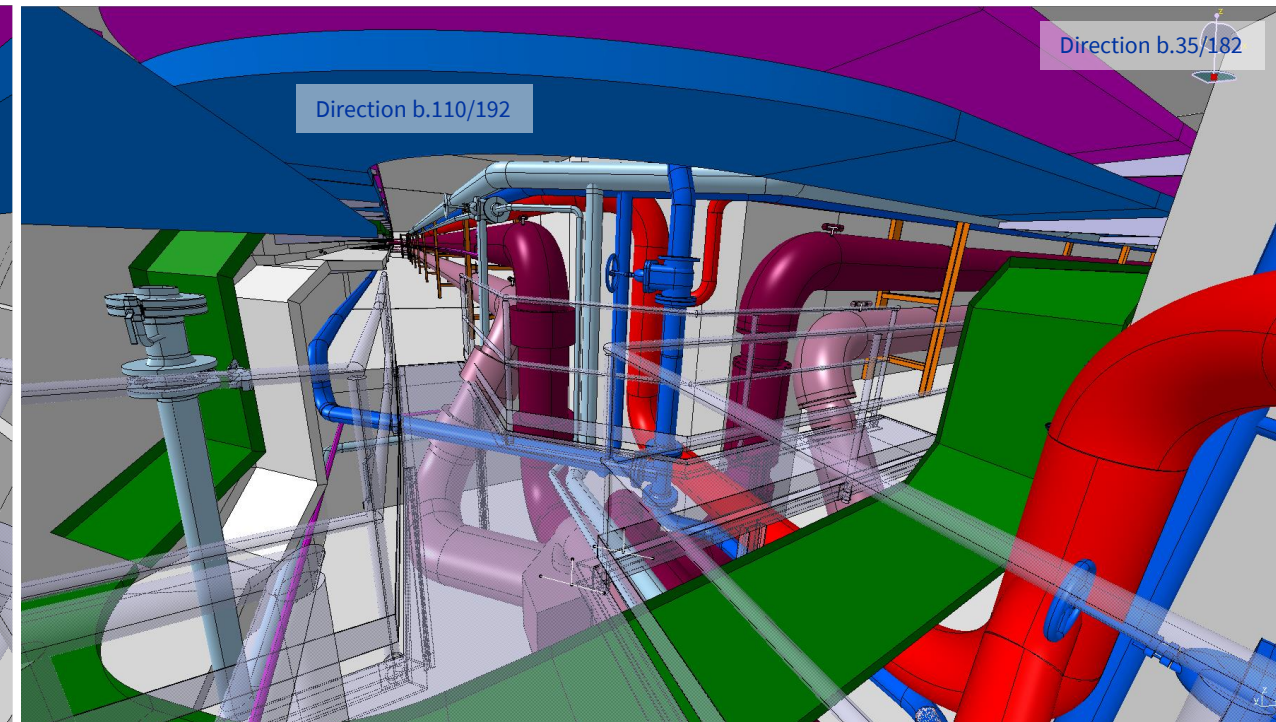
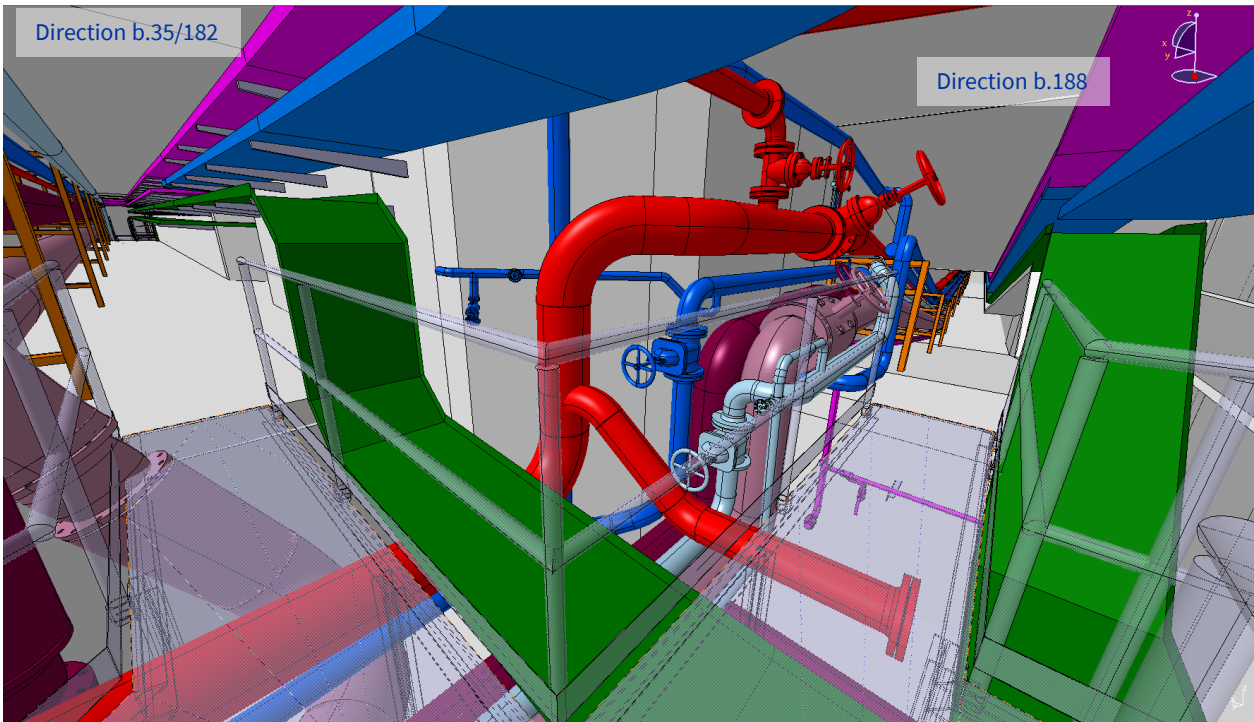
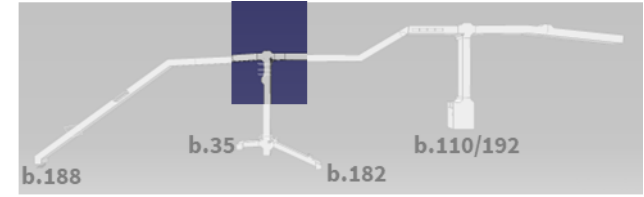

# Intégration Galerie 825

zone ouest (Partie 4) **Reverse Eng en cours:**

Jonction 825/Dcum A-1090

- Garde corps en interférence avec un boîtier électrique

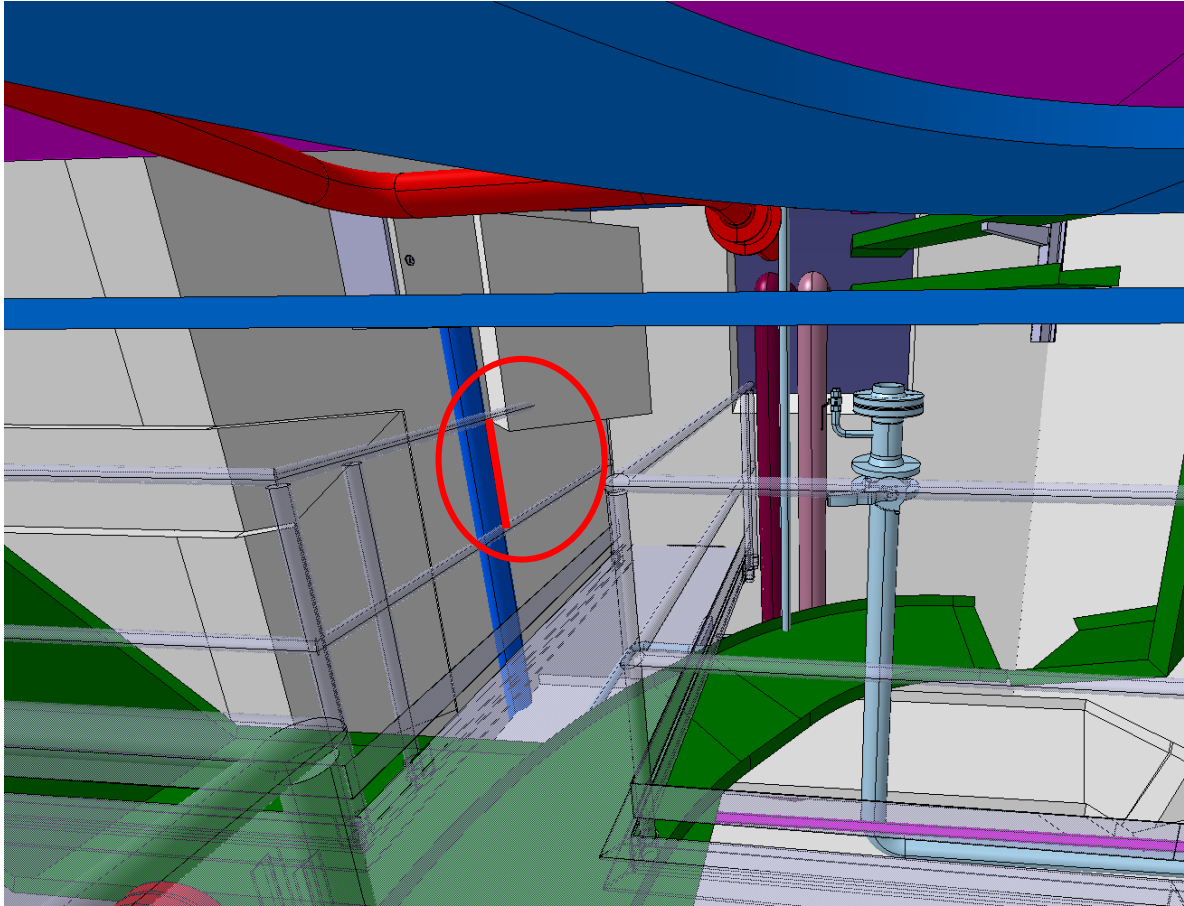
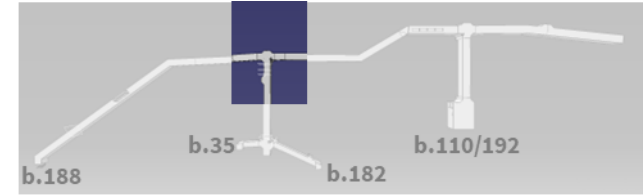

# Intégration Galerie 825

zone ouest (Partie 4) **Reverse Eng** en cours:

Jonction 825 Dcum D-0030

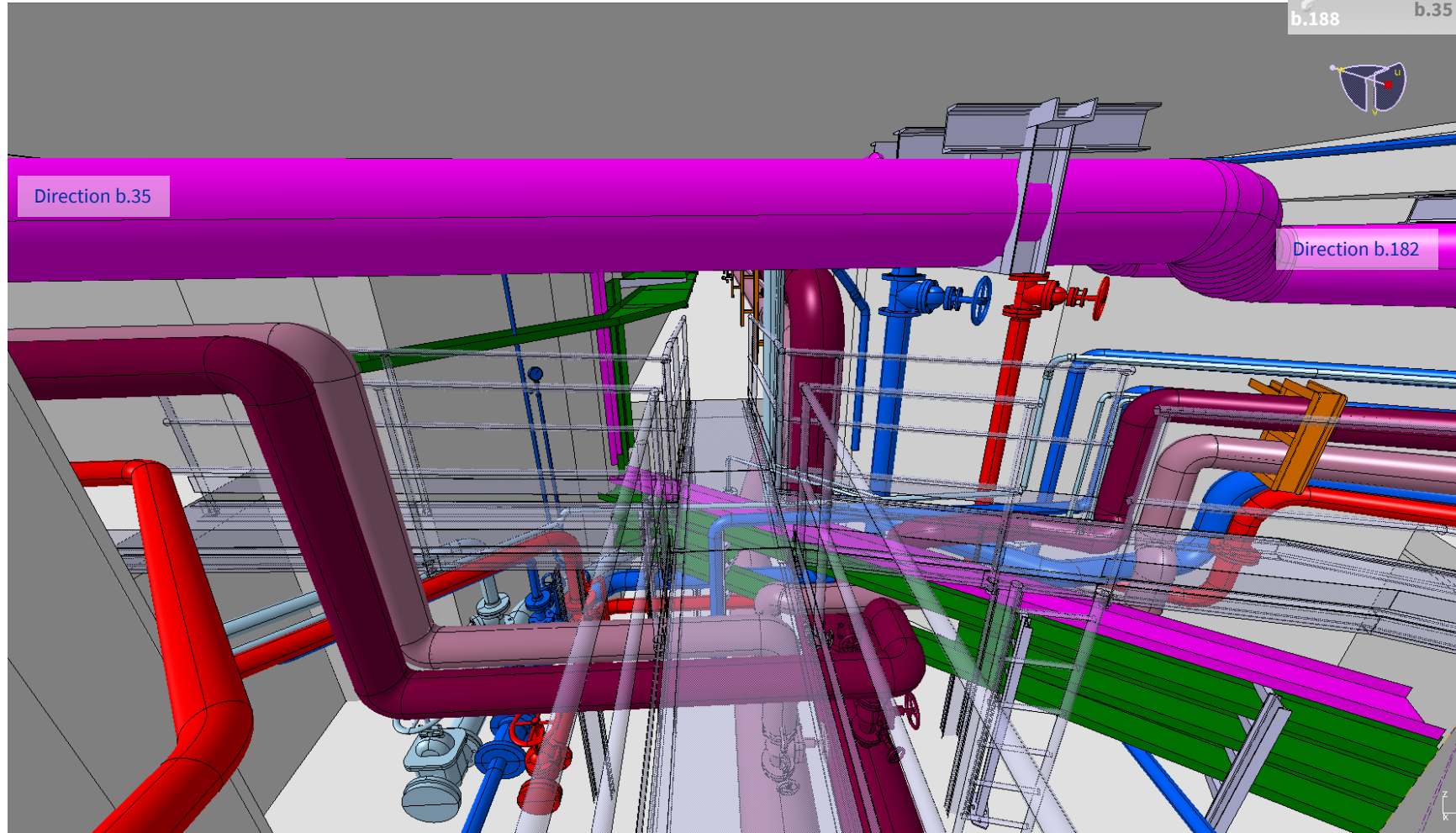



# Intégration Galerie 825

zone ouest (Partie 4) **Reverse Eng en cours:**

Jonction 825 Dcum D-0030

- Tuyauterie SCE a décaler

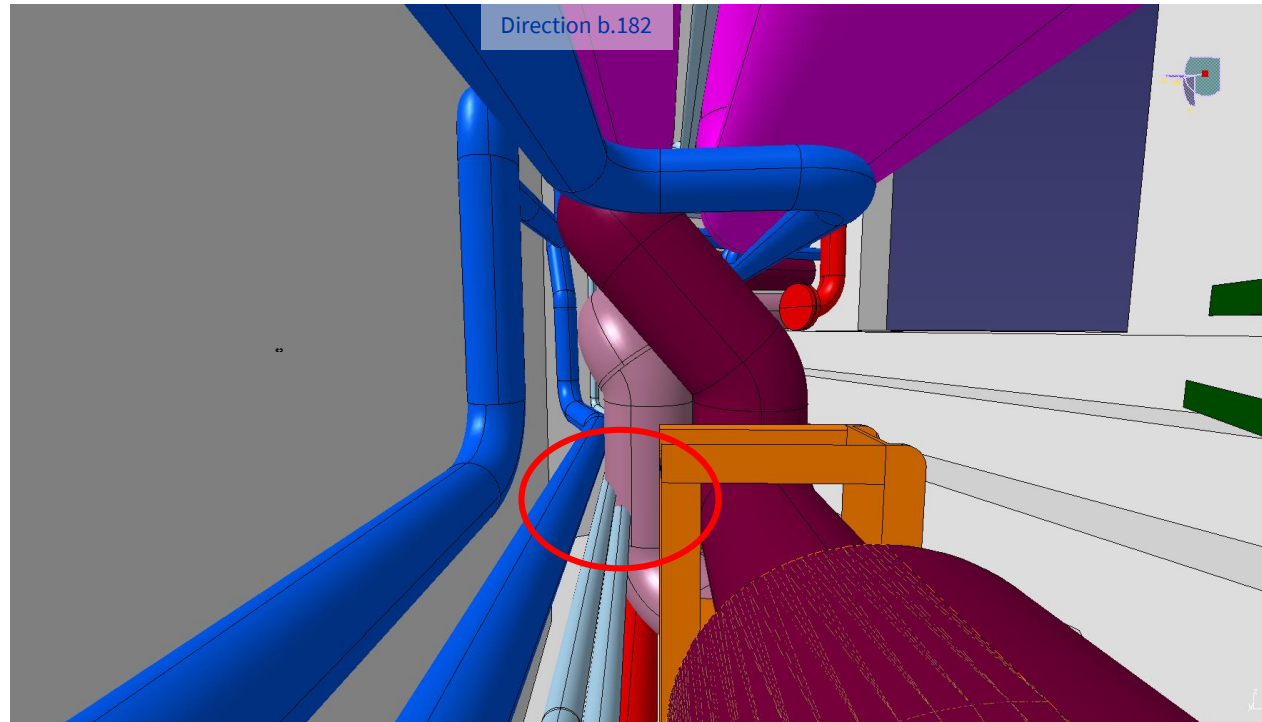
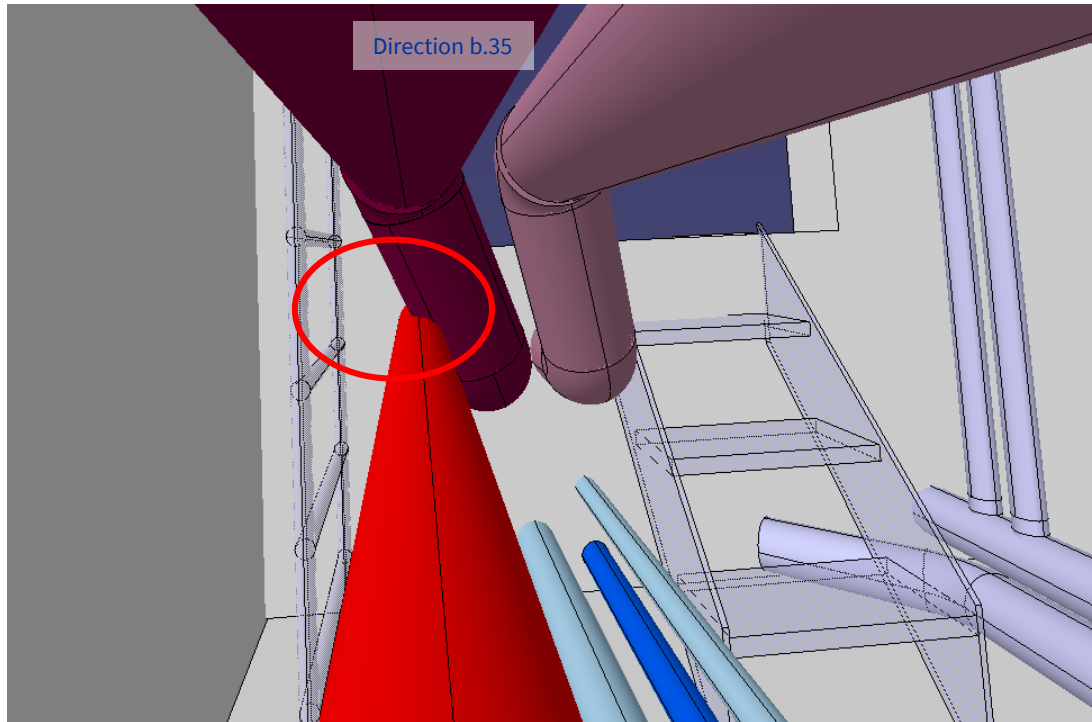
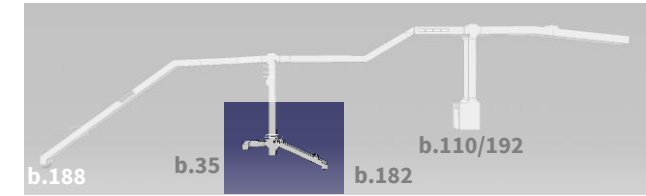

# Intégration Galerie 825

zone ouest (Partie 4) **Reverse Eng** en cours:

Jonction 825 Dcum D-0030

- deux autres tuyauteries origine?

Direction b.35

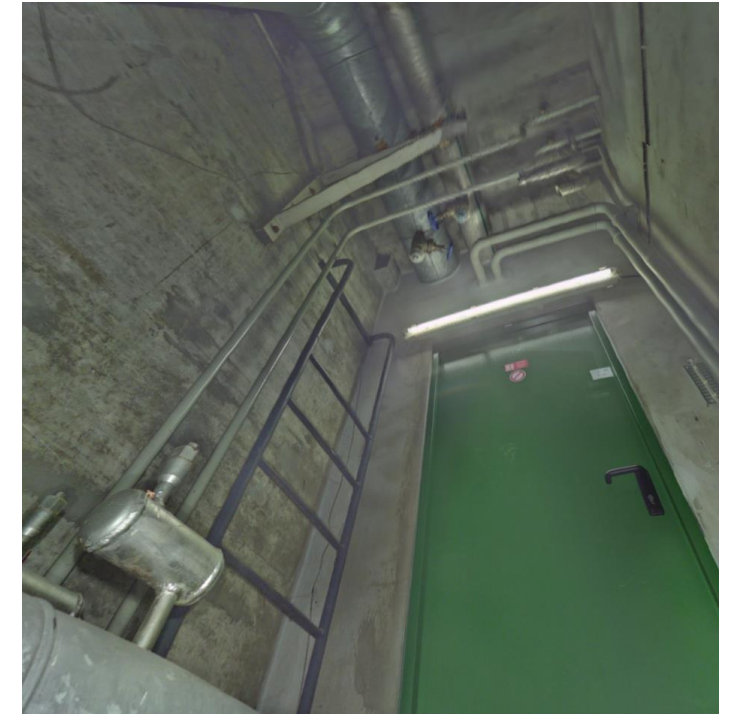
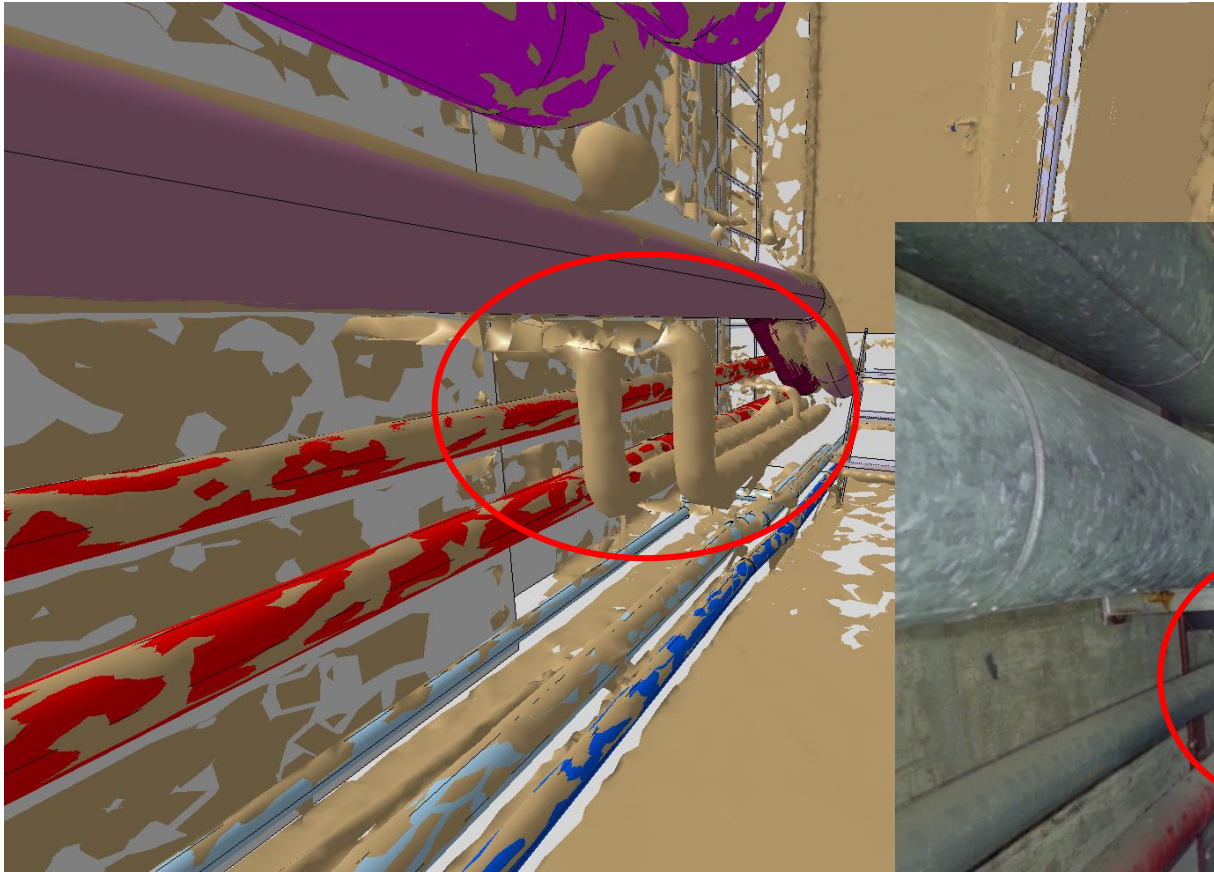
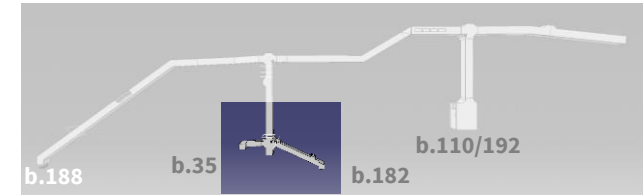

# Intégration Galerie 825

zone ouest (Partie 4) **Future Configuration en cours:**

Jonction 825/b.188 Dcum A-1190

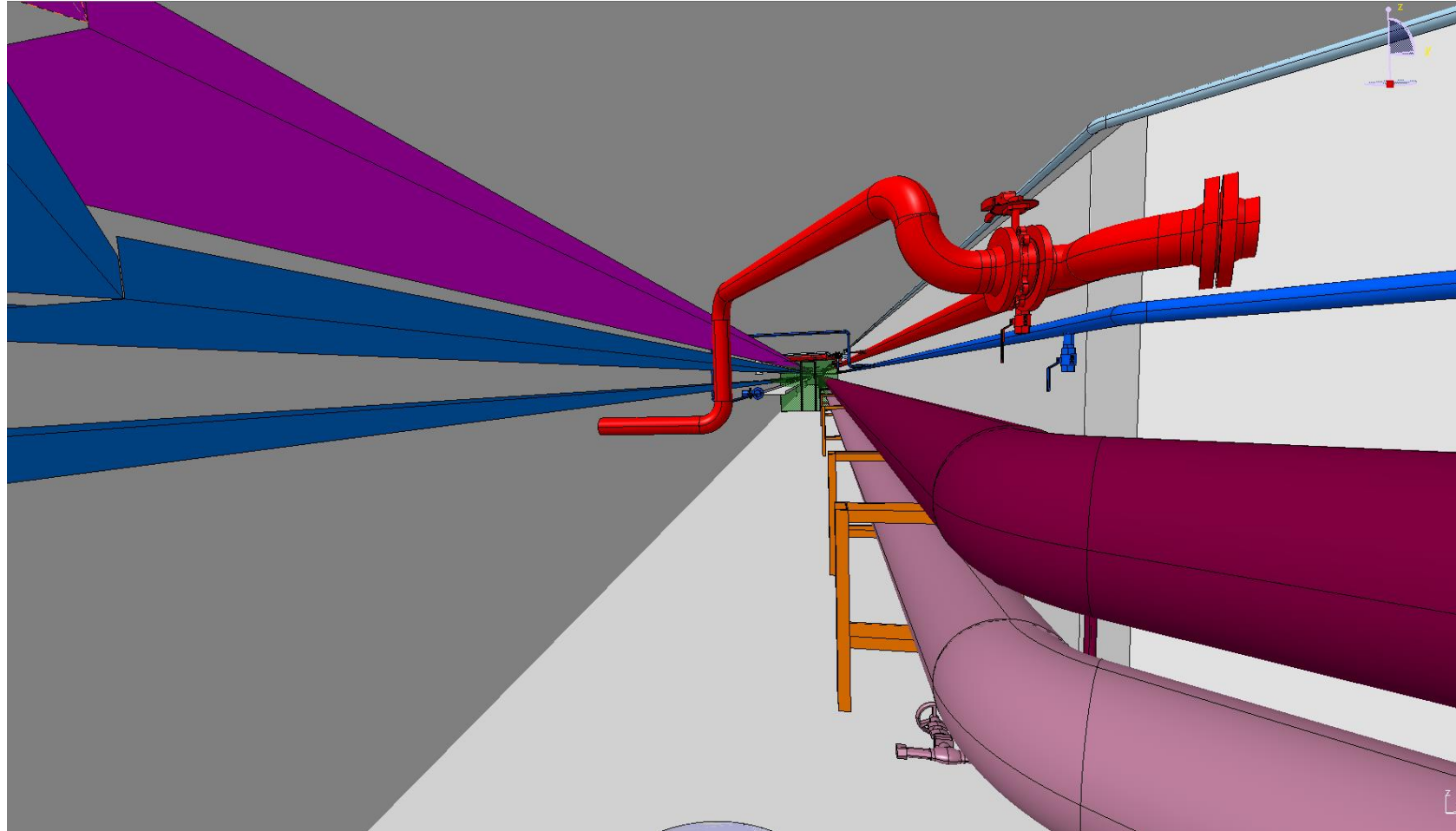

# Intégration Galerie 825

zone ouest (Partie 4) **Future Configuration en cours:**

Jonction 825/Dcum A-1090

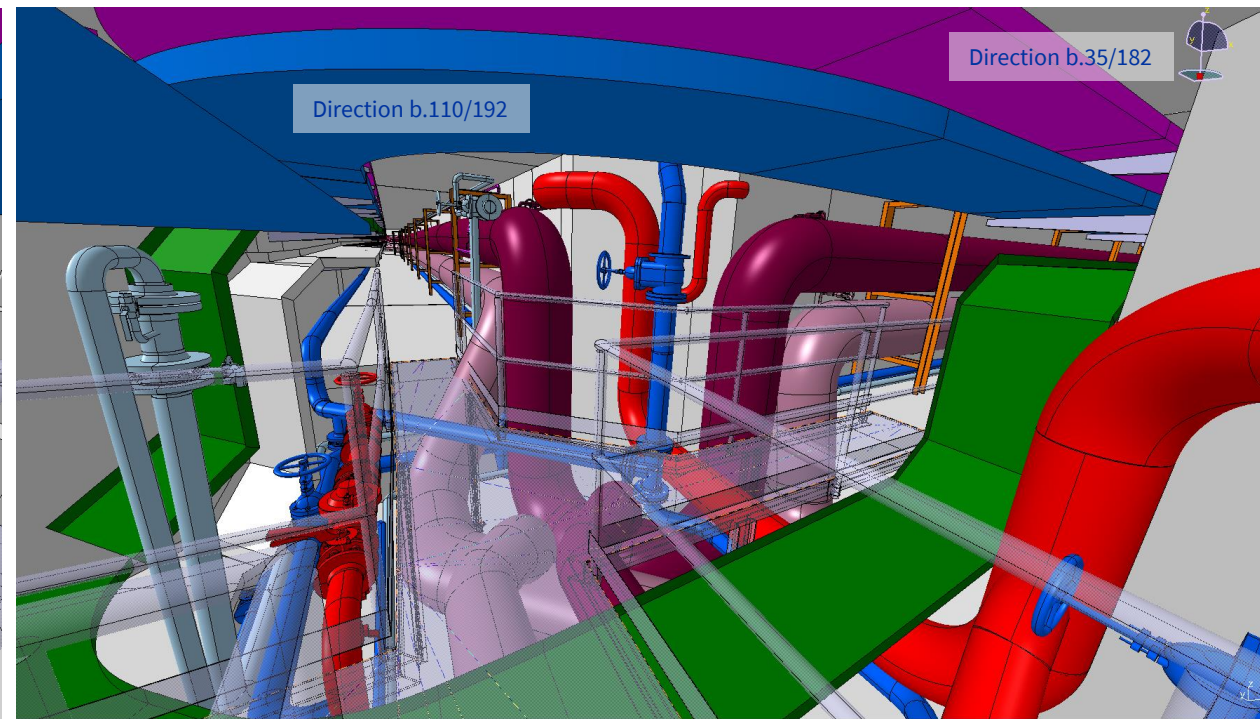
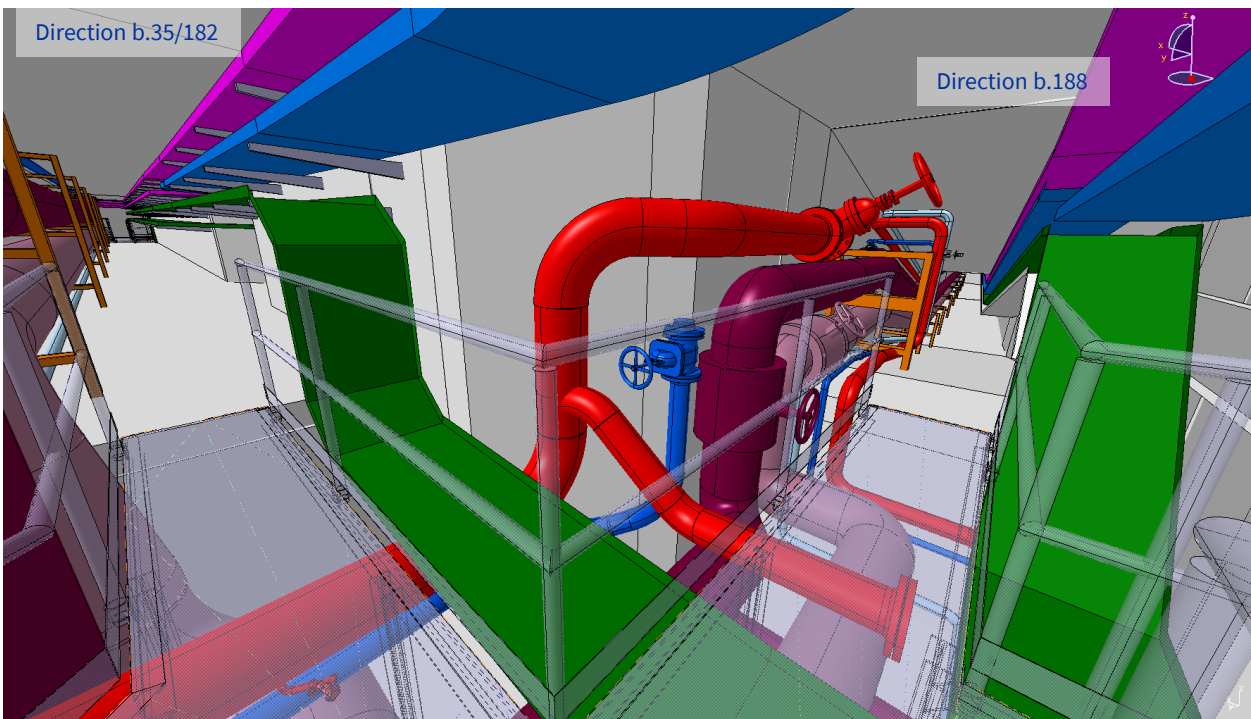
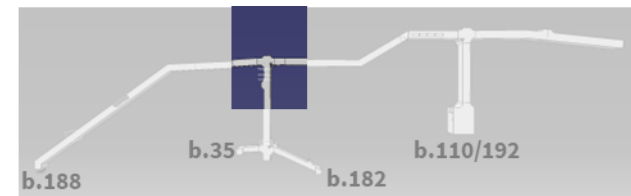

# Intégration Galerie 825

zone ouest (Partie 4) **Future Configuration en cours:**

Jonction 825/Dcum A-1090

- Interférence tuyauteries CV / support SCE

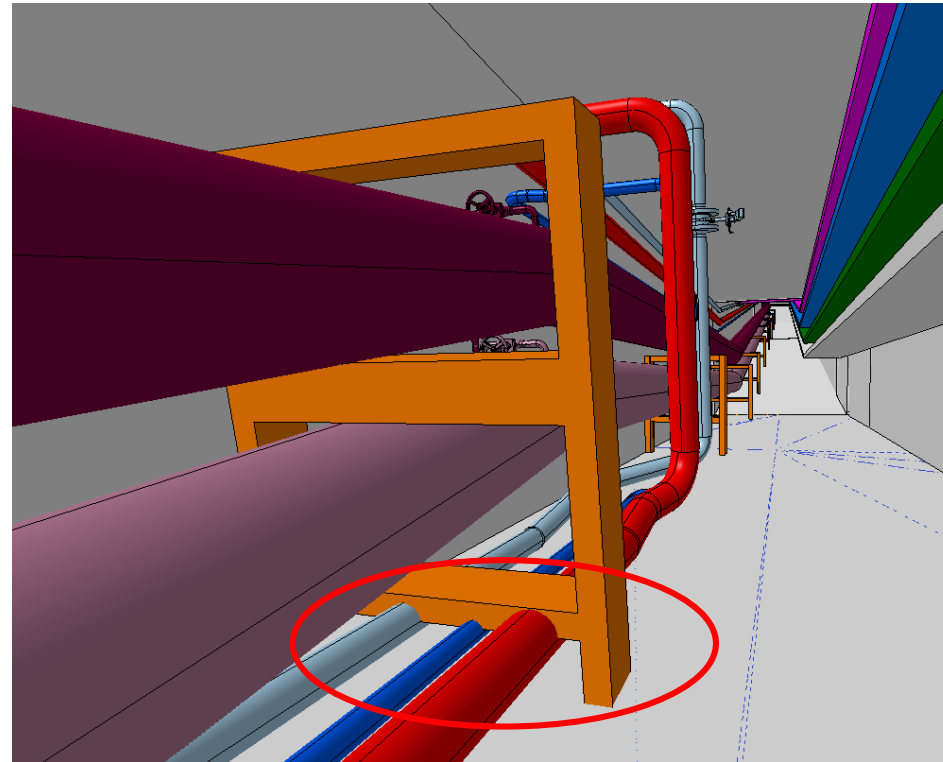
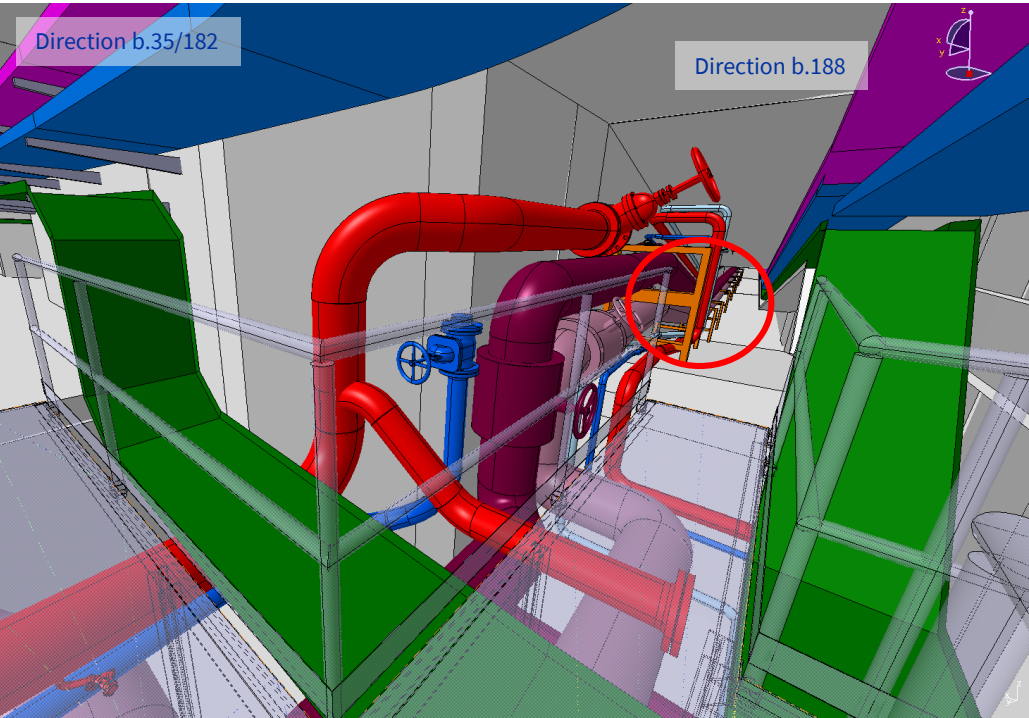
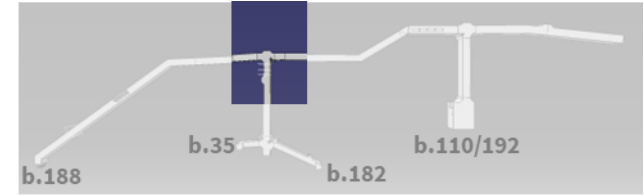

# Intégration Galerie 825

zone ouest (Partie 4) **Future Configuration en cours:**

Jonction 825/Dcum A-1090

- Interférence AC / SCE

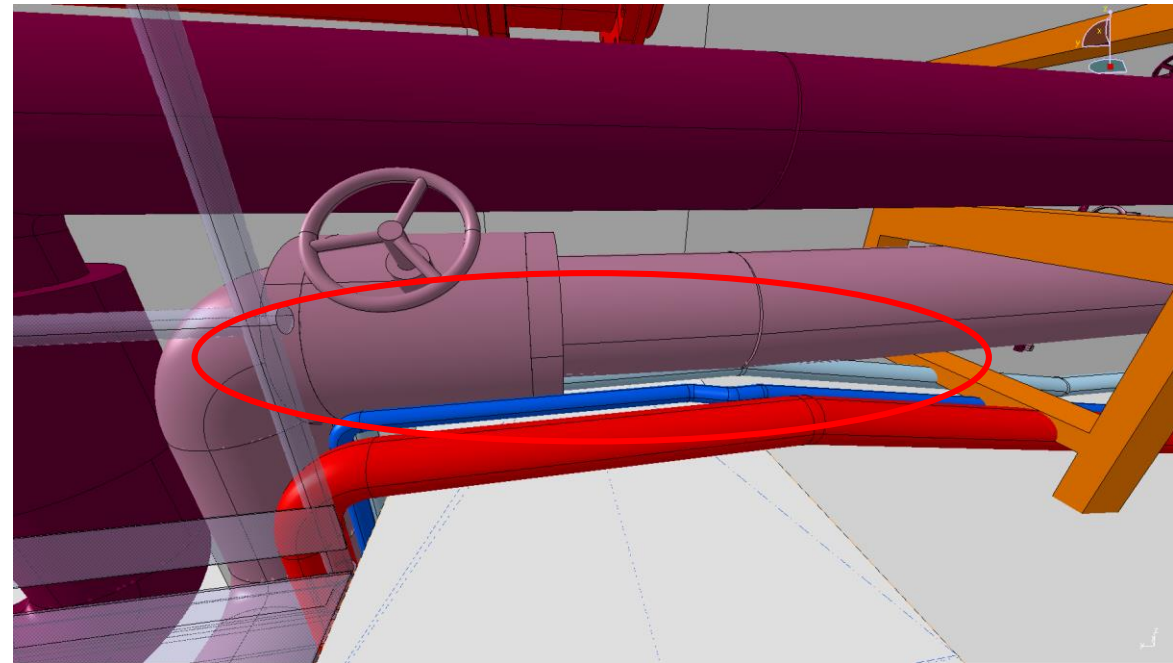
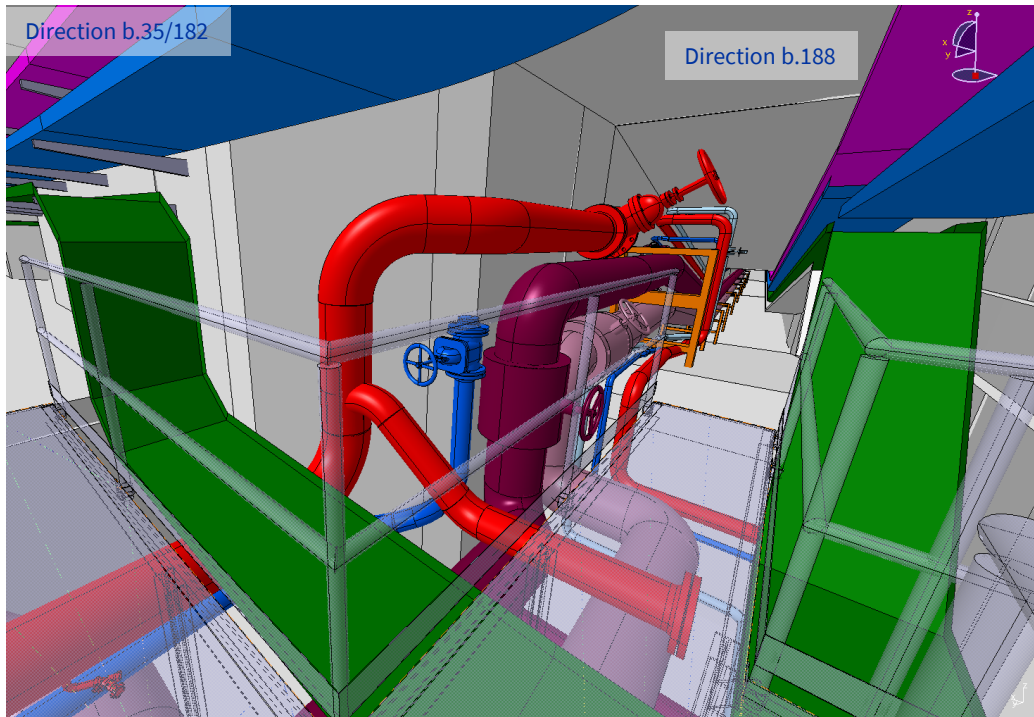
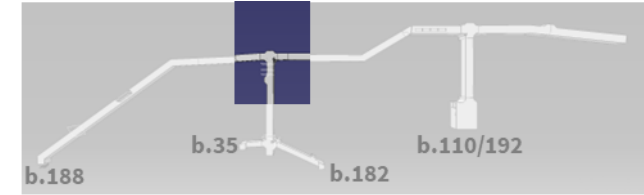

# Intégration Galerie 825

zone ouest (Partie 4) **Future Configuration en cours:**

Jonction 825/Dcum A-1090

- Interférence CV / Echelle à câble

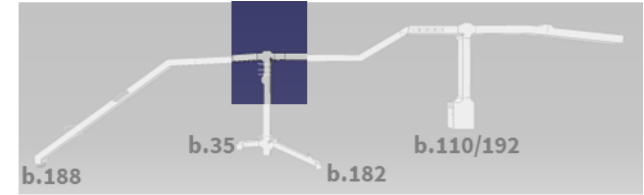
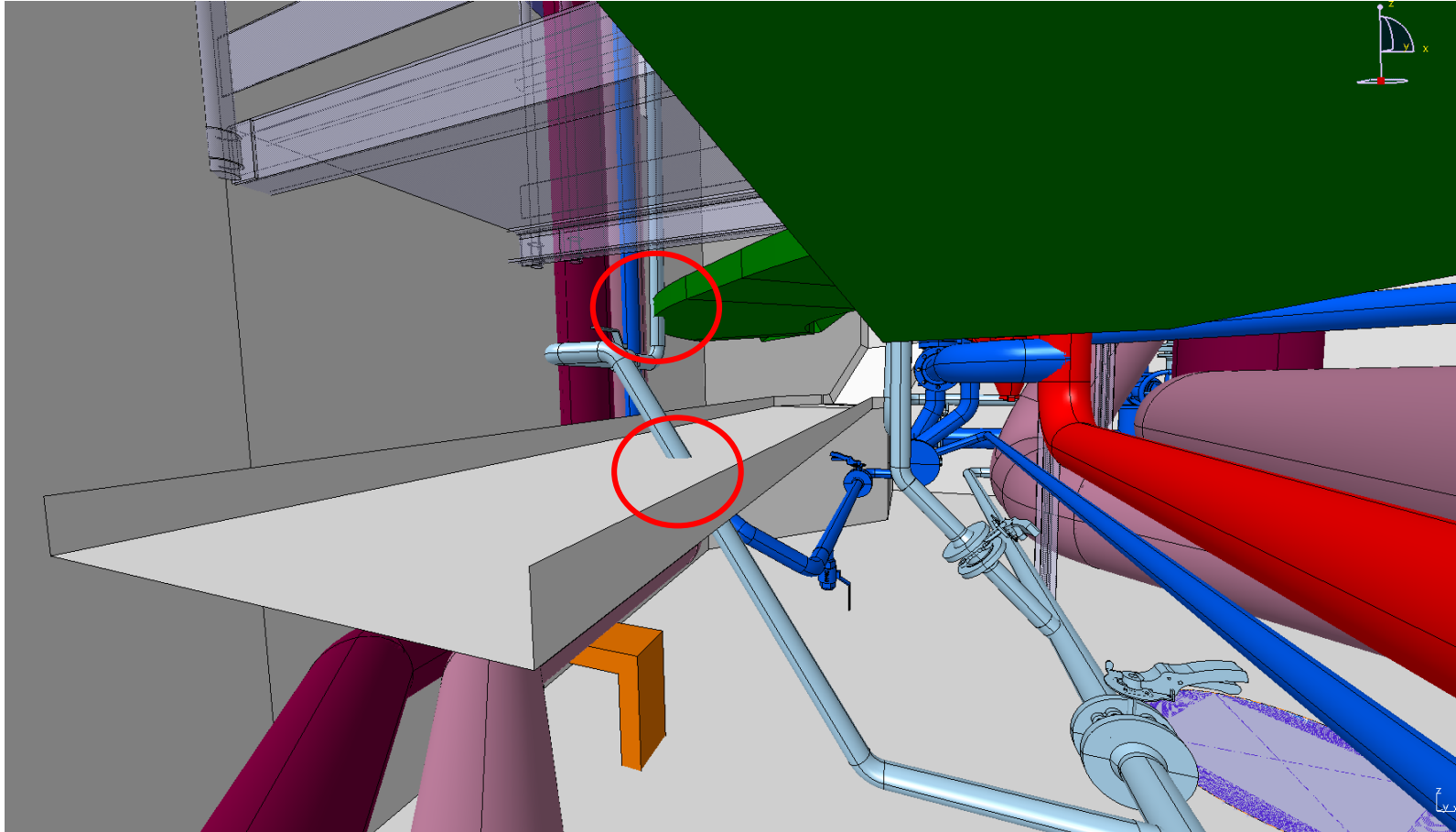

# Intégration Galerie 825

zone ouest (Partie 4) **Future Configuration en cours:**

Jonction 825/Dcum A-1090

- Interférence ED / Support

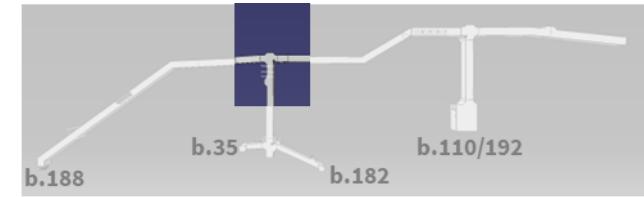
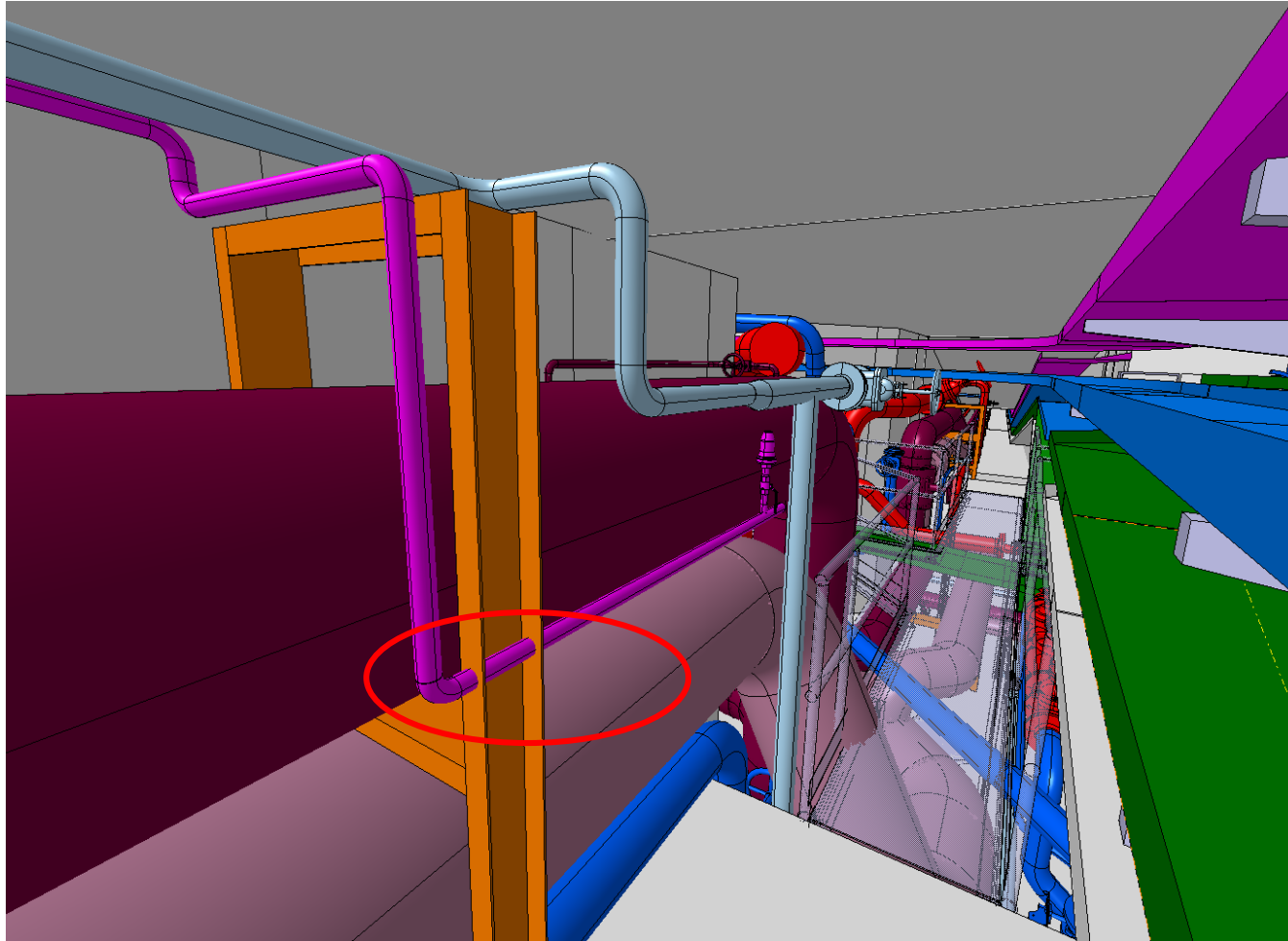



# Intégration Galerie 825

zone ouest (Partie 4) **Future Configuration en cours:**

**Jonction 825 Dcum D-0030**

- ED a retirer ou déplacer

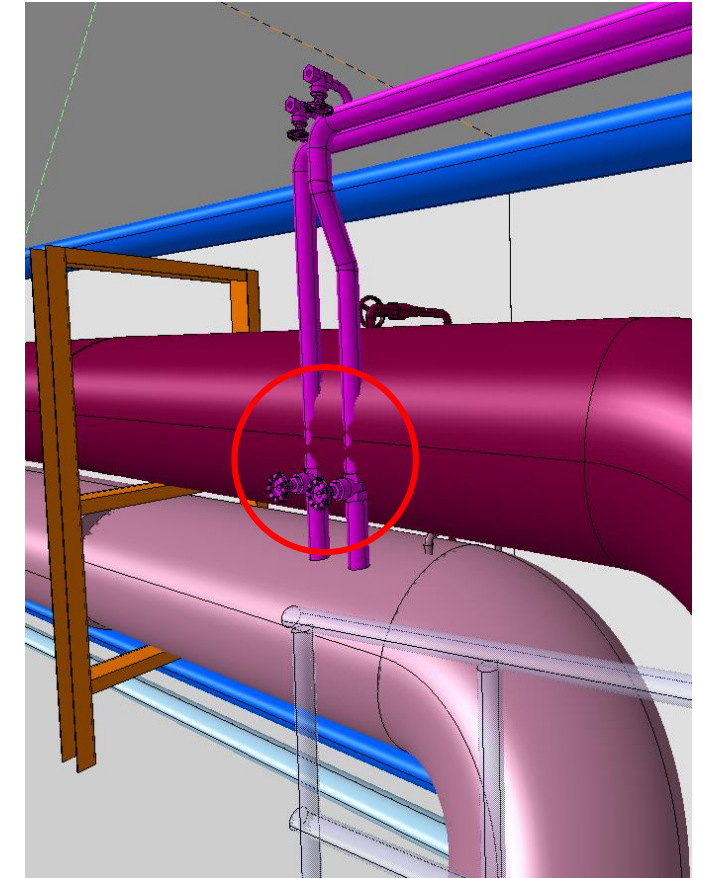
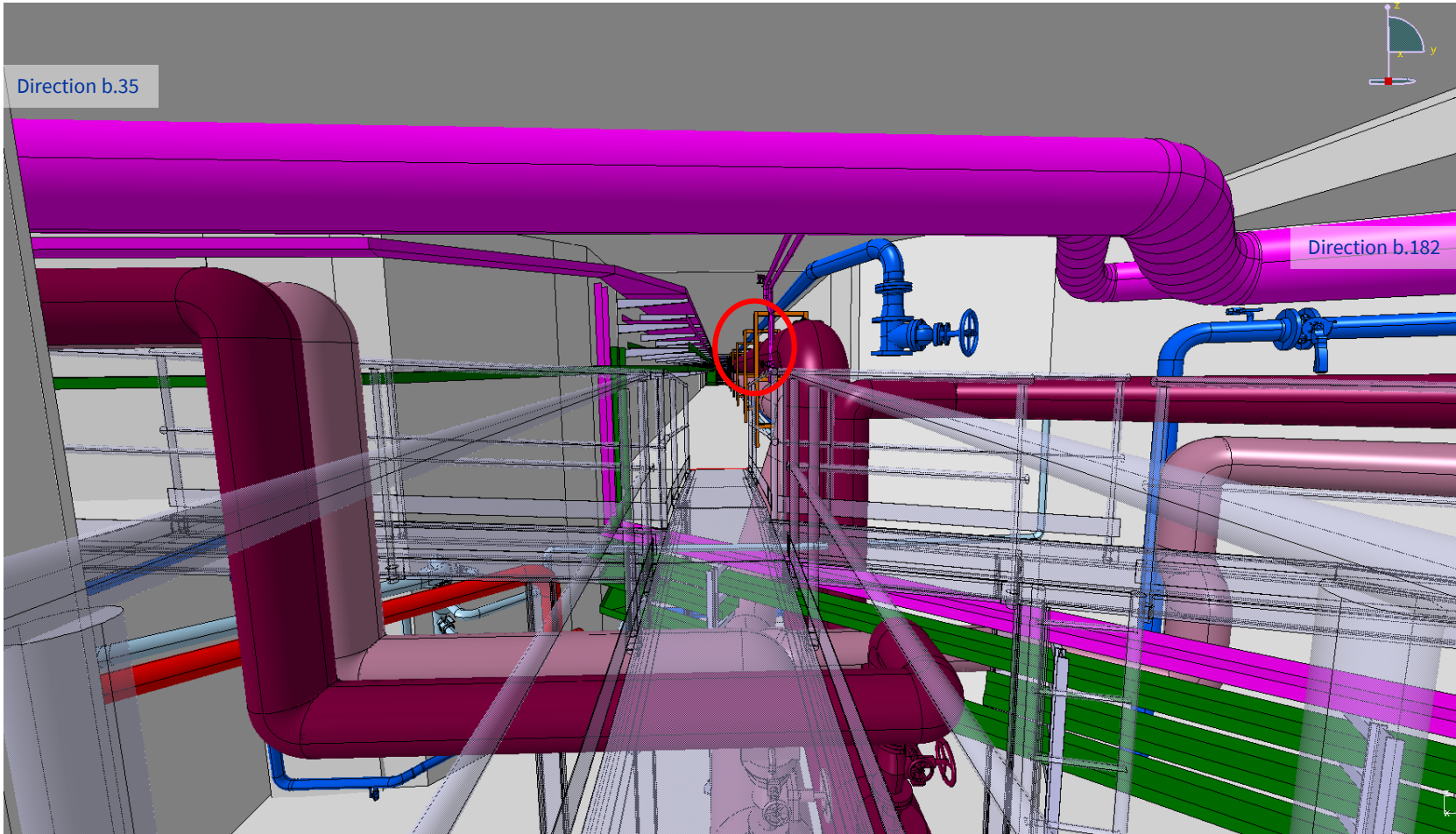
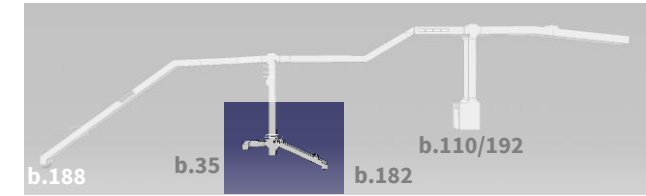

# Intégration Galerie 825

zone ouest (Partie 4) **Future Configuration en cours:**

Jonction 825 Dcum D-0030

- Tuyauterie SCE a décaler

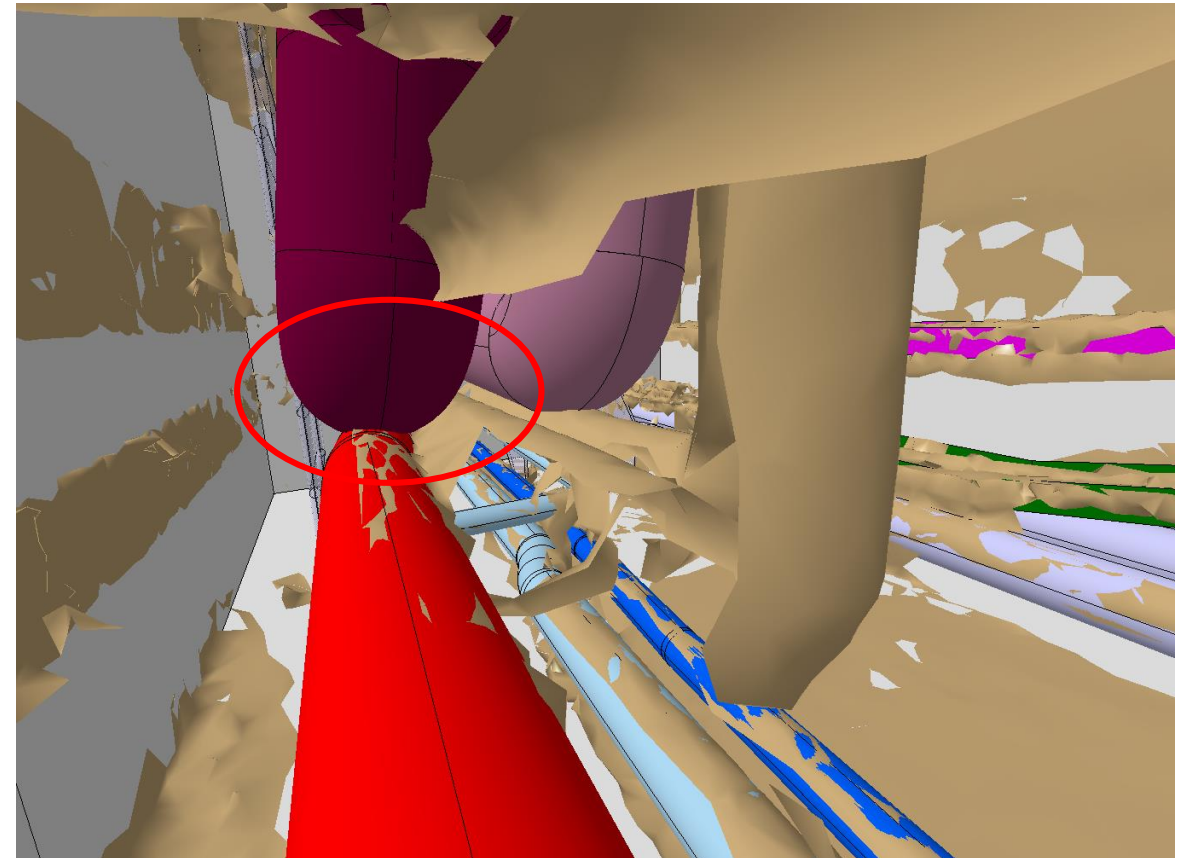
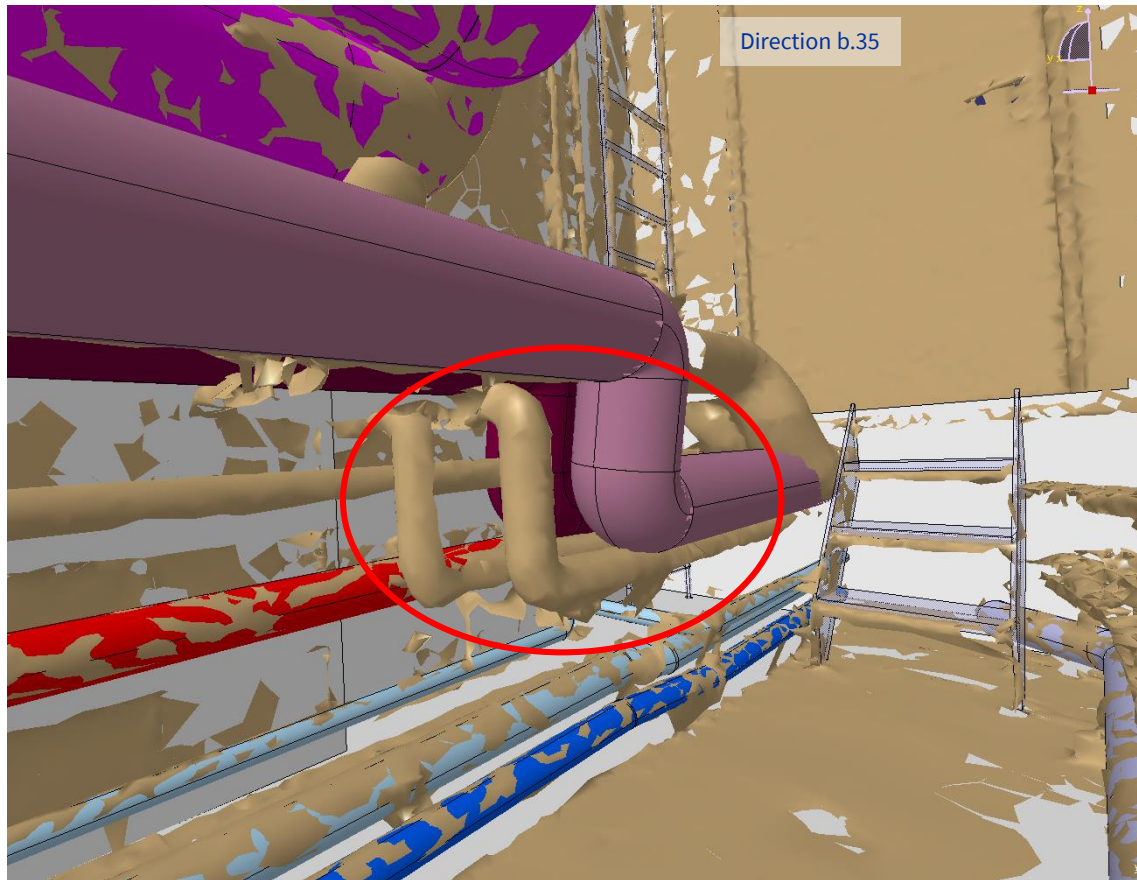
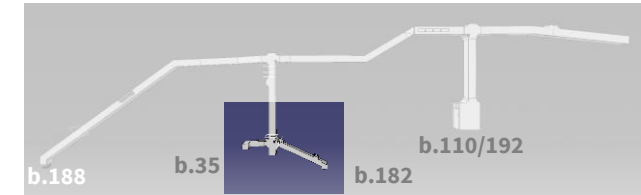

# Intégration Galerie 825

zone ouest (Partie 4) **Future Configuration en cours:**

Jonction 825 Dcum D-0030

- Interférence CV / SCE + Support SCE à rajouter

Direction b.182

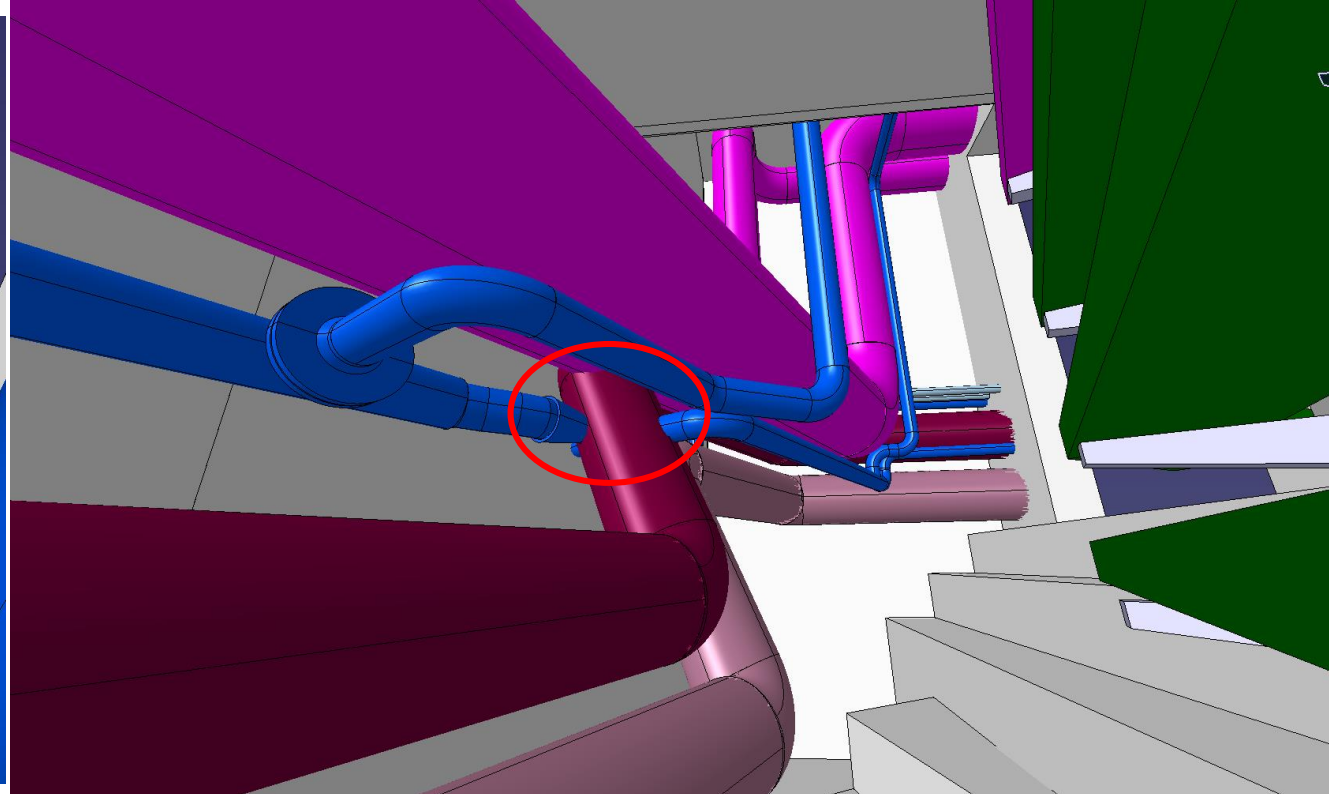
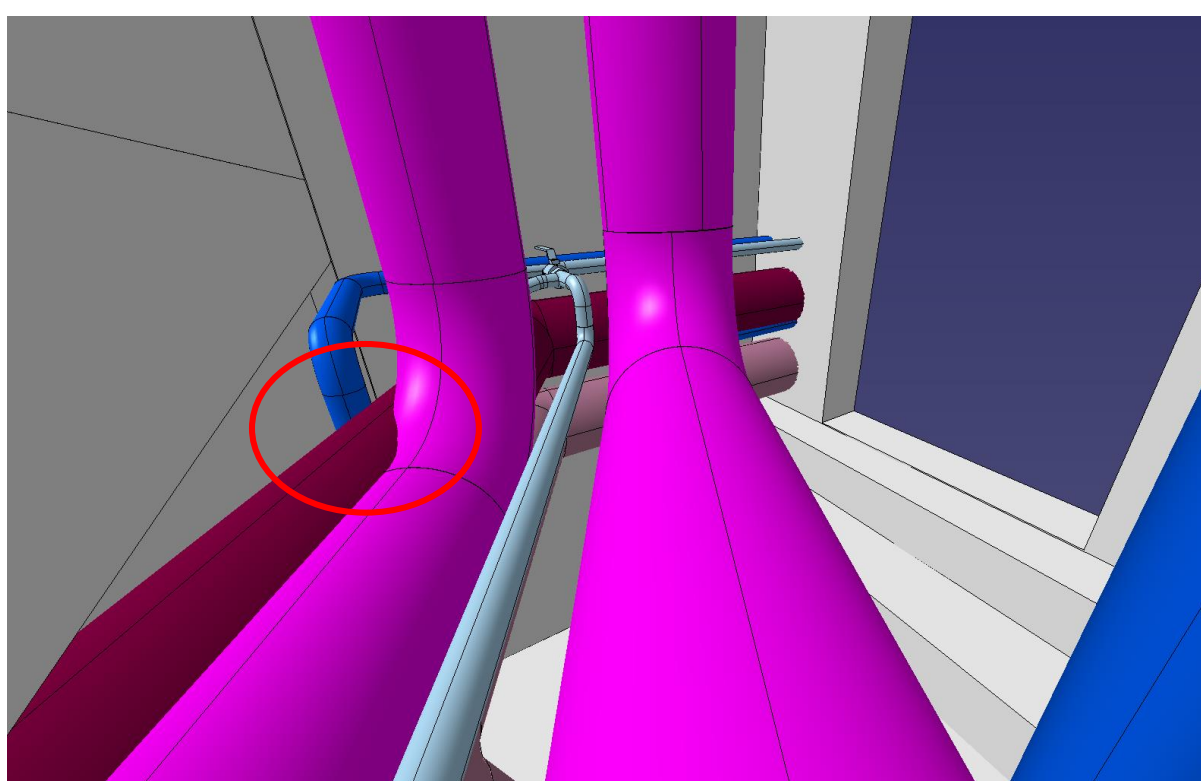
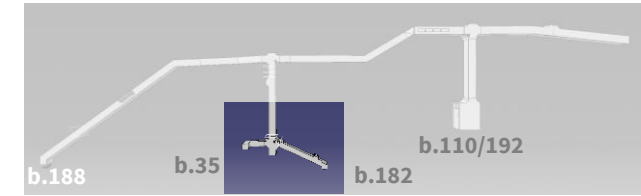

# Intégration Galerie 825

## Légende:

- document EDMS catalogue des échelles à câbles : 340478
- La couleur verte : basse tension (BT)
- La couleur turquoise : moyenne tension (MT – Réseau 18Kv)
- La couleur violet : Réseau contrôle



- Eau surchauffée aller en violet foncé
- Eau surchauffée retour en rose claire
- Eau potable
- Eau incendie
- Air comprimé
- Eau déminéralisée
- Eau glacée
- Hélium

**Merci pour votre attention**

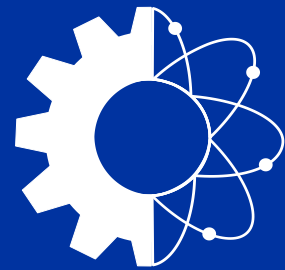

**ENGINEERING  
DEPARTMENT**

Jean-Baptiste MAYOLINI EN-ACE-INT