

# ITS3 updates

Wires will come from A side instead of flex and this wires need to be welded on the FPC in the cyss  
so new proposal for FPC C side without stripes  
same positioning on the gluing mandrel than A side  
same peek half rings

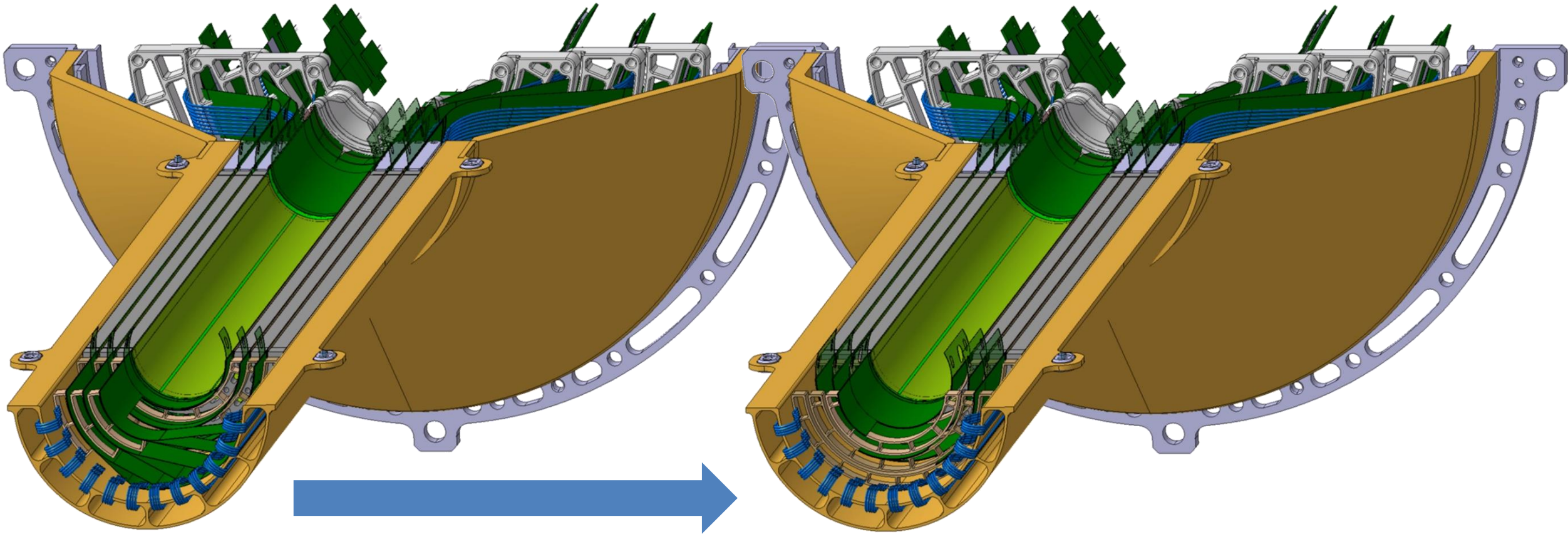

# ITS3 updates

Positioning the FPC in line with the chip and keeping it around the mandrel was not easy for the previous prototype  
Add a position and tension device to the jig, as small and simple as possible

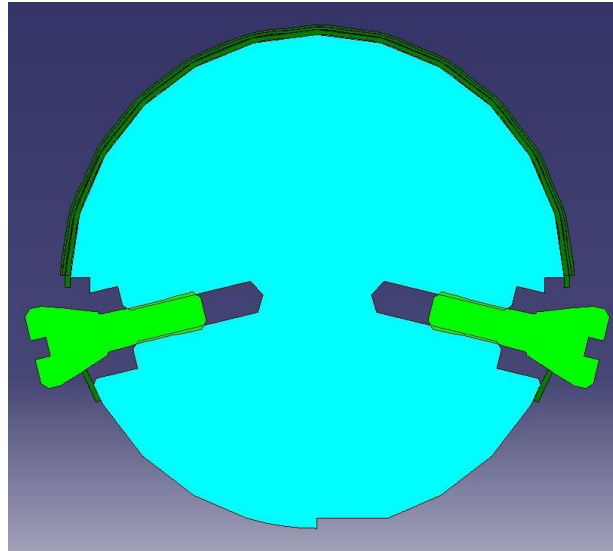
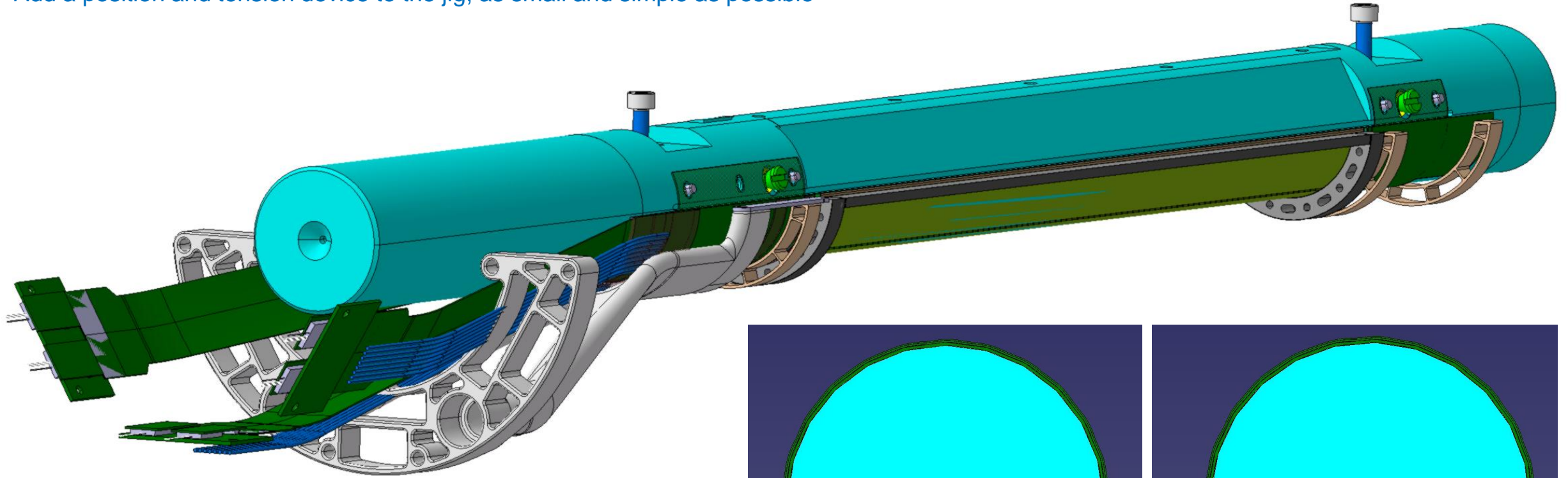

Nominal

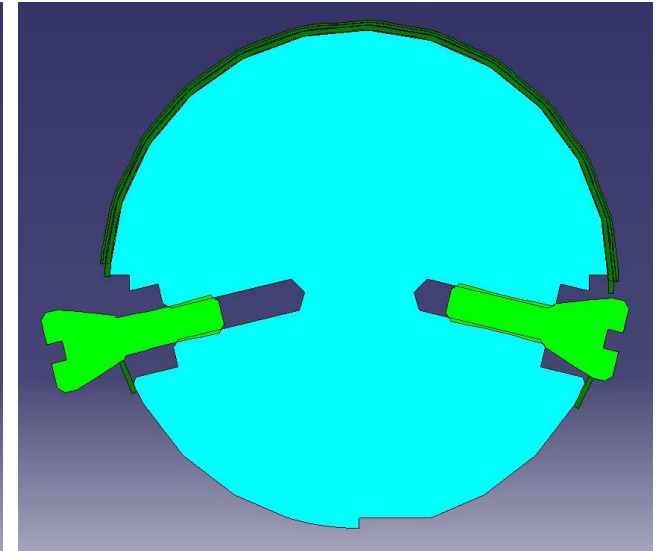

Maximum tilt ( $\pm 0,7\text{mm}$ )

# ITS3 updates

This device is compatible with previous gluing parts

I asked to workshop a piece of the mandrel and conical screws to try this concept

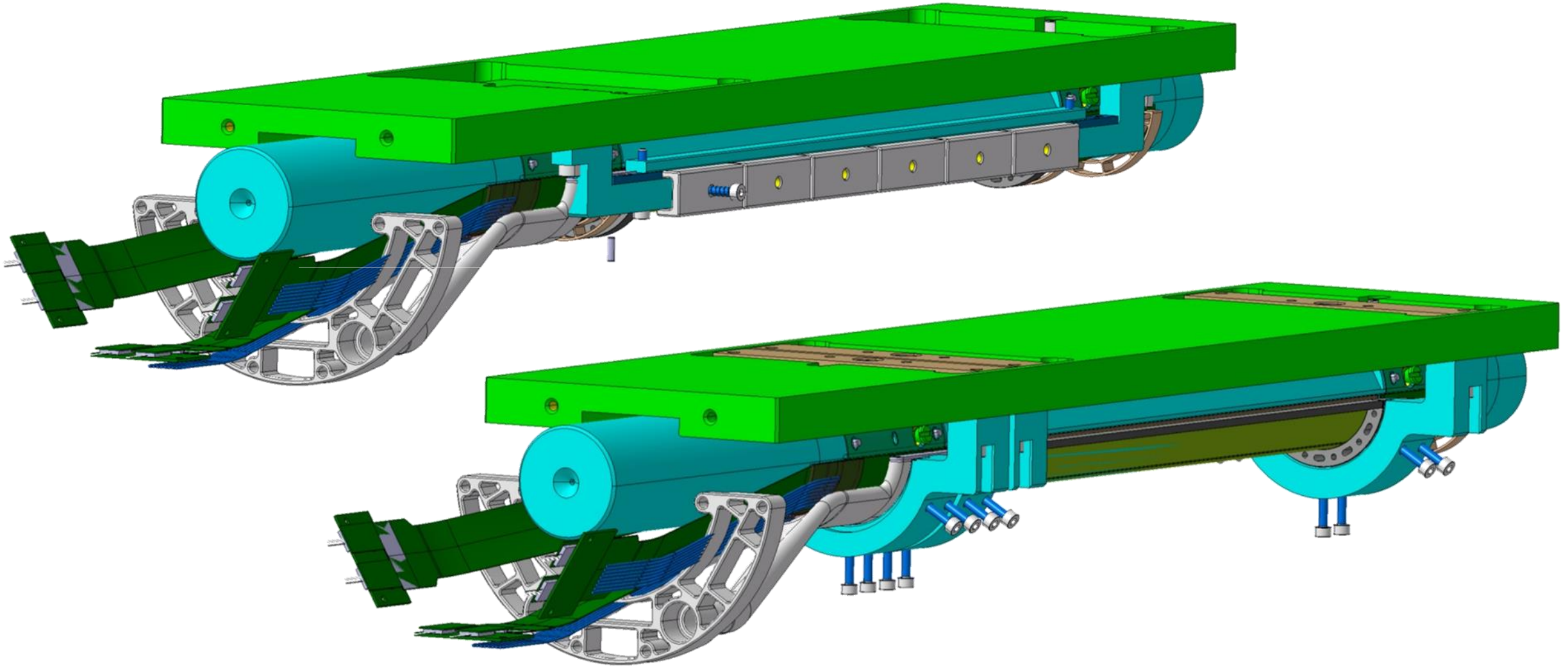

# ITS3 updates : insertion / extraction

keep working on a way to extract the ITS2 beampipe and cage without moving the TPC, which would save a lot of time

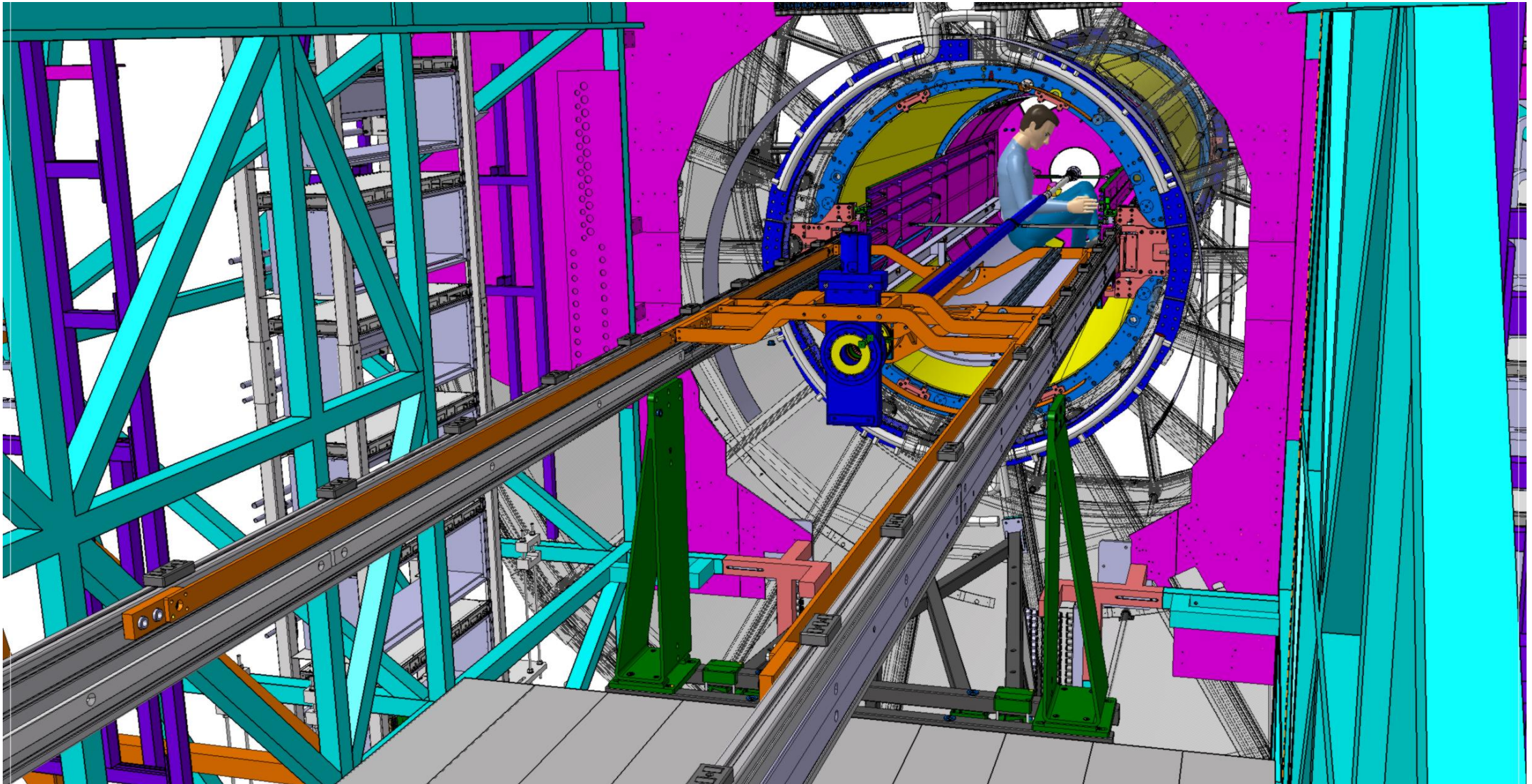

# ITS3 updates : insertion / extraction

A first chassis design is close to production and we will try different phases of the process in the cage replica

