

DIS2025

Bruce Mellado
Wits/iThemba LABS

WITS
UNIVERSITY



science & innovation

Department:
Science and Innovation
REPUBLIC OF SOUTH AFRICA

DIS'24 International Advisory Committee – 09/03/24



ROOMS DINING FUNCTIONS & EVENTS WHAT TO DO PROMOTIONS GENERAL CONTACT US

WHERE IT ALL COMES TOGETHER BEAUTIFULLY!

LAGOON BEACH HOTEL CONFERENCE CENTRE AND SPA

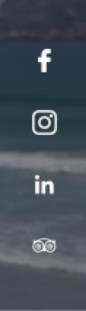

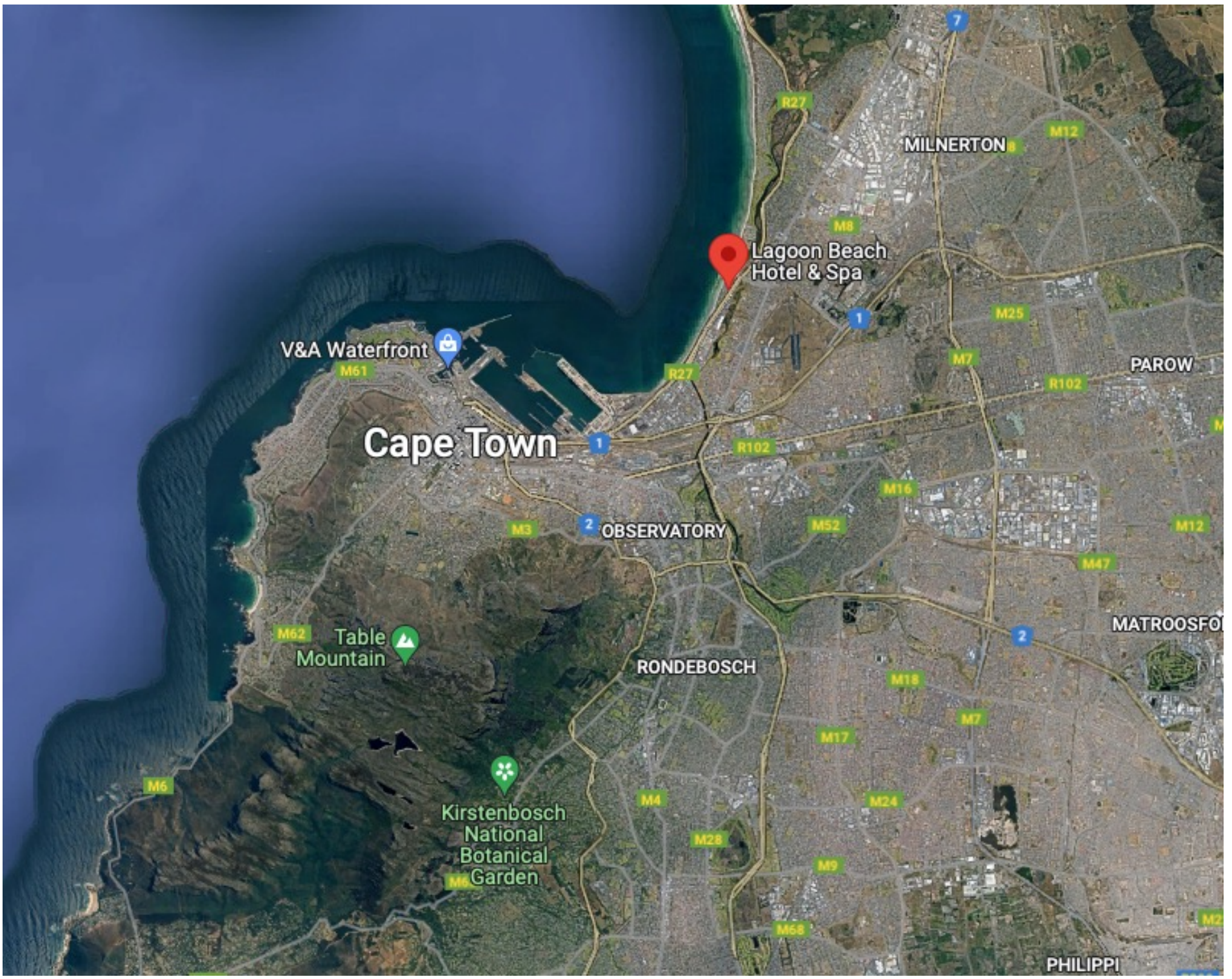

Cape Town

Lagoon Beach Hotel & Spa

V&A Waterfront

Table Mountain

Kirstenbosch National Botanical Garden

OBSERVATORY

RONDEBOSCH

MILNERTON

PAROW

MATROOSFO

PHILIPPI

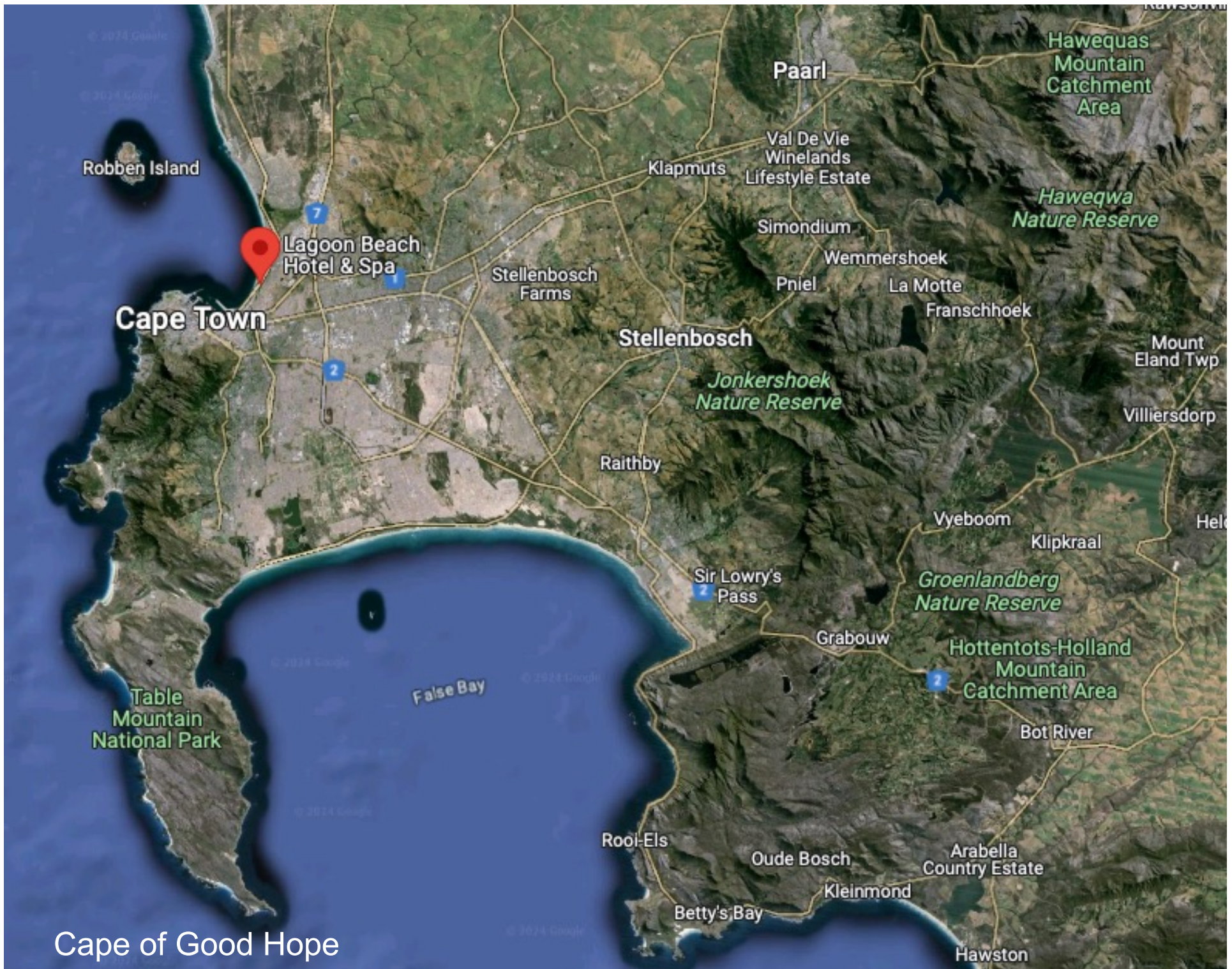

Robben Island

Cape Town

Lagoon Beach Hotel & Spa

Stellenbosch Farms

Stellenbosch

Paarl

Klapmuts

Val De Vie Winelands Lifestyle Estate

Simondium

Wemmershoek

Pniel

La Motte

Franschhoek

Hawequas Mountain Catchment Area

Haweqwa Nature Reserve

Jonkershoek Nature Reserve

Mount Eland Twp

Villiersdorp

Raithby

Vyeboom

Klipkraal

Sir Lowry's Pass

Groenlandberg Nature Reserve

Grabouw

Hottentots-Holland Mountain Catchment Area

Bot River

Table Mountain National Park

False Bay

Rooi-Els

Oude Bosch

Arabella Country Estate

Kleinmond

Betty's Bay

Hawston

Cape of Good Hope

Atlantic Suite

Host a maximum of 600 delegates. The venue can also be subdivided into two separate venues, each with their own access.

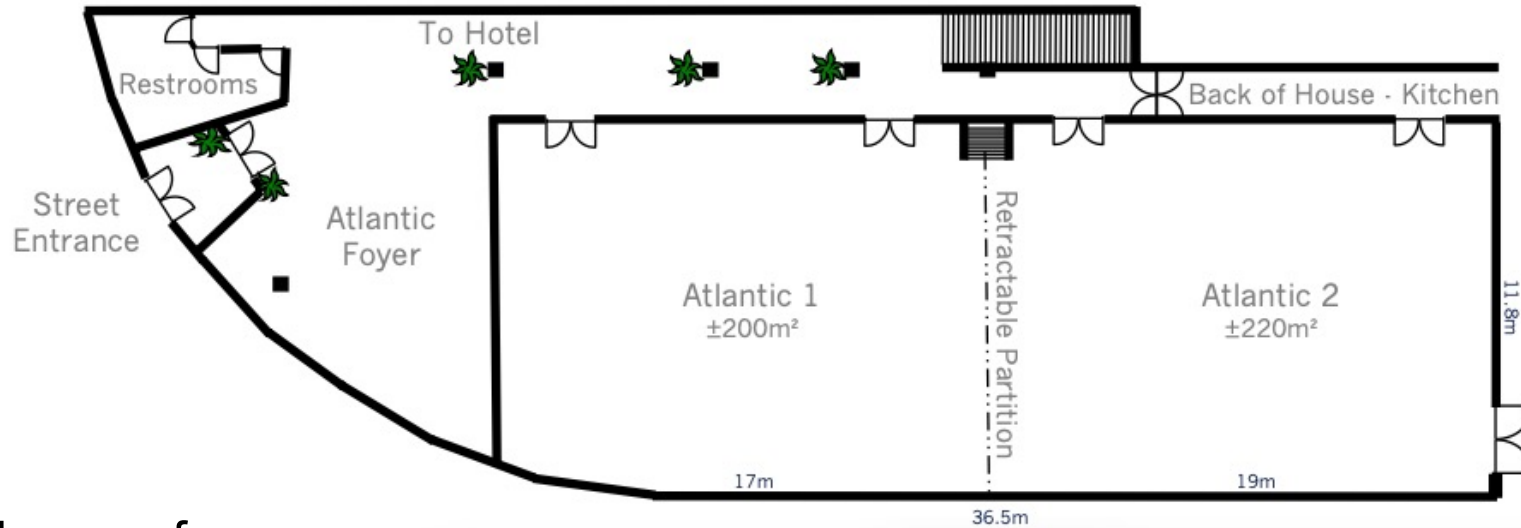

Proposed venue for plenary sessions



- Air-Conditioning
- Audio-visual equipment
- Partial Natural Light
- Dimmable Lighting
- Dividers
- Telephone Line
- Wireless Internet
- Black Out
- Vehicle access
- Draping Rails
- Wheelchair Accessible

Cinema Maximum 550	Schoolroom Maximum 350	U-Shape Maximum 150	Boardroom Maximum --	Cocktail Maximum 450
Banquet Maximum 350	Banquet with Stage/ Dance Floor Maximum 280	Cabaret Maximum 210	Length & Width 36.5 x 11.8	Height 3.8

Courtyard Suite

Host a maximum of 160 delegates. The venue can also be subdivided into two separate venues with their own access

Sample of room for parallel sessions

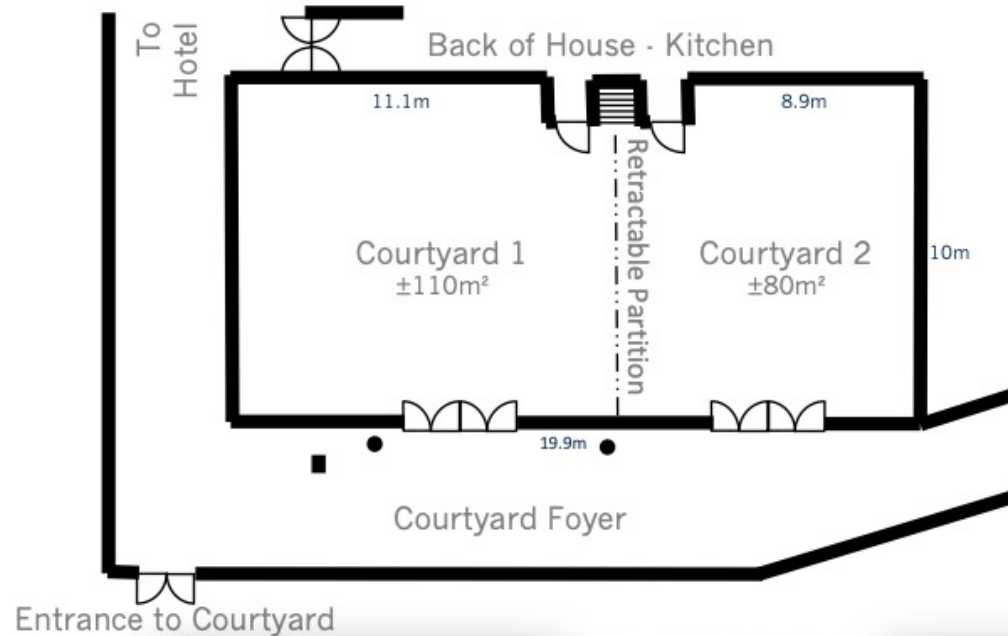

- Air-Conditioning
- Audio-visual equipment
- Dimmable Lighting
- Dividers
- Telephone Line
- Wireless Internet
- Black Out
- Wheelchair Accessible

Cinema Maximum 160	Schoolroom Maximum 100	U-Shape Maximum 50	Boardroom Maximum 40	Cocktail Maximum 150
Banquet Maximum 130	Banquet with Stage/dance floor Maximum 120	Cabaret Maximum 60	Length & Width 19.9 x 10	Height 3.42

Lagoon View

Sliding doors that lead to a patio with direct access to the beach. This venue can host a maximum of 100 guests.

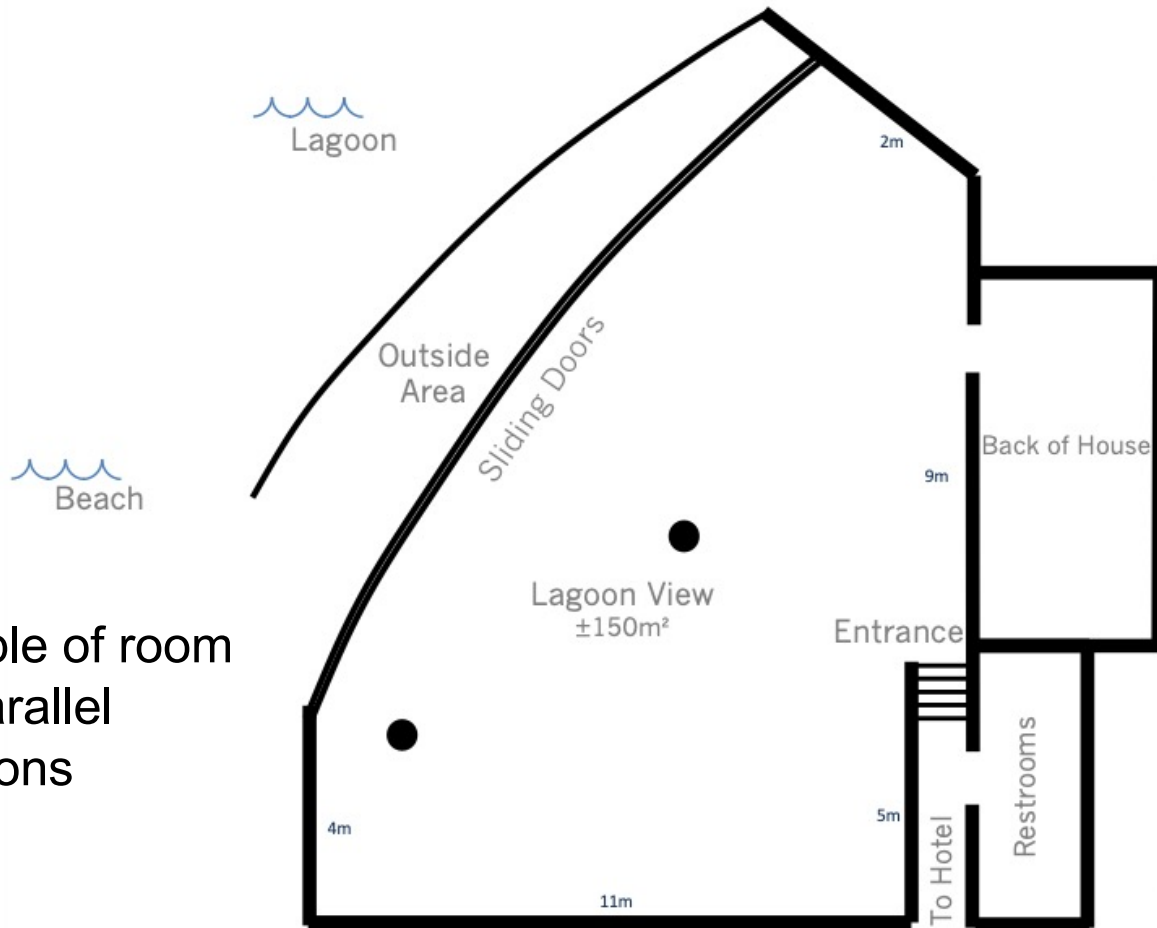

Sample of room for parallel sessions

- Air-Conditioning
- Audio-visual equipment
- Lights
- Natural Light
- Telephone Line
- Wireless Internet
- Black Out

Cinema Maximum 100	Schoolroom Maximum 40	U-Shape Maximum 35	Boardroom Maximum 20	Cocktail Maximum 100
Banquet Maximum 70	Banquet with Stage/dance floor Maximum 50	Cabaret Maximum 30	Length & Width 14 11	Height 3.46



Conference package with 1 plenary and 6 parallel → 400-450 Eur

This includes:

INCLUDED IN FULL DAY CONFERENCE PACKAGE (HALF DAY PACKAGE LESS 1 X TEA BREAK)	
* Tea, coffee & snack on arrival	* A4 Notepad & pen
* Tea, coffee & snack at mid-morning	* 2 x 250ml bottles atmospheric water per delegate
* Tea, coffee & snack at mid-afternoon	* Free uncapped Wi-Fi
* Lunch (3-course Chef's Choice)	* Projector screen (16:9 Ratio)
* 1 x Soft drink with lunch per delegate	* Flipchart/w hiteboard with markers
* Room hire for main conference	* Data projector (4.5K) and cabling
* Parking (subject to availability)	* PC Audio (for sound presentations)

Accommodation in Hotel (4*) ~100 Eur a night

Cheaper options available around the hotel.

Dinners are offered at the hotel's restaurant.

Option to Uber to Cape Town's Marina (3.5-5 Eur per ride)

Dinners cost 10-30 Eur depending on restaurant and amount of alcohol

Ride to and from the airport with Uber is 10-15 Eur each way

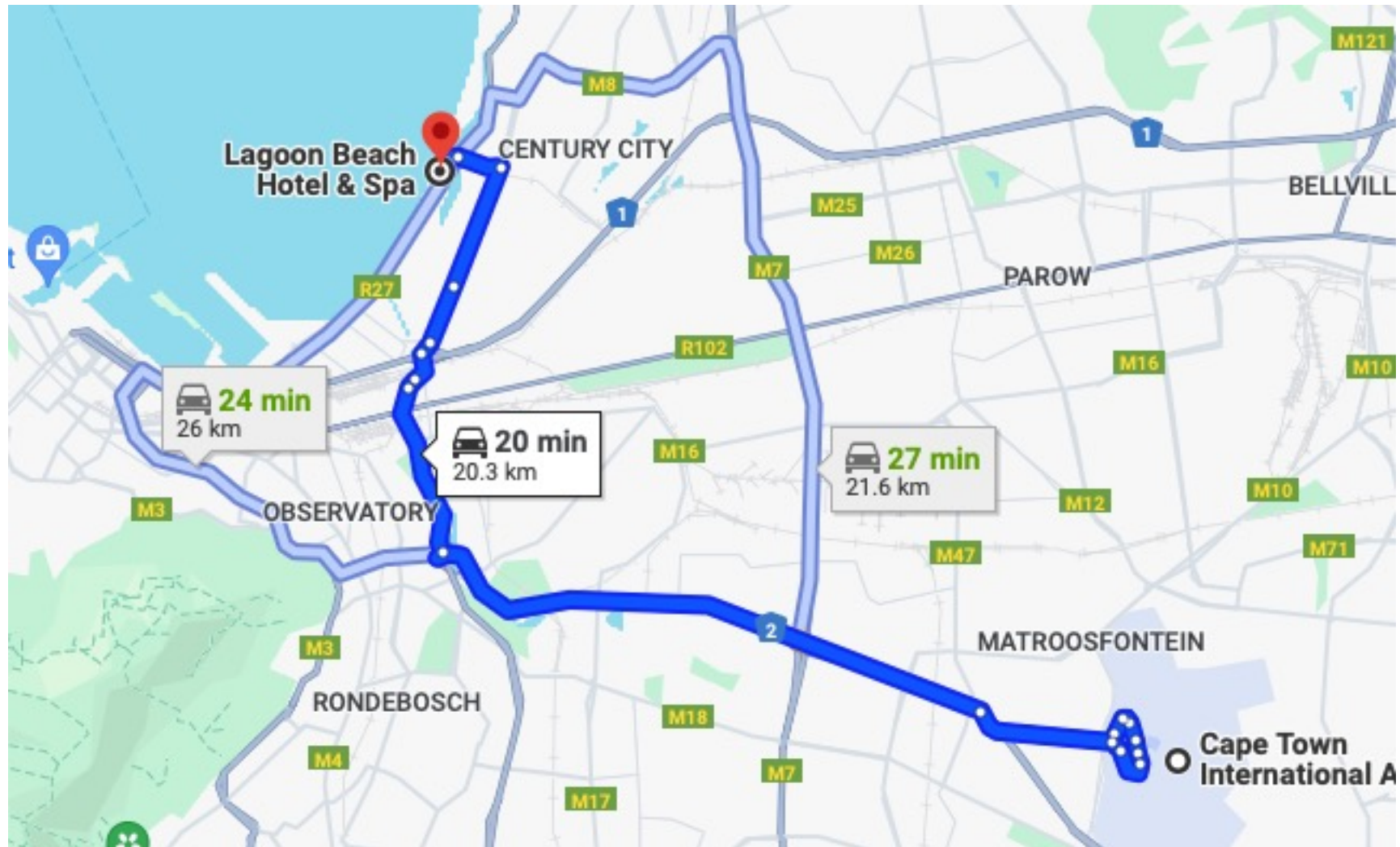

Dates

- ❑ **Need to decide very soon about the exact dates, with two candidate weeks:**
 - ❑ **March 24th – 28th**
 - ❑ **March 31st – April 4th**