



BDF Trolley Roller skates

Jean-Louis Grenard, Christophe Mucher - CERN

18-8-2023

Context

New target station for a new experiment

Time frame:

- Project approval 2024
- Detail engineering 2022 -> 2026
- Mock-up installation ~2027
- Final installation ~2029

Trolley

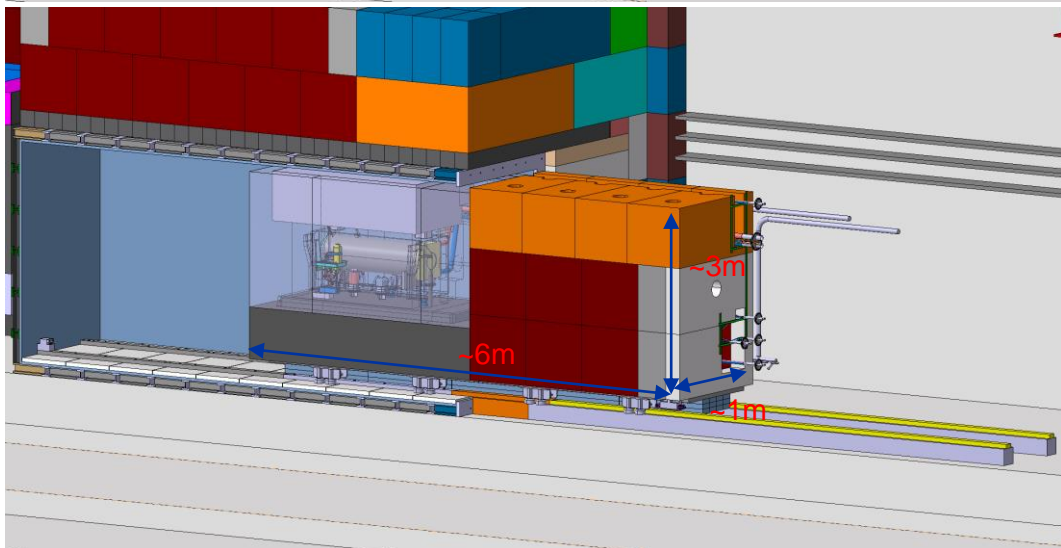
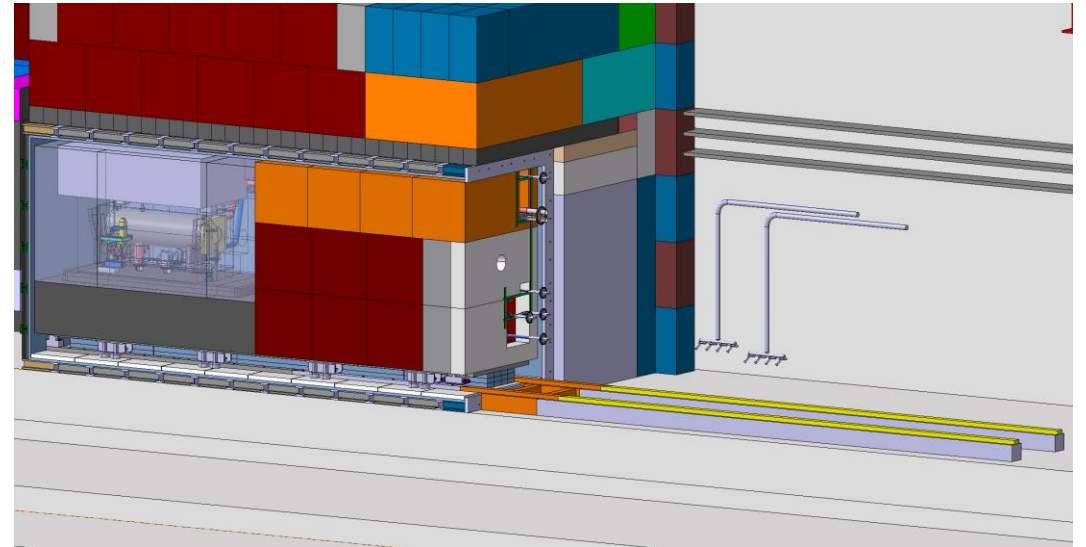
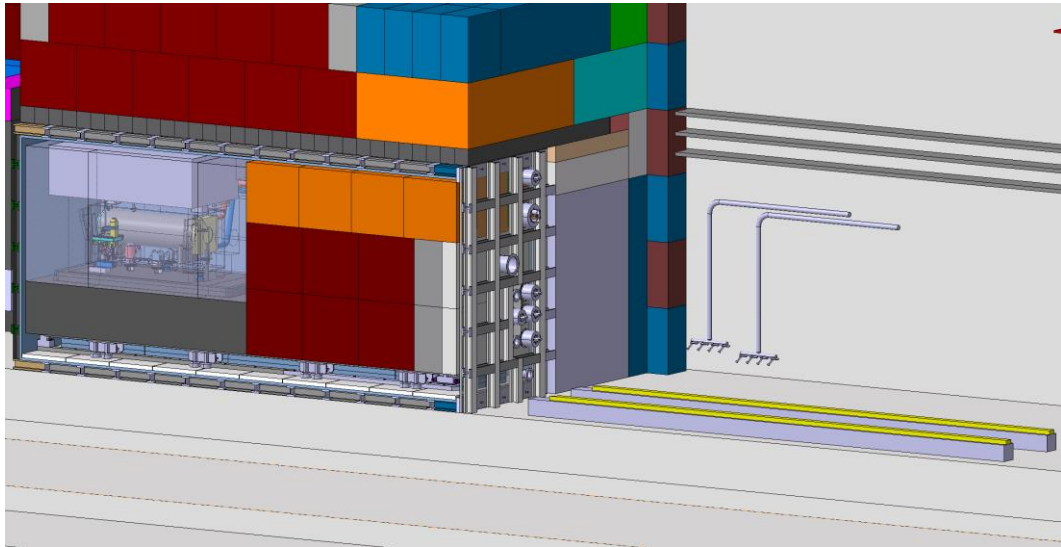

Trolley – constrains

- During operation in primary vacuum
- During maintenance in an industrial environment (possibly some dust)
- Potential presence of water (in case of a water leak)
- High level of radiation MGy
 - No plastics
- Total weight to be moved ~200t

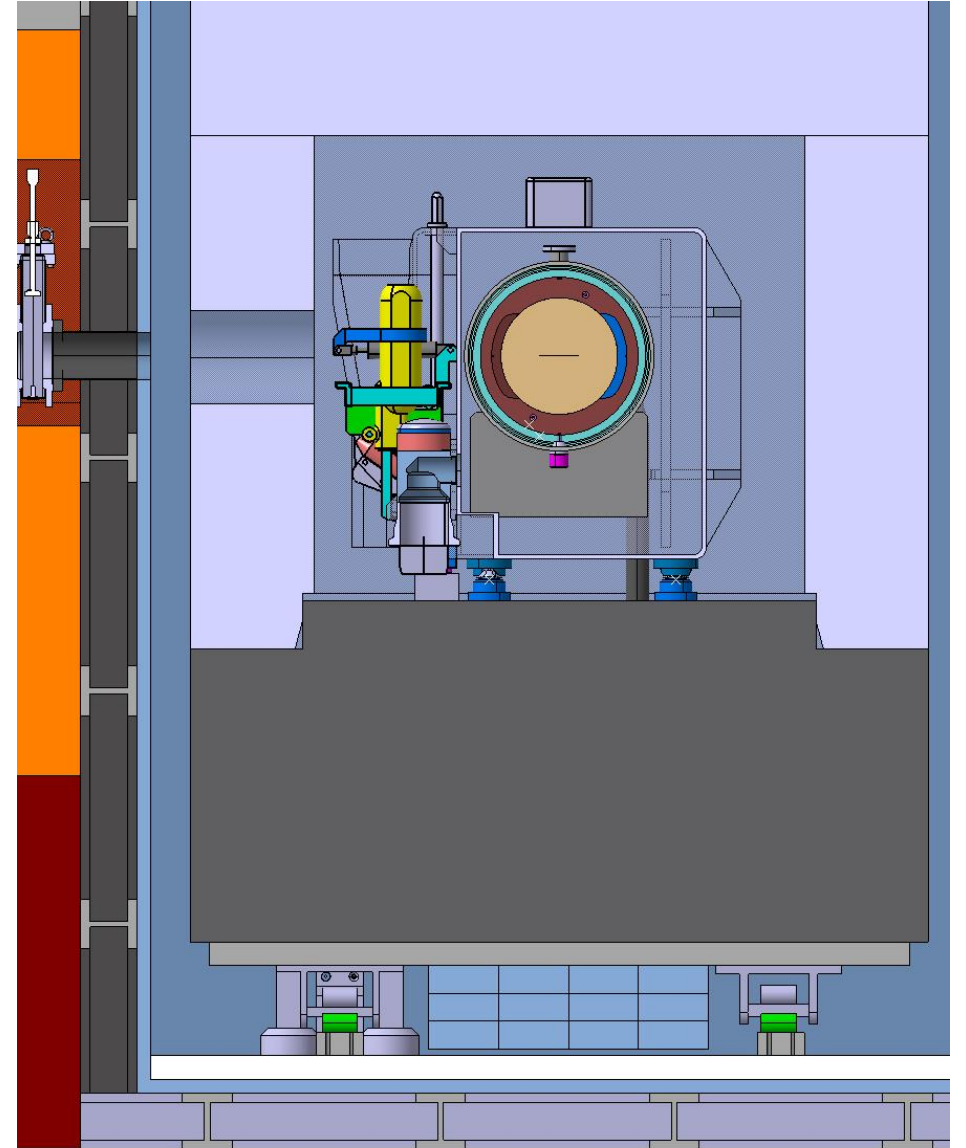

List of questions

- Do you have full stainless-steel constructions?
- Any typical application of full stainless-steel design?
- If we would like to buy a prototype do you have an existing design?
 - Qualification within our environment
- What mechanical tolerances could you achieve with your design?
- Are they bearings on the guide wheels?
- What are the requirement (hardness, tolerances) for the rails?



home.cern