

UR15 REGISTRES DE DESENFUMAGE 3D / SCAN

Claudia Delgado

16/08/2024

Registres A

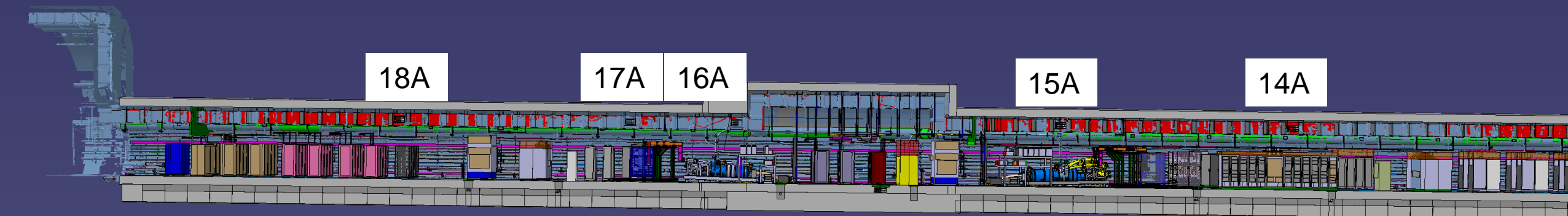
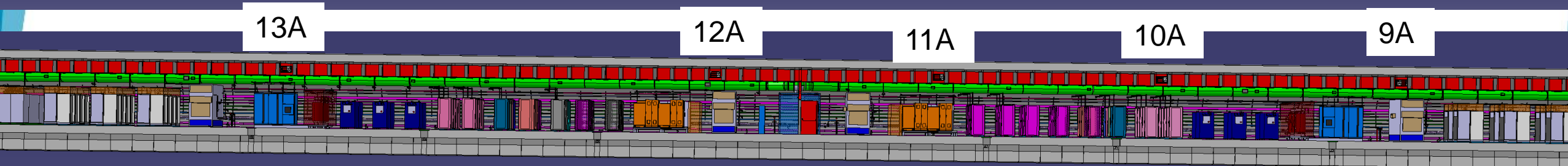

Registres B

1B

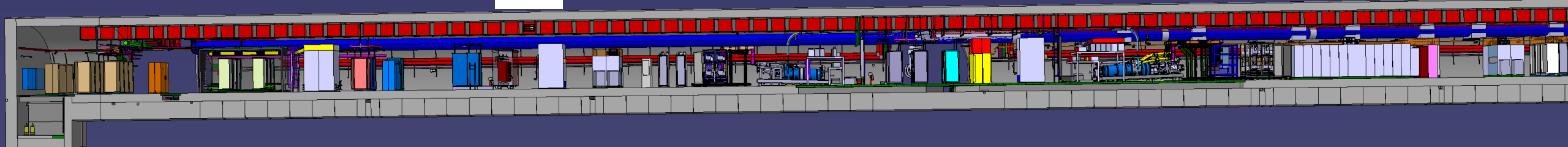

2B

3B

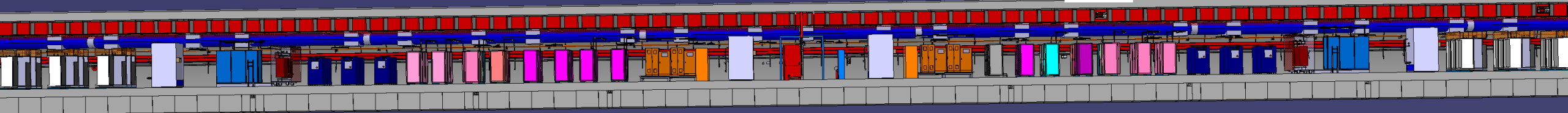

4B

5B

6B

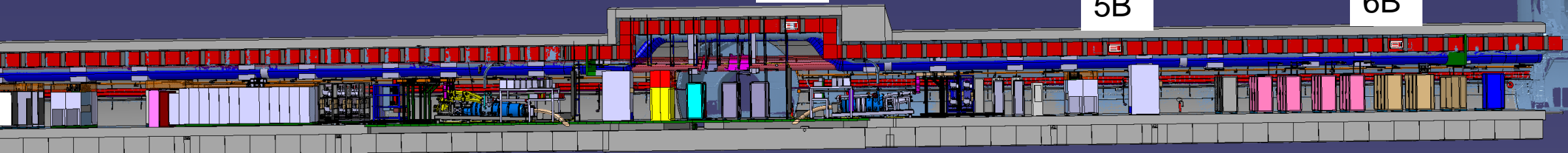

Registre 1A

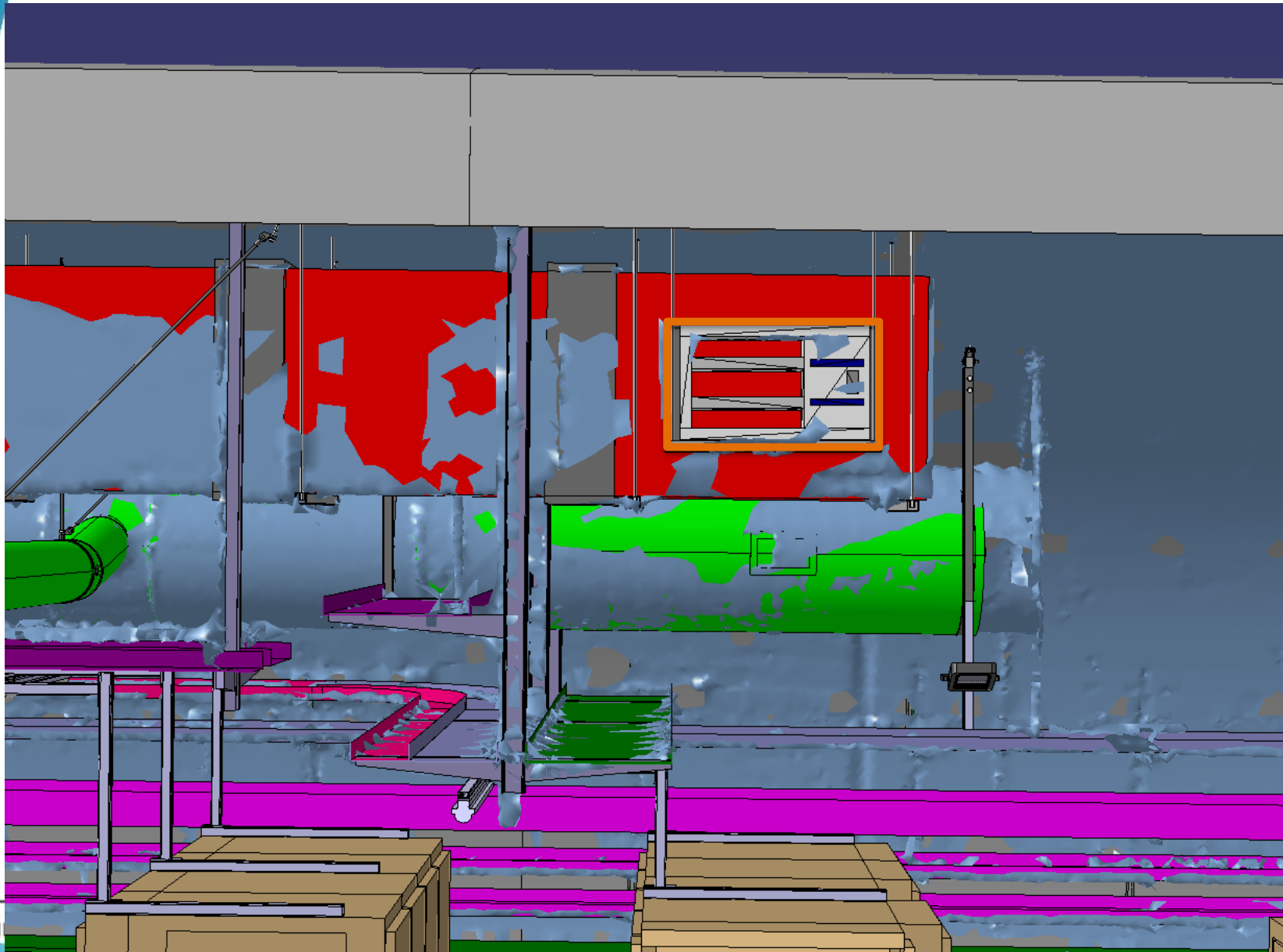

No conflict

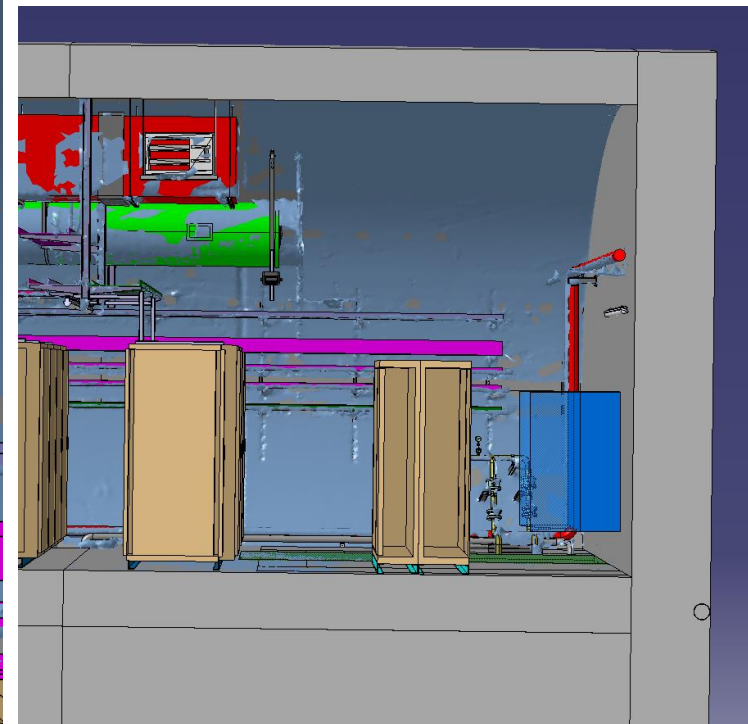

Registre 2A

No conflict



Registre 3A

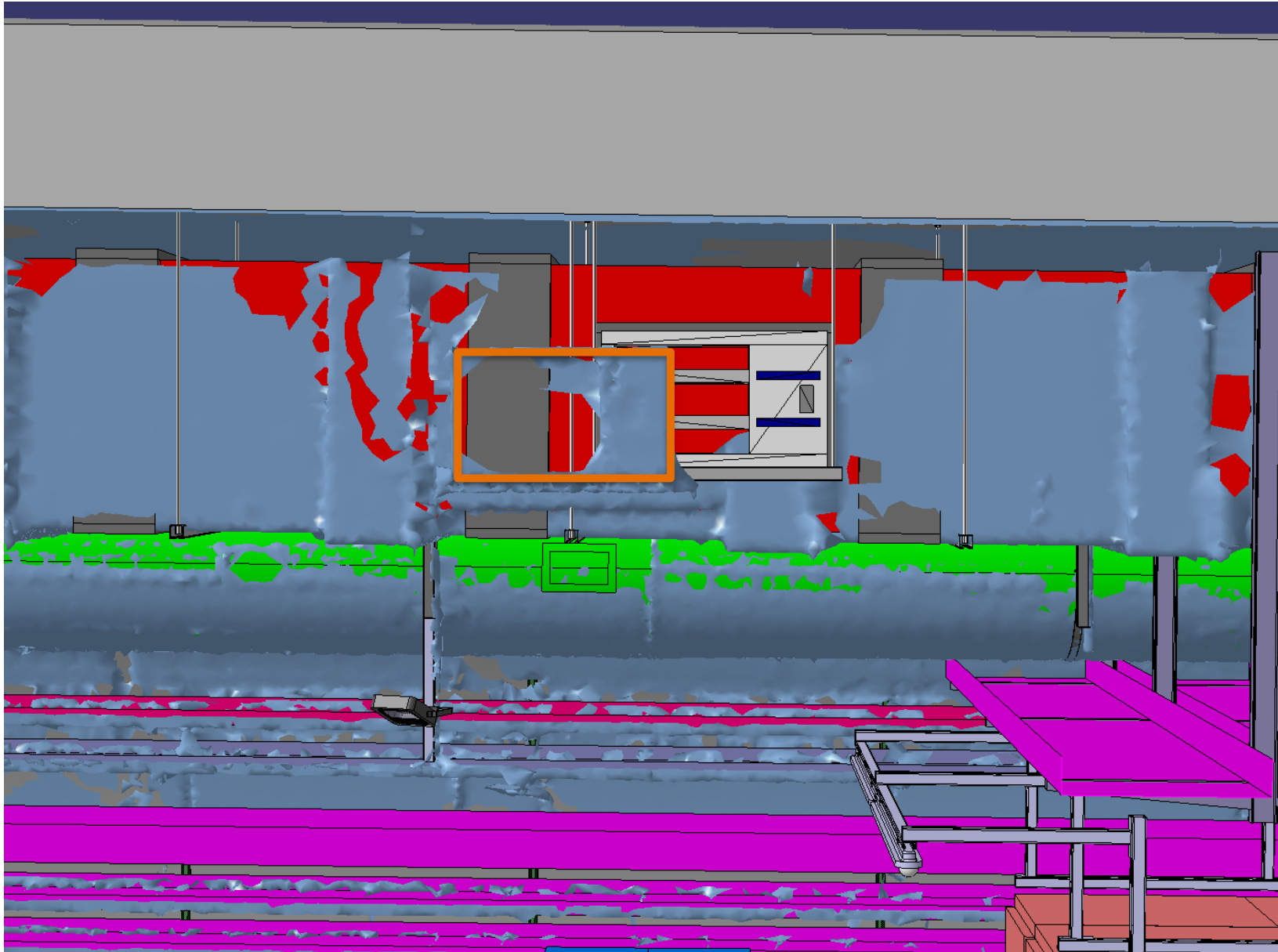

No conflict

Registre 4A

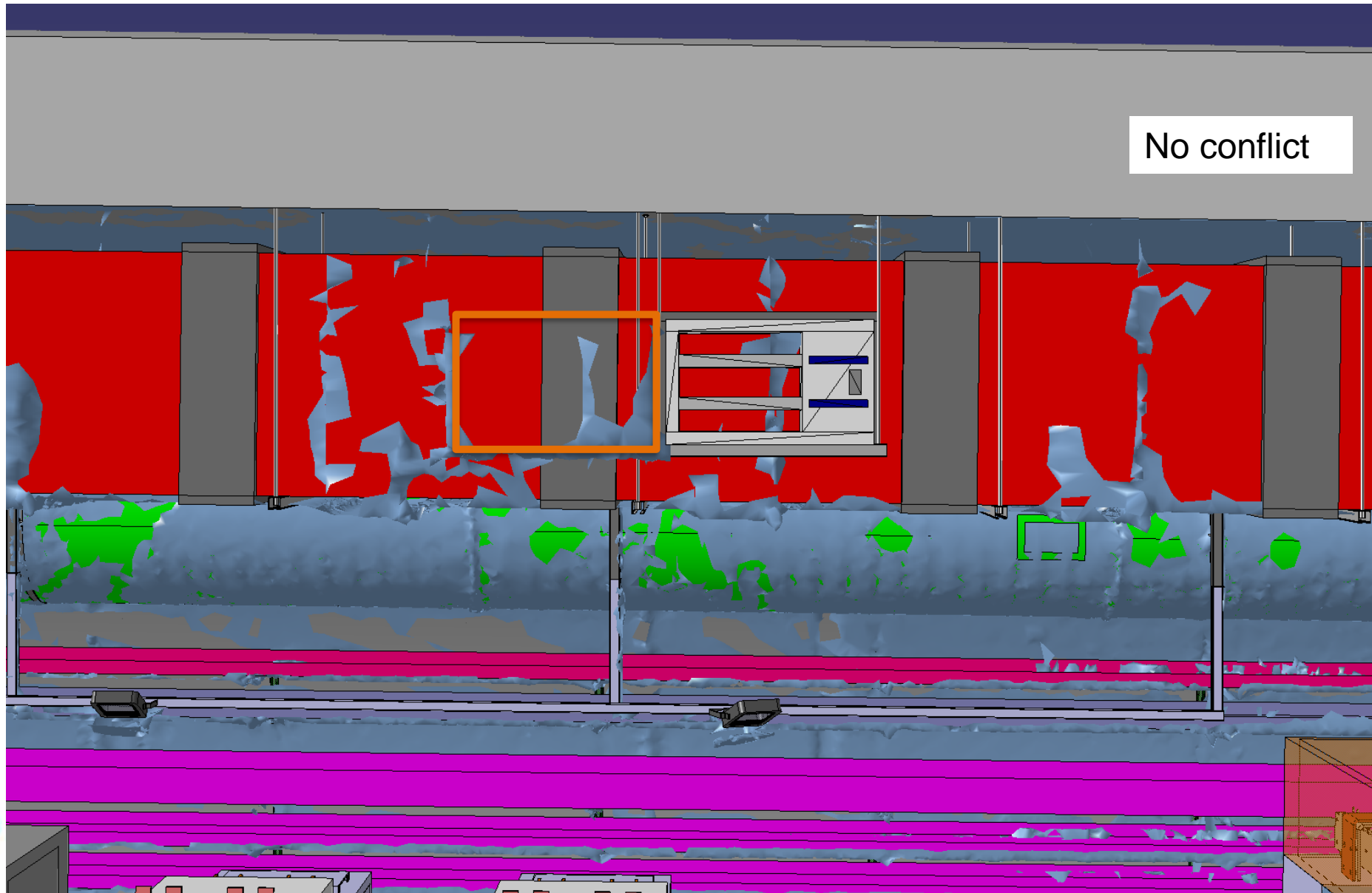

Registre 5A

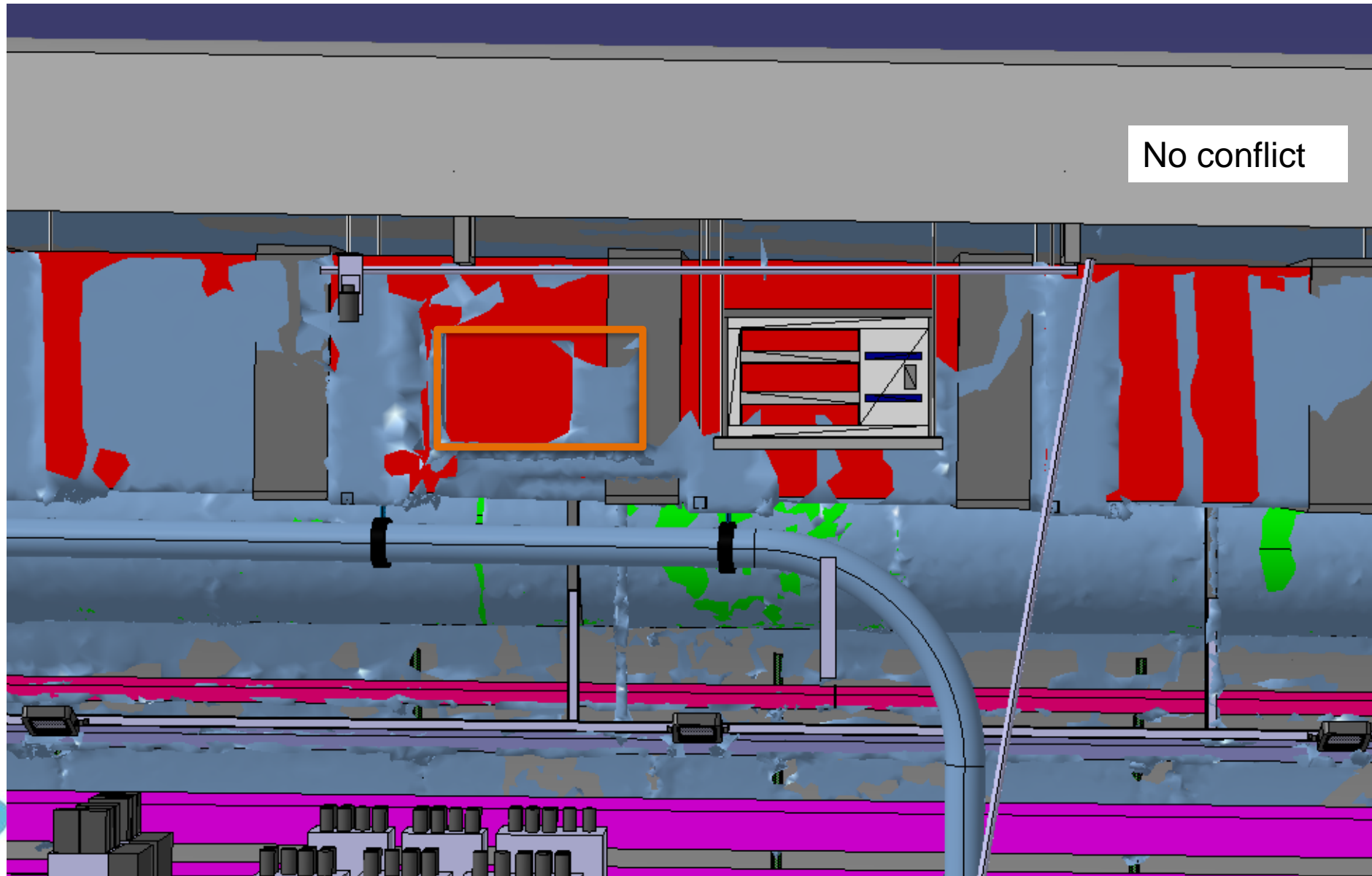

Registre 6A

Pas de conflit, mais le support sera trop proche de celui du registre.

Solution proposée :
Déplacer le support sur le côté

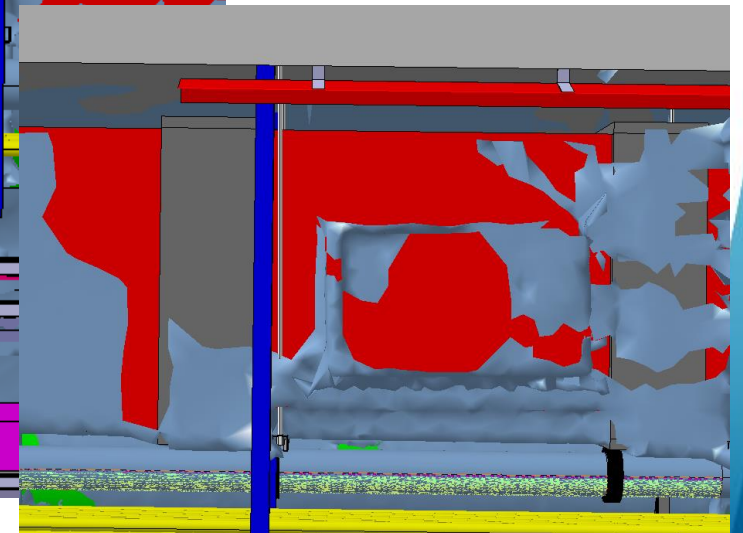
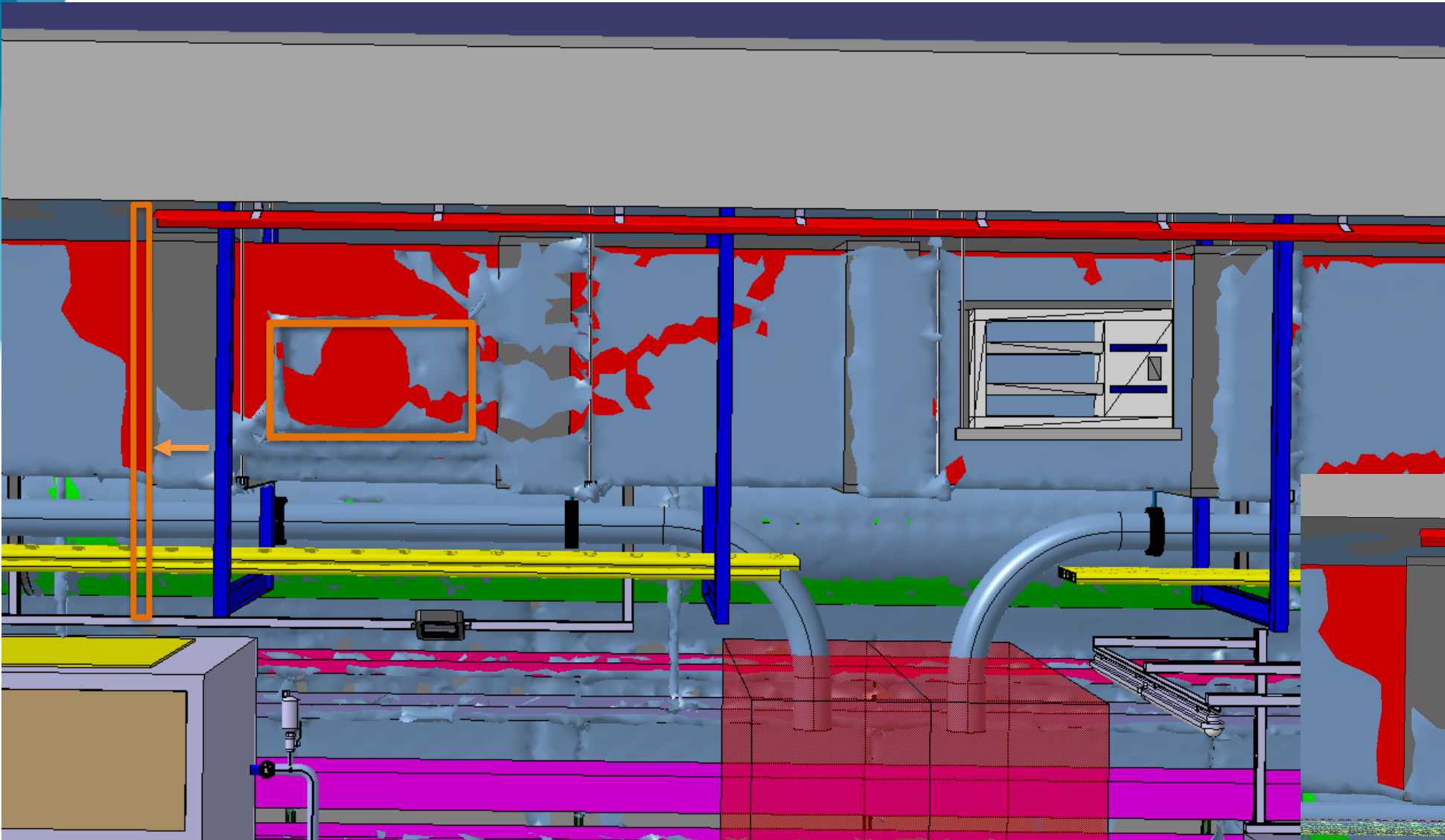

Registre 7A

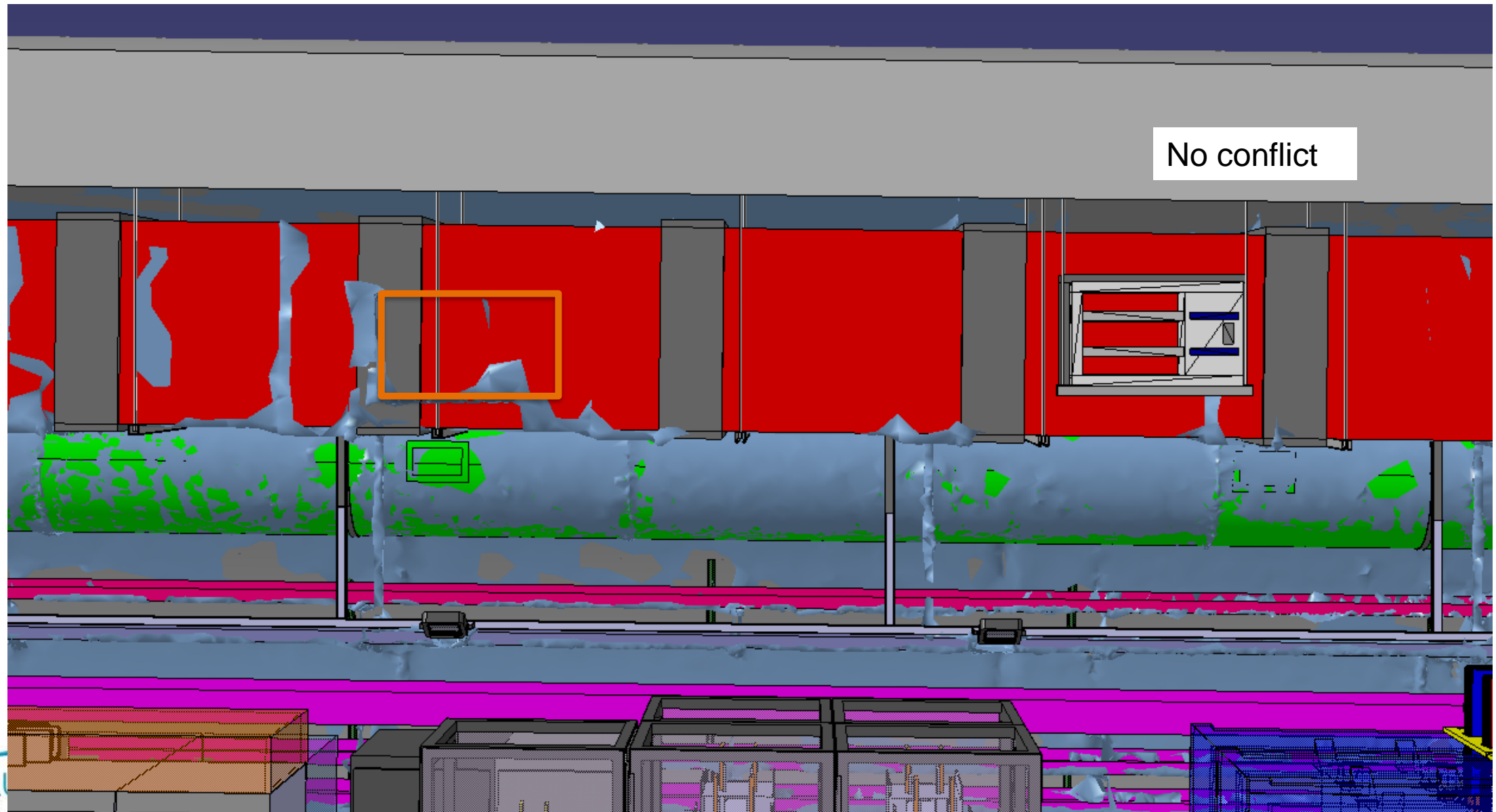

Registre 8A

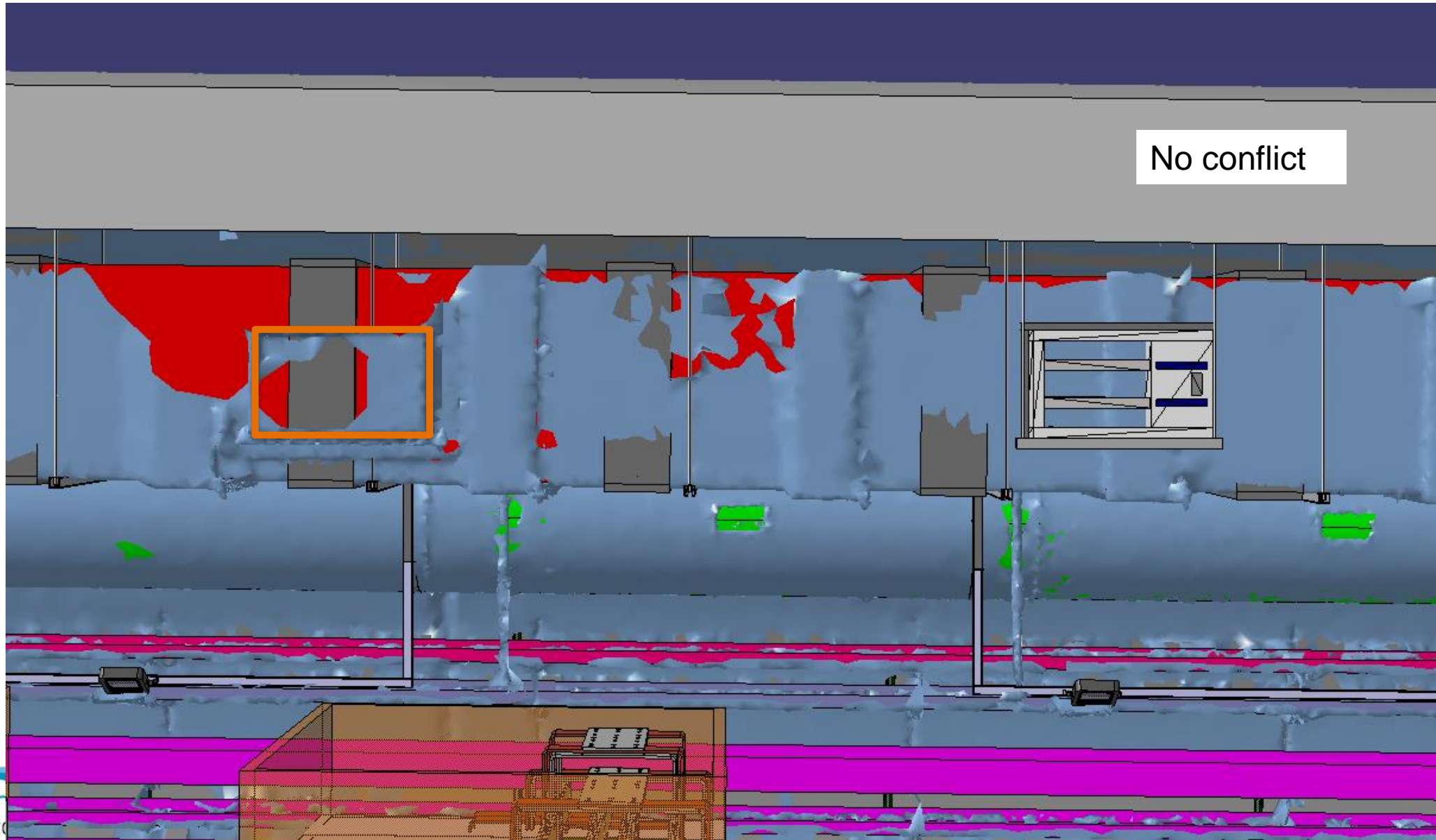

Registre 9A

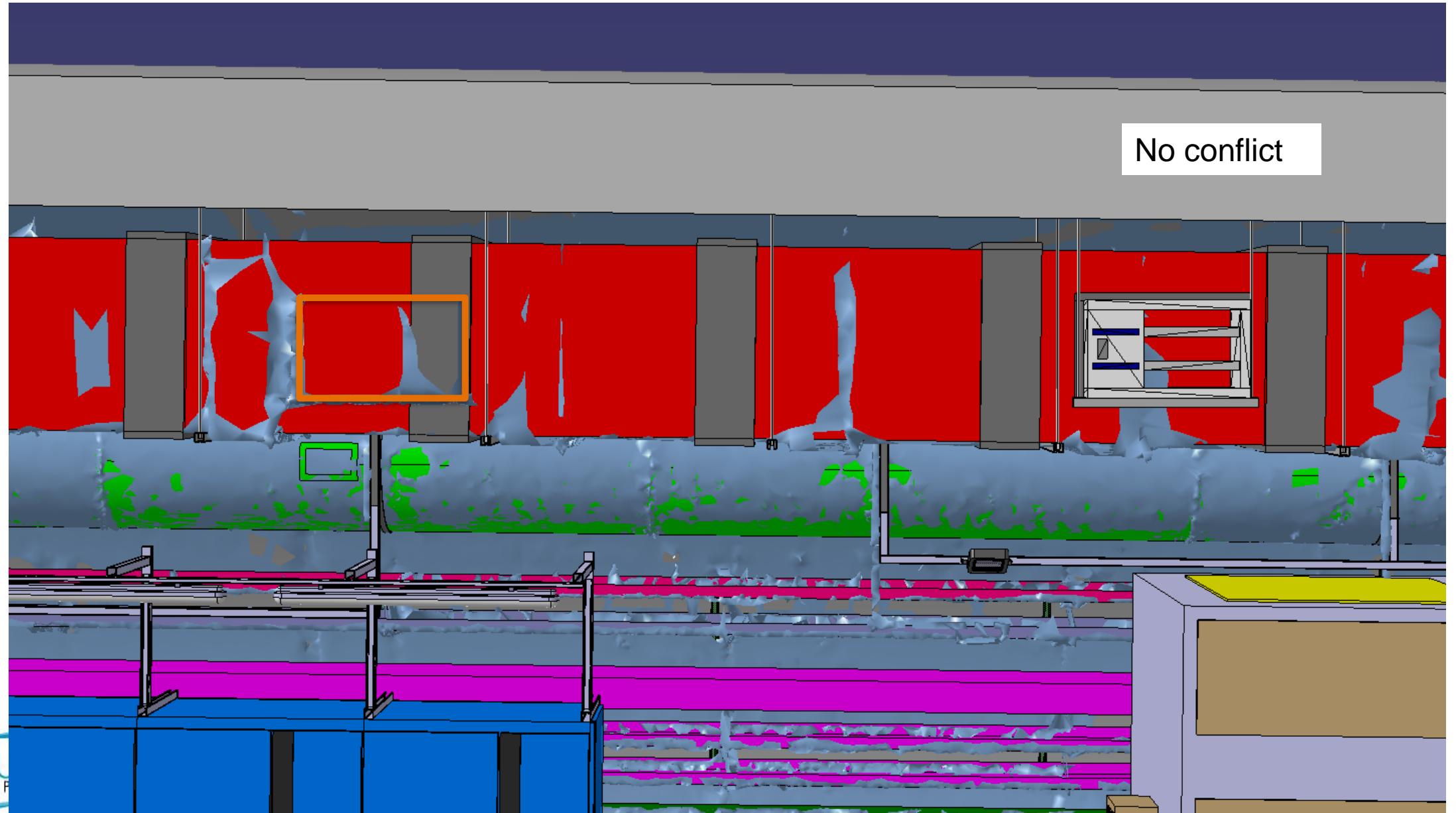

Registre 10A

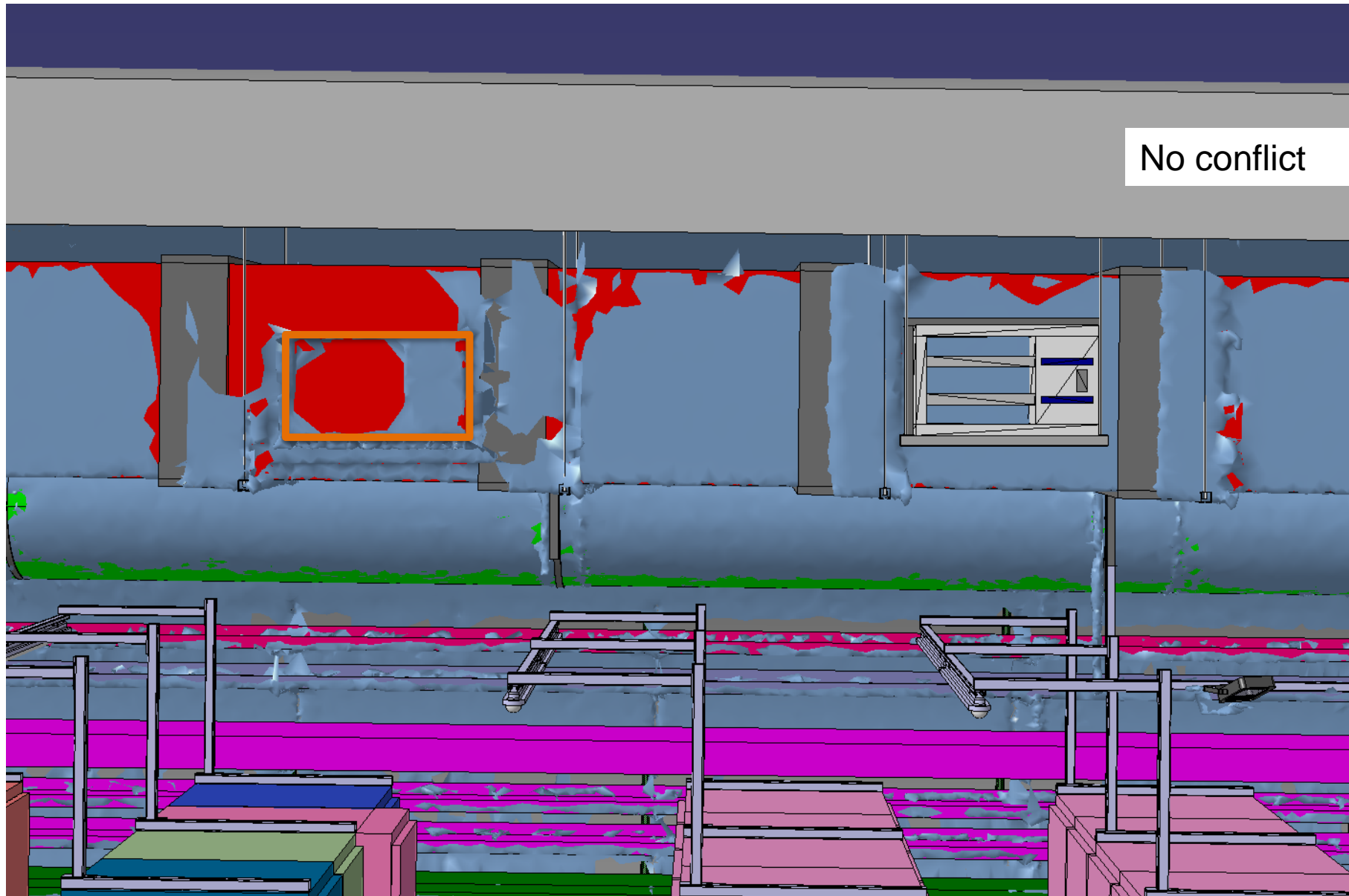

Registre 11A

No conflict

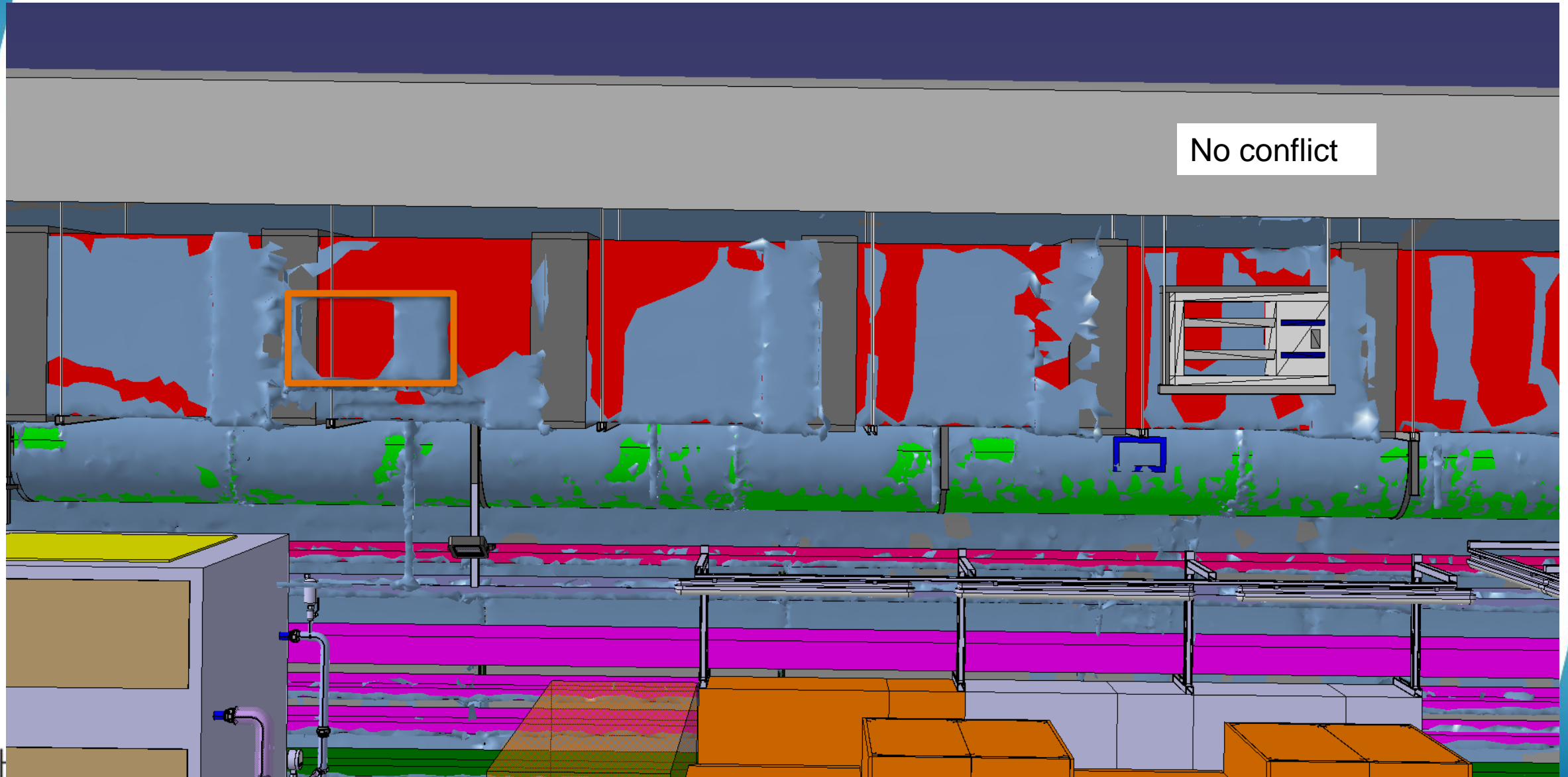

Registre 12A



Registre 13A

No conflict

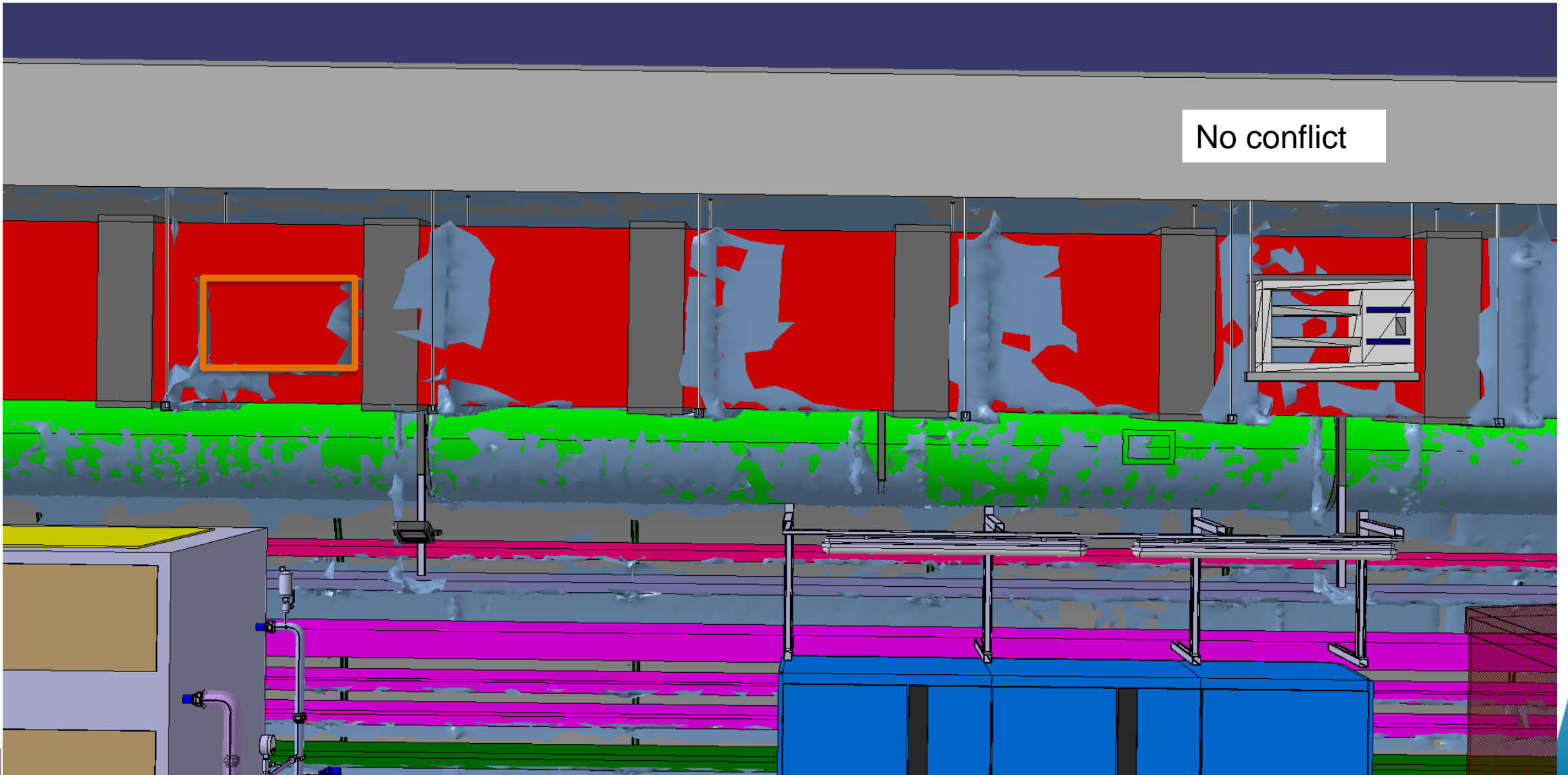

Registre 14A

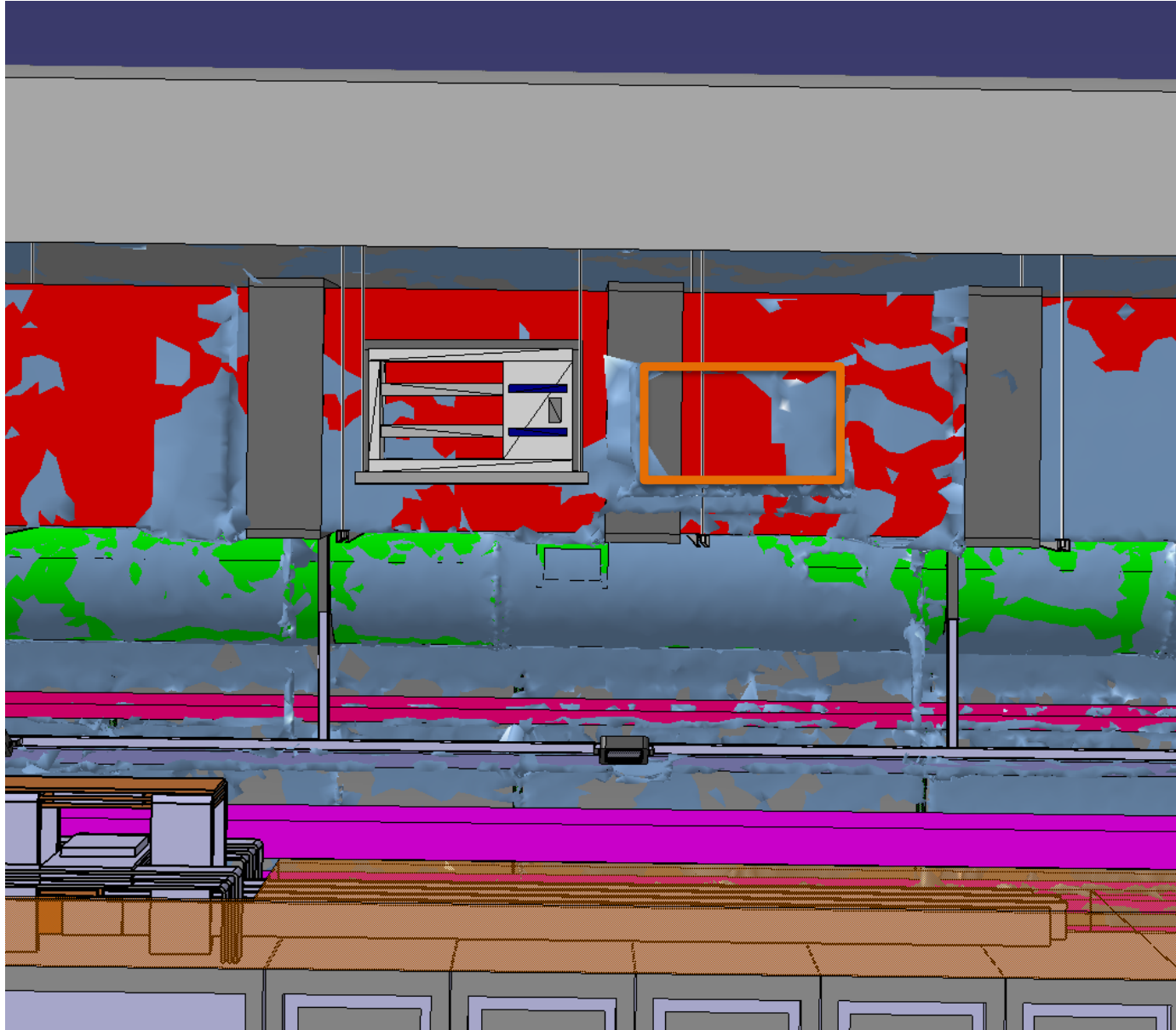

No conflict

Registre 15A

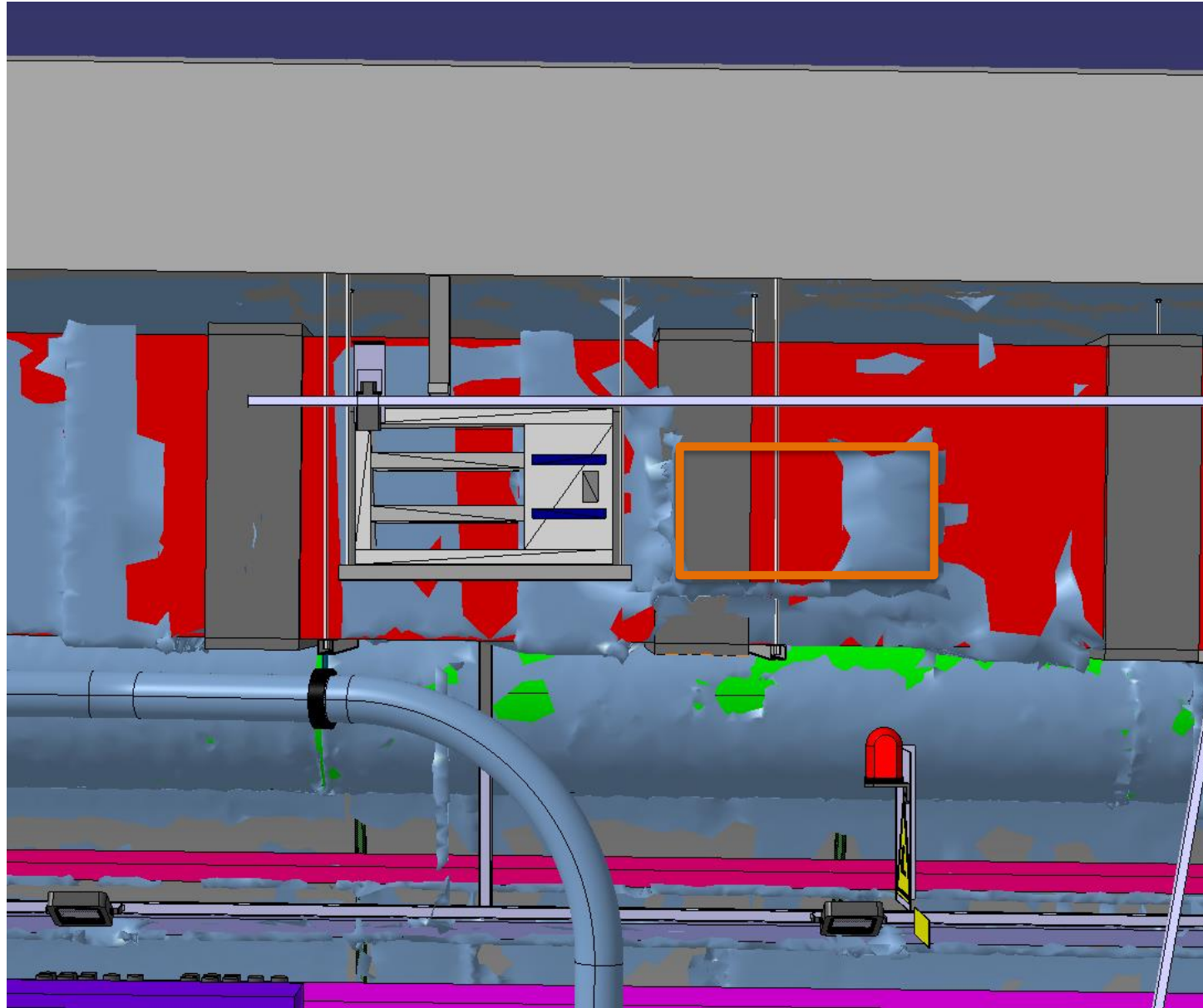

No conflict

Registre 16A

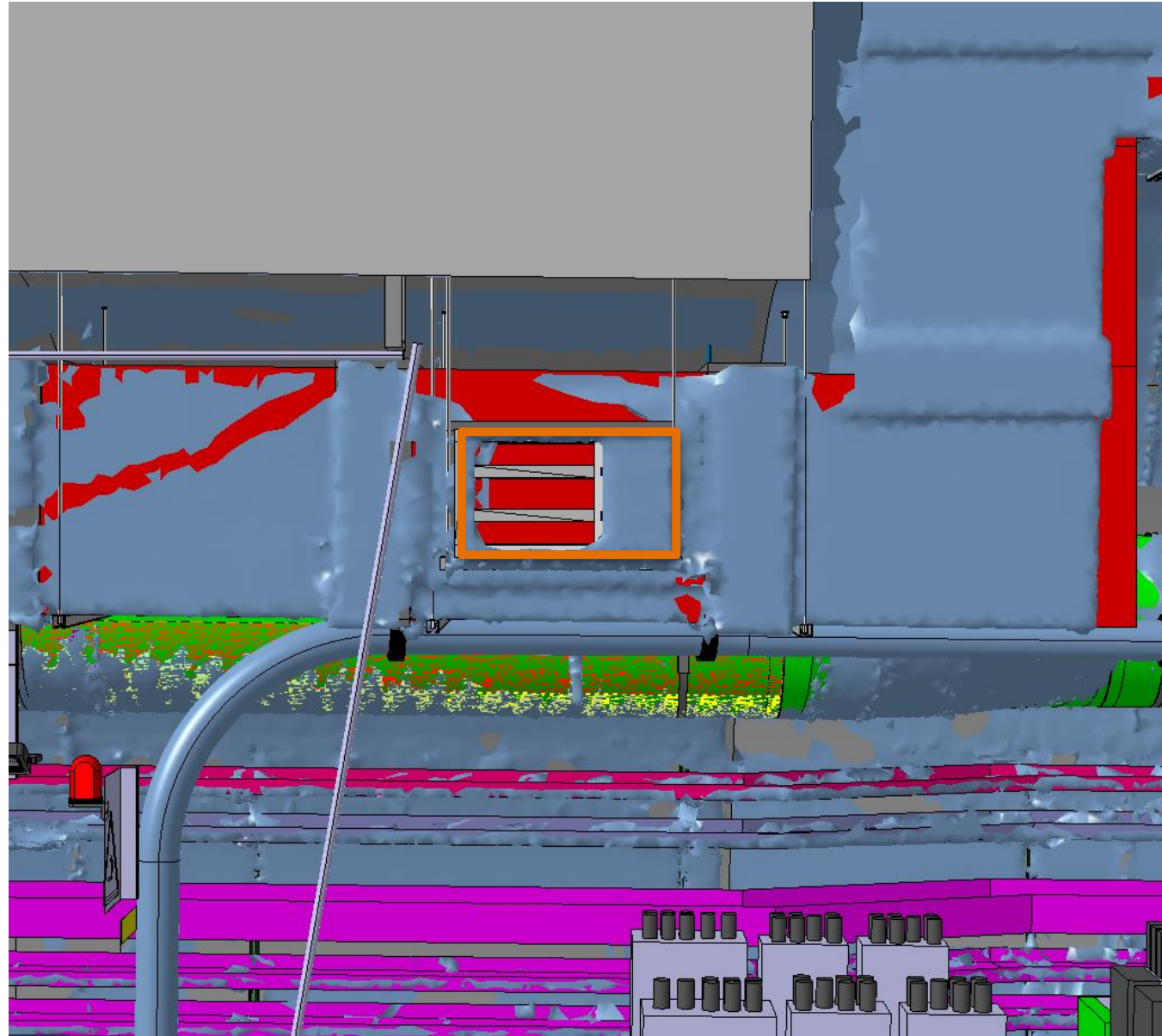

No conflict

Registre 17A

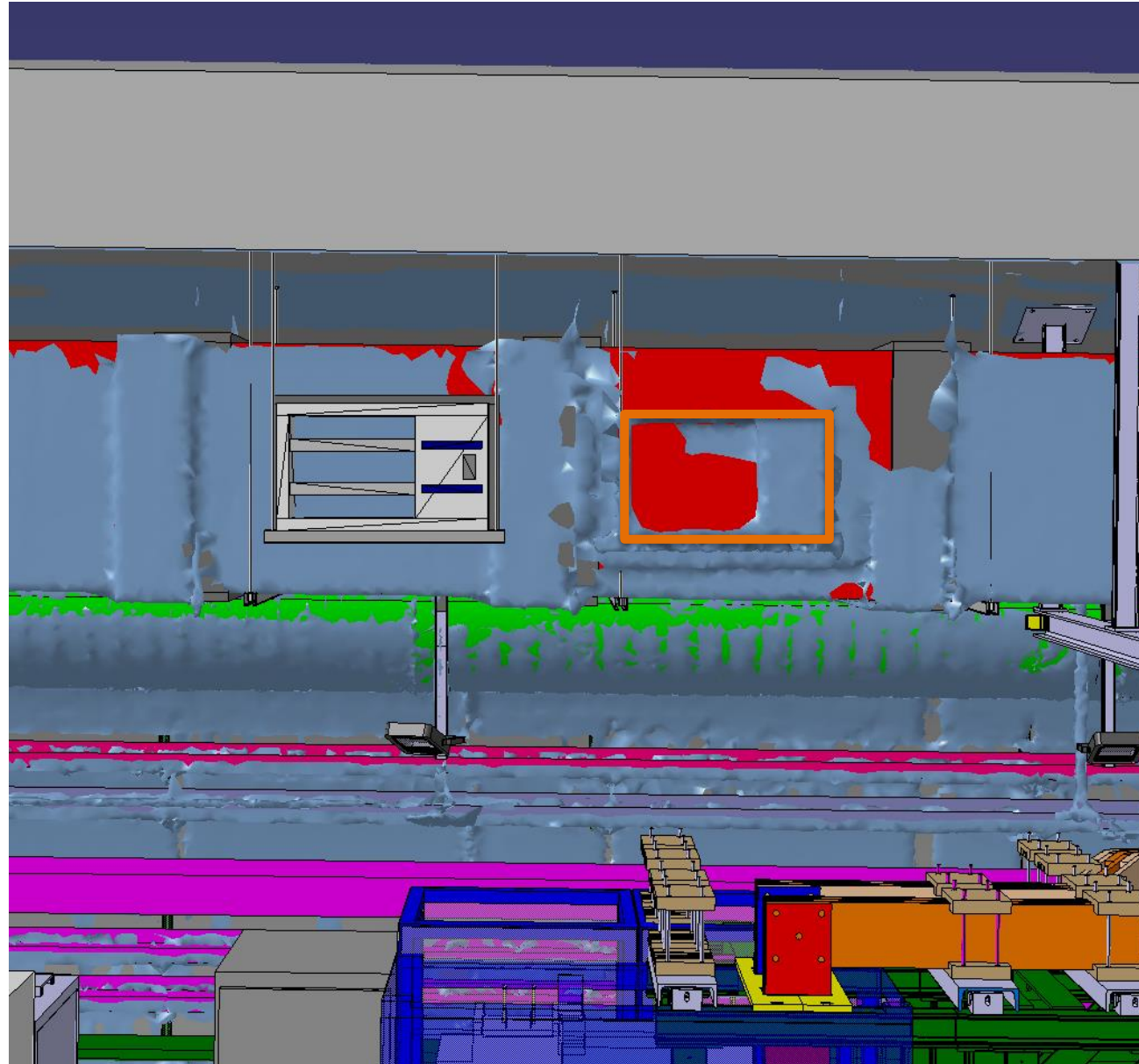

No conflict

Registre 18A

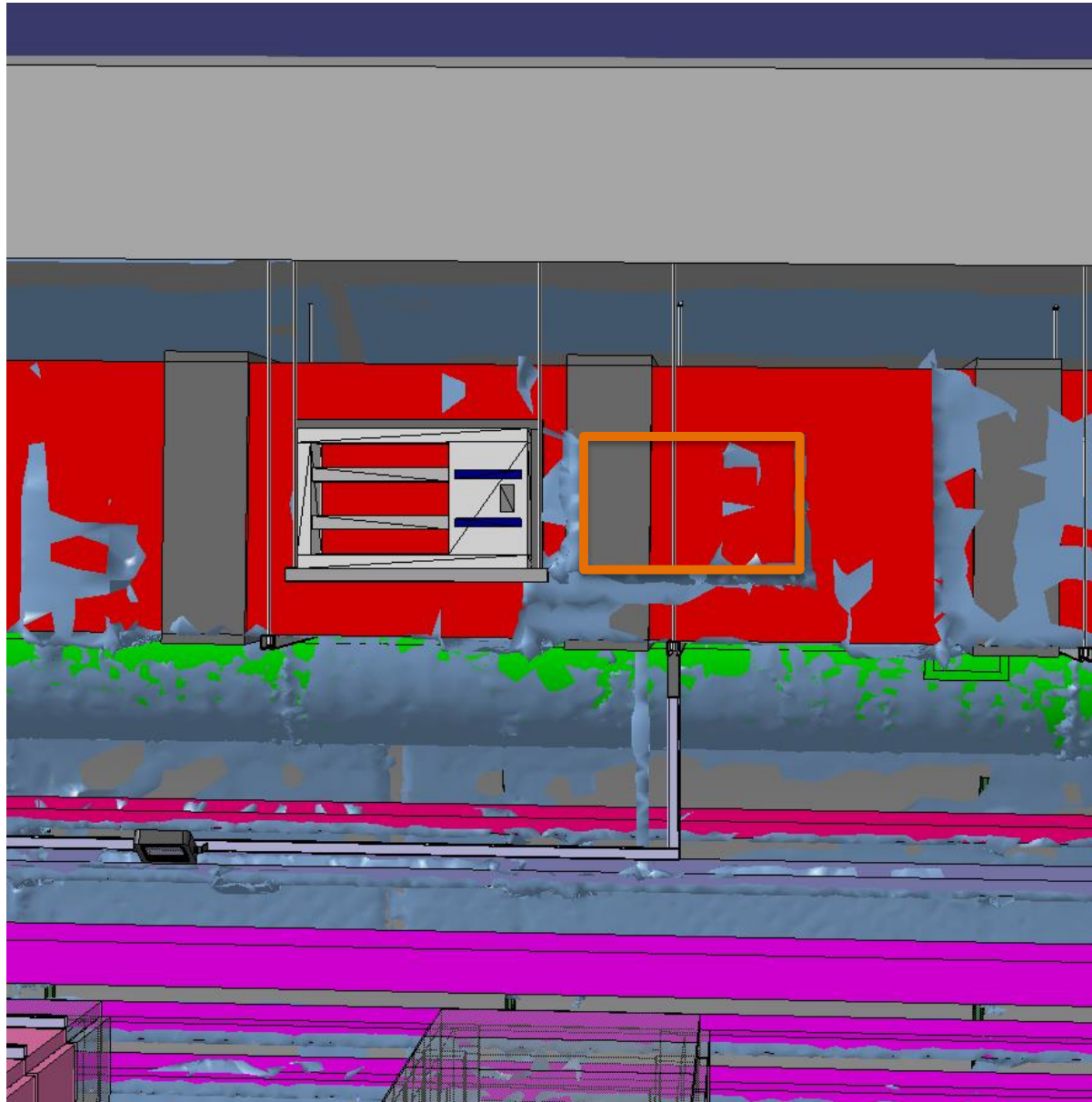

No conflict

Registre 1B

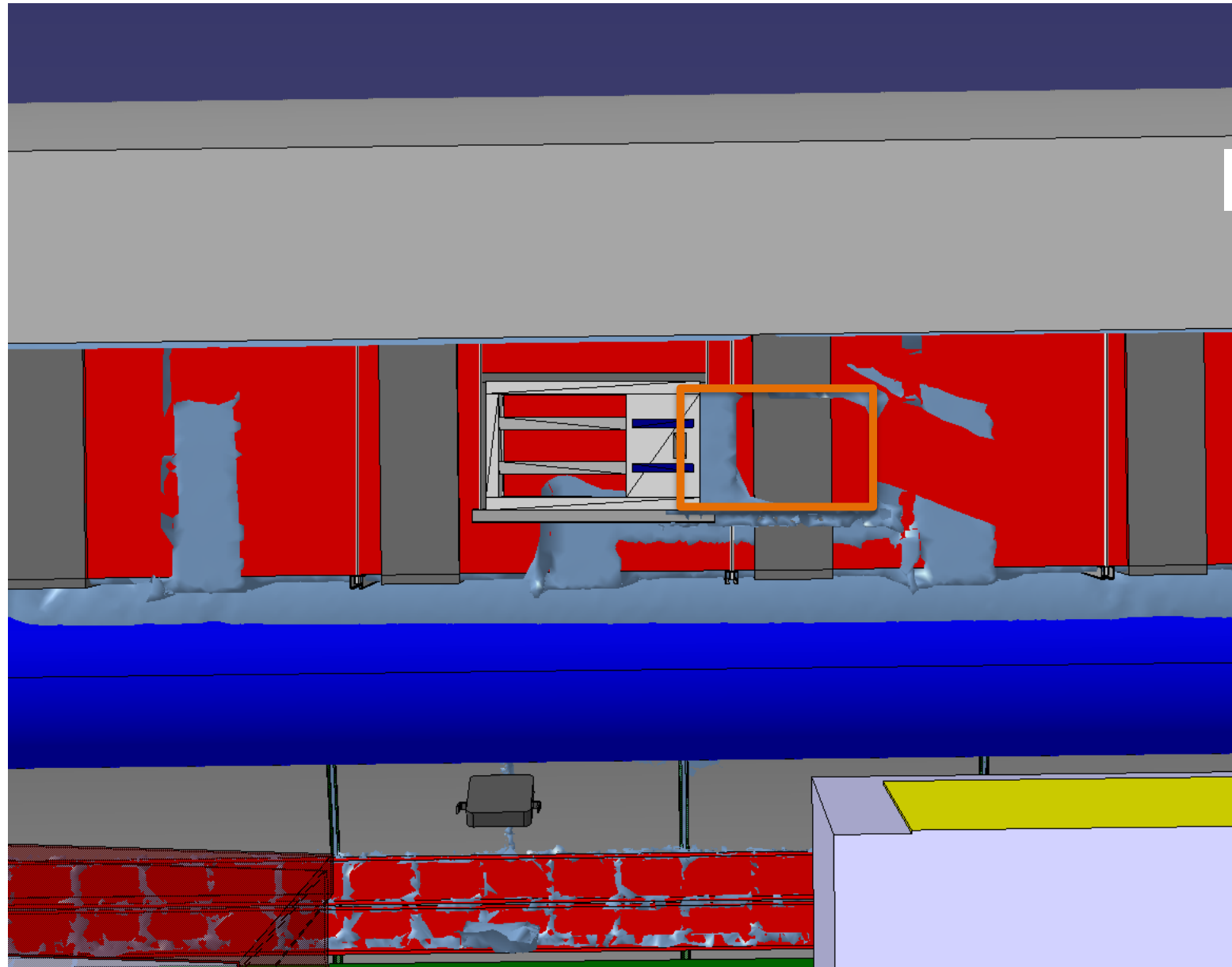

No conflict

Registre 2B

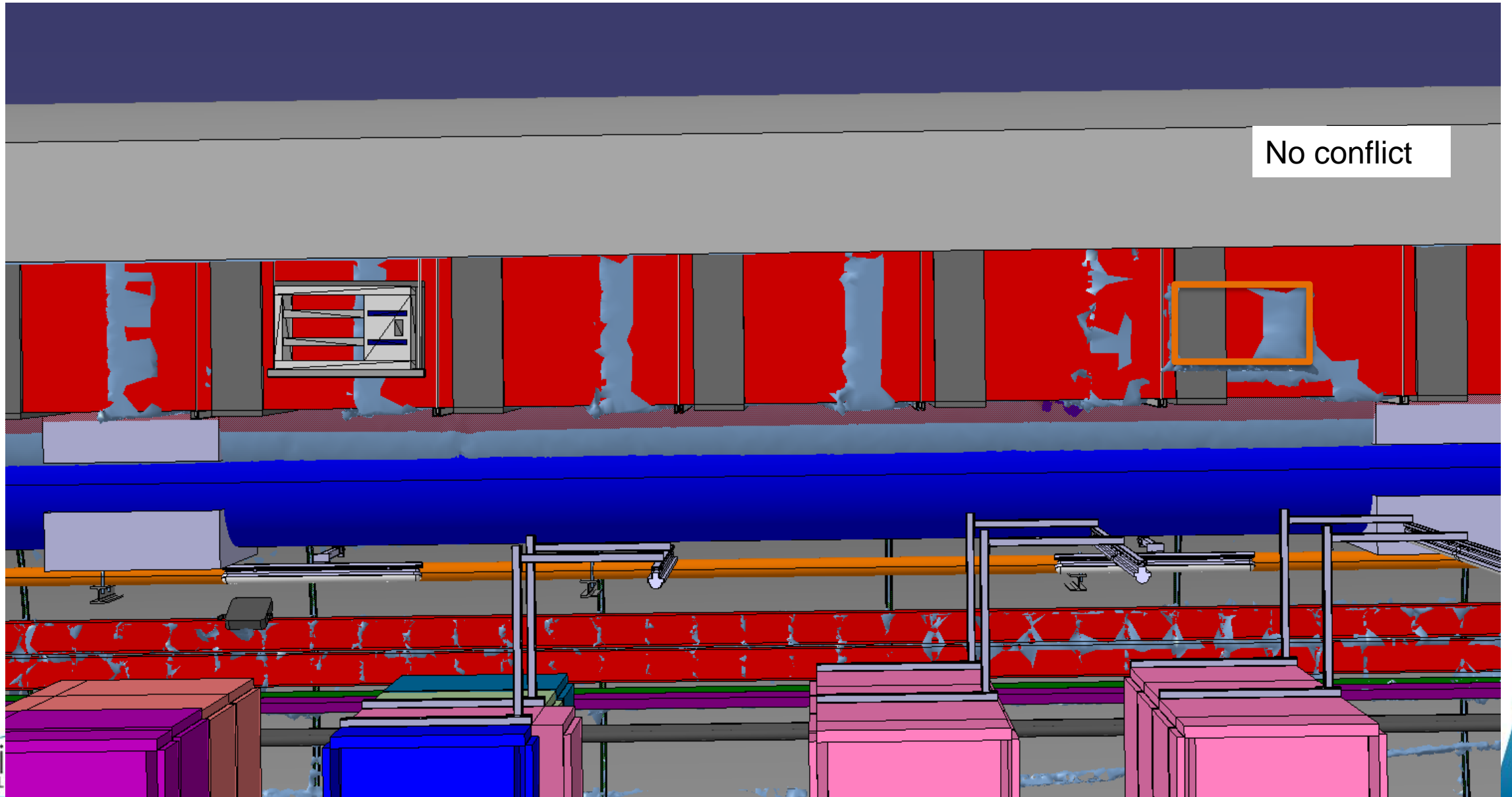

Registre 3B

No conflict

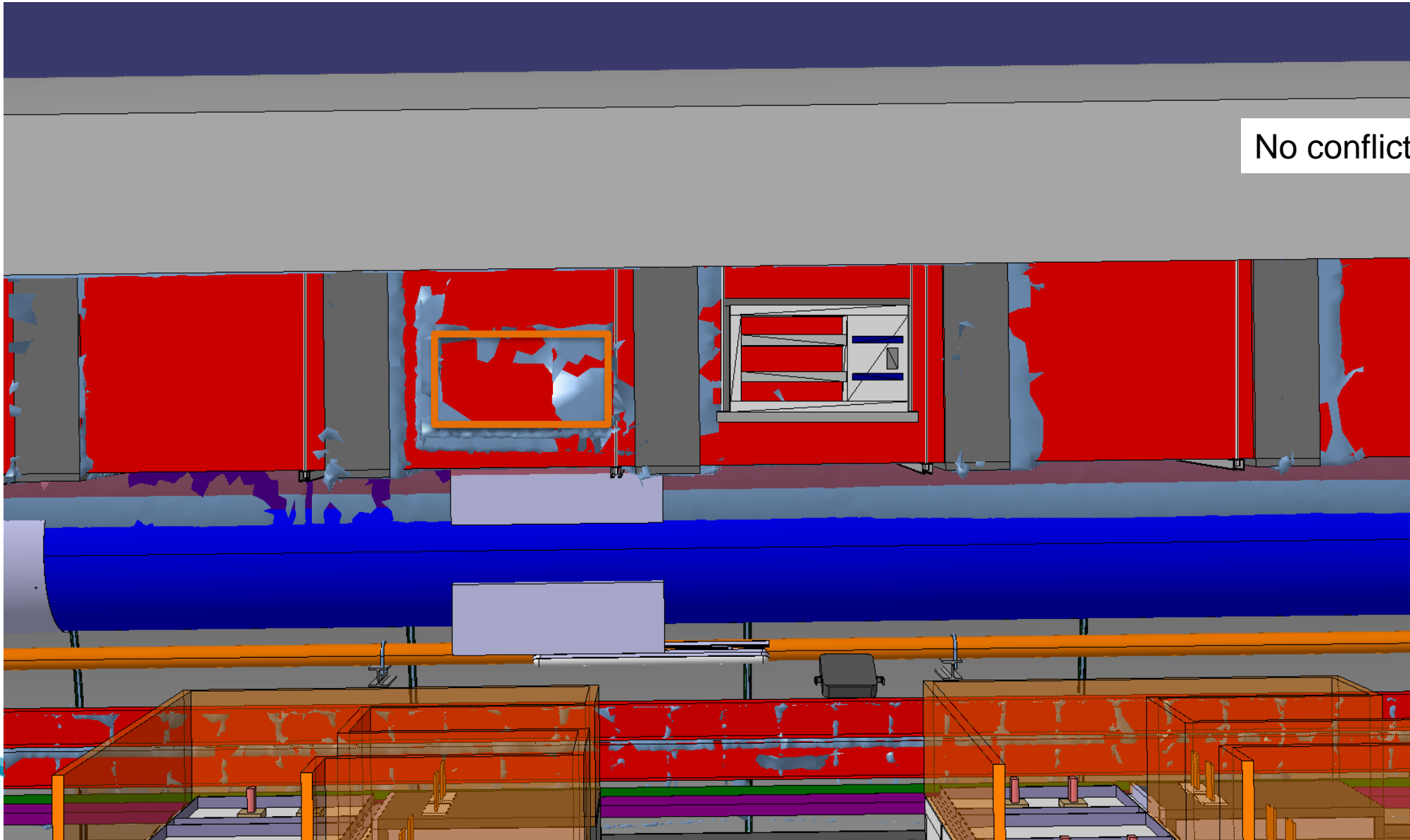

Registre 4B

Conflict – Support equipment DFHM

Solution proposée: Couper le profilé vertical et d'ajouter une poutre horizontale pour maintenir la rigidité

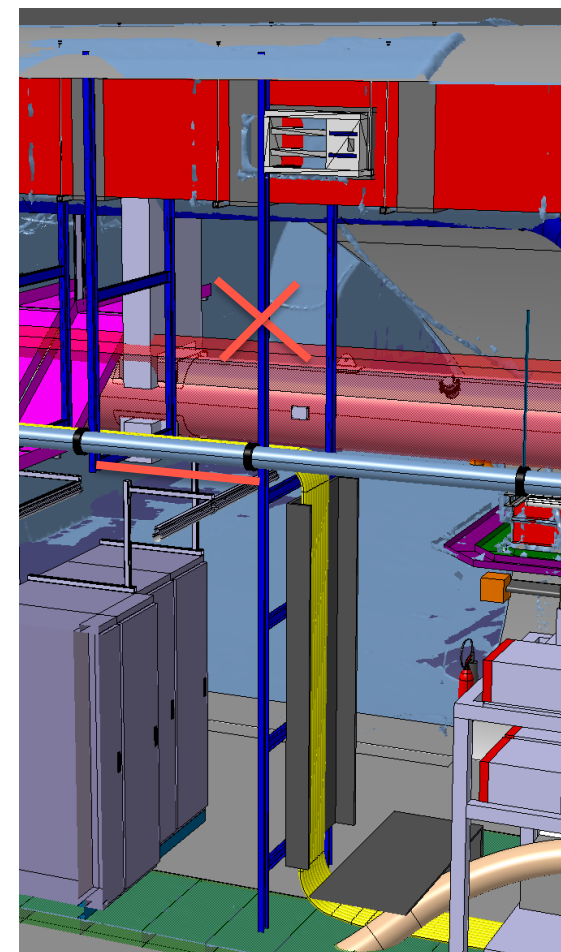
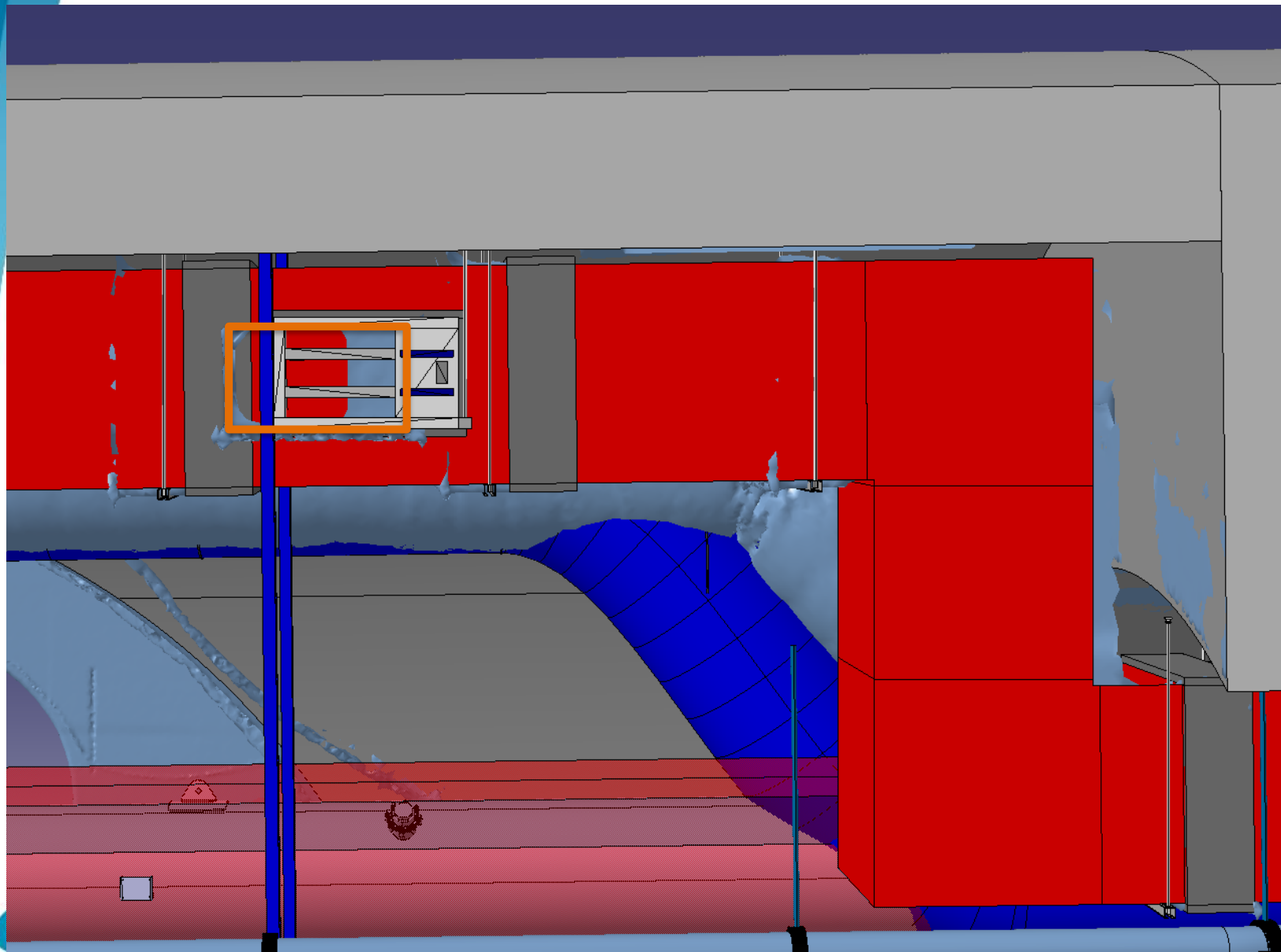

Registre 5B

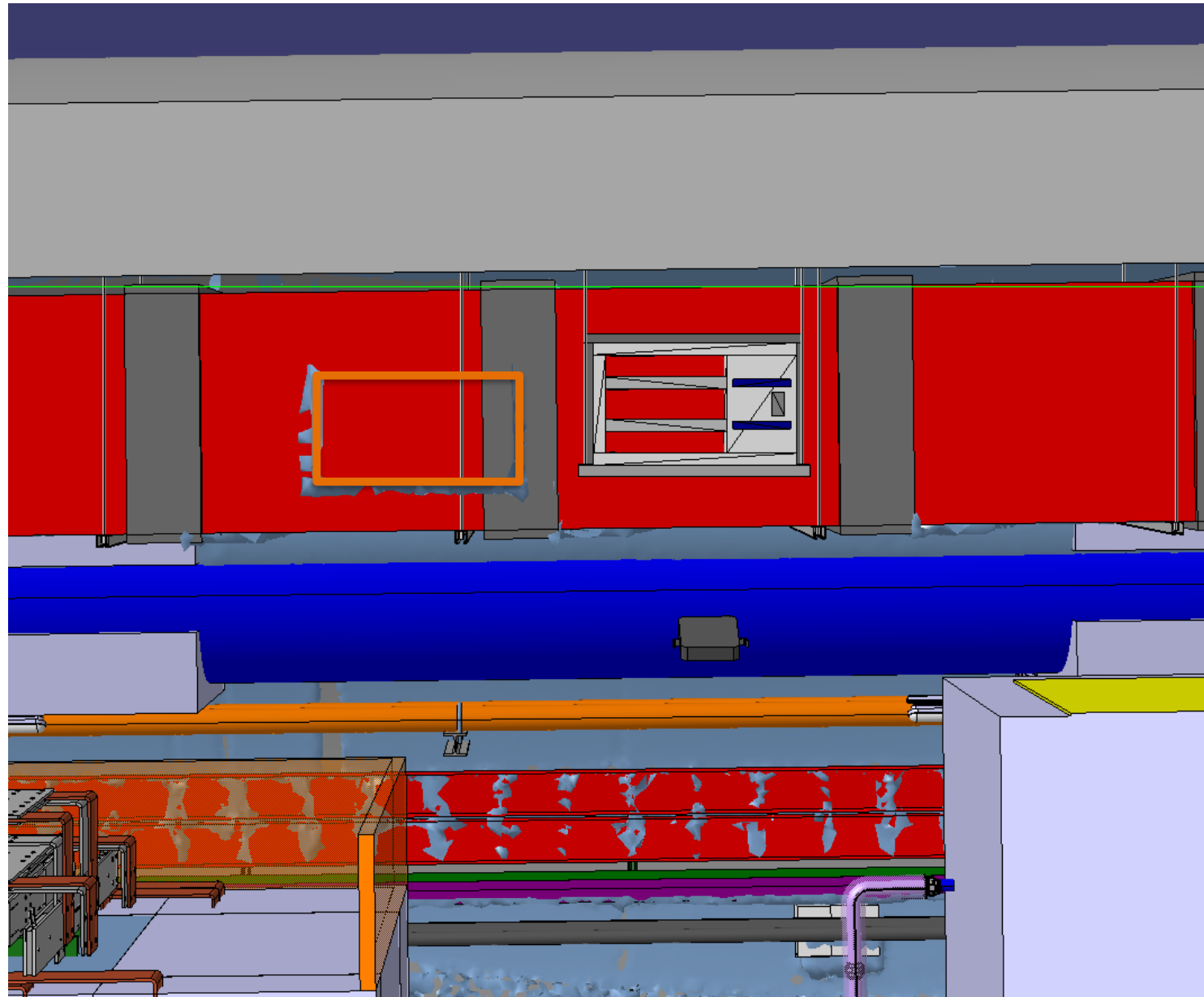

No conflict

Registre 6B

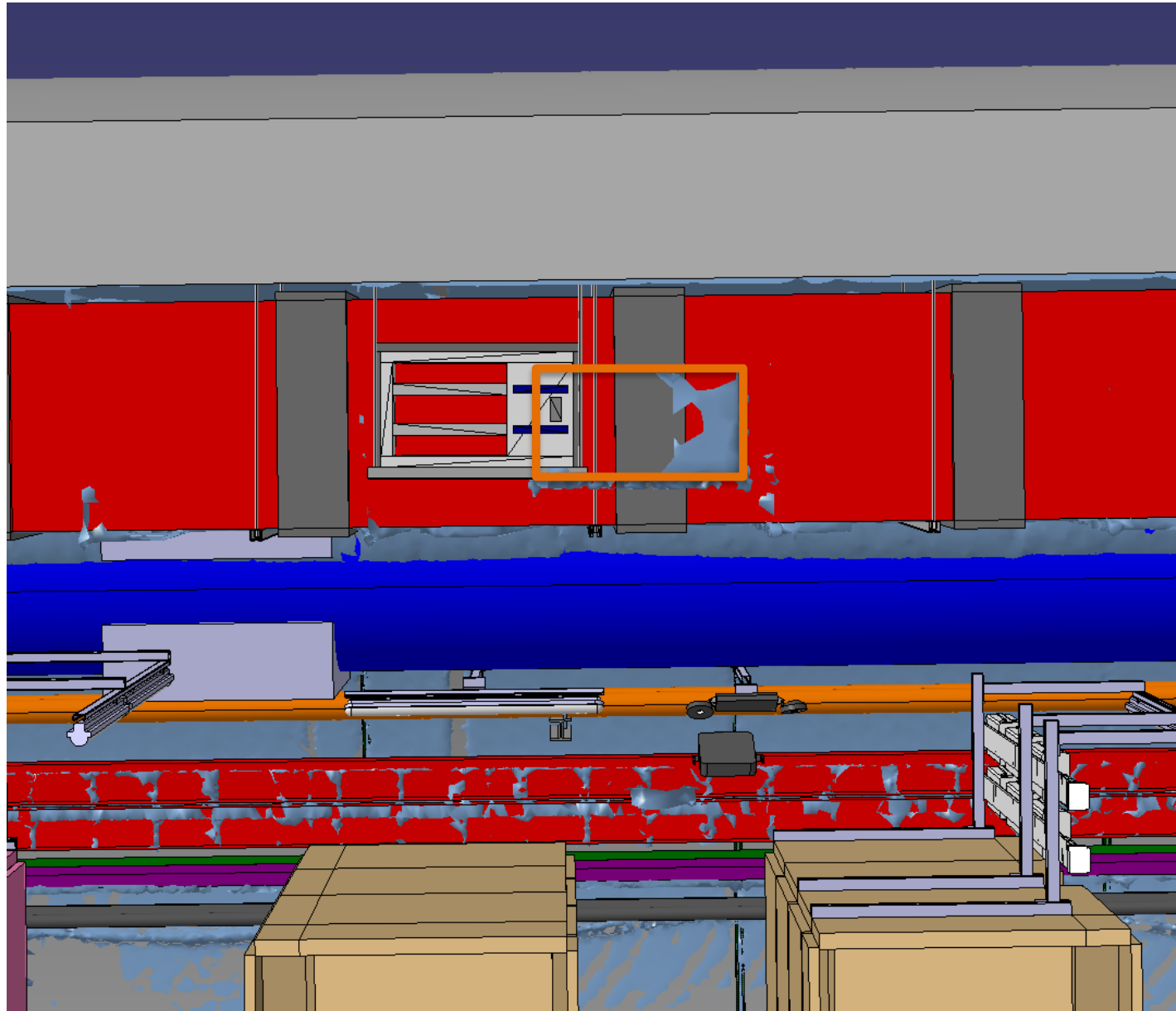

No conflict