

THIS IS LOUISIANA TECH UNIVERSITY

<http://www.latech.edu/>

Dick Greenwood
greenw@phys.latech.edu



Located in beautiful Louisiana (USA)!



LOUISIANA TECH
UNIVERSITY[®]

INSTITUTIONAL HIGHLIGHTS

- North Louisiana's only Carnegie Doctoral/Research University
- North Louisiana's only SREB Doctoral Four-Year 2 Research University
- Ranked #7 in the nation for graduating students with least amount of debt (2011) and the second consecutive year in the Top Ten (2010 and 2011 US News & World Report Best Colleges Report)
- Highest ranked Louisiana public university in mid-career median pay for graduates (PayScale.com's 2010-11 College Salary Report)
- Highest ranked Louisiana public university in Washington Monthly's 2009 Best National Universities list-One of *Kiplinger's* 100 Best Values in Public Colleges (2009 and 2010)



GRADUATION RATES

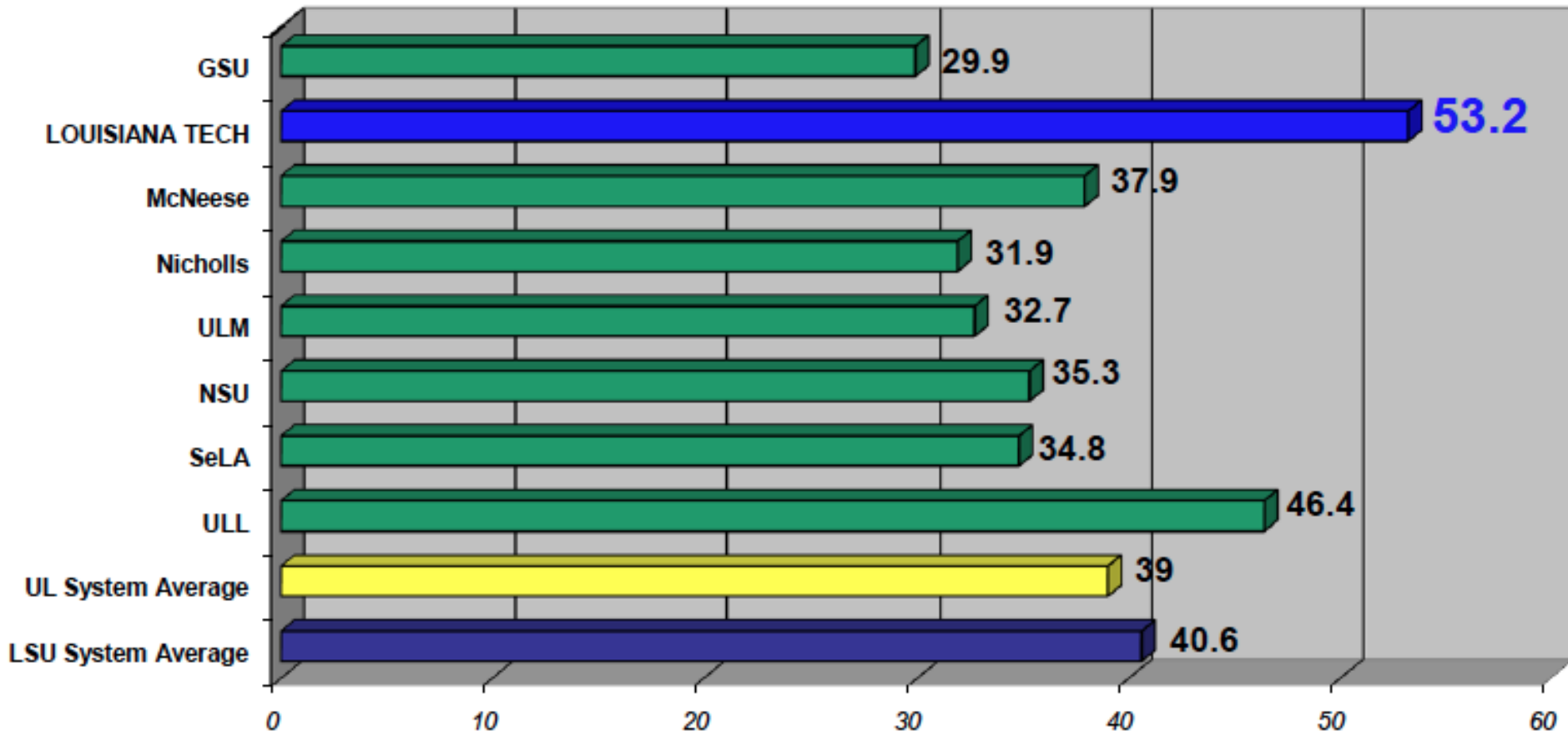

RETENTION RATES

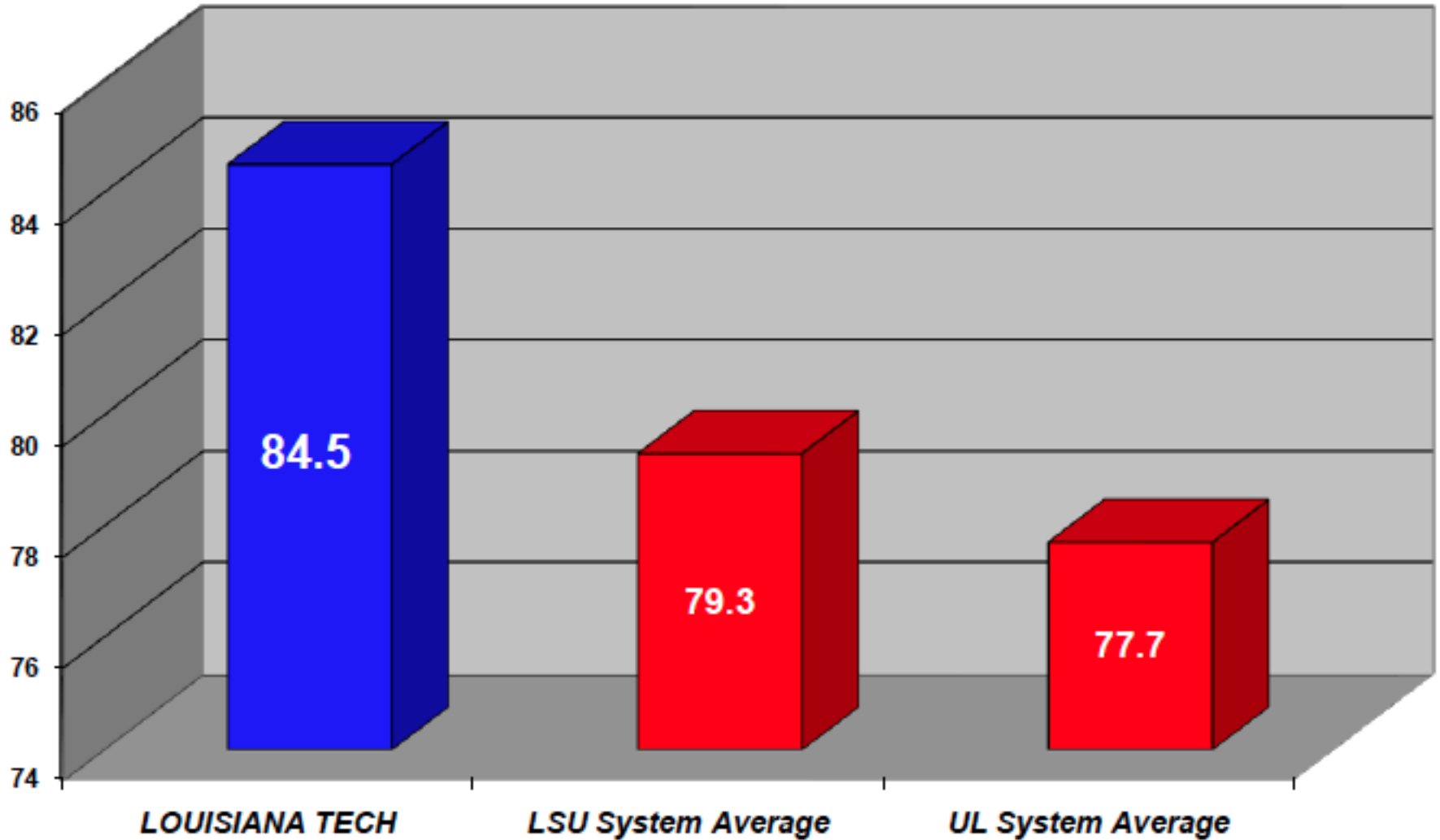

LOUISIANA TECH
UNIVERSITY

SOURCE: Louisiana Board of Regents

YEARS TO COMPLETION (First-Time Baccalaureate)

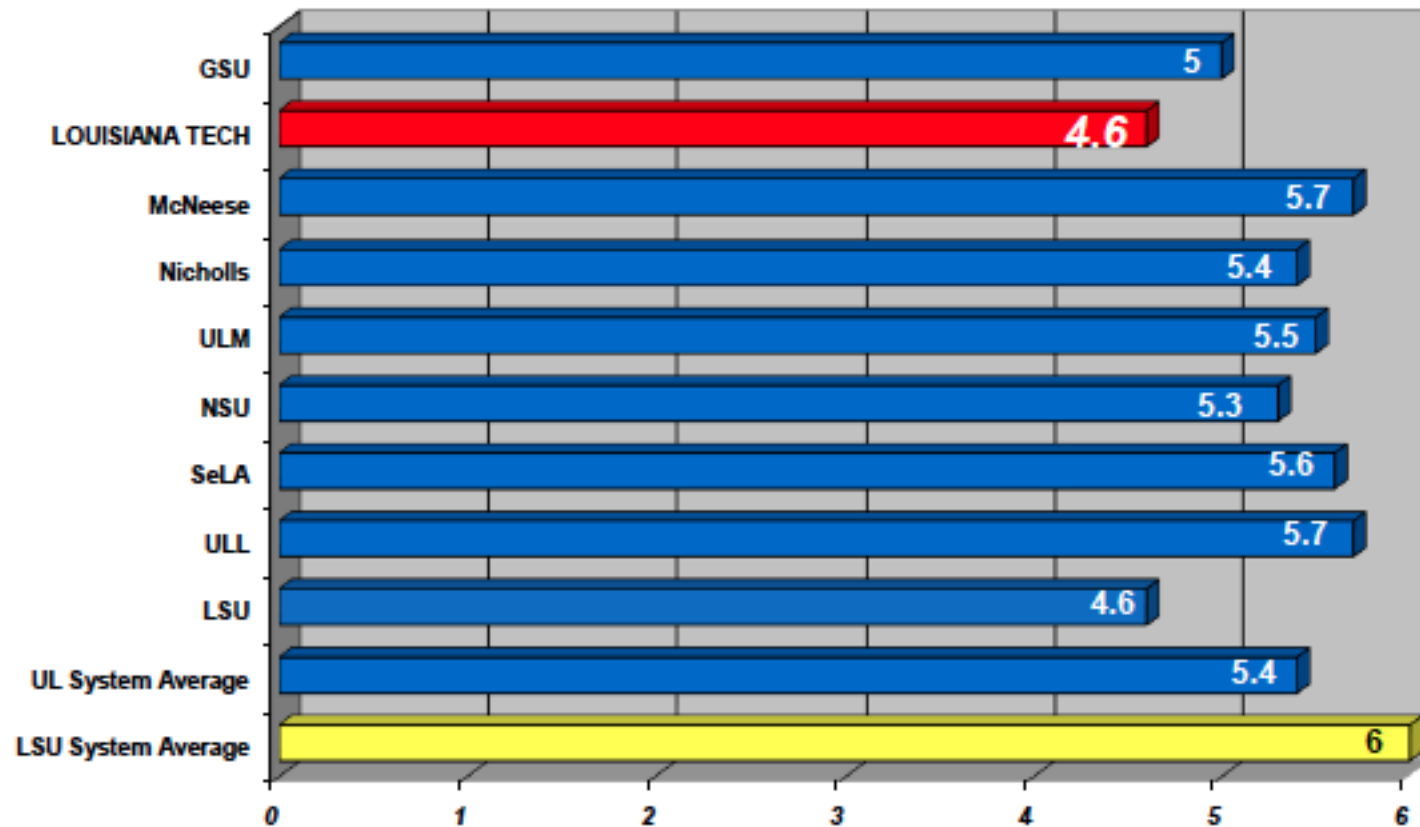



ENTERPRISE CAMPUS
AT LOUISIANA TECH UNIVERSITY
RESEARCH PARK

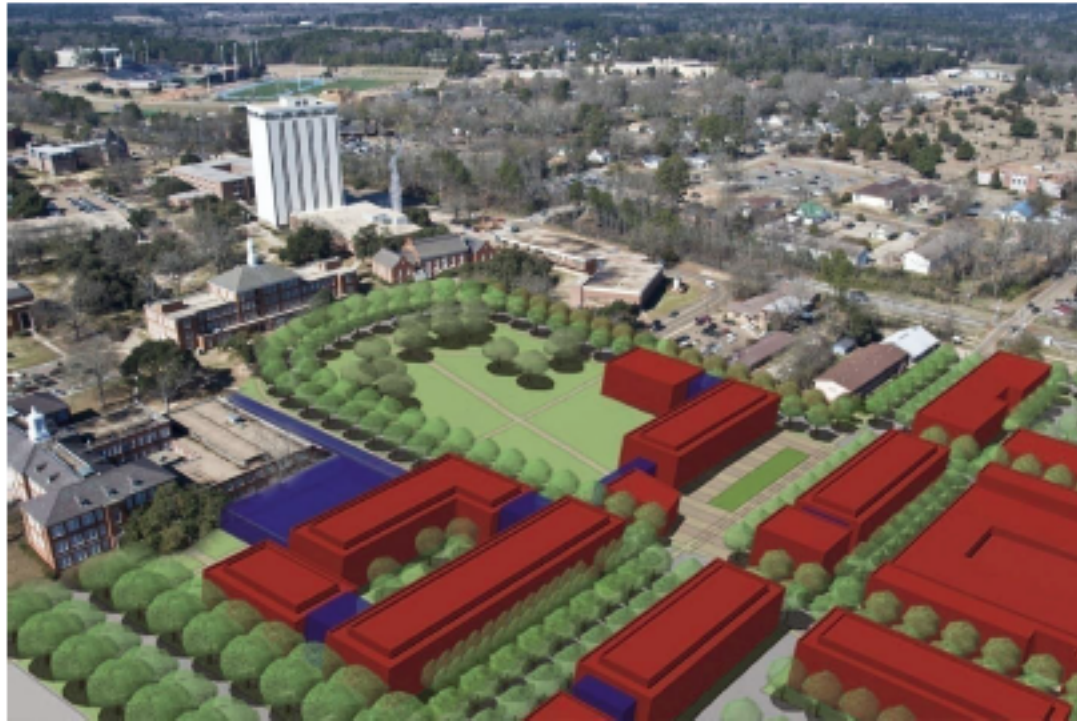

LOUISIANA TECH
UNIVERSITY[®]



Mission: To provide an environment that supports the powerful engagement of industry, government and community partners in the research, development, and educational activities of Louisiana Tech University

Vision: The Enterprise Campus will serve as the intellectual epicenter for technology enterprises in North Louisiana.

Goals:

- Foster collaborations between the University and partners in industry and government
- Provide resources for emerging technology companies and innovators to conduct R&D
- Advance the region's competitiveness in the knowledge economy
- Enhance research and educational opportunities for our faculty and students
- Afford job opportunities for our graduates
- Contribute to the revitalization of the geographic and economic core of the community.

ACADEMIC PROGRAMS

Louisiana Tech's Doctoral Programs

Doctor of Philosophy in Computational Analysis and Modeling (Interdisciplinary)

Doctor of Philosophy in Engineering (4 concentrations - Interdisciplinary)

Doctor of Philosophy in Biomedical Engineering

Doctor of Philosophy/Joint MD program in Biomedical Engineering (in conjunction with LSU Med Center - Shreveport, LA)

Doctor of Education in Curriculum and Instruction

Doctor of Education in Educational Leadership

Doctor of Philosophy in Counseling Psychology

Doctor of Philosophy in Industrial/Organizational Psychology

Doctor of Business Administration (6 concentrations)

Doctor of Audiology

College of Engineering and Science:

<http://www.latech.edu/coes/>

The College of Engineering and Science offers several interdisciplinary programs:

Biomedical Engineering
Electrical Engineering Technology Chemical Engineering
Engineering and Technology Management Chemistry
Industrial Engineering Civil Engineering
Mathematics and Statistics Computational Analysis and Modeling
Mechanical Engineering Computer Science
Microsystems Engineering Construction Engineering Technology
Molecular Science and Nanotechnology Cyber Engineering
Nanosystems Engineering Electrical Engineering
Physics



Physics Research

<http://www.phys.latech.edu/research>

- Research is a vital part of any physics program, and Louisiana Tech has built a reputation nation-wide for interdisciplinary research. Most of the research conducted by Louisiana Tech's physics faculty is in conjunction with one of the following research centers:
- [Center for Applied Physics Studies](#) (CAPS):
 - **Nuclear & Medium-energy Particle Physics:** Dr. Grimm, Dr. Johnston, Dr. Simicevic, Dr. Wells
 - **High Energy Particle Physics:** Dr. Greenwood, Dr. Sawyer, Dr. Wobisch
- [Institute for Micromanufacturing](#) (IfM):
 - **Condensed Matter Physics, Surface Physics, Nanoscience:** Dr. Derosa, Dr. Dobbins, Dr. Lvov
- [LIGO Observatory](#) in Livingston, LA:
 - Dr. Zotov
- Physics Education:
 - Dr. Shaw



LOUISIANA TECH
UNIVERSITY

LaHEP Computing

- Tier 3 cluster used to process and analyze ATLAS data stored locally.
- The cluster has 21 compute nodes, 600 batch slots, and over 60 TB of storage.
 - We have dedicated access to nine of the compute nodes (216 threads) and opportunistic access to the other twelve nodes (384 cores).
- The cluster is connected to the 10 gigabit/s Louisiana Optical Network Initiative (LONI) network
 - joins the National LambdaRail and Internet2 networks in Baton Rouge to ensure high speed connectivity internationally.
- Hadoop Distributed File System (HDFS) provides 21 TB of redundant storage (42 TB raw)
- A Lustre storage system is being deployed (40 TB available).
- We plan to install both an Open Science Grid (OSG) compute element and storage element for grid job submissions to our site and SRM/GridFTP file transfer capabilities.



Thank you!!



LOUISIANA TECH
UNIVERSITY[®]