

Nikhef Site Report

Paul Kuipers
paulks@nikhef.nl

Outline

- Storage
- Wi-Fi Network
- Windows
- Laptop backup/restore
- Grid

Storage

- /data
- iSCSI
 - performance
- gluster
 - Poweredge R515 (4)
 - 30 TB/server
 - 2 x 10 Gb/s
 - distributed mode
 - scalability (volume/bandwidth)
 - glusterfs/fuse

Wi-Fi Network

- Cisco AP I250B
 - capacity
 - overview
 - manageability
- Aruba
 - 3400 (2)
 - AP-105 (30-40)
 - configuration modular
 - overview
 - usage
 - coverage

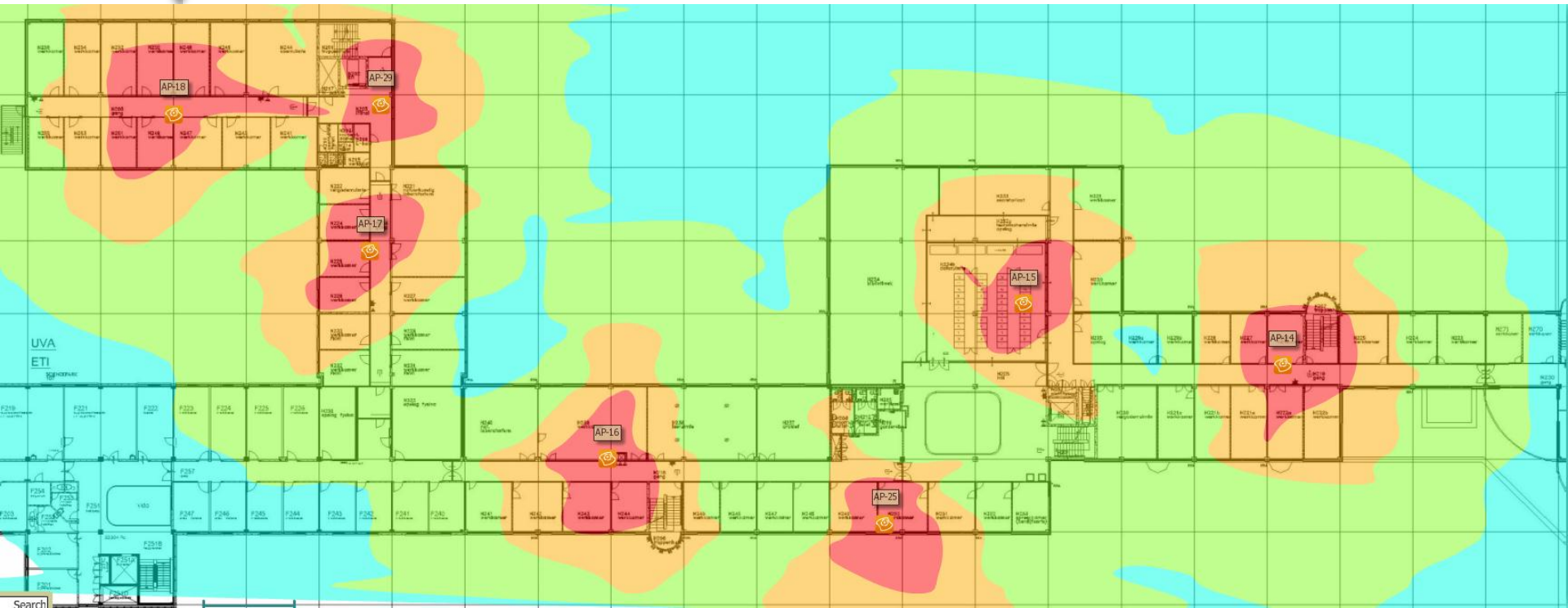

P. Kuipers
Nikhef
Amsterdam
Computer-
Technology



Windows

- Desktop Central (ManageEngine)
 - distribution / update
 - reboot
- OS Deployer (ManageEngine)
 - linux preloader
 - driver problems (new hardware)
 - network
 - disk
 - first Windows OS install
 - disk images laptop
 - Acronis snapdeploy

Laptop backup/restore

- desktop
- crashplan
 - 2 TB
 - 20 GB/user
 - client OS's
 - background
 - configuration
 - per instance
 - user (after starting backup)

Grid

- **compute NL/T I**
 - 5000 cores (Nikhef 2600)
 - torque/maui problems
 - queue 15000 jobs
 - worker nodes
 - network
- **services virtualised**
 - Xen Cloud Platform 1.5
 - 16 nodes (Dell M610 / 96 GB RAM / 2x6 cores HT)
 - Dell Compellent
 - 50 TB (auto-tiering SSD / 10k SAS / 7k2 N/L SAS)

Questions?