

Implantation Gbar au CERN

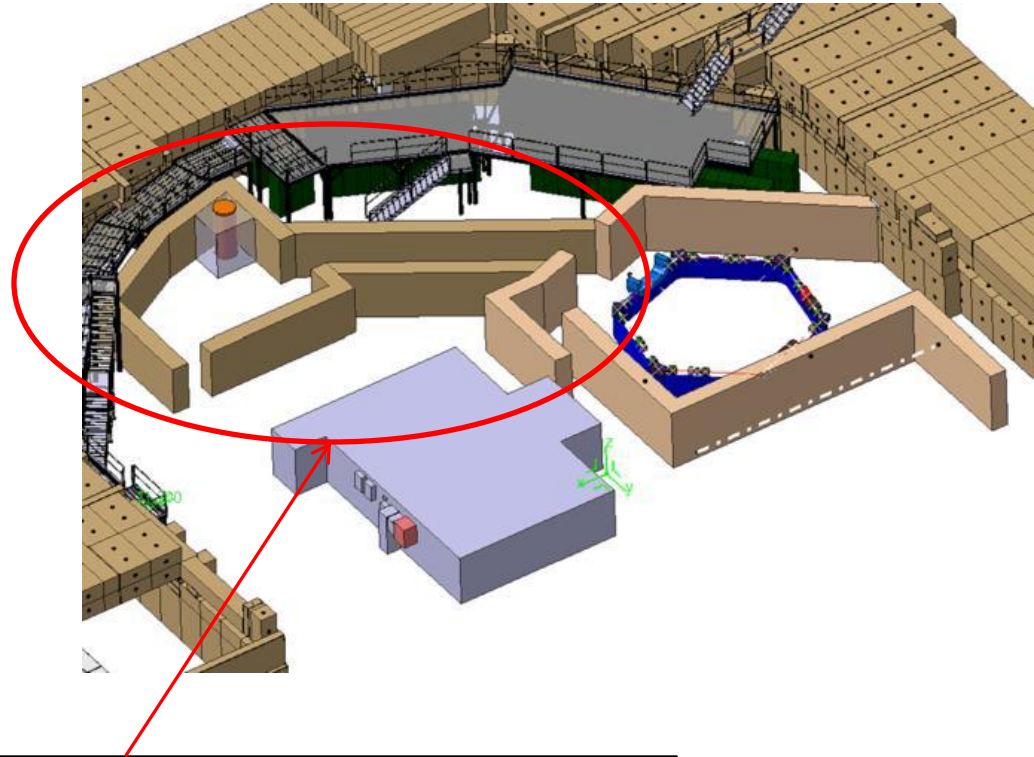

Proposition d'enveloppe du CERN

Proposition de design général CEA

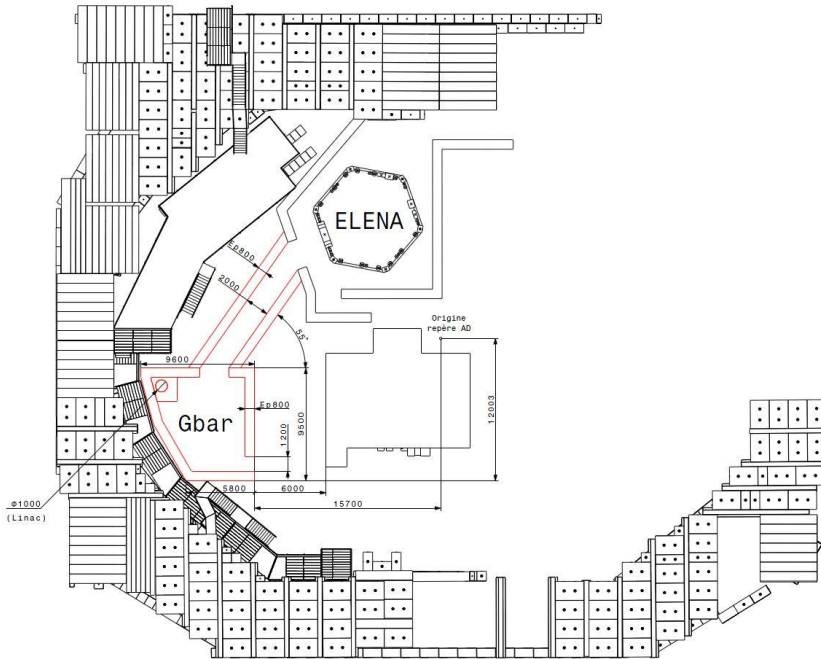
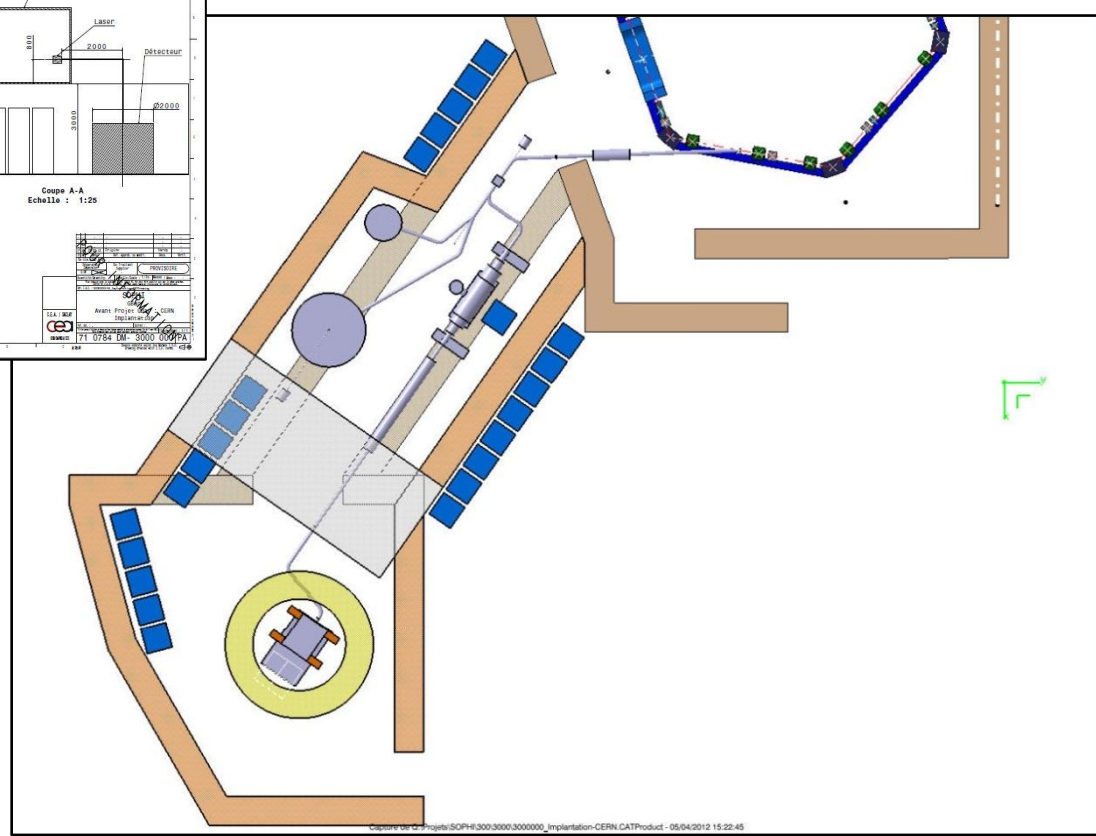
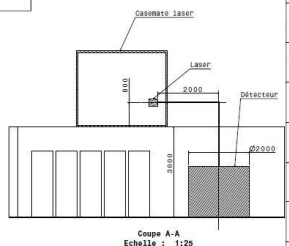
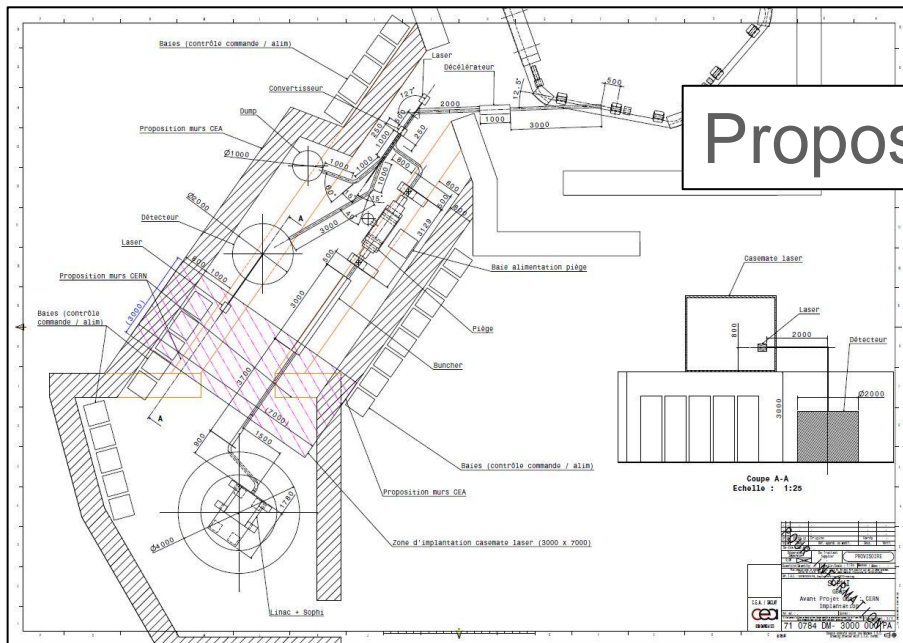

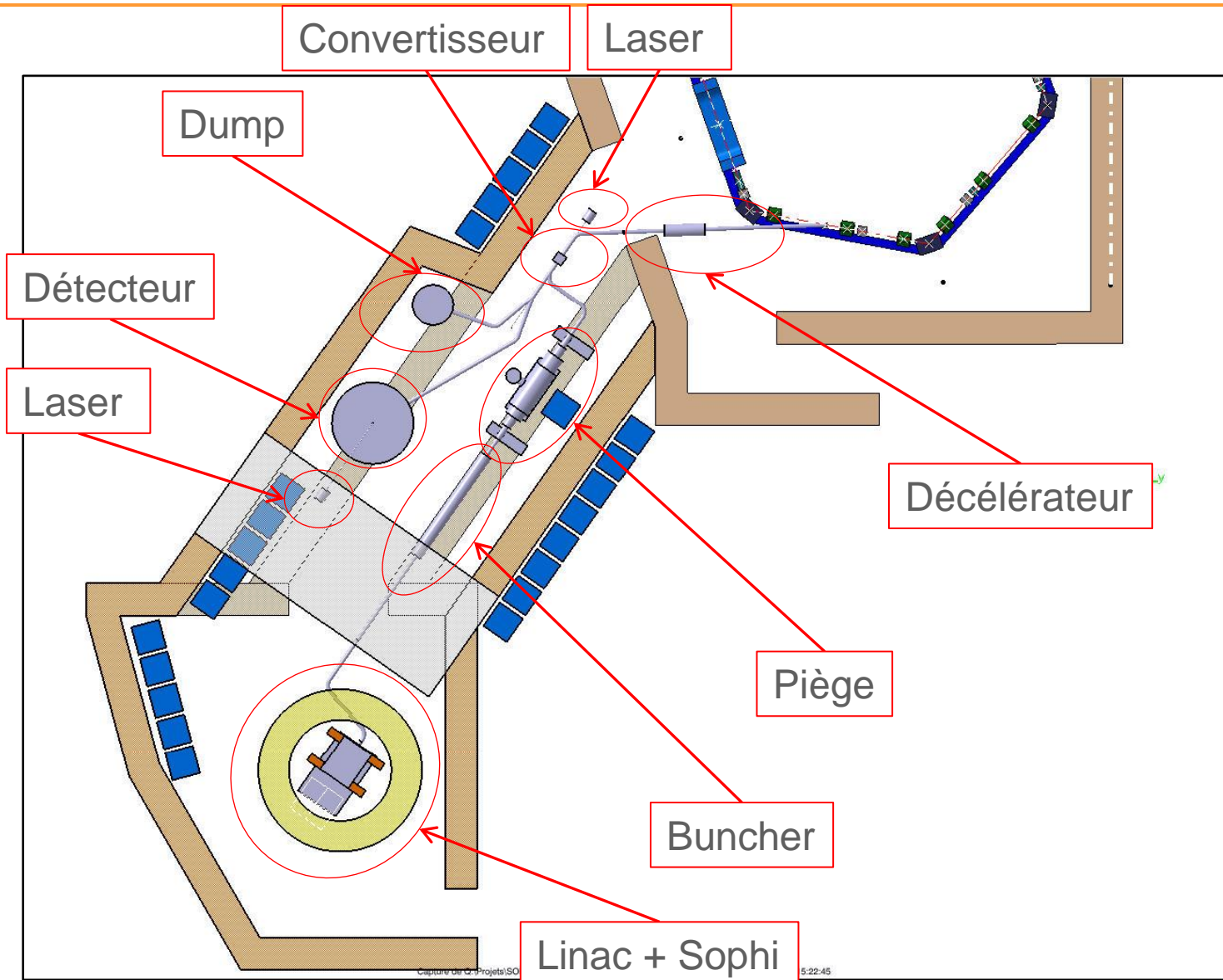

Capture de C. Projets/SO

5:22:45



Pour pouvoir finaliser le design général de l'implantation, il faut :

- Définir la position du faisceau d'extraction d'ELENA

Chaque sous système doit :

- Définir et valider l'espace nécessaire (position et dimensions des éléments)
- Définir ses contraintes propres et celles qui interagissent avec les autres sous systèmes
- Définir les interfaces avec les autres sous systèmes

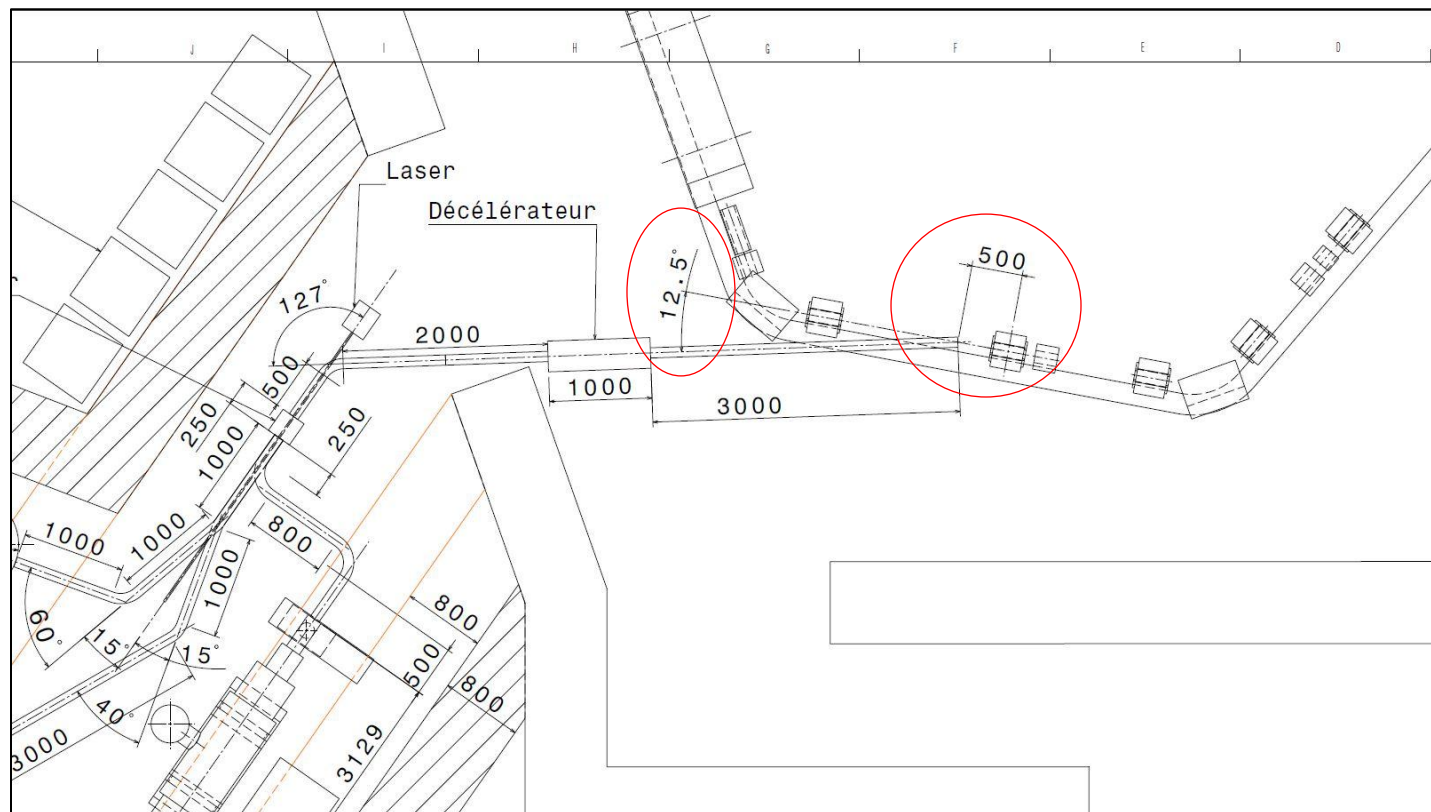

Faisceau d'extraction d'ELENA

Interaction avec laser

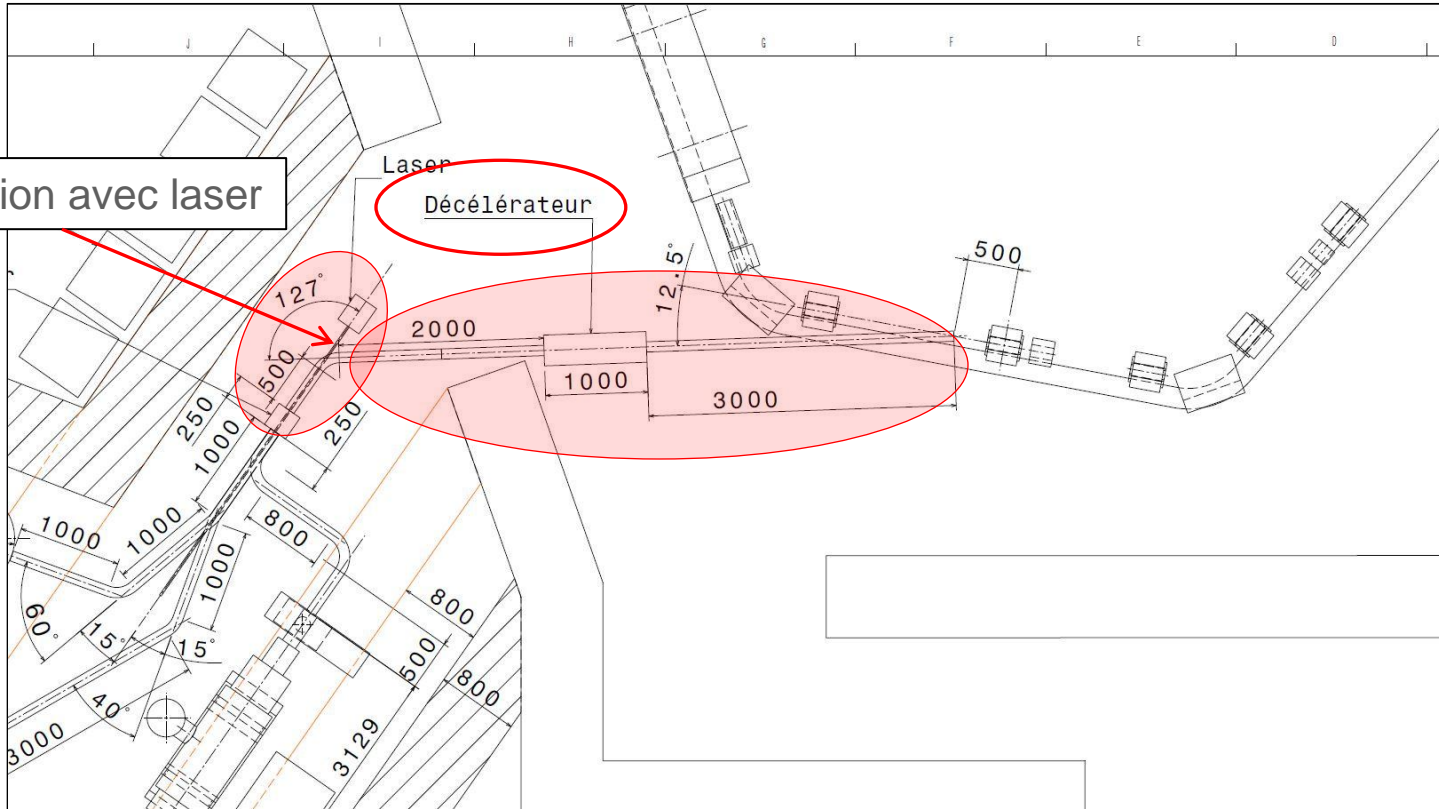

Décélérateur

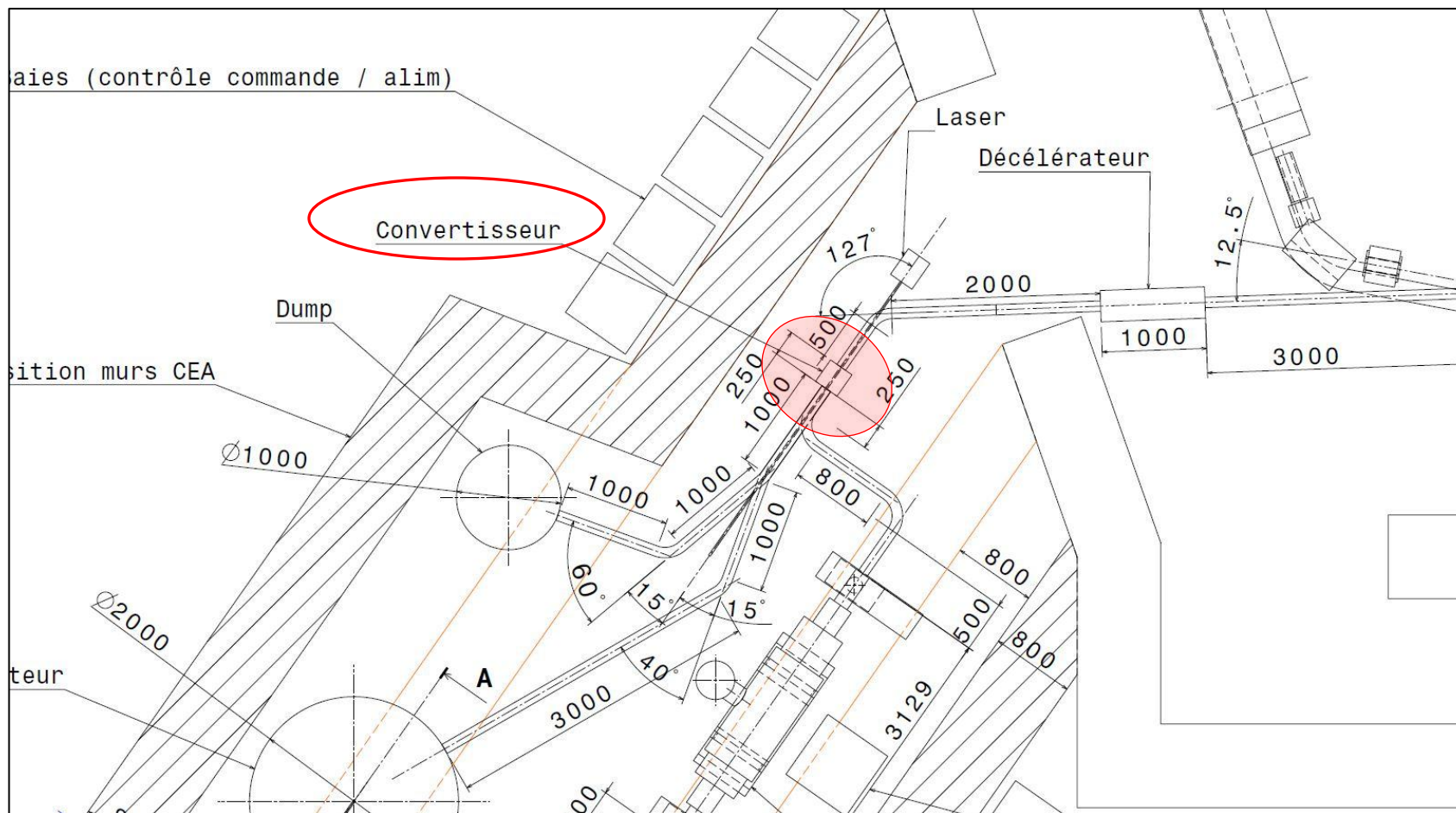

Convertisseur

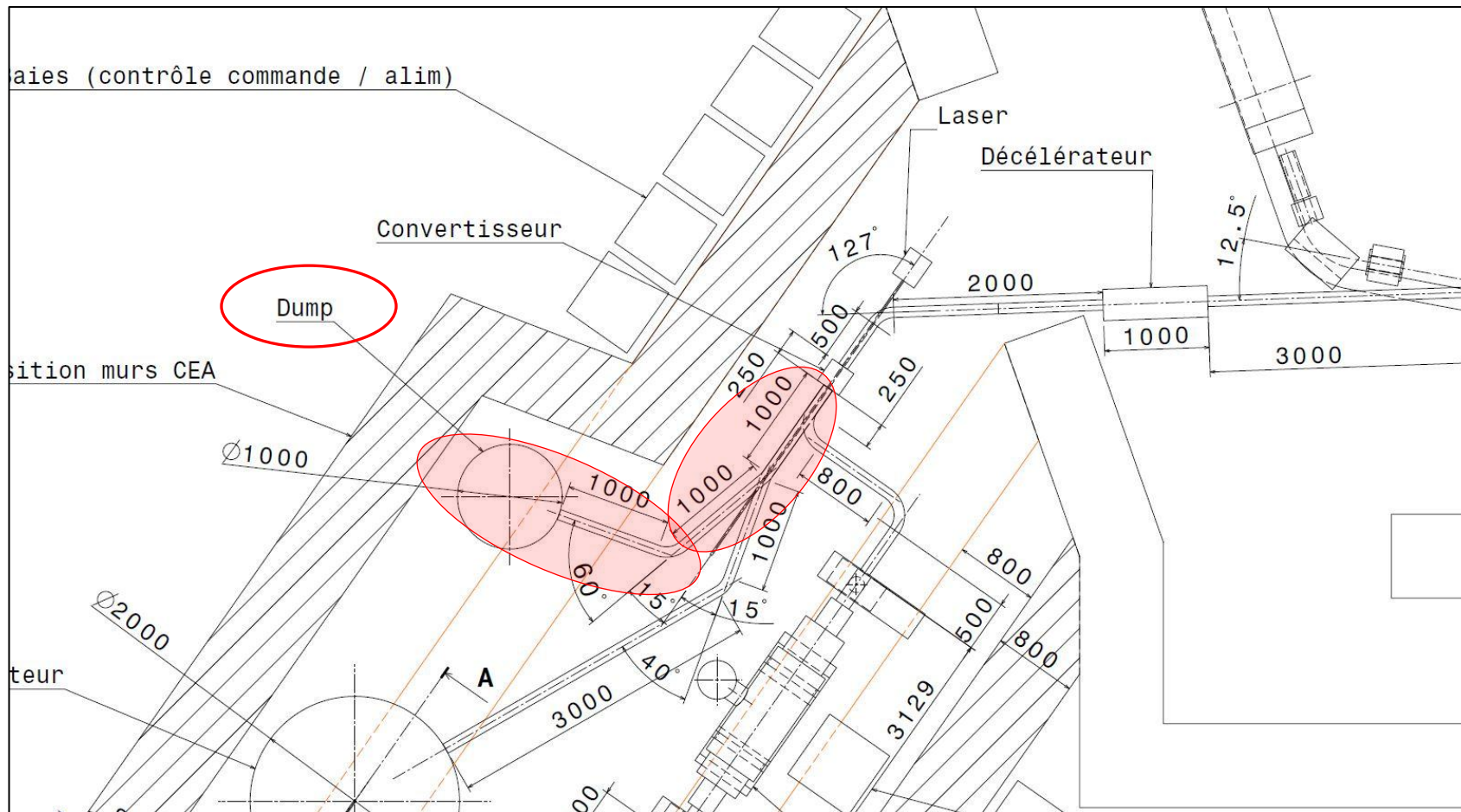

Dump

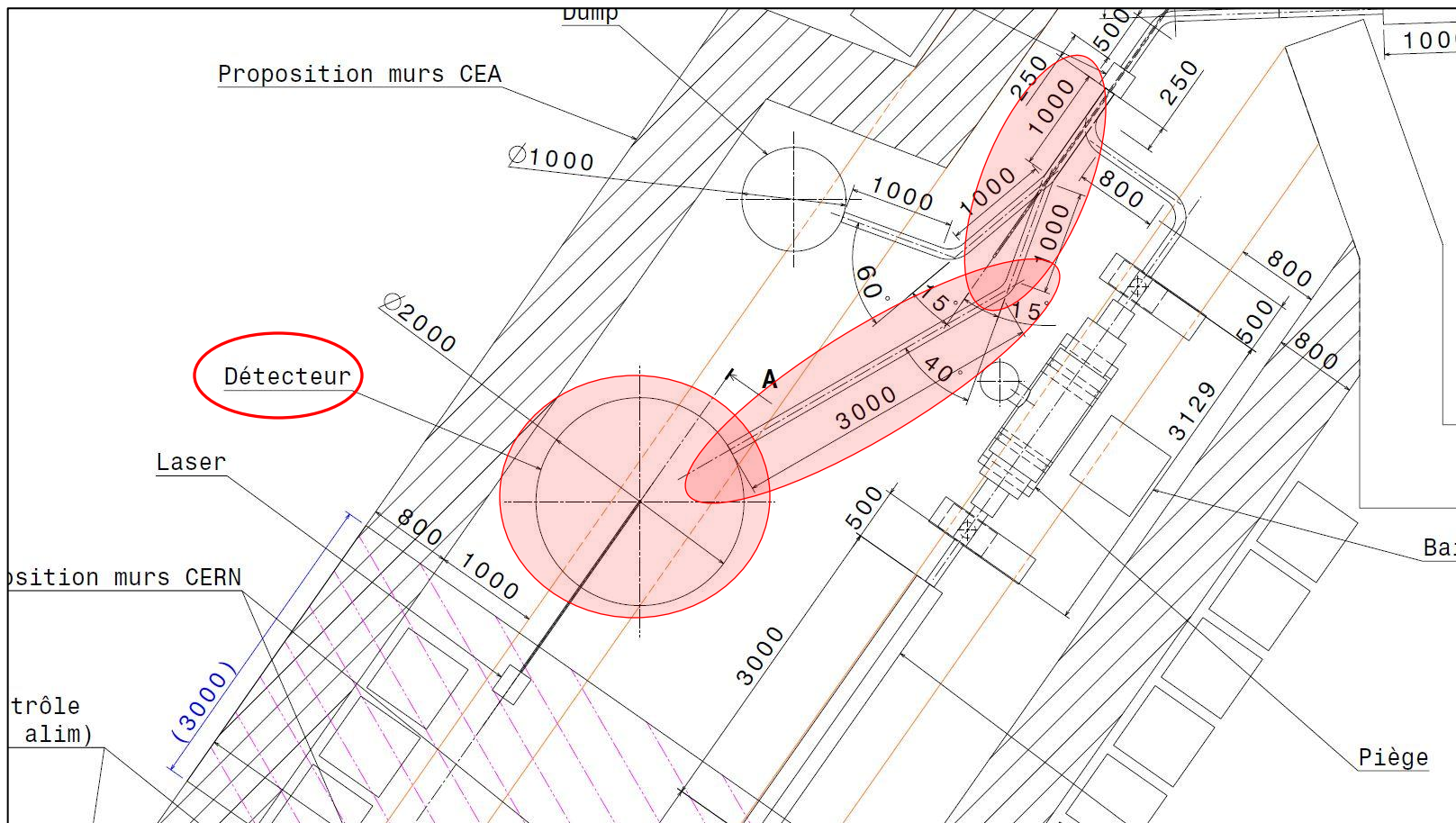

DéTECTEUR

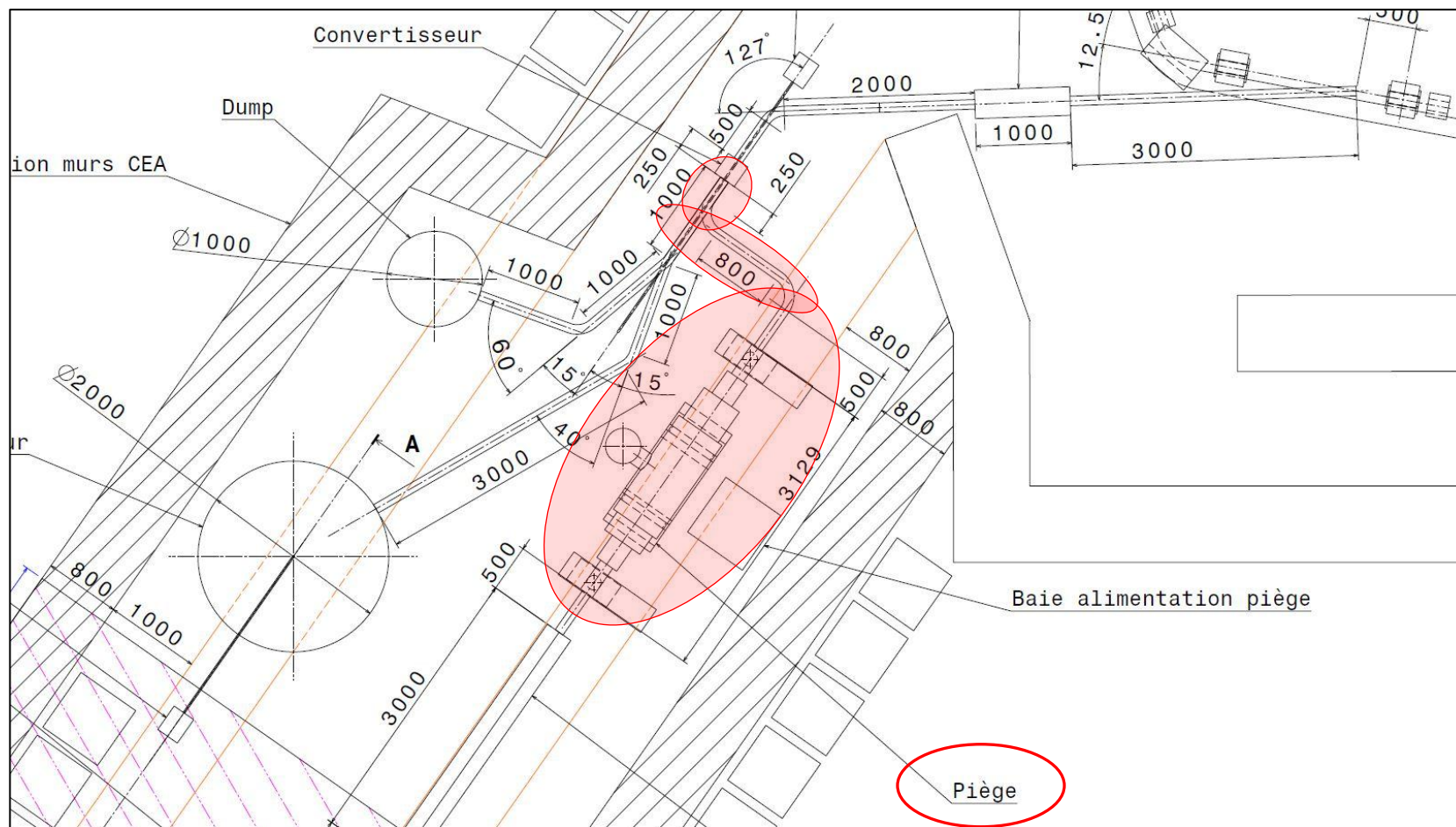

Piège

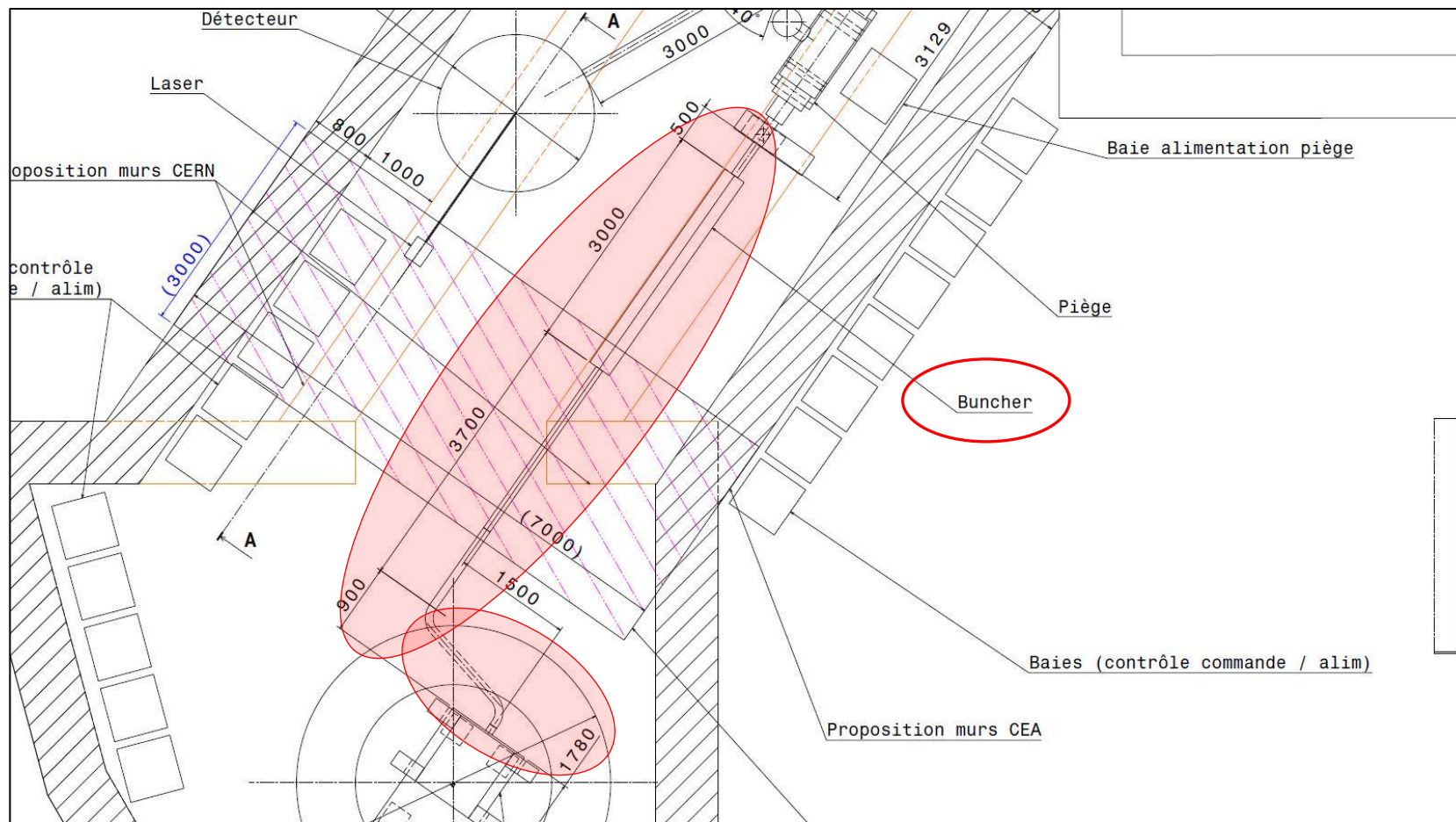

Buncher

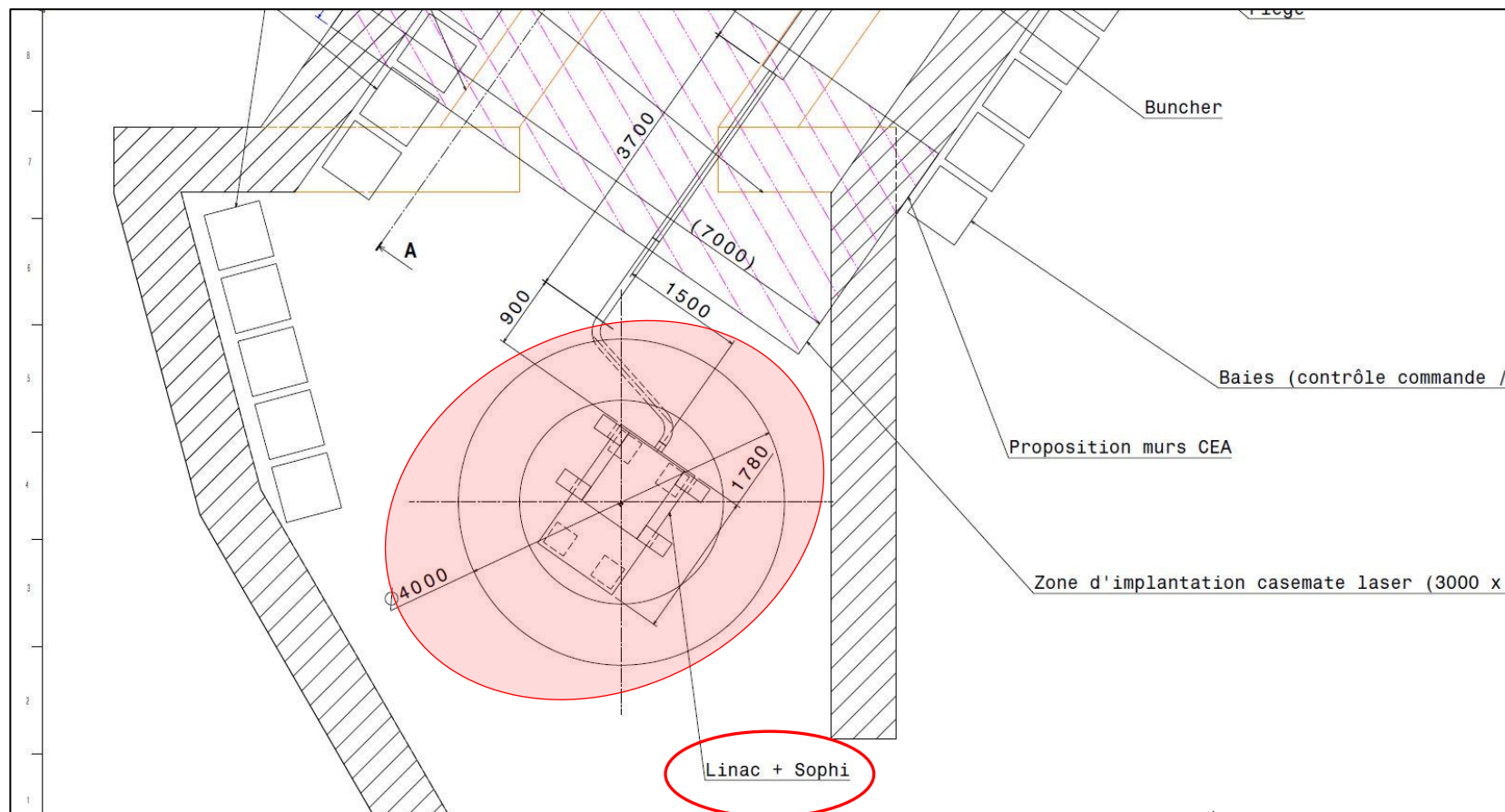

Linac

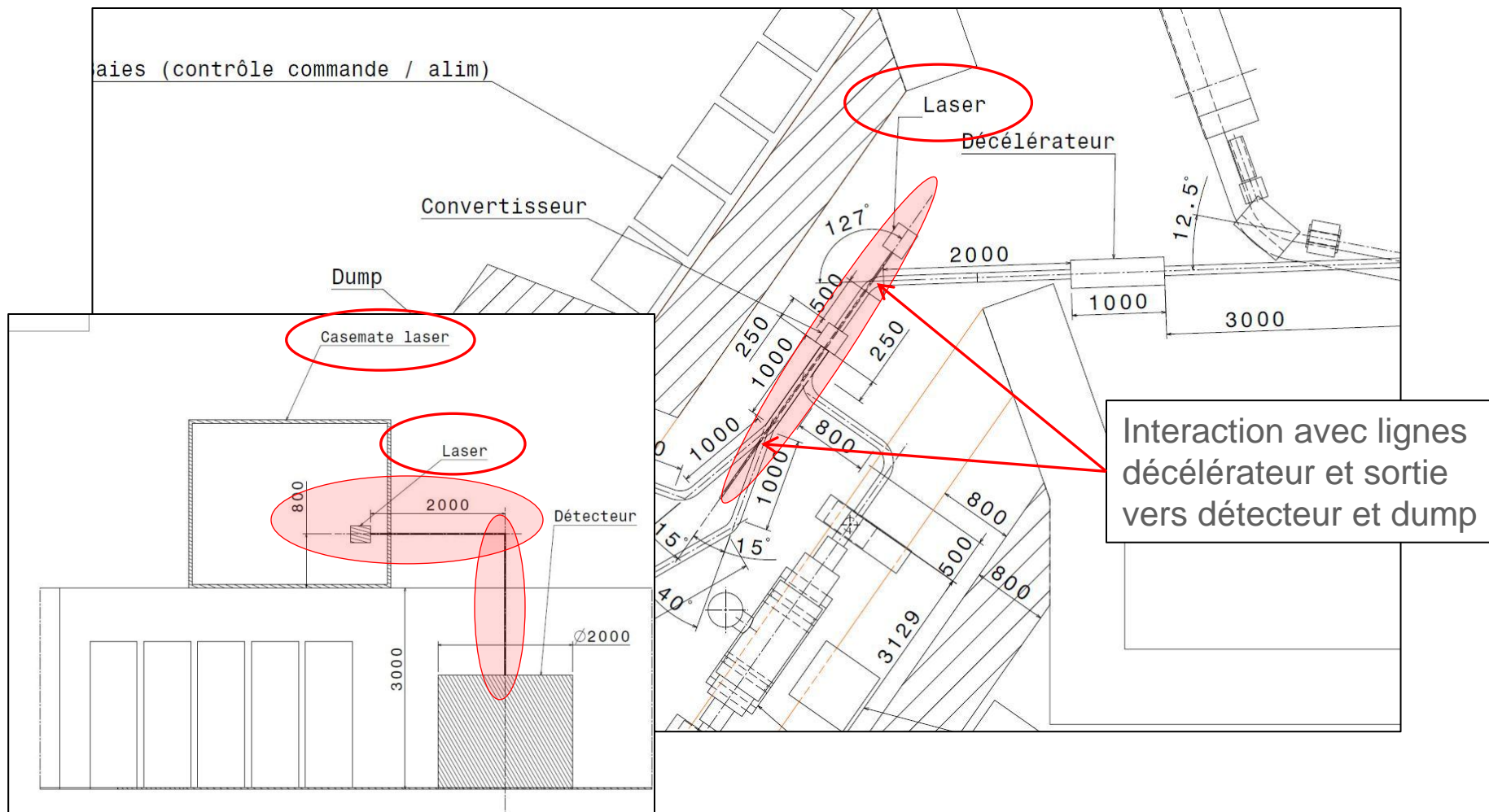

Lasers et casemate

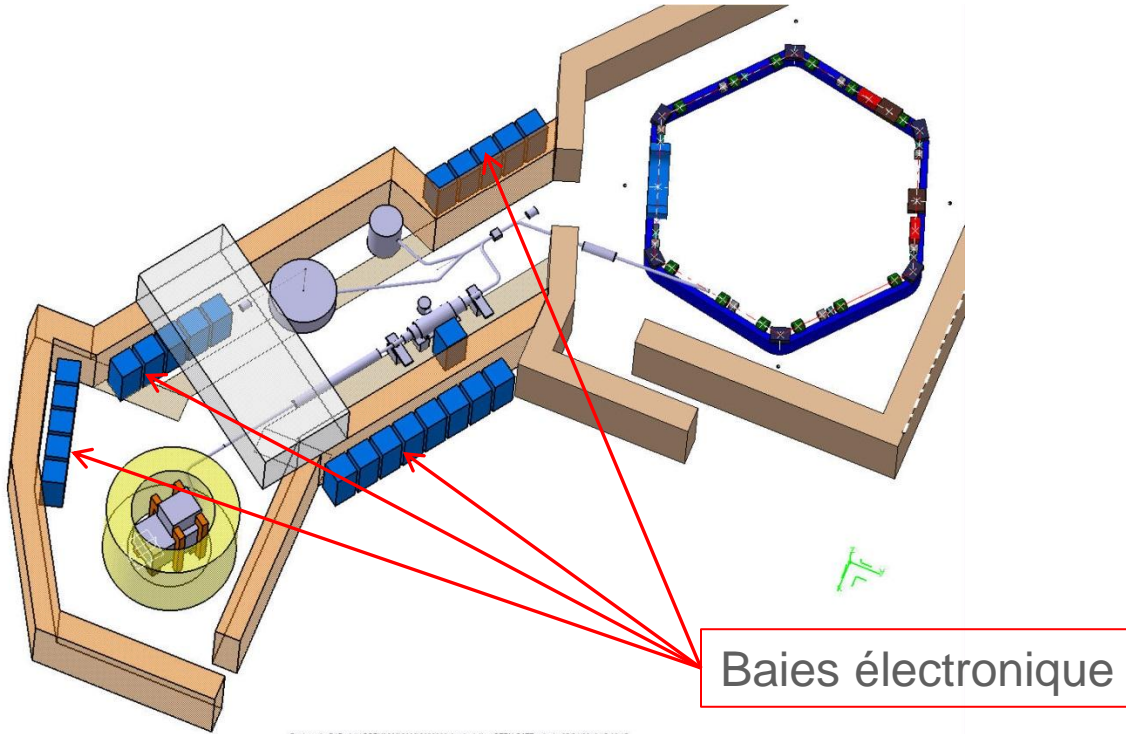

Implantation baies

