

Site Report GSI Beijing Fall 2012

Walter Schoen, GSI



News from GSI – FAIR project



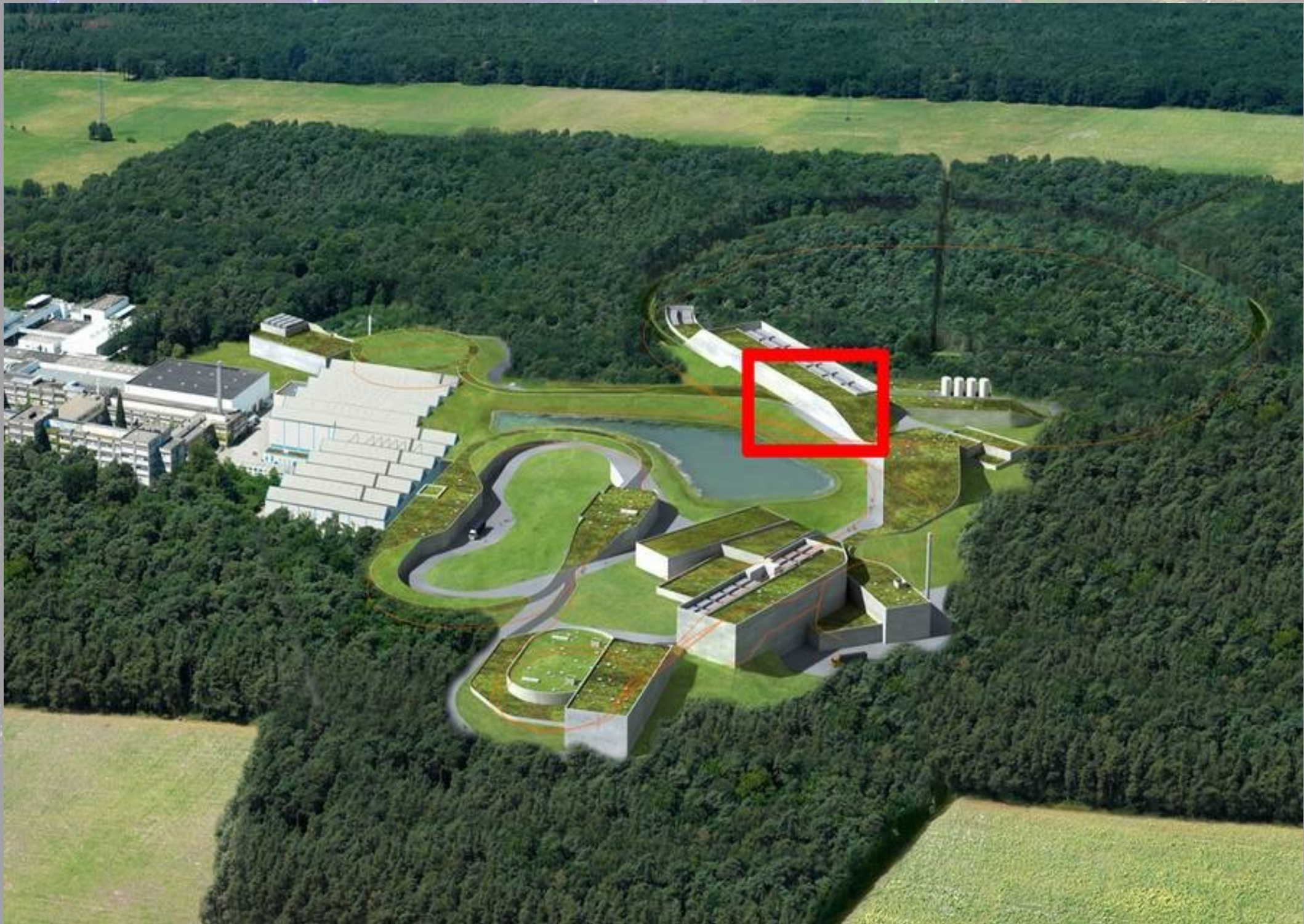

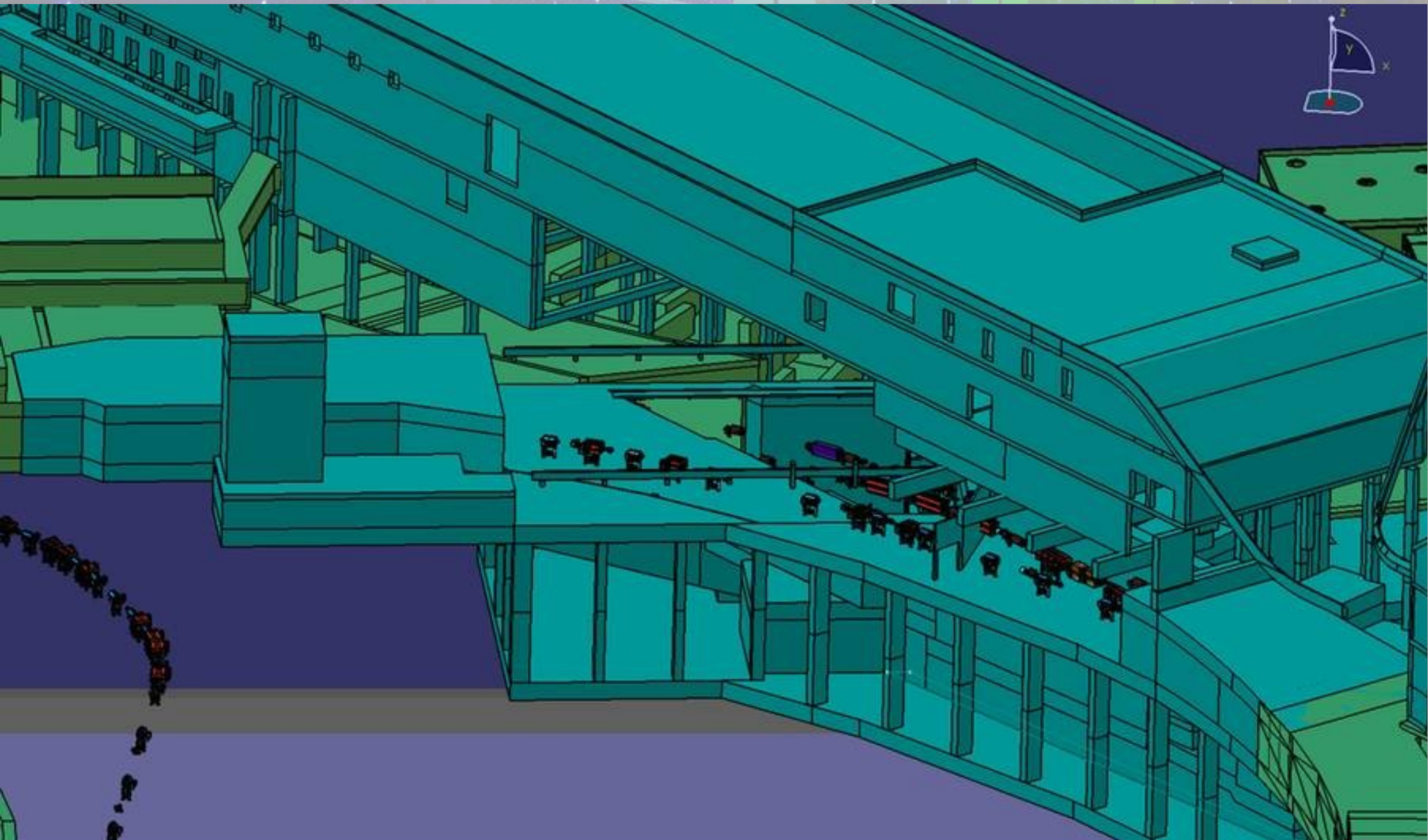



=> „real work“ is going on :-)

News from HPC Department - new people :-)



- new people :-)

- Victor Penso (jan 2012)
- Matthias Pausch (IT Security/HPC, April 2012)
- Birgit Alborea (HPC, July 2012)
- Thomas Stibor (HPC, September 2012)
- Matteo Dessalvi (HPC) (October 2012)



Thomas Stibor



Matthias Pausch

News from Prometheus / Hera

- Prometheus: The IB cluster, Hera: The IB lustre
- Users are happy :-), IB works very stable, lustre is stable (some incidents with aged lustre hardware)
=> migration of users to Prometheus
- 2048 cores from Prometheus reserved for lattice tests
 - ongoing performance tests with lattice QCD on „bulldozer“ CPUs
=> needs optimization
 - will be test cluster for „wheezy“ release (improved FP's)
 - will be test cluster for slurm scheduler
- GE: ok for our 10.000+ core cluster however there are open questions
 - good for massive parallel jobs? => (network topology support)
 - scalability good for 300.000+ cores?
 - future of GE?

News from lustre, II

=> /hera will be growing :-)

What is the future of /lustre - the ethernet lustre?

- Still 1.7 Petabyte, will loose capacity due to migration of the „new“ OSS (less than 3 years old) to Hera, the IB lustre
- Will loose capacity due to aged hardware, data on RAID 5 OSS will be migrated to RAID6 OSS, Then final shutdown of RAID 5 ... :-) next months
- There will be still (reduced) capacity for the ethernet cluster

FAIR HPC Backbone \square 1TB/s

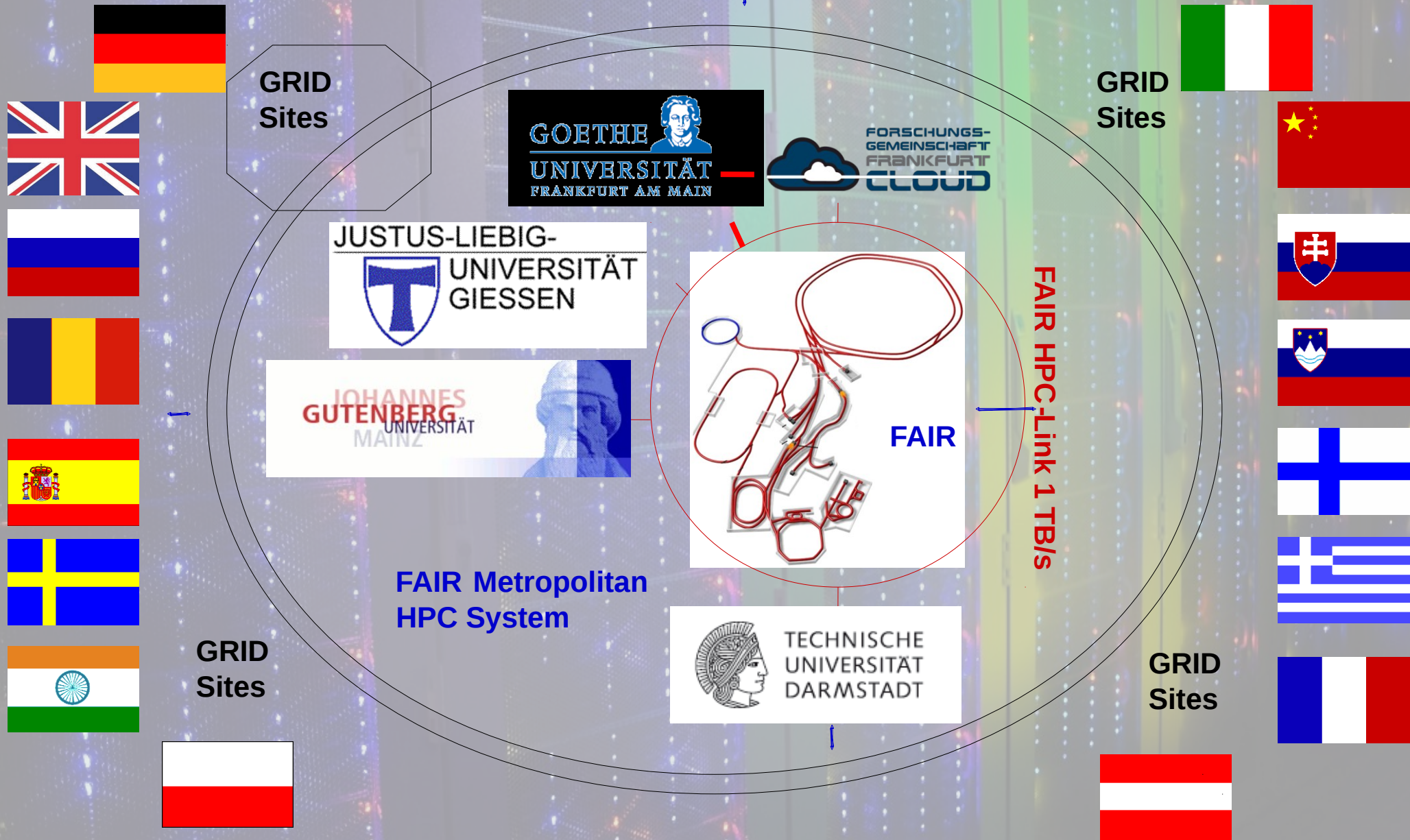

Connecting Loewe-SC (Frankfurt) with Hera:

- Building HPC router cluster (LNET) for the TeraLink 12 x 10 Gbit Ethernet => lustre IB loadbalacing

=> details: Thomas, lustre talk tuesday

TeraLink
GSI - LoeweCSC

120Gbit => lustre

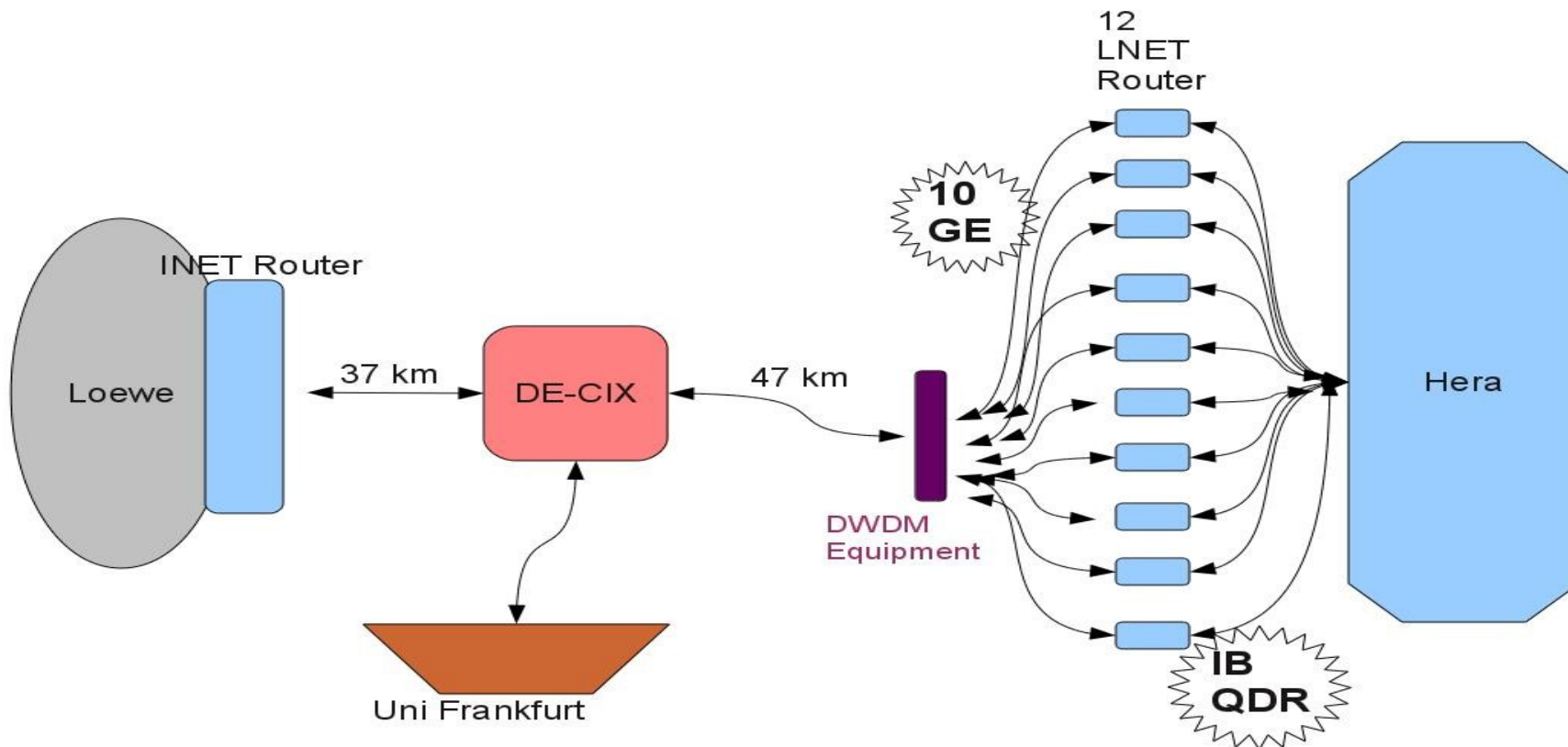

New Developments

How to connect sites with different GID and UID space?

- Mapping of „outside“ GID/UIDs into a virtual lustre space (kernel)
=> Thomas (Stibor) merged newest lustre code 2.3xx with Kerberos 1.10.x + mapping features, creating Debian (Wheezy) packages
 - „Kerberized“ communication between MDS and OSS on the test system is already working :-)
- => test with clients + performance measurements necessary
- Git: https://github.com/stibor/lustre-kbr/tree/b2_3-kbr

New Windows Domain Structure

=> launched by IT Security eliminate some „aged“ structure (e.g flat domain structure)

- **Common project of IT Security, Core IT (Windows,Network), HPC**
- **Hierarchical domain structure**
- **Introducing PKI, strong authentication, smart cards encrypted documents, key recovery**
- **VMs based on KVM (Linux), secured by Linux FWs
=> Kernel SamePage Merging + live migration**