

# LIU-PSB

INTEGRATION LIGNE BI  
SITUATION ACTUELLE

## SCAN ZONE INJECTION



PLUSIEURS ZONES MAL DEFINIES

## INFRASTRUCTURE ZONE INJECTION

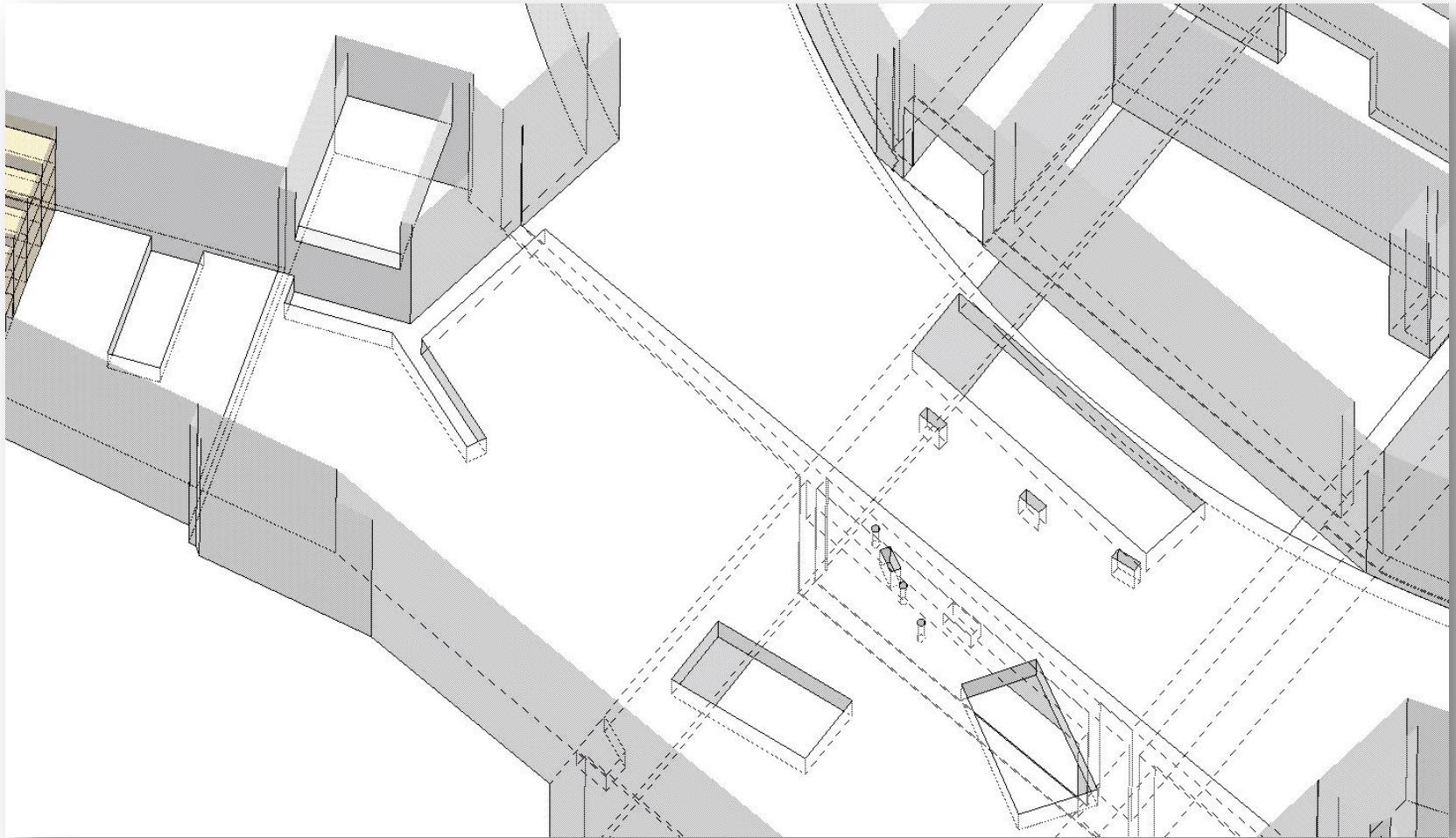

PAS DE MODELES 3D POUR:

- CABLES ET ECHELLES A CABLES
- CIRCUIT EAU + AZOTE
- FAUX PLANCHERS (CAILLEBOTIS); ESCALIER METALLIQUE

# ELEMENTS MACHINE ZONE INJECTION

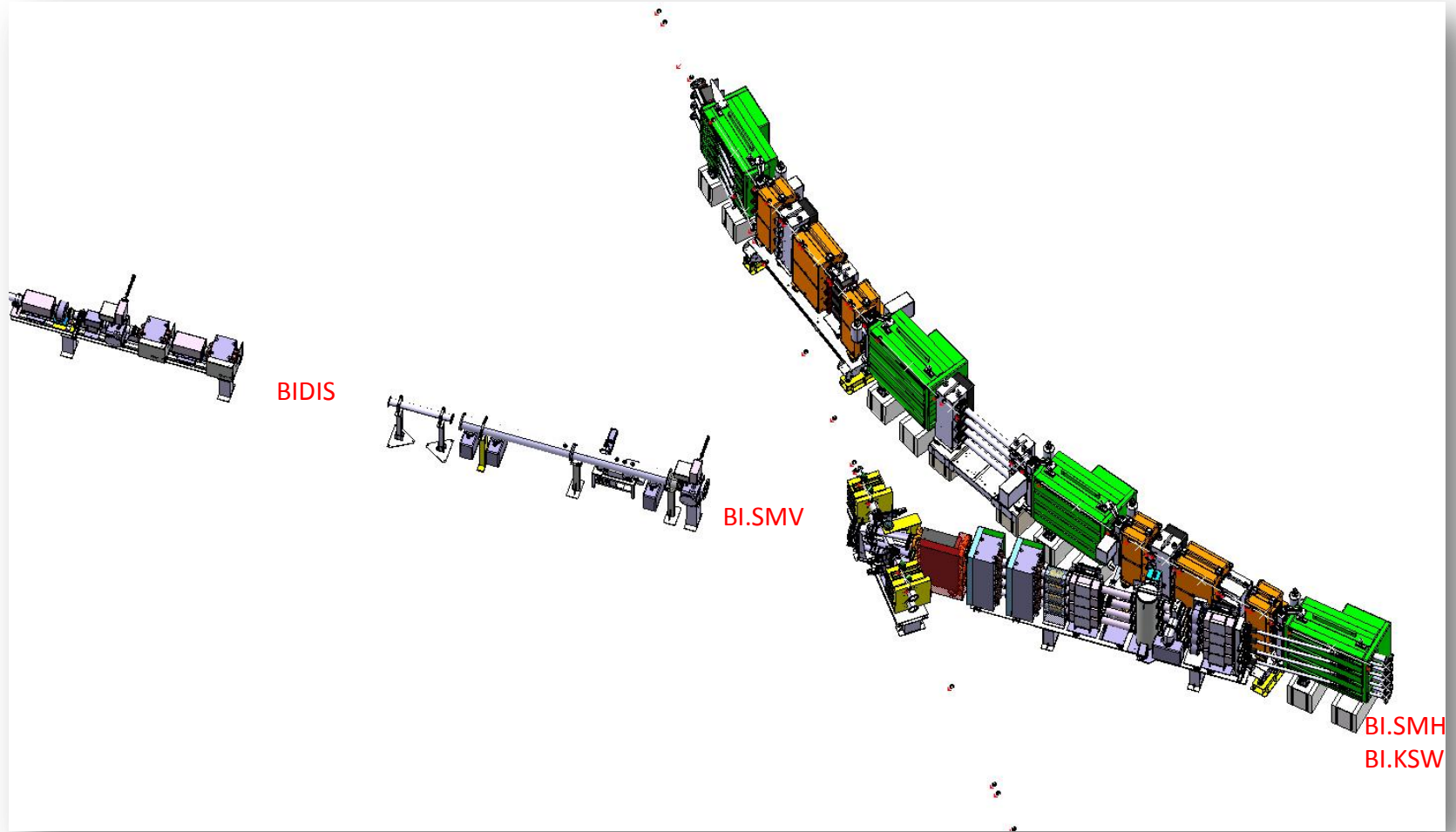

QUELQUES ELEMENTS NON MODELISES



GENIE CIVIL + ELEMENTS MACHINE + SCAN



# NOUVEL AIMANT BI BVT

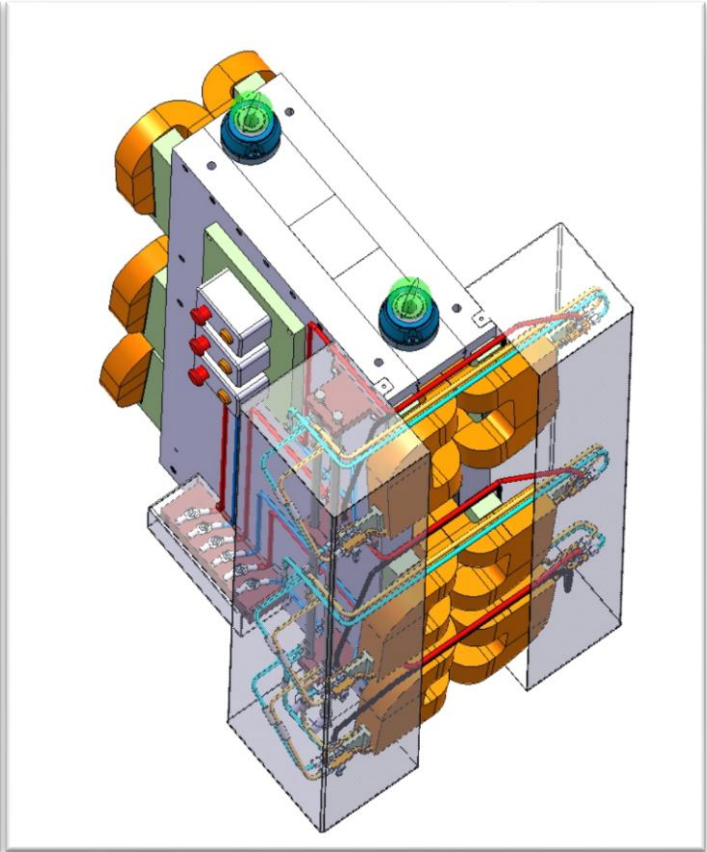
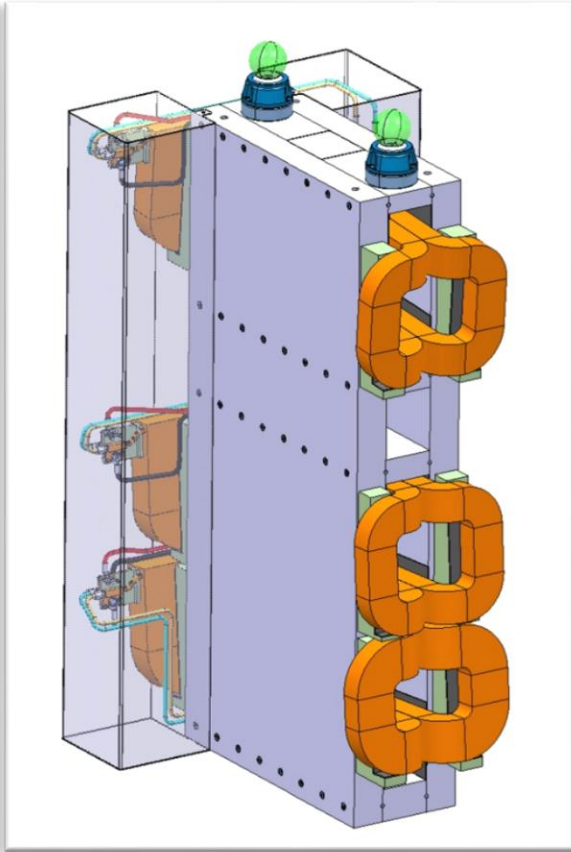
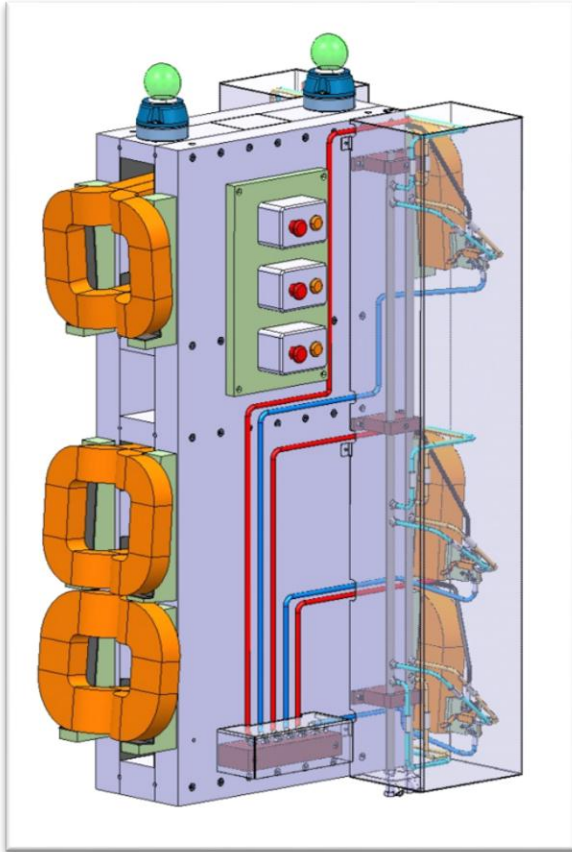



NOUVEAUX PICK-UP's  
UMA20; UMA30; UMA40; UMA50

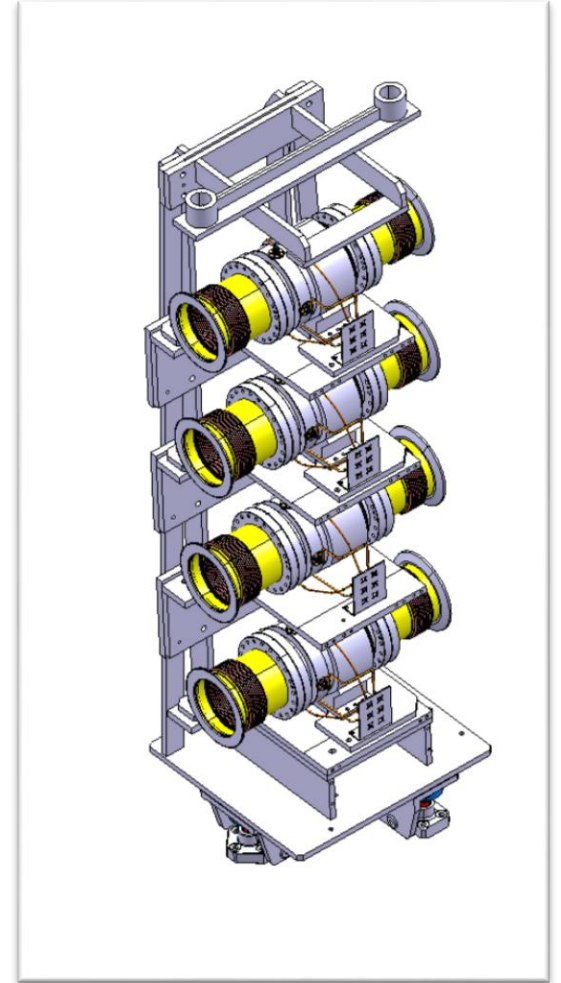
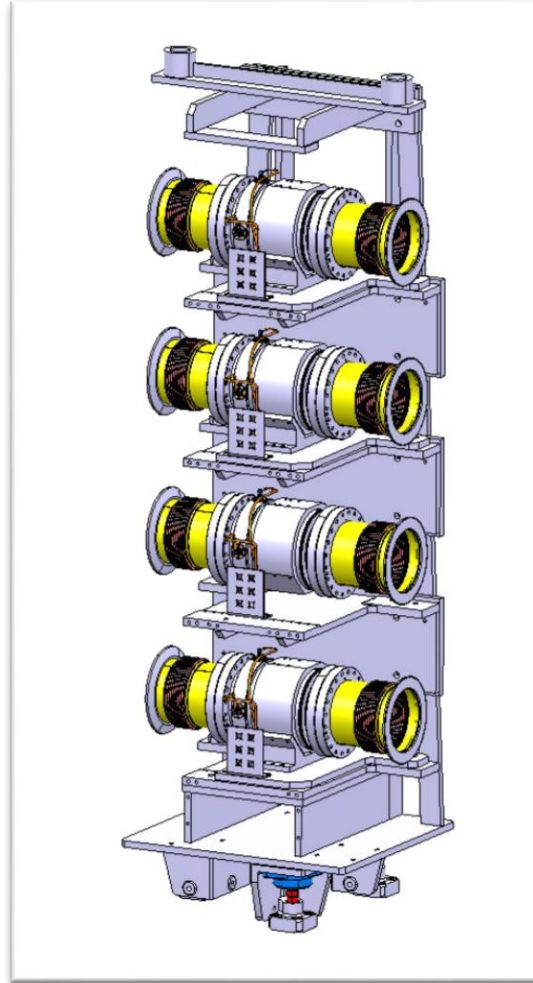
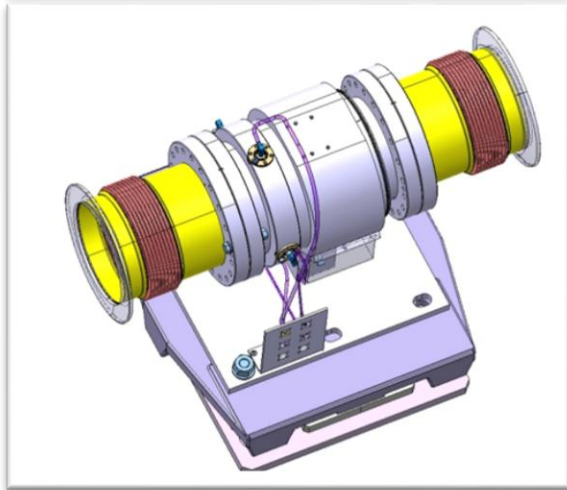
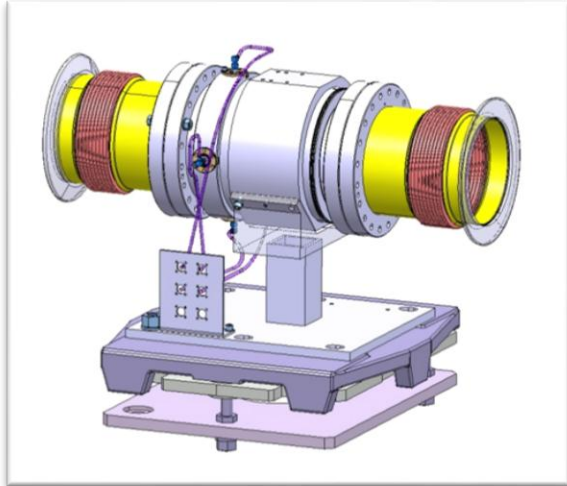

NOUVEAU BI. DIS

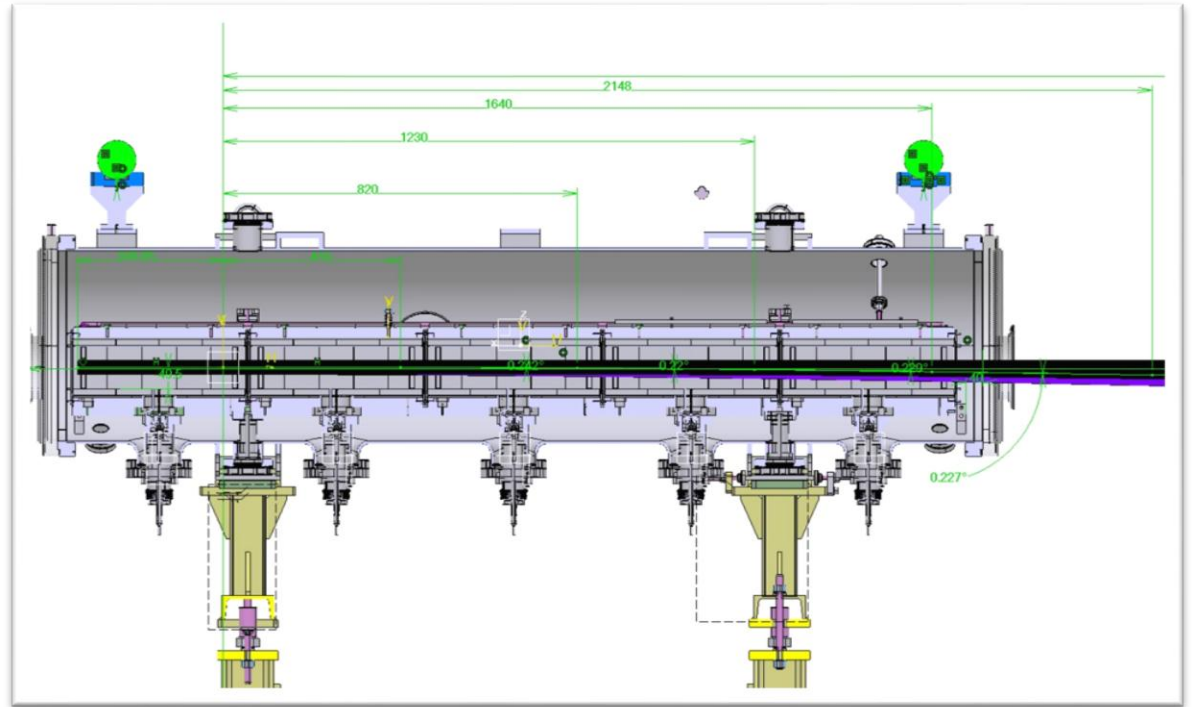
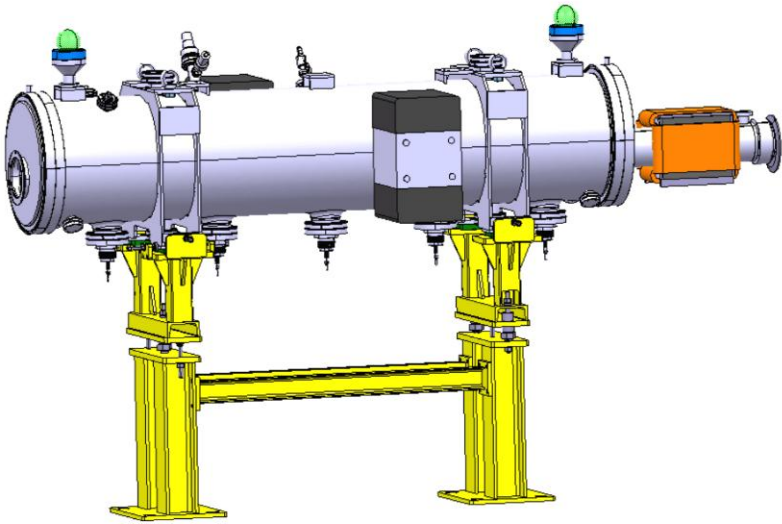



NOUVELLE SECTION DROITE 01

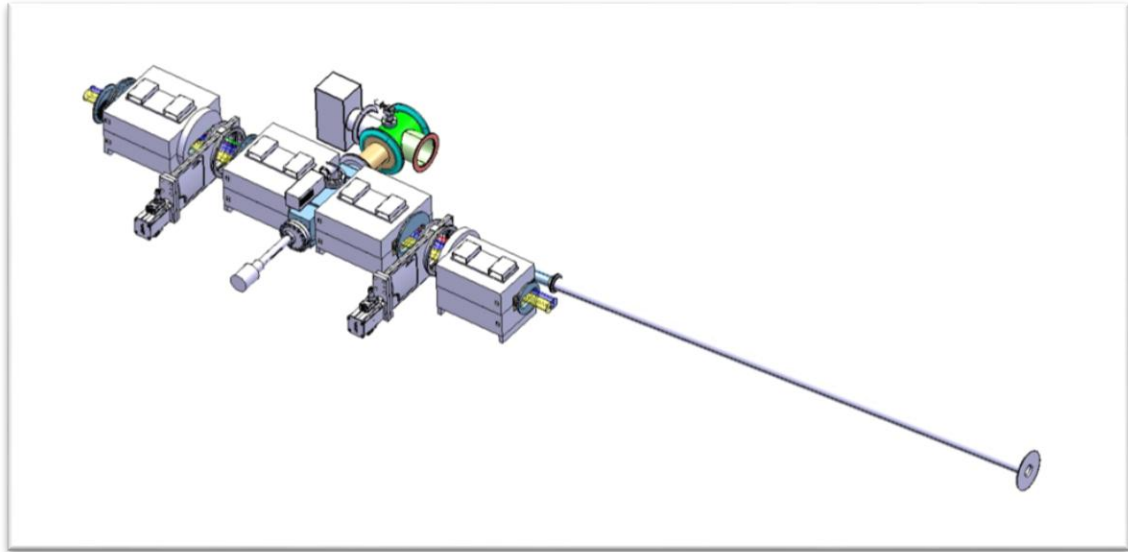
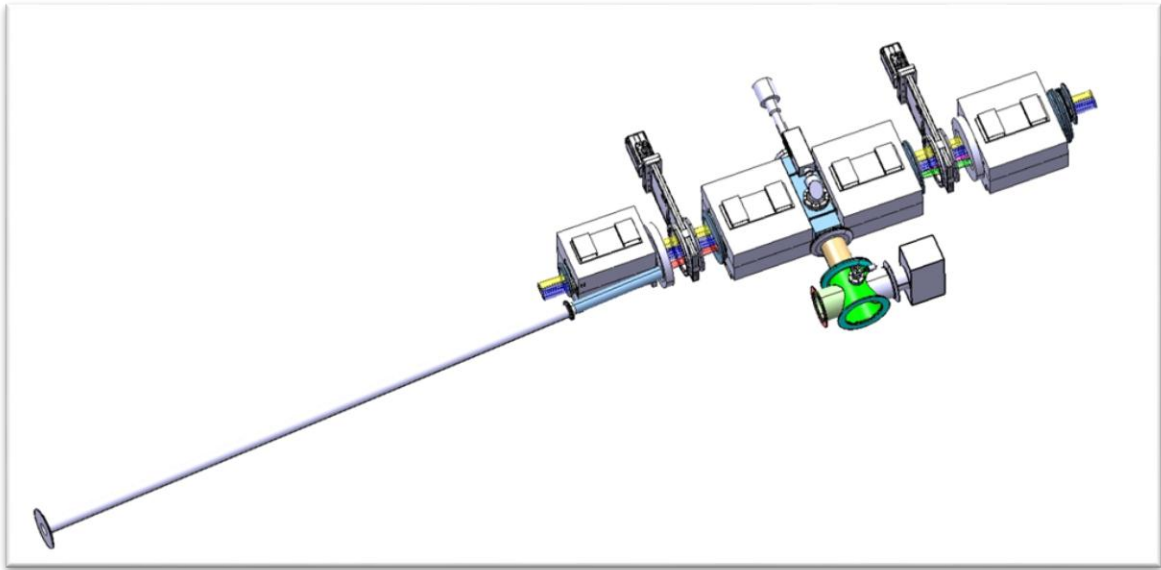

NOUVEAU BI. SMV

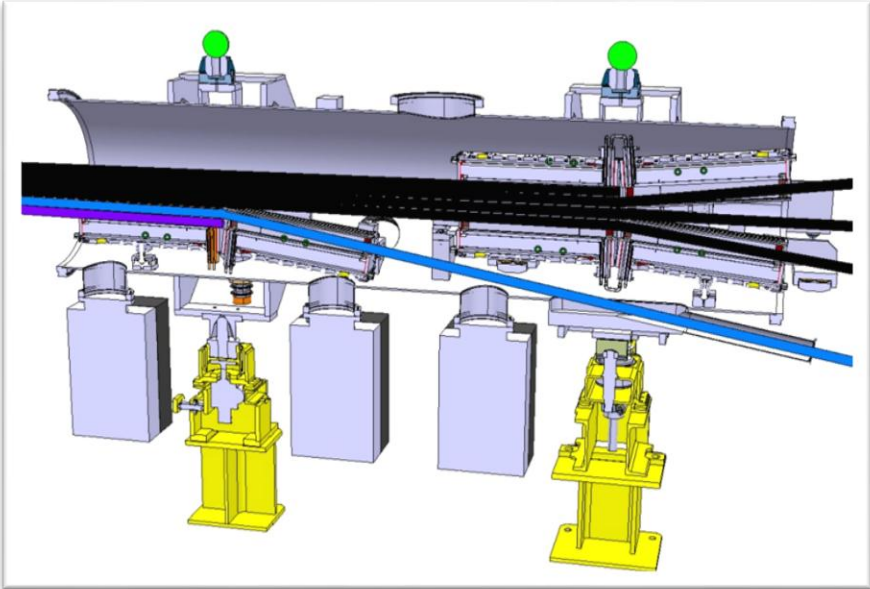
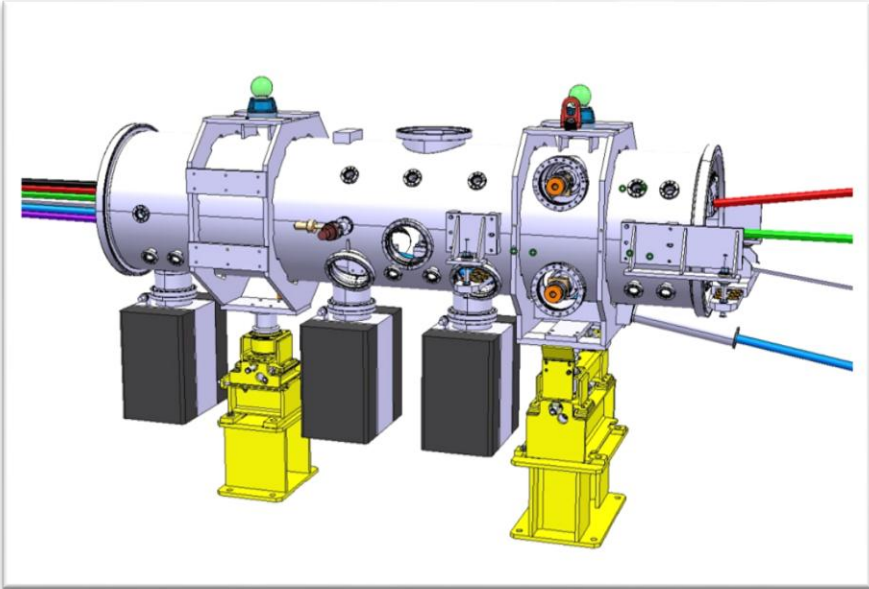

# NOUVELLE CONFIGURATION

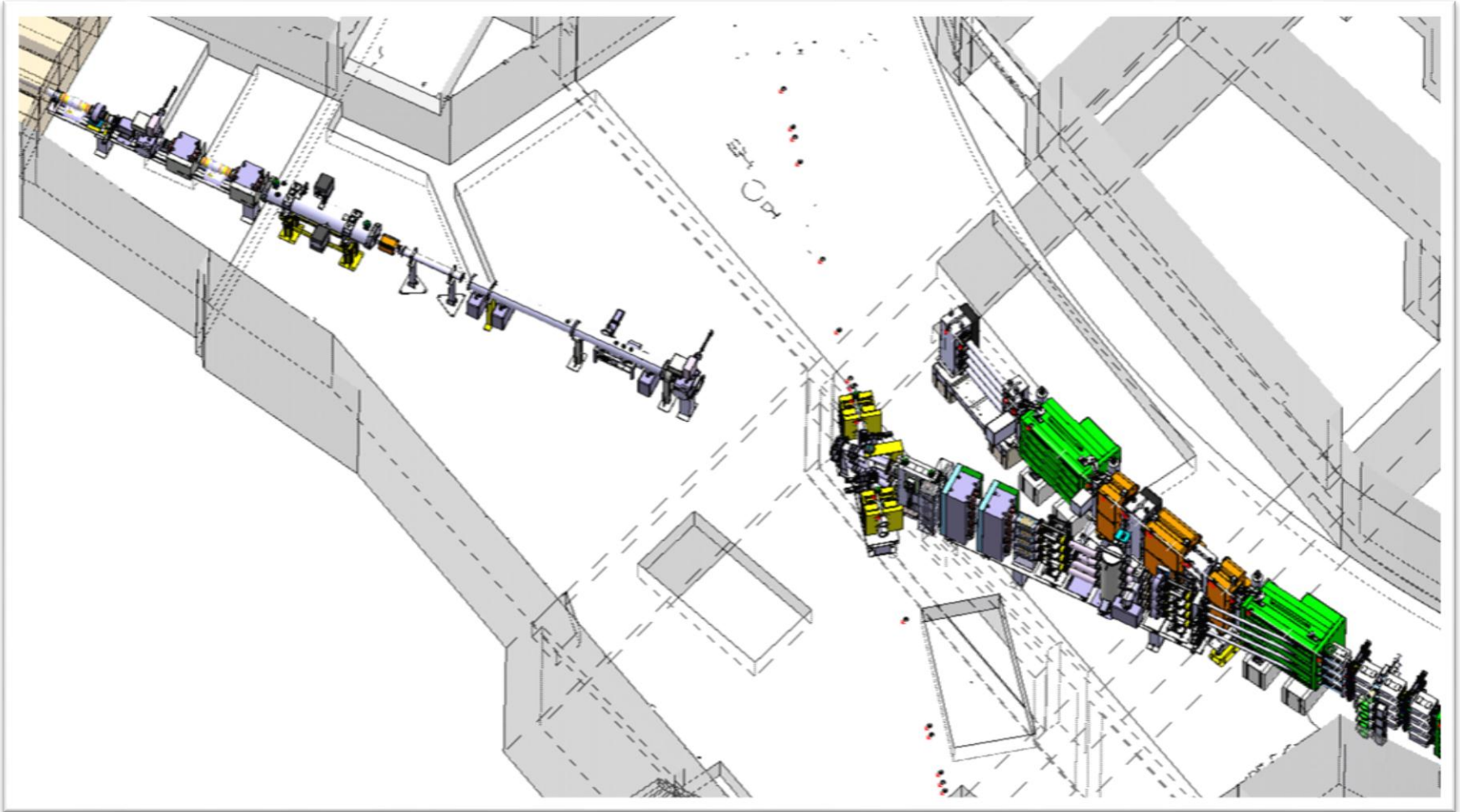



NOUVELLE CONFIGURATION  
UMA20; UMA30; BI DIS

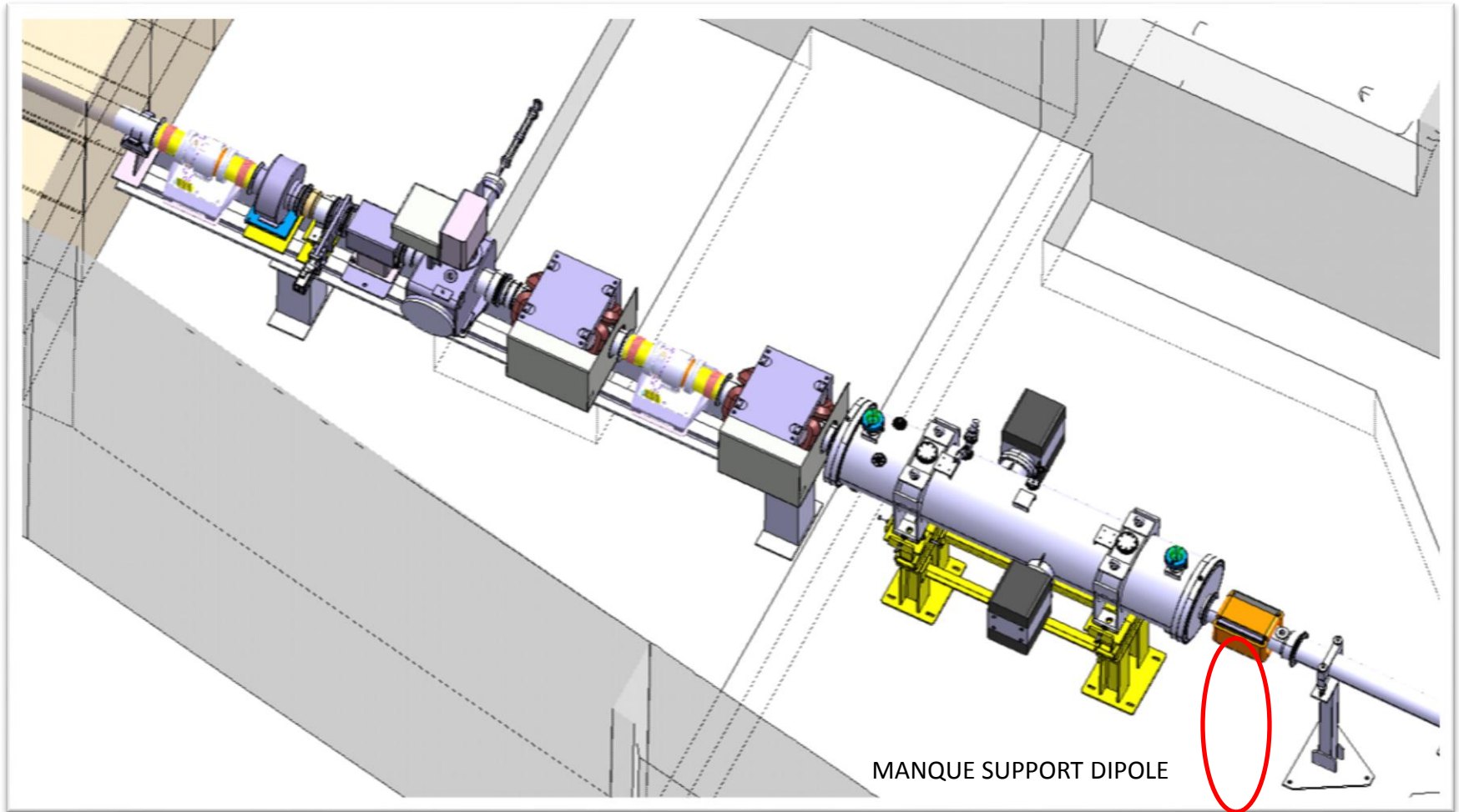

NOUVELLE CONFIGURATION  
BI BVT; UMA40; UMA50

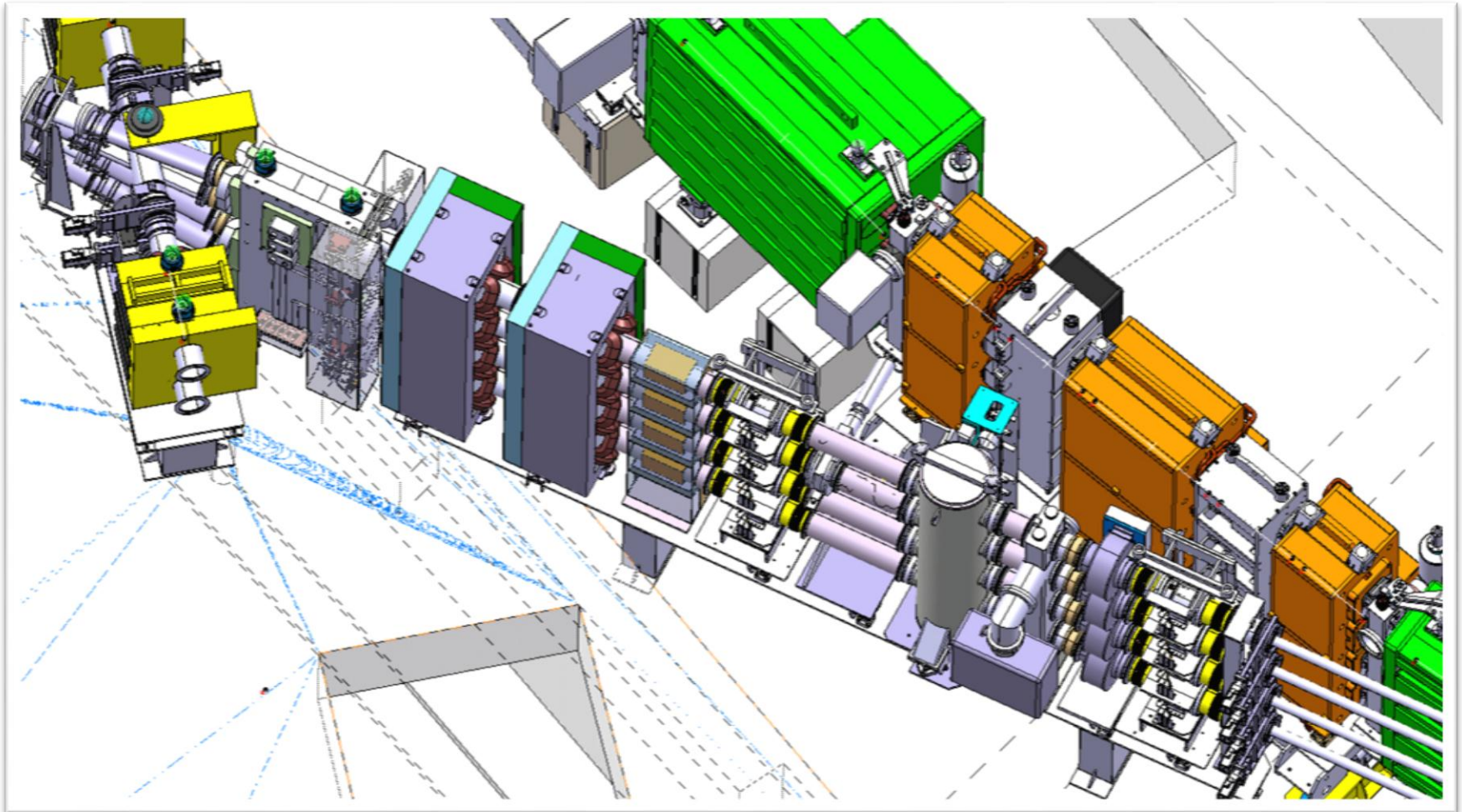



NOUVELLE CONFIGURATION BI BVT

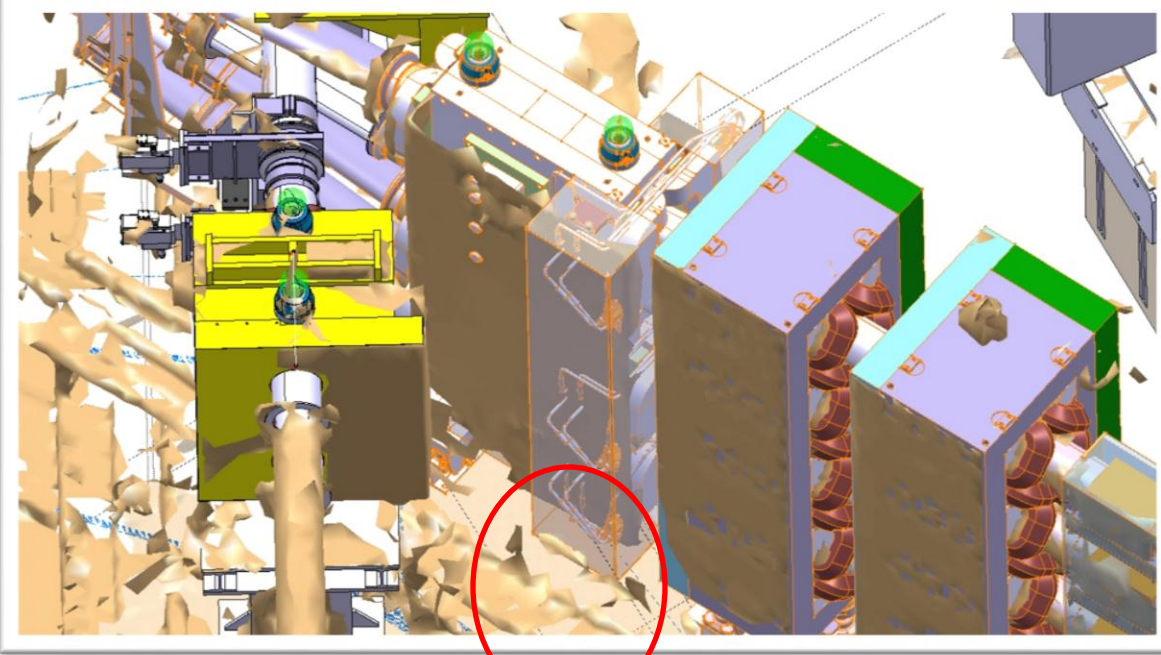

ACCESSIBILITE JOINTS ET COLLIERS ??

ZONE A CONTROLER  
(CONNEXION EAU)

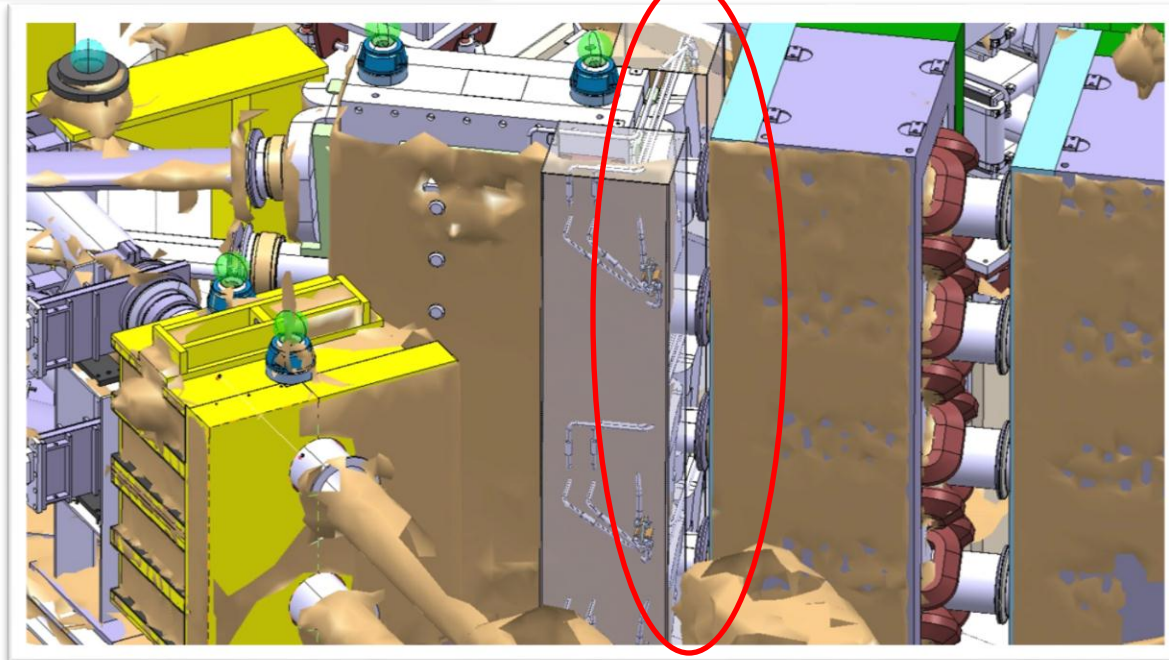



NOUVELLE CONFIGURATION  
SECTION DROITE 01 ET BHZ 162

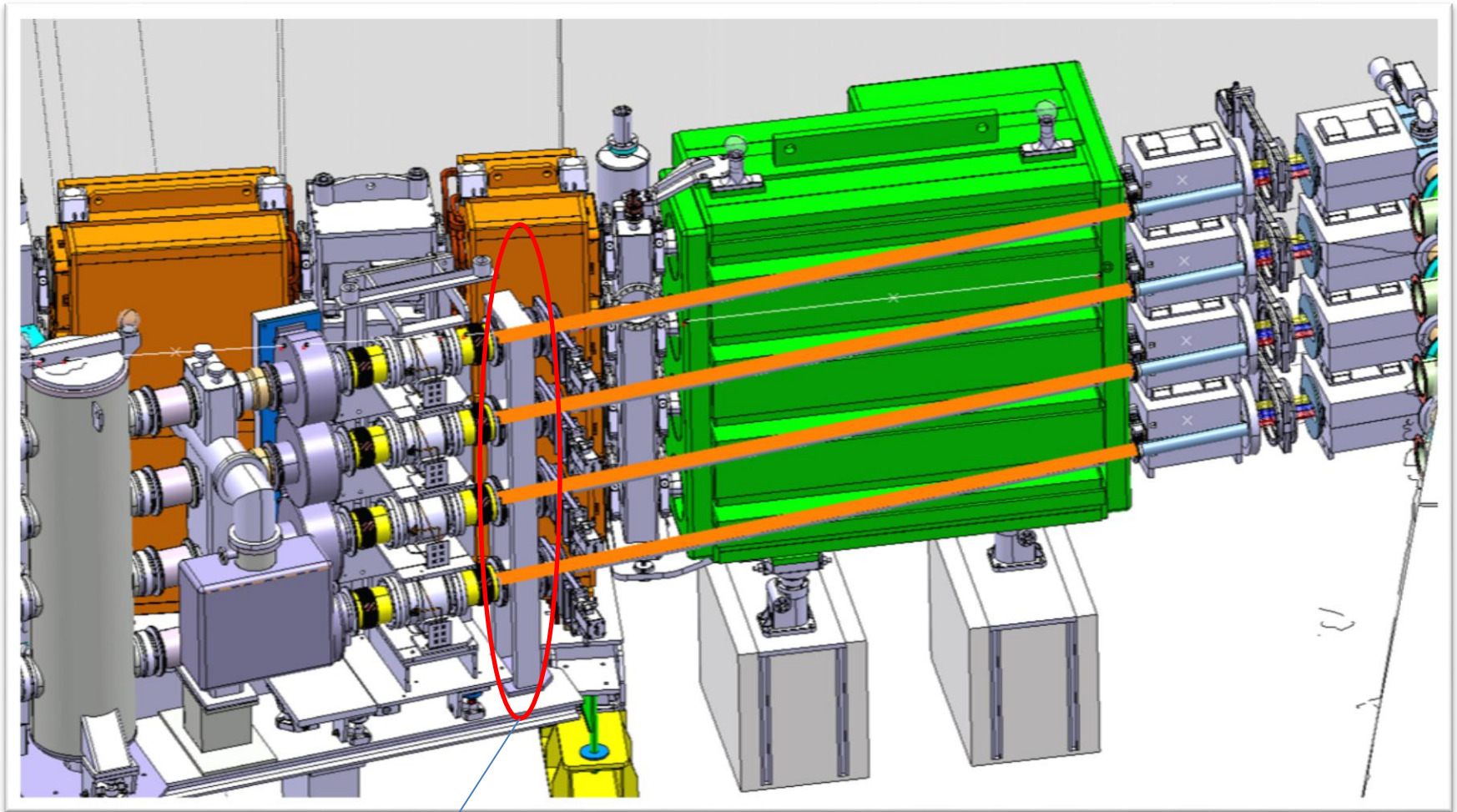

CHAMBRE A VIDE TROP LONGUE

NOUVELLE CONFIGURATION  
SECTION DROITE 01

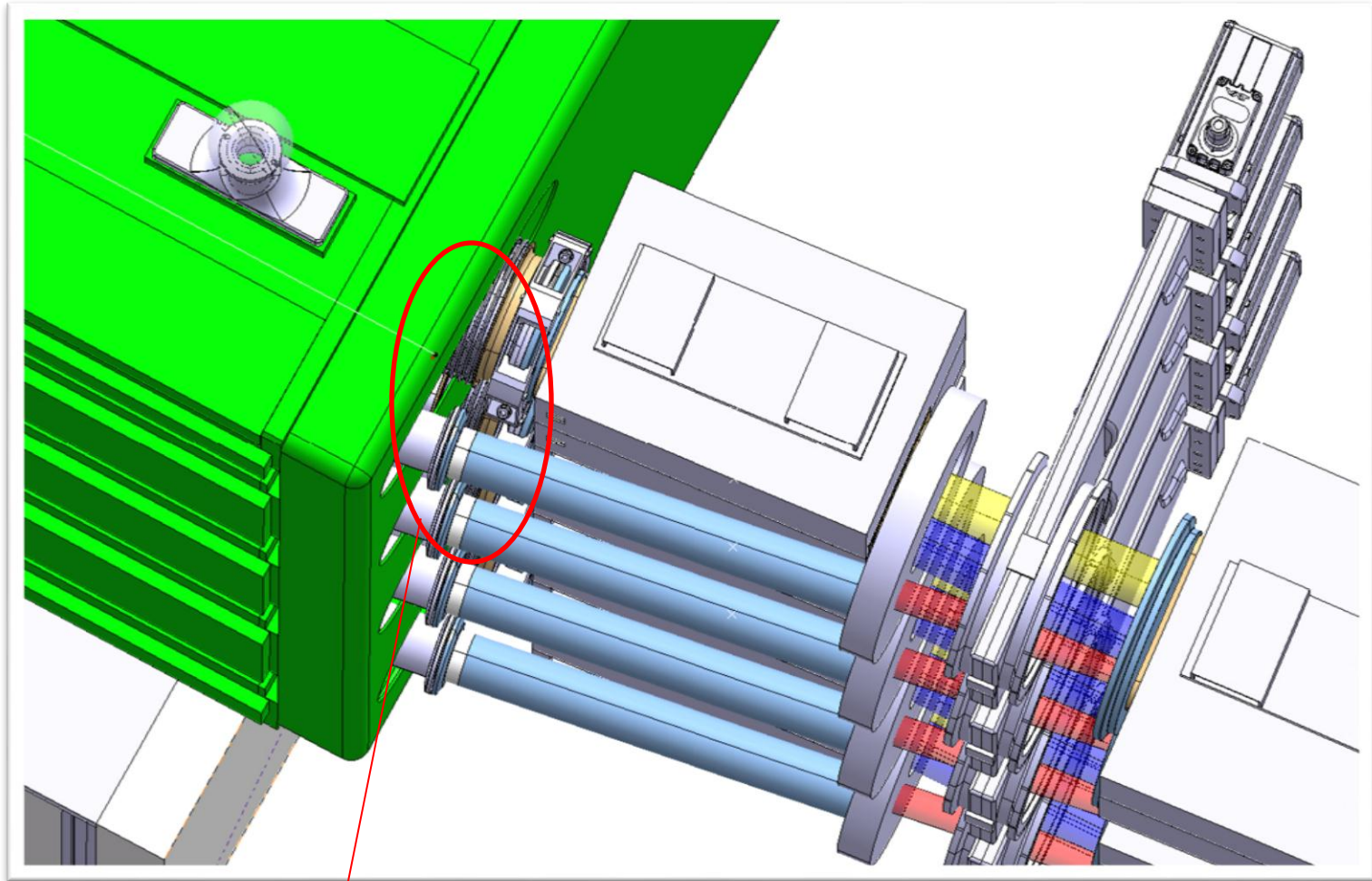

CAPOT A MODIFIER; MONTAGE COLLIER!



NOUVELLE CONFIGURATION  
SECTION DROITE 01

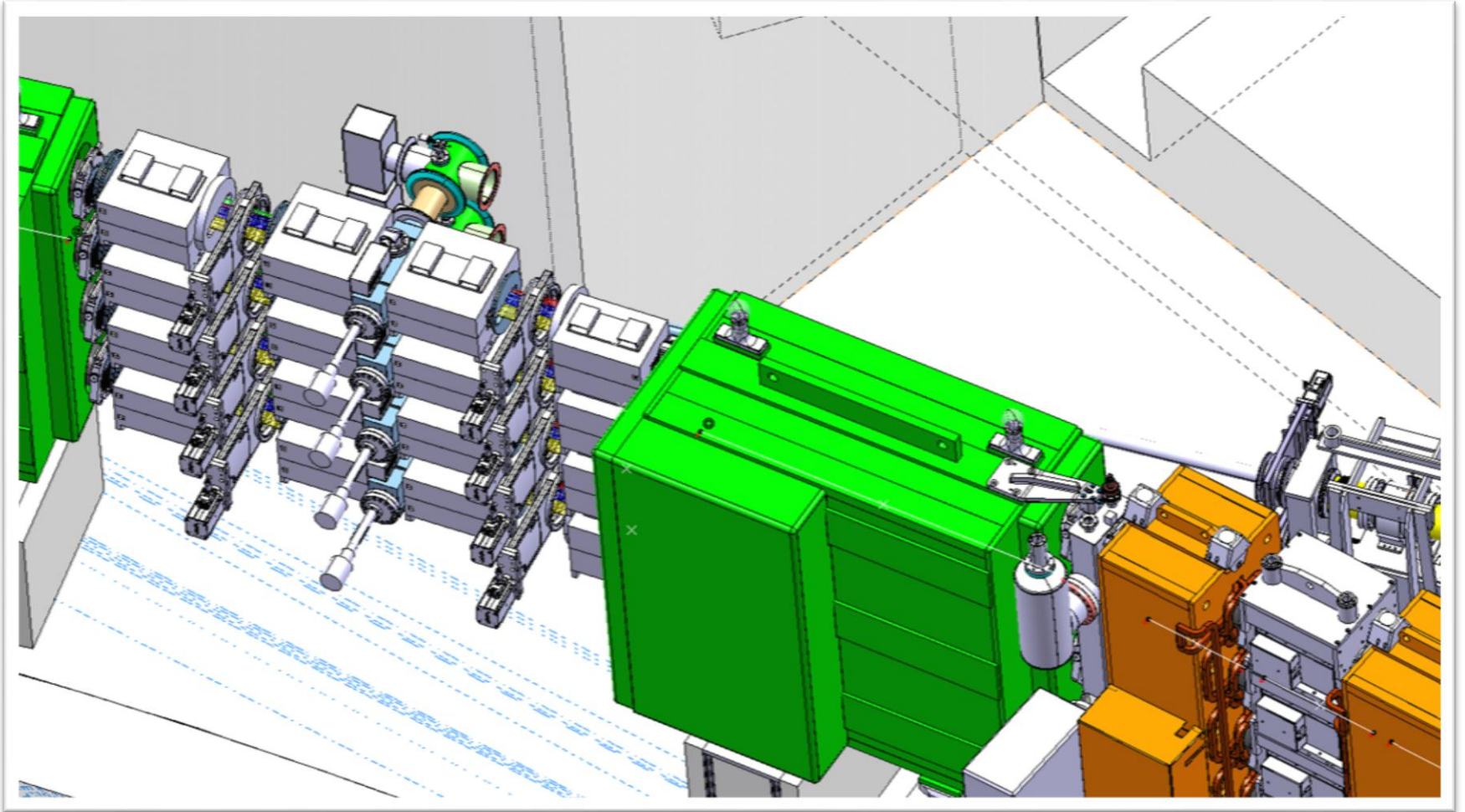



# RESUME

ATTENTE DU "SCAN" COMPLEMENTAIRE

PAS DE MODELES 3D POUR:

- CABLES ET ECHELLES A CABLES (EN/EL)
- CANALISATIONS *Eau déminéralisée, eau de ville, azote* (EN/CV)
- FAUX PLANCHERS (CAILLEBOTIS); ESCALIER METALLIQUE (GS/SE)

MANQUE DE REFERENCES EN COORDONNEES CERN POUR IMPLANTATION PRECISE DE BI.DIS ET BI.SMV

NECESSITE D'ETUDIER LE SYSTEME VIDE DE CETTE LIGNE DANS "SON ENSEMBLE"

SUPPORT BI.DHZ/DVT40 A ETUDIER

MODELES 3D POUR NOUVEAUX ELEMENTS:

- BI.MQNDB50 et BI.MQNDB60
- BI.DHZ/DVT50
- BI.DHZ/DVT70 ?

PREVOIR MODIFICATION BI.MTV30 et CHAMBRE A VIDE EN AMONT