

SAFETY TRAINING FOR THE PH DEPARTMENT

Making sure that people coming into areas under your responsibility are competent.

Three levels of training :

- Induction (SC)
- Specific (PH)
- Specialised (PH)

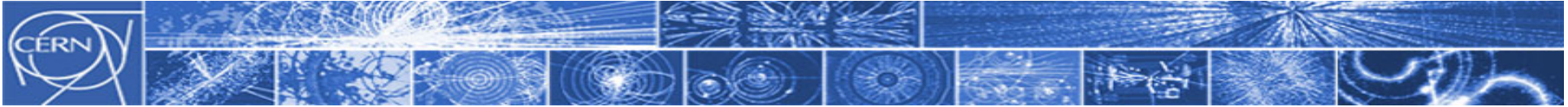

SAFETY TRAINING AND THE TSO

The TSO is a key player who has responsibility and authority for Safety in a given area.

The TSO training course (3 days) gives a sound basis, complimented by local knowledge and experience

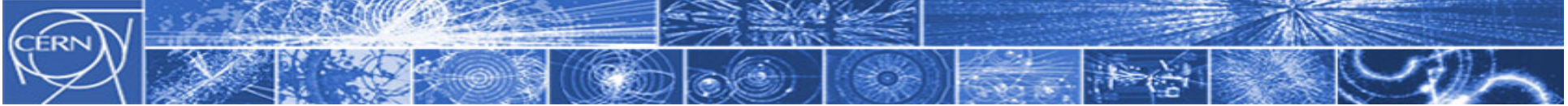

WHAT'S NEW ?

Training guide for Group Leaders In Matters Of Safety The GLIMOS

A training package designed to meet the needs of GLIMOS :

Flexibility, training in the work place, small audience.

Good results with over 20 GLIMOS now trained.

<http://ph-dep.web.cern.ch/ph-dep/Safety/Training/GlimosTrainingList.asp> 3

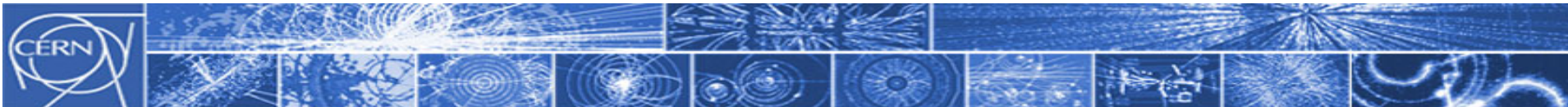

- Physics
- Organization
- Info & Communication
- Policy & Procedures
- Services
- Safety**

- Safety
- Structure
- Safety Office
- Safety Plan
- Glossary

GLIMOS TRAINING:

The GLIMOS is the most important person for the safety of his experiment and has complete authority over personnel and equipment in all matters that concern safety of the experiment. To facilitate the work of the GLIMOS a short training course is available which contains practical information for the safe running of your experiment. The information given is based on the "Safety Guide for Experiments", SAPOCO 42, and the A5 Safety Code. [Contact C. Griggs](#) (73314, 163948 or Christopher.griggs@cern.ch) to organize a meeting.

Powerpoint presentation: [PH GLIMOS.ppt](#)

new [Trained GLIMOS \(list\)](#)

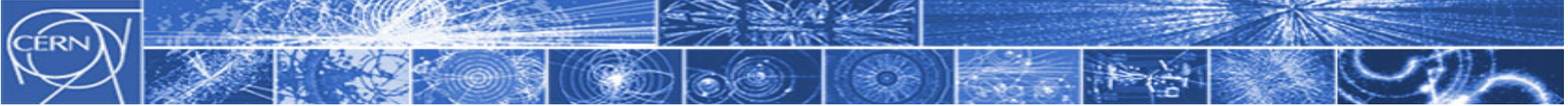

WHAT'S NEW ?

Laser safety training

(following C.SCHAEFER's request)

2 levels :

- Beginner
- Expert



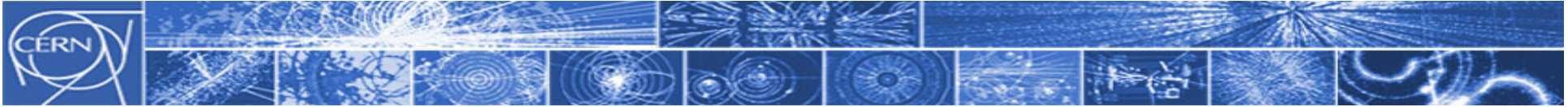

EVACUATION EXERCISES

The PH department has a total of 33 buildings for which evacuation exercises must be organised.

Building 28 has been used as a test to produce a standard evacuation exercise procedure.

Initial exercises will be carried out in collaboration and initiated by the PH safety office after which the TSO will take a leading role in organising yearly exercises.

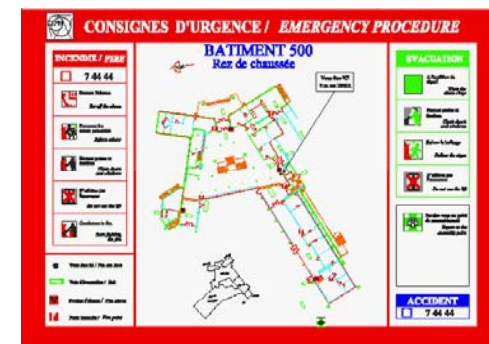

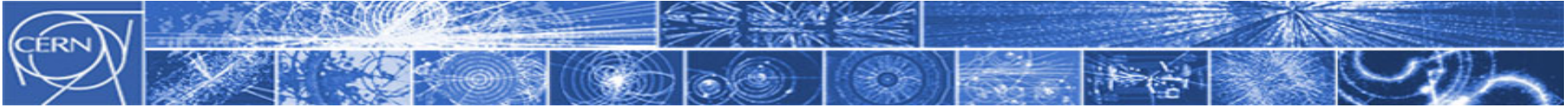

STANDARD PROCEDURE FOR EVACUATION EXERCISES



<http://ph-dep.web.cern.ch/ph-dep/Safety/EvacuationTest/EvacuationGuide.html>

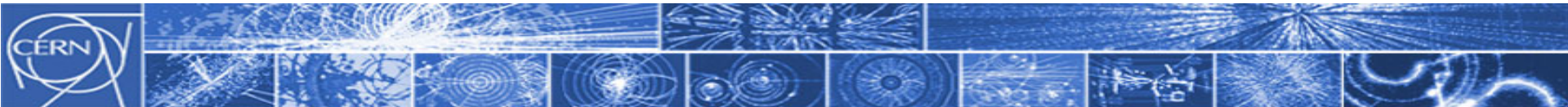

Physics Department

[PH Home](#) | [PH old website](#) | [Contact us](#) | [CERN Home](#)

Search

- [Physics](#)
- [Organization](#)
- [Info & Communication](#)
- [Policy & Procedures](#)
- [Services](#)
- [Safety](#)

- [Safety](#)
- [PH Safety Structure](#)
- [PH Safety Office](#)
- [GLIMOS](#)
- [PH Safety Plan](#)
- [Glossary](#)

Safety Office

PH-SO Responsible	C. Detraz	
Officers	C. Griggs	
	B. Pichler	
GLIMOS		
TSO CERN (sos)		
TSO's of PH (welcome to the 2 new TSOs since 31 oct 2007)		

Safety for experimental areas

- [new Safety Visits to experimental areas](#)
- [Safety Guide for Experiments](#)
- [new Flammable gas guidelines and registration](#)
- [The GLIMOS: ISIEC \(obligatory\); Blue Poster; Who's who \(under construction\)](#)
- [Beam schedule, Experimental areas, etc.](#)
- [Meetings and minutes](#)

Safety training

- [new GLIMOS Safety Training](#)
- [Laser Course](#)
- [new Evacuation exercise: Guidelines: PH-Record](#)

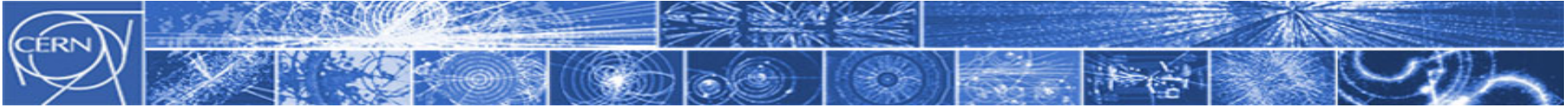

LOOKING FORWARD TO 2008

Risk assessment training for TSO's

In situ training for TSO's to help identify risks, assess gravity and decide what to do.

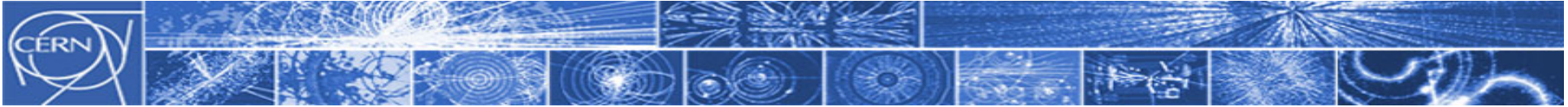

PH Department Safety Office

- Information
- Instruction
- Training
- Guidance

for **you** and **your work area**