

RCE/COB DAQ UK training workshop



Andreas Korn,
University College London

Andreas.Korn@cern.ch

Introduction

- **Workshop**
 - Welcome!
 - Proved very popular (packed room!)
 - Stay mostly in 5th floor DWB conference
- **COB/RCE**
 - Cluster on a Board with Reconfigurable Cluster Elements (more by the experts)
 - ATCA form factor
 - Powerful flexible & High bandwidth
 - Proposed for use in ATLAS, LSST, LBNE, ...
 - Useful interexperiment discussion!

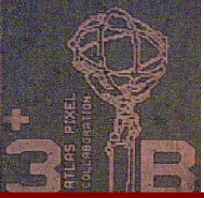

Information

- Localities

Dinner

Denys Wilkinson Building

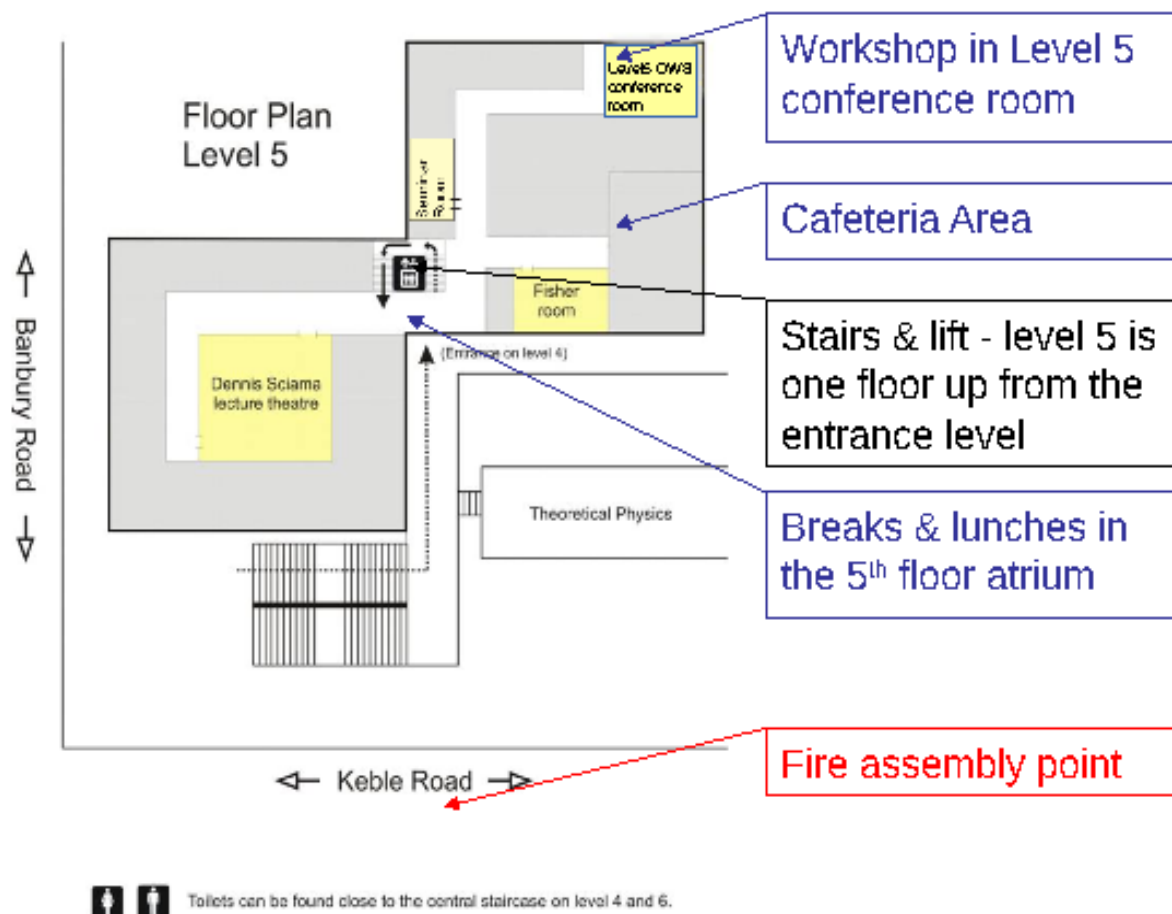

<http://www.theroyal-oakoxford.co.uk/>



Thank you!

- **Ian Shipsey/Oxford**
 - Hospitality & generously providing catering
- **SLAC team**
 - Su Dong & Mike Huffer leadership
 - Jim Panetta co-organising setup
 - SLAC Lecturers:
Mark Arndt, Ric Claus, Mike Huffer, Sergio Maldonado, Gregg Thayer
- **Sue Geddes & Jaya John John**
 - Doing all the real work!
 - Workshop would not have been possible without you!

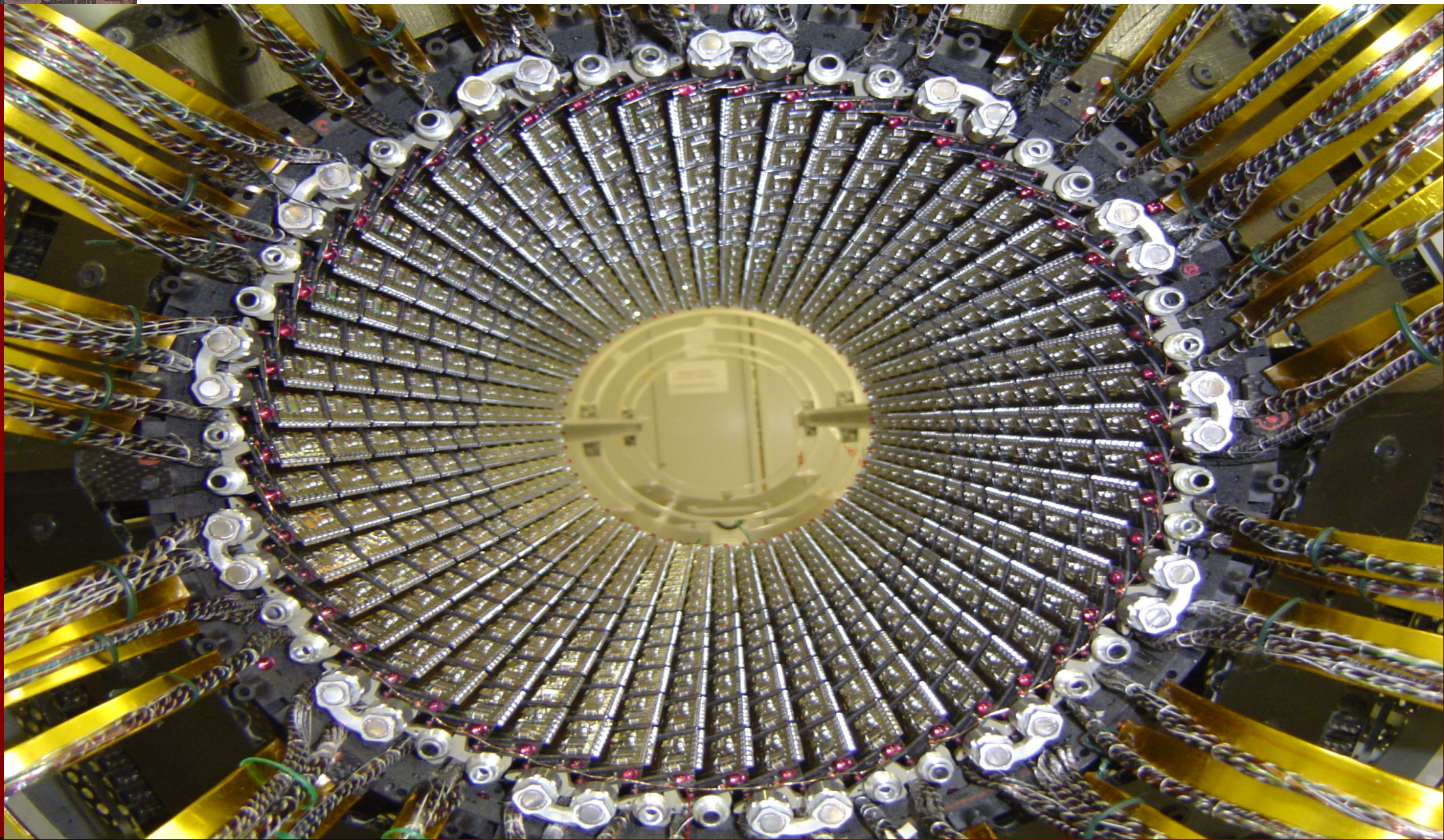

Bonus Slides