



MICE CM41

Overview of progress

- *Work in the Hall*
 - *PRY foundations*
 - *Compressor integration*
 - *Pipework and services*
 - *Electrical*
 - *Liquid hydrogen system*
 - *Staffing & planning*

Andy Nichols, STFC, 10/2/15





PRY Foundations



- *The PRY foundations are complete and effectively ready for the legs*
 - *Some work to understand pre-tension of tie rods to floor*
 - *Lifting gear and fasteners all present*
 - *More from Jason on detailed plans*
 - *Legs were scheduled to land at LHR yesterday; we will probably get them here by Friday*
 - *Temporary storage in R9; some minor weld attachments required*
 - *Have made lifting and assembly plan for complete installation*
 - *SS longitudinal tie downs being modified to comply with PRY*



Compressor integration



- *All CCR compressors for Step IV now placed*
 - *Electrical services complete*
 - *Water infrastructure complete*
 - *Working now on flushing and final hose connections*
 - *Not a stress for Step IV*
 - *Tracker compressors also located, connected and working, two in Hall and two in trench*
 - *Design work for hose support framework and routing is complete (quite a big job)*
 - *Procurement and some manufacture well underway*
 - *Pre-fabrication in R9*



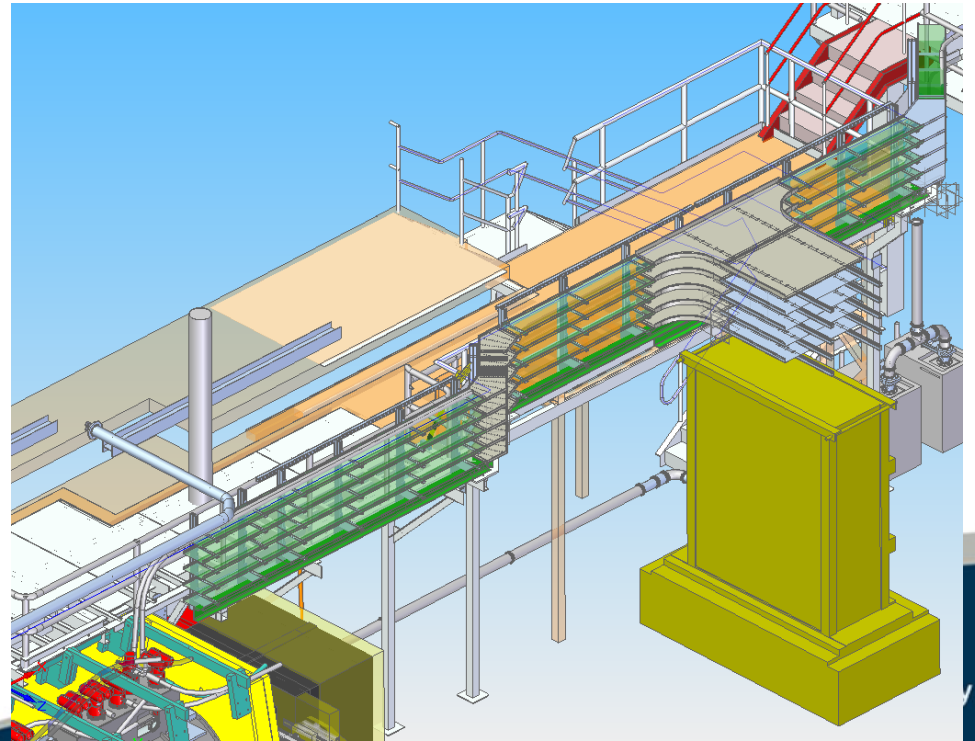
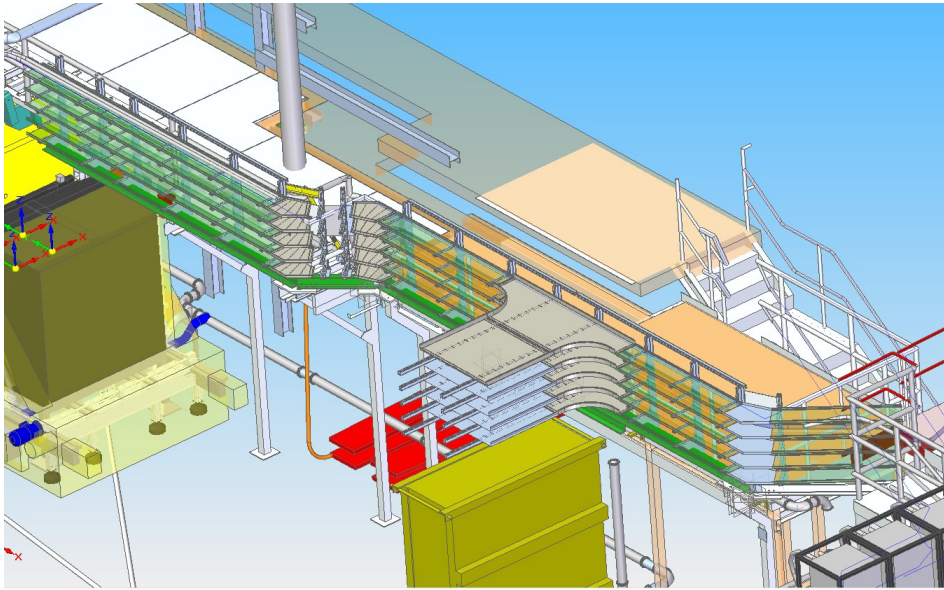

MICE COMPRESSOR TRAY ASSEMBLY – courtesy Paul Barclay

- ASSEMBLY AREA R9 Set aside
- Effort:- Two operatives start end of February with framework delivery
- Fabricated parts :- Main support frame and legs ordered x 3 weeks
- Machined parts :- Main bulk of parts ordered as of 6 Feb x 3 -4 weeks Some parts for manufacture large plates in house x 3 weeks
- 3/4inch Aeroquip elbows 40 off placed with new supplier by Shared Services 9 Feb expected x 5 weeks
- Main bulk of Tray support frame places with LASNEK x 3 weeks
- Outstanding orders :- Main frame assembly fixings all M10 . Standard straight tray runs various widths Lasnek x 2 weeks from order.
- Confirm Design over Downstream Solenoid and supports
- Finalise Lasnek framework above Beam Stop for Loop Tray and fixing to West Mezzanine

Pipework & services



- *Permanent He supply will be installed for tracker*
 - *All Swagelock fittings*
 - *Individual valves for each cryostat*
 - *Not much to say, but it's also quite a big job because of the routing*
 - *Also a fabricated N2-jacketted hydrogen line from outside - see hydrogen talk*



Electrical



- *All racks in RR2 installed except vacuum rack*
 - *Now being populated and connected*
 - *Heavy magnet cables have been laid in*
 - *Revised ODH scheme designed and agreed*
 - *ODH parts on order; will be installed by DL and commissioned by Supplier in time for Step IV*

Liquid hydrogen

- *Pre Step IV review in January a success*
 - *Mostly admin and safety, actions being taken by WG*
 - *Only significant hardware remaining is bottle pack replacement of hydride bed and final assembly of absorber and windows*
 - *Thin window inventory a slight worry, two safety windows have defects and cannot be used, but we should be OK as potential spares being measured now*



Staffing & Planning



- *Flexible extended day working is planned*
 - *Core two teams of two, with possibility of three teams*
 - *Made possible by help from IC and DL workshops*
 - *Aim to begin around mid-March with 06:00-18:00 days Mon-Thur, with 06:00-12:00 Friday, leaving weekends free for running and commissioning*
 - *Will enable PRY, compressor hose supports and He lines to be installed in parallel*

