

PROGRESS ON DESIGN WORK WP11



A. Temporal



DESIGN MAGNET 11T 1 IN 1 AS BUILT

- Priority 1: Produce V5 of single aperture model, which shall be an update of V4 with the following changes:

Remove the 8-9 mm gap that was left between the outermost turn and the saddle because the coils were actually longer than defined by Roxie. We are now able to produce the coils at the length defined by Roxie in a reproducible way;

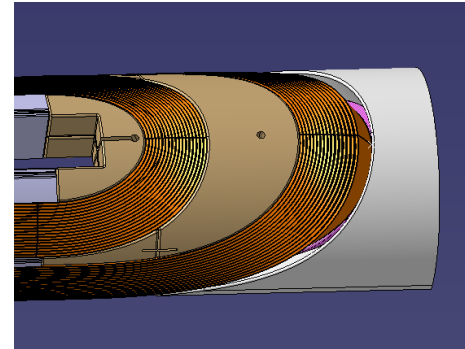
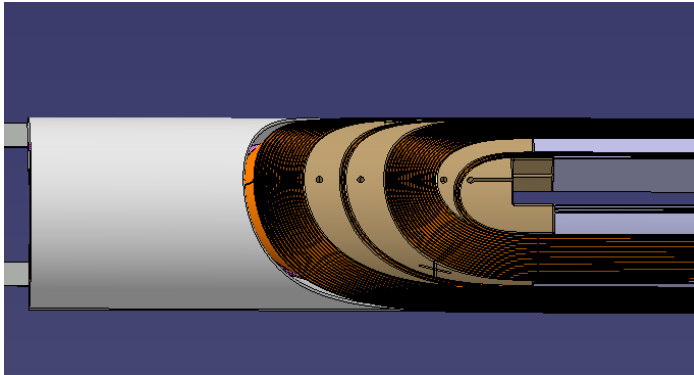

DESIGN 11T 1IN1 COIL V5

- 3D DESIGN, ASSEMBLY DRAWING and drawing def UPDATED.

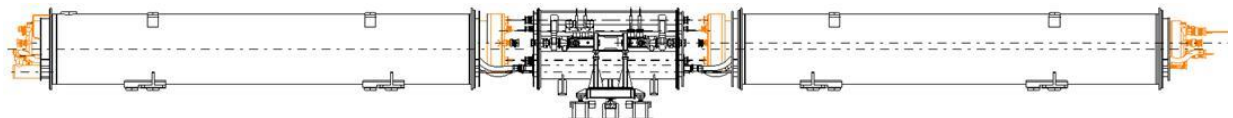
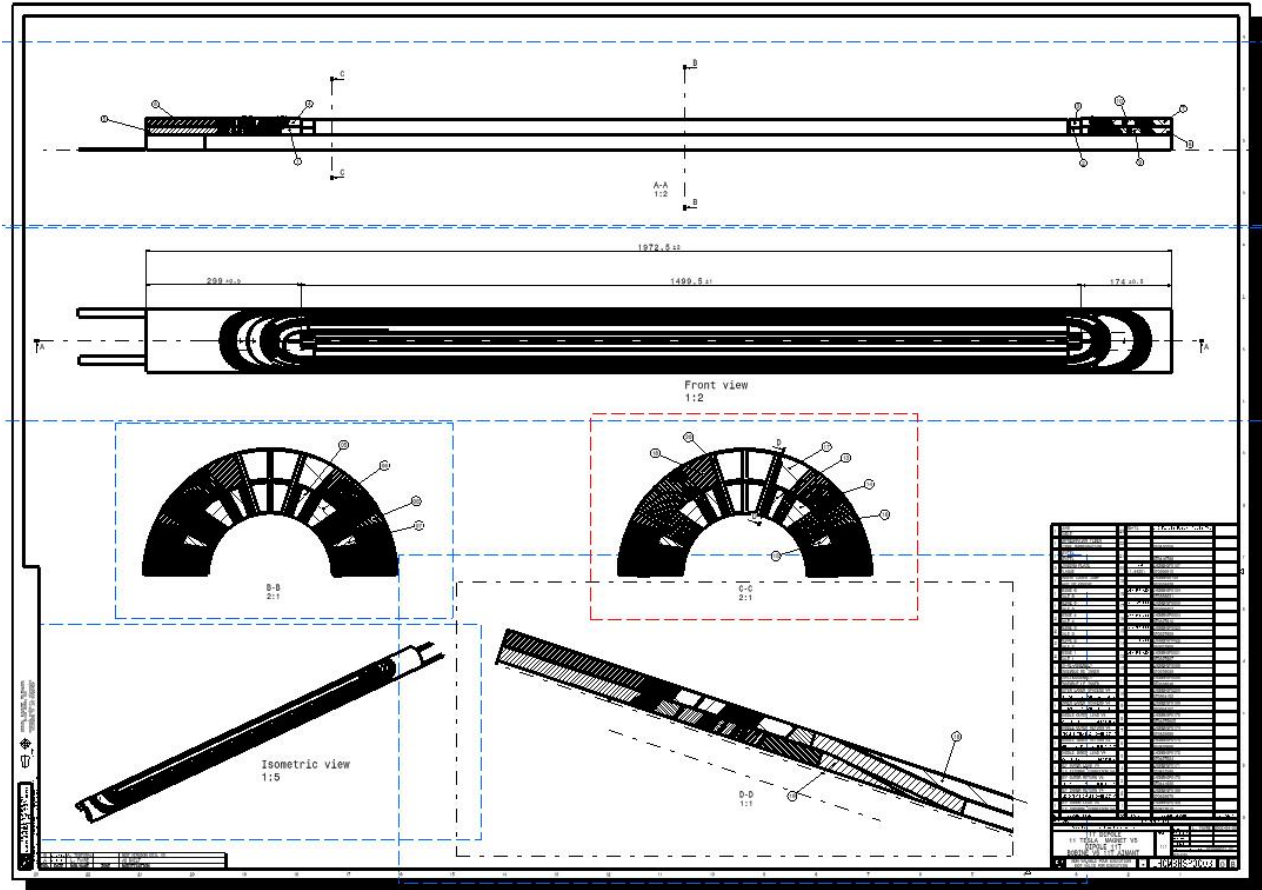
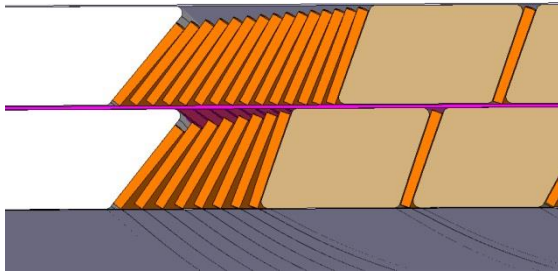

11T DIPOLE 1IN1 V5 DRAWING REVIEW

MODIF .05 2015	FOLDER EDMS	PLANS	INDICE	NUMERO ST	DESIGNATION	QTE / MAGNET	MODEL PROGRESS	DRAWING PROGRESS NOT VALIDE FOR EXECUTION	FOR INFORMATION	FOR PR
		LHCMBHSP0003			COIL V5					control1
		LHCMBHSP0107	A	ST0366910	LOADING PLATE COIL V4	2				
		LHCMBHSP0005	O	ST0511481	INSULATED CABLE (UNREACTED)					
		LHCMBHSP0143	O	ST0374438	CERAMIC INSERT LAYER JUMP					
		LHCMBHSP0168	A	ST0427610	COIL END SPACER - C4LI-K	1				
		LHCMBHSP0169	A	ST0425679	COIL END SPACER - C4RI-K	1				
		LHCMBHSP0170	A	ST0441930	COIL END SPACER - C4RO-K	1				
		LHCMBHSP0171	O	ST0427598	COIL END SPACER - C4LO-K	1				
		LHCMBHSP0172	B	ST0427624	COIL END SPACER - C4LI-S	1				Control 1
		LHCMBHSP0173	B	ST0425688	COIL END SPACER - C4RI-S	1				Control 1
		LHCMBHSP0174	B	ST0425693	COIL END SPACER - C4RO-S	1				Control 1
		LHCMBHSP0175	B	ST0427605	COIL END SPACER - C4LO-S	1				Control 1
		LHCMBHSP0199	B	ST0564152	COIL - Spacer Set IL (S.L.S.)	1				
		LHCMBHSP0200	B	ST0564152	COIL - Spacer Set OL (S.L.S.)	1				
		LHCMBHSP0021	B	ST0327907	WEDGE 1 - INNER	2				Control 1
		LHCMBHSP0022	B	ST0327908	WEDGE 2 - INNER	2				Control 1
		LHCMBHSP0023	B	ST0327909	WEDGE 3 - INNER	2				Control 1
		LHCMBHSP0024	B	ST0327910	WEDGE 4 - OUTER	2				Control 1
		LHCMBHSP0050	B	ST0366457	WEDGE 5 - OUTER	2				Control 1
		LHCMBHSP0104	B	ST0366631	COIL V4 - WEDGE 6 - OUTER	2				Control 1
		LHCMBHSP0004	O	ST0366071	CROSS SECTION - V4	1				Control 1

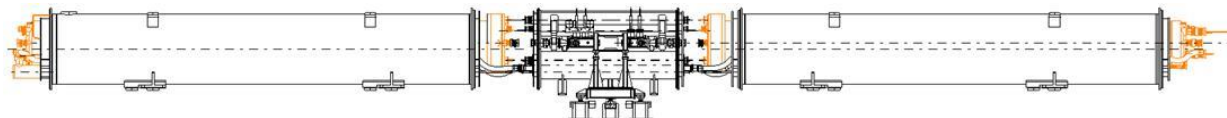

11T dipole 1 in 1 collared coils V5

- Implement the latest version of the instrumented collar packs. There are now 3 instrumented collar packs;
- Remove the capacitive gauges and correct the pole piece/collar as needed;
- Implement collar packs of uniform length.

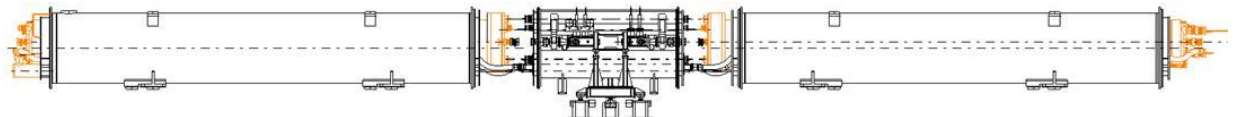

11T dipole 1 in 1 collared coils V5

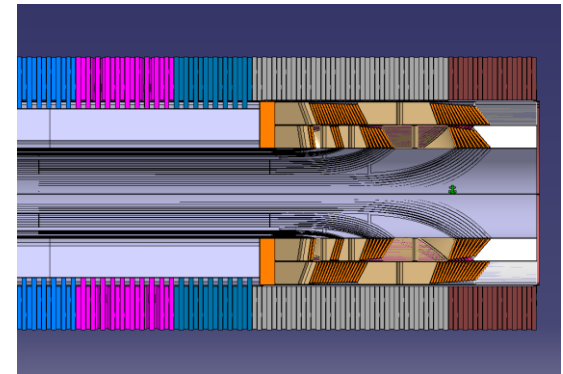
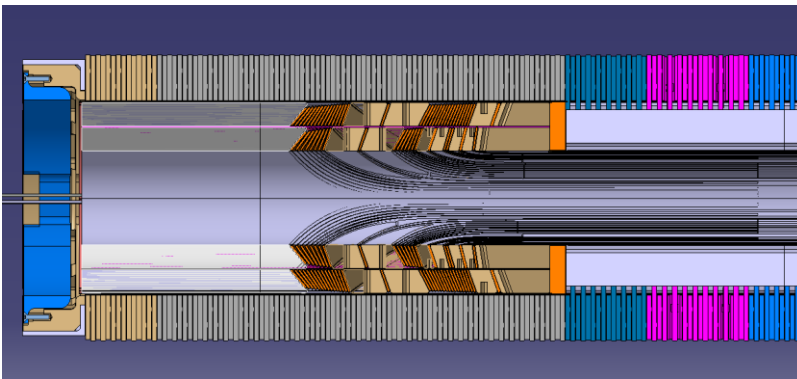
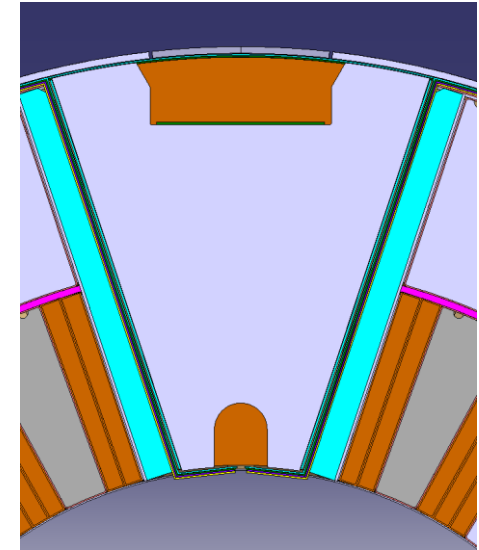
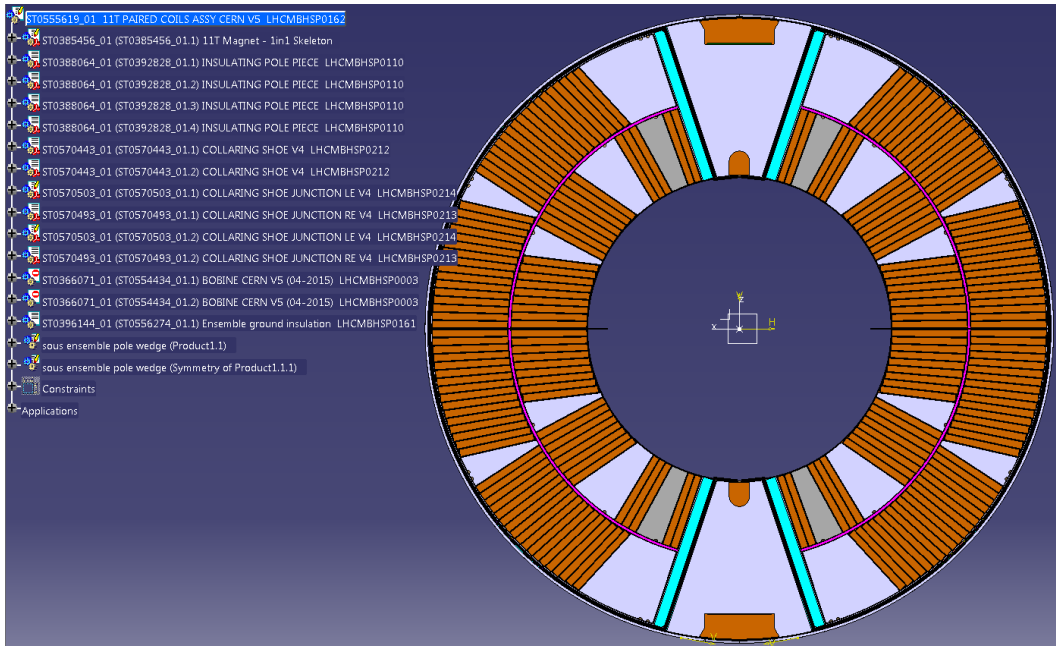

11T dipole 1 in 1 collared coils V5

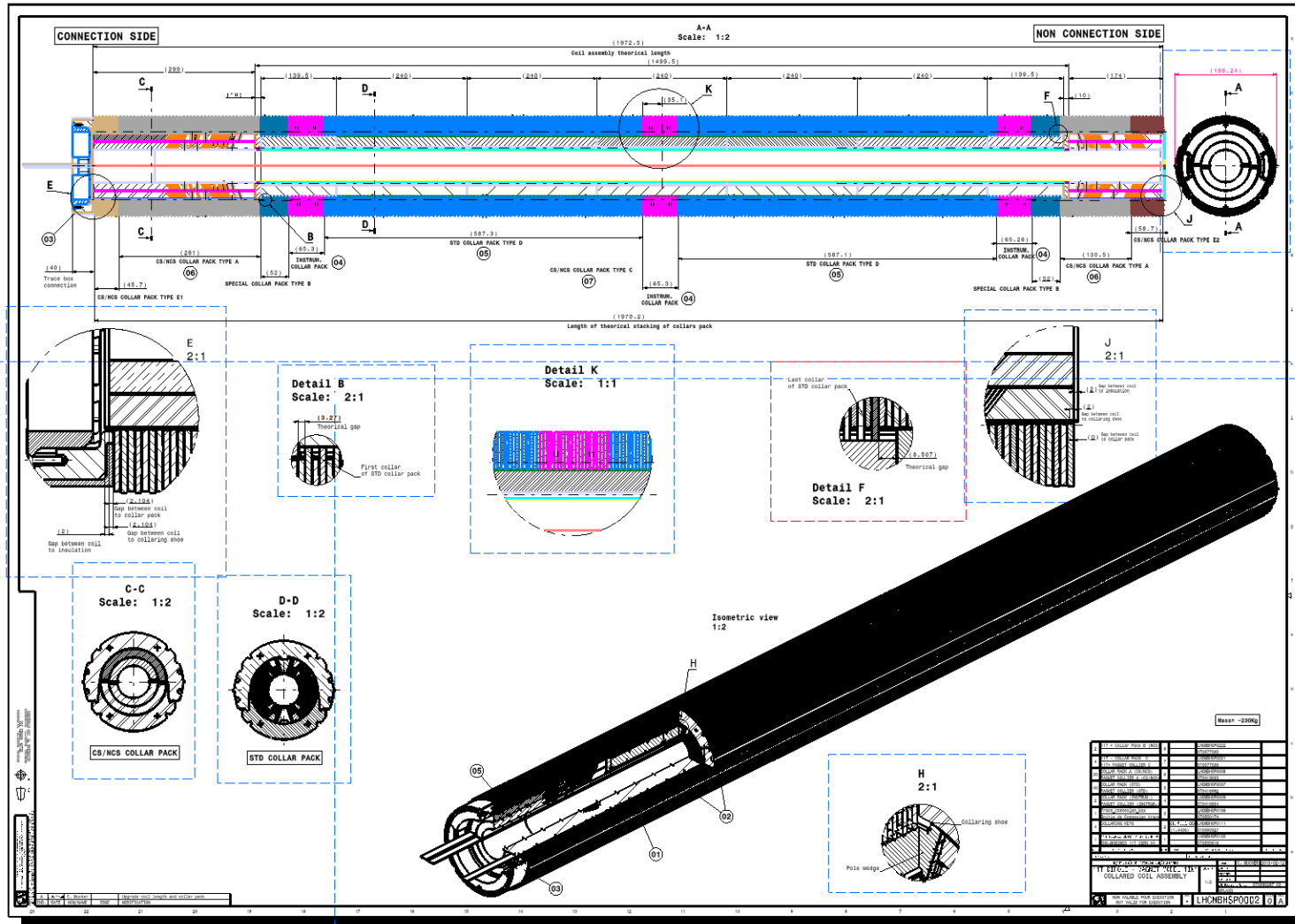

The collared coils design and drawings are finished.

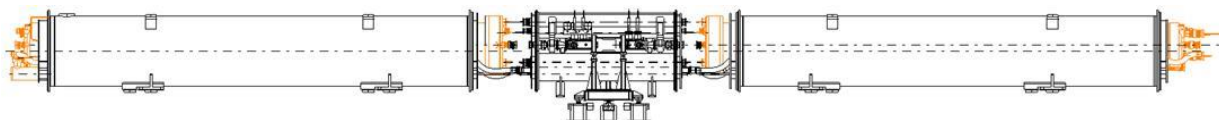

11T DIPOLE 1IN1 V5 DRAWING REVIEW

MODIF .05 2015	FOLDER EDMS	PLANS	INDICE	NUMERO ST	DESIGNATION	QTE / MAGNET	MODEL PROGRESS	DRAWING PROGRESS NOT VALIDE FOR EXECUTION	FOR INFORMATION	FOR PRODUCTION
	1222836	LHCMBHSP0002	B	ST0390287	COLLARED COIL ASS. V5			CONTROL1		
		LHCMBHSP0162		ST0555619	PAIRED COILS ASSY CERN V5			CONTROL1		
		LHCMBHSP0155	O	ST0383320	COLLAR NOSE SHIM	2				
		LHCMBHSP0111	A	ST0383327	COLLARING KEYS	4		CONTROL1		
		LHCMBHSP0178	A	ST0491472	COLLARS PACK (STD) PUNCHED	18		CONTROL1		
		LHCMBHSP0253		ST0682646	COLLARS PACK (STD)BIS PUNCHED	18		CONTROL1		
		LHCMBHSP0238	A	ST0674315	COLLARS PACK TYPE A (CS/NCS) PUNCHED	5		CONTROL1		
		LHCMBHSP0252		ST0684206	COLLARS PACK TYPE A (CS/NCS) BIS PUNCHED	5		CONTROL1		
		LHCMBHSP0233	A	ST0673853	COLLARS PACK (INSTRUM.) PUNCHED	3		Control 1		
		LHCMBHSP0251		ST0683308	COLLARS PACK (INSTRUM.)BIS PUNCHED	3		CONTROL1		
		LHCMBHSP0237	A	ST0674324	COLLARS PACK B PUNCHED	2		Control 1		
		LHCMBHSP0250	A	ST0683389	COLLARS PACK B BIS PUNCHED	2		CONTROL1		
		LHCMBHSP0236	O	ST0675121	COLLAR PACK TYPE E1 (PUNCHED)	1		Control 1		
		LHCMBHSP0249		ST0684283	COLLAR PACK TYPE E1 BIS (PUNCHED)	1		CONTROL1		
		LHCMBHSP0234	O	ST0675097	COLLAR PACK TYPE E2 (PUNCHED)	1		Control 1		
		LHCMBHSP0248		ST0684296	COLLAR PACK TYPE E2 BIS (PUNCHED)	1		CONTROL1		
		LHCMBHSP0188		ST0550174	TRACE INTERFACE RING	1		CONTROL1		
		LHCMBHSP0189		ST0550162	TRACE INTERFACE RING- BASE RING	1		CONTROL1		
		LHCMBHSP0190		ST0550164	TRACE INTERFACE RING- INTEGRATION HOUSING	1		CONTROL1		
		LHCMBHSP0191		ST0550177	TRACE INTERFACE RING- RING JOINT COVER	1		CONTROL1		
		LHCMBHSP0136	O	ST0417137	U-SHAPE INSTRUMENTATION	2		OBSOLETE		

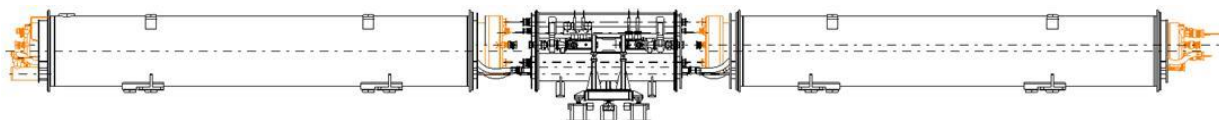

11T DIPOLE MAGNET 1IN1 V4

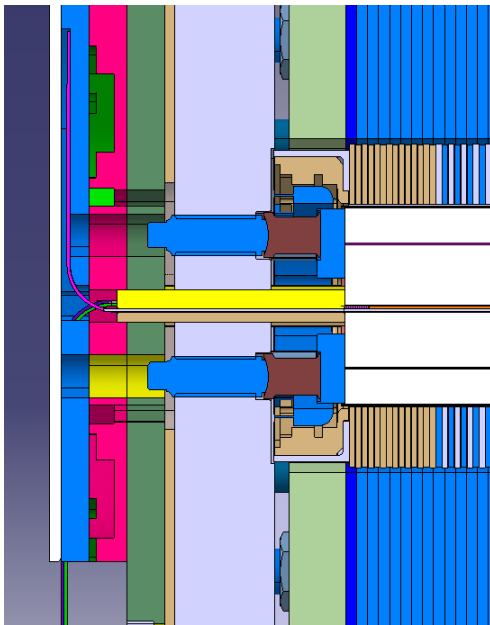
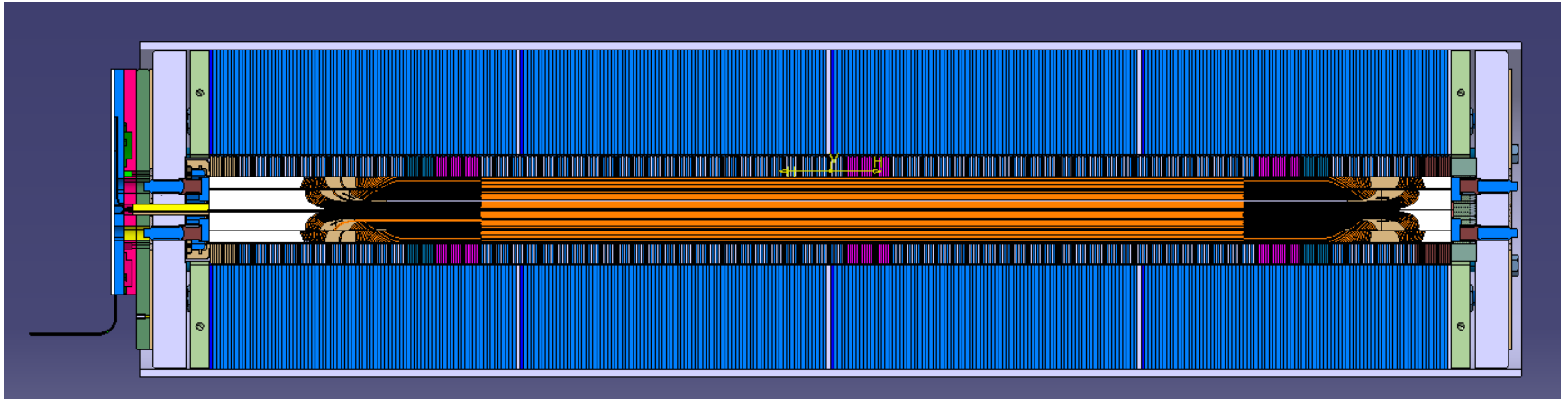

it remains the modification of the routing of cables at the pizza box

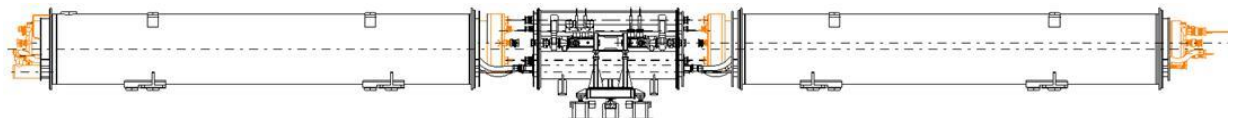
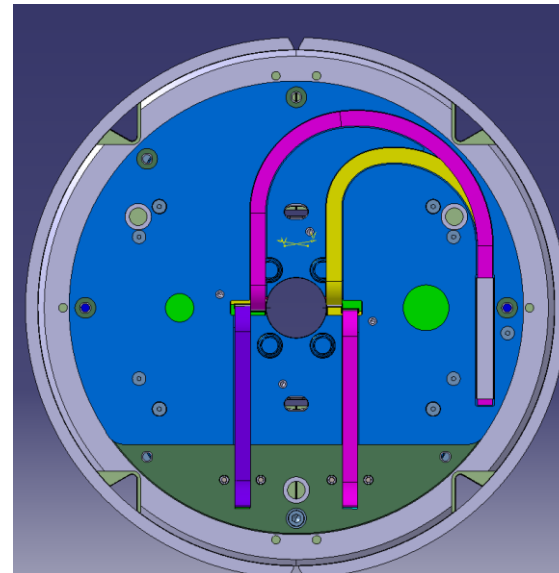

11T DIPOLE MAGNET 1IN1 V5

CONNECTION BOX V5

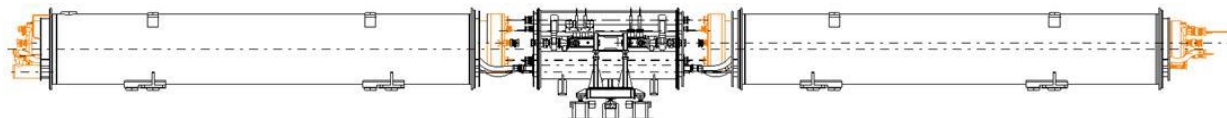
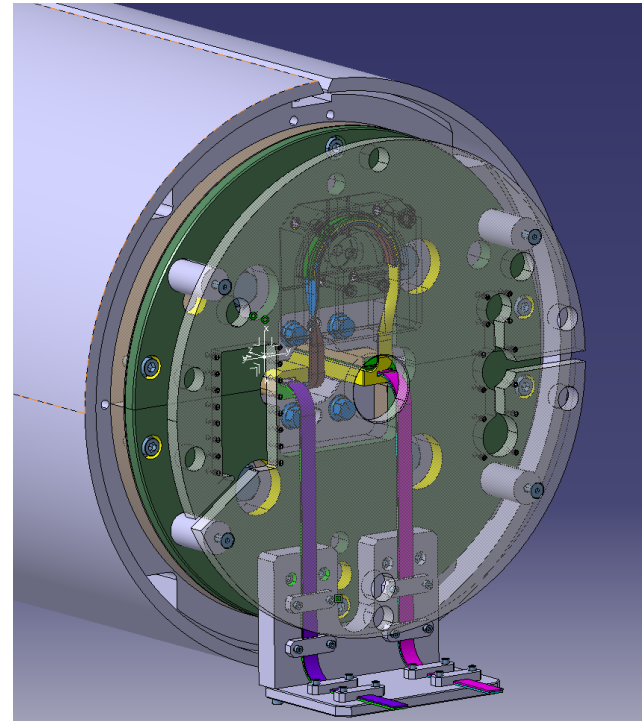
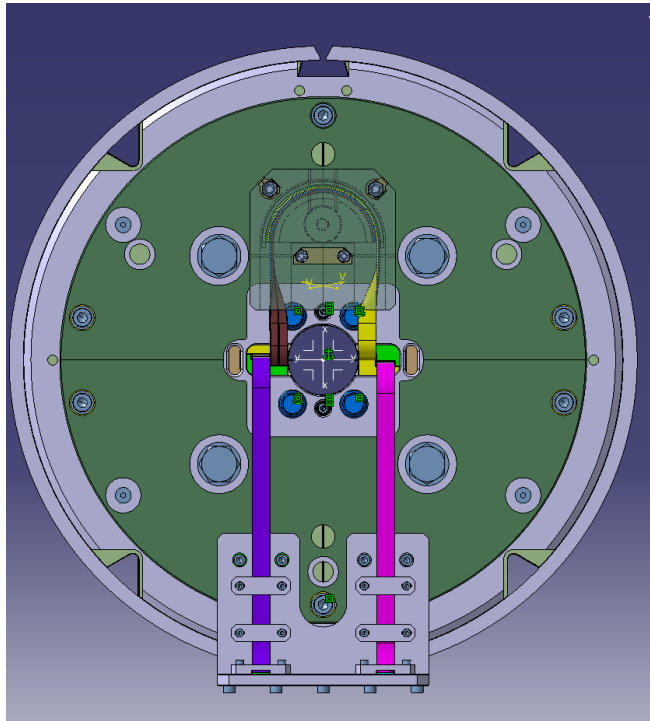

11T DIPOLE MAGNET 1IN1 V5

CONNECTION BOX V5

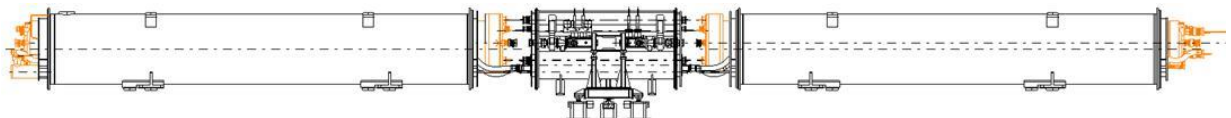
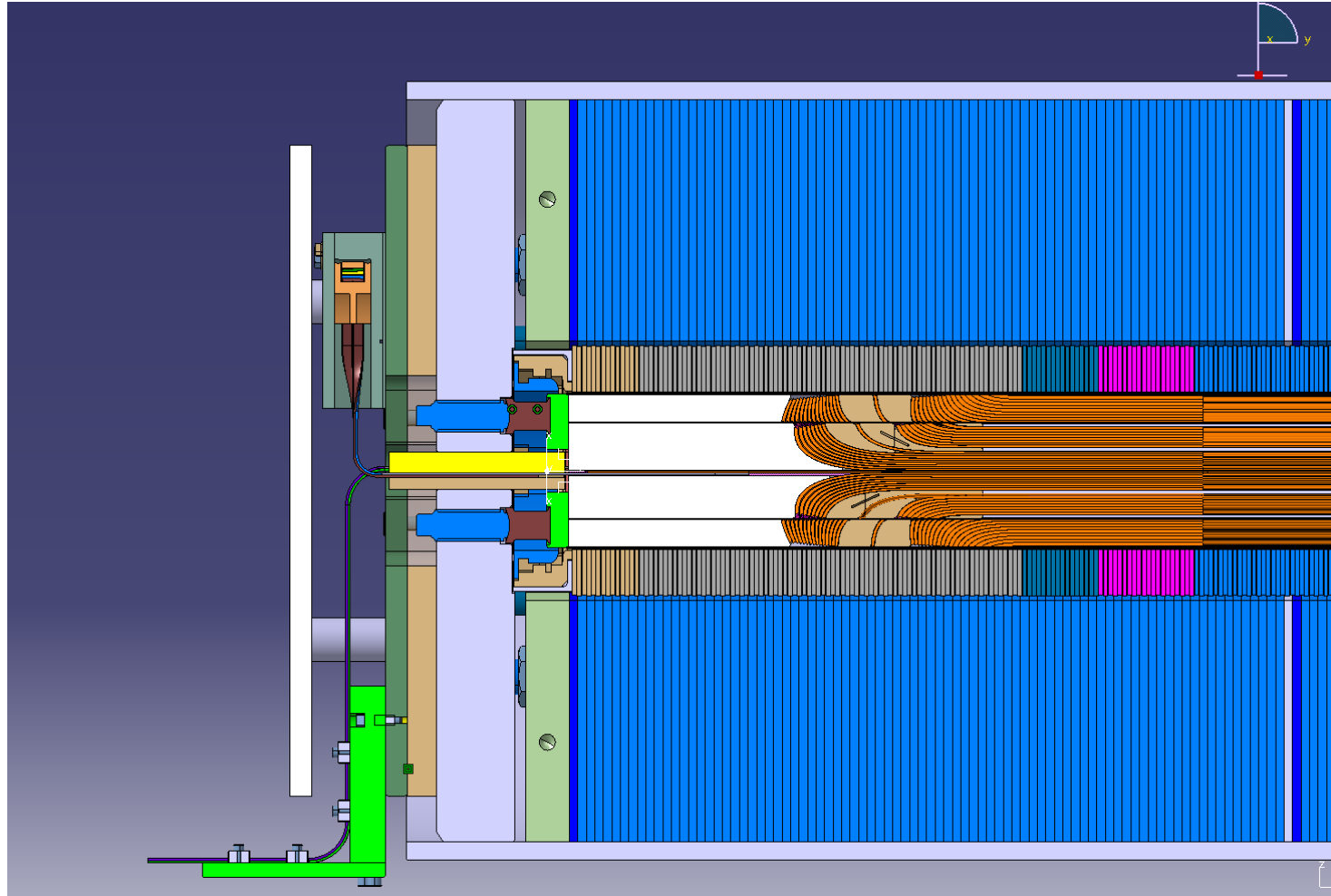

11T DIPOLE 1IN1 V5 DRAWING REVIEW

MODIF .05 2015	FOUNDER EDMS	PLANS	INDEX	NUMERO ST	DESIGNATION	QTE / MAGNET	MODEL PROGRESS	DRAWING PROGRESS NOT VALIDE FOR EXCLUSION	FOR INFORMATION	FOR PRODUCTION
	1227930	LHCMBHSP0156		ST0418211	CONNECTION BOX V5			Control 1		
		LHCMBHSP0208	O	ST0569683	U PROFILE	1				
		LHCMBHSP0245	O	ST0678611	11T MAGNET 1IN1- CS INSULATION PLATE-1 V5	1		Control 1		
		LHCMBHSP0244	O	ST0678819	11T MAGNET 1IN1- CS INSULATION PLATE-2 V5	1		Control 1		
		LHCMBHSP0207	O	ST0569686	UPPER WEDGE COPPER	1		OBSOLETE		
		LHCMBHSP0182	O	ST0546497	CONNEXION BOX - SPLICE PLATE	1		OBSOLETE		
		LHCMBHSP0166	O	ST0473645	CONNEXION PLATE	1		CANCELLED		
		LHCMBHSP0246		ST0682727	11T DIPOLE-CONNEXION BOX-COVER PLATE ASSY	1		Control 1		
		LHCMBHSP0167		ST0473646	11T DIPOLE-CONNEXION BOX-COVER PLATE	1				
		STD		ST0682745	ENSAT-S M3 INSERT St Steel 1.4305	28				
		LHCMBHSP0176	B	ST0483515	INSTRUMENTATION PLATE	1		CANCELLED		
		LHCMBHSP0243	O	ST0678481	11T MAGNET 1IN1-CS BASE PLATE ASSY V5	1		Control 1		
		LHCMBHSP0242	O	ST0678479	11T MAGNET 1in1 -CS BASE PLATE-1 V5	1		Control 1		
		LHCMBHSP0241	O	ST0678806	11T MAGNET 1in1 -CS BASE PLATE-2 V5	1		Control 1		
		LHCMBHSP0239	O	ST0678679	11T MAGNET 1IN1- JUNCTION BOX SHIM	1		Control 1		
		LHCMBHSP0217		ST0430949	11T Magnet 1in1 - CABLES ROUTING ASS	1		Control 1		
		LHCMBHSP0158		ST0432718	11T DIPOLE-MAGNET 1IN1-LEADS ENDPLATE CLAMP ASSY	1		Control 1		
		LHCMBHSP0152	B	ST0417733	LEADS ENDPLATE CLAMP 1	1		Control 1		
		LHCMBHSP0157	B	ST0432700	LEADS ENDPLATE CLAMP 2	1		Control 1		
		LHCMBHSP0209		ST0569964	SUPRA CABLE PROTECTION -S/A	1		CANCELLED		
		LHCMBHSP0210	A	ST0569968	LEADS ENDPLATE CLAMP 4	1		CANCELLED		
		LHCMBHSP0211	A	ST0569967	LEADS ENDPLATE CLAMP 3	1		CANCELLED		
		LHCMBHSP0240	O	ST0678917	SPACER PLATE CONNECTOR	4		Control 1		
		LHCMBHSP0185	A	ST0385638	CONNEXION BOX-BASE PLATE	1		Control 1		
		LHCMBHSP0223		ST0669469	11t Leads support assy	1		Control 1		
		LHCMBHSP0226		ST0669439	11T Leads support-Part 1	1		Control 1		
		LHCMBHSP0227		ST0669463	11T Leads support-Part 2	1		Control 1		
		LHCMBHSP0228		ST0669474	11T Leads support-Leads clamp	8		Control 1		
		STD		ST0425619	DOUILLE NOYEE M6 X 14MM	20				

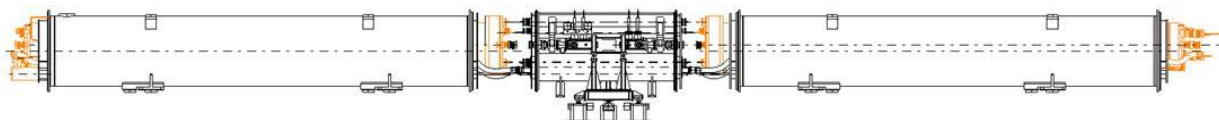

11T DIPOLE MAGNET 1IN1 V5

END PLATE CS AND RETURN

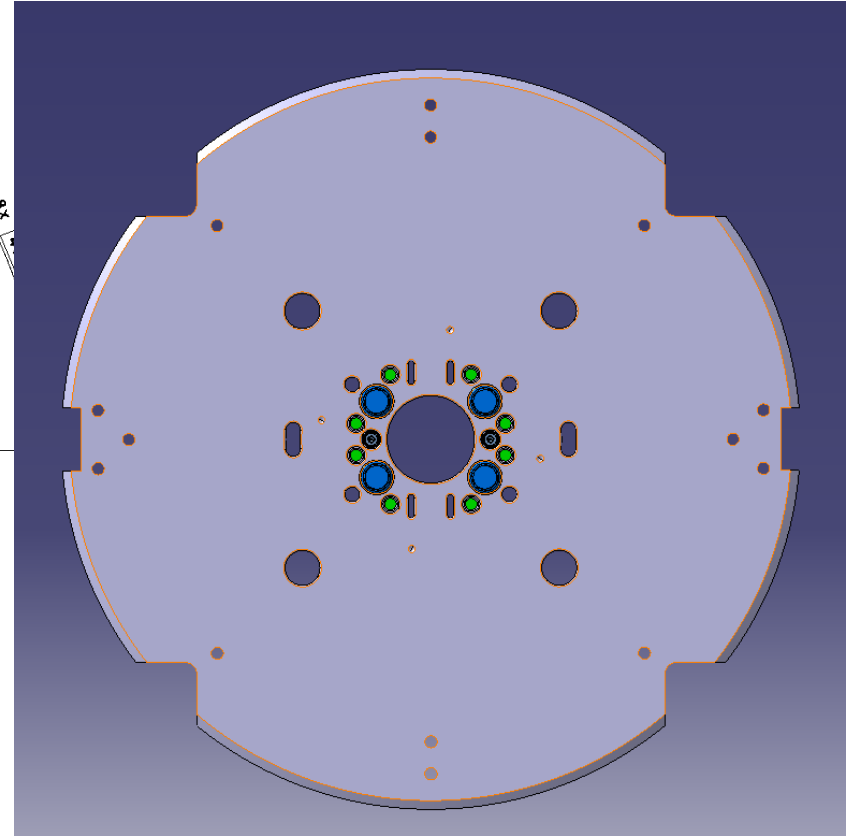
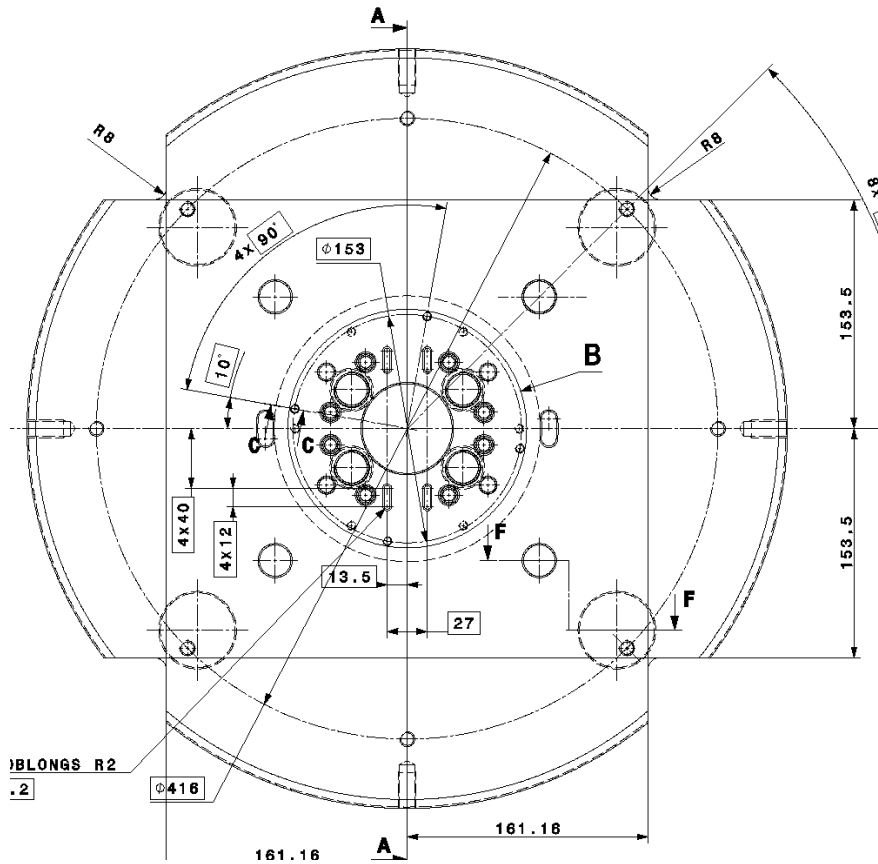

11T DIPOLE MAGNET 1IN1 V5

END PLATE CONNECTION SIDE

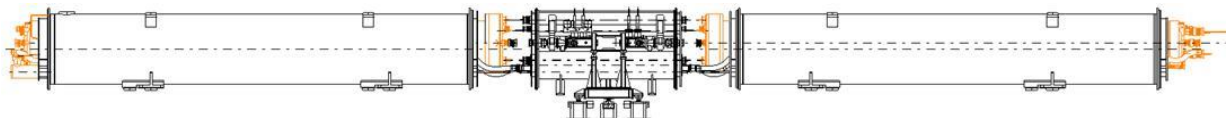
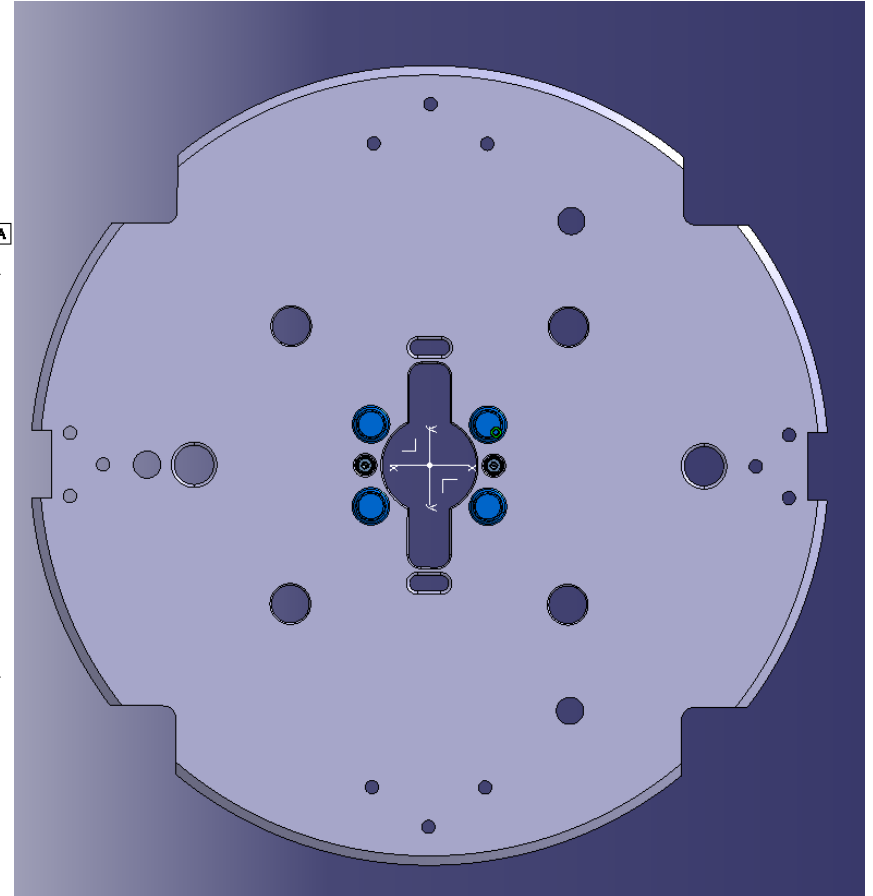
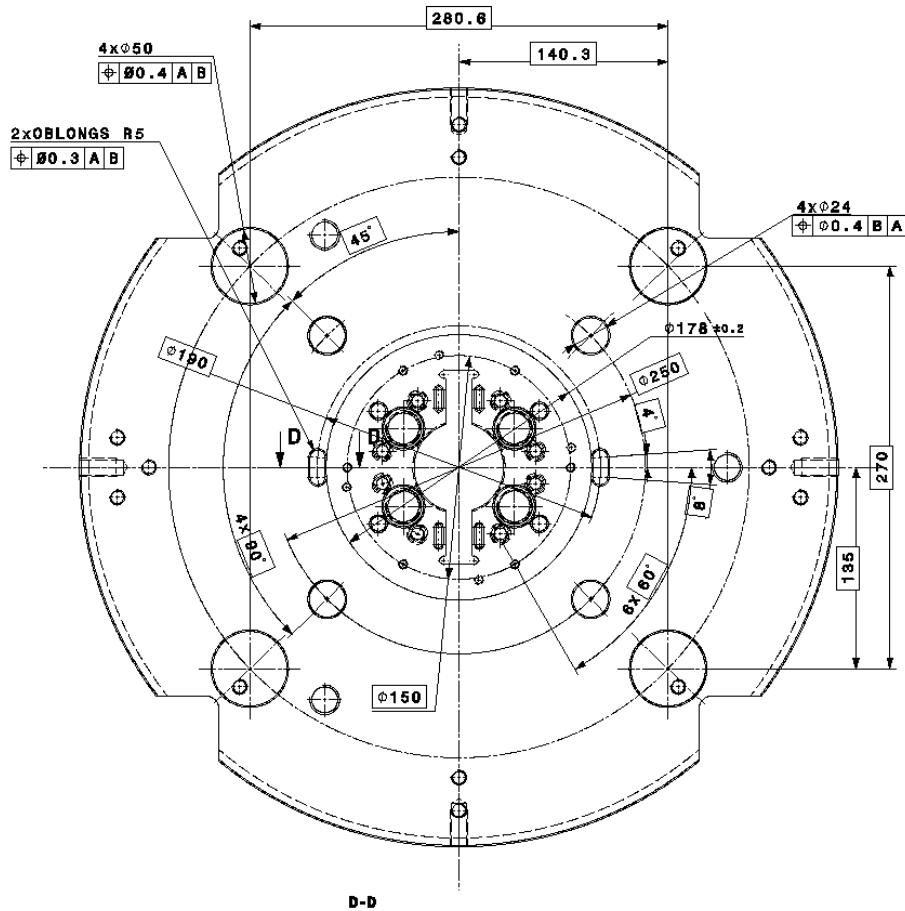

11T DIPOLE MAGNET 1IN1 V5

BULLET GAUGES 1IN1 V5

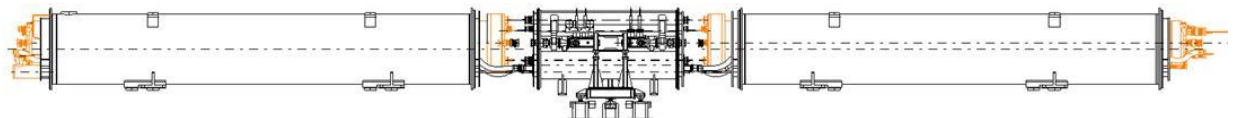
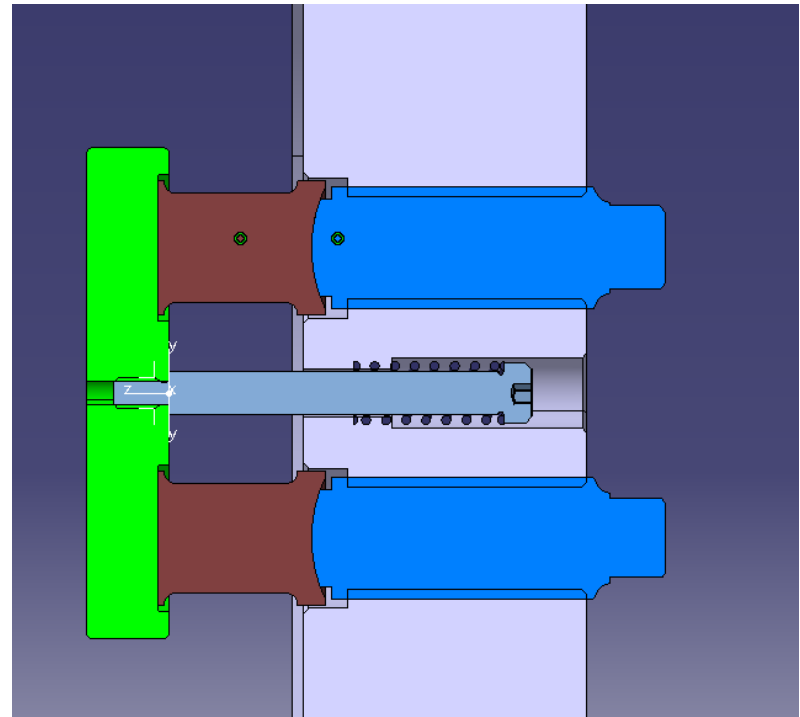
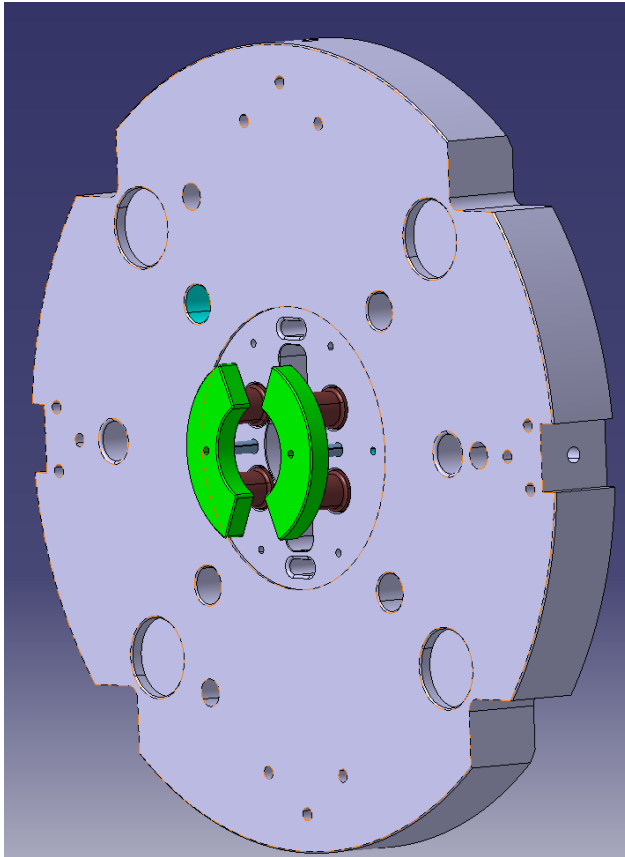

11T DIPOLE 1IN1 V5 DRAWING REVIEW

MODIF .05 2015	FOLDER EDMS	PLANS	INDICE	NUMERO ST	DESIGNATION	QTE / MAGNET	MODEL PROGRESS	DRAWING PROGRESS NOT VALIDE FOR EXECUTION	FOR INFORMATION	FOR PRODUCTION
	1223851	LHCBHSP0146	A	ST0417642	RETURN END PLATE ASS. V5					
		LHCBHSP0141	B	ST0385537	RS END FLANGE	1				
		LHCBHSP0247	0	ST0682881	GAUGE PRESSURE PLATE V5	2		Control 1		
		LHCBHSP0144	0	ST0418596	END PLATE DISTANCE RING	1				
		LHCBHSP0145	0	ST0425098	VIS JAUGE M24X3	4				
		LHCOMXCM0101	0	ST0426839	LONG CYLINDER	4				
				ST0582836	SHOULDER BOLT 1031-6x60 ST	2				
	1339163	LHCBHSP0147		ST0418026	CONNECTION END PLATE ASS. V5			Control 1		
		LHCBHSP0142	D	ST0385624	CS END FLANGE V5	1		Control 1		
		LHCBHSP0247	0	ST0682881	GAUGE PRESSURE PLATE V5	2		Control 1		
		LHCBHSP0145	0	ST0425098	VIS JAUGE M24X3	4				
		LHCOMXCM0101	0	ST0426839	LONG CYLINDER	4				
				ST0582836	SHOULDER BOLT 1031-6x60 ST	2				

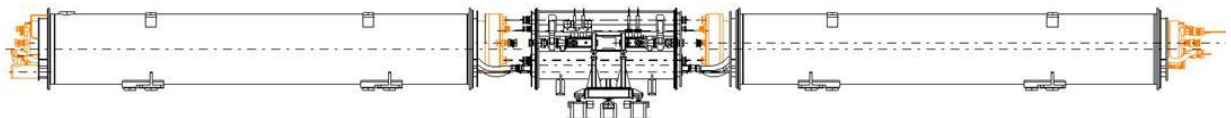

11T DIPOLE MAGNET 2 in 1 MBHDP101

Priority 2: Develop the 3D model of the extremities of the prototype and of the model MBHDP101 for the 2-1 assembly. They should be 'nearly' identical (for example, the diameter of the yoke, i.e. also that of the end plate will be different, as the yoke will have a 540 mm OD in the prototype). What we need is described here after.

- First model 2-in-1, named MBHDP101, with the existing yoke of 550 mm OD (I recall here that we already have yoke laminations on stock that we are going to use);
- The end plates shall be 75-mm thick and the bullet gauges as per concept shown during the meeting of Tuesday. Regarding the bullet gauges, Hervé to confirm the final details of integration and Christian/Friedrich to confirm that the level of stress especially in the threads and the stress field in the region of the gauges are acceptable;
- The electrical instrumentation (trace, V-taps) shall be compatible with the instrumentation scheme of the 1-in-1 assembly (same remark applies for the insulation/connection box aka 'pasta box'), as we are going to use the same collared coils (the collared coils of the 'SP' models will go in the 'DP' models);
- Electrical connections to be designed identical to those of the MBH #2 (Hervé to give details on this point), including insulation plates/supports as needed;
- $\frac{1}{2}$ -Yokes to be made of 500 mm packs, as done for the single aperture model.

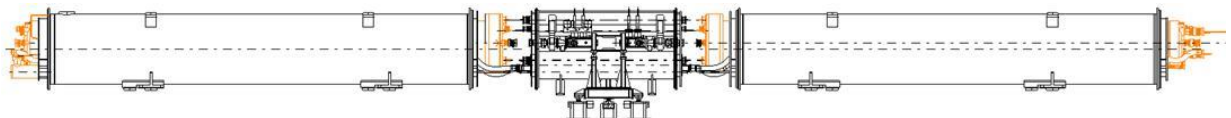
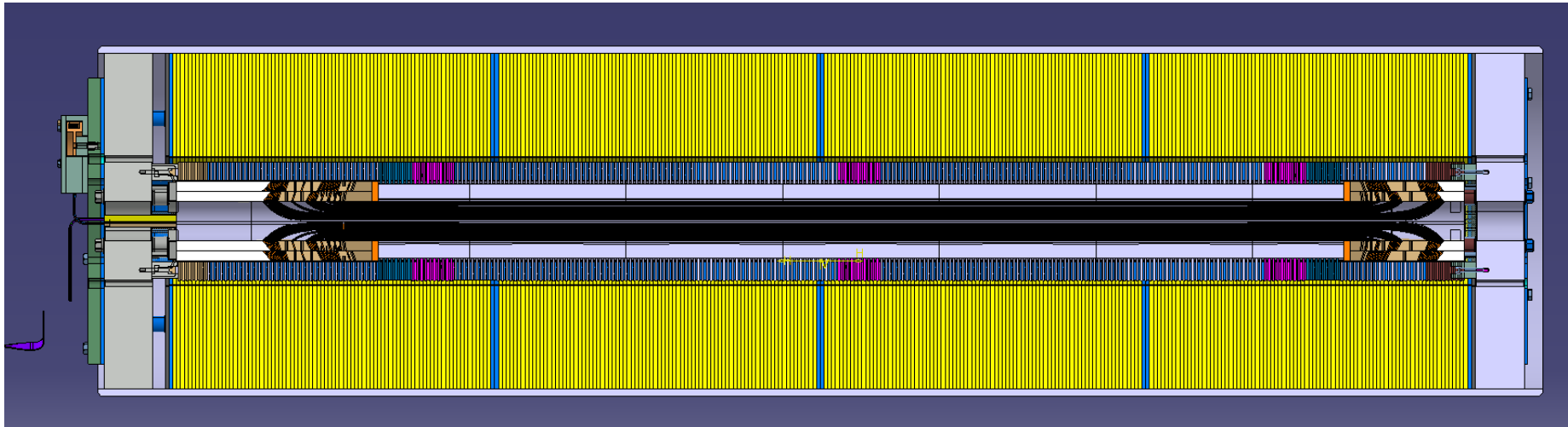

11T DIPOLE MAGNET 2 in 1 MBHDP101

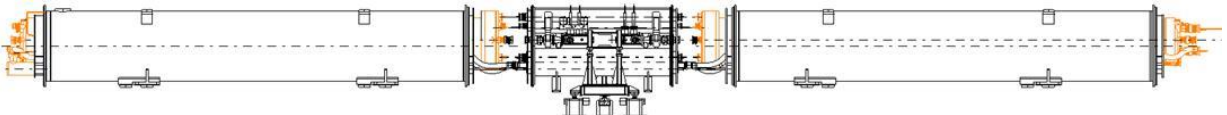
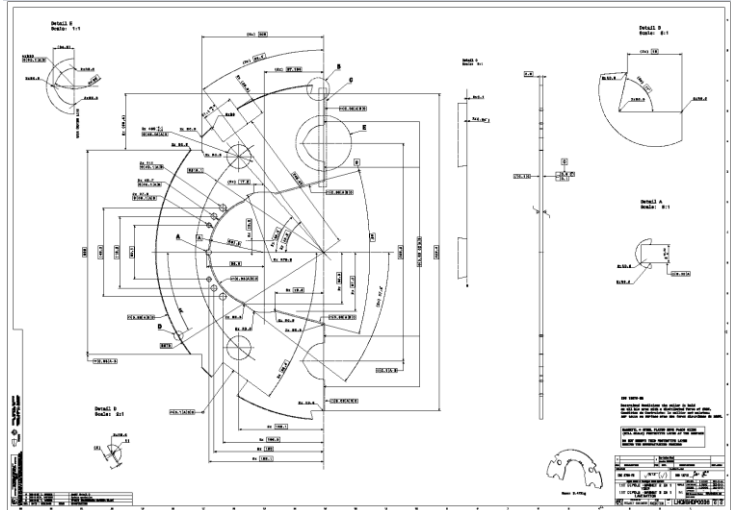
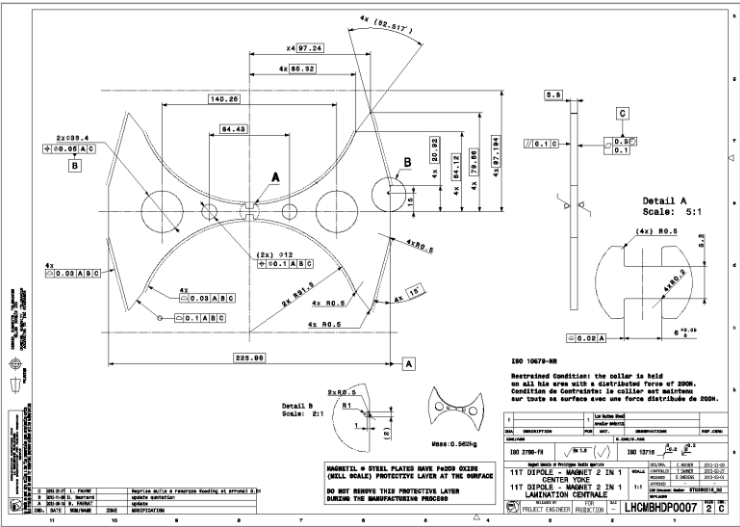
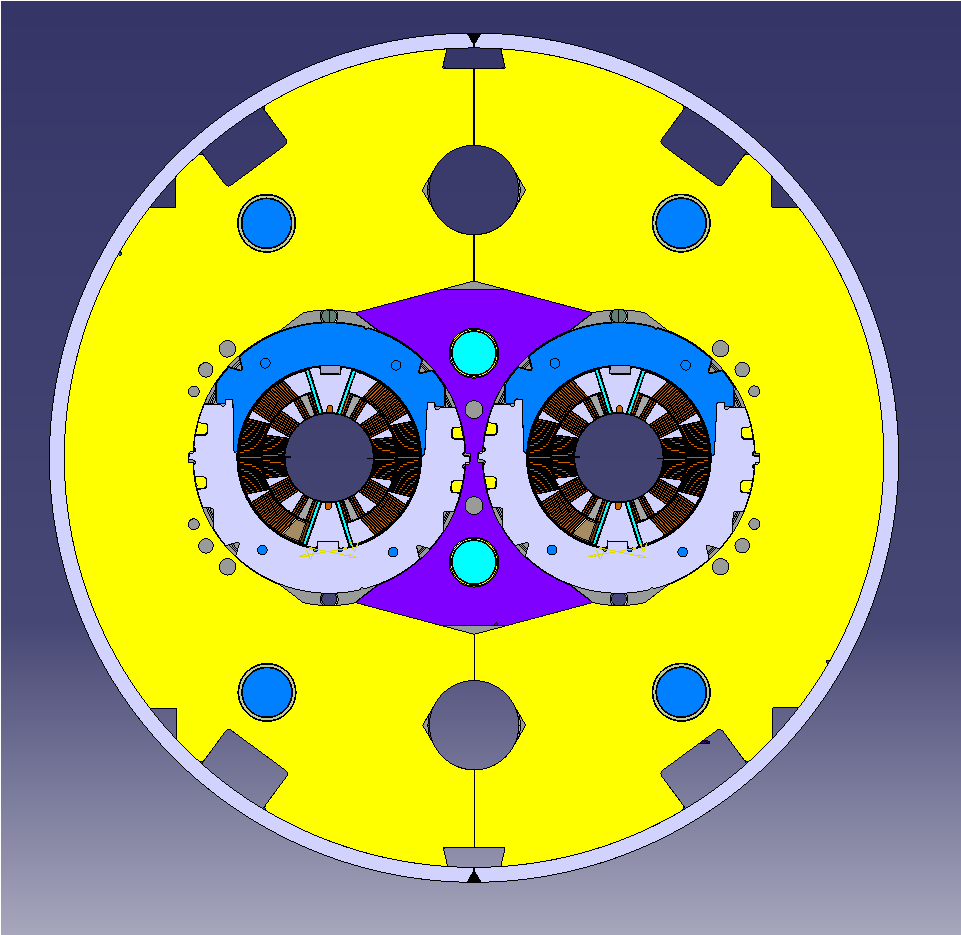

11T DIPOLE 2 in 1 DRAWING REVIEW

PLANS	INDICE	NUMERO ST	DESIGNATION	QTE / MAGNET	PLAN IMPR/IME	MODEL PROGRESS	A FABRIQUER	NOT VALIDE FOR EXECUTION	FOR CONTROL	FOR PRODUCTION	TYPE DE PLANS
2 AND 1 LAMINATION ASSEMBLY											
LHCMBHP0013	0	ST0385601_02	2 AND 1 LAMINATION ASSEMBLY	2							PLANS SOUS-ENSEMBLE COMPOSES DE:
LHCMBHP0017	0	ST0385311_02	LAMINATION OUTER END PLATE	2							PLAN
LHCMBHP0015	0	ST0429897_02	YOKE PACK	4 PACKET							PLANS SOUS-ENSEMBLE COMPOSES DE:
LHCMBHP0014	0	ST0429902_02	END YOKE DESIGN	8							PLAN
LHCMBHP0006	A	ST0380209_02	YOKE	336							PLAN
LHCMBHP0016	0	ST0388648_02	ROD FOR YOKE	2							PLAN
LHCMBHP0012	0	ST0429925_02	BEARING PIPE	8							PLAN
2 AND 1 CENTER YOKE ASSEMBLY											
LHCMBHP0019	0	ST0390392_02	CENTER YOKE ASSEMBLY	1							PLANS SOUS-ENSEMBLE COMPOSES DE:
LHCMBHP0016	0	ST0388648_02	ROD FOR YOKE	2							PLAN
LHCMBHP0018	0	ST0430253_02	CENTER YOKE END PLATE	2							PLAN
LHCMBHP0020	0	ST0432319_02	CENTER YOKE PACK	4							PLANS SOUS-ENSEMBLE COMPOSES DE:
LHCMBHP0007	C	ST0380216_02	CENTER YOKE	84							PLAN
LHCMBHP0021	0	ST0432320_02	END CENTER YOKE	8							PLAN
2 AND 1 WELDED HALF SHELL ASSEMBLY											
????	0	ST0390464_01	2 AND 1 WELDED HALF SHELL ASSEMBLY	1							PLANS SOUS-ENSEMBLE COMPOSES DE:
LHCMBHP00130	B	ST0256567_02	OUTER SHELL	2							PLAN
LHCMBHP0008	0	ST0397630_02	2 IN 1 WELDED HALF SHELL	2							PLAN

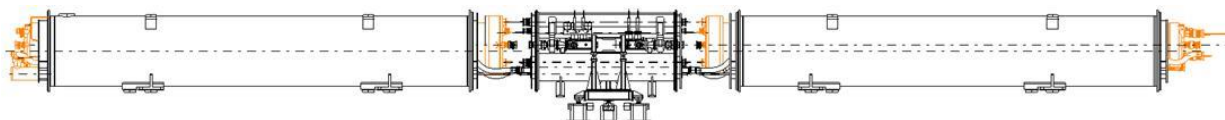

11T DIPOLE MAGNET 2 in 1 MBHDP101

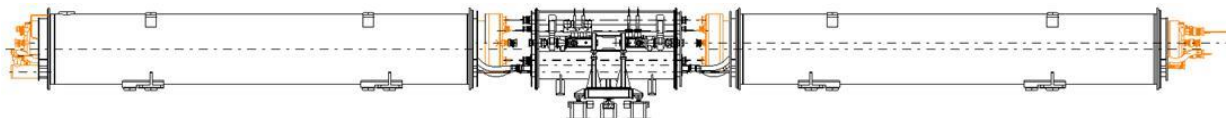
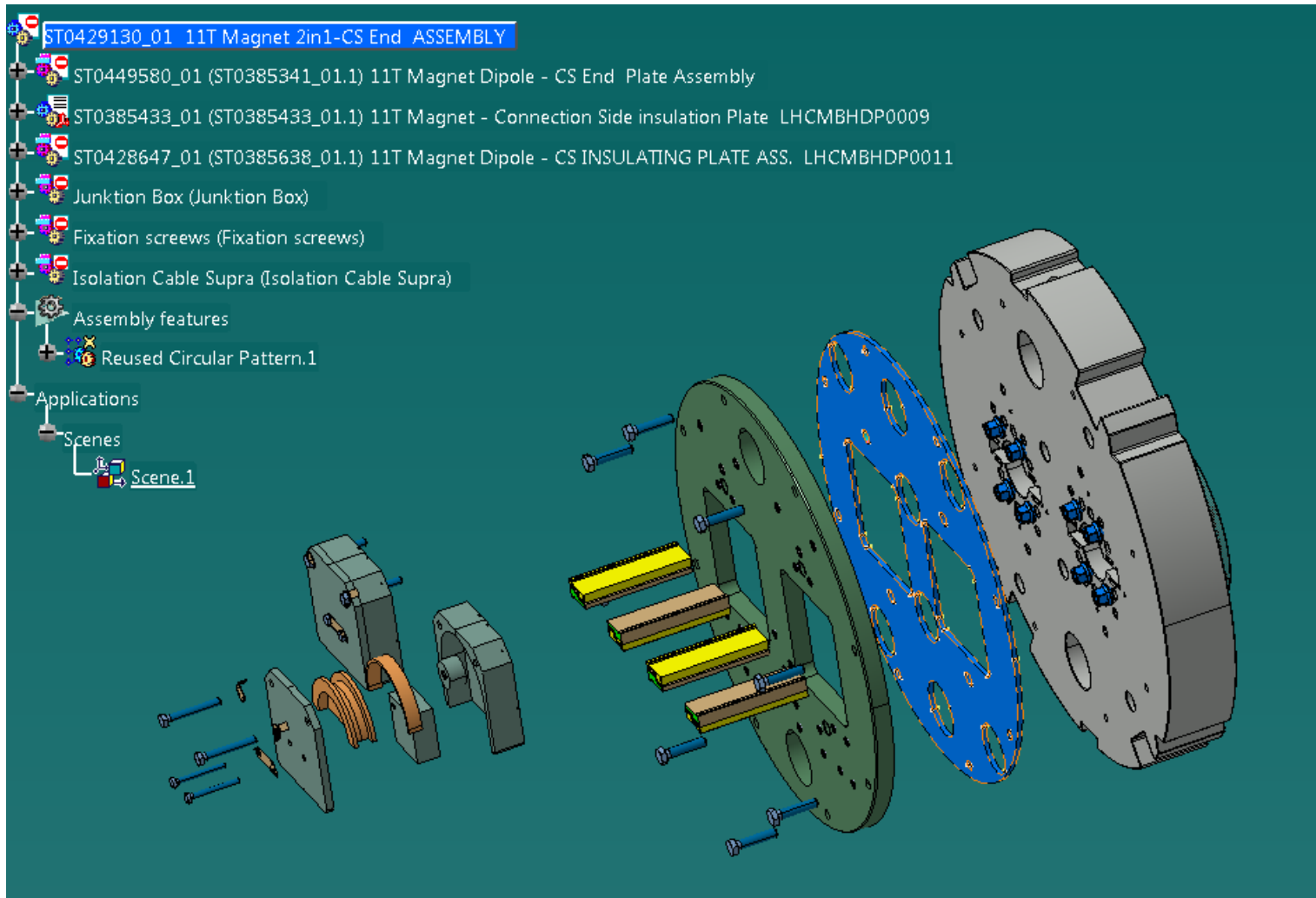

11T DIPOLE MAGNET 2 in 1 MBHDP101

CS END PLATE ASSEMBLY

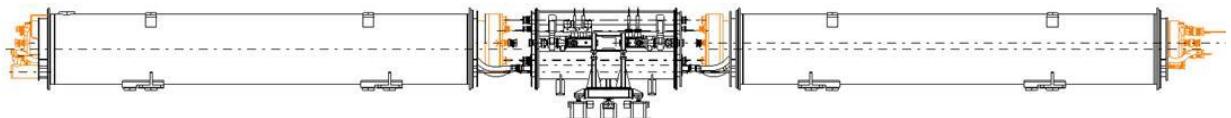
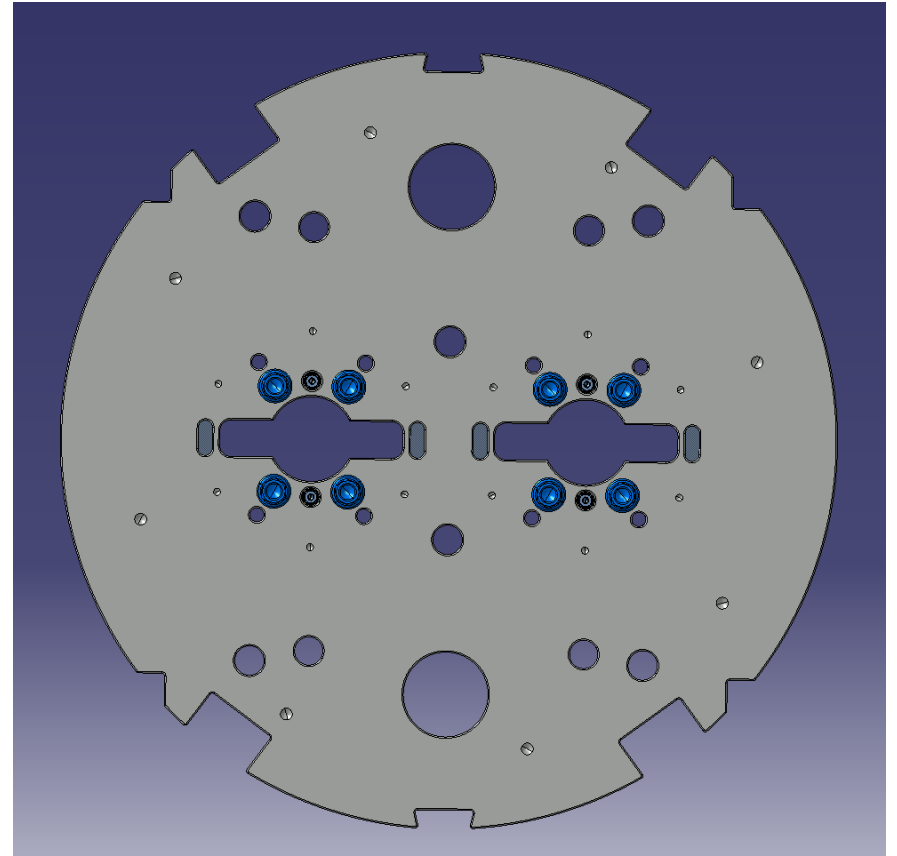
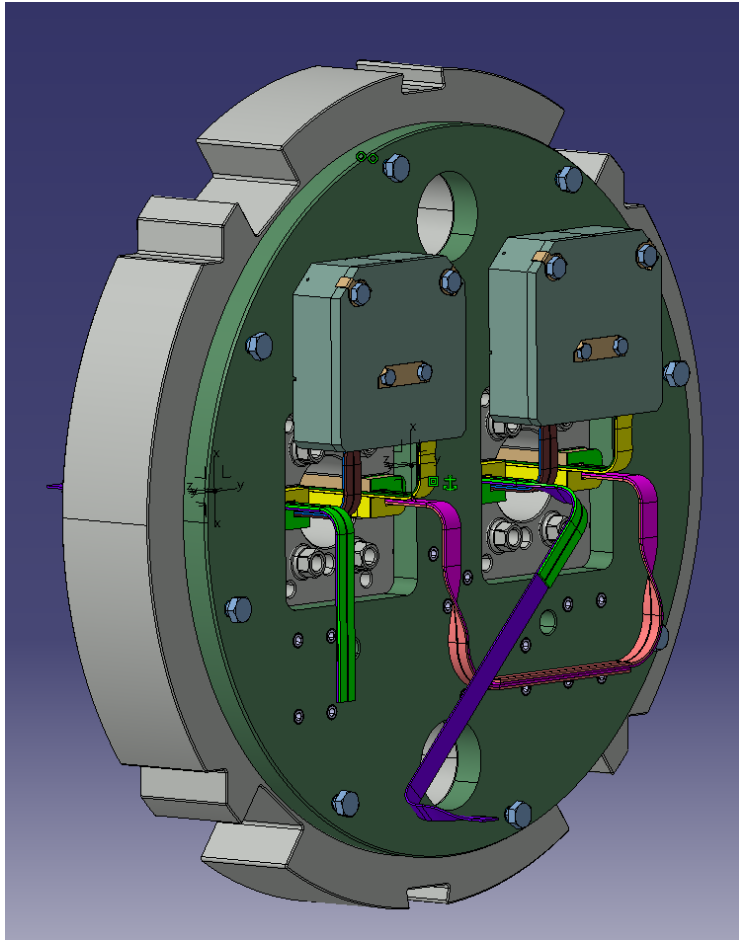

11T DIPOLE MAGNET 2 in 1 MBHDP101

CS END PLATE ASSEMBLY WITH BULLETS GAUGES 1IN1

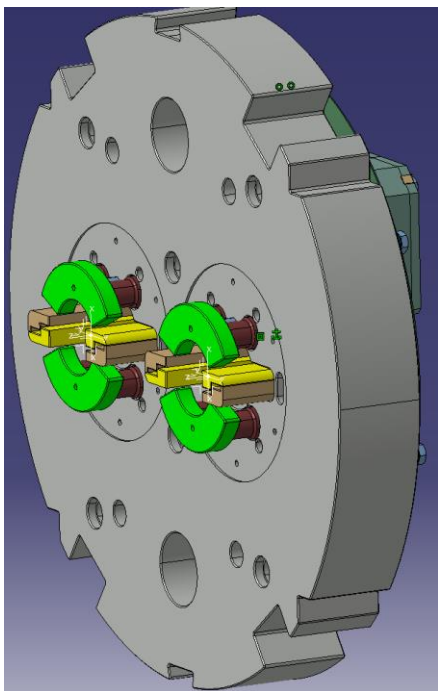

PLANS	INDICE	NUMERO ST	DESIGNATION	QTE / MAGNET	PLAN INPRIME	MODEL PROGRESS	A FABRIQUER	NOT VALIDE FOR EXECUTION	FOR CONTROL	FOR PRODUCTION	TYPE DE PLANS
2 in 1 CS END ASSEMBLY											
????	0	ST0429130_02	CS END ASSEMBLY	1							PLANS SOUS-ENSEMBLE COMPOSES DE:
LHCMBHDP0009	0	ST0385433_02	CS & RS INSULATION PLATE	2			OBSELETE				PLAN
LHCMBHDP0010	0	ST0429348_02	2 IN 1 GAUGESCREW M24	8							PLAN
LHCMBHDP0011	0	ST0289430_02	CYLINDRE FOR GAUGES	8							PLAN
LHCMBHDP0012	0	ST0682881	GAUGE PRESSURE PLATE VS	4							PLAN
LHCMBHDP0013	0	ST0428647_02	CS INSULATING PLATE ASSEMBLY	1							PLAN
LHCMBHDP0025	0	ST0385341_01	11T Magnet - 2in1 SC END FLANGE	1							PLAN

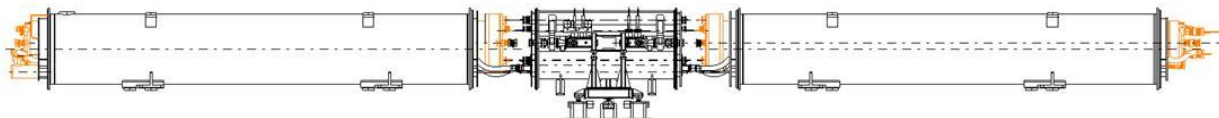

11T DIPOLE MAGNET 2 in 1 MBHDP101

RS END PLATE ASSEMBLY

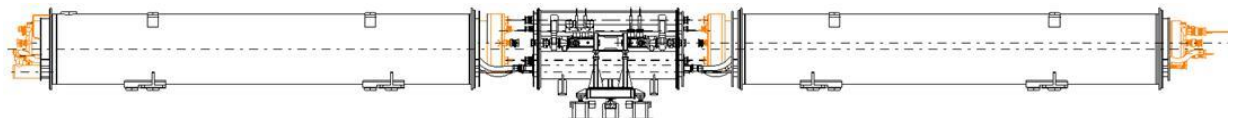
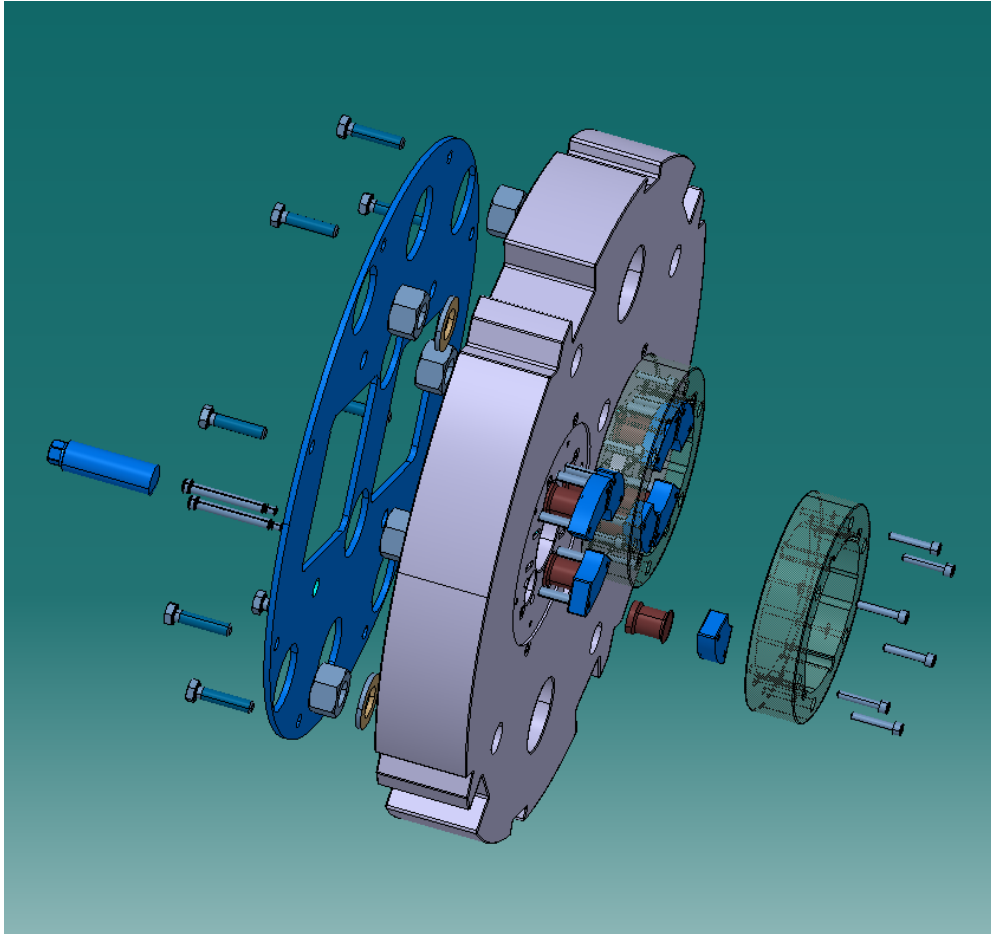

11T DIPOLE MAGNET 2 in 1 MBHDP101

RS END PLATE ASSEMBLY

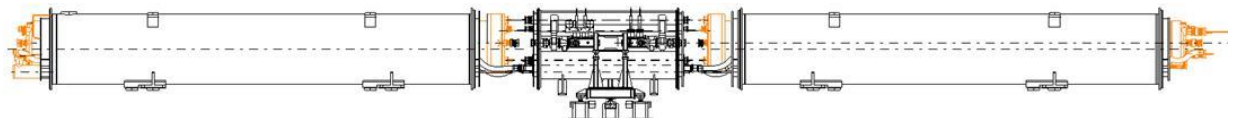
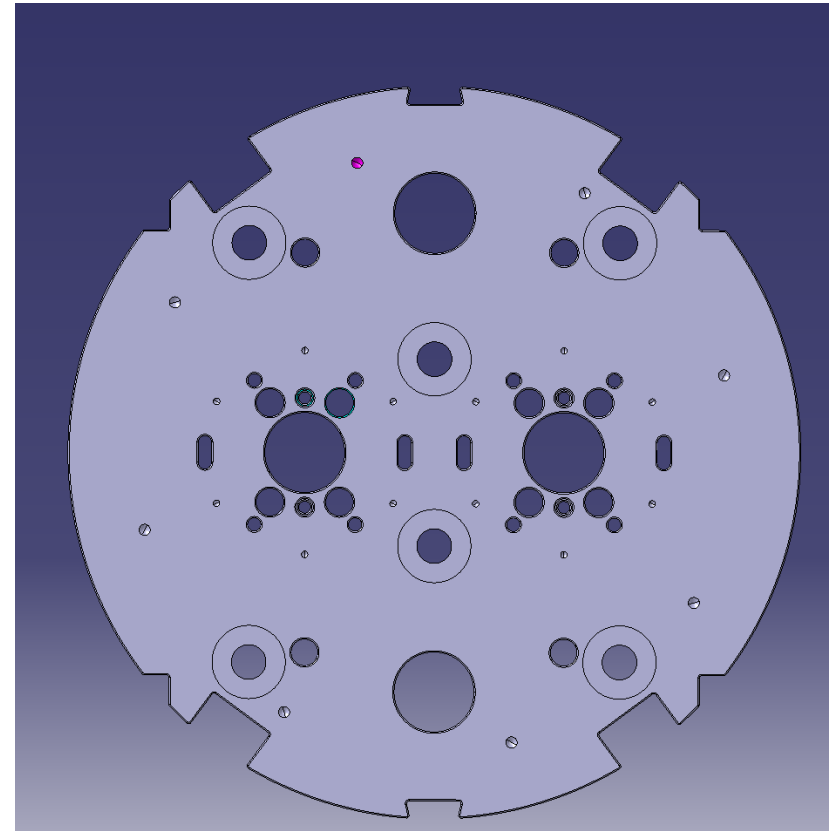
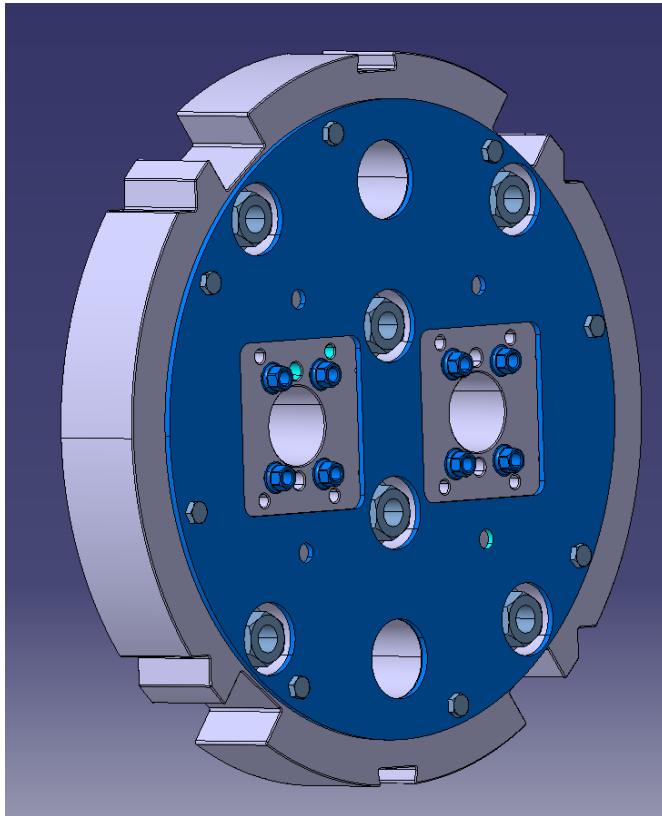

11T DIPOLE MAGNET 2 in 1 MBHDP101

RS END PLATE ASSEMBLY REVIEW DRAWING

PLANS	INDICE	NUMERO ST	DESIGNATION	QTE / MAGNET	PLAN INPRIME	MODEL PROGRESS	A FABRIQUER	NOT VALIDE FOR EXECUTION	FOR CONTROL	FOR PRODUCTION	TYPE DE PLANS
2 in 1 RS END ASSEMBLY											
????	0	ST0429377_02	RS END ASSEMBLY	1							PLANS SOUS-ENSEMBLE COMPOSES DE:
LHCMBHDP0009	0	ST0385433_02	CS & RS INSULATION PLATE	2							PLAN
LHCMBHDP0010	0	ST0429348_02	2 IN 1 GAUGESCREW M24	8							PLAN
LHCMQXCM0101	0	ST0289430_02	CYLINDRE FOR GAUGES	8							PLAN
LHCMBHSP0247	0	ST0682881	GAUGE PRESSURE PLATE V5	4							PLAN
LHCMBHSP0144	0	ST0418596_02	END PLATE DISTANCE RING	2							PLAN
LHCMBHDP0024	0	ST0385392_01	11T Magnet - 2in1 RS END FLANGE	1							PLAN

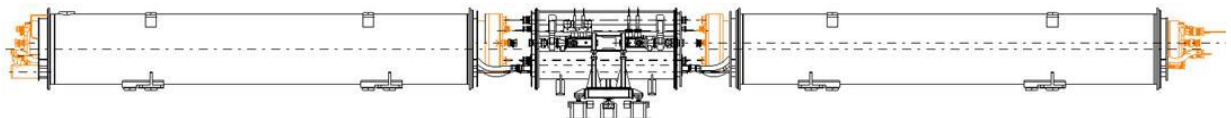

11T DIPOLE MAGNET 2 in 1 MBHDP102

Priority 3: Develop the 3D model of the extremities of the prototype and of the model for the 2-1 assembly MBHDP102. They should be identical.

- The yoke OD shall be 540 mm and the yoke shall have an integrated cut-back, i.e. non-magnetic steel laminations in the ends (Frédéric and Susana to check whether these can be full non-magnetic laminations);
- The design of the yoke shall be revised to be compatible with the alignment features and assembly requirements (Hervé to check this). Once the design is revised, we shall check the magnetic design (Susana) and the mechanical integrity (Christian/Friedrich);

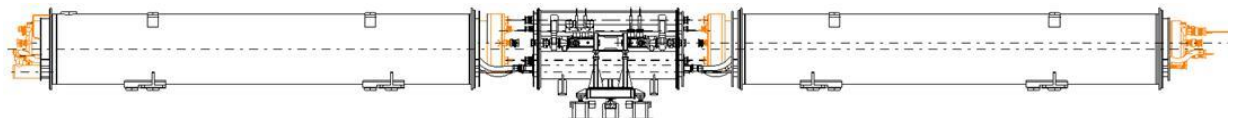

DESIGN 11T 2 in 1 LONG COIL

- Remove the 8-9 mm gap that was left between the outermost turn and the saddle because the coils were actually longer than defined by Roxie.
However, we do not make the saddles longer to compensate for this.
This means that the coils will be shorter than what we have on the drawing because we will not change now the length of the winding pole and, anyway,
there are other reasons for the coils to be different in length in reality, when compared to the drawing. The model and the drawings will be updated when the prototype is done and we have all the necessary information to determine the exact length of the coils that we need for the series.

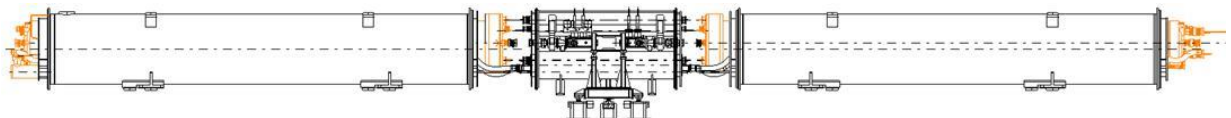

DESIGN 11T 2 in 1 LONG COIL REVIEW DRAWING

Design Number allocated	N° SMARTTEAM		11T DIPOLE - COLLARED COILS					
LHCMBH_C0001		11T DIPOLE - COLLARED COILS General Assembly	LHCMBH_C0001 (refer to sp0002)					
LHCMBH_C0002			LHCMBH_C0002 (reserved)					
LHCMBH_C0003		11T DIPOLE - COLLARED COILS Paired Coils - Shimming	LHCMBH_C0003 (refer to sp0162)					
LHCMBH_C0004			LHCMBH_C0004 (reserved)					
LHCMBH_C0005		11T DIPOLE - COIL COIL (external trace) 11T DIPOLE - COIL Coil Cross-Section (Ext. Trace) 11T DIPOLE - COIL COIL variant with EMBEDDED GH 11T DIPOLE - COIL Coil Cross-Section (variant Emb. GH) RESERVED RESERVED	LHCMBH_C0005					
LHCMBH_C0006			LHCMBH_C0006					
LHCMBH_C0007			LHCMBH_C0007 (reserved)					
LHCMBH_C0008			LHCMBH_C0008 (reserved)					
LHCMBH_C0009			LHCMBH_C0009 (reserved)					
LHCMBH_C0010			LHCMBH_C0010 (reserved)					
LHCMBH_C0011		11T DIPOLE - COIL Unreacted Coil flaser Layer 11T DIPOLE - COIL Unreacted Coil (Outer Layer 11T DIPOLE - COIL Insulated SC Cable COIL - Insulated Wedge 1 Inner COIL - Insulated Wedge 2 Inner COIL - Insulated Wedge 3 Inner COIL - Insulated Wedge 4 Outer COIL - Insulated Wedge 5 Outer COIL - Insulated Wedge 6 Outer COIL - Key C4LI-K COIL - Key C4RI-K COIL - Key C4RO-K COIL - Key C4LO-K COIL - Saddle C4LI-S COIL - Saddle C4RI-S COIL - Saddle C4RO-S COIL - Saddle C4LO-S COIL - Spacer Set IL COIL - Spacer Set OL COIL - Loading Plate COIL - Ceramic Insert LJ	LHCMBH_C0011					
LHCMBH_C0012			LHCMBH_C0012					
LHCMBH_C0013	ST0682468		LHCMBH_C0013					
LHCMBH_C0022	ST0682479		LHCMBH_C0022					
LHCMBH_C0023			LHCMBH_C0023					
LHCMBH_C0024			LHCMBH_C0024					
LHCMBH_C0025			LHCMBH_C0025					
LHCMBH_C0026			LHCMBH_C0026					
LHCMBH_C0027			LHCMBH_C0027					
LHCMBH_C0028			LHCMBH_C0028					
LHCMBH_C0029			LHCMBH_C0029					
LHCMBH_C0030			LHCMBH_C0030					
LHCMBH_C0031			LHCMBH_C0031					
LHCMBH_C0032			LHCMBH_C0032					
LHCMBH_C0033			LHCMBH_C0033					
LHCMBH_C0034			LHCMBH_C0034					
LHCMBH_C0035		LHCMBH_C0035						
LHCMBH_C0036		LHCMBH_C0036						
LHCMBH_C0037		LHCMBH_C0037						
LHCMBH_C0038		LHCMBH_C0038						
LHCMBH_C0039		LHCMBH_C0039						
LHCMBH_C0040		LHCMBH_C0040						
LHCMBH_C0041		LHCMBH_C0041						
LHCMBH_C0042		LHCMBH_C0042						
LHCMBH_C0043		LHCMBH_C0043						
LHCMBH_C0044		LHCMBH_C0044						
LHCMBH_C0045		LHCMBH_C0045						
LHCMBH_C0046		LHCMBH_C0046						
LHCMBH_C0047		LHCMBH_C0047						
LHCMBH_C0048		LHCMBH_C0048						
LHCMBH_C0049		LHCMBH_C0049						
LHCMBH_C0050		LHCMBH_C0050						
LHCMBH_C0014			11T DIPOLE - COIL Ground Insulation Scheme (Ext.					
				LHCMBH_C0014				

