

PRACTICAL MATTERS

- Overview of Programme
- Locations
- Help

Programme Overview

Monday 6 April

Registration/lunch	12:00	
Plenary I	13:30	Collider physics
Tea	15:30	
Parallel I	16:00	A (MW); B (L); C (DS)
Reception	18:00 – 20:30	University Museum

All plenary sessions
are in the Martin Wood
Lecture Theatre

Parallel Session Lecture Theatres
A: Martin Wood
B: Lindemann
C: Dennis Sciama (DWB, Keble Rd)

Tuesday 7 April

Plenary II	09:00	LHC
Coffee	10:30	
Parallel II	11:00	A (MW); B (L); C (DS)
Lunch	13:00	
IoP (Lindemann)	13:45	New PAB group
Town mtg (a)	14:00	STFC
Tea	15:30	
Town mtg (b)	16:00	STFC
HEPP Group	17:05	PP2020
Conference Dinner	19:00 for 19:30	Christ Church Hall Pay bar until midnight

Wednesday 8 April

Plenary III	09:00	Neutrinos/dark matter
Coffee	11:00	
Parallel III	11:30	A (MW); B (L); C (DS)
Lunch	13:00	
IoP (Lindemann)	13:30	HEPP group AGM
Plenary IV	14:00	Outlook
Close	15:30	

Note that rooms in Balliol and Jowett Walk must be cleared by 10:00 and that the College will close at 13:00

It is recommended that you bring your luggage to the MW with you. We will keep it near the Main Desk and under observation at all times

Locations



C: Clarendon Lab, Martin Wood Complex
Lindemann Lecture Theatre

P: Particle Physics (Denys Wilkinson Bldg)

Pedestrian crossing here – Parks Rd can be quite busy at various times during the day

M: University Museum (Reception, Tuesday)

B: Balliol College

J: Balliol, Jowett Walk annexe

X: Christ Church (Conference Dinner, Wednesday)

Clarendon Building

Ground floor

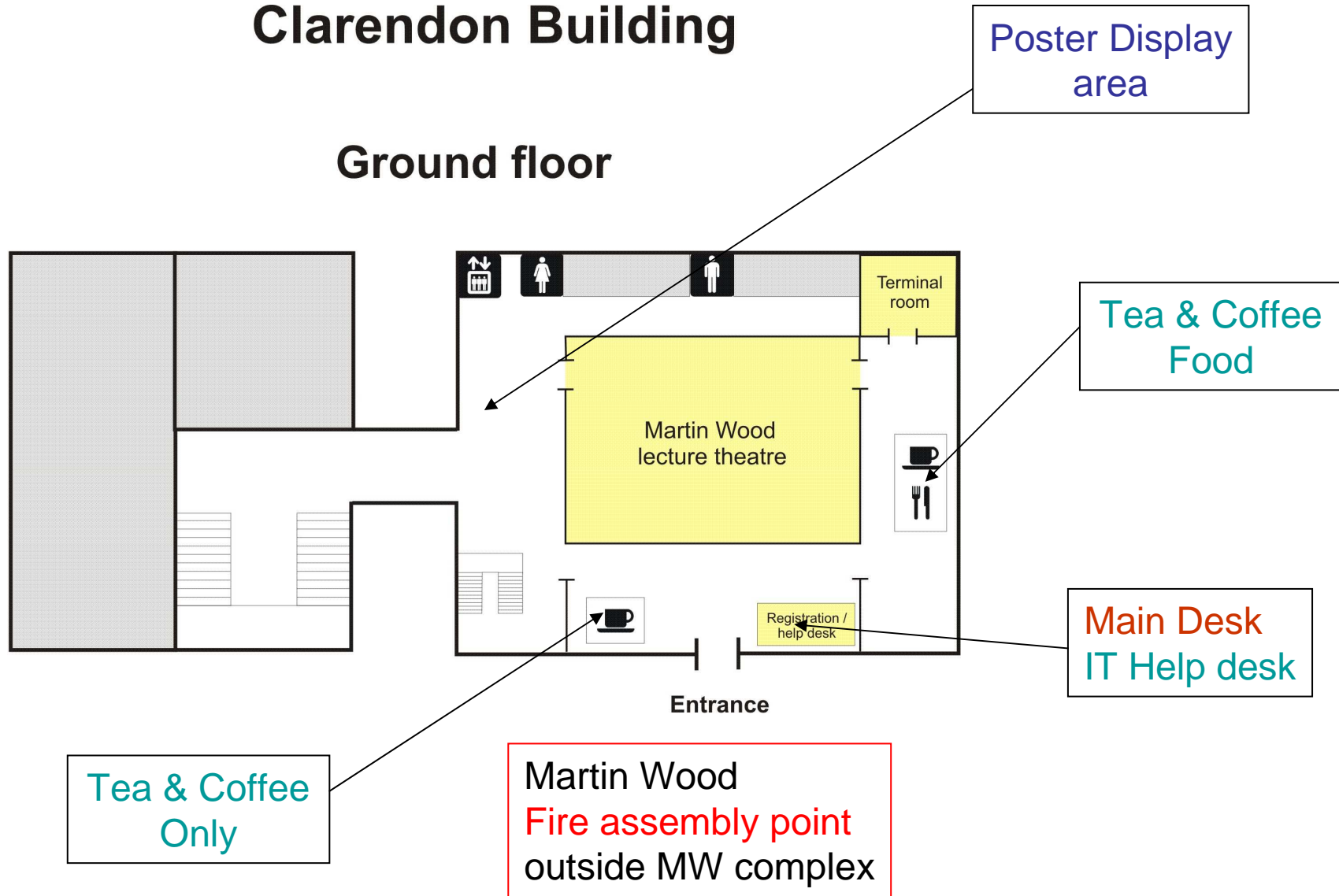

1st floor

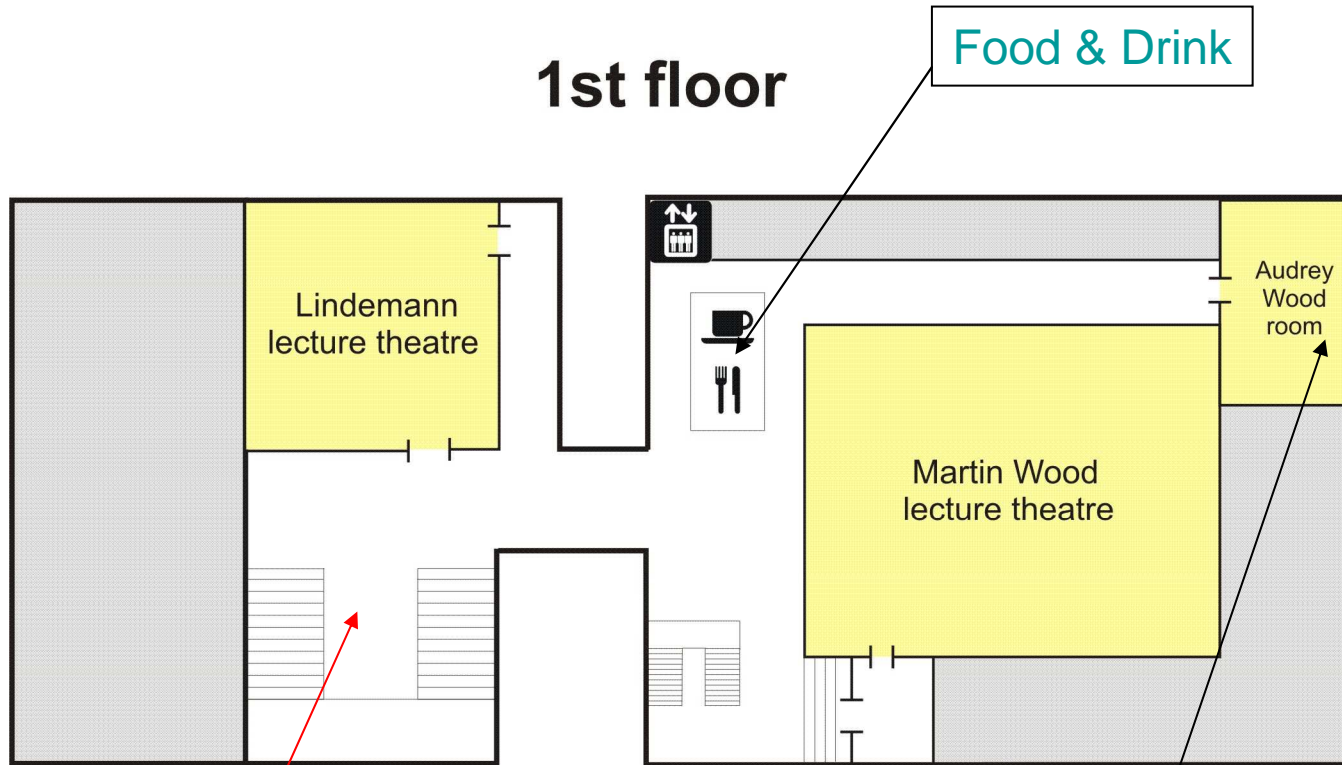

Food & Drink

Lindemann
lecture theatre

Audrey
Wood
room

Martin Wood
lecture theatre

Lindemann
fire assembly point
- down main stairs
- outside entrance

Display area: GRIDPP, OUP, EPJC
Ratcliffe Science Library (RSL)
Tour of the RSL, Tuesday 1800 – sign up

Denys Wilkinson Building

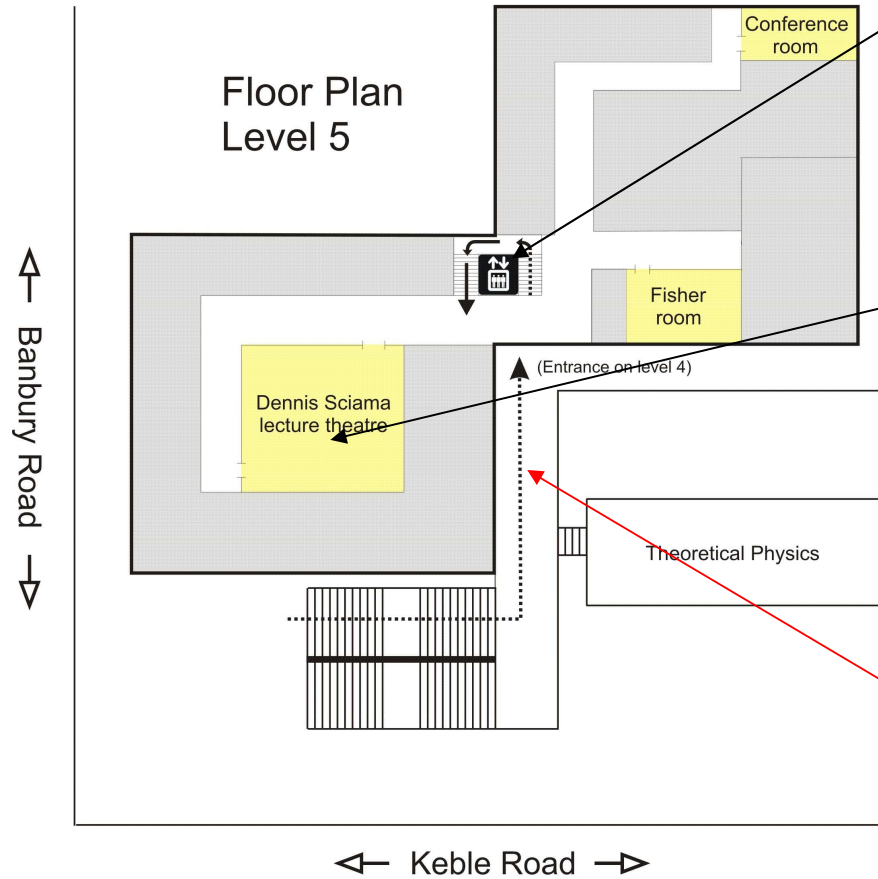

Stairs and lift - level 5 is one floor up from the entrance level

We are using the Dennis Wilkinson Lecture Theatre for Parallel sessions only

Fire assembly point

All coffee and tea provision, help desks etc are on the Clarendon side

 Toilets can be found close to the central staircase on level 4 and 6.

Help

- The Conference Main Desk (Martin Wood Foyer)
 - all matters to do with registration and payment
 - help and advice on transport
 - emergency phone or video conferencing
- IT Help Desk
 - wireless access
 - Indico problems
 - specials
- Balliol College Porters Lodge
 - questions to do with rooms and breakfast

PLEASE WEAR YOUR CONFERENCE BADGE AT ALL TIMES

You will need it to gain access to:

- the Denys Wilkinson Building (for the Dennis Sciama Lecture Theatre)
- the Reception in the University Museum
- the Conference Dinner in Christ Church

PLEASE TURN OFF MOBILE PHONES