

MEDICIS

Safety Alarms Systems

D. Raffourt

S. Grau Speaker



Safety Alarm Systems

Fire detection and evacuation

Outline

1. Requirements
2. Architecture
3. Layout
4. Status
5. Resources

1. Requirements

Compliant with Cern code E:

- Fire detection In Workshop – Laboratories - Technical services room - Corridors
- Evacuation sirens, automatically triggered by the fire detection system. Distributed manual push buttons mainly in the escape passages and near the exit doors

Additional requests:

- Fire detection on last filtrations stages
- Fire detection on electrical cabinet in CV room

Not included

- Fire detection in hot cells

2. Architecture

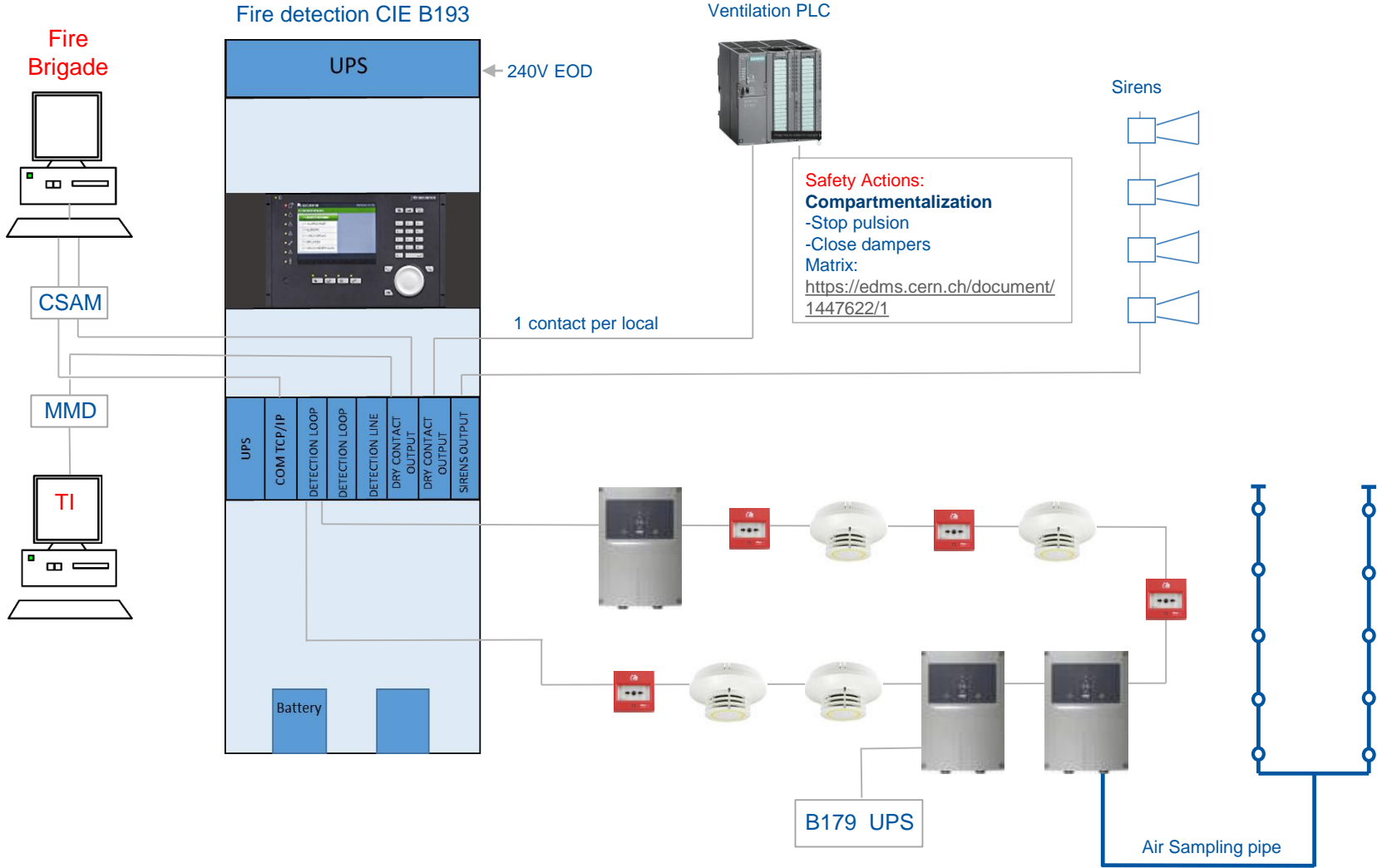

3. Fire detection layout

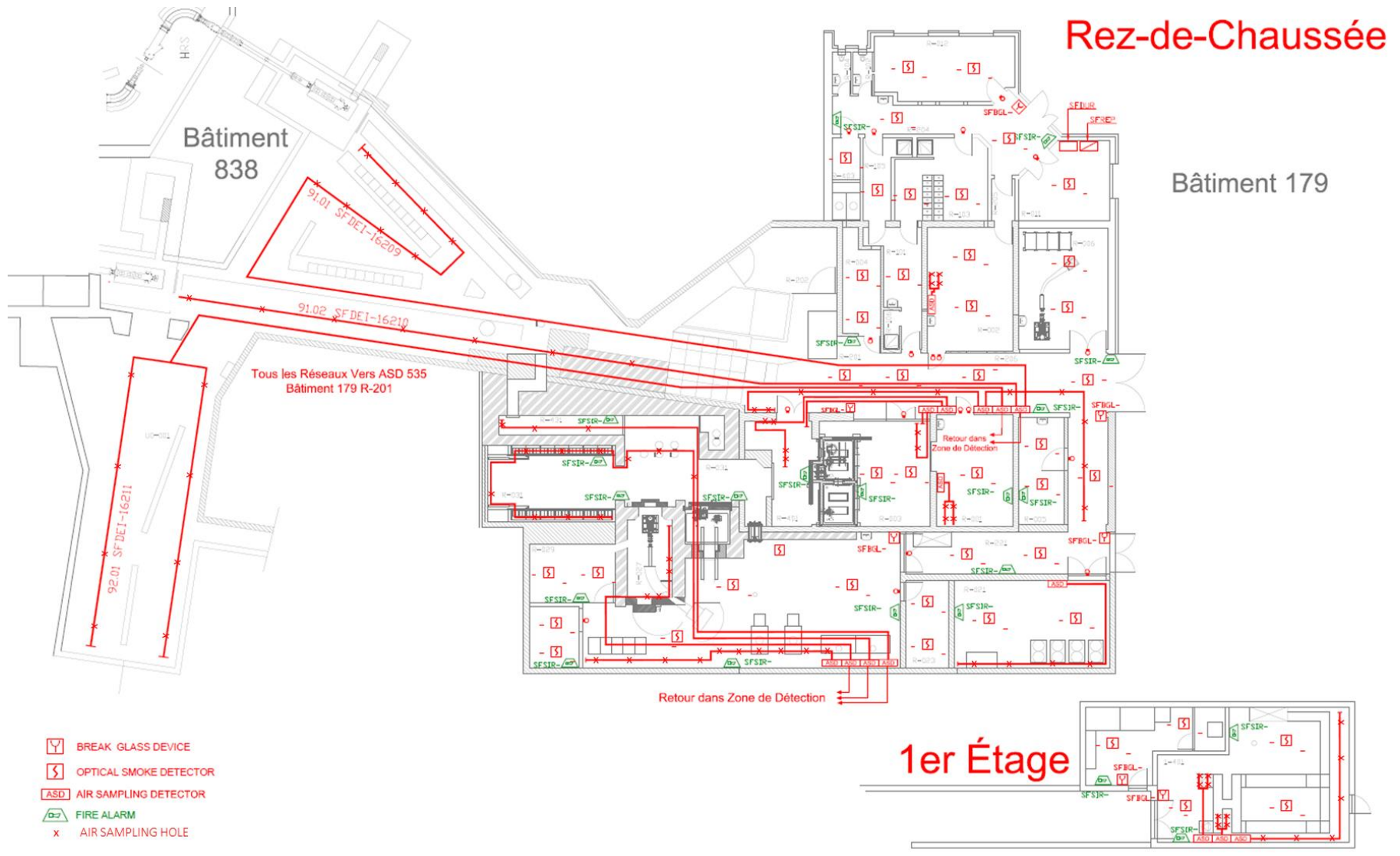

-  BREAK GLASS DEVICE
-  OPTICAL SMOKE DETECTOR
-  AIR SAMPLING DETECTOR
-  FIRE ALARM
-  AIR SAMPLING HOLE

1er Étage

4. Fire detection and evacuation status

- Requirements 
- Preliminary design 
- Details design : 
- CIE Installation : 
- Cables B193 to B171 : 
- Integration : Some details to be fixed
- Contract Orders : March 2016
- Implementation : April 2016
- Commissioning : May 2016

5. Resources

1. Contracts

- Fire detection and evacuation : **B1212 Hekatron**

2. FTE

- 2015: 0.05 2016: 0.05

3. Budget

MEDICIS DI/EVAC	KCHF
Engineering	10
Supply	50
Cabling	25
Installation	25
Commissioning	10
CIE	0
TOTAL DI+EVAC	120