

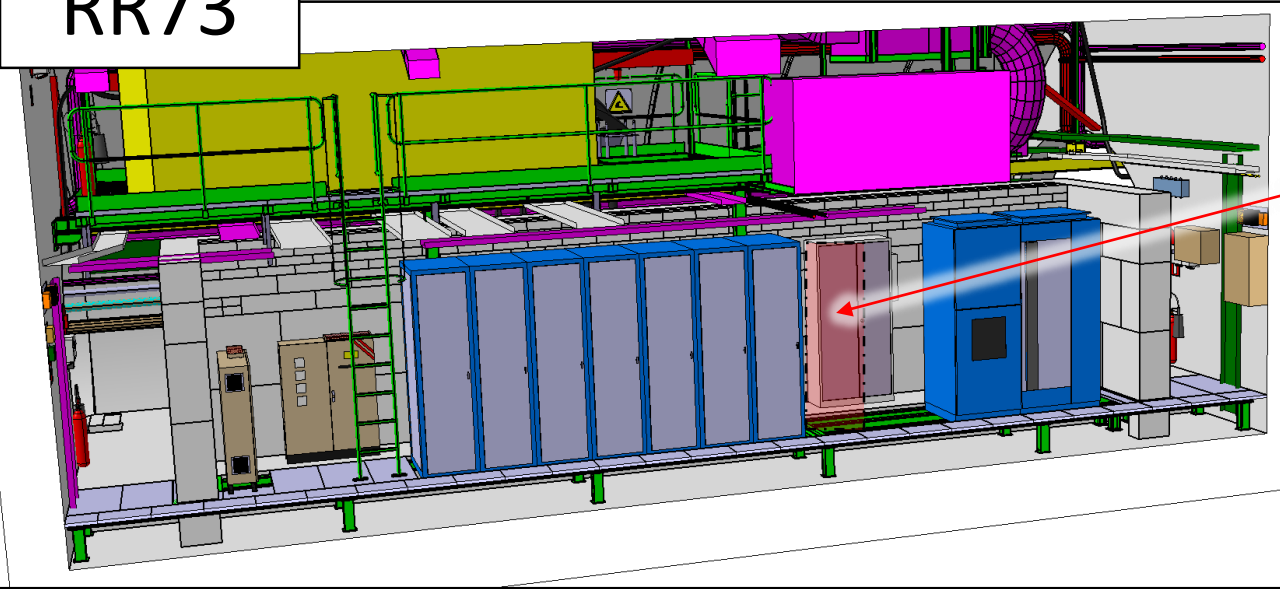

AFTER VISIT (04/11/2016) of RR73

1- PROPOSAL : POSITION OF POWER CONVERTOR 600A

RR73



1 - remove rack RYSA 01 (SPARE EPC)

See pictures after

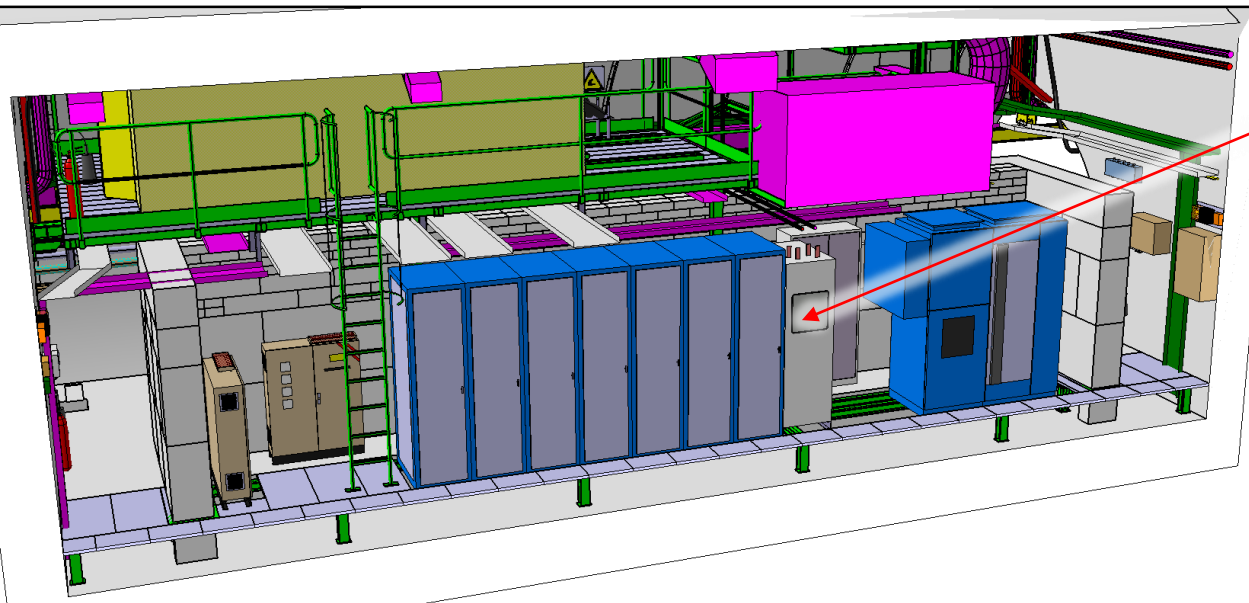

2 - PLACE PC for 11T

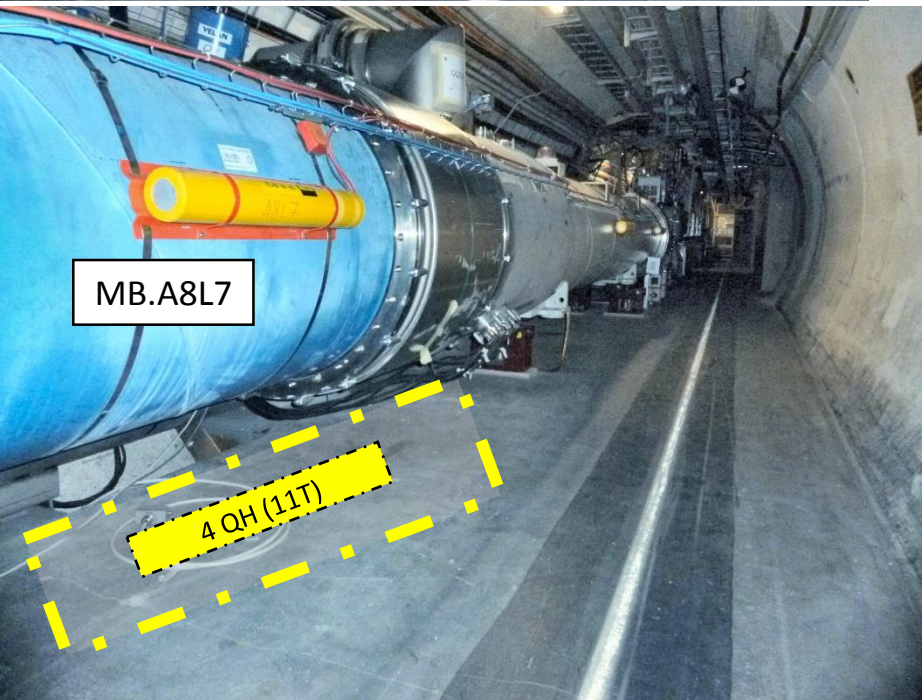

3- FOUND SPACE AT BOTTOM OF MACHINE
TO PUT THE QUENCH HEATERS

(SEE LAYOUT MACHINE AFTER)

PHOTO 04/11/2016



**RACK RYSA 01 :
NOT IN INTEGRATION !
NOT IN DATA BASE !**



08/11/2016

-CABINET: uiac_00763 SUR ERD1/73



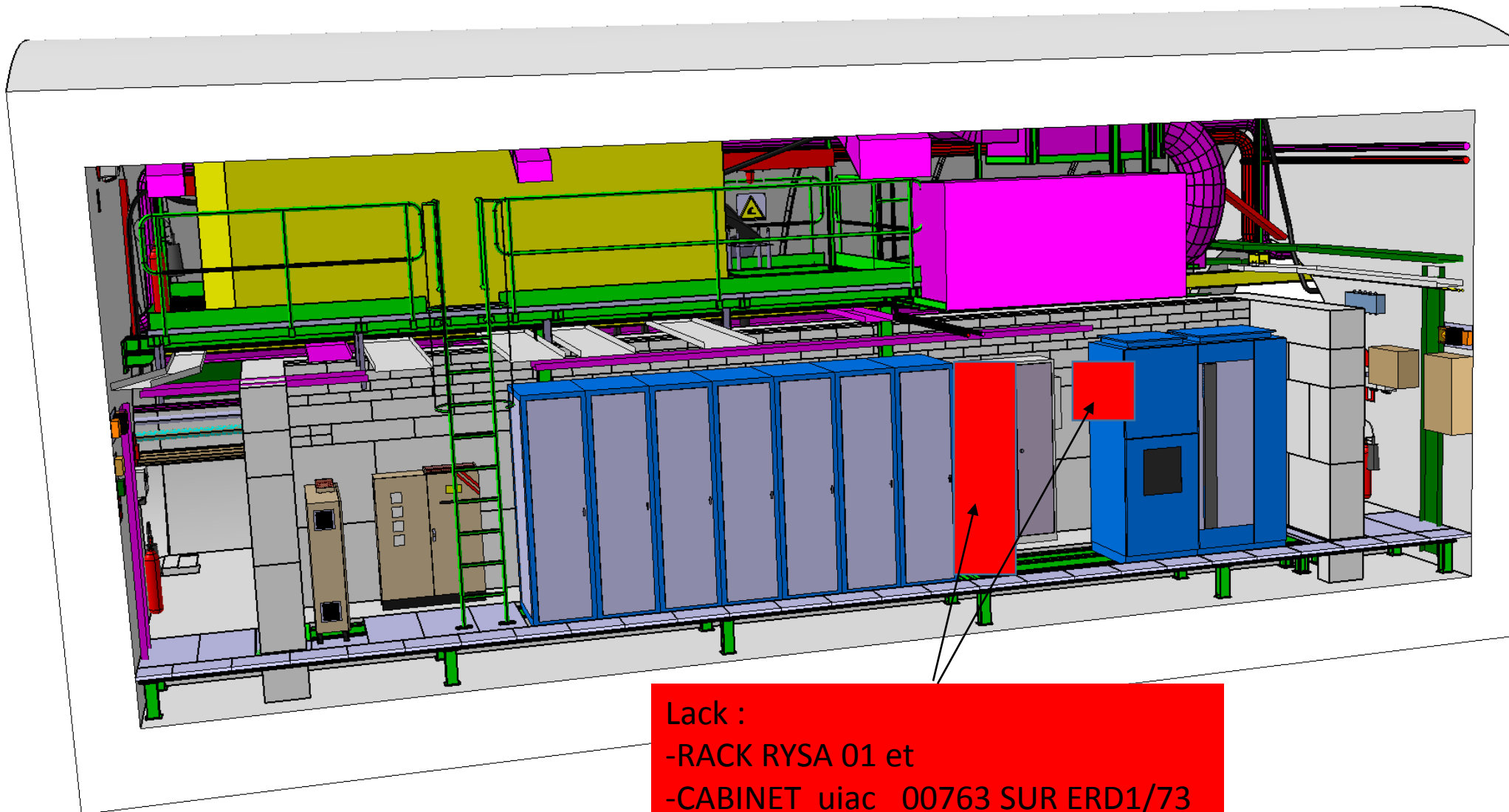

Lack :
-RACK RYSA 01 et
-CABINET uiac_00763 SUR ERD1/73

ST0640100_01 : RR73-1701-INTEG GENE 2014



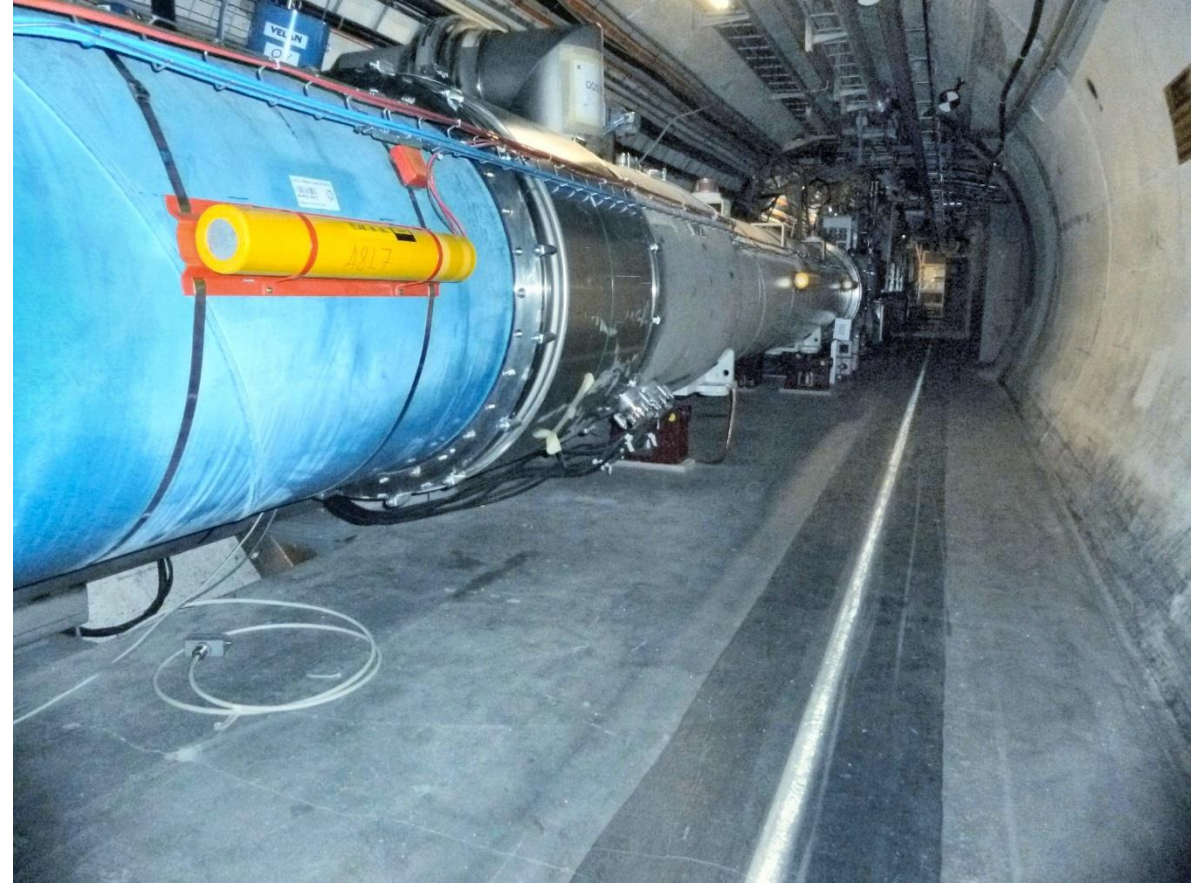



Option :

2-position of Quench heaters DQHDS (needs 16 + 3 pw sup)



- Solution 2 : specific racks or chassis at 1st floor

RR77

LS2

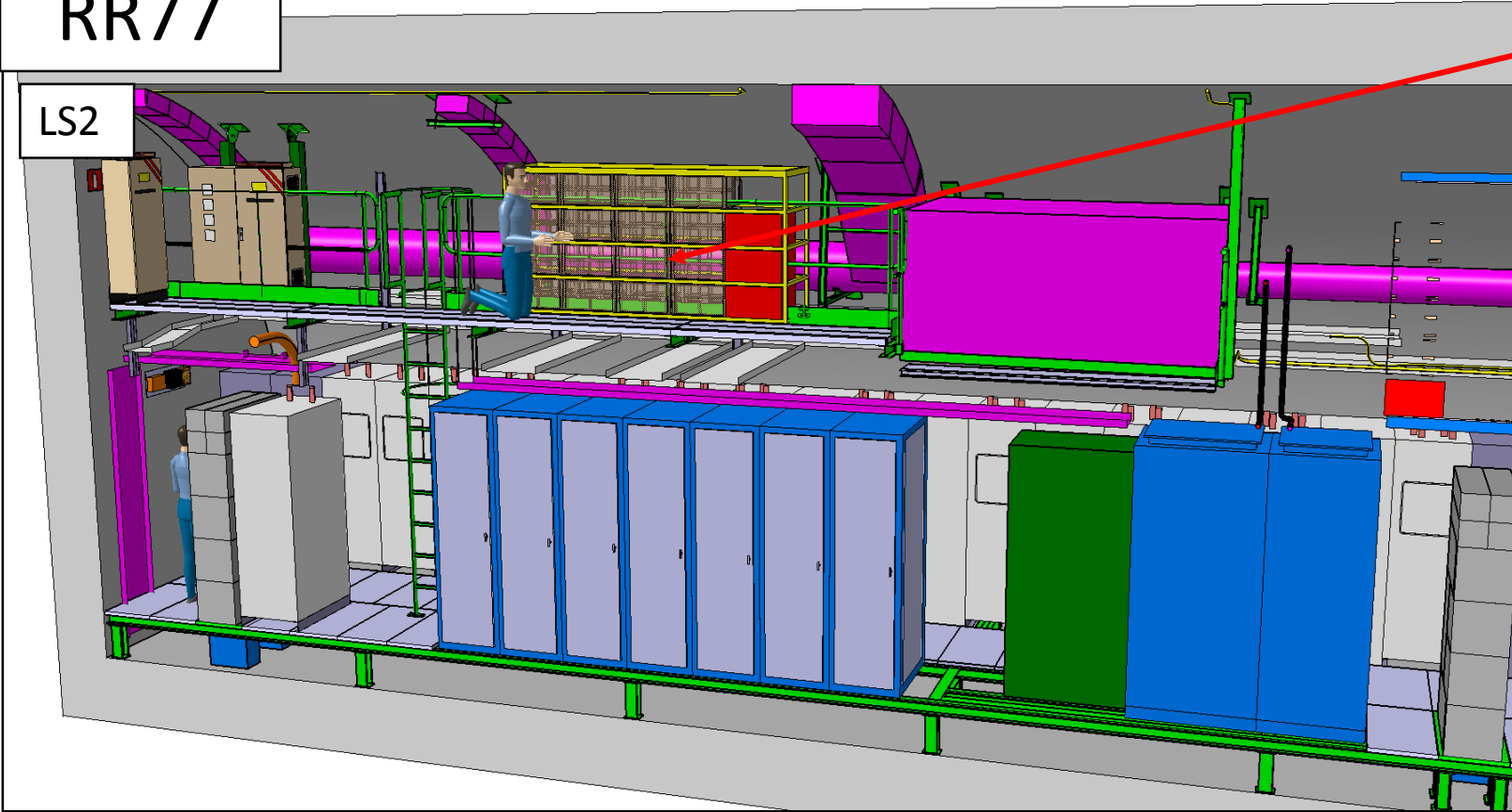

SPECIFIC CHASSIS (IF POSSIBLE) WITH
16 DQHDS + 3 PWS

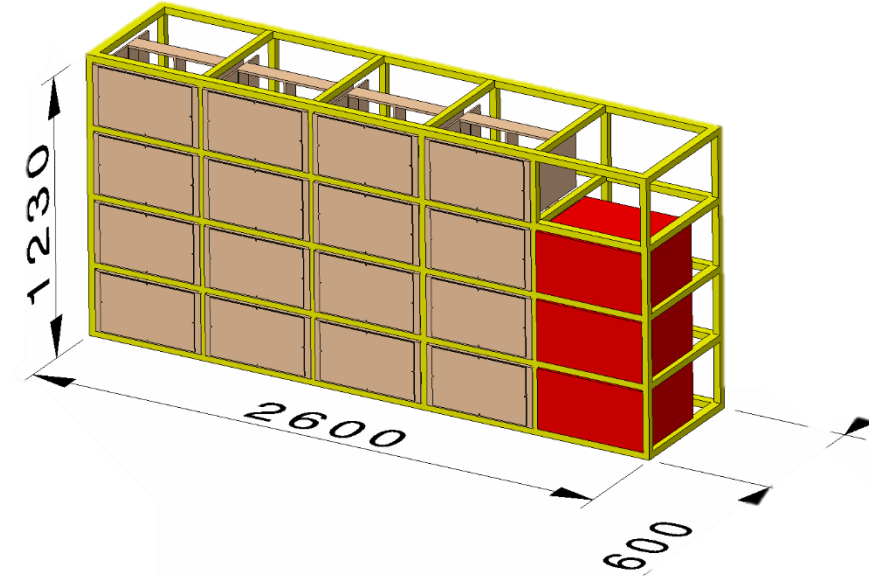



Control if we can have QH on top of connexion

Extra slides

SPACE AT BOTTOM OF MACHINE

FOUND SPACE FOR

4 X

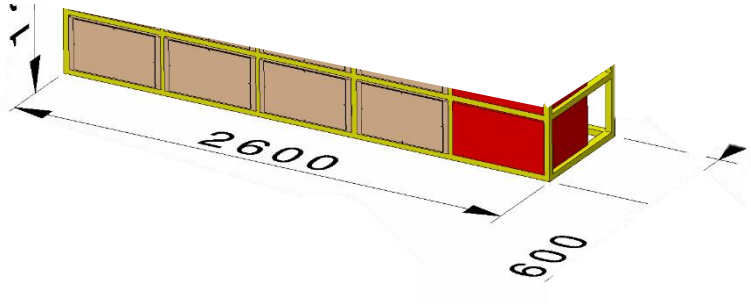

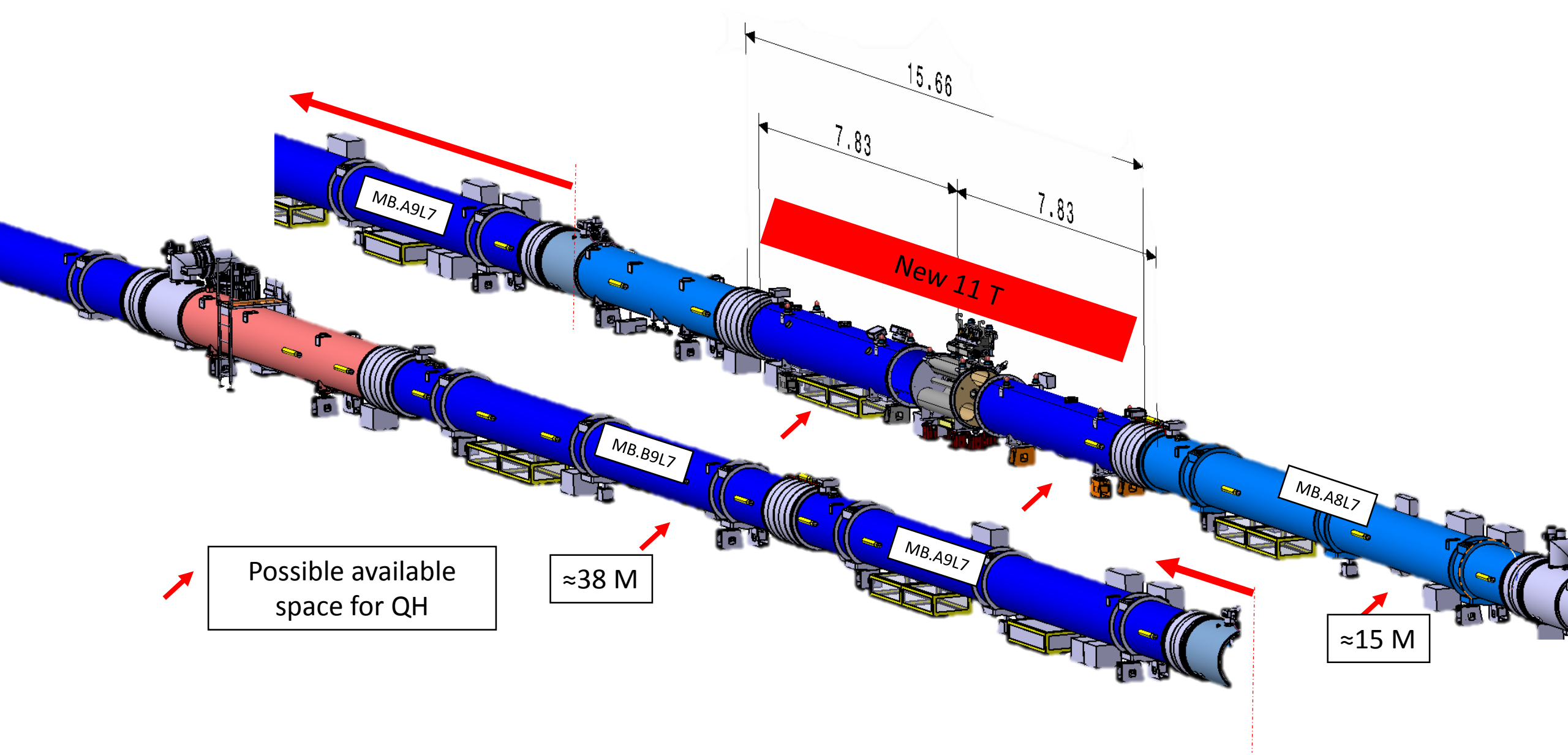

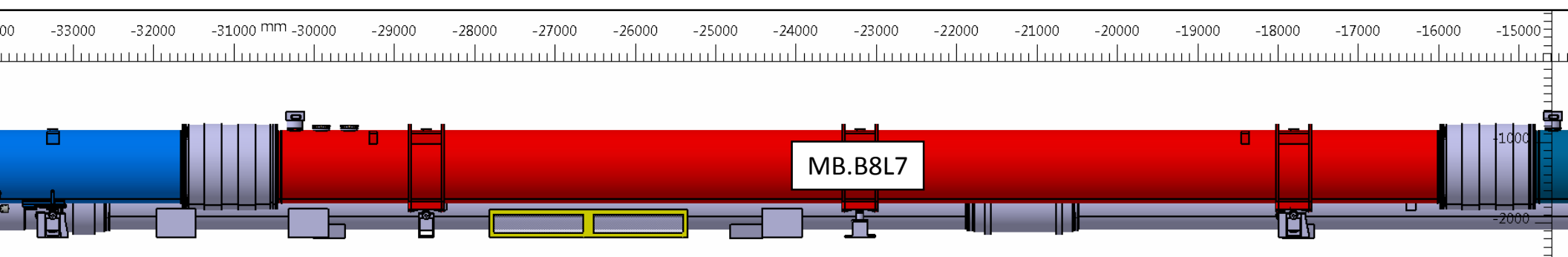
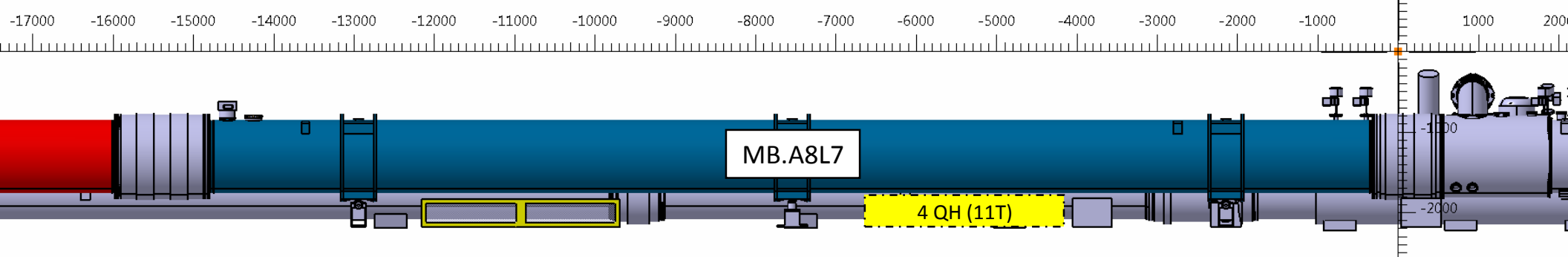
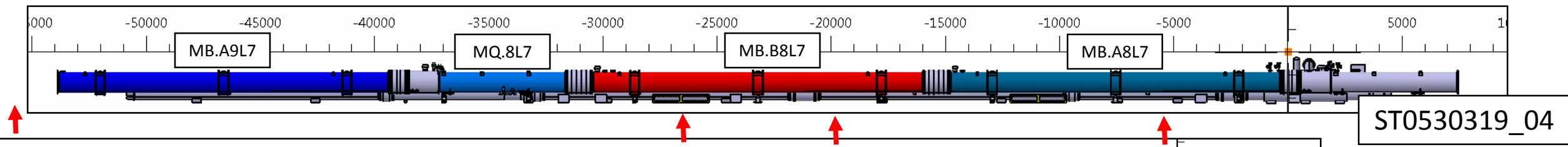

ST0530314_09

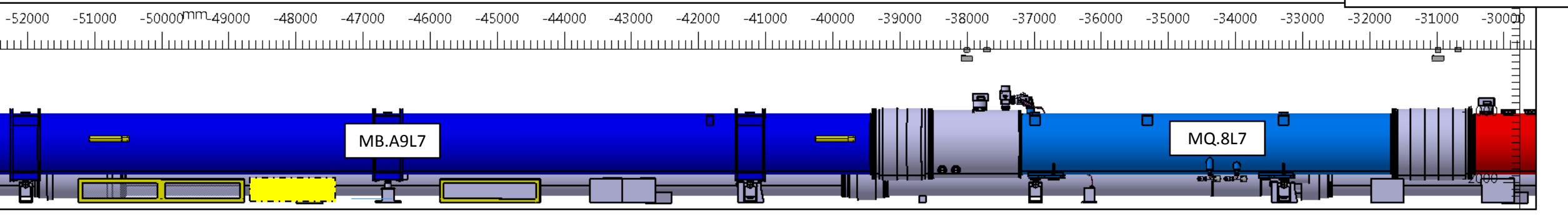

LHC

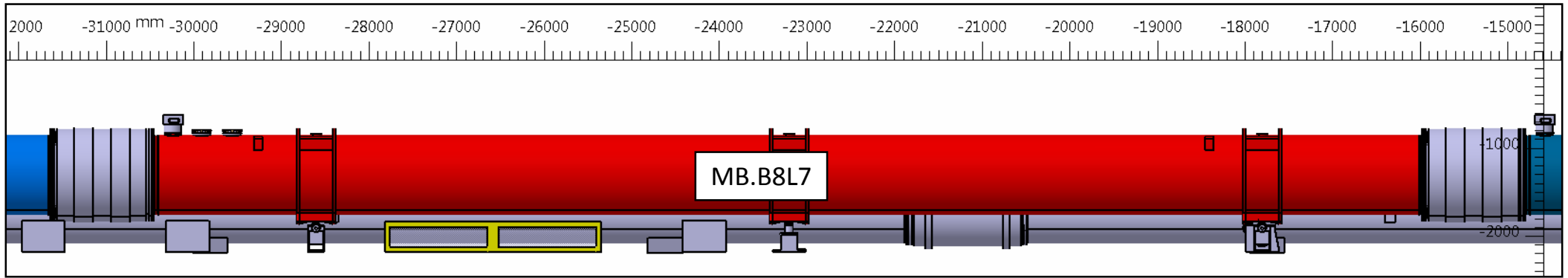

LS2
11 T

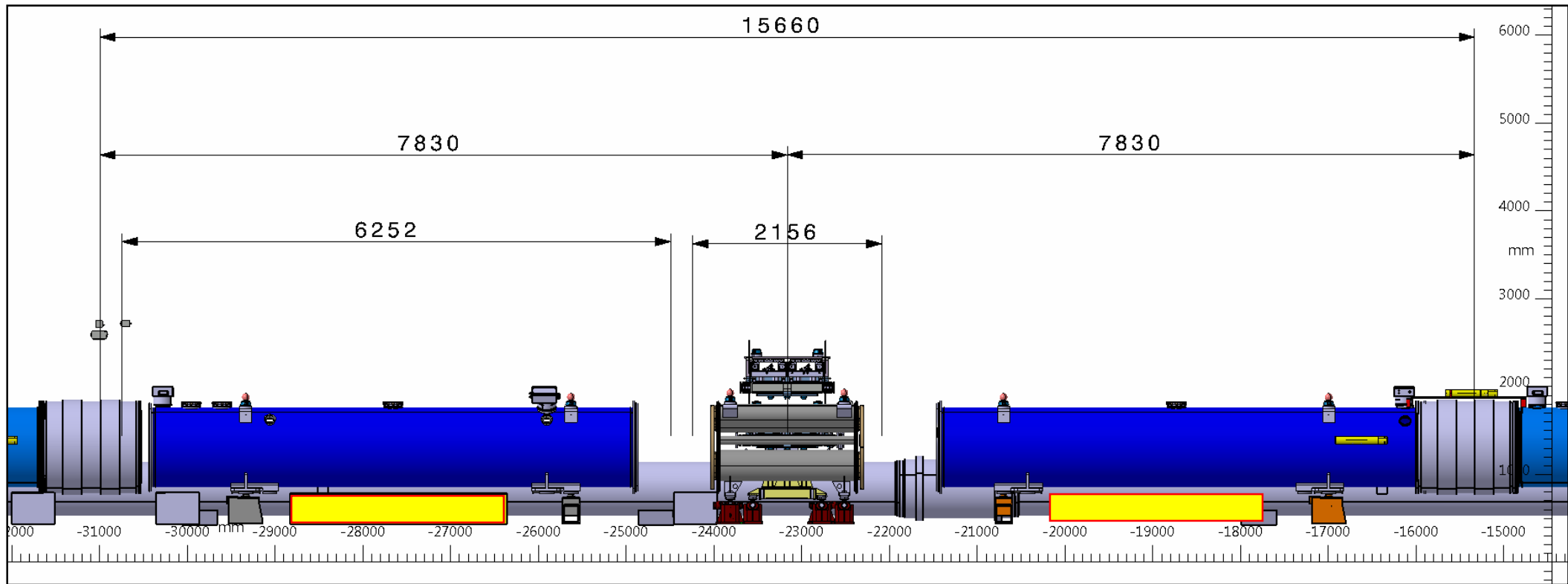

4 QH (11T)

4 QH (11T)

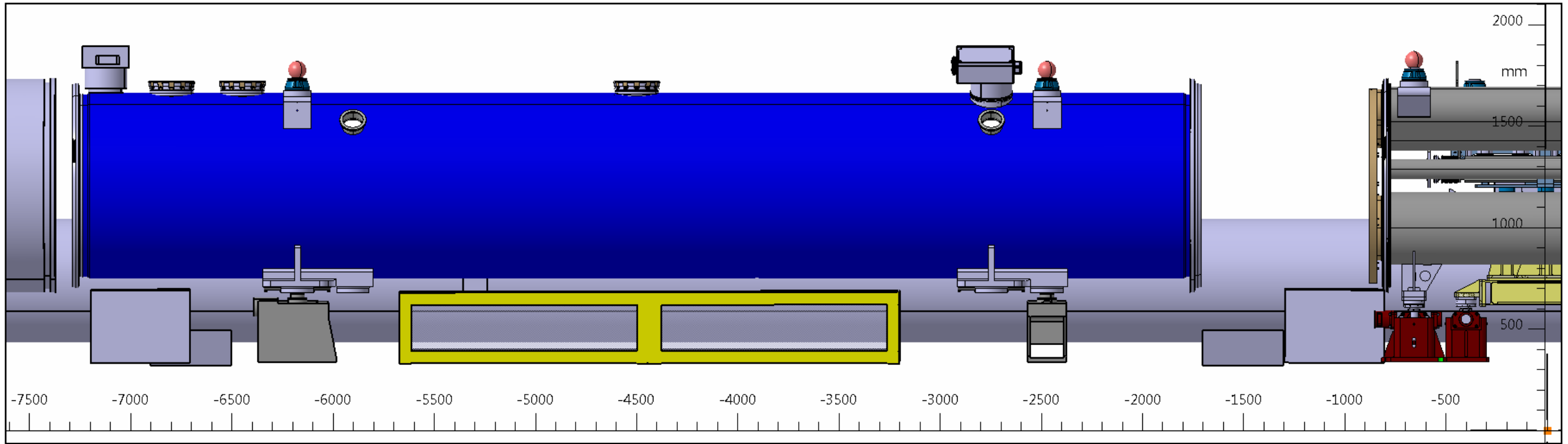

Control if feasible
(Need free space around jacks)

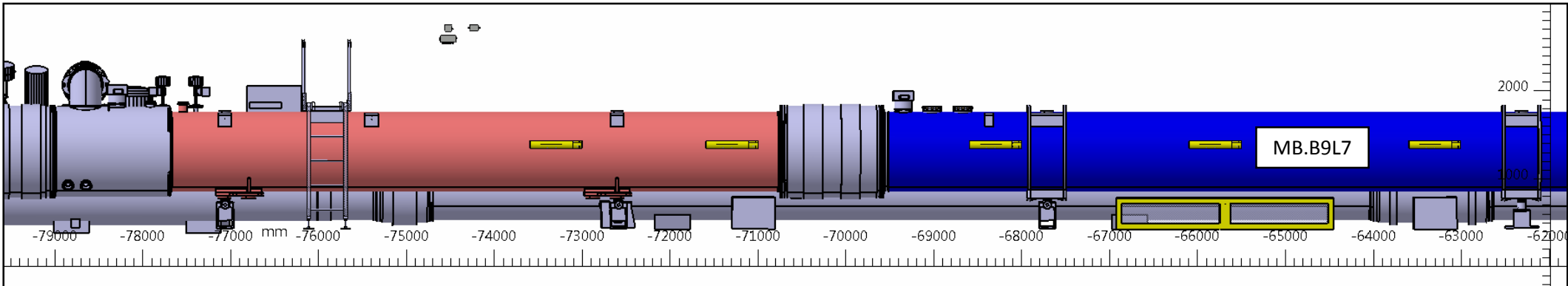
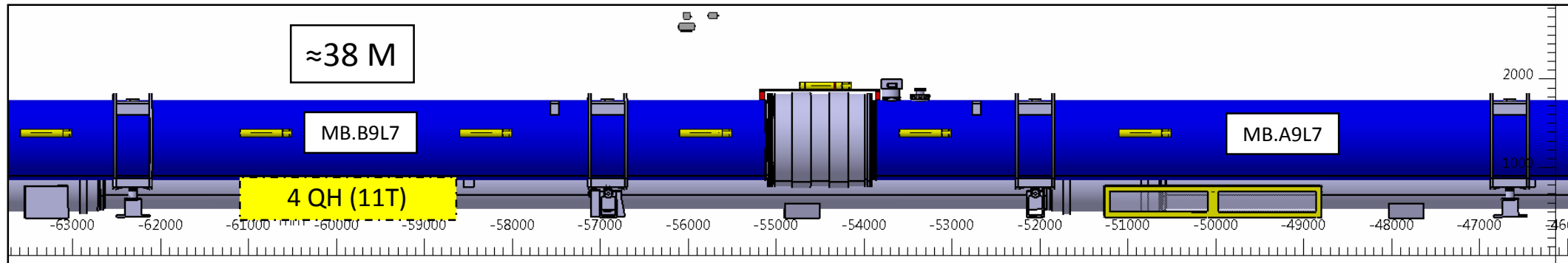
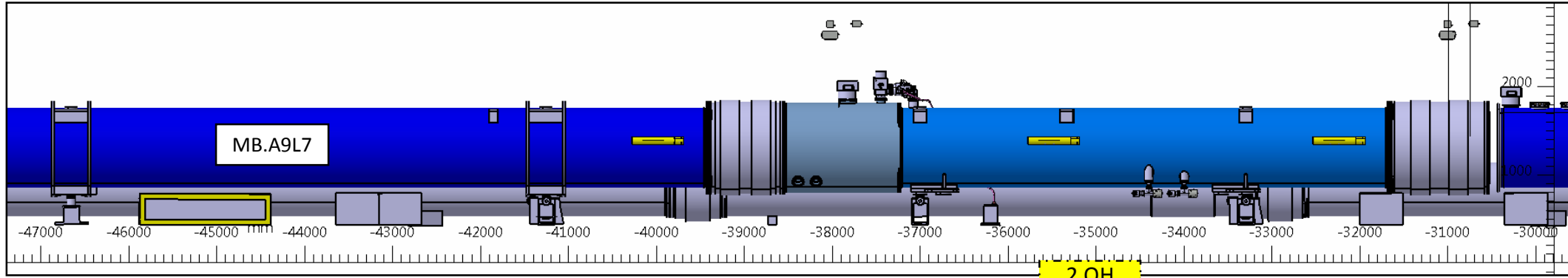

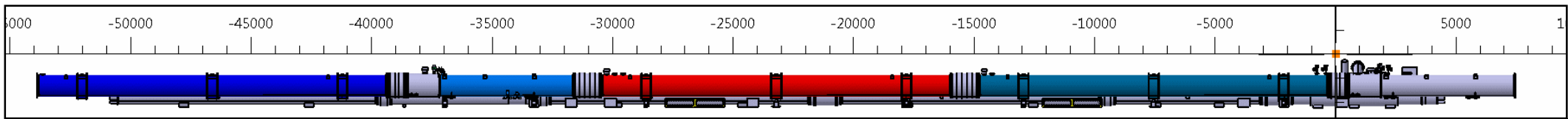

ST0530319_04

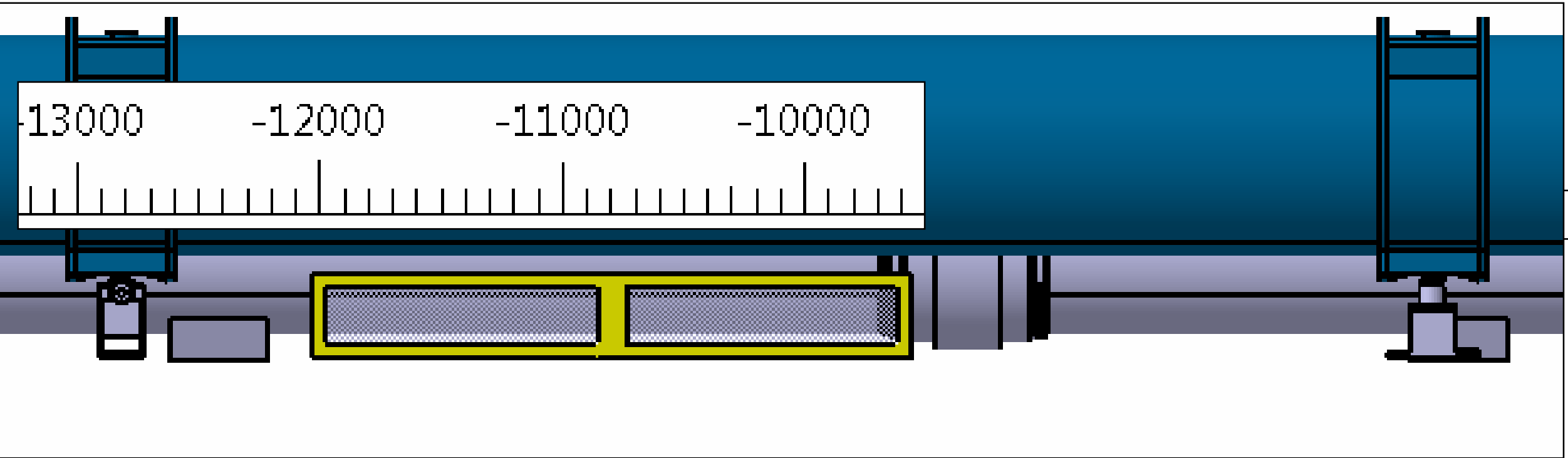
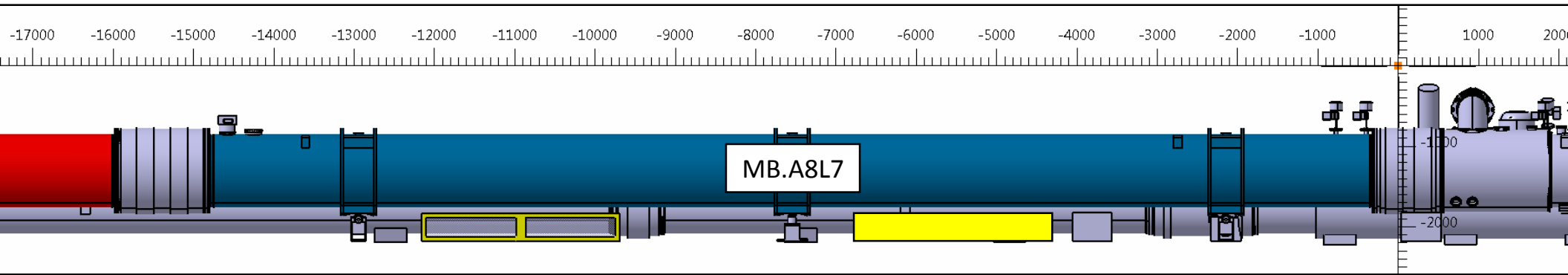

EXTRACT TO LAYOUT MACHINE

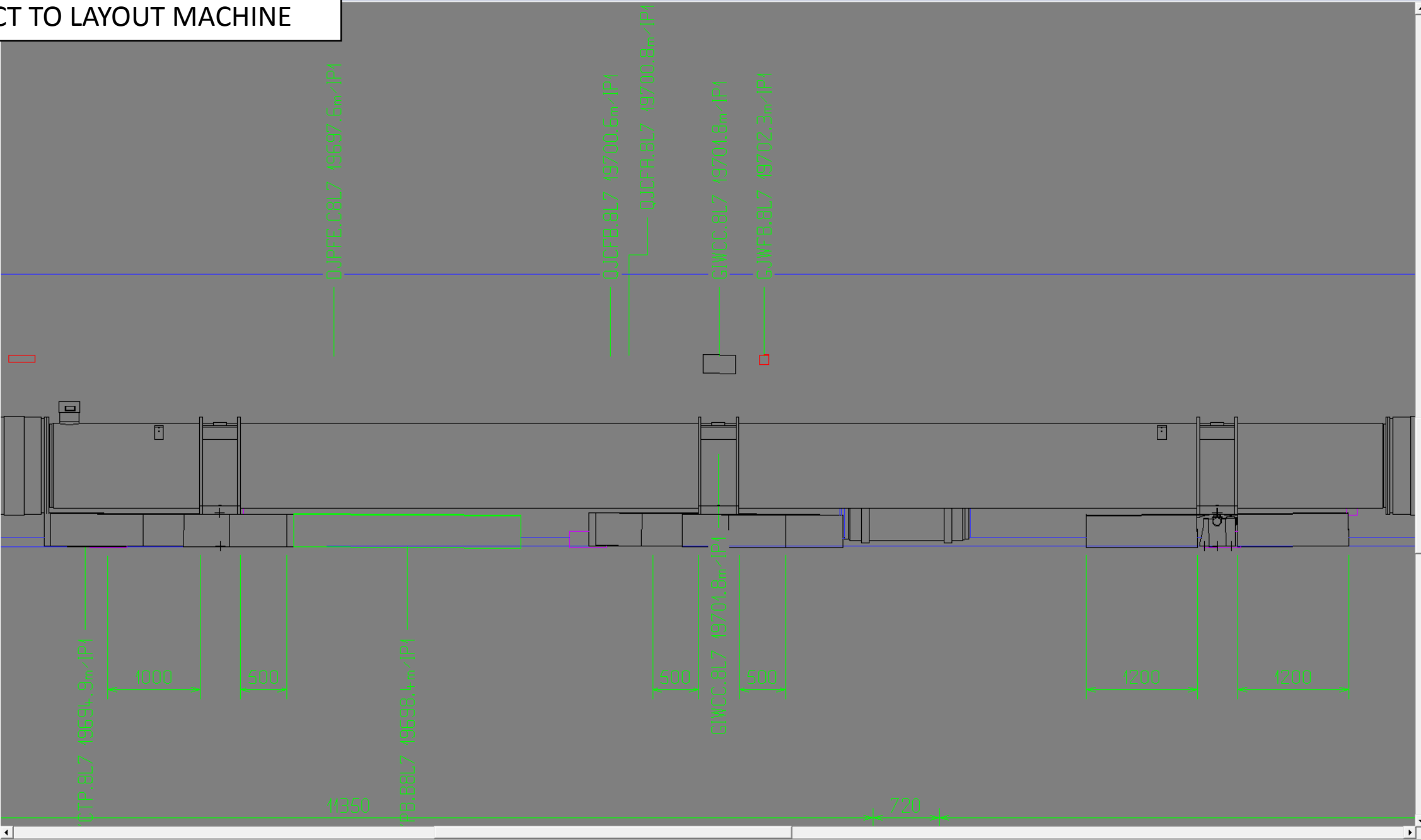

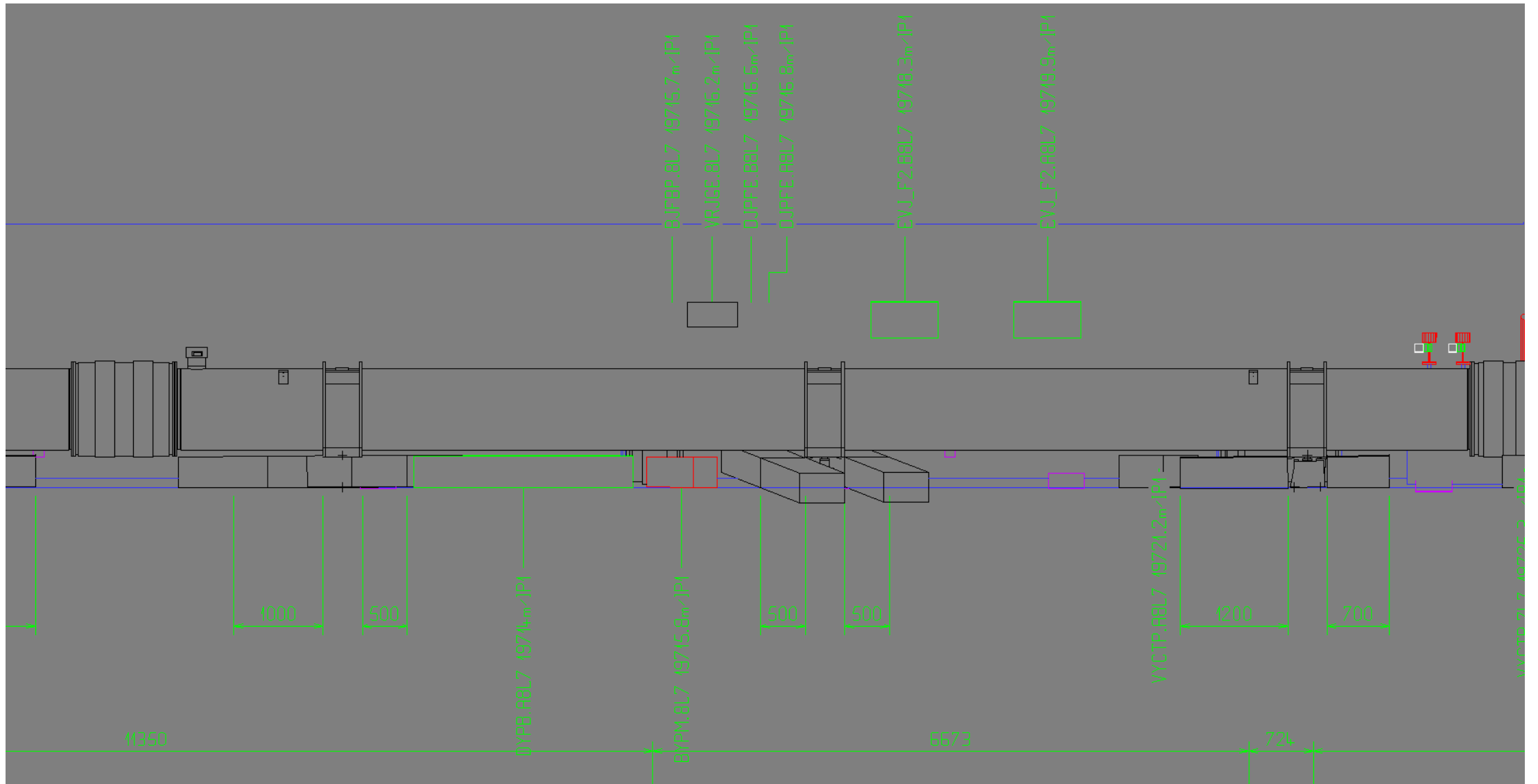

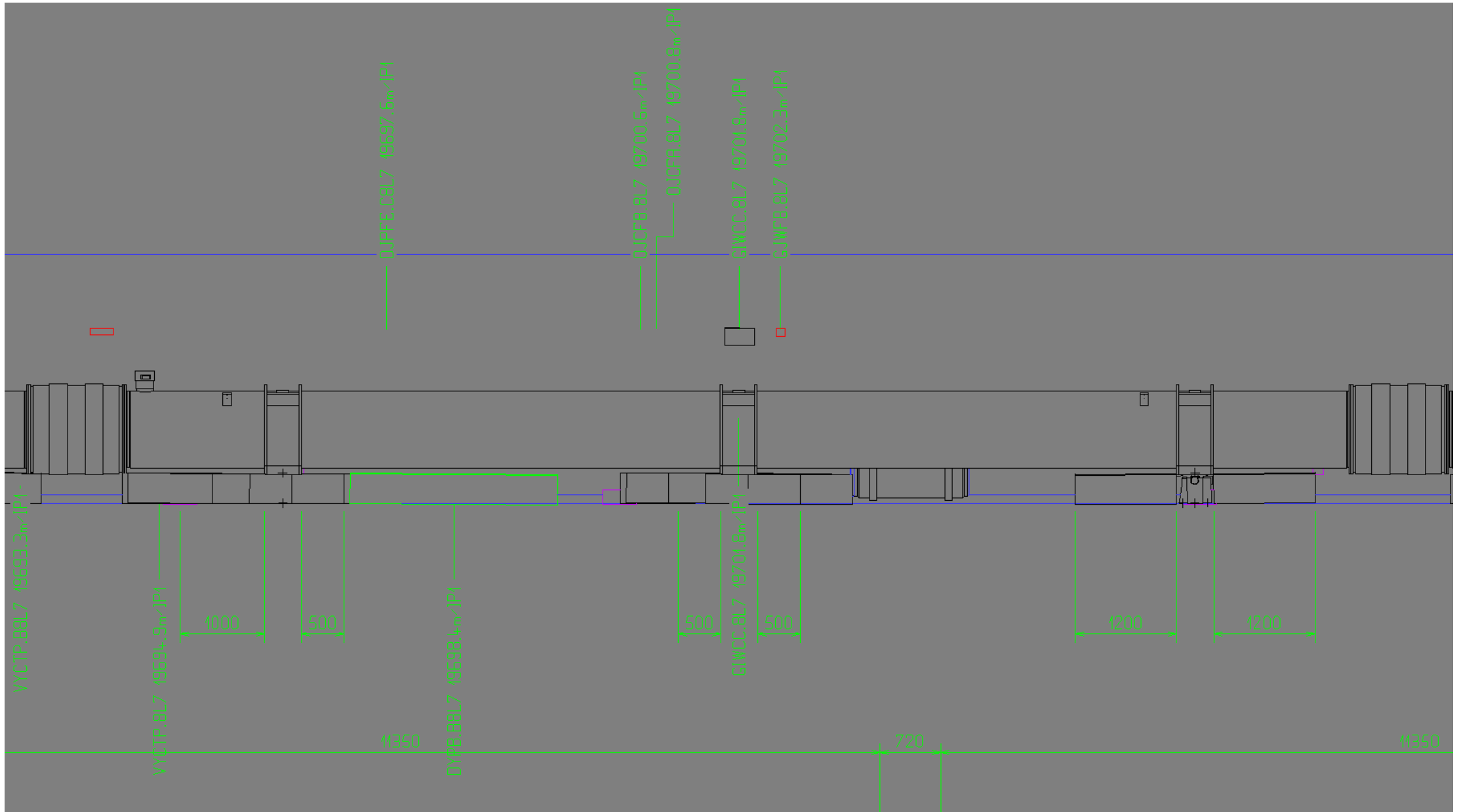



1-POSITION

2-INSTALLATION OF COLLIMATOR (news)

3-Integration study in RR73/77

3-position QDS

RR77

QDS : ASSUME THAT CAN
PLACE IN DYPG01 rack

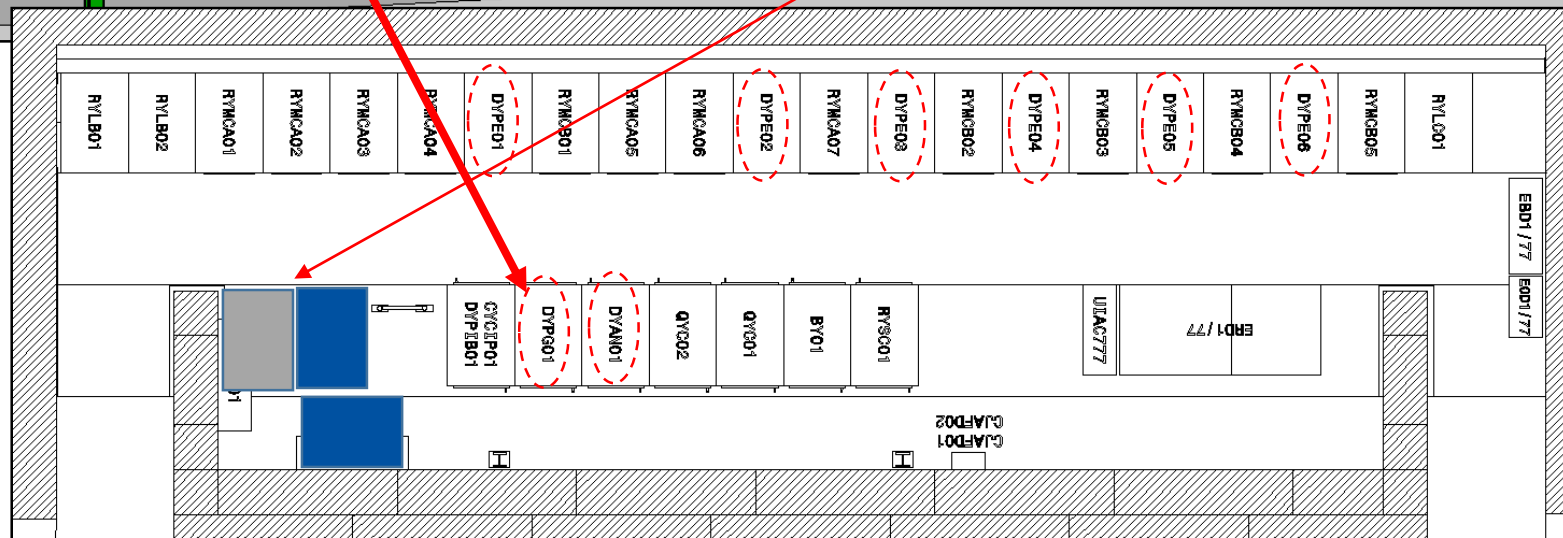
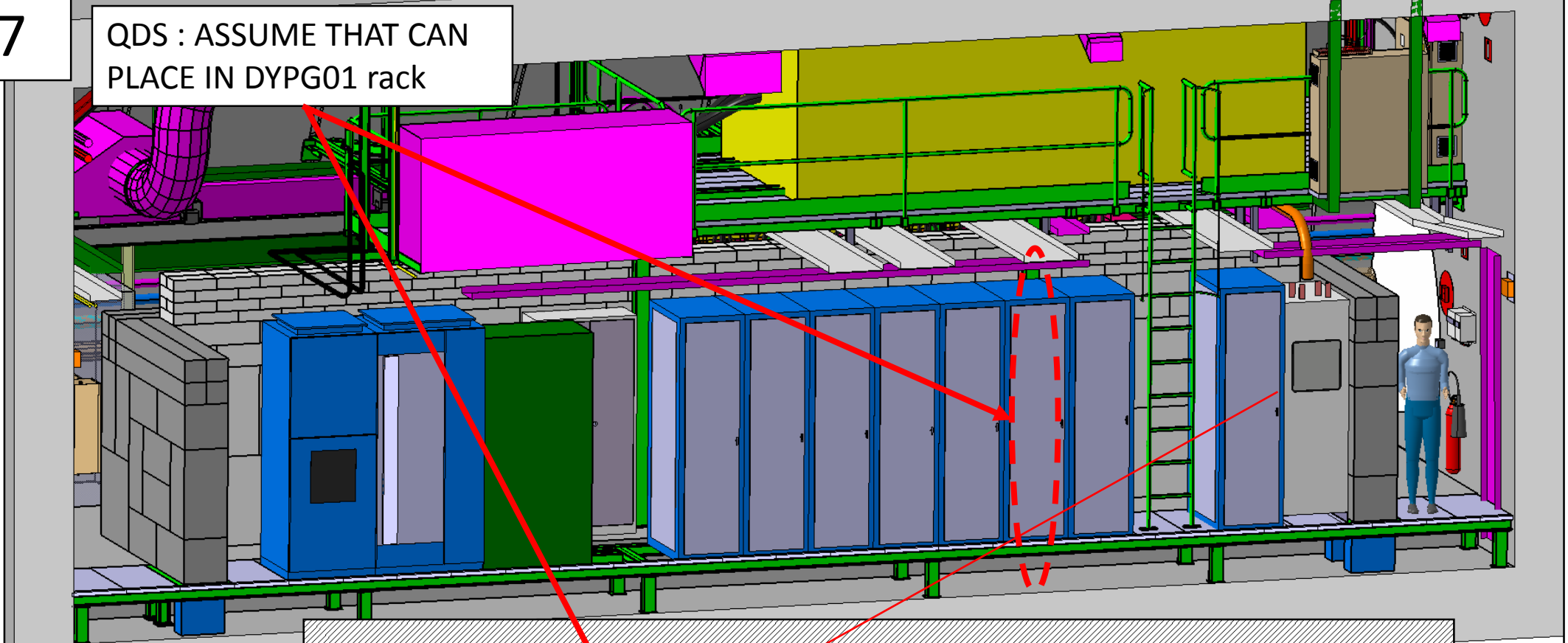



1-POSITION

2-INSTALLATION OF COLLIMATOR (news)

3-Integration study in RR73/77

Present layout:

POSITION OF 11 T MAGNET

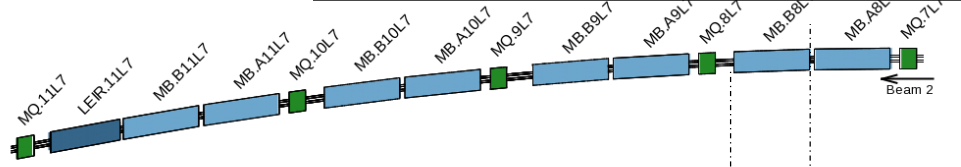

Layout with ~~BS combiners and~~ 11T dipoles:

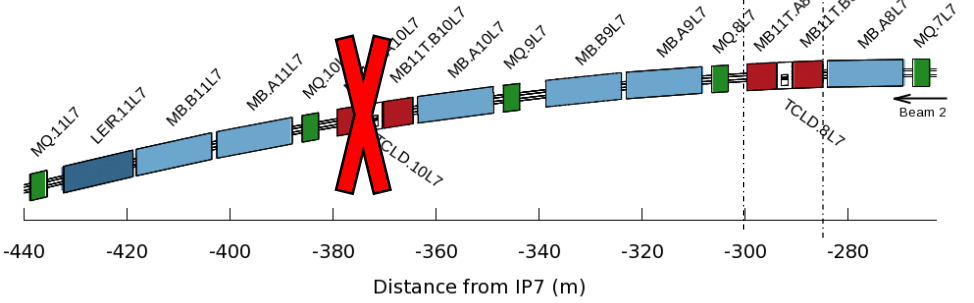

08/11/2016

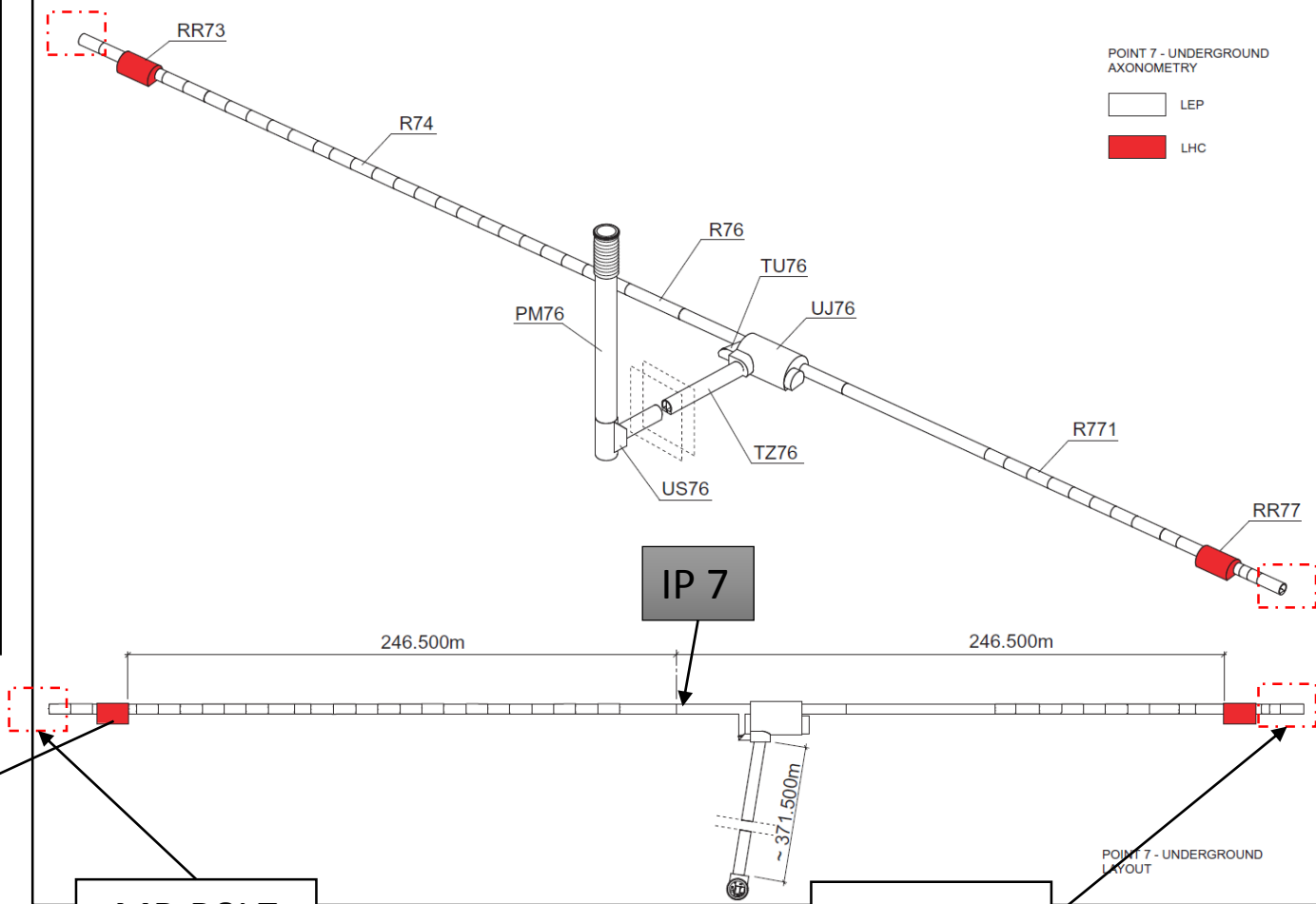

MB.B8L7

DCUM (ip7) :
 Start at: -284.564 m
 Middle : -292.394 m
 End : -300.224 m
 (15.660 m)

MB.B8R7

DCUM (ip7) :
 Start at: 284.564 m
 Middle : 292.394 m
 End : 300.224 m
 (15.660 m)

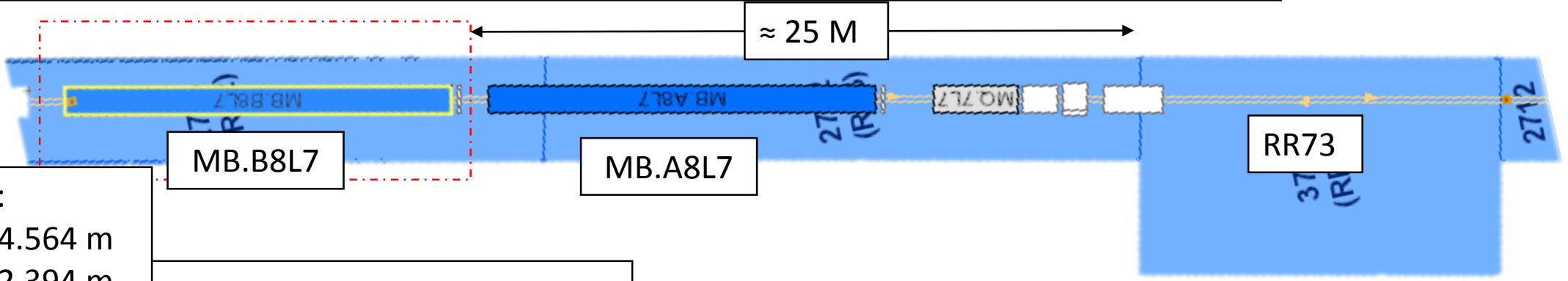
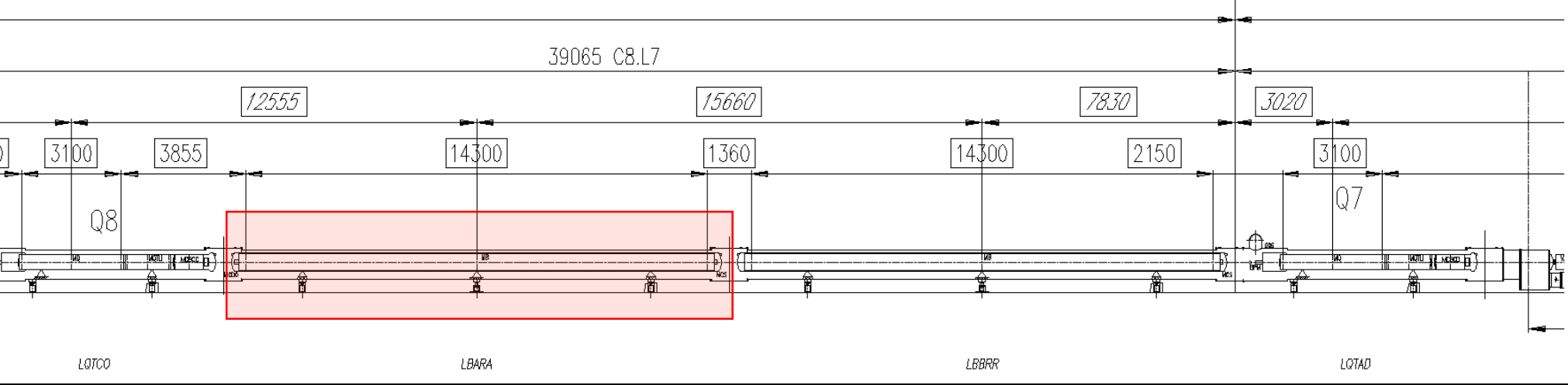

DCUM (ip7) :
 Start at: 284.564 m
 Middle : 292.394 m
 End : 300.224 m
 (15.660 m)

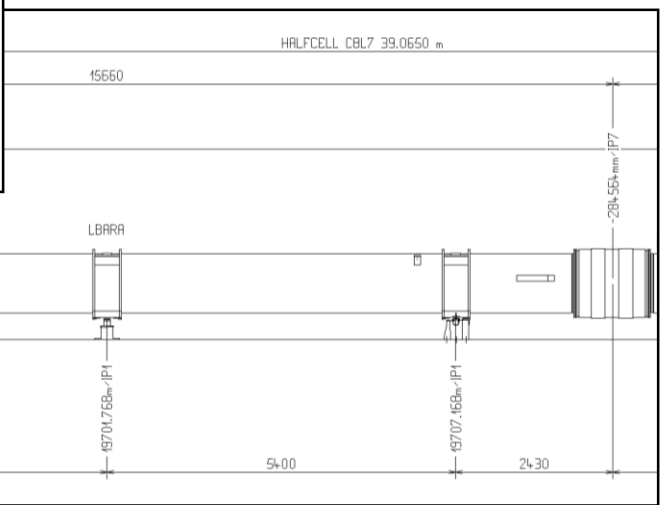

REPLACE BY : 11 T MAGNET (LS2)

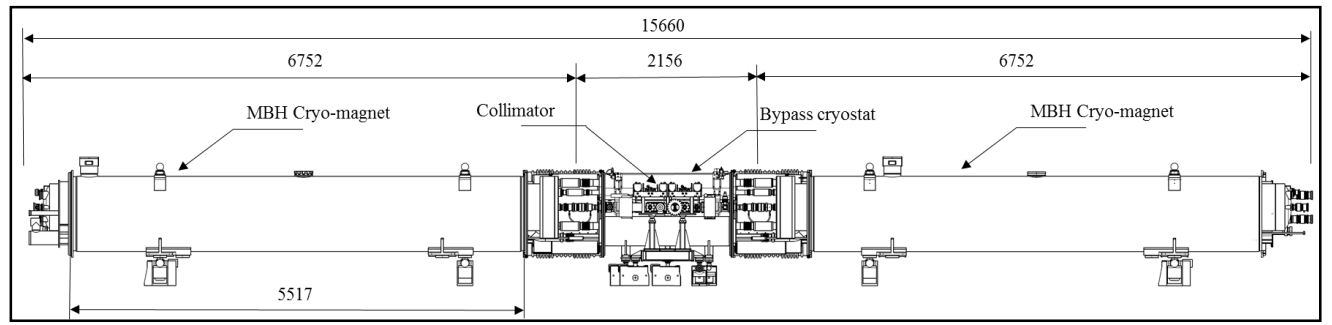



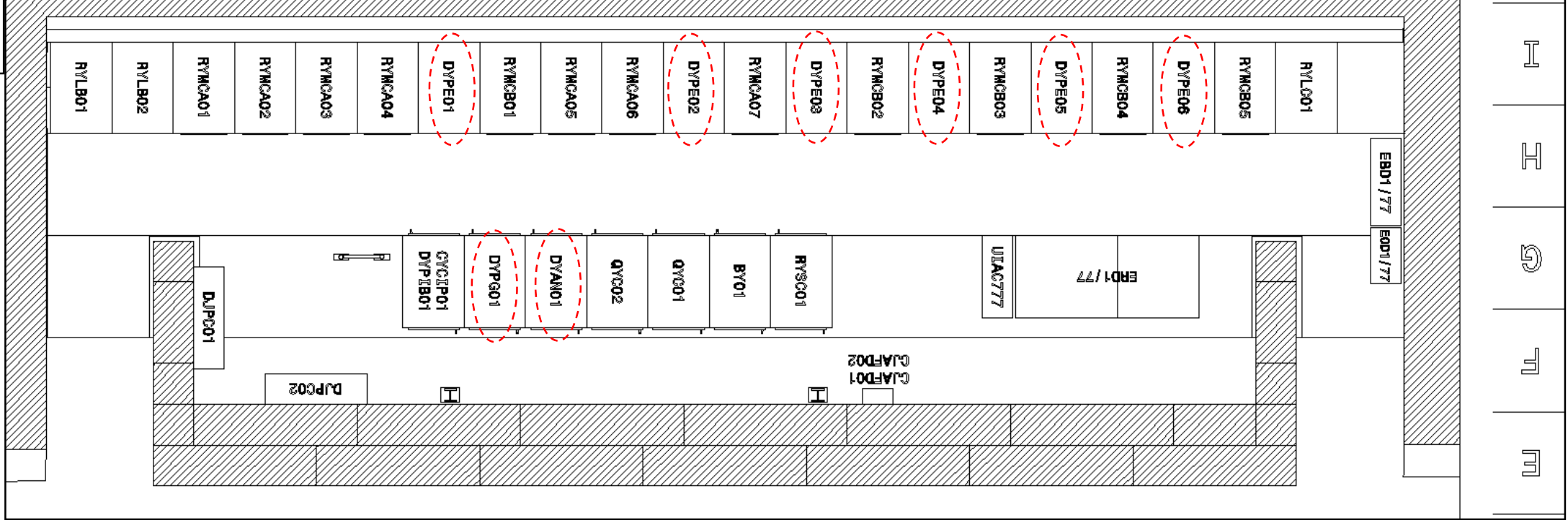

RYLC01	1.2 RCBCH6.R7B2 1.1 RCBCV6.R7B1
RYMCB05	1.2 RQ6.R7B1 1.1 RQ6.R7B2
DYPE06	
RYMCB04	1.2 ROF.A78B1 1.1 ROF.A78B2
DYPE05	
RYMCB03	1.2 ROD.A78B1 1.1 ROD.A78B2
DYPE04	
RYMCB02	1.2 RSS.A78B1 1.1 RSS.A78B2
DYPE03	
RYMCA07	1.2 RQS.R7B1 1.1 RQS.A78B2
DYPE02	
RYMCB01	1.2 RQTL9.R7B1 1.1 RQTL9.R7B2
DYPE01	

RR73

10/2016

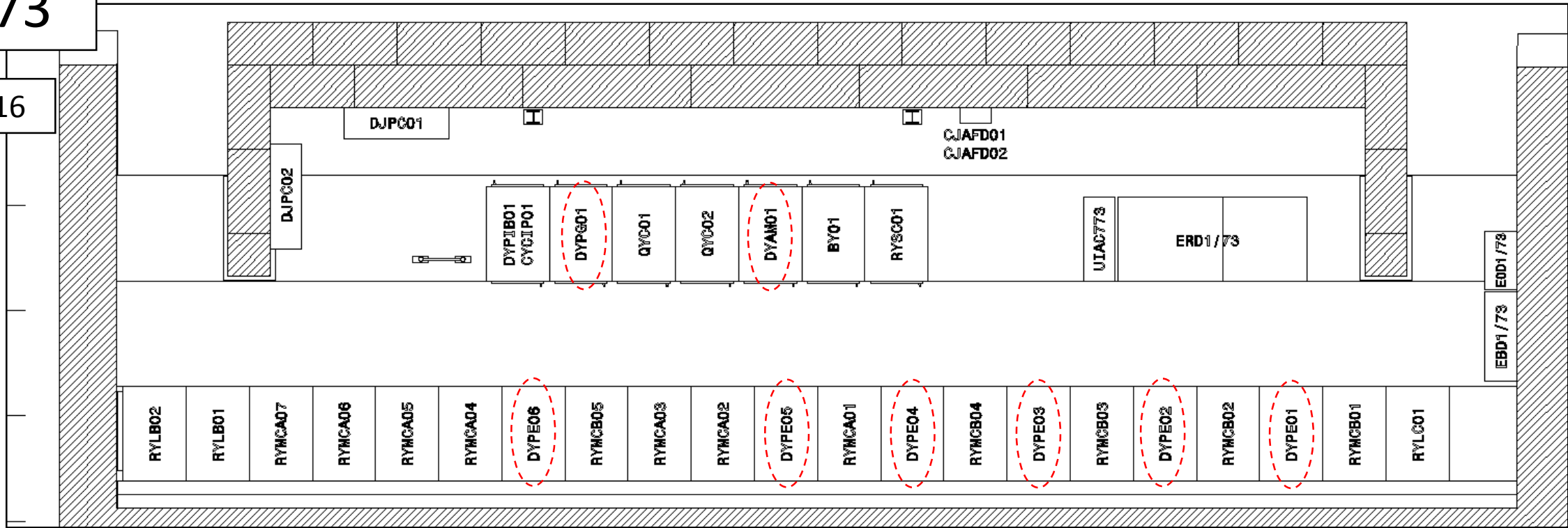

RR73

10/2016

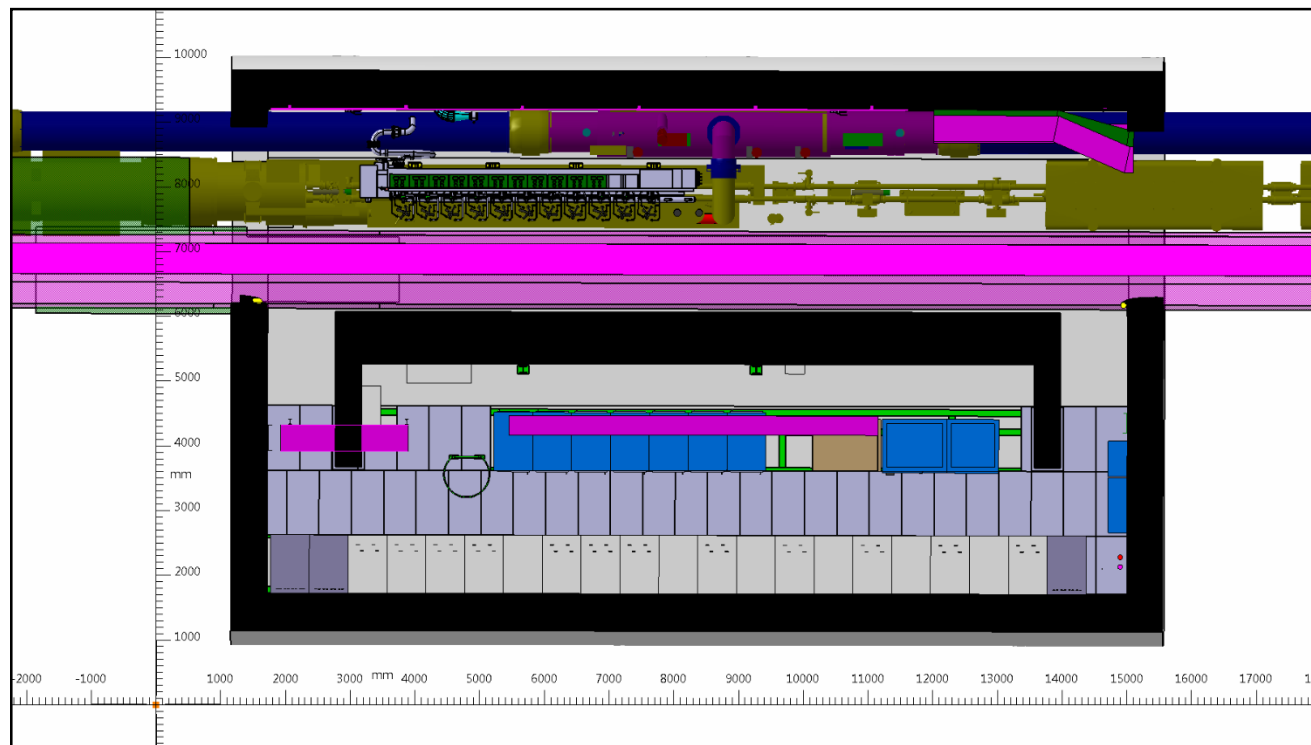
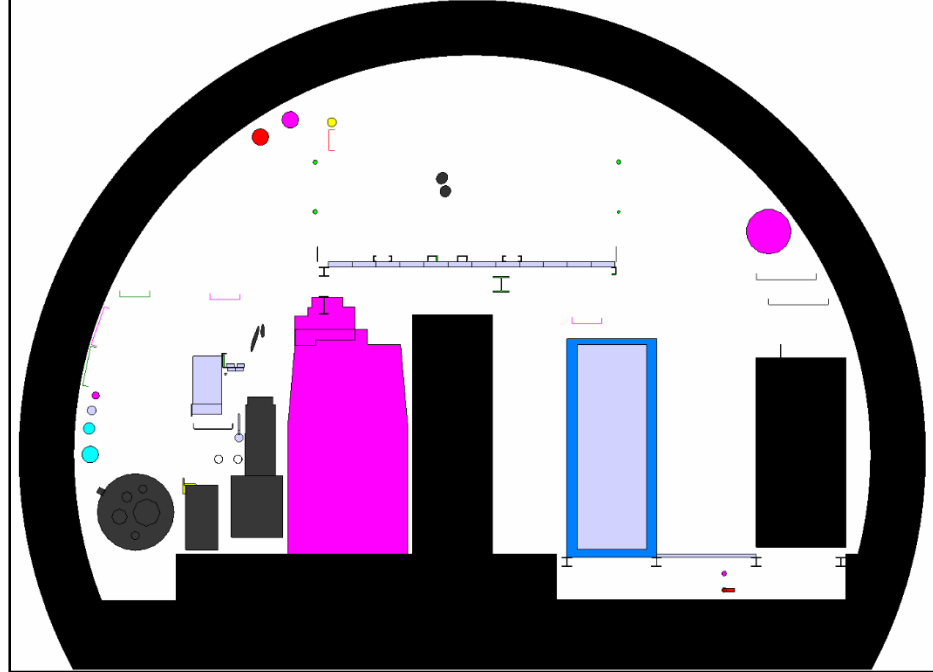
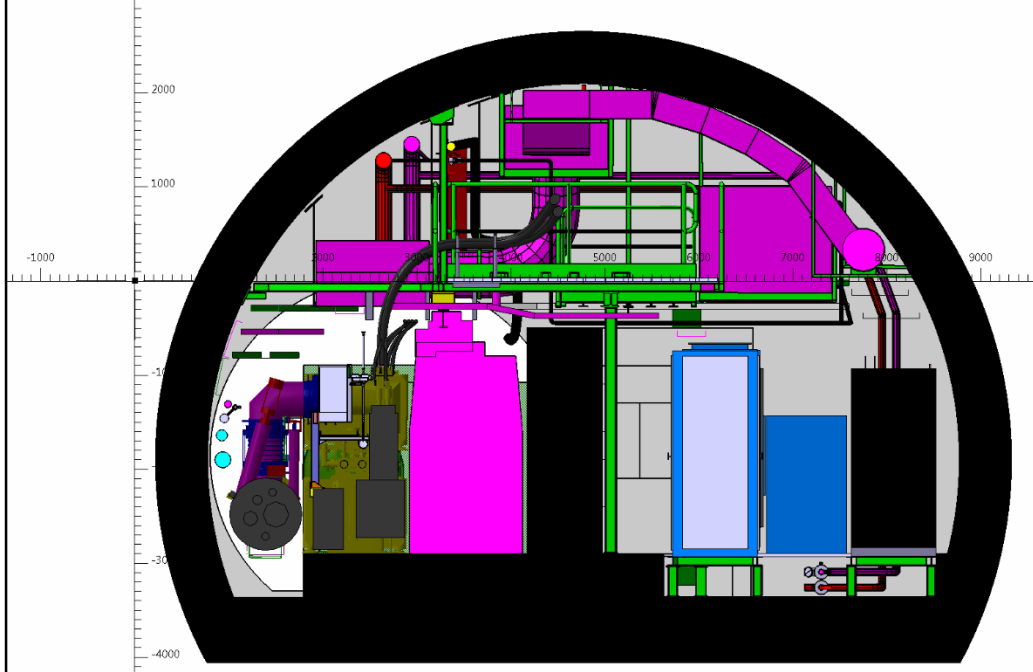

08/11/2016

RR77

10/2016

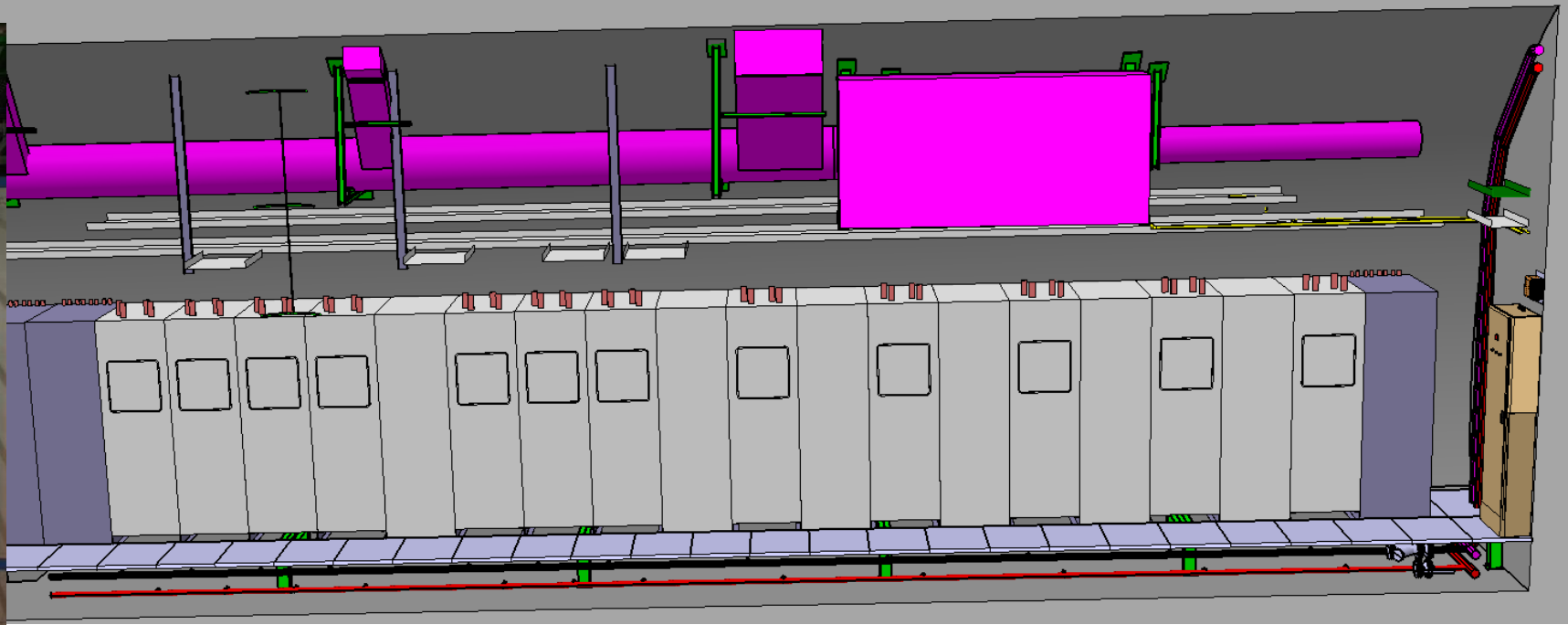
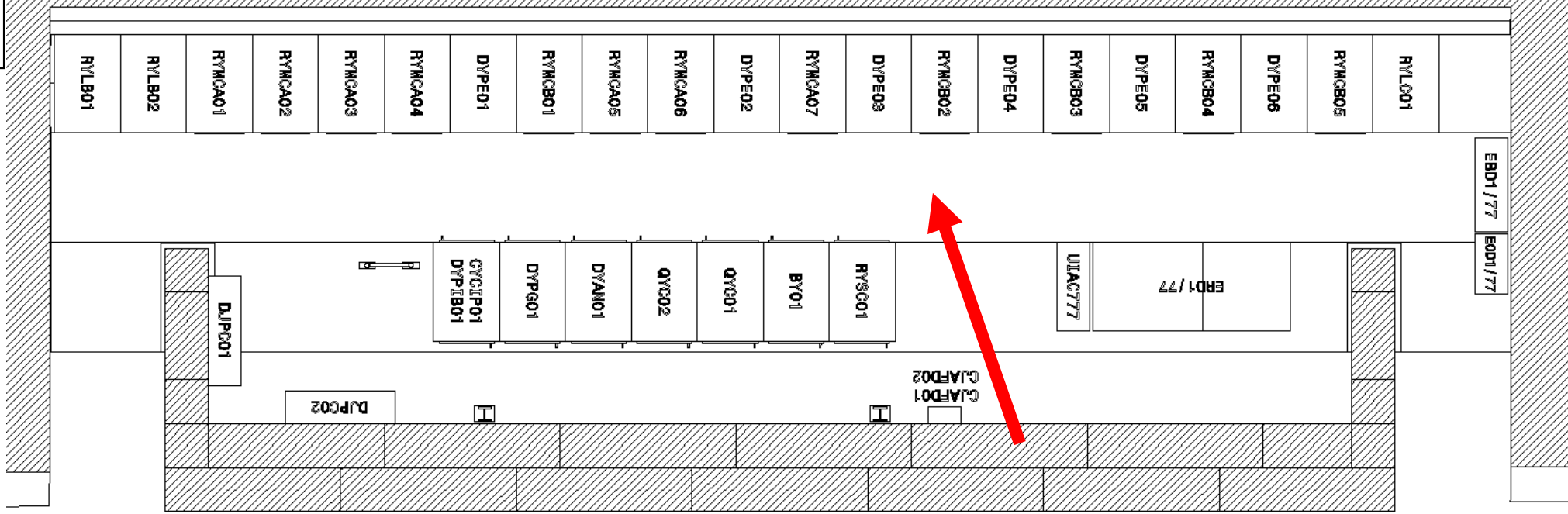



08/11/2016



35

