

## 2F LOBBY

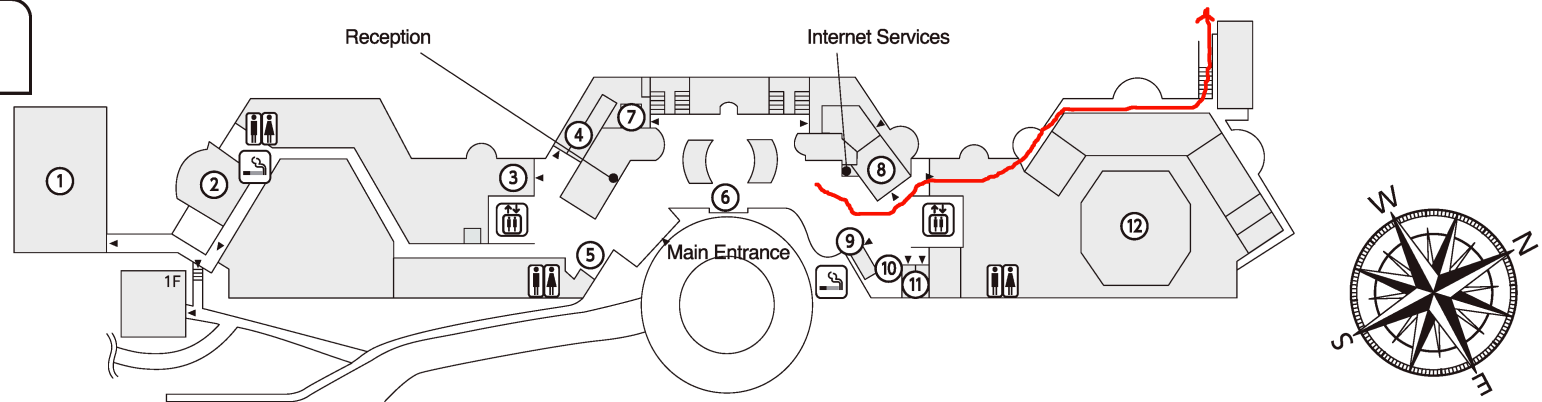

- |  |                    |                                   |
|--|--------------------|-----------------------------------|
| ① Spa and Sauna HAMA NO YU                 | ⑤ Car rental desk  | ⑨ Hotel shop TANCHAMA MAE SHOUTEN |
| ② Wine and Cocktail bar CORAL VIEW         | ⑥ Morning Market   | ⑩ TANCHAMAE Stage                 |
| ③ Japanese and Okinawan cuisine SHICHIFUKU | ⑦ Bridal Salon     | ⑪ Kinki Nippon Tour Desk          |
| ④ Relaxation and Massage SANNIN            | ⑧ Lounge PRASHANTI | ⑫ Banquet Hall                    |

## 1F BEACH

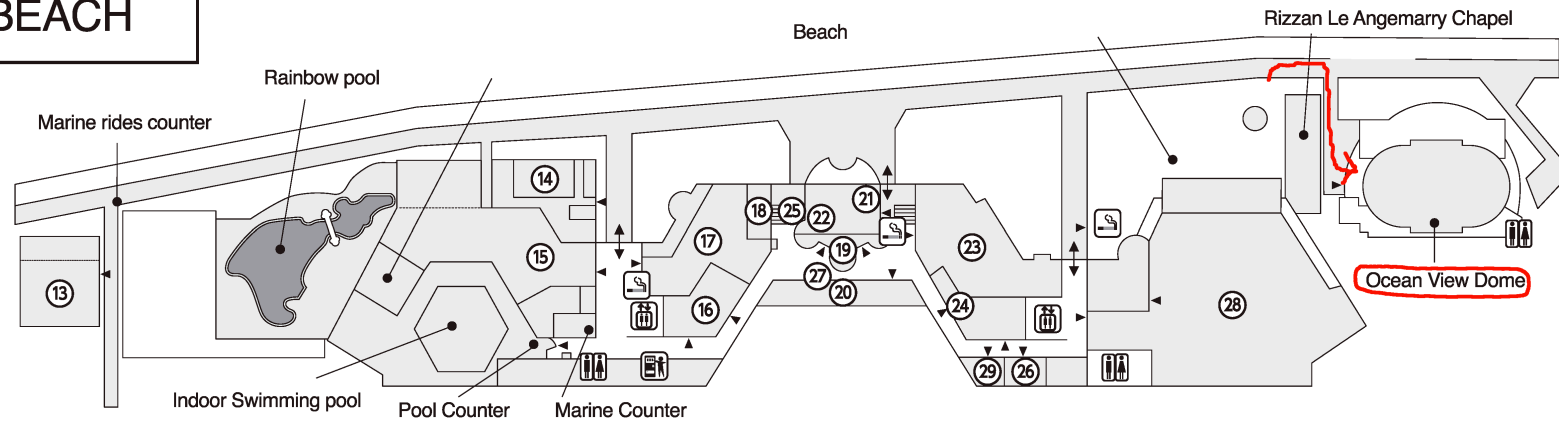

- |                                  |  |   |                                   |
|----------------------------------|--|---|-----------------------------------|
| ⑬ Yakiniiku restaurant CHURAHAMA | ⑱ SPORTS GYM ADAN                        | ⑳ Accessories shop WITO & Handmade shop | ㉒ Awamori shop AKABANA            |
| ⑭ Beachside izakaya SHIMAUTA     | ㉑ Hotel shop CHURASAN                    | ㉓ Chinese cuisine MANDARIN COURT        | ㉔ Handmade shop                   |
| ⑮ Casual dining BLUE LAGOON      | ㉒ Game Center                            | ㉔ Convenience store RIZZAN CONVINI      | ㉖ Seaside restaurant TANCHAMA BAY |
| ⑯ Hotel shop CHANPURU            | ㉑ Nail Art NAIL JOY & Handcrafted shells | ㉓ Delivery Desk                         | ㉗ Kids' Room (Nursery)            |
| ⑰ Barbecue restaurant HIBIS      |  |   |                                   |

