

Integration and data life cycle

Y. Muttoni & all



ENGINEERING
DEPARTMENT

[EDMS 1775265](#)

Main goal

- Only the CATIA/Smarteam data are involved by the datalife cycle.
- Why integration data should be follow a data lifecycle?
 - To have a correct status on the document stored in smarteam.
 - To be sure between different model with the same description only one is the valitaded model and can be use.

Integration data. Drawings & 3D Models

- Conceptual layout Drawing *
 - Produced by Excel Engine
- Consolidated layout Drawing *
 - Produced by DMU Engine
 - Produced by hand
- Differential layout Drawing
 - Produced by hand
- 3D scene Drawing not necessary
 - Produced by hand

*Definition see EDMS [1760014](#)

Data conceptual layout Excel engine

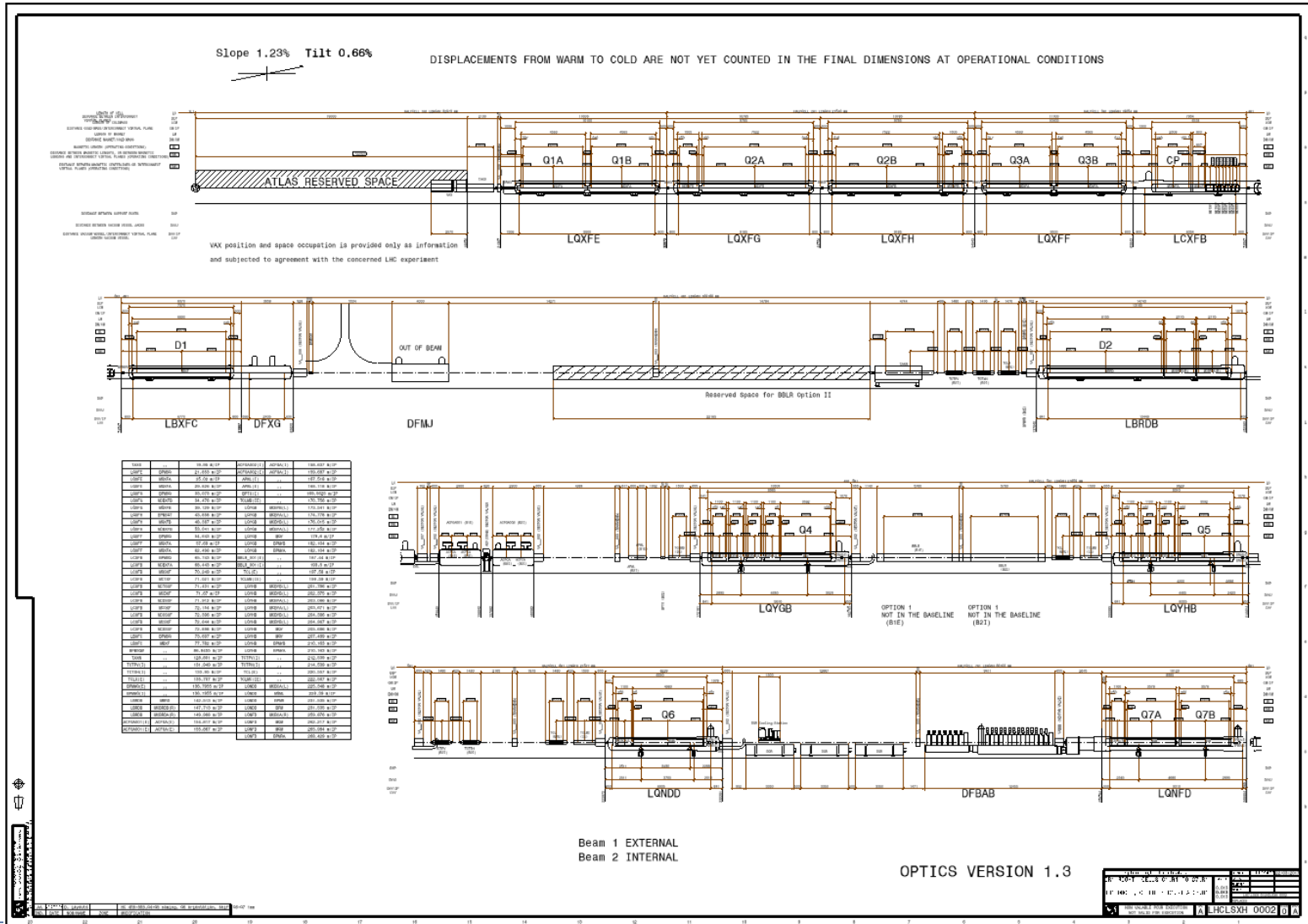

Consolidated layout Drawing

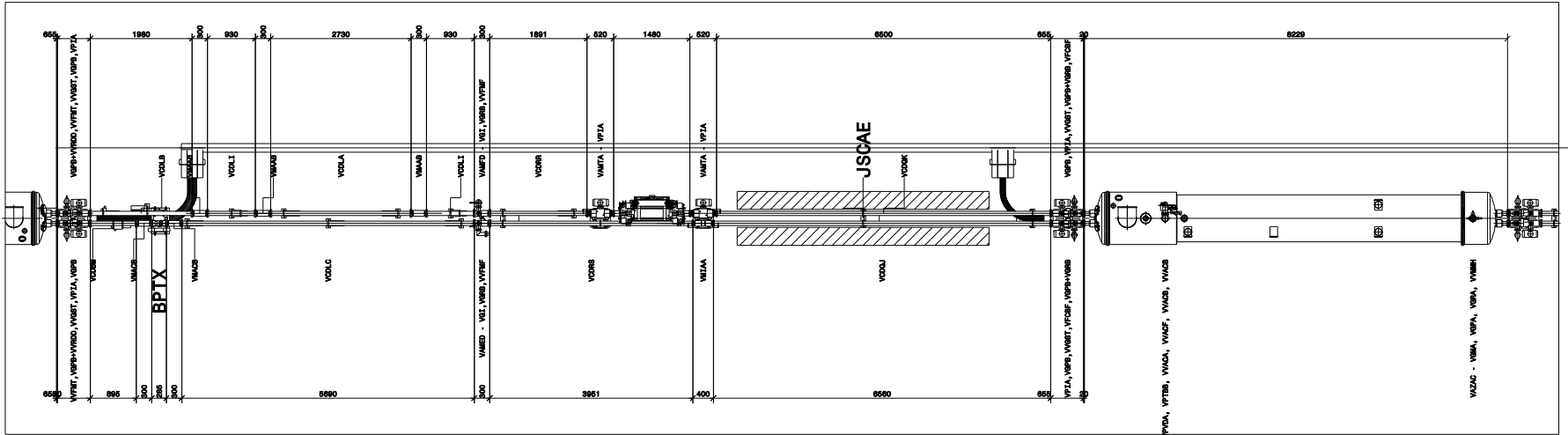
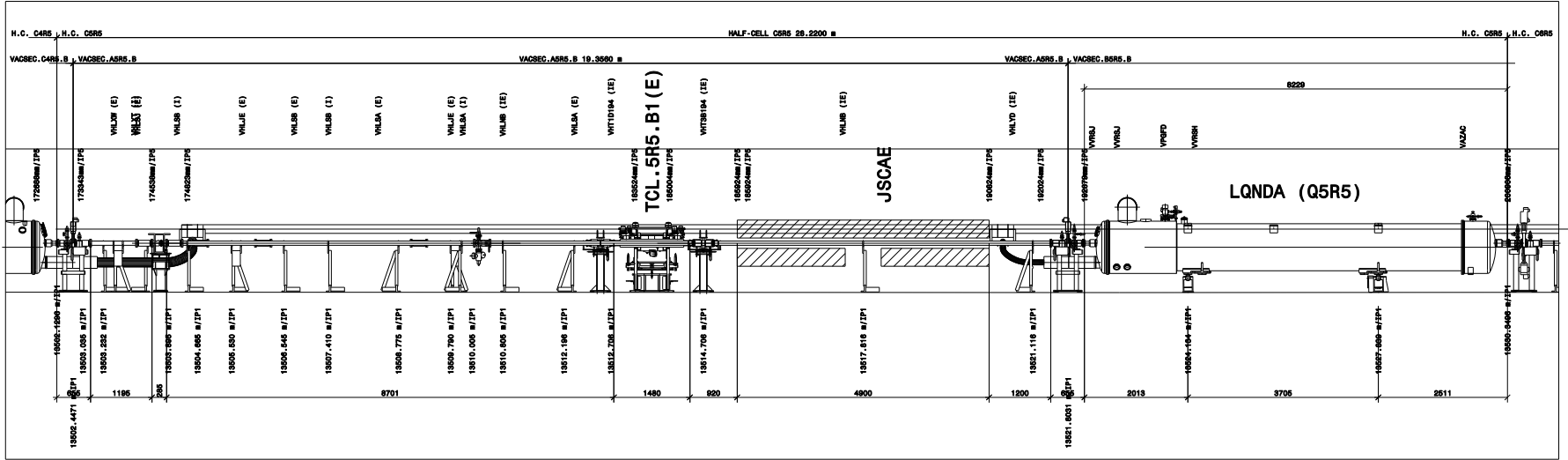

Data model equipment

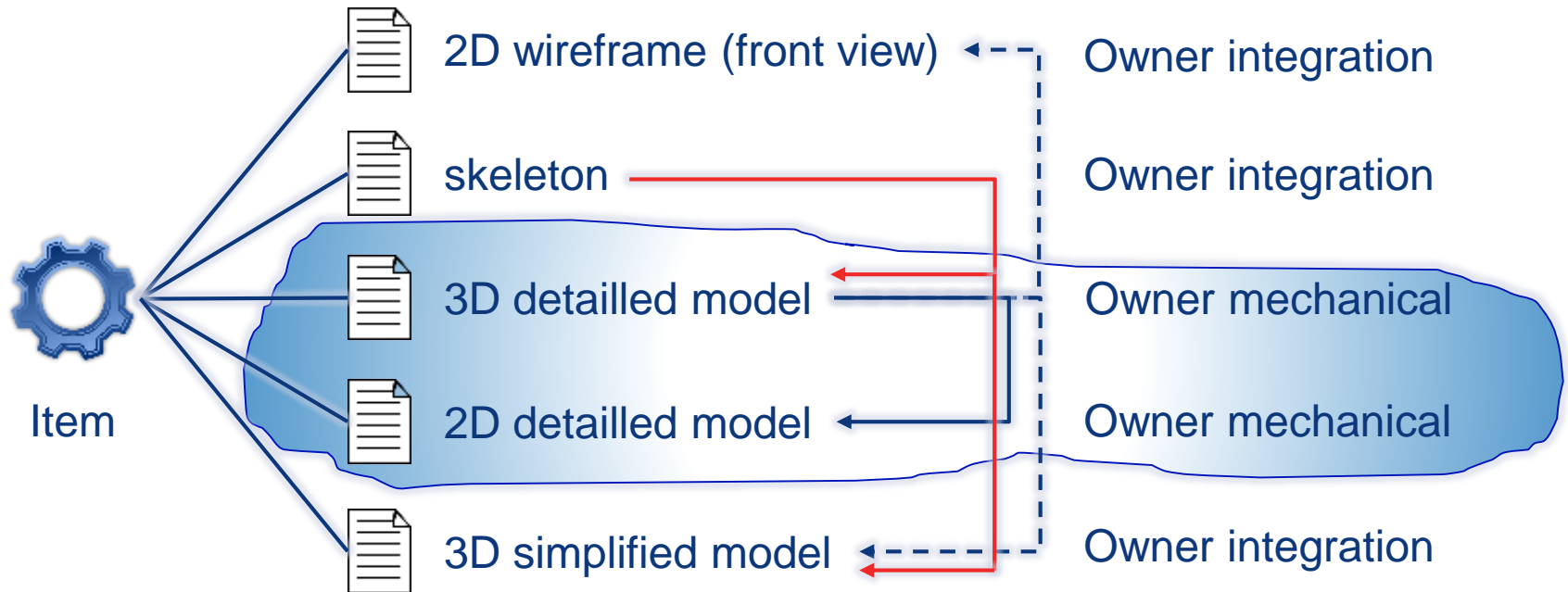

No link

3D detailed model

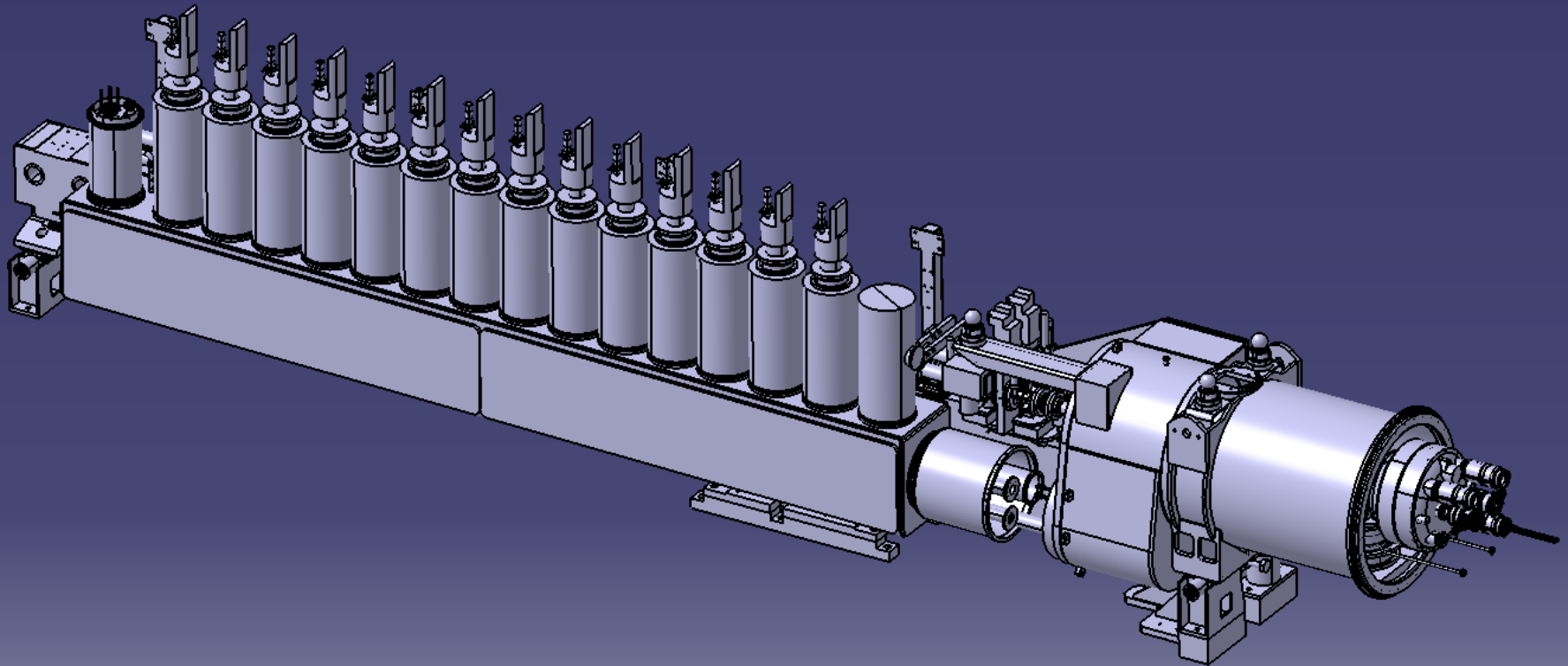

Data model equipment

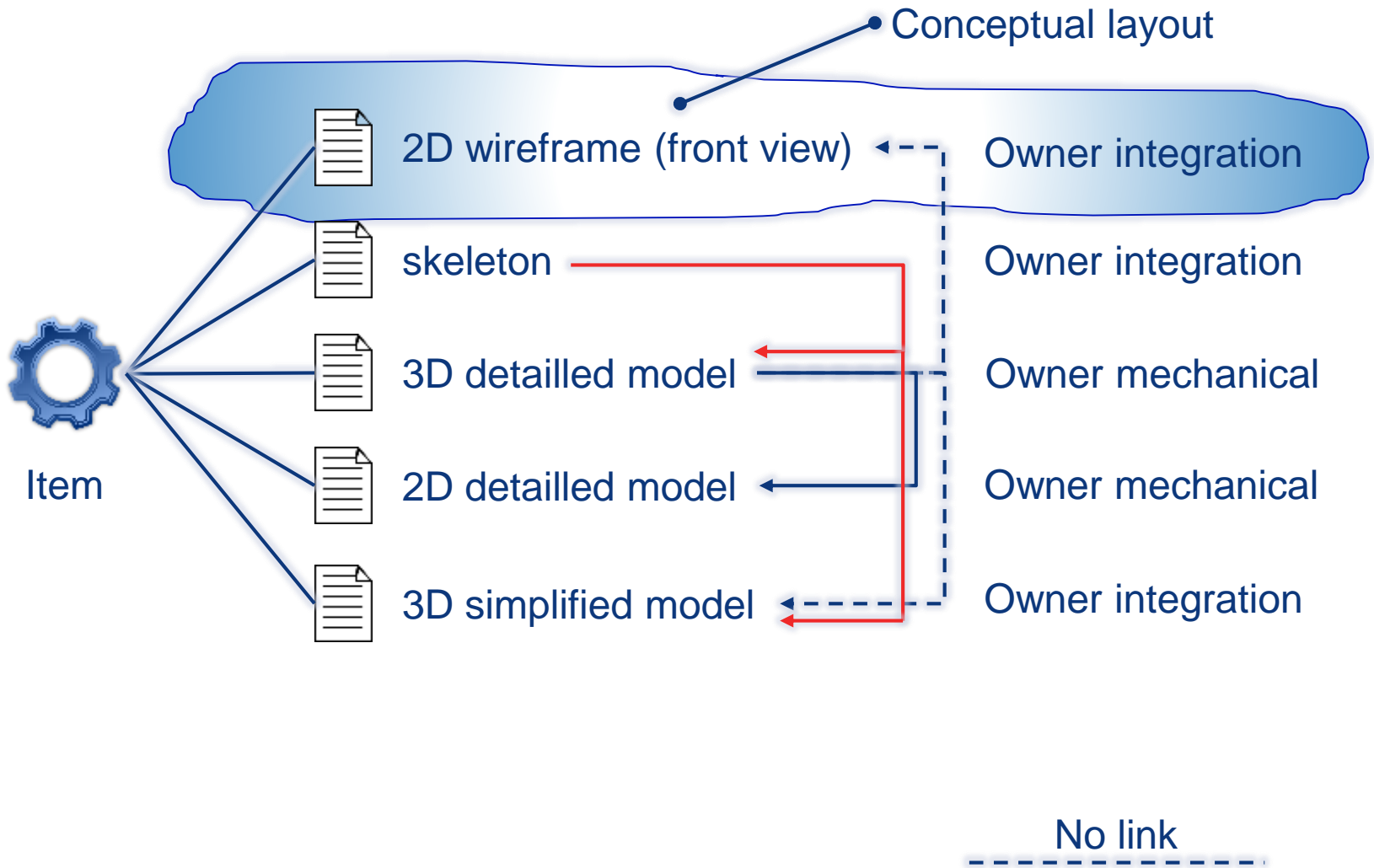

2D wireframe

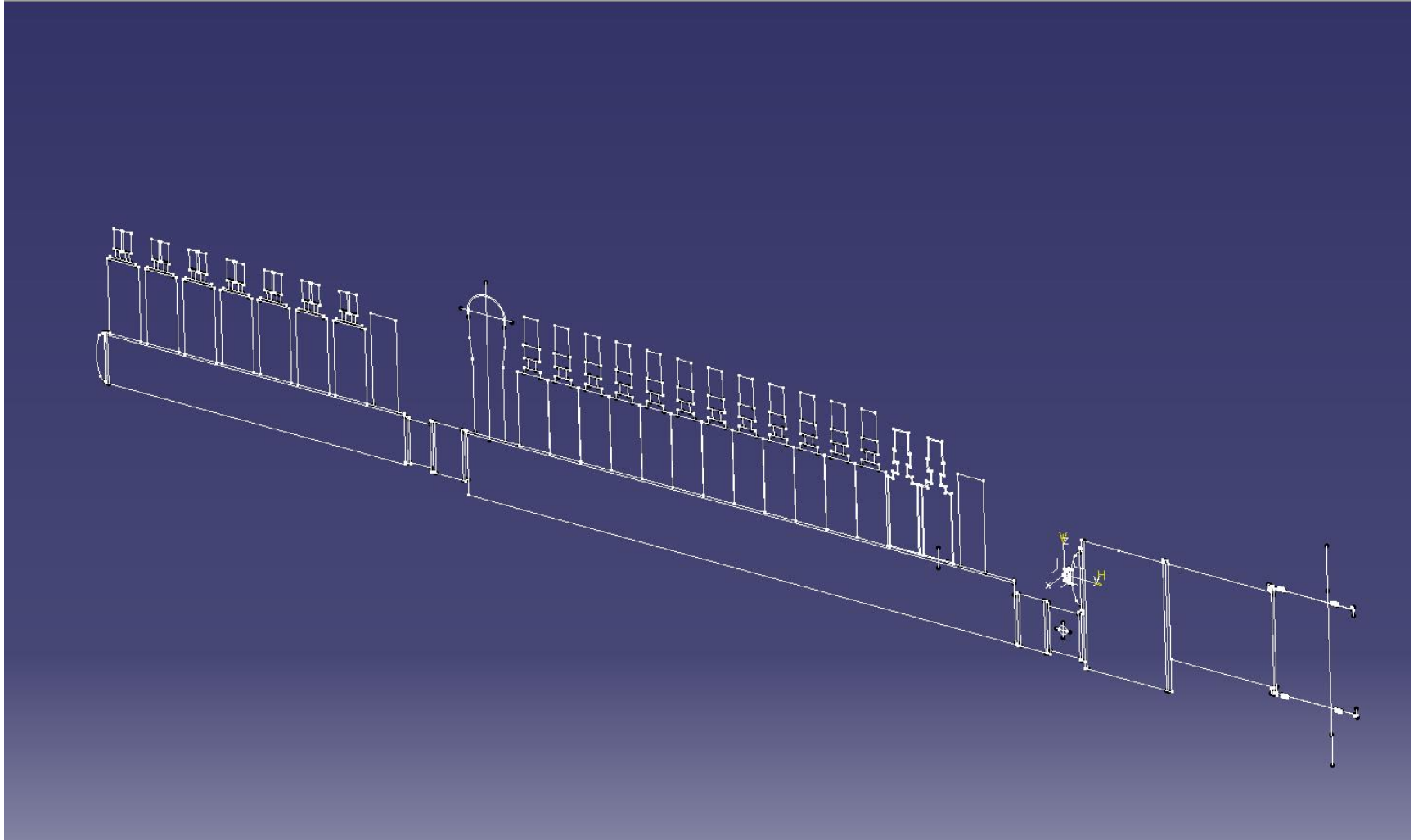

Data model equipment

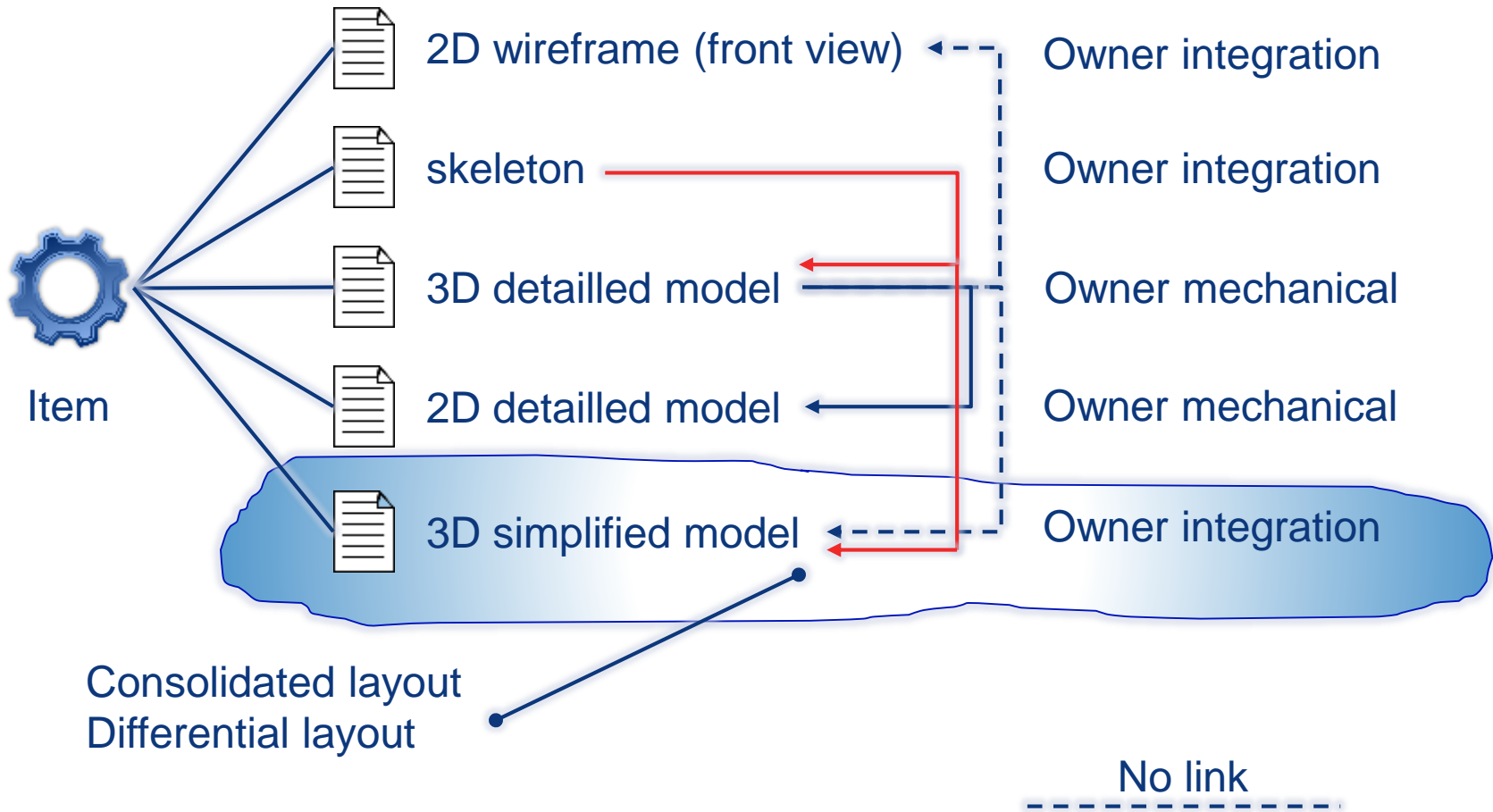

3D simplified model

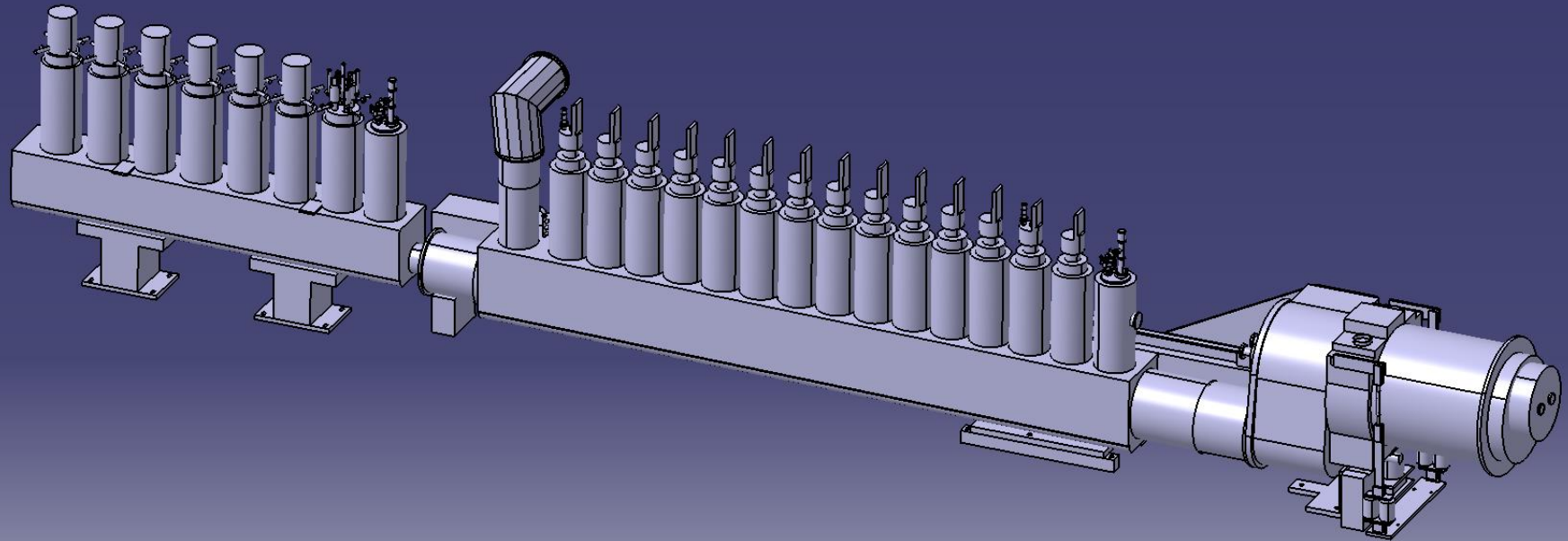

Data conceptual layout Excel engine

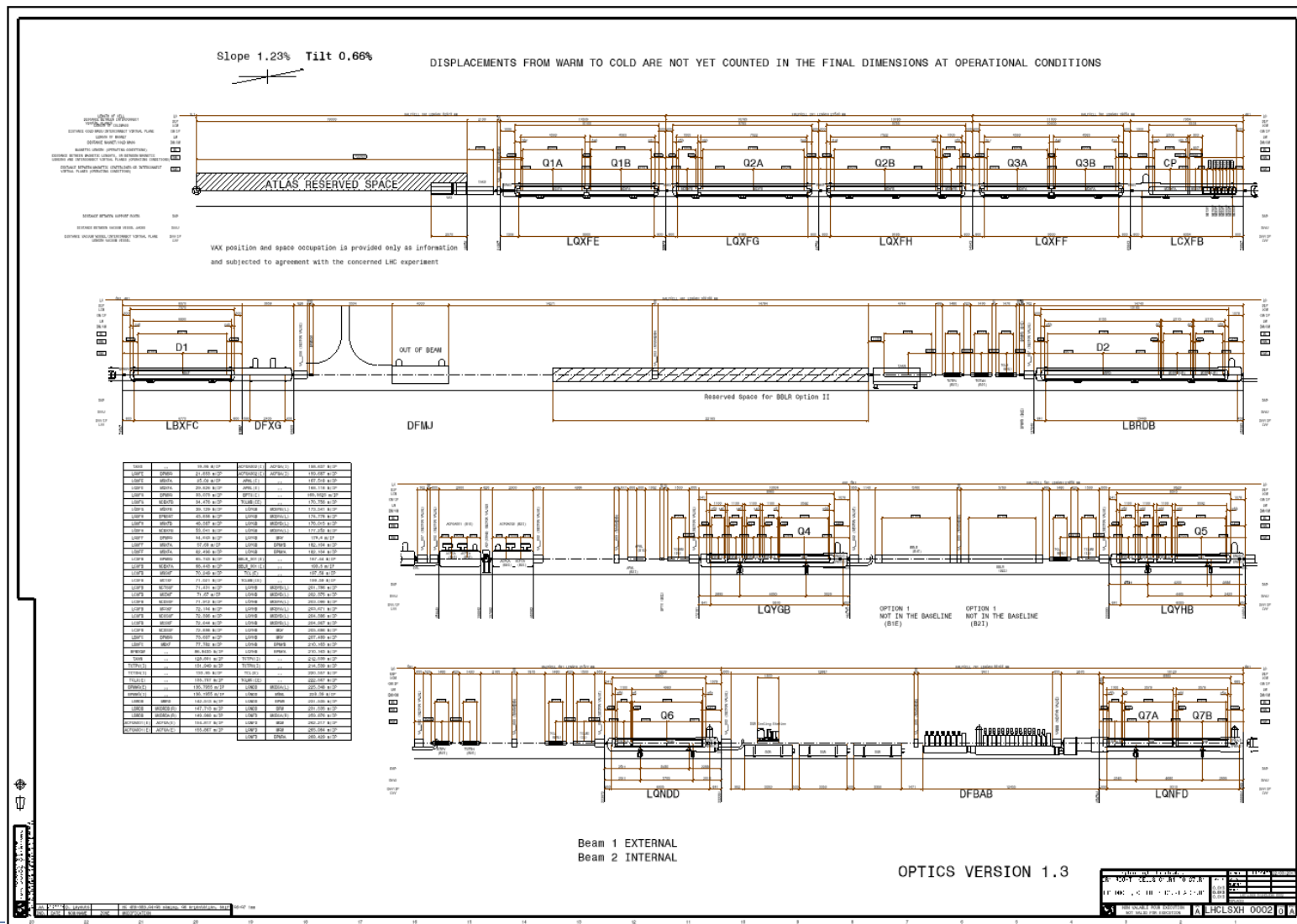

Data conceptual layout Excel engine

Item
ST123

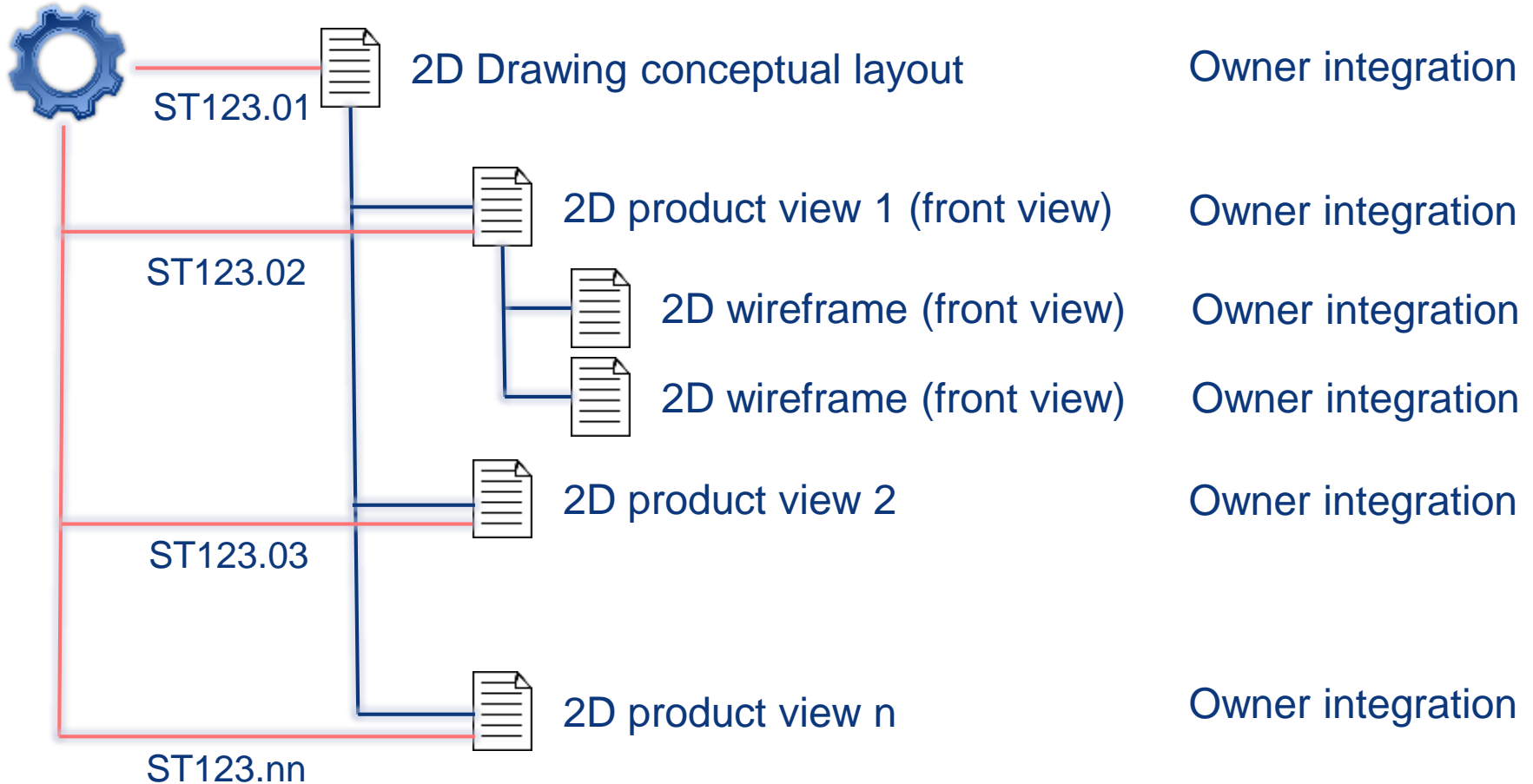

Data conceptual layout Ready for check

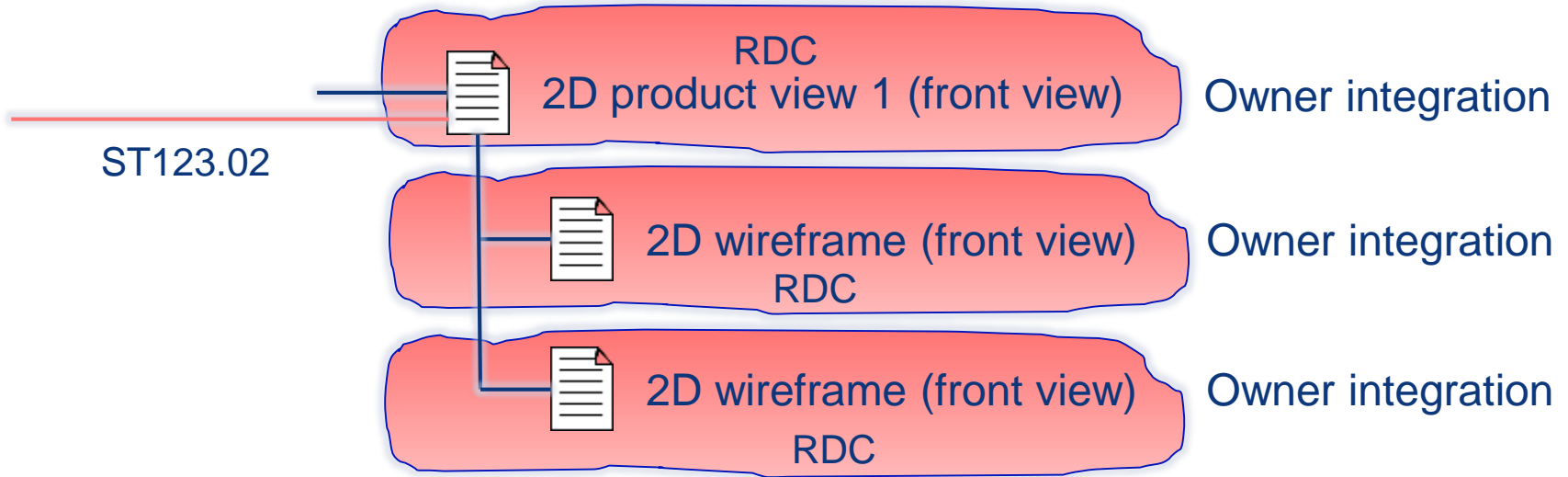

Data conceptual layout Ready for check

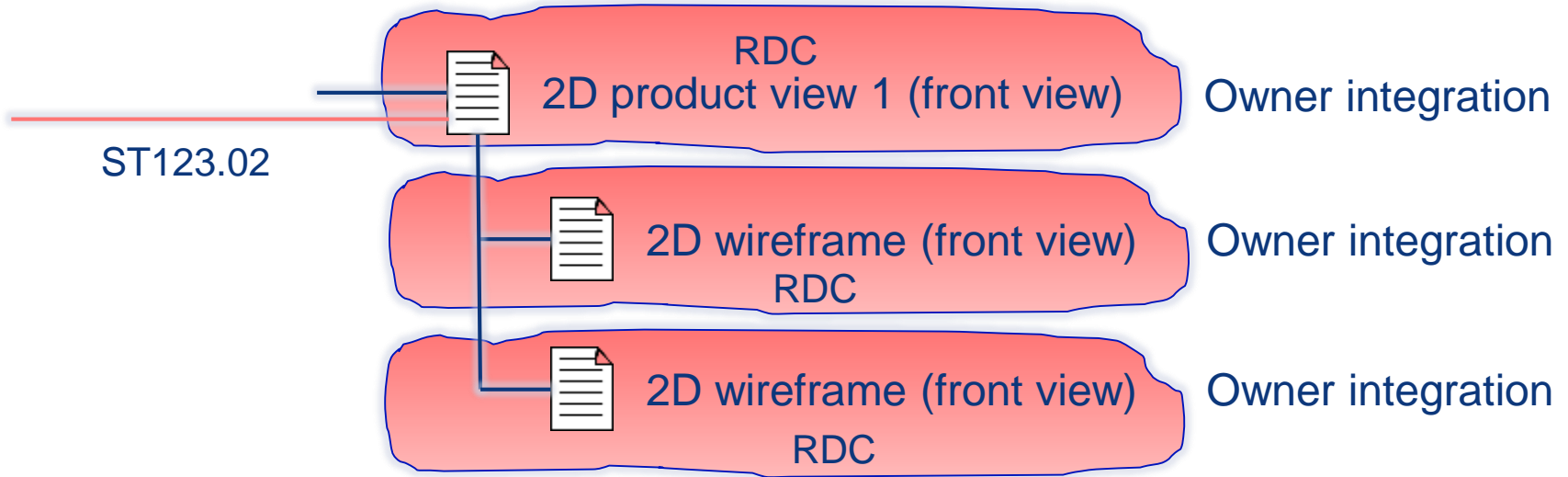

Data conceptual layout control

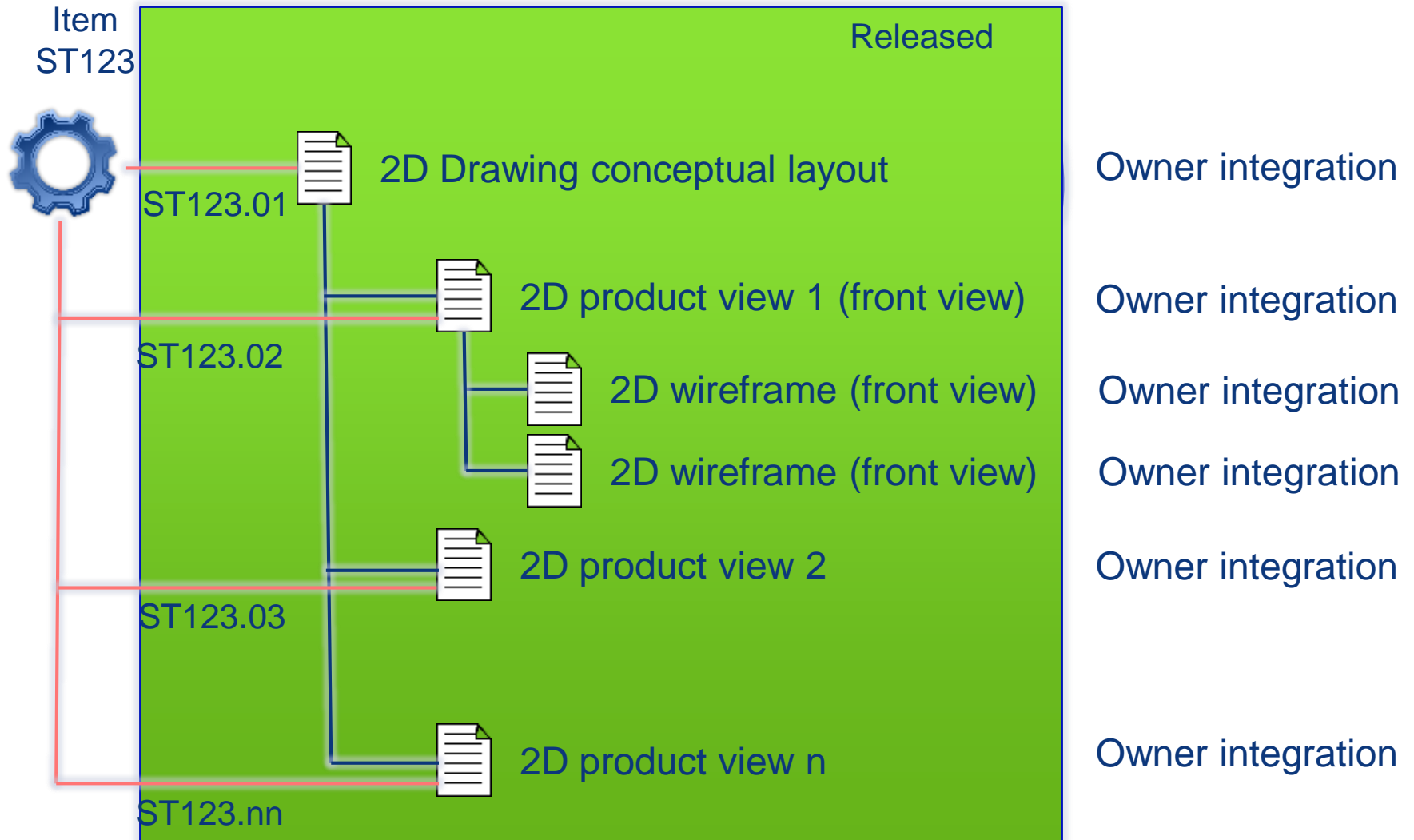

Data consolidated layout DMU engine

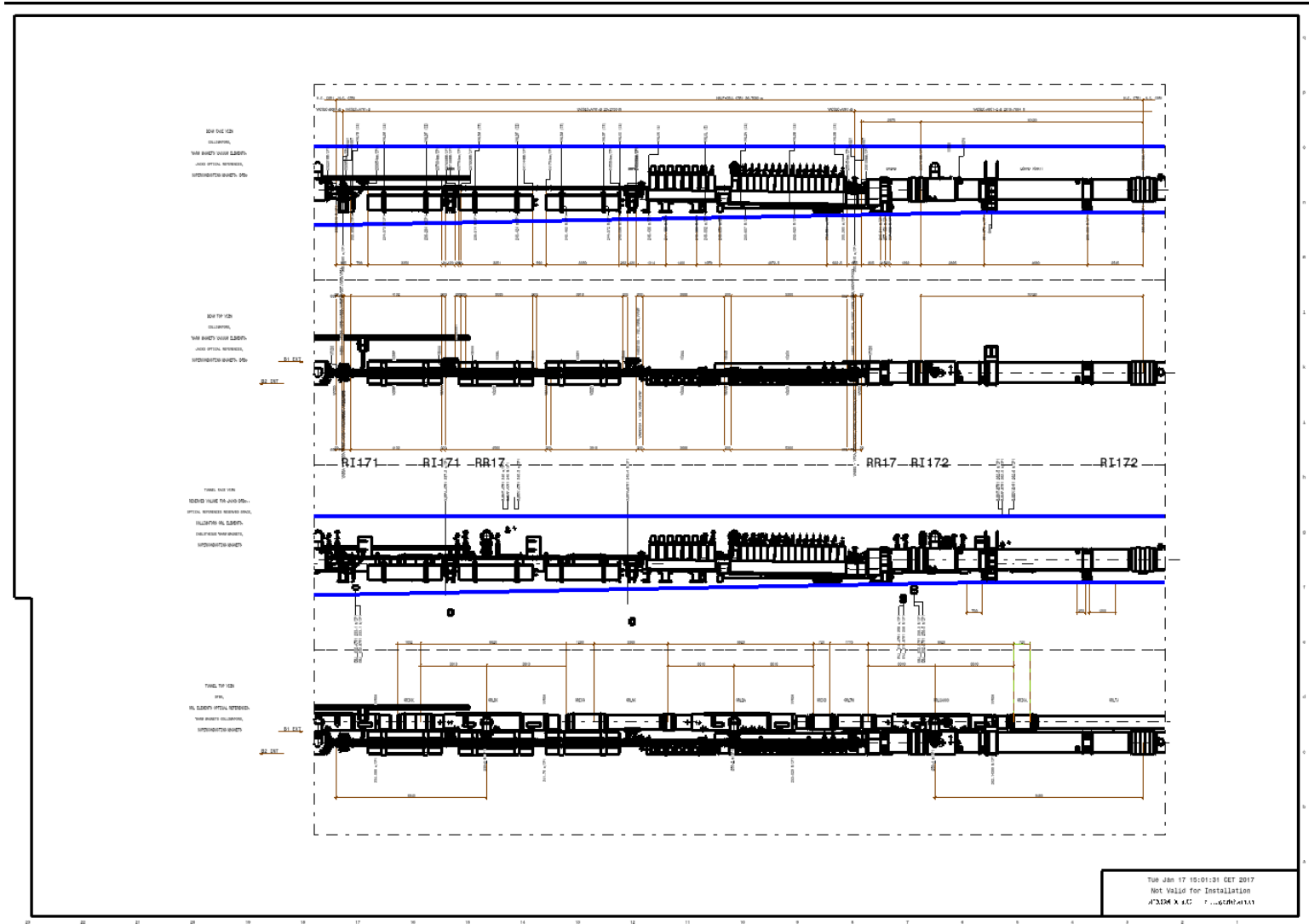

Data consolidated layout DMU engine

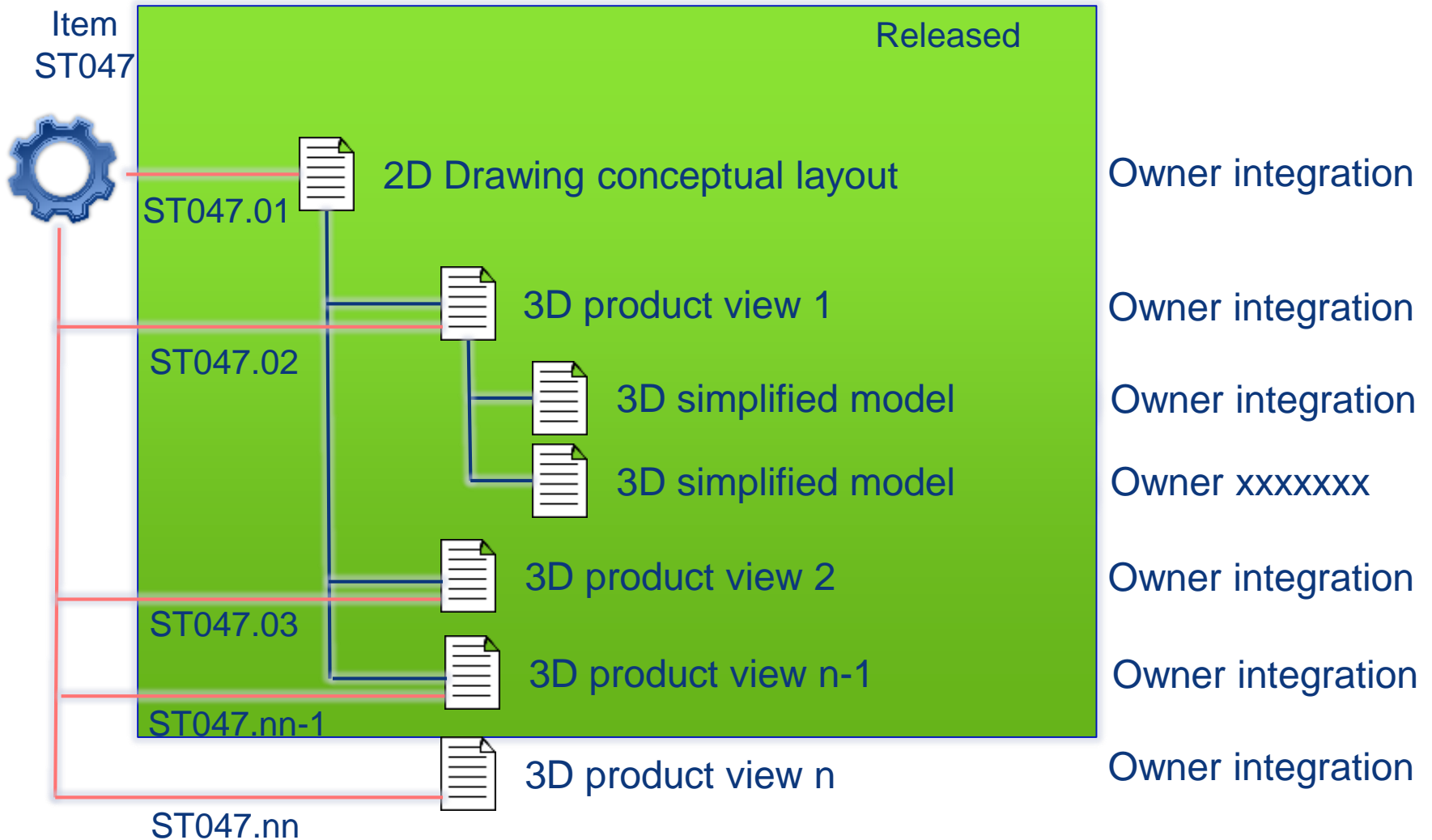

Data consolidated layout DMU engine

Items

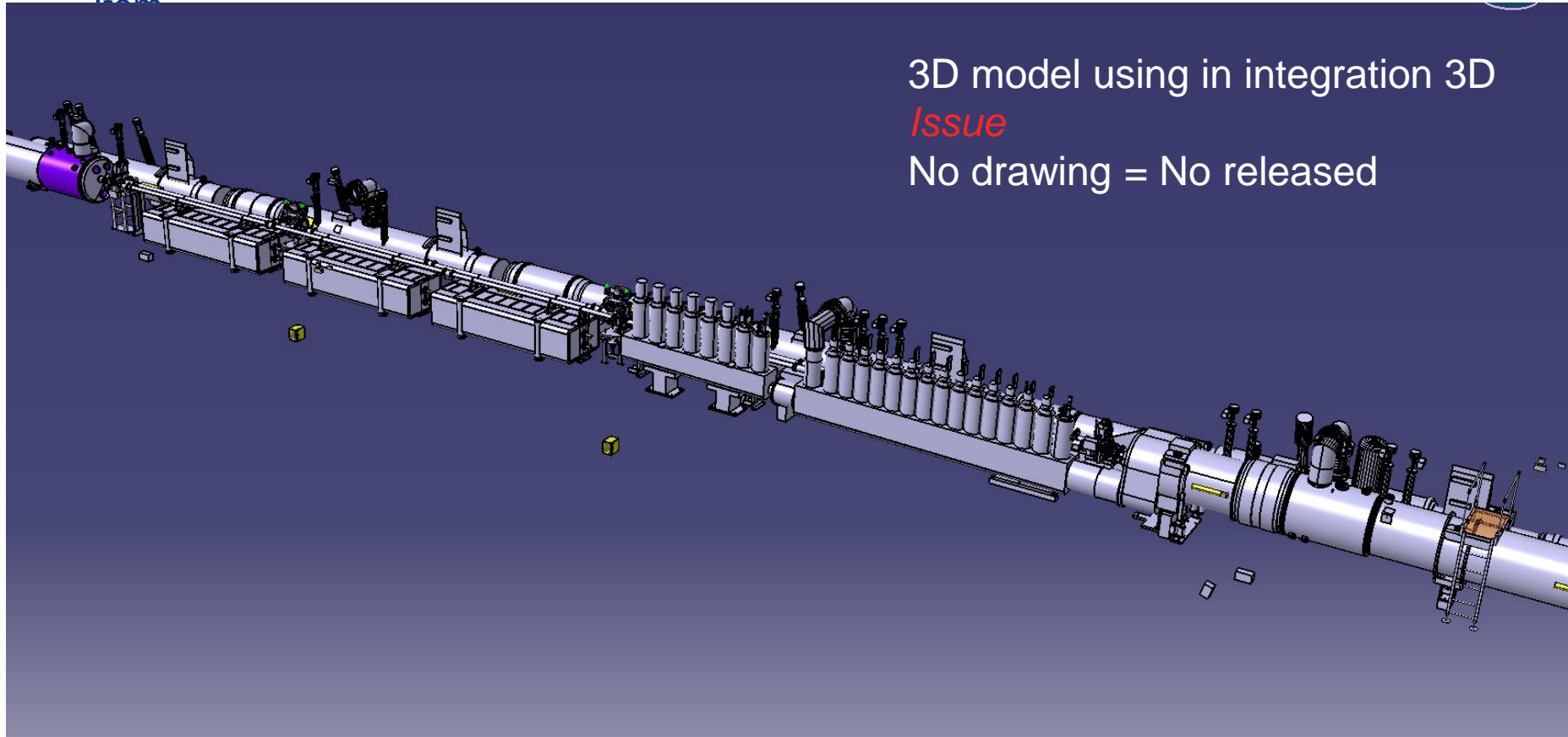

3D model using in integration 3D

Issue

No drawing = No released

ST047.nnn-1

ST047.nn



3D product view n RDC

Owner integration

Integration example - video

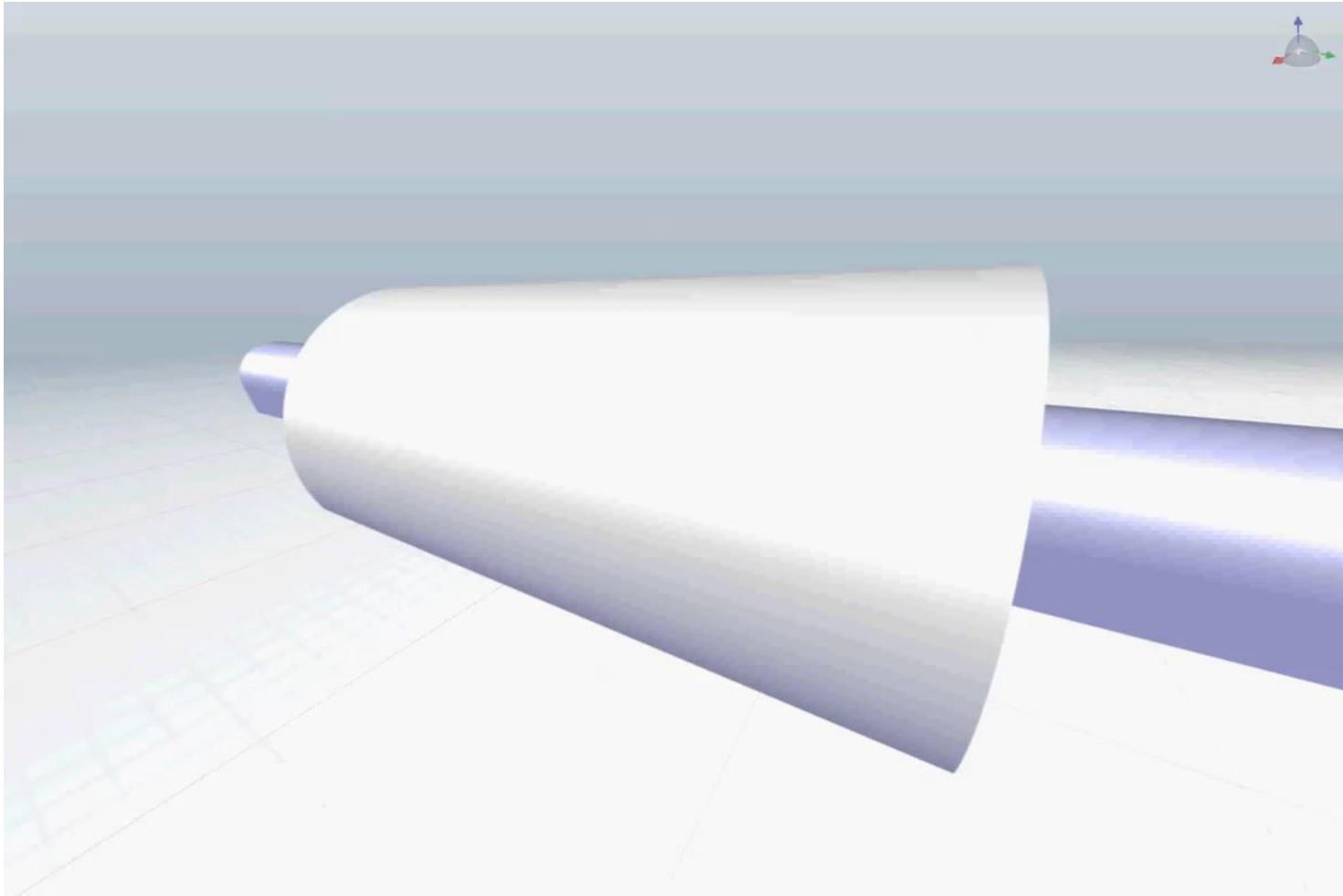

Integration work Process

Study phase



3D models

Integration Team



Design offices

Services design office

- Civil engineering
- Metallic structure
- Lift
- Shielding
- Piping
- Ventilation
- Ventilation door
- Câbles tray
- Electrical Eq.
- Cryogenic Eq.
- Access control
- Sector door
- Transport & handling
- Security Eq. Fire detection
- Survey

Mechanical design office

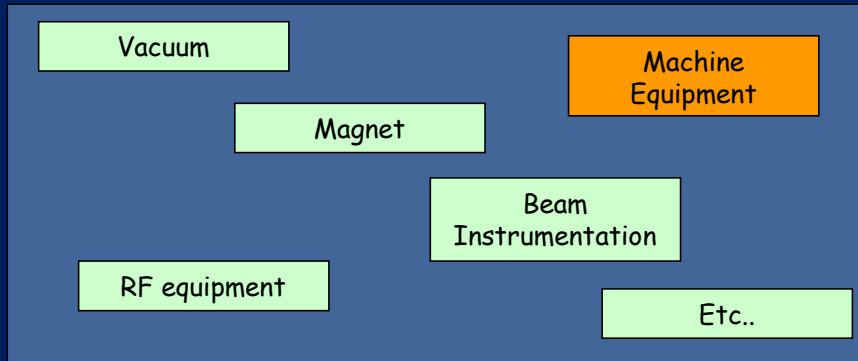

3D Scene

- Normally no integration drawing = no 3d model released.
- But integration is the owner of the top product and the 3D model services inside is under designer service responsibility.
- Two main point:
 - Integration 3D model top product and all the other components should be released.
 - Integration 3D model top product can be use by other designer in a drawing. In this case the top product should be ready for check or released (and all the components)



ENGINEERING
DEPARTMENT

Conceptual layout (2D skeletons, prototyping)



1. Inv: Req for each 2D sketch
2. CL req. on Prot + Draw
3. Update from CAD

Consolidated layout

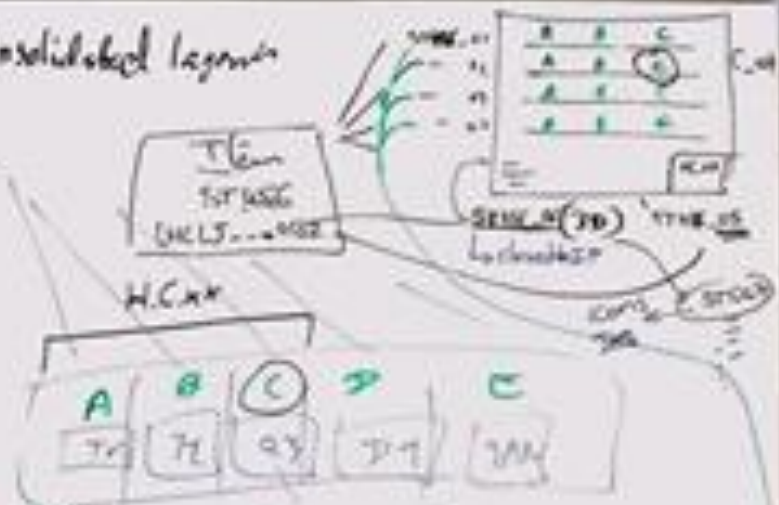

1. Inv take req
2. RFC \Rightarrow Clean-up
3. Give back req
4. Upload Dim to CAD
5. Sign in CAD

- Layer
- 01 - 2D wireframe (kicker)
 - 02 - 2D complete
 - 03 - 3D
 - 04 - 3D stage
 - 05 - skeleton

