



Passive absorber

Mechanical design

Luca Gentini, Alessandro Bertarelli, Federico Carra, Michele Pasquali



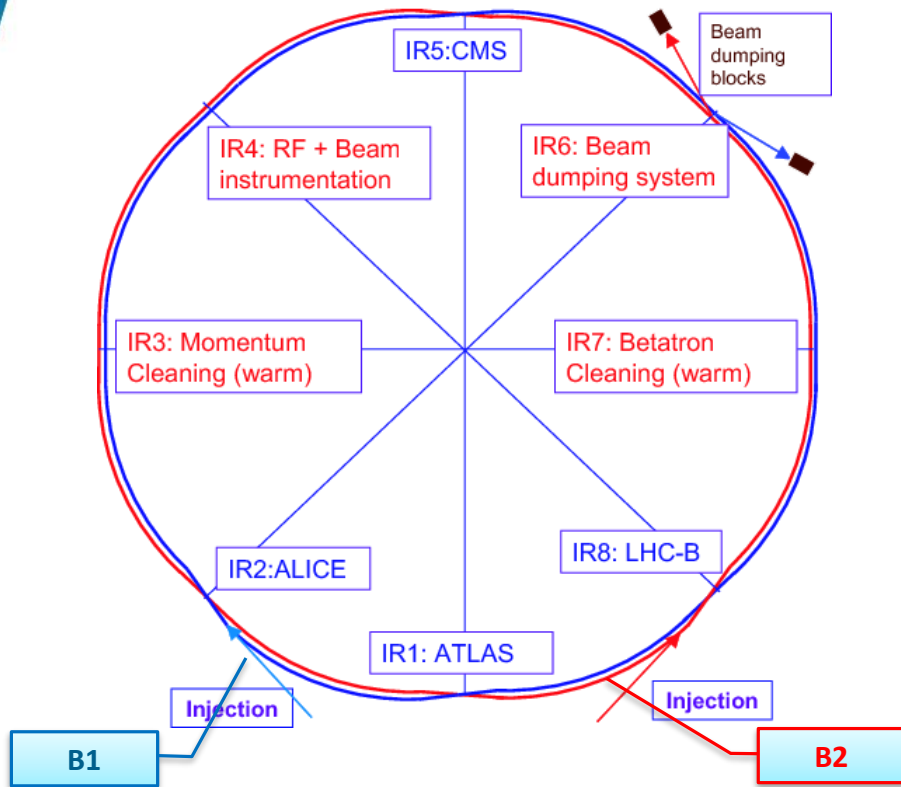

R7 – B2

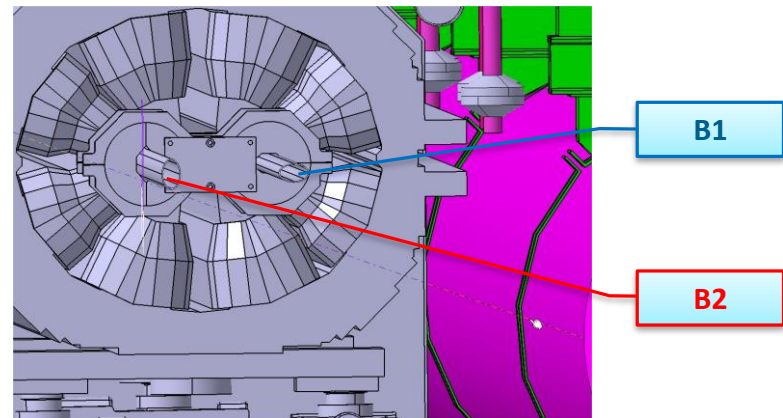

L7 – B1

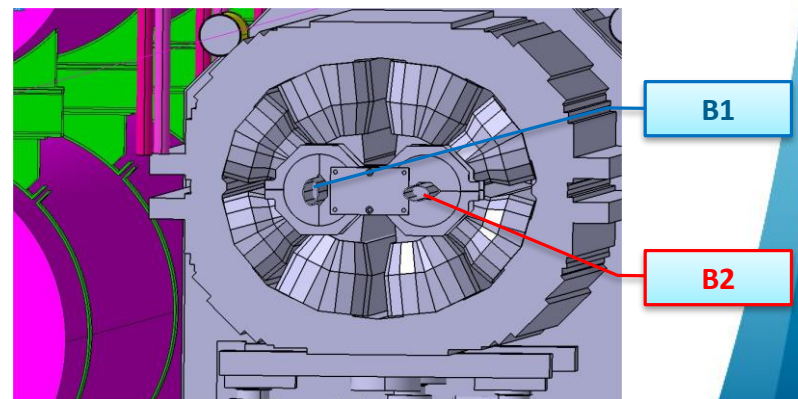

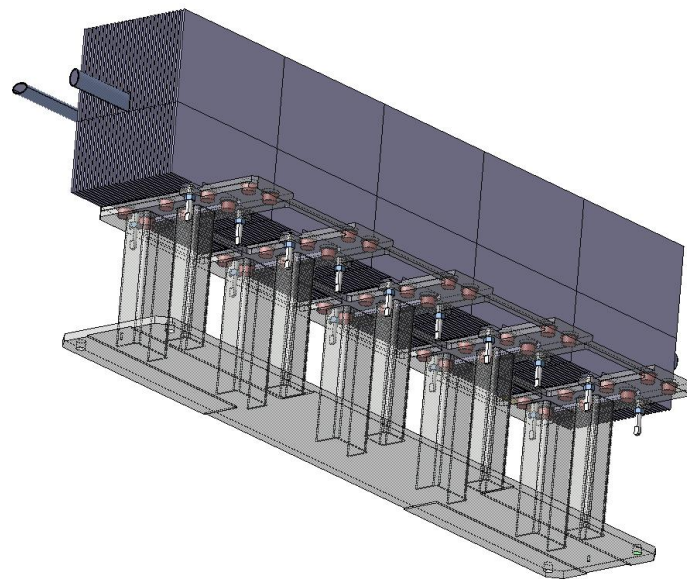
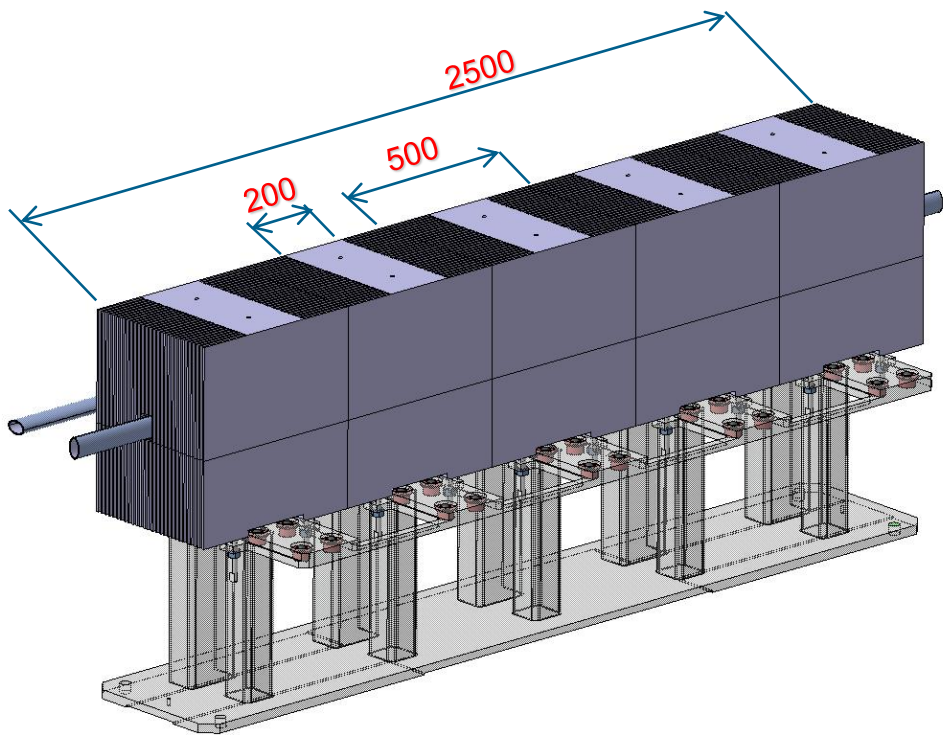

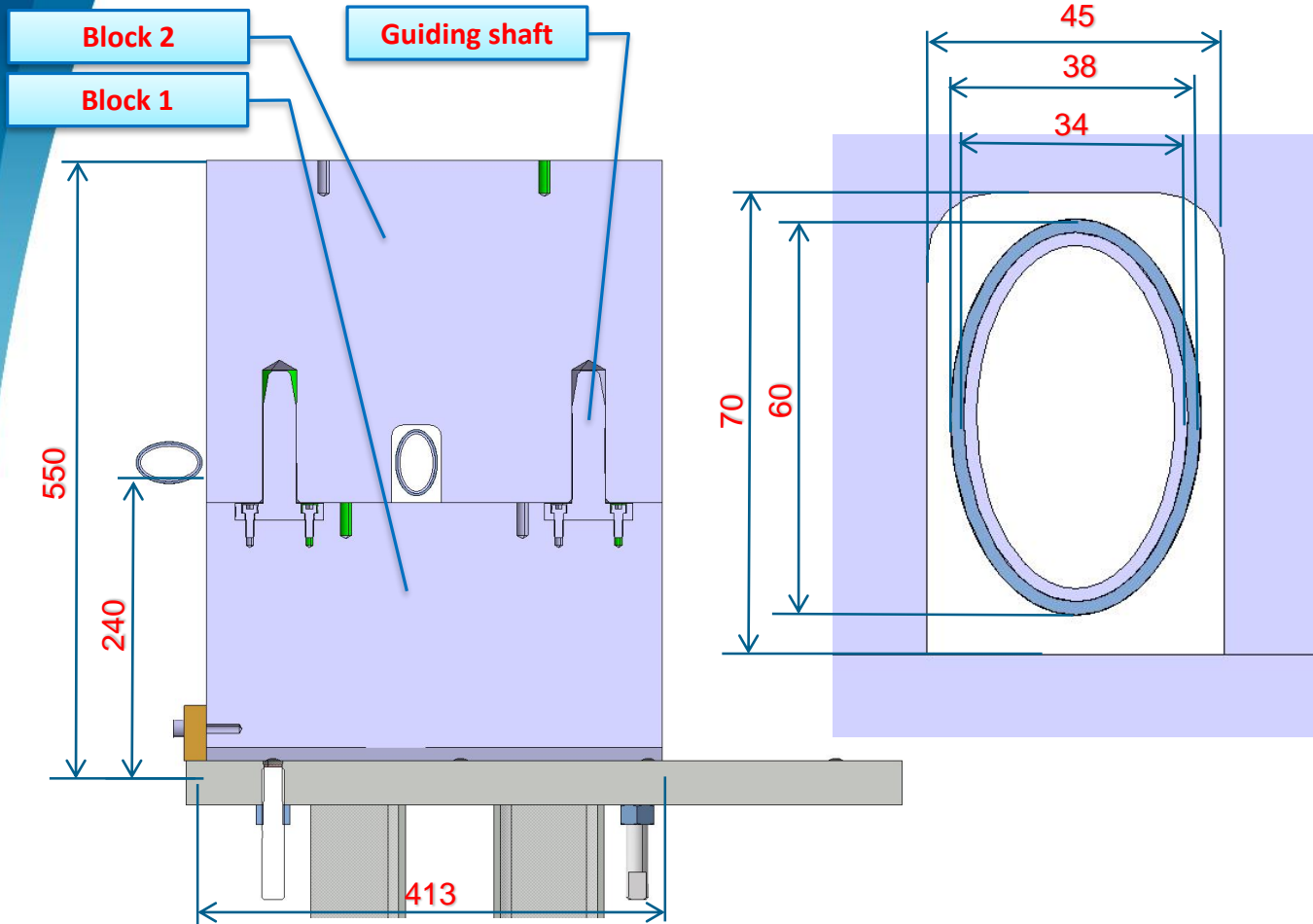

- External Chamber dimensions: 34 x 56
- Th. heating jackets: 2 mm
- Bloc 1 weight: 225 Kg
- Block 2 weight: 296 Kg
- Support weight: 158 kg
- TOTAL weight: 2800 kg

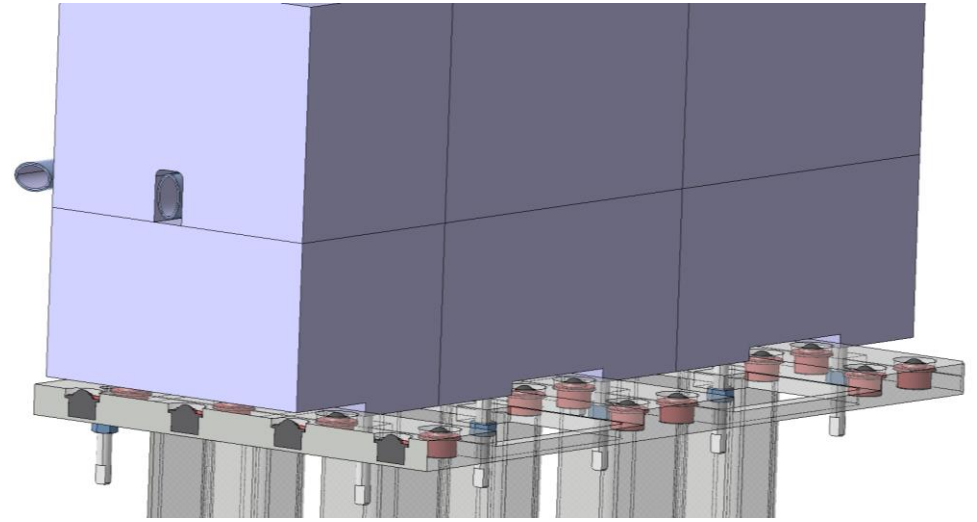
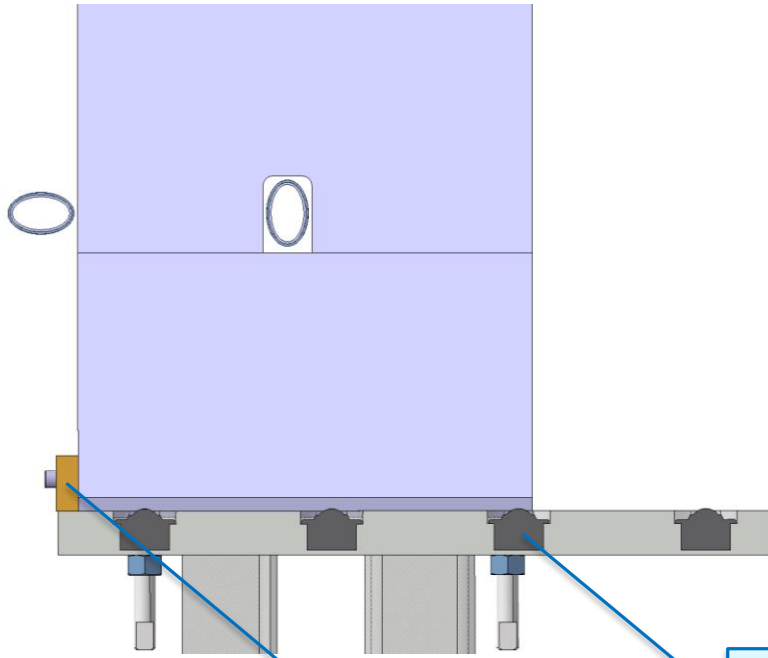

Mechanical stopper

Ball rollers

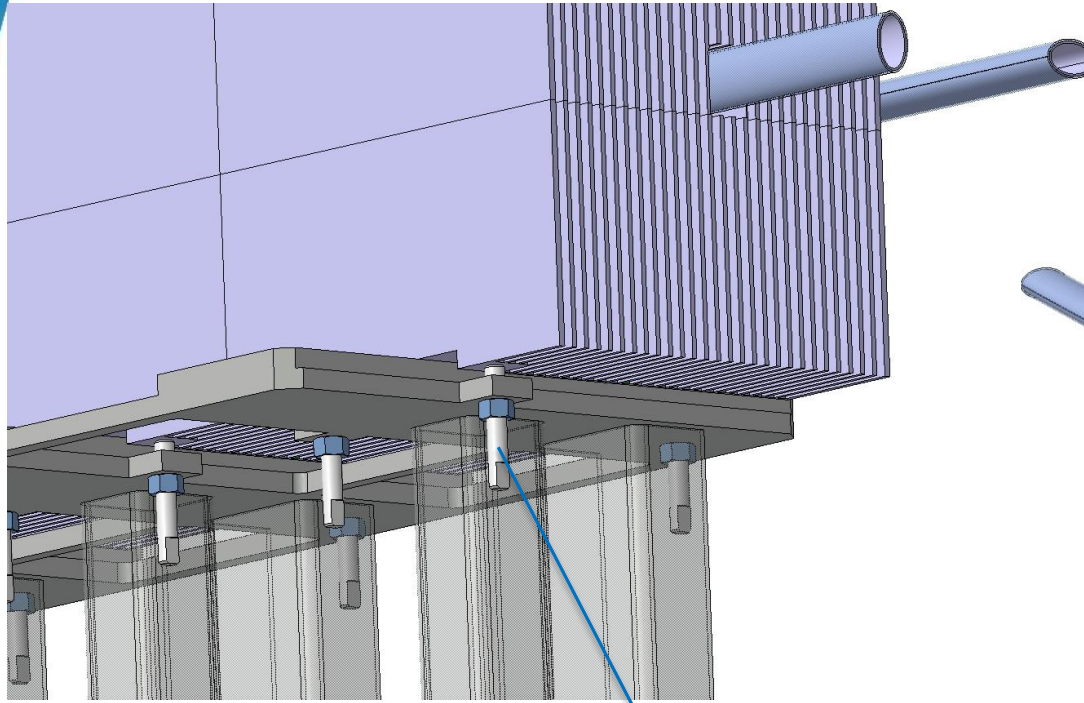

Adjusting rod

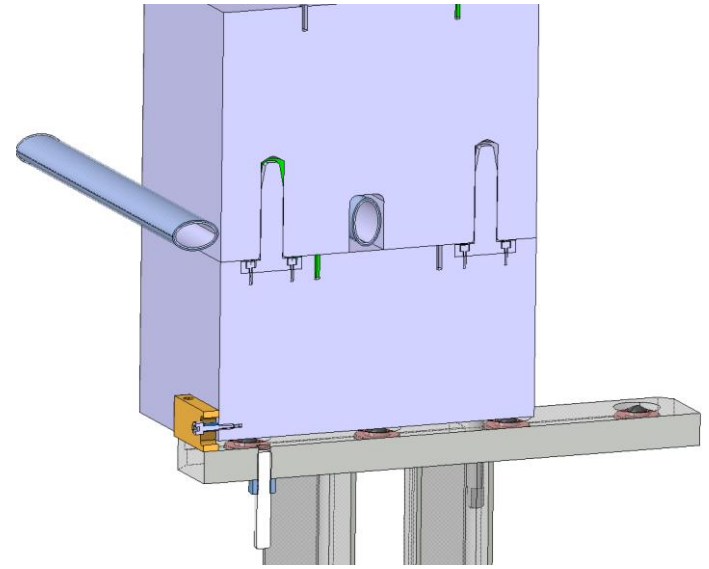

R7 – B2

QRL

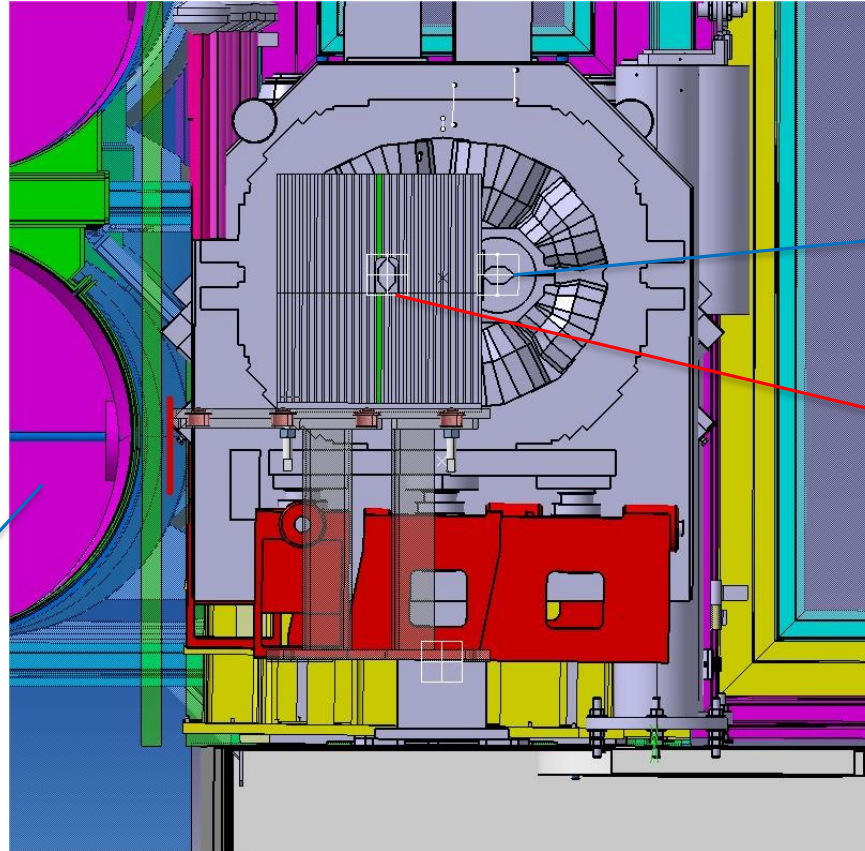

B1

B2



Thank you for your attention

