



# TREC in experimental areas

Frederic Aberle  
Claudia Ahdida  
Gerald Dumont  
Jean-François Gruber

# Guidelines

- Every material **leaving a beamline** has to be **traced in TREC** and **controlled by RP**
- Every material **leaving a radiologically classified building** has to be **controlled by RP**

# Flow



- Identify the material (traceability stickers) **before** installing in the beamline. **Trace reasonably** (i.e. do not use one code per screw)
- Do the request **well in advance**, with indication of the time when the material will be available for the measurement (measurement deadline). Use comments in TREC if needed
- Deposit the material in the Buffer Zone, if possible. Otherwise, call the RP Officer (**Meyrin: 72504, Prévessin: 75252**)
- **Sign the EDH** created by TREC, and **wait for the RPO signature** before leaving the building
- **Update the location** of your equipment when it has been transported

# Layout of the areas – North Area

- North Area
  - 1 Buffer Zone available, second one on the way
    - TREC mandatory for equipment in beam lines\*

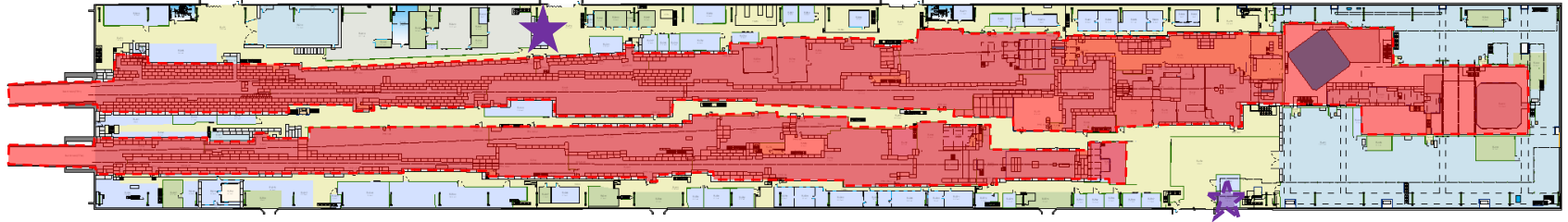

\* As depicted by red areas

# Layout of the areas – East Area

- East Area
  - 1 Buffer Zone available
  - TREC mandatory for equipment in beam lines\*
- CHARM/IRRAD
  - 1 Buffer Zone available
  - TREC mandatory for equipment in beam lines\*



\* As depicted by red areas

# Layout of the areas – AD Hall

- AD Hall
  - 1 Buffer Zone available (next one to be build soon)
  - TREC mandatory for equipment leaving AD ring\*
  - TREC mandatory for beam equipment and experimental setup\*
  - TREC not mandatory if 60cm away from the beam line\*. RP control still needed

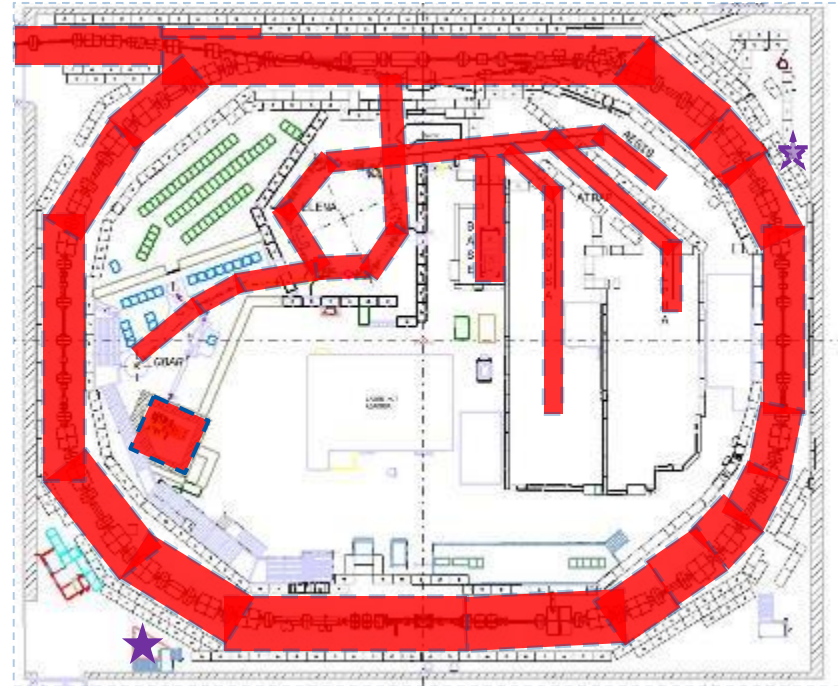

\* As depicted by red areas

# RP Contacts

- RP contact available at: <https://espace.cern.ch/RP-LHC/DivDocs/RP-AS-Contacts-LastUpdate.pdf>
- Do not hesitate to contact the RPO of the concerned area
- Meyrin: +41227672504
- Prévessin: +41227675252

HSE-RP-AS (October 2018)  
CONTACT PERSONS

Revision: 20/09/2018

|                            | Responsible / studies | Operational RP                               |
|----------------------------|-----------------------|--|
| <b>LHC complex</b>         |                       |  |
| LHC – accelerator          | Cristina Adoriso      | Christophe Tromel<br>Angelito Herve          |
| LHC – experiments          | Robert Froeschl       | Nadine Conan<br>Isabel Brunner               |
| <b>SPS complex</b>         |                       |  |
| SPS – accelerator, T12/T18 | Helmut Vincke         | Angelito Herve<br>Christophe Tromel          |
| SPS – target areas         | Helmut Vincke         | Yann Pira<br>Frederic Aberle                 |
| AWAKE                      | Cristina Adoriso      | Christelle Saury<br>(Yann Pira)              |
| HIRadMat                   | Helmut Vincke         | Christelle Saury<br>(Nadine Conan)           |
| North experimental area    | Claudia Ahdida        | Frederic Aberle<br>Yann Pira                 |
| <b>PS Complex</b>          |                       |  |
| Linac2, Linac3, LEIR       | Markus Wadorski       | Jean-Francois Gruber<br>(Florent Philippou)  |
| Linac4                     | Markus Wadorski       | Jean-Francois Gruber<br>Florent Philippou    |
| PS Booster                 | Fabio Pozzi           | Gérald Dumont<br>(Jean-Francois Gruber)      |
| Isolde / Medics            | Fabio Pozzi           | Alexandre Dorsival<br>Elodie Aubert          |
| PS - accelerator           | Robert Froeschl       | Gérald Dumont<br>(Jean-Francois Gruber)      |
| East experimental area     | Robert Froeschl       | Jean-Francois Gruber                         |
| AD / GBAR                  | Claudia Ahdida        | Gérald Dumont                                |
| n_TOF                      | Fabio Pozzi           | Jean-Francois Gruber<br>(Alexandre Dorsival) |
| CTF3 / CLEAR               | Markus Wadorski       | Gérald Dumont<br>(Jean-Francois Gruber)      |

(Names) in parenthesis are responsible only during absence periods

HSE-RP-AS (October 2018)  
CONTACT PERSONS

Revision: 20/09/2018

|                                   | Responsible / studies | Operational RP  |
|-----------------------------------|-----------------------|---|
| <b>Other sites and facilities</b> |                       |   |
| LIGHT                             | Markus Wadorski       | Nadine Conan<br>(Christophe Tromel)   |
| Radioactive workshops             | Markus Wadorski       | Angelito Herve (PREVESSIN)<br>Yann Pira (PREVESSIN)<br>Cyrilac Le Cousin (MEYRIN)<br>(Gérald Dumont) (MEYRIN) |
| Radioactive storage               |                       | Florent Philippou (MEYRIN)<br>Yann Pira (PREVESSIN)<br>Frederic Aberle (PREVESSIN)                            |
| Operational dosimetry             | Gérald Dumont         | Frederic Aberle (PREVESSIN)<br>Jean-Francois Gruber (MEYRIN)  |
| Portiques                         | Markus Wadorski       | Didier Alberto (PREVESSIN)  |
| RF tests areas (SM18, XBOX)       | Markus Wadorski       | N. Conan (PREVESSIN)<br>G. Dumont (MEYRIN)  |
| High-level dosimetry              | Helmut Vincke         | Isabel Brunner<br>Didier Alberto  |
| Central contact:                  | PS complex            | 72504   |
|                                   | SPS/LHC complexes     | 75252   |
| Frederic Aberle                   | 161607                | Angelito Herve 163168   |
| Cristina Adoriso                  | 165345                | Cyrilac Le Cousin 161672  |
| Claudia Ahdida                    | 164145                | Yann Pira 166071  |
| Didier Alberto                    | 160649                | Florent Philippou 167992  |
| Elodie Aubert                     | 169097                | Fabio Pozzi 166258  |
| Isabel Brunner                    | 164401                | Christelle Saury 162238   |
| Nadine Conan                      | 160641                | Christophe Tromel 163199  |
| Alexandre Dorsival                | 164834                | Heinz Vincke 165456   |
| Gérald Dumont                     | 164758                | Helmut Vincke 163701  |
| Robert Froeschl                   | 160058                | Markus Wadorski 163758  |
| Jean-Francois Gruber              | 169144                |   |

(Names) in parenthesis are responsible only during absence periods



# Reminders (often forgotten)

- The TREC code follows the equipment part until the end of his life
- Record your request in TREC
- Indicate a responsible person who is at CERN and available to sign in EDH
- Sign your EDH
- Wait until RPO signature before leaving
- In case of urgency, contact the RPO
- For specific cases, contact the RPO

# Thank you for your attention

Do you have questions?