

BERKELEY LAB

LAWRENCE BERKELEY NATIONAL LABORATORY



U.S. DEPARTMENT OF
ENERGY

Welcome to the PDG Collaboration Meeting



- **US DOE Facility**
 - Please obey all posted signs
- **Pedestrian safety**
 - Use sidewalks and crosswalks; watch your step
 - Do not interact wild animals on site
- **Traffic safety**
 - 15 mph speed limit on site due to construction
- **Smoking**
 - In designated areas only
- **Reporting emergencies**
 - Dial **911** for life-threatening emergencies
 - Dial **6999** (on lab phone) for non-life threatening events

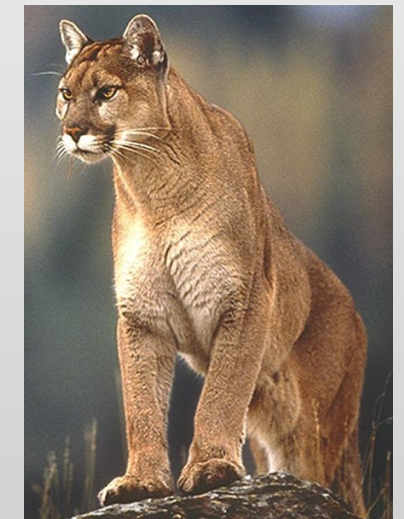
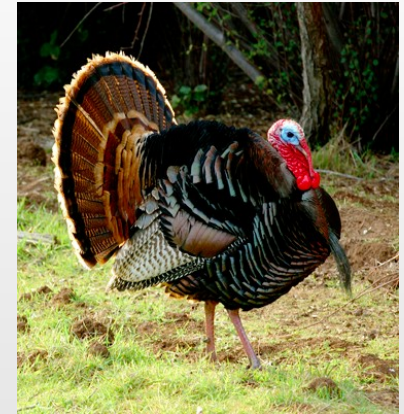

you are here

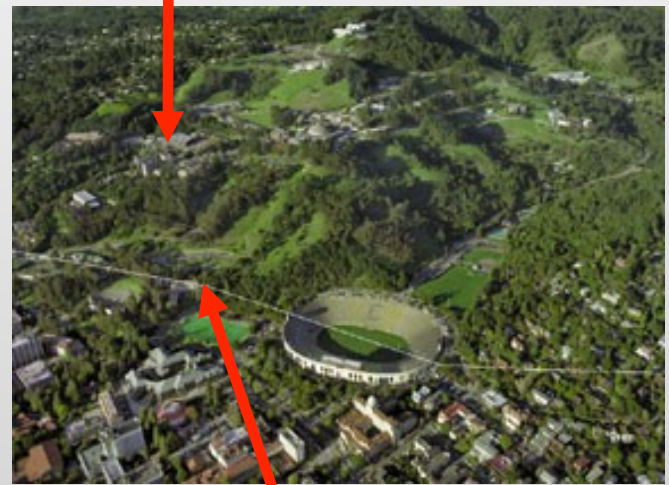

Hayward fault



Drop down on the floor

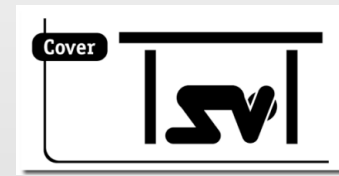

Cover under a sturdy desk, table or other furniture



Hold onto it and be prepared to move with the furniture

Evacuate to assembly area in parking lot. Take personal items.

Follow Directions from the Building Emergency Team

Towards the Bay and San Francisco

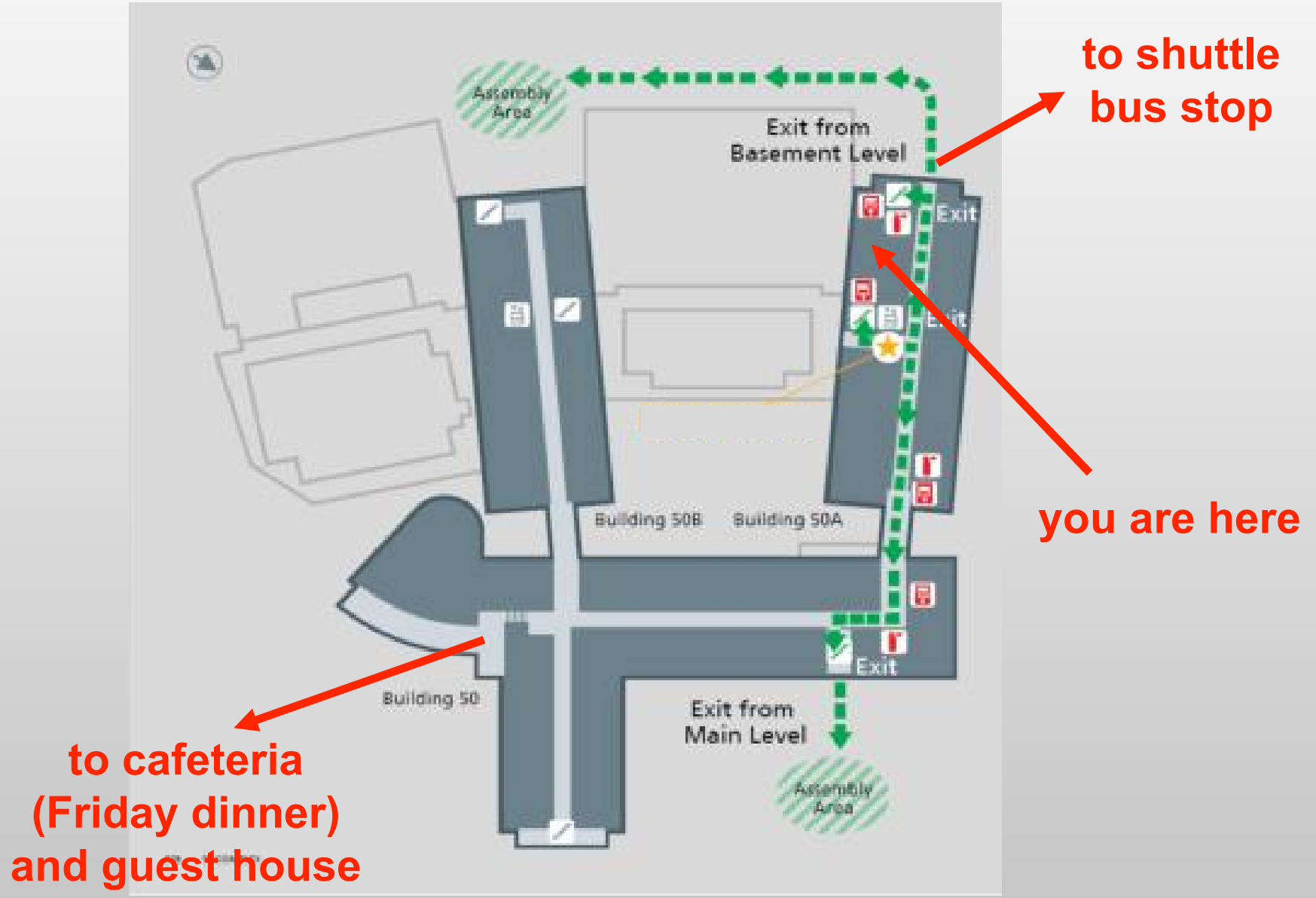

- Available today but not on weekend
 - You want the **Blue Route** to go down to / come back from Berkeley
 - Runs about every 10 min – see [schedule](#)
 - Last bus back to LBNL departs at 9:15pm from downtown BART

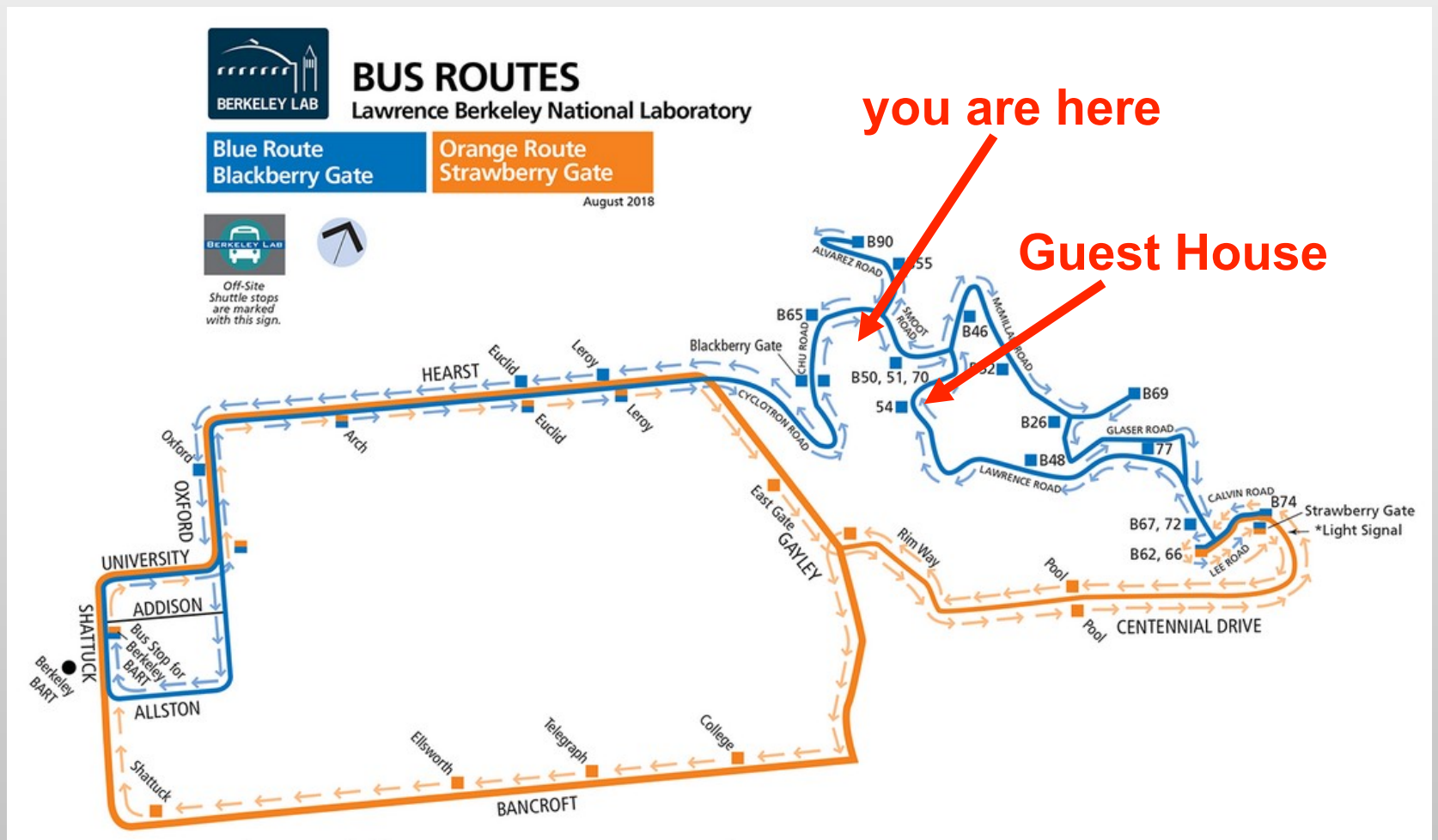

- **Friday 7pm**
 - LBNL cafeteria

- **Saturday 7pm**
 - Longbranch
2512 San Pablo Ave
Berkeley
 - Contact Dan or Troy if you need transportation
 - Depending on when football game ends, we may try to arrive early to avoid traffic

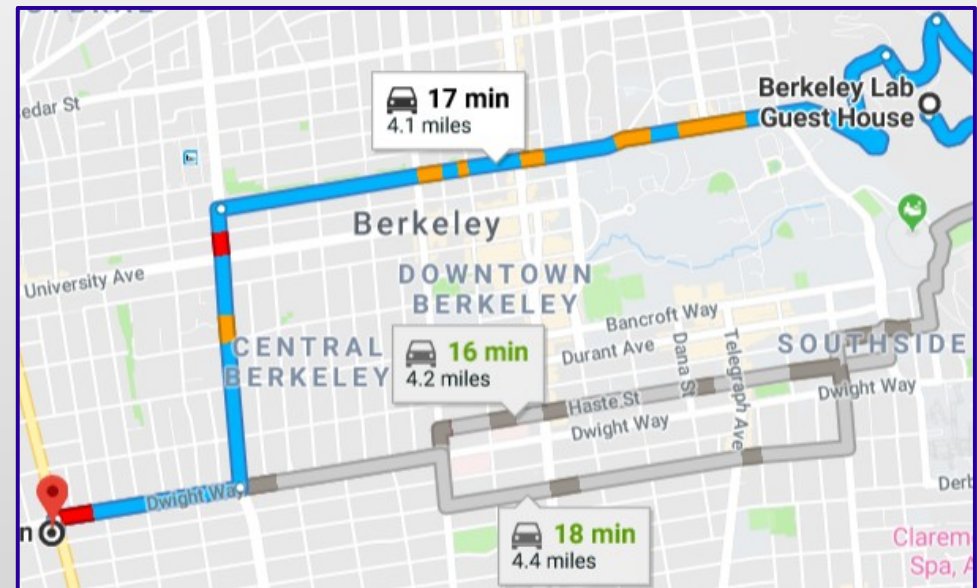

- **Guest lecture by Carl Haber (LBNL) after Friday dinner**
 - *New technologies for the preservation of rare, damaged, and deteriorating sound recordings of immense value to our cultural heritage*