

1992

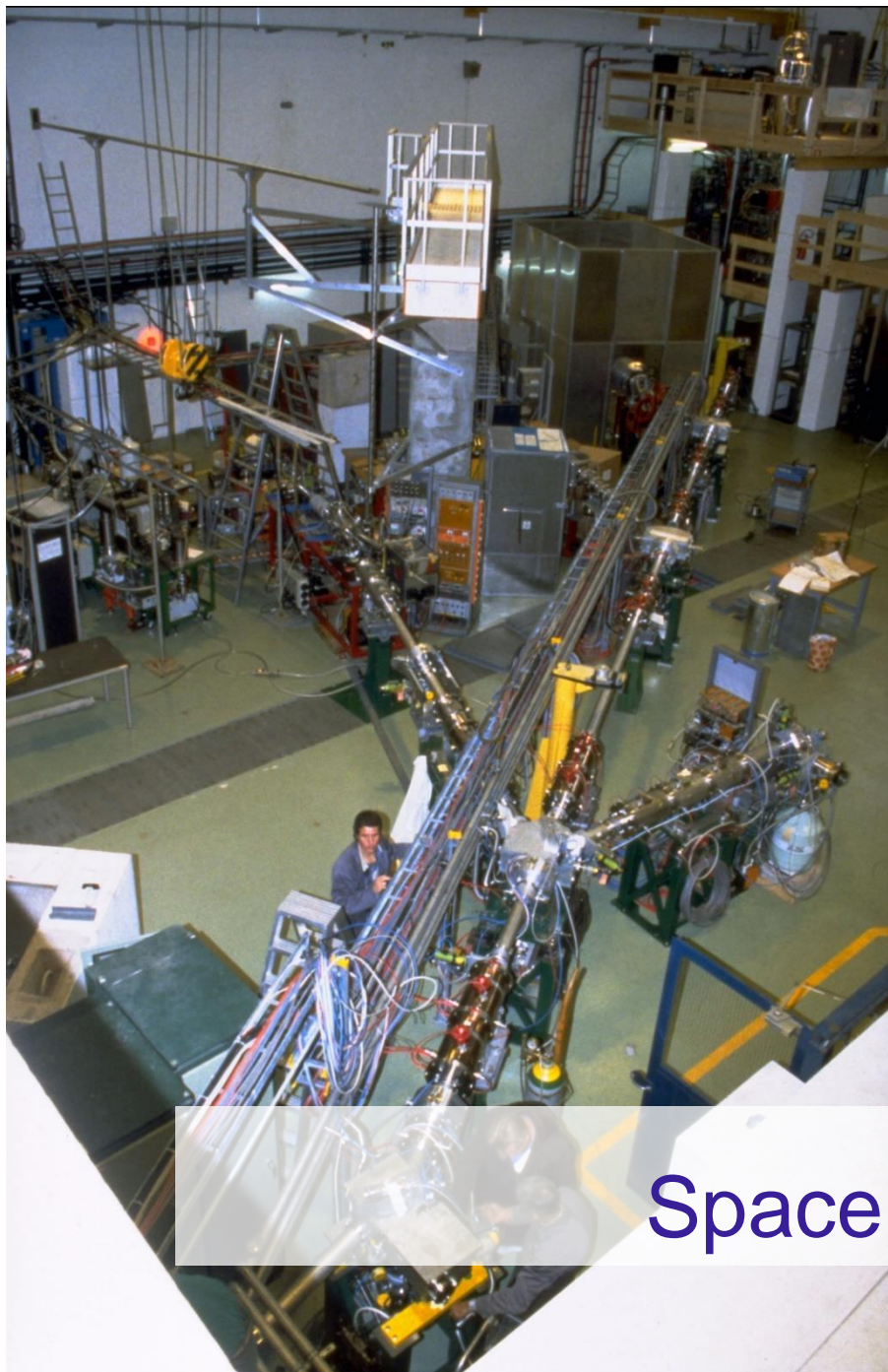

2019



Space in the ISOLDE hall

Experiments/setups which are or may be coming in the foreseeable future

- Puma (pending approval by INTC and SPSC)
- MIRACLS
- MRTOF(s)
- CRIS platform and upgrade
- Additional VITO parts
- Magnet for PAC studies
- Upgrade of GLM/GHM area and new collection chamber plus integration of tape station.

Overview of the ISOLDE hall (pdf needs updating)

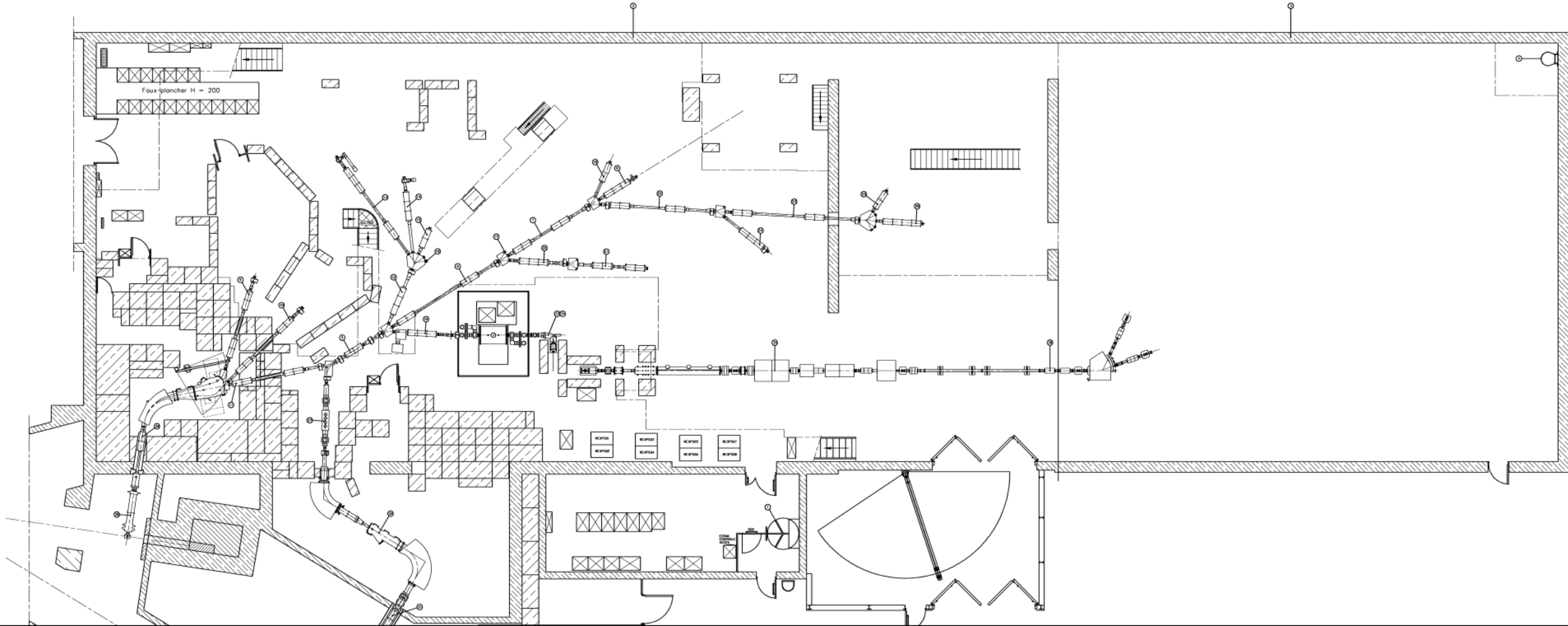

MEDICIS

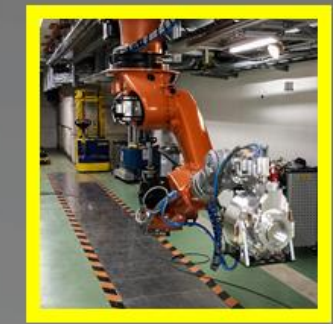
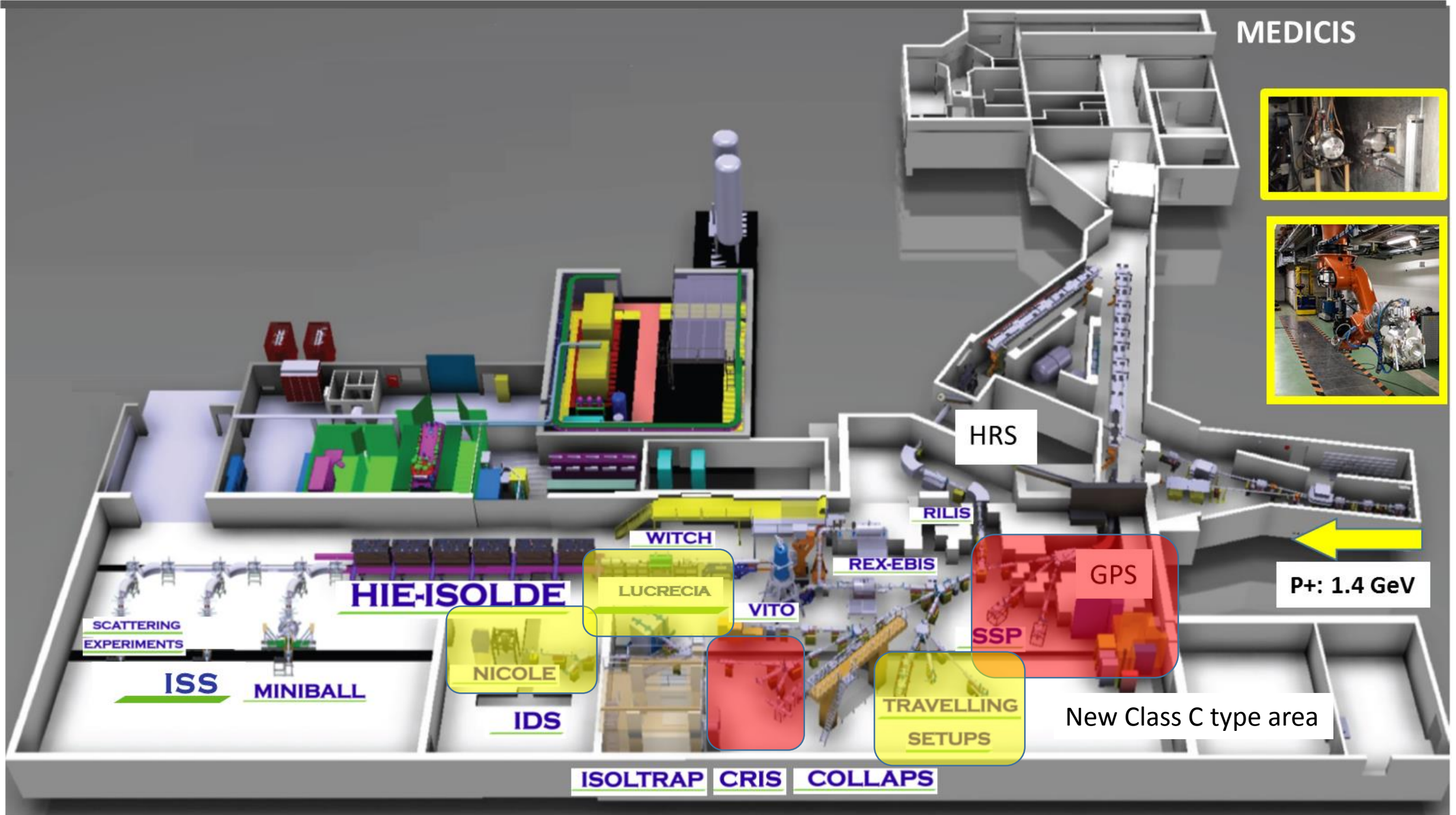

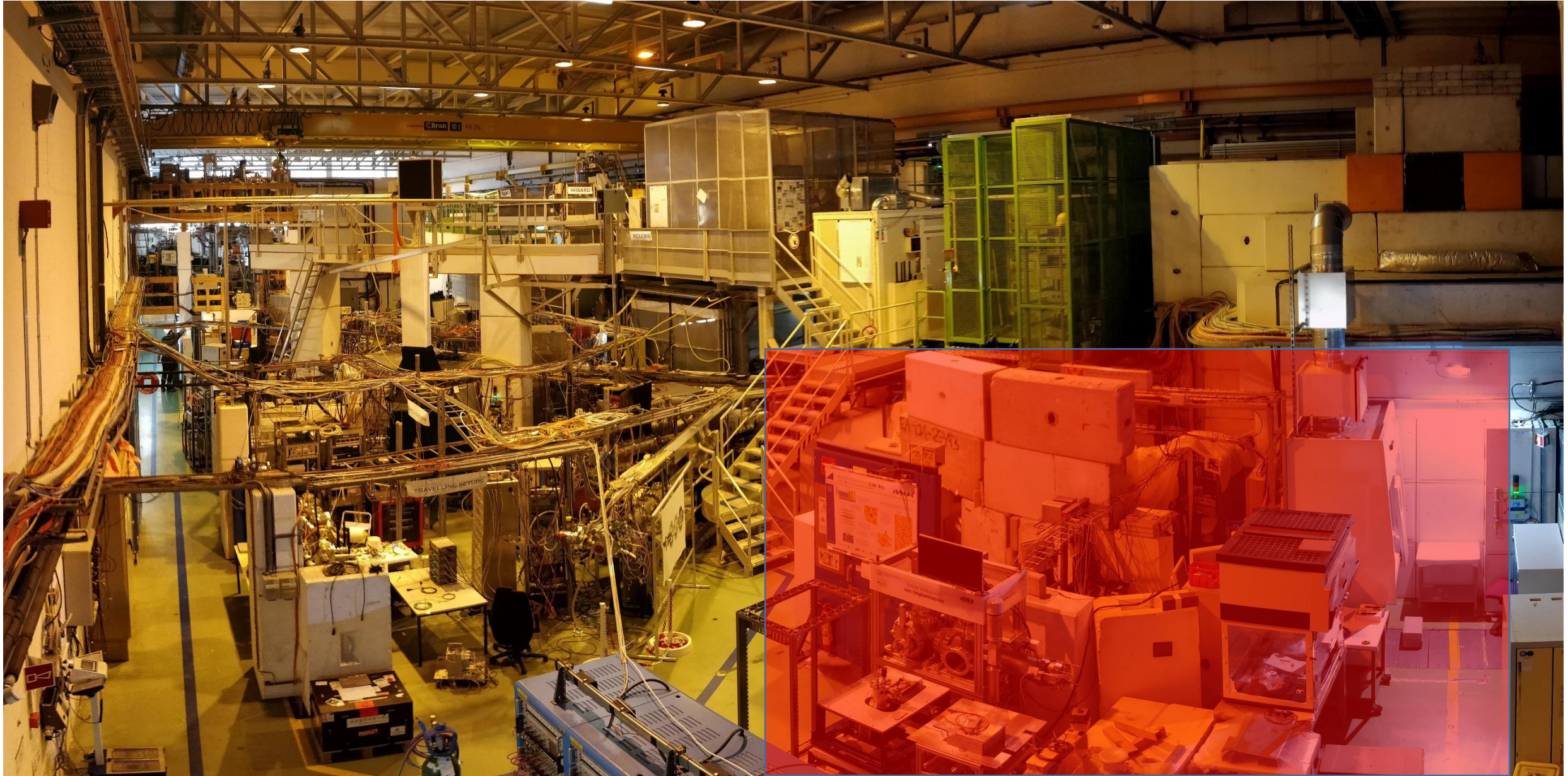

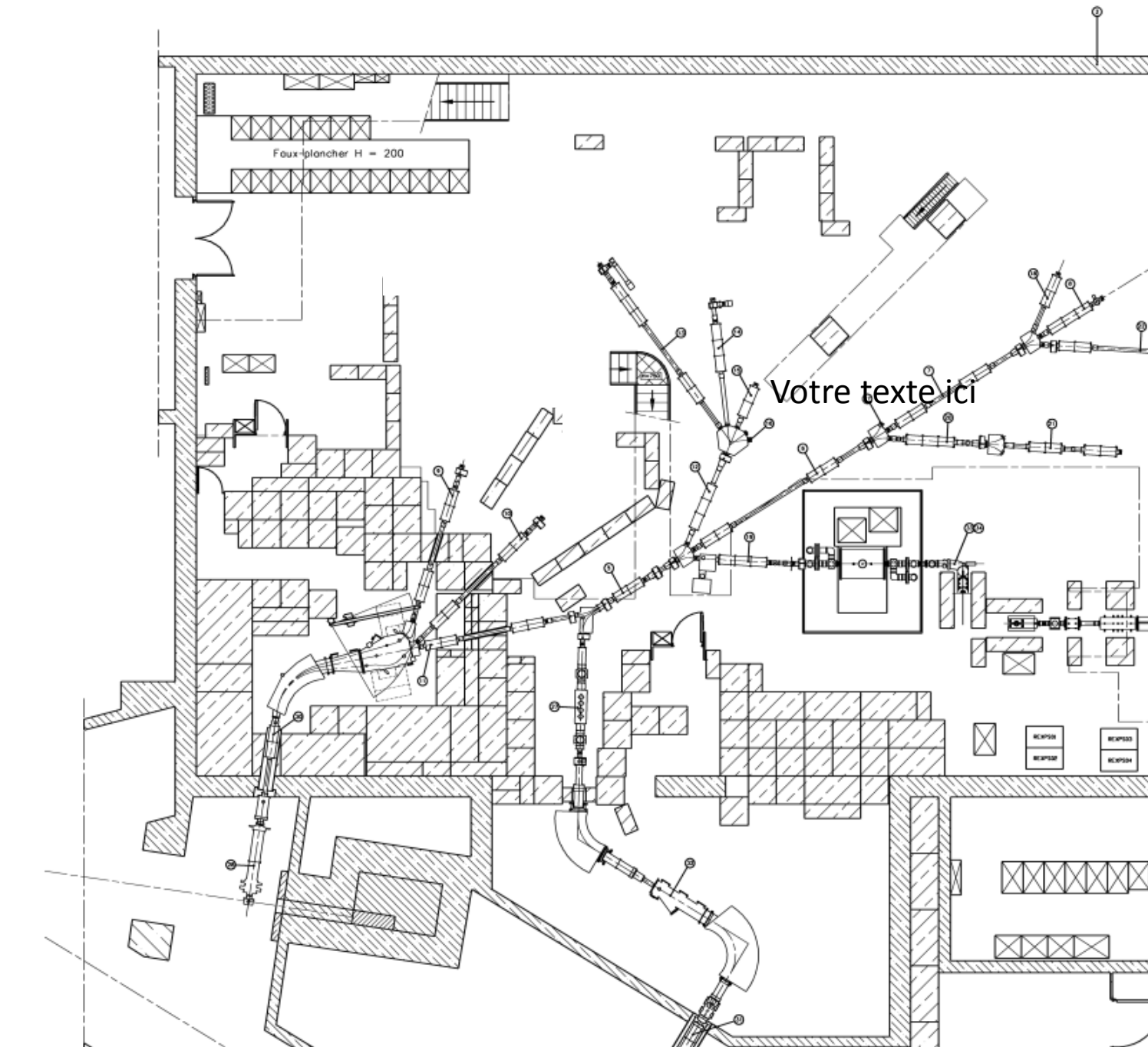

- New collection chamber
- Additional Fast tape station to allow for transparent TISD work while HRS performs physics
- Retain need for travelling experiments to be installed...e.g. biophysics chamber; mossbauer; detector setups such as windmill, Gandalf etc

- Reconfigure blocks to allow for removal of samples without exposing other users to risk of contamination.
- Avoid installing a roof for many reasons...
- Design work starts Q2 2019.

New and visiting setups

Surface implantation



Online setup for ^{68}Cu PAC

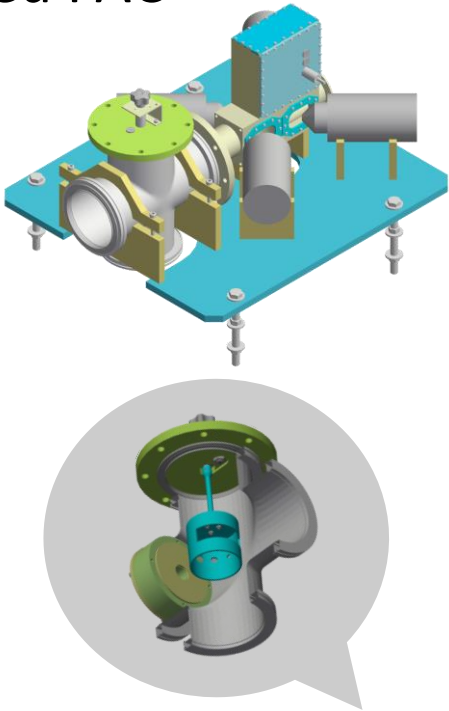

Implantations on ice



Mossbauer 2.0

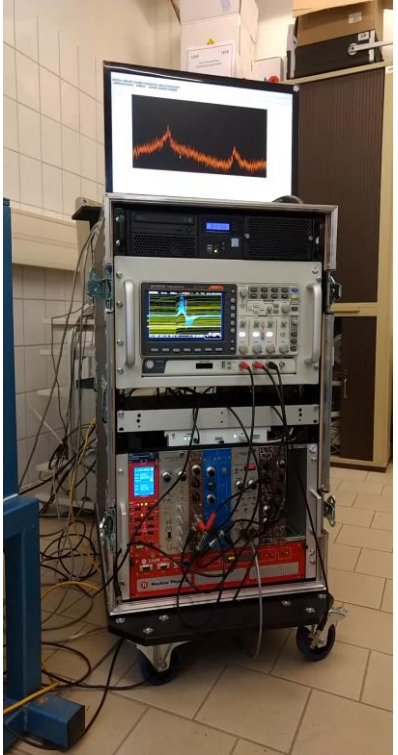
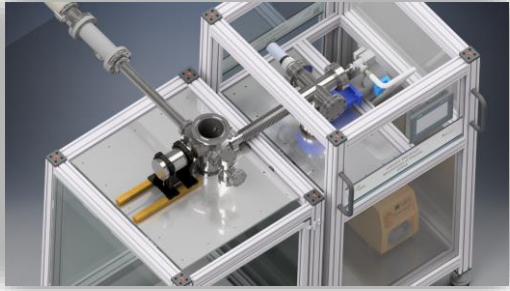

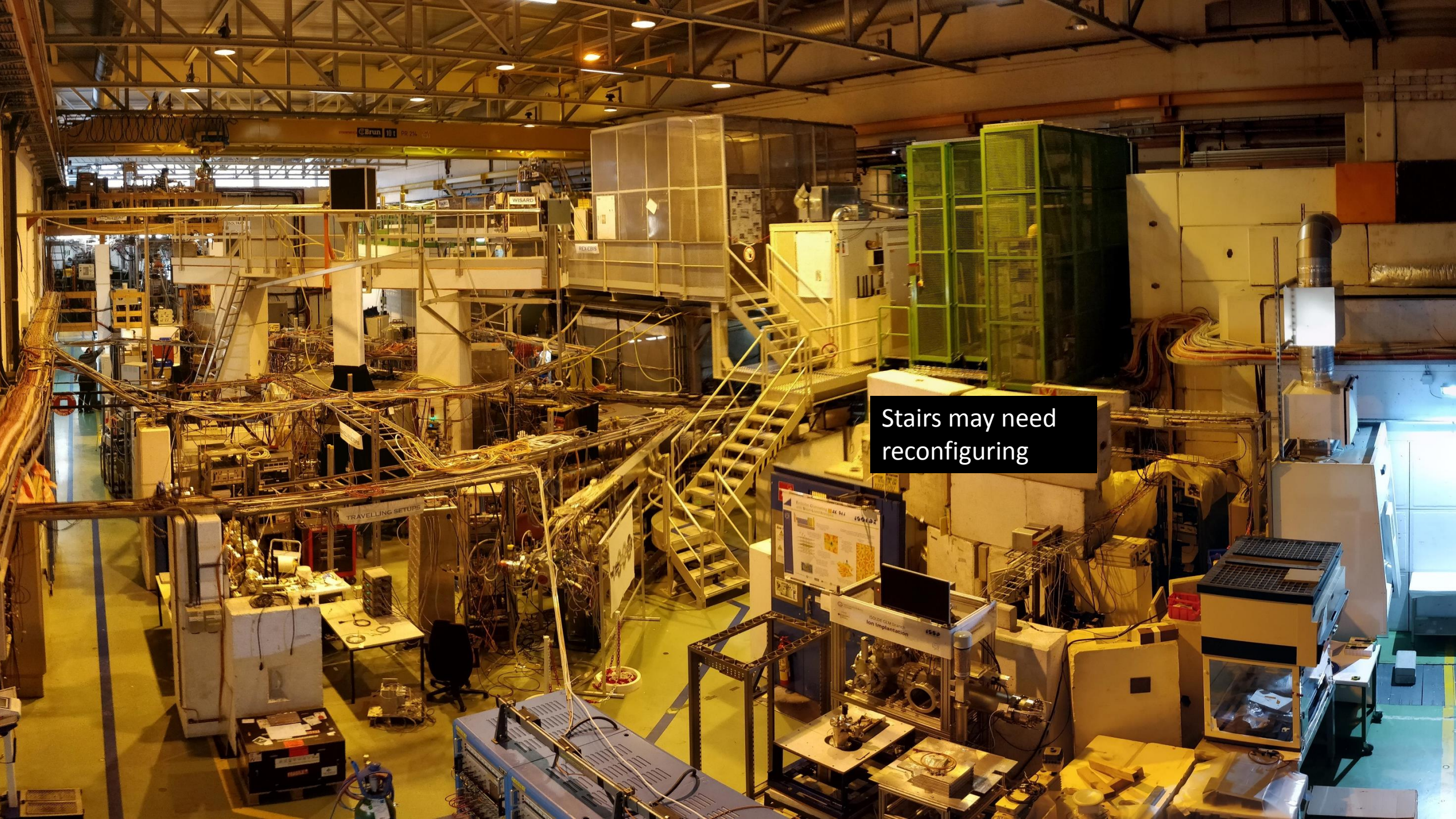

Stairs may need reconfiguring

The PUMA device

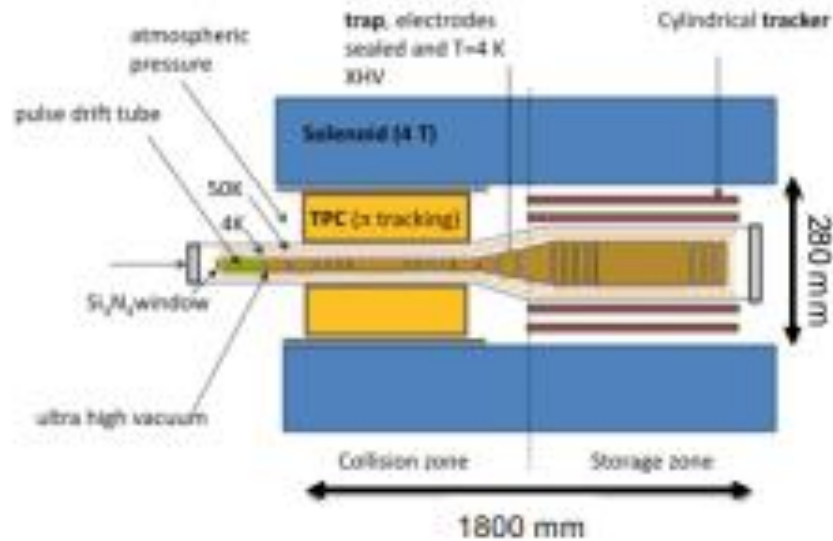

Operation of PUMA:

- Solenoid: 2 cold heads
- Trap: 1 cold head + electrode HV



Many challenges: beam quality, low energy implantation, pure beam, bunched.

SPACE for PUMA?

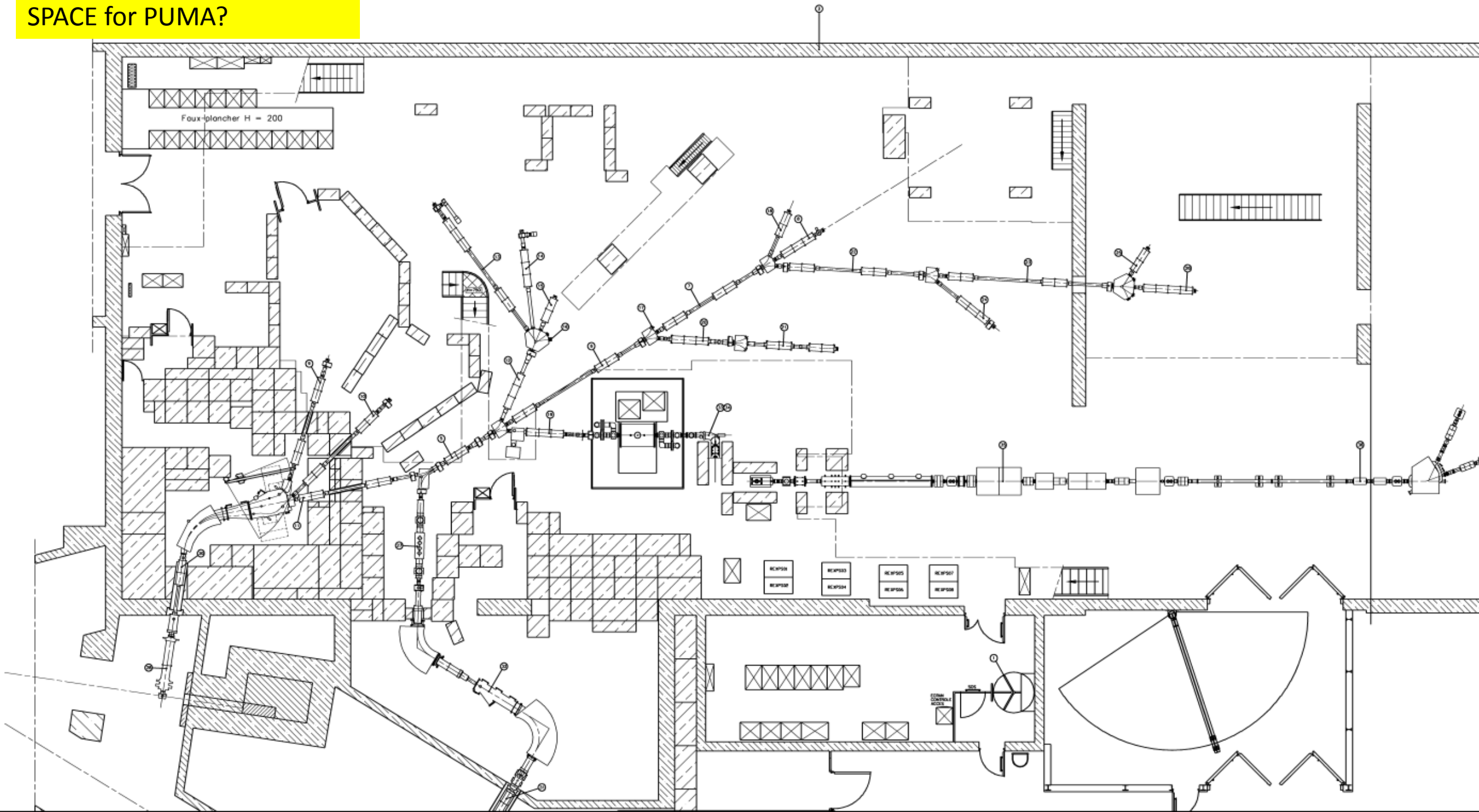



Status of NICOLE?

No beam since ~ 2010

How cold can it go? Collaboration? Will submit status reports to retain their shifts

In terms of space would suit PUMA (beam quality could be a problem).

NICOLE		
IS460	12	12
IS575	17	17

NICOLE

2007

Magnetic dipole moments of High-K isomeric states in Hf isotopes
IS460

2013

Beta-delayed neutrons from oriented $^{137,139}\text{I}$ and $^{87,89}\text{Br}$ nuclei
IS575

29

12

12

17

17

LA1/LA2



LA1 to be kept for travelling experiments.

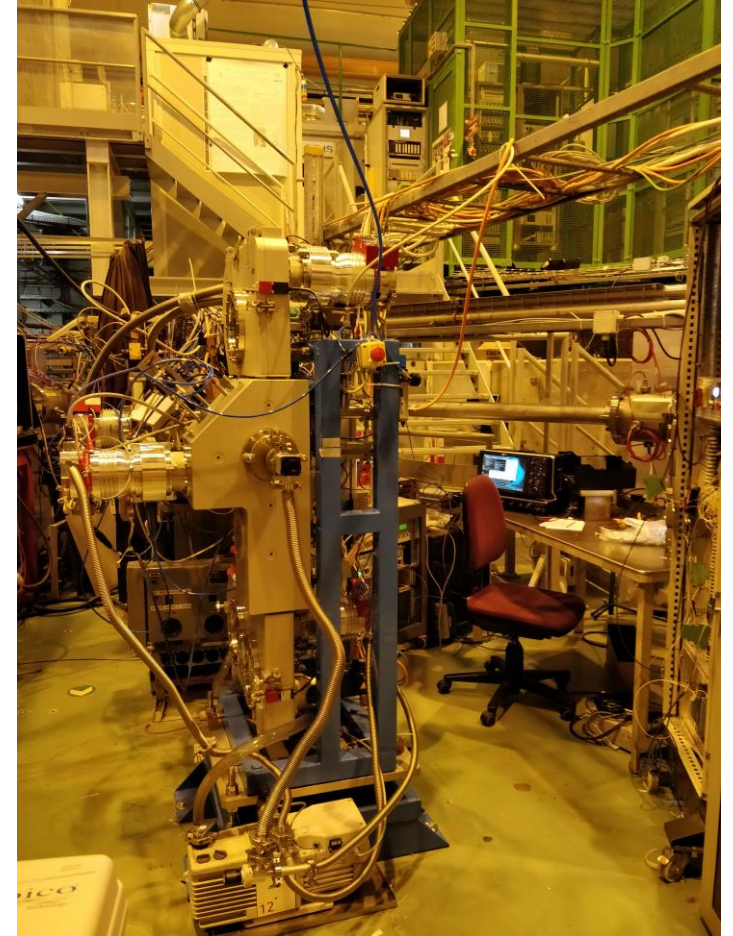

LA2 currently occupied by FTS;
future site for MIRACLS?

SPACE for MIRACLS?

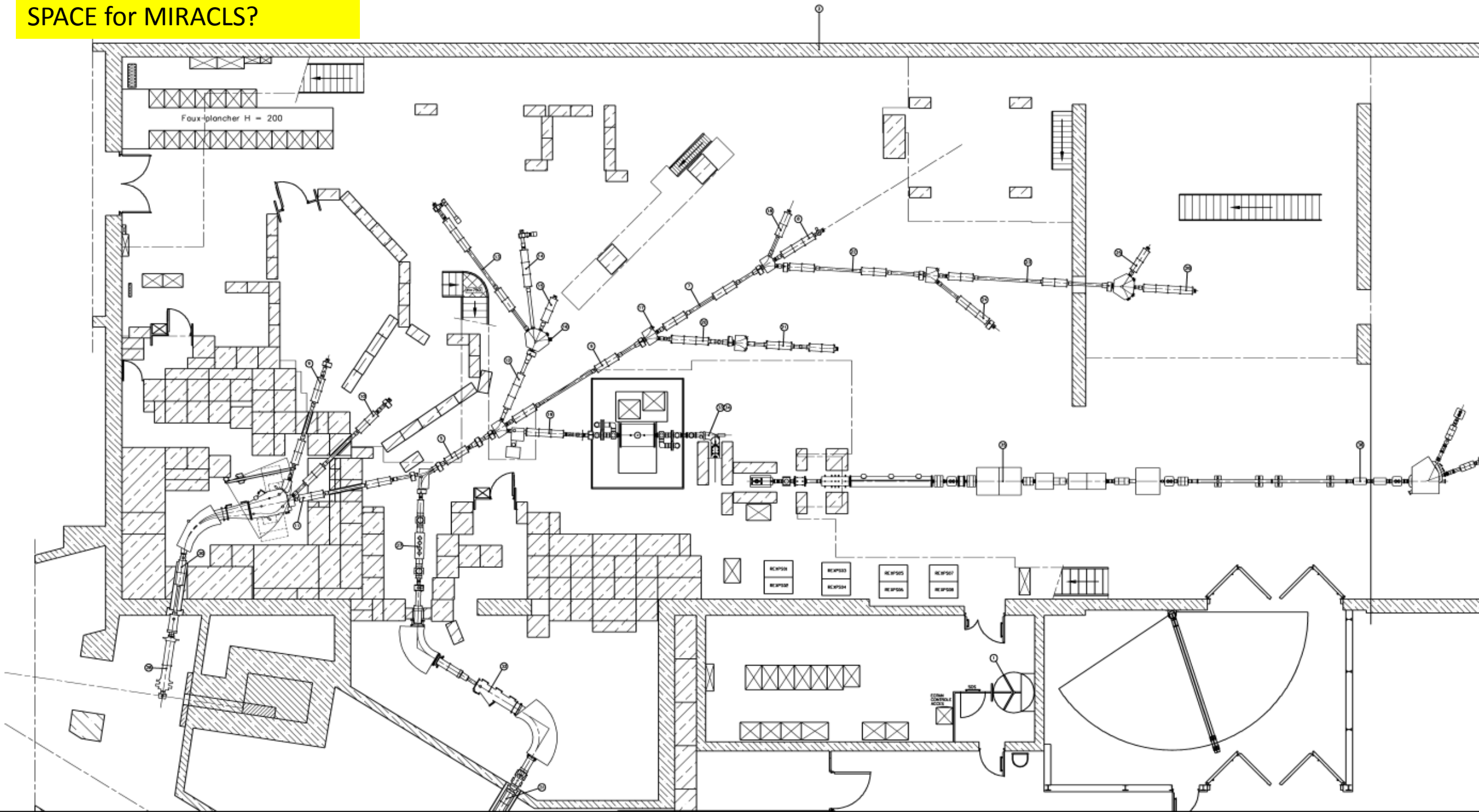



WISARD

REVERSIS

CRIS platform?

CRIS

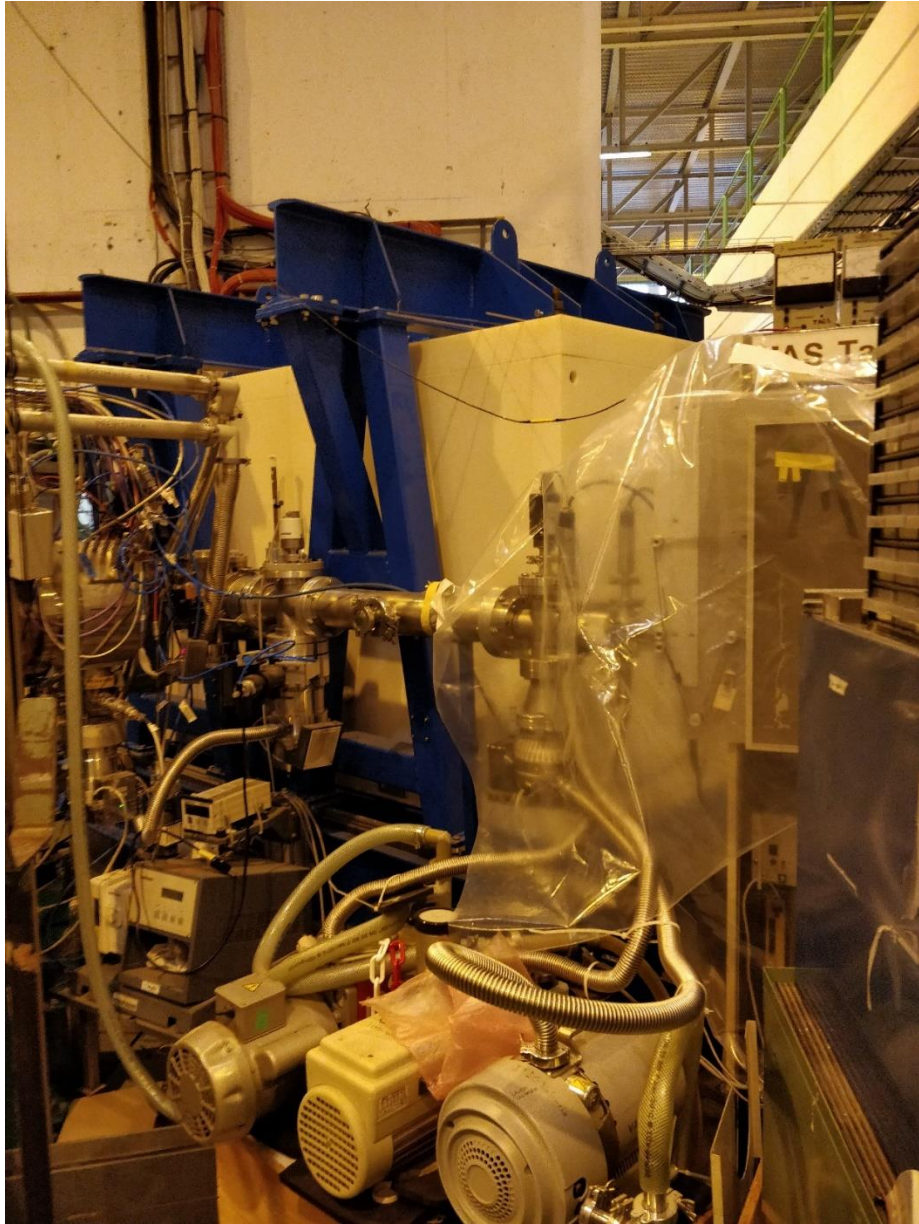

TAS/Lucretia

No current experiments (since RB in September)

Technical modifications needed for future running.

Collaboration are discussing future plans.

Space which could be used for new or expanded setups...

Other space which could be used?

Old control room?

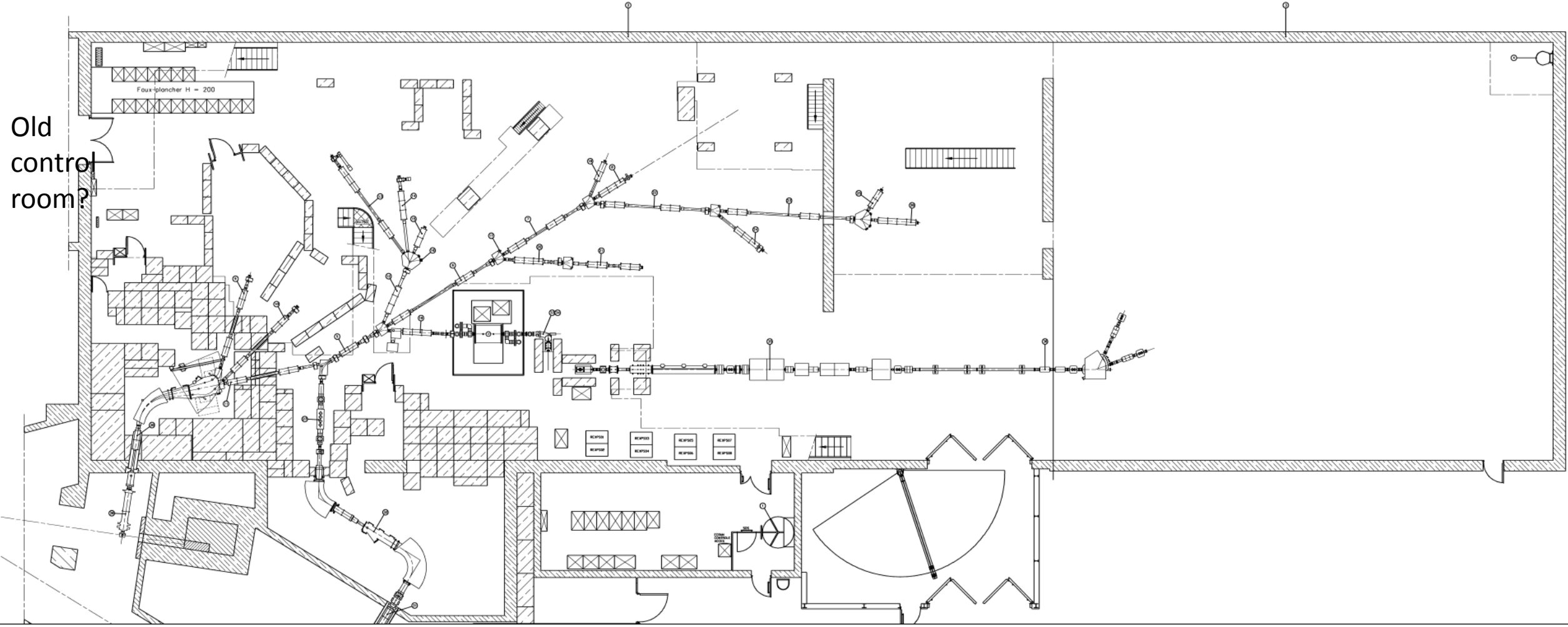

Space currently occupied by equipment which should be cleaned up in 2019



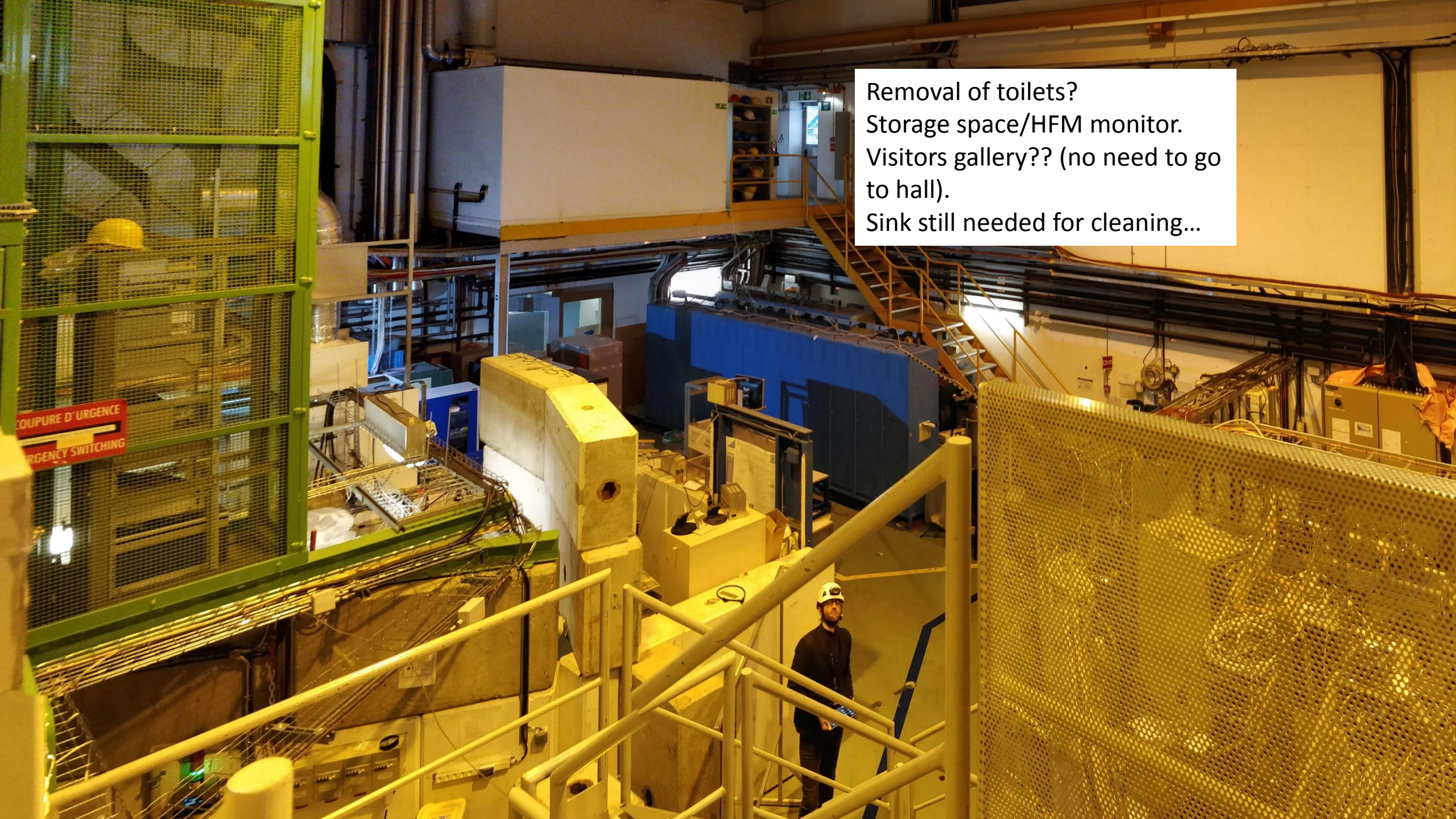

Removal of toilets?
Storage space/HFM monitor.
Visitors gallery?? (no need to go to hall).
Sink still needed for cleaning...

COUPURE D'URGENCE
EMERGENCY SWITCHING