

12th International “Hiroshima” Symposium on the Development and Application of Semiconductor Tracking detectors (HSTD12)

International Conference Center Hiroshima, Hiroshima, Japan, Dec. 15-18, 2019

KEY DATES:

Abstract submission: 15 July - 2 Sep.

Registration: 15 July - 15 Oct. (Early) - 15 Nov.

<https://indico.cern.ch/event/803258/>

For further information – email: hstd@ml.post.kek.jp



TOPICS:

Simulations

Technologies

Pixel and Strip Sensors

Radiation Tolerant Materials

ASICs

Large Scale Applications

Applications in Biology, Astrophysics, Medicine, ...

New Ideas and Future Applications

International Advisory Committee:

P. Allport (Univ. Birmingham, UK)

N. Cartiglia (INFN Torino, Italy)

M. Garcia-Sciveres (LBNL, Berkeley, US)

G. Hall (Imperial College, London, UK)

S.C. Lee (Academia Sinica, Taipei, Taiwan)

T. Ohsugi (Hiroshima Univ., Japan)

A. Seiden (Univ. California, Santa Cruz, US)

T. Takahashi (Univ. Tokyo, Kashiwa, Japan)

Local Organizers:

Y. Fukazawa (Chair, Hiroshima)

T. Mizuno (Hiroshima)

T. Ohsugi (Hiroshima)

H. Takahashi (Hiroshima)

Y. Unno (KEK)

Organizing Committee:

Y. Fukazawa (Hiroshima)

S. Hou (Academia Sinica)

X. Lou (IHEP)

H. F.-W. Sadrozinski (UC Santa Cruz)

Y. Unno (Chair, KEK)

Sponsors & Supporters:

Hamamatsu Photonics

Hiroshima Univ.

Hayashi-Repic, Acrorad

SOI Consortium

C&A



Welcome
to 12th Hiroshima Symposium
(HSTD12)

The Symposium is made possible by all
contributions. First of all, you

the participants

Then ...

The organizers

International Advisory Committee:

P. Allport (Univ. Birmingham, UK)
N. Cartiglia (INFN Torino, Italy)
M. Garcia-Sciveres (LBNL, Berkeley, US)
G. Hall (Imperial College, London, UK)
S.C. Lee (Academia Sinica, Taipei, Taiwan)
T. Ohsugi (Hiroshima Univ., Japan)
A. Seiden (U. California, Santa Cruz, US)
T. Takahashi (Univ. Tokyo, Kashiwa, Japan)

Organizing Committee:

Y. Fukazawa (Hiroshima)
S. Hou (Academia Sinica)
X. Lou (IHEP)
H. F.-W. Sadrozinski (UC Santa Cruz)
Y. Unno (Chair, KEK)

Local Organizers:

Y. Fukazawa (Chair, Hiroshima)
T. Mizuno (Hiroshima)
T. Ohsugi (Hiroshima)
H. Takahashi (Hiroshima)
Y. Unno (KEK)

Sponsors & Supporters:

Hamamatsu Photonics
Hirhosima Univ., CORE-U
Hayashi-Repic
Acrorad
SOI Consortium
C&A

... and more

Support from City of Hiroshima

- We appreciate the support of the city/citizens of Hiroshima
 - through “Hiroshima Convention bureau”
 - Financial support
 - “Kagura” dancing as an entertainment in the banquet
 - Free admission to the peace memorial museum, and
 - Welcome message from the mayor

December 15, 2019



Dear the 12th International "Hiroshima" Symposium on the Development and Application of Semiconductor Tracking Detectors (HSTD12) participants,

It is my great pleasure to welcome you to Hiroshima upon the occasion of the 12th International "Hiroshima" Symposium on the Development and Application of Semiconductor Tracking Detectors (HSTD12).

As I am sure you are aware, Hiroshima is known across the globe as a place of peace. People from all corners of the world visit Peace Memorial Park, where UNESCO World Heritage site the Atomic Bomb Dome stands as a symbol of Hiroshima. Their kind offerings of flowers and paper cranes at the Cenotaph for the A-bomb Victims and the Children's Peace Monument are unending. Being held here in Hiroshima, I believe that the impact of this symposium will be amplified in several ways, such as through wider coverage of outcomes and results.

Hiroshima City has prospered for the past 400 years. Initially a castle town, our city has developed into one of western Japan's core cities for industry, the economy, and administration. We are blessed with temperate climates and an abundance of nature, and are known as the "City of Water" for the six rivers that flow through our city. These six rivers create stunning cityscapes which are best enjoyed from aboard a pleasure boat river cruise or from one of our many riverside open-air cafes. These views change with the passing of the seasons, and never fail to impress residents and tourists alike.

Here in Hiroshima, I hope you all experience hospitality like no other. Please enjoy our rich natural sites and cityscapes, food culture, and local traditional performing arts, among so much more our city has to offer. Moreover, it is my earnest wish that you will also share in Hiroshima's enduring wish for peace which I believe former U.S. President Barack Obama and Pope Francis took to heart during their historic visits to our city in May 2016 and November this year respectively. I sincerely hope that Hiroshima becomes a city which you will want to visit again and again.

In closing, I would like to offer my very best wishes for the success of this symposium, and for the health and prosperity of everyone involved.

Sincerely yours,



MATSUI Kazumi
Mayor
The City of Hiroshima

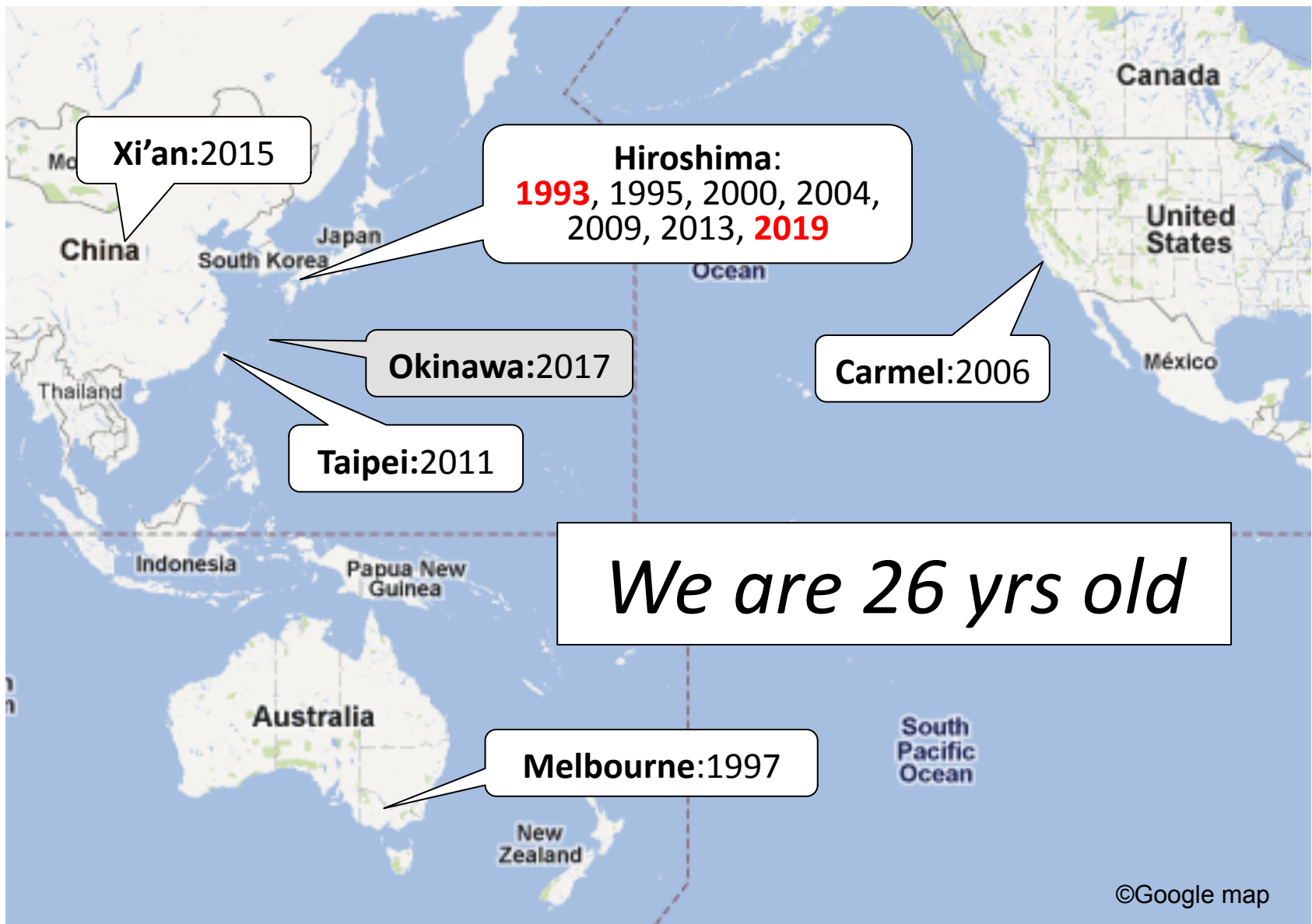

“Hiroshima” sympo around the Pacific rim, every 2-3 yrs, alternating Hiroshima and outside, in tradition...

HSTD12 - Logistics

Y. Unno, Y. Fukazawa, T. Mizuno, H.
Takahashi
Local Organizers

Garbage Disposal

- No garbage box in the building
 - Participants should use LOC-prepared garbage bags (at several places, e.g. Coffee/Tea/Poster rooms).
- Three garbage bags:
 - Combustible: Raw garbage, Paper garbage ...
 - Incombustible: Plastics in general...
 - Recyclable: Bottles (PET, Glass)、Cans (Al, Steel) ...
- Last words:
 - NO LITTER, please.

Garbage separation

From Hiroshima city

1. Burnable

- Food waste
- paper

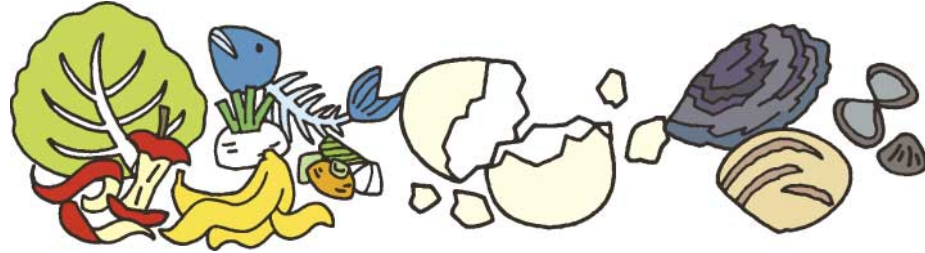

2. Unburnable

- Plastic
- **Cap** of PET bottle
- **Label** of PET bottle

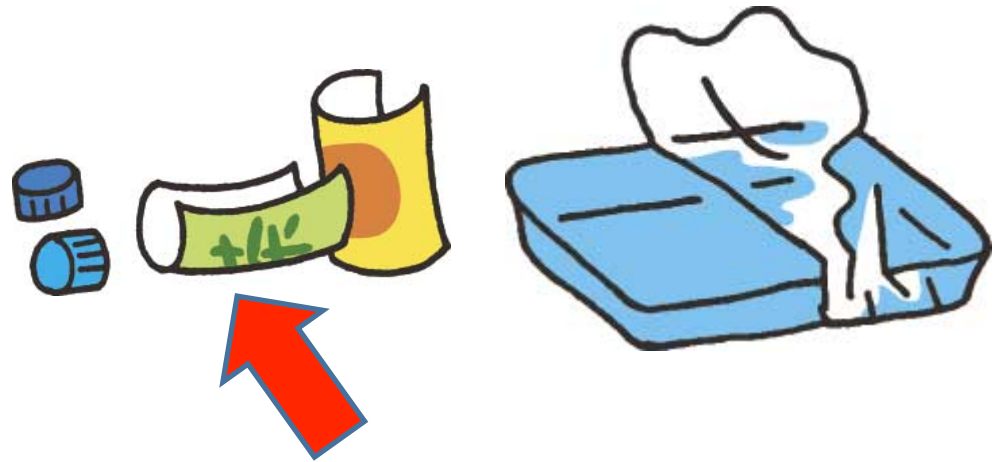

3. PET, Can

- Only bottle body
- Can



NO-Smoking

- Please pay attention
 - The whole park, including all buildings, is NO-Smoking.
 - Smoking is only allowed in one dedicated area in B1F floor in this building.

Venue (Opens at 8:30)

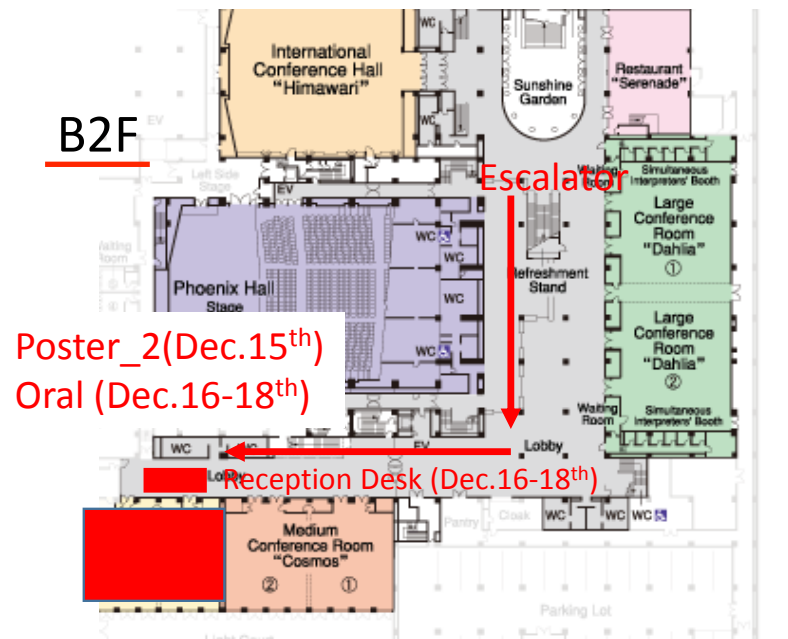
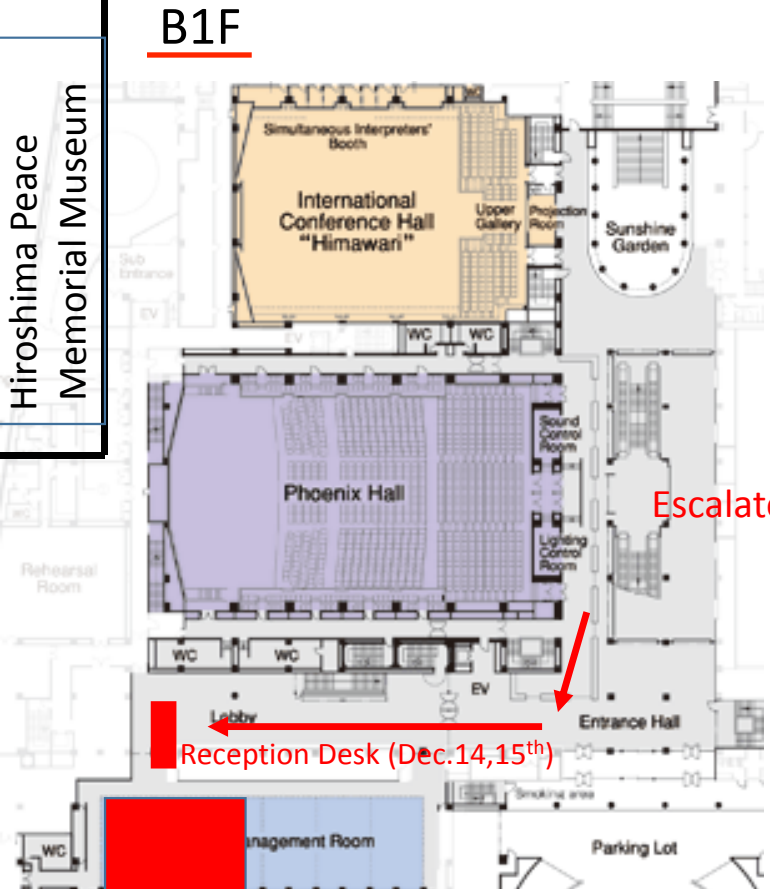
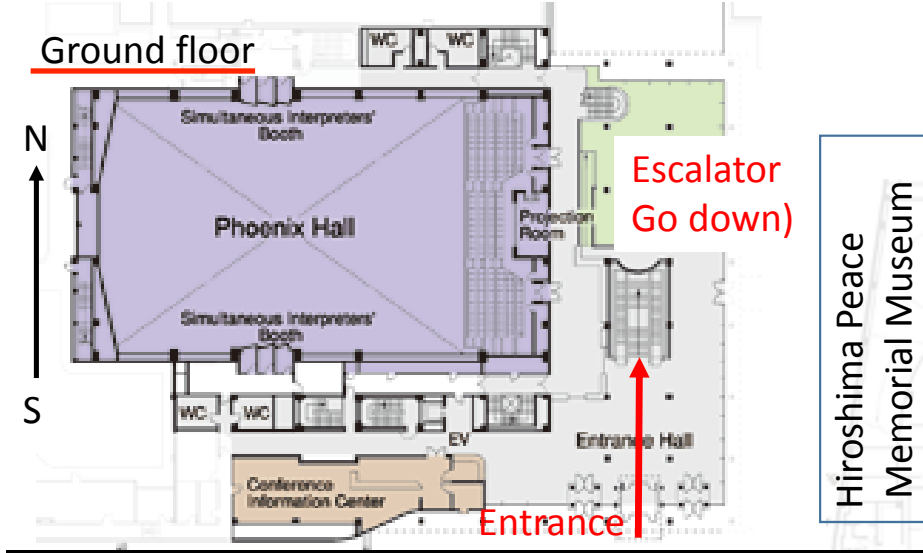

Reception food/drink (Dec. 14th)
Oral, Poster_1 (Dec. 15th)
Poster (Dec. 16-18th)

Schedule (in general)

	14 th (Sat)	15 th (Sun)	16 th (Mon)	17 th (Tue)	18 th (Wed)
(8:30-9:00)		Building open Registration#2 (9:00-12:30)	Building open	Building open	Building open
(9:00-10:40) AM1		Session1 (B1F M. rooms#4-6)	Session5 (B2F RAN)	Session7 (B2F RAN)	Session11 (B2F RAN)
(10:40-11:20) Coffee break & POSTER session		Coffee & POSTER (POSTER posting) (B1F M. room#3 + B2F RAN1/2)	Photo/Coffee & POSTER (Even# to standby) (B1F M. rooms#5-6)	Coffee & POSTER (Odd# to standby) (B1F M. rooms#5-6)	Coffee & POSTER (B1F M. rooms#5-6)
(11:20-12:40) AM2		Session2	Session6	Session8	Session12
(12:40-14:20) Lunch		Lunch & POSTER	Excursion(*)	Lunch & POSTER	Lunch & POSTER (removal)
(14:20-16:00) PM1		Session3	Excursion(*)	Session9	Session13
(16:00-16:40) Tea break & POSTER session		Tea & POSTER (Odd# to standby)	Excursion(*)	Tea & POSTER (Even# to standby)	Adjourn
(16:40-18:00) PM2		Session4	Excursion(*)	Session10	
(18:00-21:00) Evening	Welcome party Registration#1 (B1F Meeting rooms#5-6)	POSTER (free time) Transfer (19:00) to B1F M. rooms#5-6	POSTER (free time)	Symposium Banquet (Bunka Koryu Kaikann)	

(*)The session room will be “locked” while we are in Excursion. You can leave your bags.

A Few Remarks

- The building opens at 8:30
- Posters shall be posted at the 1st coffee/tea/poster break on 15th Dec.
- Poster rooms are different on 15th and the rest
 - 15th: Meeting room#3 (B1F) AND RAN(1/2) (B2F)
 - the rest (16th-18th): Meeting rooms#5-6 (B1F)
 - Transfer of the poster boards are taken care by the organizers, at 19:00 on 15th.
- Posters are available until 21:00 on 15th and 16th
 - Join till your dinner break or even after dinner !!
 - You can bring your own refreshments
 - You can get from a vending machine on the ground floor or at a convenience store (Lawson, 260 m south).
 - Don't forget to trash your garbage into LOC-prepared garbage bags.
- An English guidance is available on 3rd and the last day
 - for local attractions, sightseeing, and else
 - near the poster rooms (B1F, Meeting rooms#5-6)
- Lunches & Dinners
 - Your adventure into the town
 - A restaurant guide is in your kit and in the next page

Restaurant Guide



- 1) Hazeya
- 2) かんらん車
- 3) Okonomimura
- 4) 大丸堂
- 5) こひなた
- 6) Oyster ship Kanawa
- 7) Starbucks
- 8) DOUTOR Hiroshima Hondori Shop
- 9) くにあつ 中電前店
- 10) dali
- 11) SocialBookCafeハチドリ舎
- 12) Subway
- 13) 45 | キャラントサンク
- 14) 陽気 大手町店
- 15) 和華
- 16) 唐人楼
- 17) Ichiran Hiroshima Hondori shop
- 18) まいどおおきに 広島袋町食堂店
- 19) Cafe Ponte
- 20) にぎり座
- 21) TULLY'S COFFEE Hiroshima Hondori Shop
- 22) Kurashiki Coffee
- 23) Park South Sandwich
- 24) Obscura Coffee Roasters
- 25) Mister Donut
- 26) KFC
- 27) McDonald's
- 28) Tsukemen Karabu Tokaichimachi
- 29) 炭焼ダイニング WA
- 30) Ita Soba Kaoriya
- 31) 旬の肴と炙り 月あかり



A great job by students 😊

Vegetarian: <http://www.ttb.mlit.go.jp/chugoku/content/000044336.pdf>

Halal: <http://www.ttb.mlit.go.jp/chugoku/content/000044332.pdf>

WiFi information

- **Conference room:**
 - SSID: icch-wifi
 - Password: icch2427777
- **Lobby:**
 - SSID: icch-free
 - Password: icc-h

Copy, Fax, Print

- Self-service at the information/office on the ground floor
- With fee
 - Copy: per side, B5/A4/B4/A3, B&W/10 JPY, Color/50 JPY
 - Fax: sending per page, 50 JPY (domestic), 100 JPY (international), receiving per page, 10 JPY
 - Print: per side, B&W/10 JPY, Color/50 JPY, use your own PC

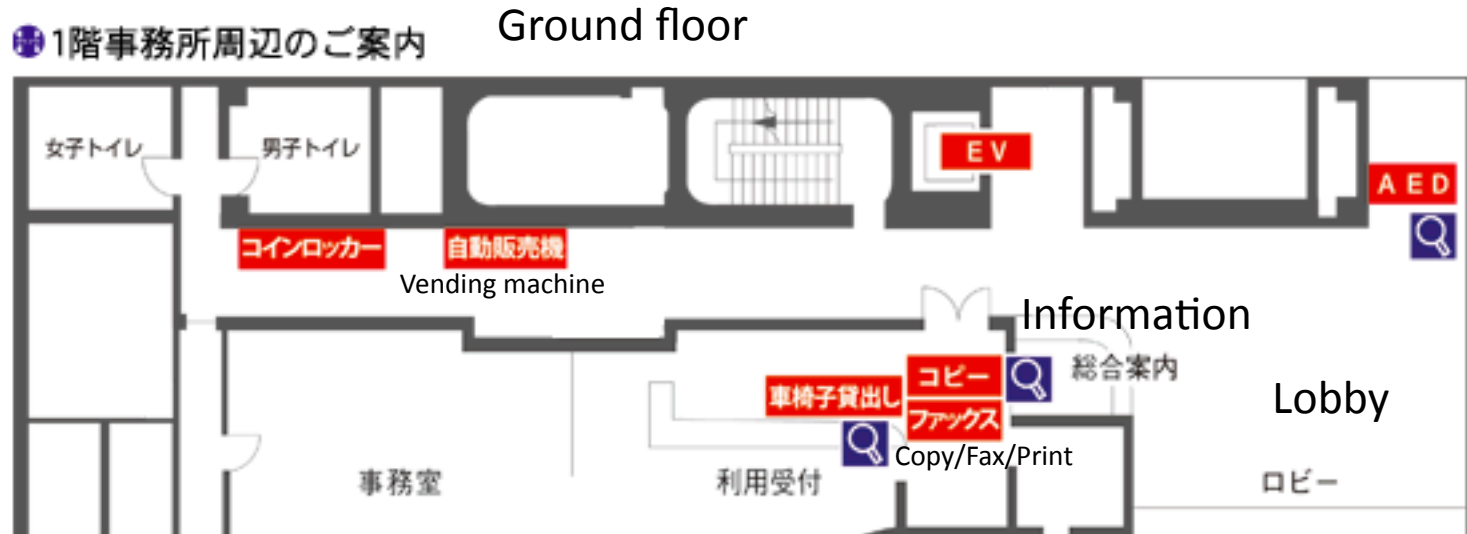

A Print Shop

- In case you have to print your poster (A0),
- A print shop is available, “Office24Kamiyacho”, “Kinko’s Heiwa-to-ori-ten”, ...

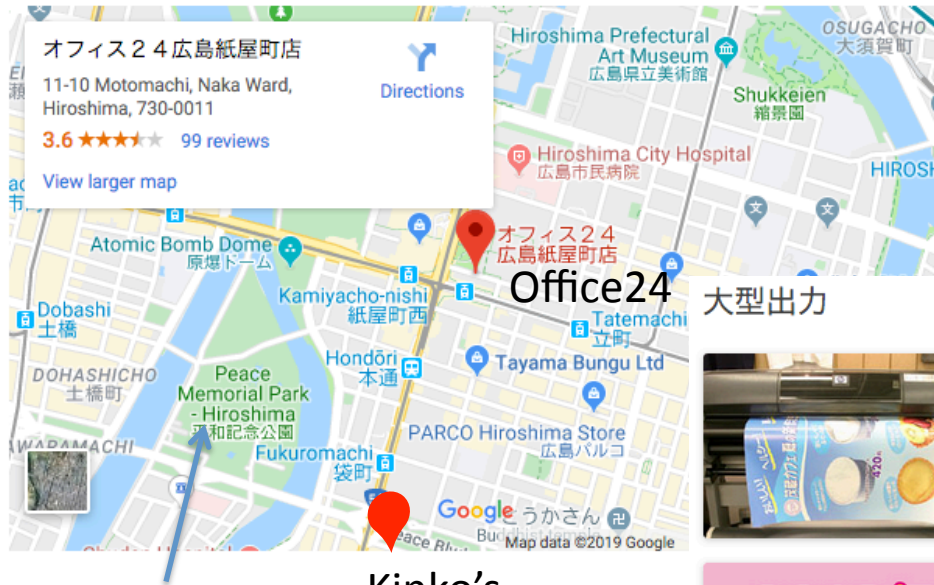

Office24 大型出力



- ▶ 店舗スタッフがお客様のデータをお預かりして、ご注文通りに作業します。
- ▶ モノクロ、カラーともにボリュームディスカウントがあります。
- ▶ 大判出力サービスには1ファイルにつき出力基本料金600円(税別)が別途必要となります。

Office24

Fee: One A0 poster might cost 50 euro...

Kinko's

We are here

2018年9月2日から料金に変更になります。

大判出力 ※2~9枚...10%OFF 10~19枚...15%OFF 20枚以上...20%OFF (同じデータを出力した時に限ります)

	用紙	B0	A0/B1	A1/B2	A2以下
モノクロ	コート紙	3,500円	2,587円	1,467円	767円
	光沢・半光沢紙	3,500円	2,587円	1,467円	767円
カラー	コート紙	7,000円	5,000円	3,000円	1,500円
	半光沢紙	8,500円	6,000円	3,500円	1,700円
	光沢紙	9,400円	7,334円	4,200円	2,100円

Excursion from 13:00 on Dec 16th (Mon)

Miyajima: <http://www.miyajima.or.jp/english/index.html>

Schedule

13:00 leave conference hall by bus

lunch (delivered sandwich+water) on bus

13:40 arrive Miyajima parking area

(1) 13:50 ferry

14:00 Miyajima island

(2) 14:30 enter Itsukushima shrine

Free time (shopping, other temples, etc.)

(3) 17:00 meet at entrance of ferry terminal

(See left bottom of next page)

17:30 leave Miyajima parking area

18:30 dismiss at conference hall (may delay due to traffic jam)



At (1), (2) and (3), LOC deliver a ticket for ferry/shrine.
If you miss especially (3), we will leave without you.

LOC phone: 090-4366-3858

+81-90-4366-3858

Enjoy excursion on Dec. 16th



Banquet at 19:00-21:00 on Dec 17th (Tue)

Place: **Bunka Koryu Kaikan**
文化交流会館

500 m (~6 mins) south
from conference hall.

We can leave together
from conference hall at **18:30**.

There is Kagura show 神楽
(Japanese traditional dance)
during banquet.

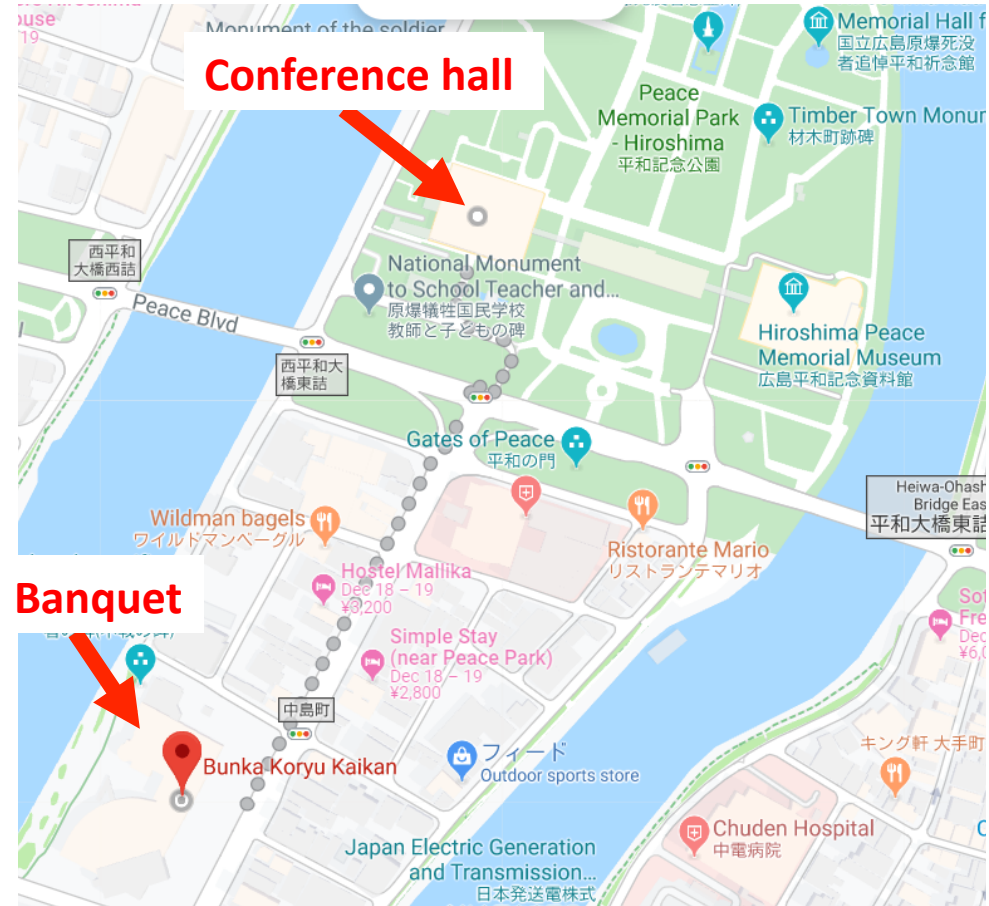

Dinner on Dec. 17th

Enjoy “Kagura”



Other Point-of-Interests

- There are two places in this park...
- Hiroshima Peace Memorial Museum
 - <http://hpmmuseum.jp/?lang=eng>
 - Admission: Free with your name tag
 - Opening hours: 8:30-17:00
- Hiroshima National Peace Memorial Hall for the Atomic Bomb Victims
 - <https://www.hiro-tsuitokenkan.go.jp/english/index.php>
 - Admission: free
 - Opening hours: 8:30-17:00

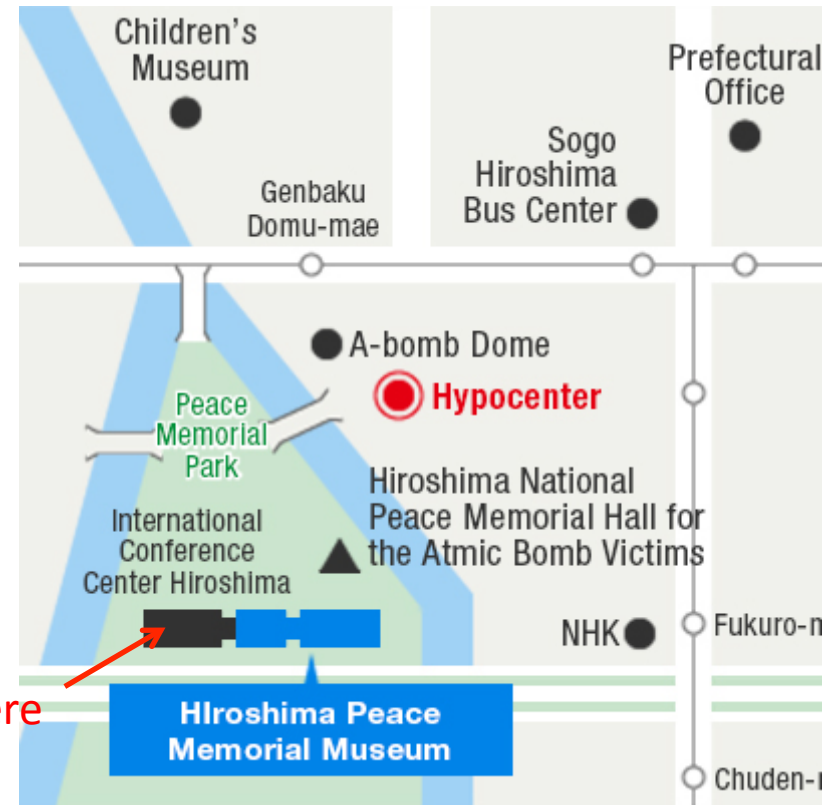

Enjoy local food



Hiroshima-style
Okonomi-yaki

おこのみやき
お好み焼き



Oyster
カキ／牡蠣



穴子／あなご
Anago-Meshi

Enjoy the symposium,
maximally 😊

The organizers

Backup

Miyajima Guide Map

WiFi Spot

- Men's Western style toilet
- Men's Japanese style toilet
- Woman's Western style toilet
- Woman's Japanese style toilet

Mt. Misen Observatory
Opening hours
10:00~16:00



Misen Climbing Path (Momijidani Course)
Approx. 1.5 hr walk from Momijidani Park

Misen Climbing Path (Daishoin Course)
Approx. 1.5~2 hr walk from Daishoin Temple

Itsukushima shrine

Meet at 17:00

- WC
- Men's Western style toilet
- Men's Japanese style toilet
- Woman's Western style toilet
- Woman's Japanese style toilet

- ATM
- Bank
- Post Office
- Police Station
- Clinic
- Community Center
- Commerce and Industry Hall
- Yamabe Path
- Uguisu Nature Walk
- Zonkoji Temple
- Tokujuji Temple
- Nagahama Shrine
- Miyajima Traditional Crafts Center
- Ferry Terminal
- Tourist Information
- World Cultural Heritage Monument
- The Three Most Scenic Spots of Japan Monument
- Taira no Kiyomori Statue

