



# TCLMs Masks

## HiCoIDEM

E. Berthomé, L. Gentini



**EN** Engineering Department

October 31<sup>st</sup>, 2019

# TCLMs Masks design

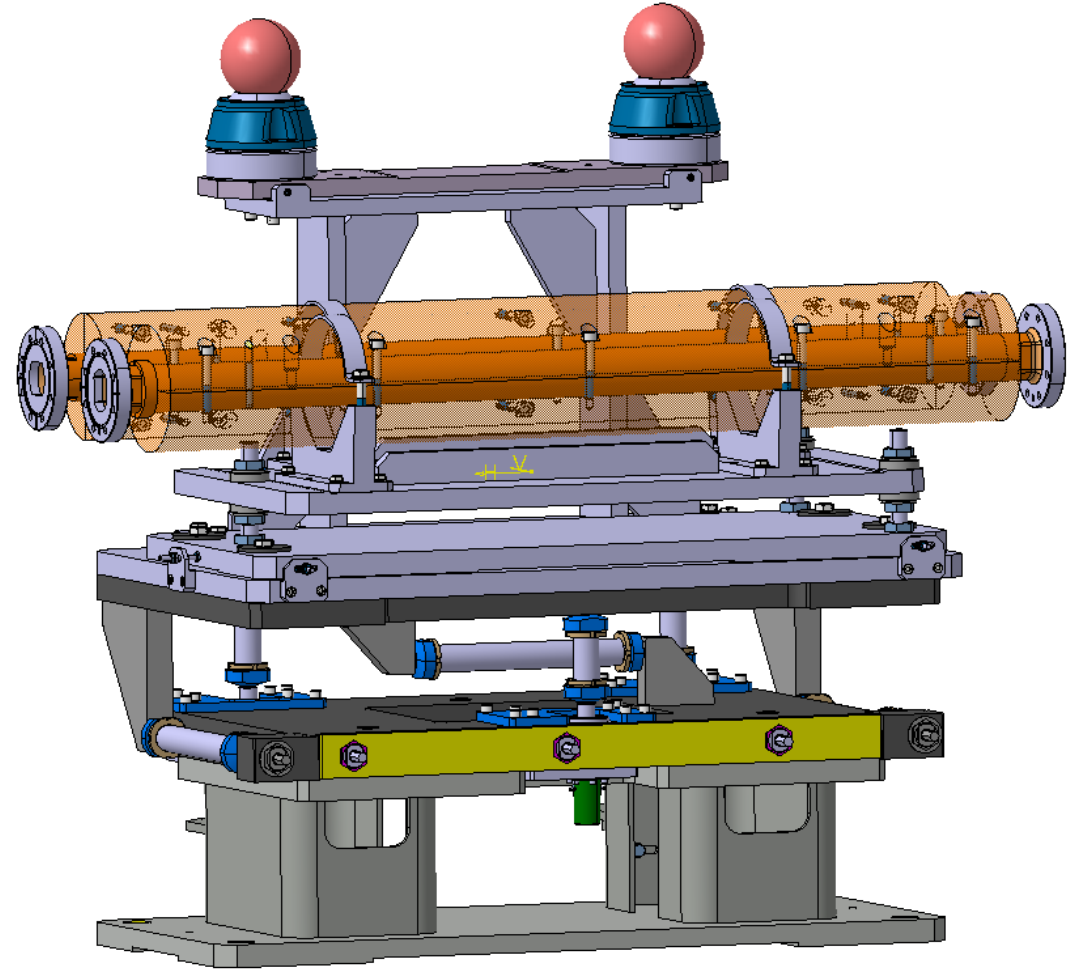
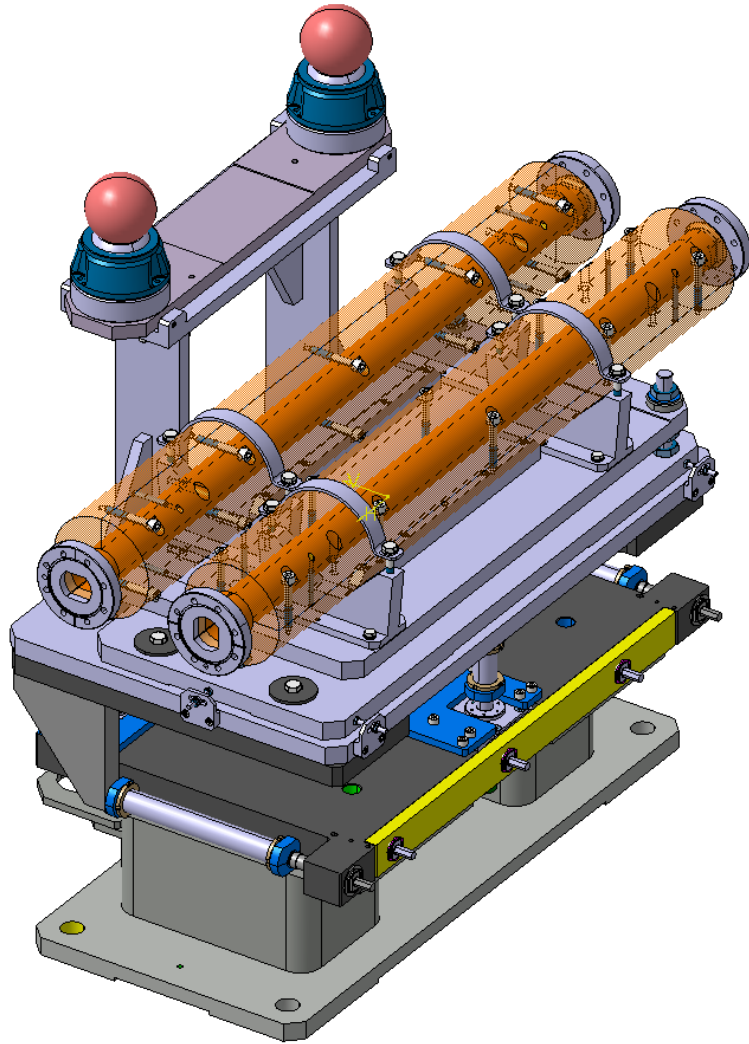

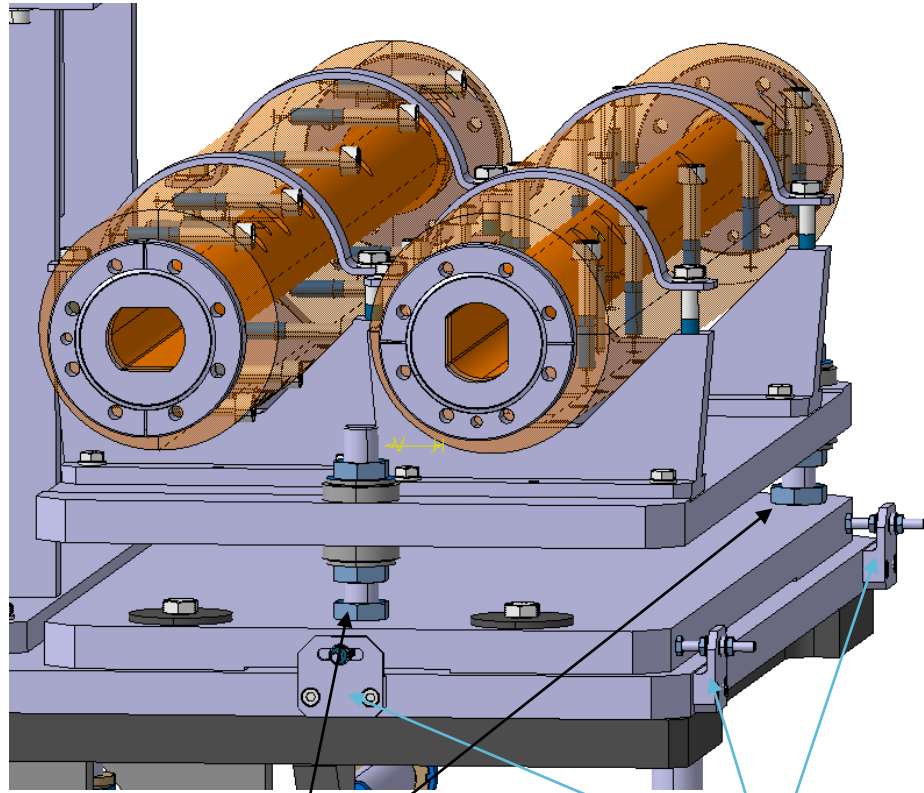

Tilt adjustments

Independent adjustments

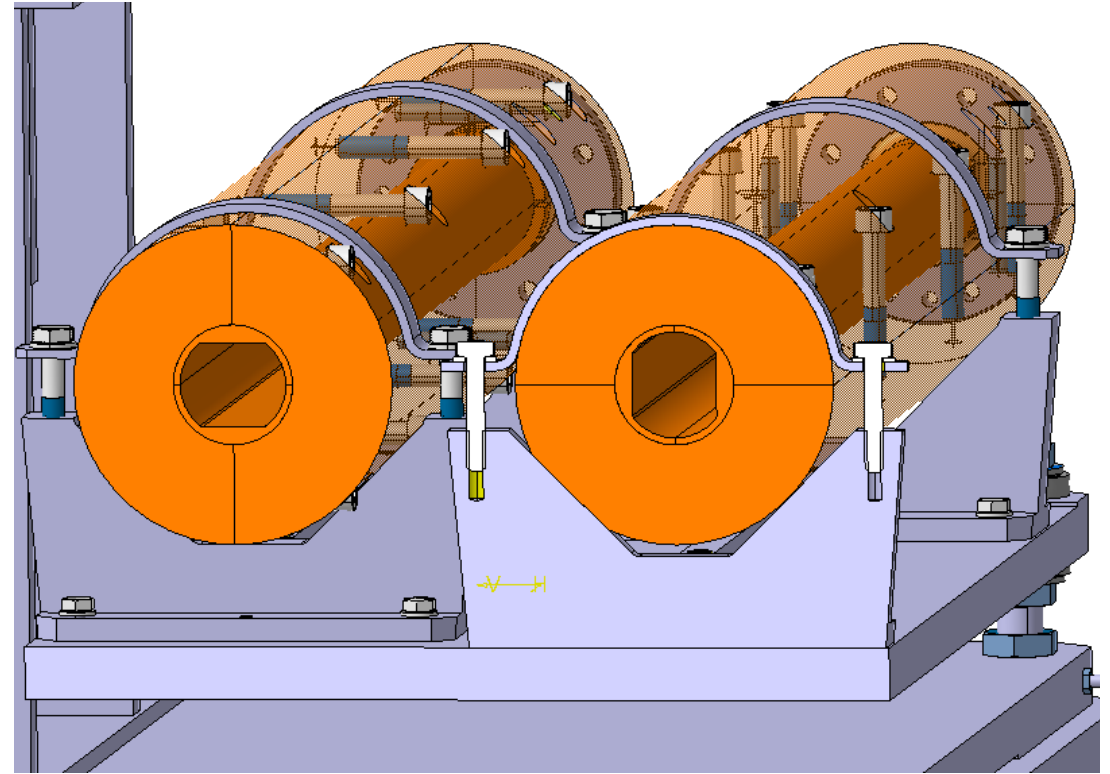

# Mask design sol.1 : Compatible with W and Cu masks

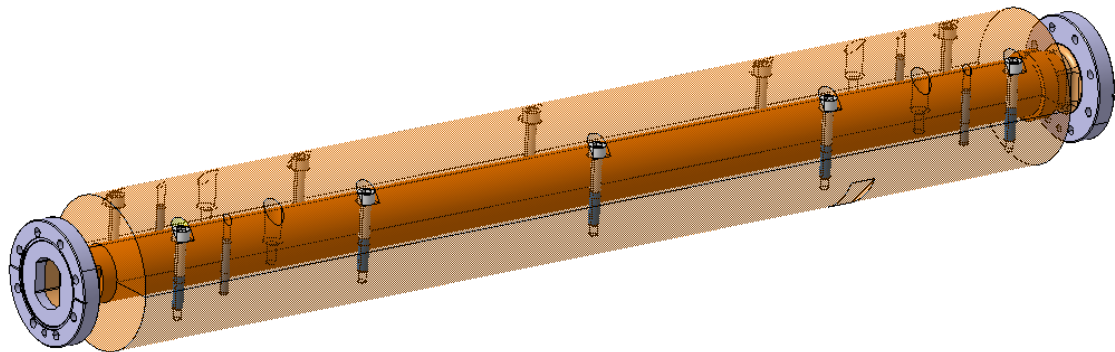

+ :  
-> Compatible with W and Cu masks

- :  
-> A lot of machining and process operations  
-> Very long-time machine for 12 equipment  
-> Position of inner chamber with outer reference not very precise

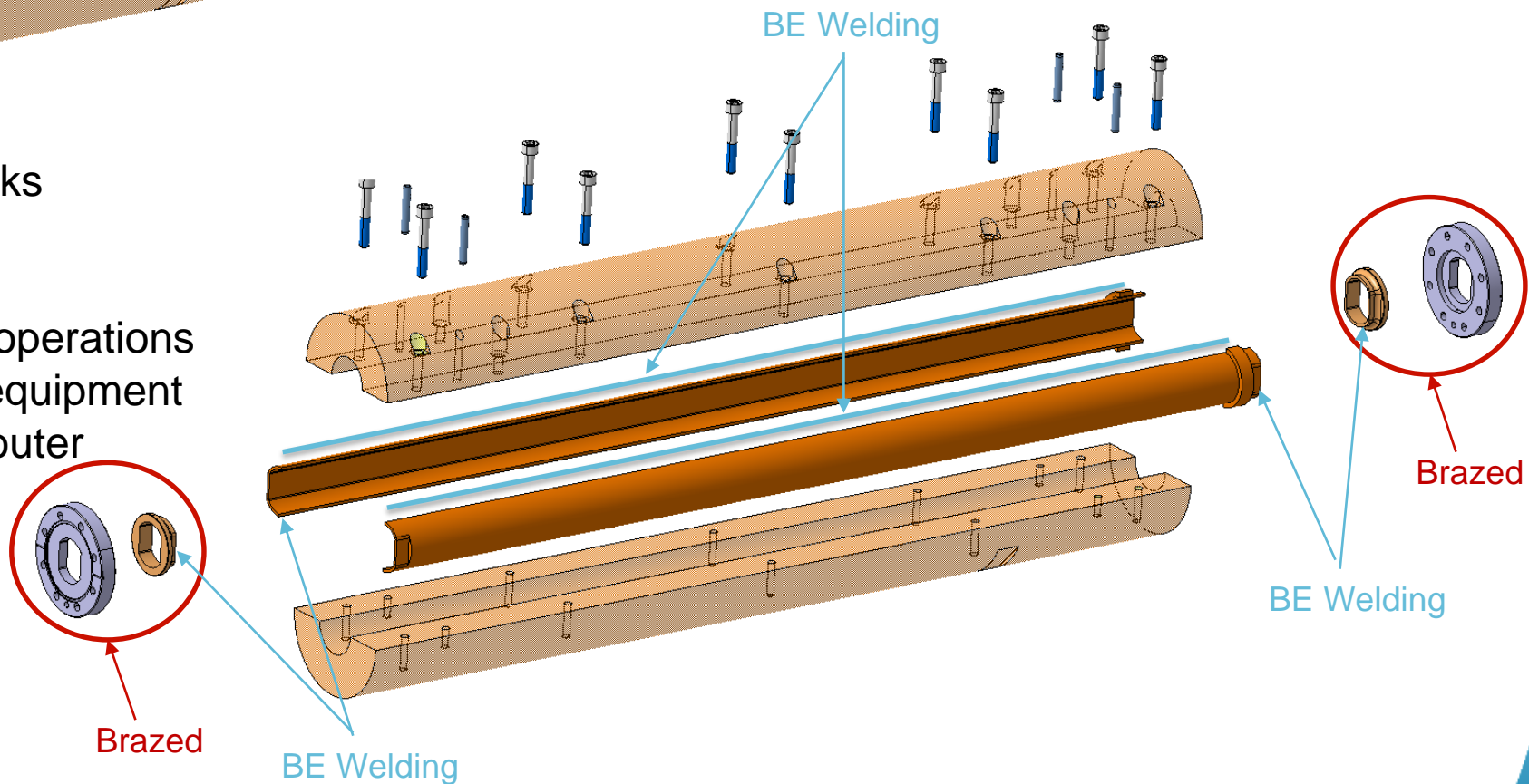



# Mask design sol.1 :

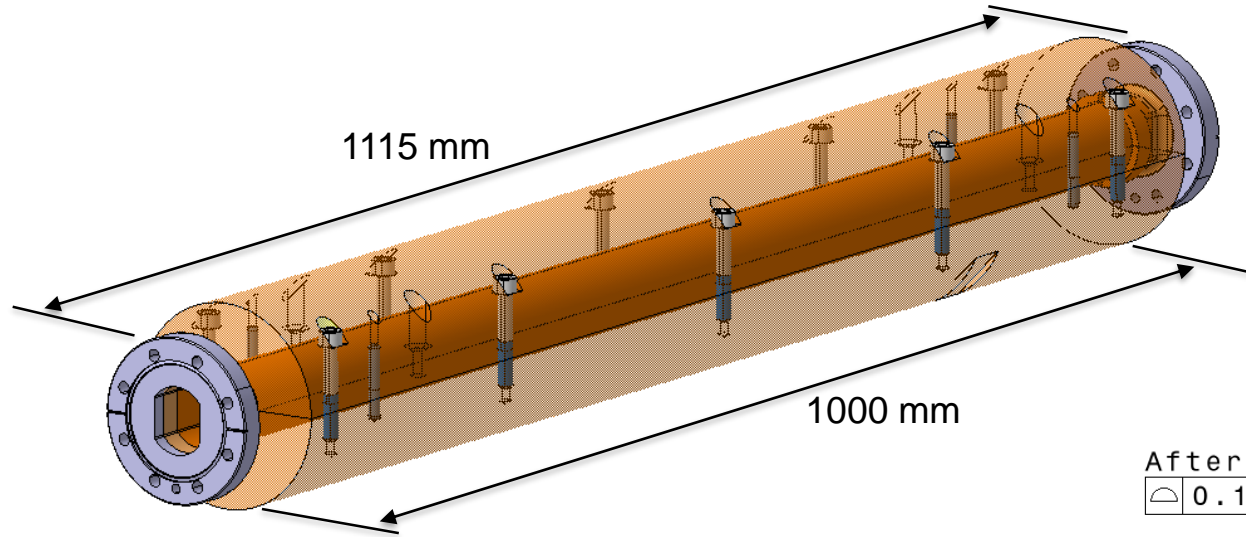

Nota: Same design but the half mask separated in several parts in the 1m long could be made.

-> 333mm long blocks allow turning machining of inner diameter = Little bit more precise

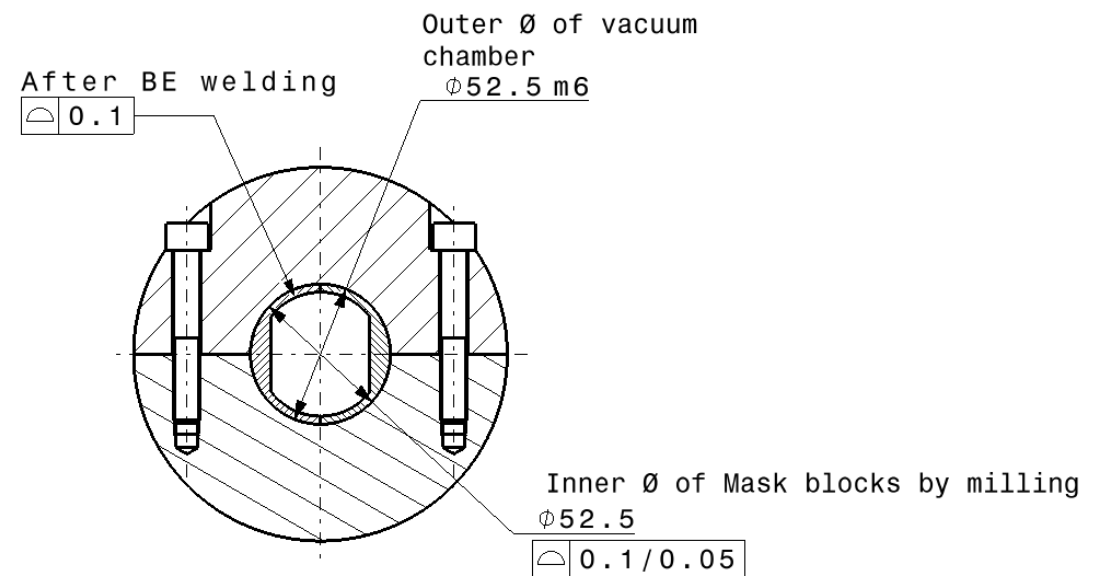

# Mask design sol.2 : 2x half Cu chamber brazed

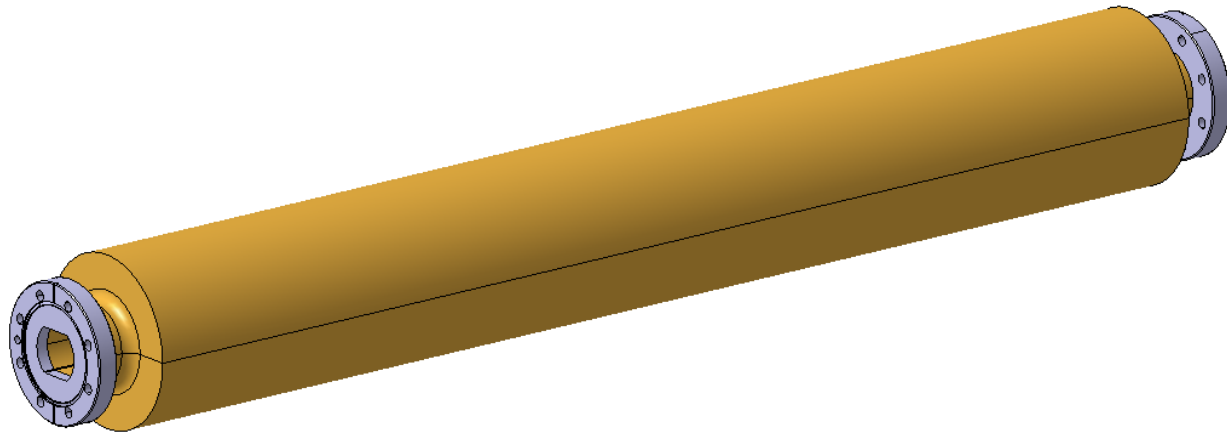

+:

- > Less raw material (~ -30%)
- > Less machining and process operation

-:

- > Only for Copper masks
- > Vacuum leaking obtained by brazing

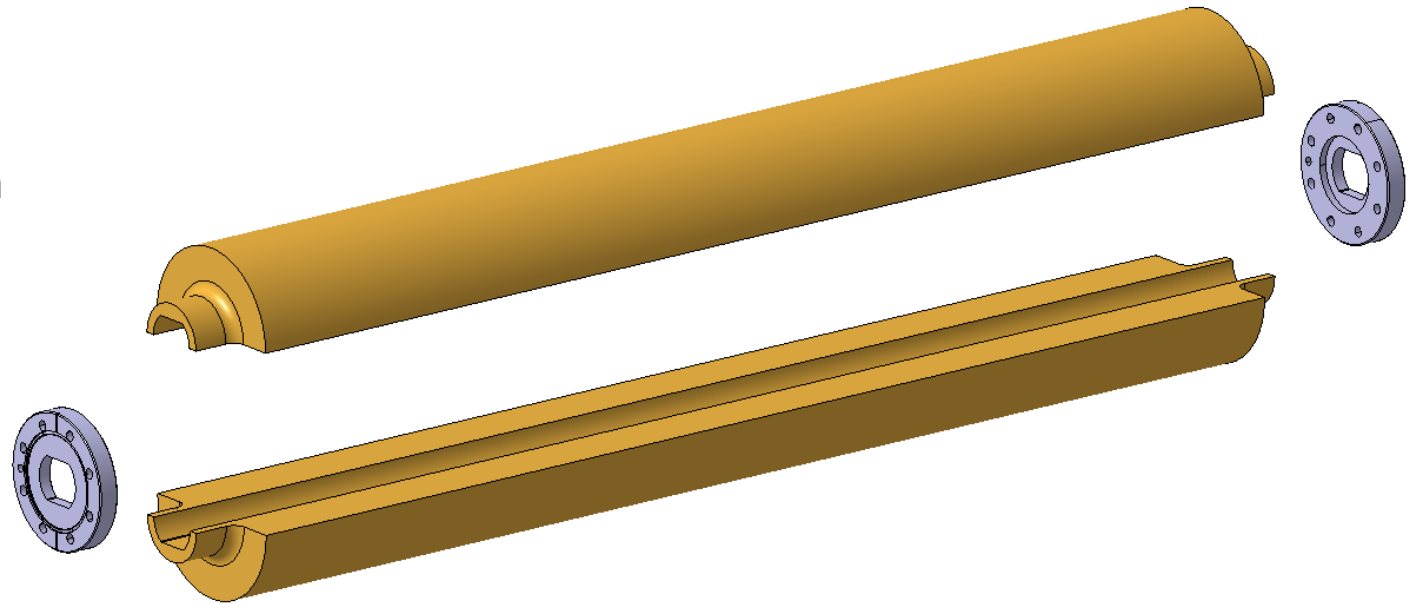

# Mask design sol.3 : 2x half Cu chamber BE welded

