

# Baby MIND readiness for 2020 beam

E. Noah

10 January 2020

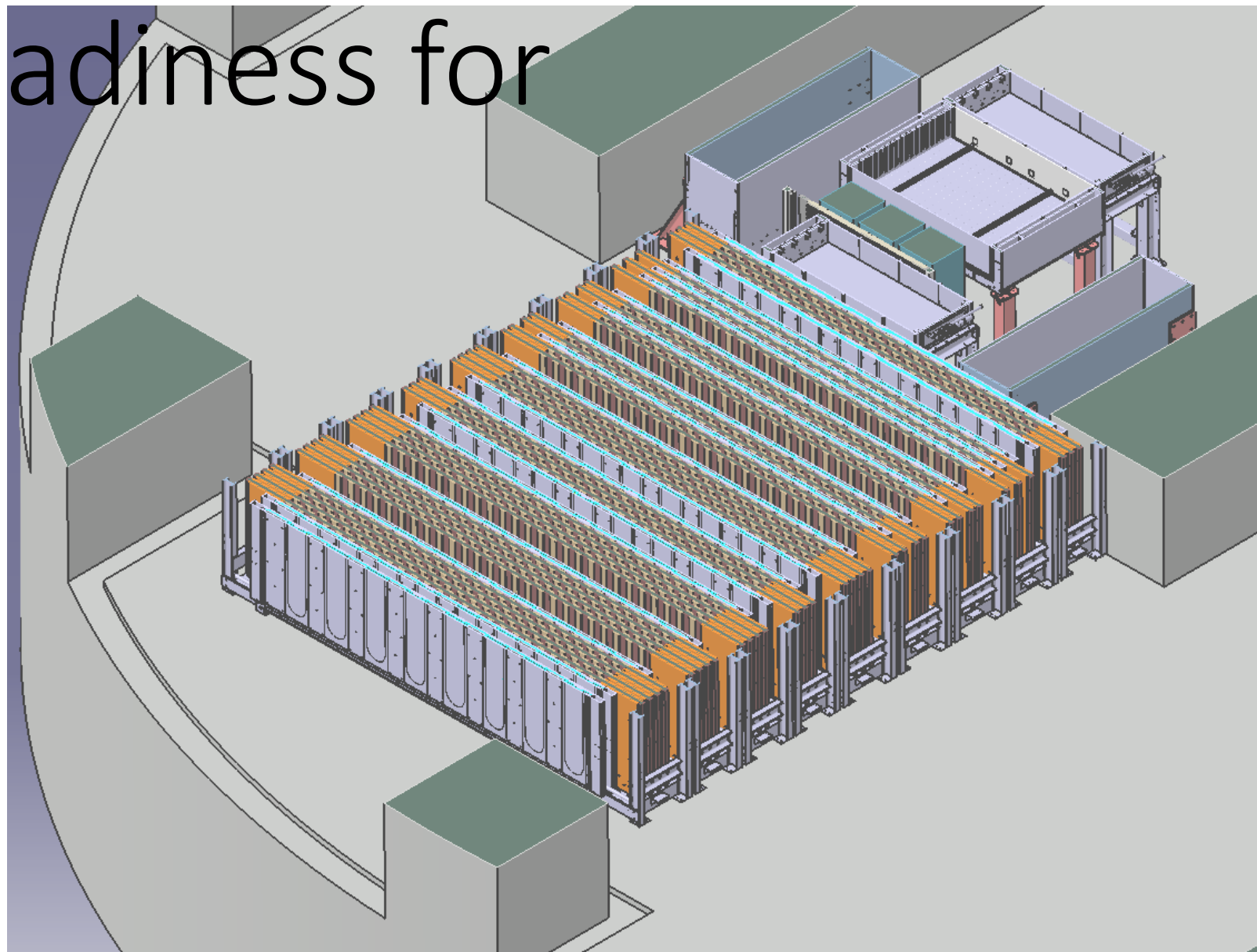



- Beam schedule
  - ON: 14<sup>th</sup> January
  - OFF: 10<sup>th</sup> February (TBC)
- Updates on hardware and data taking
  - Schedules for switching ON detector and magnet
  - DAQ updates (recent issues)
  - Calibration
  - Procedures (documentation, shift leader duties etc...)
  - Baby MIND expert shifter availability
- Analysis
  - Pre-processing of data (unpacking)
  - Data structure
  - Simulation framework
  - Baby MIND input for neutrino interactions in WAGASCI
  - Neutrino interactions in Baby MIND