

# Brainstorming on VLE – HE considerations

N. Charitonidis (CERN, EN-EA) and C. Mussolini (CERN & Univ. Oxford)

With lots of info/feedback from Y. Nagai, E. Zimmermann & NA61 colleagues



# Low Energy Line Layout

- The exact layout of the line is being studied. In case of a 4-B achromat

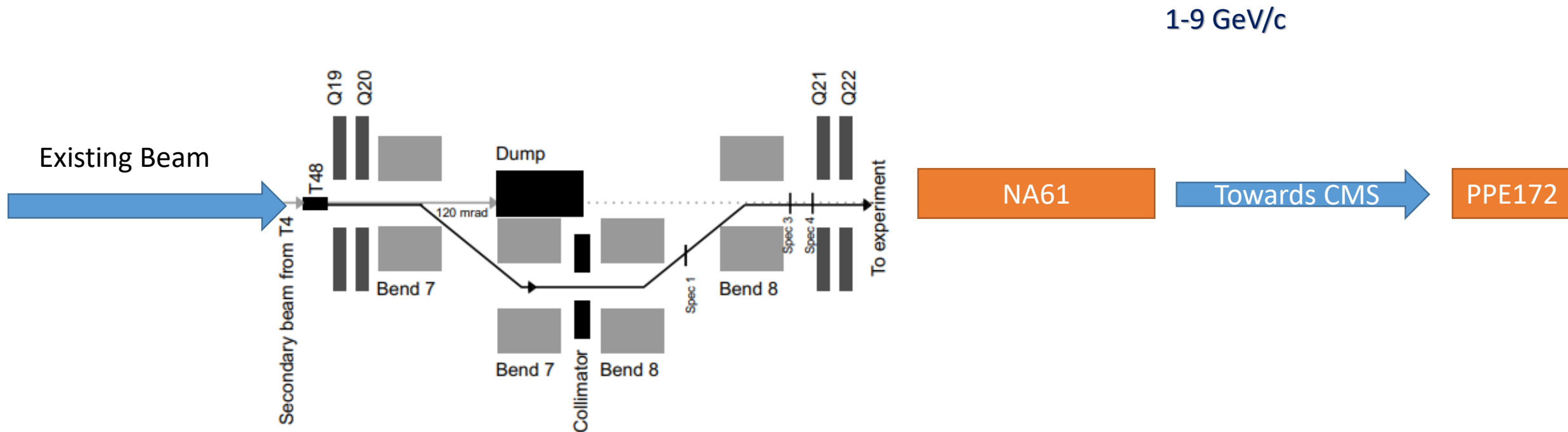

# Possibility for a low-E beam to serve NA61

- After the end of the last VLE quad :
  - ~26 meters to the mid VTPC
  - ~63 meters to PPE172
    - To be considered in terms of particle decays.

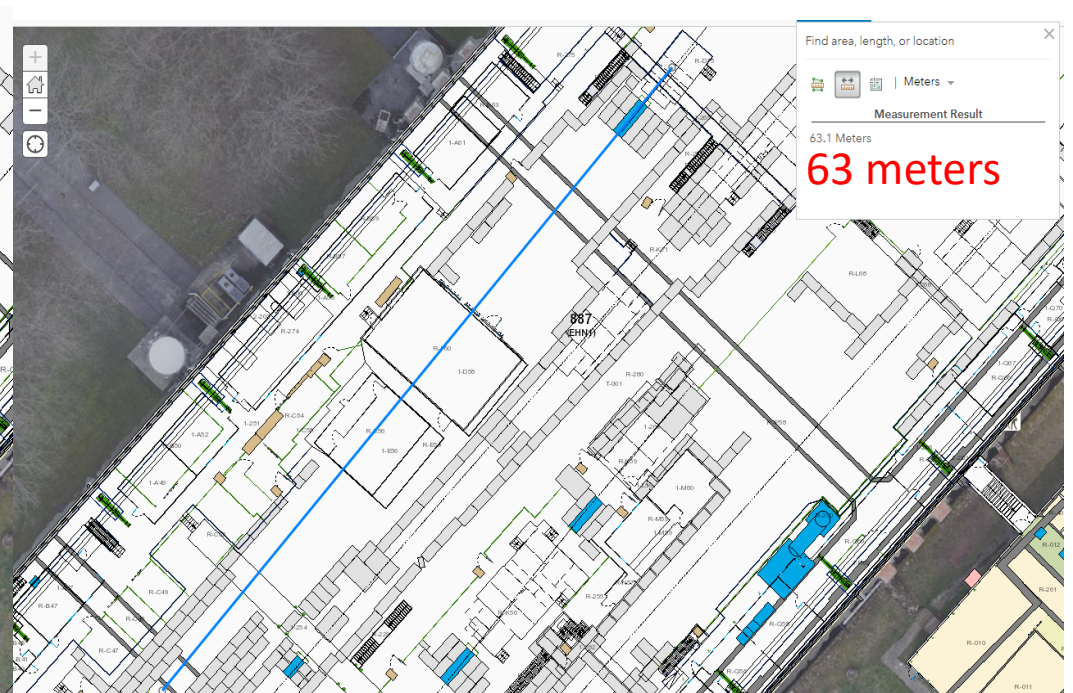

# Pions and protons could still make it

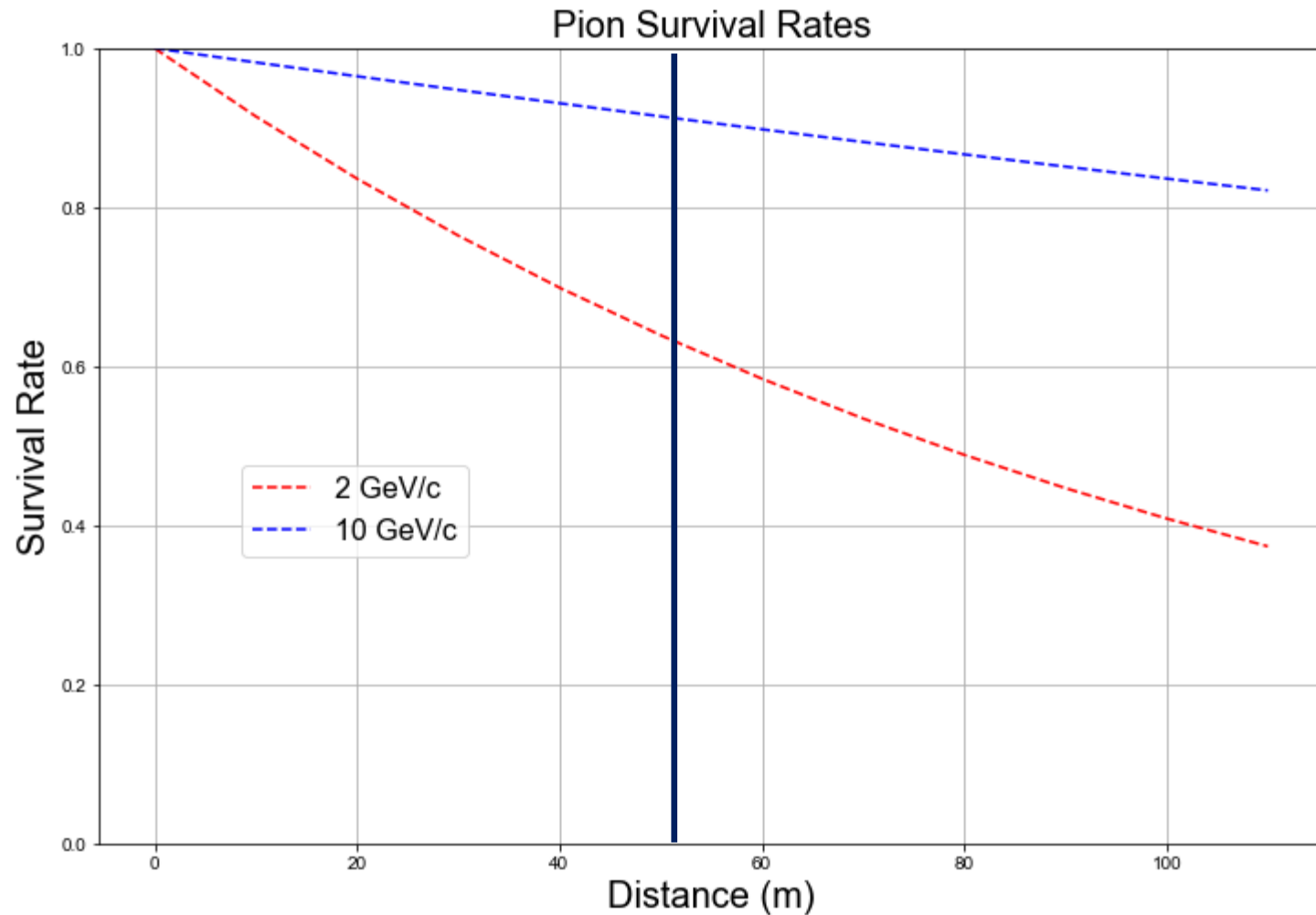

# Other considerations

- Apart from the beam-line quadrupoles, what equipment exists in PPE132-42 that needs to be imperatively preserved ?
  - BPDs ? Reserved space ?

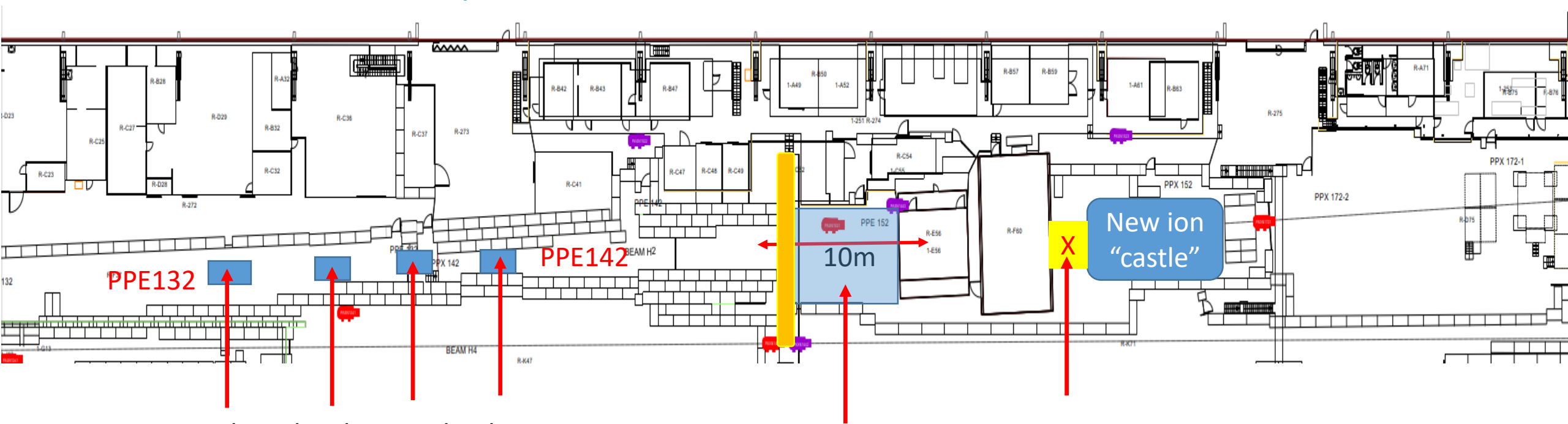

Quadrupoles that need to be re-arranged + space for CEDAR

NA61 reserved space

Possible platform for another experiment ?